



COLUMBIA COUNTY BOARD OF COUNTY COMMISSIONERS AGENDA ITEM REQUEST FORM

The Board of County Commissioners meets the 1st and 3rd Thursday of each month in the Columbia County School Board Administrative Complex Auditorium, 372 West Duval Street, Lake City, Florida 32055. The first meeting of every month is at 9:30AM while the second meeting of every month takes place at 5:30PM. All agenda items are due in the Board's office one week prior to the meeting date.

Today's Date: 1/8/2025 Meeting Date: 1/16/2025

Department: Public Works

1. Nature and purpose of agenda item:

Utility Permit from Hargray of Florida requesting to install a cable along SW Sisters Welcome to Grandview

2. Recommended Motion/Action:

Approve

3. Fiscal impact on current budget.

This item has no effect on the current budget.

COLUMBIA COUNTY BOARD OF COUNTY COMISSIONERS UTILITY PERMIT

Date: 12/18/24 Permit No. _____ County Road SW Grandview St Section No. _____

Permittee Hargray of Florida, Inc

Address PO Box 1229 Pooler, GA 31322 Telephone Number 812-430-2143

Requesting permission from Columbia County, Florida, hereinafter called the County, to contract, operate and maintain Proposed directional bore to place (1) 1.25" HDPE duct with fiber optic cable and associated
appurtenances to provide commercial broadband services. The portion on SW Sisters Welcome Rd will
be overpull into existing duct, no new excavation.

FROM: SW Sisters Welcome Rd TO: 1459 SW Grandview Pl
(overpull)

Submitted for the Utility Owner by: <u>Korie Nellis, Permit Manager</u>	<u>Korie Nellis</u>	<u>12/18/24</u>
Typed Name & Title	Signature	Date

1. Permittee declares that prior to filing this application it has determined the location of all existing utilities, both aerial and underground and the accurate locations are shown on the plans attached hereto and made a part of this application. Proposed work is within corporate limits of Municipality: YES (☒) NO (☐). If YES: LAKE CITY (☒) FORT WHITE (☐). A letter of notification was mailed on 12/06/2024 to the following utility owners Comcast, AT&T, Teco

2. The Columbia County Public Works Director shall be notified twenty-four (24) hours prior to starting work and again immediately upon completion of work. The Public Works Director is _____,
located at 607 NW Quinton St, Lake City, FL 32055 Telephone Number 386-758-1019.
The PERMITTEE's employee responsible for Maintenance of Traffic is David Dryer
Telephone Number 843-227-0183 (This name may be provided
at the time of the 24 hour notice to starting work.)

3. This PERMITTEE shall commence actual construction in good faith within 15 days after issuance of permit, and shall be completed within 60 days after permitted work has begun. If the beginning date is more than 60 days from date of permit approval, then PERMITTEE must review the permit with the Columbia County Public Works Director to make sure no changes have occurred in the transportation facility that would affect the permitted construction.

4. The construction and maintenance of such utility shall not interfere with the property and rights of a prior PERMITTEE.

5. It is expressly stipulated that this permit is a license for permissive use only and that the placing of utilities upon public property pursuant to this permit shall not operate to create or vest any property right in said holder.

6. Pursuant to Section 337-403(1), Florida Statutes, whenever necessary for the construction, repair, improvement, maintenance, safe and efficient operation, alteration or relocation of all, or any portion of said transportation facility as determined by the Columbia County Public Works Director and/or County Engineer, any or all utilities and appurtenances authorized hereunder, shall be immediately removed from said transportation facility or reset or

Utilities Permit
Page Two
Revised: 8/17/00

relocated thereon as required by the Columbia County Public Works Director and/or County Engineer and at the expense of the PERMITTEE.

7. In case of non-compliance with the County's requirements in effect as of the approval date of this permit, this permit void and the facility will have to be brought into compliance or removed from the right of way at no cost to the County.

8. It is understood and agreed that the rights and privileges herein set out are granted only to the extent of the County's right, title and interest in the land to be entered upon and used by the PERMITTEE, and the PERMITTEE will, at all times, and to the extent permitted by law, assume all risk of and indemnify, defend, and save harmless Columbia County, Florida from any and all loss, damage, cost or expense arising in any manner on account of the exercise or attempted exercise by said PERMITTEE of the aforesaid right and privileges.

9. During construction, all safety regulations of the County shall be observed and the PERMITTEE must take measures, including pacing and the display of safety devices that may be necessary in order to safely conduct the public through the project area in accordance with the Federal Manual on Uniform Traffic Control Devices, as amended for highways.

10. Should the PERMITTEE be desirous of keeping its utilities in place and out of service, the PERMITTEE, by execution of this permit acknowledges its present and continuing ownership of its utilities located between _____ and _____ within the County's right of way as set forth above. PERMITTEE, as its sole expense, shall promptly remove said out of service utilities whenever Columbia County Public Works Director and/or County Engineer determines said removal is in the public interest.

11. Special instructions: Minimum cover of thirty inches (30") will be required at all locations. Columbia County will not be financially responsible for any damage to facilities with less than thirty inches (30") cover. Cables shall not be located within driveway ditches.

12. Additional Stipulations: _____

It is understood and agreed that commencement by the PERMITTEE is acknowledgment and acceptance of the binding nature of these specialist instructions.

Submitted By: Korie Nellis
Permittee

Place Corporate Seal

Korie Nellis Permit Manager
Signature and Title

Attested

Utilities Permit
Page three
Revised: 8/17/00

Recommended for Approval:

Signature: 1. LCP
Title: ADD County MANAGER
Date: 01-27-06

Approval by Board of County Commissioners, Columbia County, Florida:

YES () NO ()

Date Approved: _____

Chairman's Signature: _____

TYPICAL BURIED CABLE
CONSTRUCTION
PARALLEL

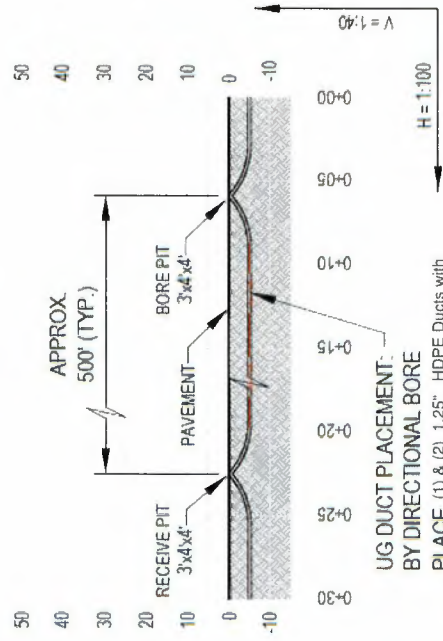

FIBER OPTIC CABLE
AT A MINIMUM DEPTH OF 36"

TYPICAL BURIED CABLE
CONSTRUCTION
CROSSING

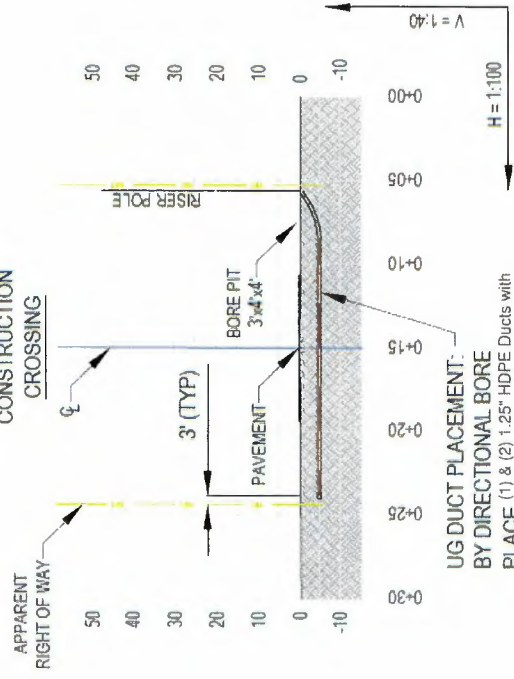

FIBER OPTIC CABLE
AT A MINIMUM DEPTH OF 5'

TYPICAL DETAIL
CONCRETE WALL

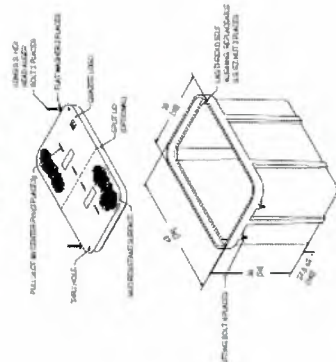

TYPICAL DETAIL
CONCRETE WALL

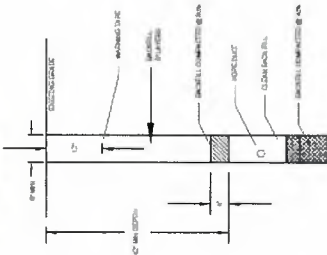

TYPICAL DETAIL
CONCRETE WALL

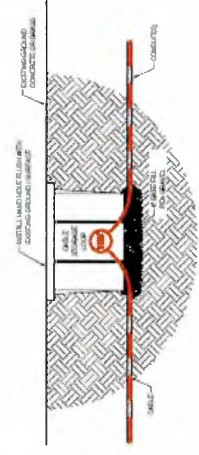

TYPICAL DETAIL
CONCRETE WALL

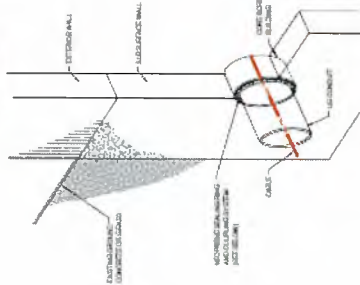

TYPICAL DETAIL
CONCRETE WALL

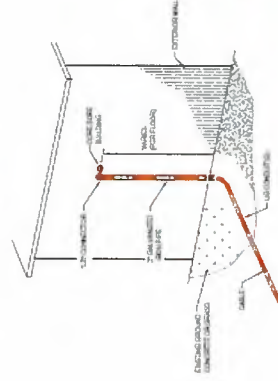

TYPICAL DETAIL
CONCRETE WALL

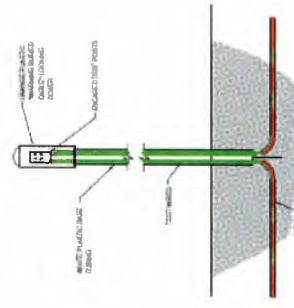

TYPICAL DETAIL
CONCRETE WALL

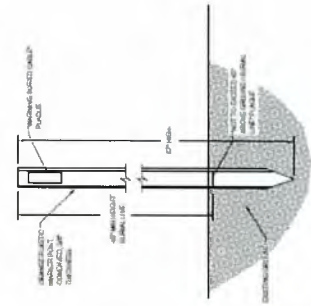

TYPICAL DETAIL
CONCRETE WALL

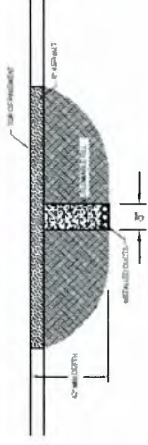

TYPICAL DETAIL
CONCRETE WALL

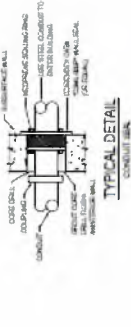

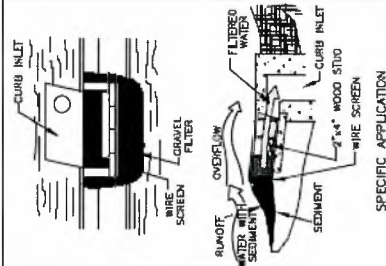

SPECIFIC APPLICATION

THIS METHOD OF INLET PROTECTION IS APPLICABLE AT CURB INLETS WHERE AN OVERFLOW CAPABILITY IS NECESSARY TO PREVENT EXCESSIVE PONDING IN FRONT OF THE STRUCTURE.

BLOCK & GRAVEL CURB INLET SEDIMENT FILTER

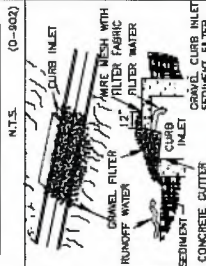

SPECIFIC APPLICATION

THIS METHOD OF INLET PROTECTION IS APPLICABLE AT CURB INLETS WHERE PONDING IN FRONT OF THE STRUCTURE IS NOT LIKELY TO CAUSE INCONVENIENCE OR DAMAGE TO ADJACENT STRUCTURES AND UNPROTECTED AREAS.

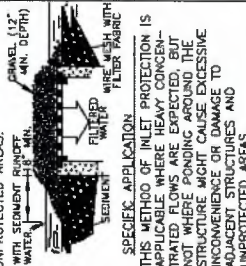

SPECIFIC APPLICATION

THIS METHOD OF INLET PROTECTION IS APPLICABLE WHERE HEAVY CONCENTRATED FLOWS ARE EXPECTED, BUT THE STRUCTURE MIGHT CAUSE EXCESSIVE INCONVENIENCE OR DAMAGE TO ADJACENT STRUCTURES AND UNPROTECTED AREAS.

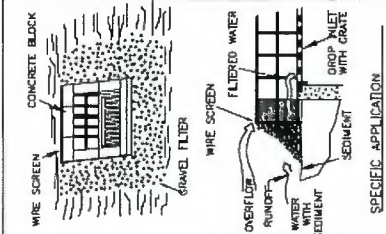

SPECIFIC APPLICATION

THIS METHOD OF INLET PROTECTION IS APPLICABLE WHERE HEAVY FLOWS ARE EXPECTED AND WHERE ANY OVERFLOW CAPABILITY IS NECESSARY TO PREVENT EXCESSIVE PONDING AROUND THE STRUCTURE.

BLOCK & GRAVEL DROP INLET SEDIMENT FILTER

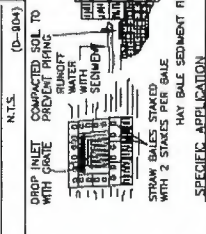

SPECIFIC APPLICATION

THIS METHOD OF INLET PROTECTION IS APPLICABLE WHERE HEAVY FLOWS ARE EXPECTED AND WHERE ANY OVERFLOW CAPABILITY IS NECESSARY TO PREVENT EXCESSIVE PONDING AROUND THE STRUCTURE.

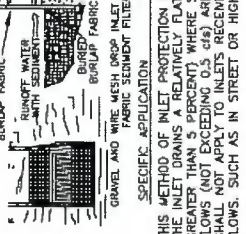

SPECIFIC APPLICATION

THIS METHOD OF INLET PROTECTION IS APPLICABLE WHERE HEAVY FLOWS ARE EXPECTED AND WHERE ANY OVERFLOW CAPABILITY IS NECESSARY TO PREVENT EXCESSIVE PONDING AROUND THE STRUCTURE.

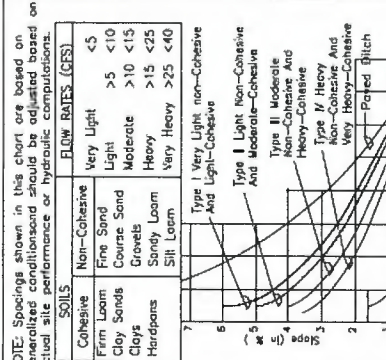

RECOMMENDED SPACING FOR TYPE I AND TYPE II HAY BALE BARRIERS, AND TYPE III AND TYPE IV BARRIERS

SPACING RECOMMENDATION FOR SILT FENCES & HAY BALES

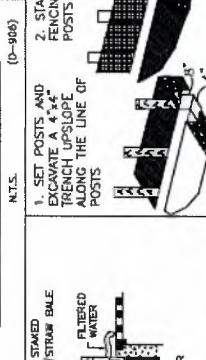

SPECIFIC APPLICATION

THIS METHOD OF INLET PROTECTION IS APPLICABLE WHERE HEAVY FLOWS ARE EXPECTED AND WHERE ANY OVERFLOW CAPABILITY IS NECESSARY TO PREVENT EXCESSIVE PONDING AROUND THE STRUCTURE.

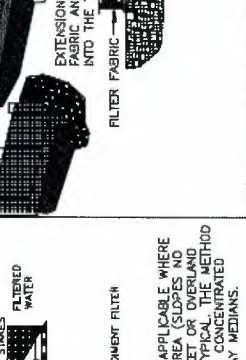

SPECIFIC APPLICATION

THIS METHOD OF INLET PROTECTION IS APPLICABLE WHERE HEAVY FLOWS ARE EXPECTED AND WHERE ANY OVERFLOW CAPABILITY IS NECESSARY TO PREVENT EXCESSIVE PONDING AROUND THE STRUCTURE.

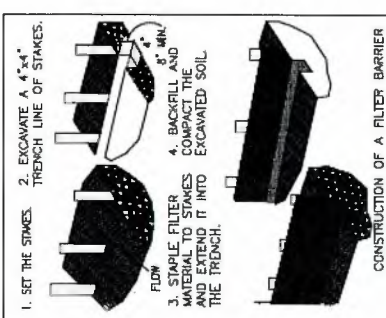

SPECIFIC APPLICATION

THIS METHOD OF INLET PROTECTION IS APPLICABLE WHERE HEAVY FLOWS ARE EXPECTED AND WHERE ANY OVERFLOW CAPABILITY IS NECESSARY TO PREVENT EXCESSIVE PONDING AROUND THE STRUCTURE.

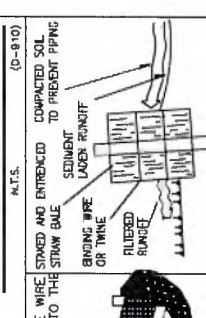

SPECIFIC APPLICATION

THIS METHOD OF INLET PROTECTION IS APPLICABLE WHERE HEAVY FLOWS ARE EXPECTED AND WHERE ANY OVERFLOW CAPABILITY IS NECESSARY TO PREVENT EXCESSIVE PONDING AROUND THE STRUCTURE.

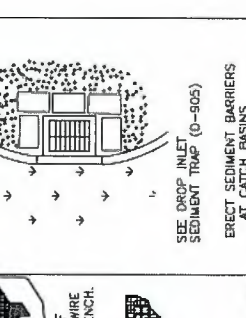

SPECIFIC APPLICATION

THIS METHOD OF INLET PROTECTION IS APPLICABLE WHERE HEAVY FLOWS ARE EXPECTED AND WHERE ANY OVERFLOW CAPABILITY IS NECESSARY TO PREVENT EXCESSIVE PONDING AROUND THE STRUCTURE.

- EROSION CONTROL NOTES**
1. ALL UTILITY LOCATIONS ARE APPROXIMATE AND MUST BE LOCATED PRIOR TO CONSTRUCTION.
 2. VEGETATION CLEARING WILL BE KEPT TO THE ABSOLUTE MINIMUM NECESSARY FOR CONSTRUCTION.
 3. MATERIAL RESULTING FROM EXCAVATION WILL NOT BE PLACED IN SUCH A MANNER THAT IT IS DISPERSED BY CURRENT OR OTHER FORCES. THE MATERIAL SHOULD BE COLLECTED AND CONTAINED AT ONE SITE AS APPROPRIATE.
 4. HEAVY EQUIPMENT WORKING IN WETLANDS WILL BE PLACED ON MATS OR LOW GROUND PRESSURE EQUIPMENT USED DURING CONSTRUCTION TO LIMIT SOIL DISTURBANCE TO THE MINIMUM AREA REQUIRED TO INSTALL THE FIBER OPTIC SYSTEM ONLY.
 5. NO STAGING AREAS OR TEMPORARY ACCESS ROADS WILL BE PLACED IN WETLANDS.
 6. APPROPRIATE SITUATION AND EROSION CONTROLS WILL BE USED AND MAINTAINED IN EFFECTIVE OPERATING CONDITION DURING CONSTRUCTION, AND ALL EXPOSED SOIL AND FILLS WILL BE PERMANENTLY STABILIZED AT THE EARLIEST PRACTICABLE DATE.
 7. SEDIMENT CONTROL FENCE (SILT FENCE) SHOULD BE INSTALLED AND MAINTAINED FOR THE DURATION OF THE CONSTRUCTION. SILT FENCE WILL BE INSTALLED ALONG AND WITHIN RIGHT-OF-WAY LINE (12 FT AWAY FROM EDGE OF R.O.W.). IF BODY OF WATER OR POTENTIAL WETLAND IS LOCATED WITHIN 60 FT FROM THE EDGE OF THE R.O.W. ANY OTHER SITUATIONS WILL BE APPROVED BY THE ENGINEER.
 8. WHEN CONSTRUCTING IN WETLANDS, THE TOP 6 TO 12 INCHES OF THE TRENCH WILL BE BACK FILLED WITH TOPSOIL FROM THE TRENCH.
 9. EXCESS MATERIAL WILL BE REMOVED FROM THE WETLAND AND PLACED ON UPLAND AREAS IMMEDIATELY UPON COMPLETION OF CONSTRUCTION.
 10. EXPOSED SLOPES OF STREAM BANKS WILL BE RESTORED TO THEIR ORIGINAL CONTOURS AND STABILIZED IMMEDIATELY UPON COMPLETION OF CONSTRUCTION.
 11. ANY TEMPORARY FILLS MUST BE REMOVED IN THEIR ENTIRETY AND THE AFFECTED AREAS RETURNED TO THEIR PRE-EXISTING CONDITION.
 12. ANY DISTURBED AREA WILL BE RE-SEEDING WITH NATIVE GRASS SEEDS AND SEDIMENT CONTROL FENCE SHOULD BE REMOVED UPON COMPLETION CONSTRUCTION IMMEDIATELY.
 13. WHEN CONSTRUCTING IN CITY LIMITS, ALL ROADWAY DRAINS SUCH AS INLETS, NEAR CURBS OR DROP INLET ON ROADWAY WHICH ARE LOCATED IN THE R.O.W. SHALL BE PROTECTED WITH TYPICAL INLET SEDIMENT FILTERS. THESE FILTERS WILL BE REMOVED IMMEDIATELY UPON COMPLETION OF CONSTRUCTION.
 14. ALL CABLE MARKERS TO BE PLACED AS FAR BACK TO R.O.W. LINE AS POSSIBLE.
 15. ALL HARD SURFACE THROUGHFARES TO BE DIRECTIONAL BORED MINIMUM 36 INCHES BELOW SURFACE, MINIMUM 5 FT FROM EDGE OF PAVEMENT TO BE CROSSED.
 16. ALL HARD SURFACE DRIVEWAYS TO BE DIRECTIONAL DRILLED.

<div data-bbox="365 472 738 1627"> </div> <div data-bbox="771 472 803 1627"> <p>MULTILANE ROADWAY SHOWN, TWO-LANE ROADWAY SIMILAR</p> </div> <div data-bbox="852 1102 1031 1606"> <p>NOTES:</p> <ol style="list-style-type: none"> 1. This Index applies to Two-Lane, Two-Way and Multilane Roadways, including Medians of divided roadways, with work beyond the shoulder. 2. Use Index 102-602 when the work operation (excluding establishing and terminating the work area) requires that two or more work vehicles cross the Offset Zone in any one hour period. 3. Use Index 102-660 when Work Area encroaches a Sidewalk. </div> <div data-bbox="852 514 950 892"> <p>SYMBOLS:</p> <div> Work Area Lane Identification and Direction of Traffic </div> </div>	<div data-bbox="1380 58 1458 2032"> <div> <div> <div>LAST REVISION</div> <div>11/01/20</div> </div> <div> <div>DESCRIPTION:</div> <div>STANDARD PLANS</div> </div> <div> <div> </div> <div> <div>FY 2024-25</div> <div>STANDARD PLANS</div> </div> </div> <div> <div> <div>TWO-LANE AND MULTILANE ROADWAY, WORK BEYOND THE SHOULDER</div> <div>INDEX</div> <div>102-601</div> </div> <div> <div>SHEET</div> <div>1 of 1</div> </div> </div> </div></div>
---	--

NOTES:

1. Cover or deactivate pedestrian traffic signal display(s) controlling closed crosswalks.
2. Place pedestrian LCDs across the full width of the closed sidewalk.
3. For post mounted signs located near or adjacent to a sidewalk, maintain a minimum 7' clearance from the bottom of the sign panel to the surface of the sidewalk.
4. "Sidewalk Closed" signs (R9-XX) may be mounted on pedestrian LCDs in accordance with the manufacturer's instructions.
5. Omit the Advance Closure LCD if it blocks access to other pedestrian facilities (e.g., transit stops, residences, or business entrances).

SYMBOLS:

-  Work Area
-  Work Zone Sign
-  Pedestrian Longitudinal Channelizing Device (LCD)
-  Lane Identification and Direction of Traffic

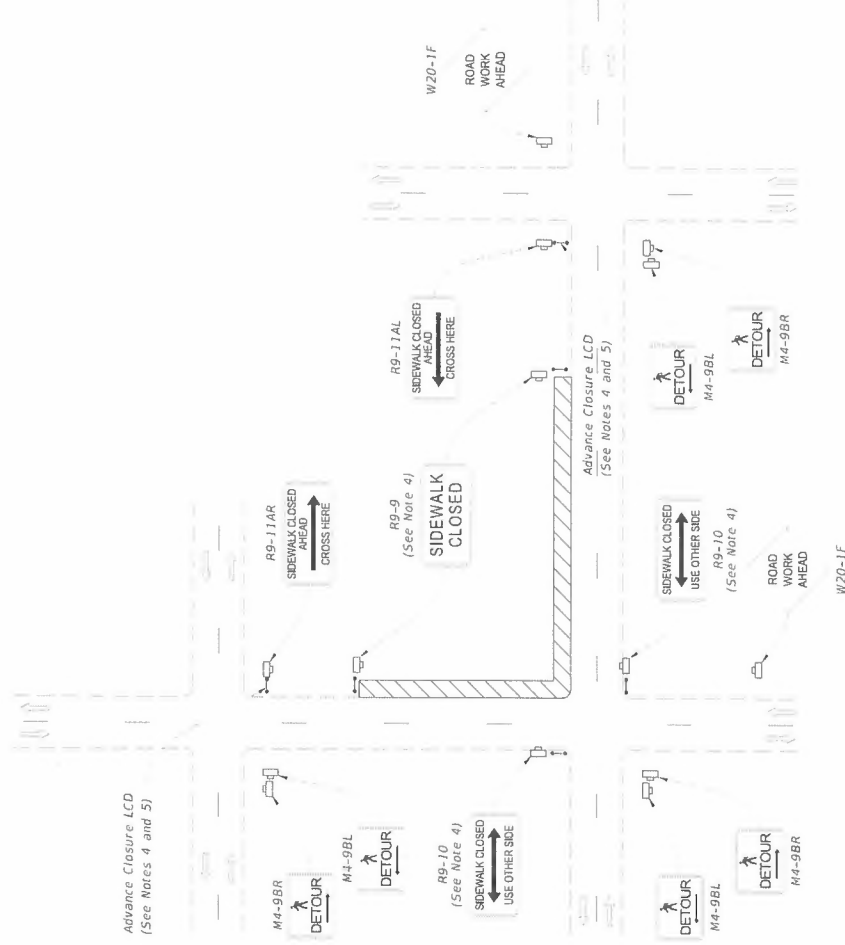

PEDESTRIAN DETOUR

LAST REVISION 11/01/20	DESCRIPTION: REVISION	 FY 2024-25 STANDARD PLANS	SIDEWALK CLOSURE INDEX 102-660 SHEET 1 of 2
------------------------------	--------------------------	--	---

clearwave® fiber™ **ENGINEERING**

- | | | | |
|---------------------------------|-------------------------------|-----------|------|
| PROJECT: | PROJECT SITE: P-035498 | BY | DATE |
| THE BLUCK STOVE PLACE | CONTRACTOR: | STAKED: | - |
| 1458 SW GRANDVIEW ST | SOURCEONE CORP. | RELEASED | - |
| LAKE CITY, FL 33025 | SCALE: | AS BUILT: | - |
| WORK ORDER #: 2208504736 | NTS | | |
- SHEET # **1**

[illegible][illegible]

PROPOSED WORK LOCATION
THE BUCK STOVE PLACE
1459 SW GRANDVIEW ST

- fact:
8 HARRISON
i) 752-7010
truckstoveplace@gmail.com



contact:
BOB HARRISON
(386) 752-7010
thebuckstoveplace@gmail.com

PROJECT:	PROJECT SITE: P-035498	BY	DATE
THE BUCK STOVE PLACE 459 SW GRANDVIEW ST LAKE CITY, FL 32025	CONTRACTOR: SOURCEONE CORP.	STAKED:	
		RELEASED:	
WORK ORDER #: 2208504736	SCALE: 1" = 40'	AS BUILT:	

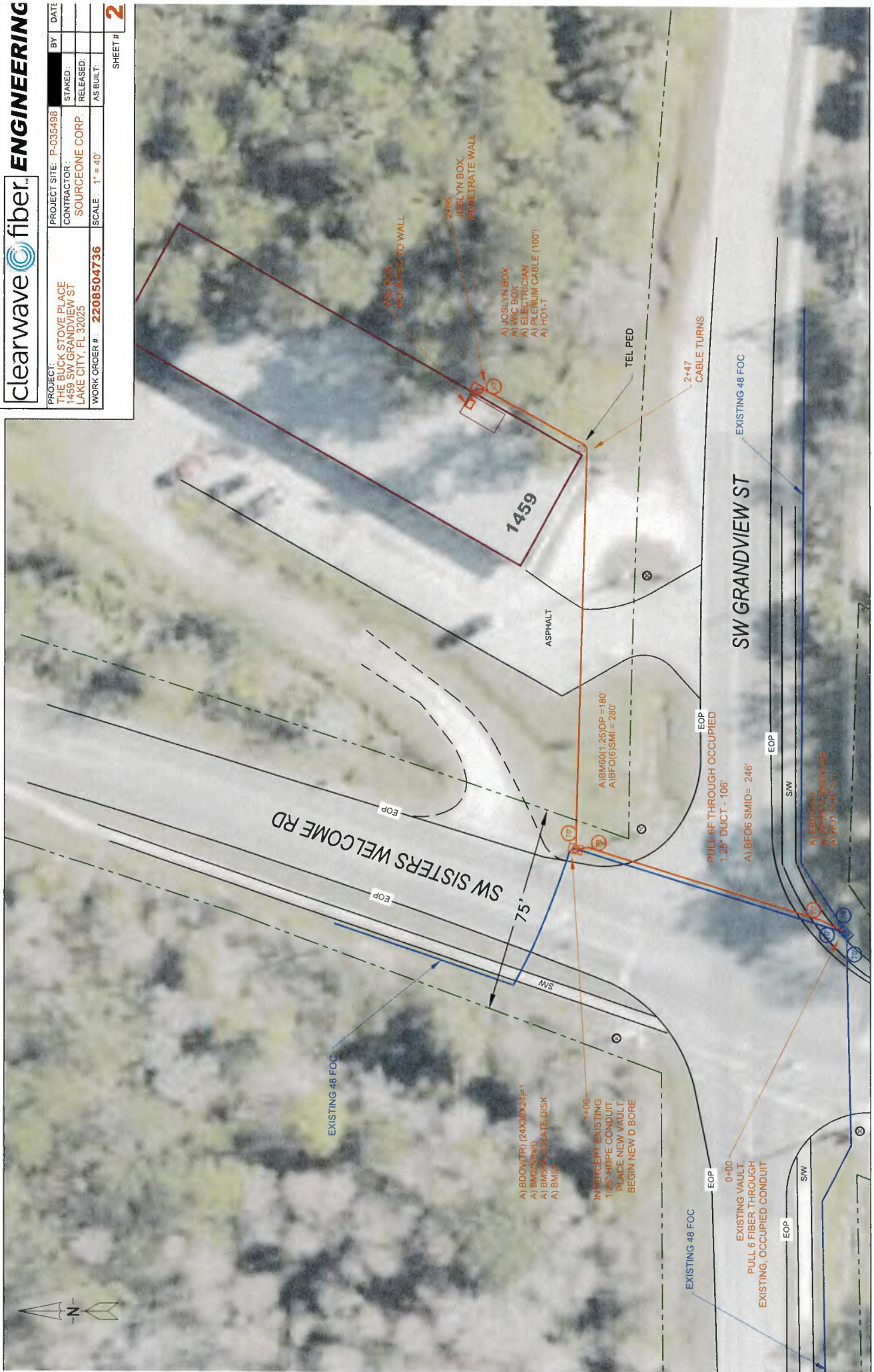

NEW VAULT
INTERCEPTS
EXISTING
CONDUIT
1 1/4" HDPE CONDUIT



NEW
(1) 1 1/4" HDPE CONDUIT
E/W (1) 6 FOC

NEW 6FOC
PULLED THROUGH
OCCUPIED 1 1/4" HDPE CONDUIT



NEW
(1) 1 1/4" HDPE CONDUIT
E/W (1) 6 FOC

NEW
WIC BOX

NEW
PLENUM CABLE

NEW
JOSLYN BOX

NEW
PLENUM CABLE
PENETRATES WALL

NEW
(1) 1 1/4" HDPE CONDUIT
E/W (1) 6 FOC



SERVER CLOSET

SW GRANDVIEW AT
SISTERS WELCOME RD