



## COLUMBIA COUNTY BOARD OF COUNTY COMMISSIONERS AGENDA ITEM REQUEST FORM

The Board of County Commissioners meets the 1st and 3rd Thursday of each month in the Columbia County School Board Administrative Complex Auditorium, 372 West Duval Street, Lake City, Florida 32055. The first meeting of every month is at 9:30AM while the second meeting of every month takes place at 5:30PM. All agenda items are due in the Board's office one week prior to the meeting date.

Today's Date: 3/8/2024 Meeting Date: 3/21/2024

Department: Public Works

### 1. Nature and purpose of agenda item:

Utility permit from Comcast requesting to run a cable along SE County Road 252

### 2. Recommended Motion/Action:

Approve Utility permit from Comcast requesting to run a cable along SE County Road 252

### 3. Fiscal impact on current budget.

This item has no effect on the current budget.

**COLUMBIA COUNTY BOARD OF COUNTY COMMISSIONERS  
UTILITY PERMIT**

Date: \_\_\_\_\_ Permit No. \_\_\_\_\_ County Road \_\_\_\_\_ Section No. \_\_\_\_\_

Permittee Southeast Utilities of Georgia OBO Comcast

Address 5934 Richard Street, Jacksonville, FL 32216 Telephone Number 407- 797 - 2997

Requesting permission from Columbia County, Florida, hereinafter called the County, to contract, operate and maintain Install 196' UG of .700 Coax along SE CR - 252 to improve service.

FR - JB1728376

FROM: 1013 SE COUNTY ROAD 252

TO: 125 SE PASTURE WAY

Submitted for the Utility Owner by: <u>Christy Feitlin - Permit Coordinator</u>	<u>Christy Feitlin</u>	3/4/2024
Typed Name & Title	Signature	Date

1. Permittee declares that prior to filing this application it has determined the location of all existing utilities, both aerial and underground and the accurate locations are shown on the plans attached hereto and made a part of this application. Proposed work is within corporate limits of Municipality: YES ( ) NO ( ). If YES: LAKE CITY ( ) FORT WHITE ( ). A letter of notification was mailed on 3/4/2024 to the following utility owners Clay Electric, Lake City Utilities, AT&T

2. The Columbia County Public Works Director shall be notified twenty-four (24) hours prior to starting work and again immediately upon completion of work. The Public Works Director is \_\_\_\_\_, located at 607 NW Quinten St Lake City, FL Telephone Number 386-758-1019. The PERMITTEE's employee responsible for Maintenance of Traffic is Tim Salyard Telephone Number 904-531-6985 (This name may be provided at the time of the 24 hour notice to starting work.)

3. This PERMITTEE shall commence actual construction in good faith within 30 days after issuance of permit, and shall be completed within 10 days after permitted work has begun. If the beginning date is more than 60 days from date of permit approval, then PERMITTEE must review the permit with the Columbia County Public Works Director to make sure no changes have occurred in the transportation facility that would affect the permitted construction.

4. The construction and maintenance of such utility shall not interfere with the property and rights of a prior PERMITTEE.

5. It is expressly stipulated that this permit is a license for permissive use only and that the placing of utilities upon public property pursuant to this permit shall not operate to create or vest any property right in said holder.

6. Pursuant to Section 337-403(1), Florida Statutes, whenever necessary for the construction, repair, improvement, maintenance, safe and efficient operation, alteration or relocation of all, or any portion of said transportation facility as determined by the Columbia County Public Works Director and/or County Engineer, any or all utilities and appurtenances authorized hereunder, shall be immediately removed from said transportation facility or reset or

relocated thereon as required by the Columbia County Public Works Director and/or County Engineer and at the expense of the PERMITTEE.

7. In case of non-compliance with the County's requirements in effect as of the approval date of this permit, this permit void and the facility will have to be brought into compliance or removed from the right of way at no cost to the County.

8. It is understood and agreed that the rights and privileges herein set out are granted only to the extent of the County's right, title and interest in the land to be entered upon and used by the PERMITTEE, and the PERMITTEE will, at all times, and to the extent permitted by law, assume all risk of and indemnify, defend, and save harmless Columbia County, Florida from any and all loss, damage, cost or expense arising in any manner on account of the exercise or attempted exercise by said PERMITTEE of the aforesaid right and privileges.

9. During construction, all safety regulations of the County shall be observed and the PERMITTEE must take measures, including pacing and the display of safety devices that may be necessary in order to safely conduct the public through the project area in accordance with the Federal Manual on Uniform Traffic Control Devices, as amended for highways.

10. Should the PERMITTEE be desirous of keeping its utilities in place and out of service, the PERMITTEE, by execution of this permit acknowledges its present and continuing ownership of its utilities located between 1013 SE COUNTY ROAD 252 and 125 SE PASTURE WAY within the County's right of way as set forth above. PERMITTEE, as its sole expense, shall promptly remove said out of service utilities whenever Columbia County Public Works Director and/or County Engineer determines said removal is in the public interest.

11. Special instructions: Minimum cover of thirty inches (30") will be required at all locations. Columbia County will not be financially responsible for any damage to facilities with less than thirty inches (30") cover. Cables shall not be located within driveway ditches.

12. Additional Stipulations: \_\_\_\_\_  
\_\_\_\_\_  
\_\_\_\_\_  
\_\_\_\_\_  
\_\_\_\_\_

It is understood and agreed that commencement by the PERMITTEE is acknowledgment and acceptance of the binding nature of these specialist instructions.

Submitted By: Christy Feitlin  
Permittee

Place Corporate Seal

Christy Feitlin - PC  
Signature and Title

\_\_\_\_\_  
Attested

Utilities Permit  
Page three  
Revised: 8/17/00

Recommended for Approval:

Signature: 143

Title: 222 County Manager

Date: 03-06-04

Approval by Board of County Commissioners, Columbia County, Florida:

YES ( ) NO ( )

Date Approved: \_\_\_\_\_

Chairman's Signature: \_\_\_\_\_





COLUMBIA COUNTY



VICINITY MAP:  
125 SE PASTURE WAY, LAKE CITY, FL 32025

COMCAST PERMIT REQUEST FOR LOCATION:  
125 SE PASTURE WAY, LAKE CITY, FL 32025  
THESE PLANS WERE PREPARED UNDER THE  
RESPONSIBLE CHARGE OF COMCAST.

JB1728376

NO EXPECTED CONFLICTS  
WITH OTHER UTILITIES

LOCATION: 125 SE PASTURE WAY, LAKE CITY, FL 32025

TOTAL LENGTH OF JOB: 196' UG



COMCAST

JOB DESCRIPTION: CATV DIRECTIONAL BORE  
PLACEMENT

DRAWN BY: SS

DATE: 02/13/2023

SCALE: NTS

GENERAL NOTES:

ALL PROPOSED UNDERGROUND CATV WILL BE BURIED A MINIMUM OF 36" INCLUDING ROAD BORES AND DRIVEWAY BORES.

ALL PROPOSED UNDERGROUND CATV ROAD BORES WILL USE CITY APPROVED DIRECTIONAL BORE MACHINE, AS WELL AS COUNTY APPROVED CONDUIT.

ALL PROPOSED CATV ROAD BORES WILL EXTEND A MINIMUM OF 7' BEYOND THE EDGE OF PAVEMENT.

ALL PROPOSED CATV DRIVEWAY BORES WILL EXTEND A MINIMUM OF 6' BEYOND THE EDGE OF PAVEMENT.

ALL PROPOSED BORES WILL BE IN A (4"x4"x4") PIT AND WILL USE 2" HDPE CONDUIT AT 36" DEPTH USING A 5 1/4" DRILL HEAD.

ALL PROPOSED AERIAL CATV WILL BE 0.700" DIAMETER AND WILL BE LASHED TO 0.250" STEEL STRAND CABLE USING 0.125" STANDARD GALVANIZED LASHING WIRE.

ALL PROPOSED AERIAL CATV CROSSING ROADWAYS WILL HAVE A MINIMUM MID-SPAN HEIGHT OF 18'-0".

ALL PROPOSED AERIAL CATV CROSSING DRIVEWAYS WILL HAVE A MINIMUM MID-SPAN HEIGHT OF 16'-0".

LOCATES WILL BE REQUIRED IN ALL PROPOSED UNDERGROUND AREAS AT LEAST 48 HRS PRIOR TO CONSTRUCTION. NOTIFICATIONS TO ALL UTILITIES INVOLVED WILL BE MADE PRIOR TO CONSTRUCTION.

ALL DISTRIBUTED AREA WITHIN THE RIGHT OF WAY WILL BE RESTORED TO ORIGINAL OR BETTER CONDITION BY GRADING AND RE-SODDING. SOD ALL AREAS DISTURBED BY CONSTRUCTION WITH BERNUDA SOD. "ALL CRACKED SIDEWALKS ARE TO BE REPLACED FROM JOINT TO JOINT WITHIN 7 DAYS OF WORK COMPLETION."

WORK OPERATIONS ARE TO BE MINDFUL NOT TO DAMAGE THE PAVEMENT SIDEWALK WHEN POSITIONING EQUIPMENT. ANY DAMAGE INCLUDING TRACK MARKS WILL BE REPAIRED OR REPLACED BY THE CONTRACTOR.

CONSTRUCTION NOTES:

IN ORDER TO REDUCE THE DISRUPTION AND COST OF UTILITY DAMAGES OCCURRING IN THE RIGHT-OF-WAY AND EASEMENTS, THE PERMITTEE SHALL PREVENT DAMAGES TO EXISTING UTILITIES CAUSED BY THE WORK THROUGH FIELD VERIFICATION OF THE LOCATION OF THE EXISTING UTILITIES IN CASE OF OPEN EXCAVATION. VERIFICATION MAY BE PERFORMED DURING THE PERMITTEES WORK. IN THE CASE OF DIRECTIONAL DRILLING, VERIFICATION SHALL TAKE PLACE PRIOR TO MOBILIZATION OF THE DRILLING EQUIPMENT.

THE PERMITTEE SHALL VERIFY THE LOCATION OF THE EXISTING UTILITIES AS NEEDED TO AVOID CONTACT WITH DETECTION EQUIPMENT OR OTHER ACCEPTABLE MEANS. SUCH METHODS MAY INCLUDE BUT SHALL NOT BE LIMITED TO "SOFT DIG" EQUIPMENT AND GROUND PENETRATION RADAR (GPR). THE EXCAVATOR SHALL BE HELD LIABLE FOR DAMAGES CAUSED TO CITY/COUNTY/STATE INFRASTRUCTURE AND THE EXISTING FACILITIES OF THE OTHER UTILITY COMPANIES.

NO REAMER USED

THE FOLLOWING STANDARD PLANS ARE IN ACCORDANCE WITH  
THE FLORIDA DEPARTMENT OF TRANSPORTATION 2023-2024

INDEX 102-602 AND APPLY TO:

125 SE PASTURE WAY, LAKE CITY, FL 32025

NO BACKREAMER USED  
NO EXPECTED CONFLICTS  
WITH OTHER UTILITIES

COMCAST PERMIT REQUEST FOR LOCATION:  
125 SE PASTURE WAY, LAKE CITY, FL 32025

LEGEND

COMCAST AERIAL ROUTE	(S)	MANHOLE (SANITARY SEWER)
COMCAST BORE ROUTE	(M)	MANHOLE (STORM SEWER)
CABLE TV SPAN (EXIST)	□	CABLE TV PEDESTAL
CABLE TV BORE (EXIST)	○	CABLE TV RISER
FENCE	—X—	UTILITY POLE
FIBER OPTIC CABLE	—○—	FIRE HYDRANT
GAS PIPELINE	—X—	WATER VALVE
OH POWER LINE	—□—	ELECTRIC PAD
UG POWER LINE	—X—	RAILROAD CROSSING SIGN
PROPERTY LINE	—X—	RAILROAD CROSSING SIGNAL
ROAD RIGHT-OF-WAY	—X—	INLET
ROAD CENTERLINE	—X—	CATCH BASIN
EDGE OF PAVEMENT	—X—	WATER VAULT
RAILROAD CENTERLINE	—X—	TELEPHONE PEDESTAL
SANITARY SEWER	—X—	ELECTRIC VAULT
STORM SEWER	—X—	BORE PIT
OH TELEPHONE	—X—	CULVERT
UG TELEPHONE	—X—	WATER MAIN / METER
BOTTOM BANK	—X—	HAND HOLE
DRIVEWAY	—X—	UTILITY VAULT
SIDEWALK	—X—	CATV VAULT
TOP BANK	—X—	CATV VAULT
UNKNOWN UG UTILITY	—X—	GAS VALVE
WATER LINE	—X—	

LOCATION: 125 SE PASTURE WAY, LAKE CITY, FL 32025

TOTAL LENGTH OF JOB: 196' UG



COMCAST

JOB DESCRIPTION: CATV DIRECTIONAL BORE  
PLACEMENT

DRAWN BY: SS

DATE: 02/13/2023

SCALE: NTS



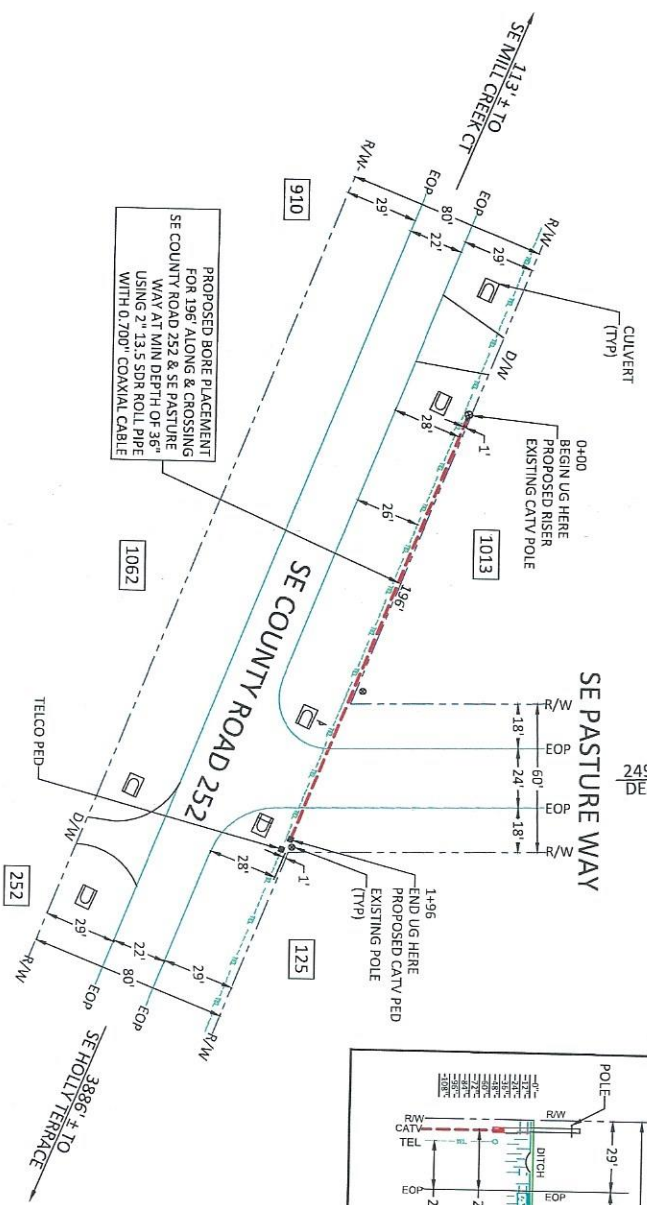
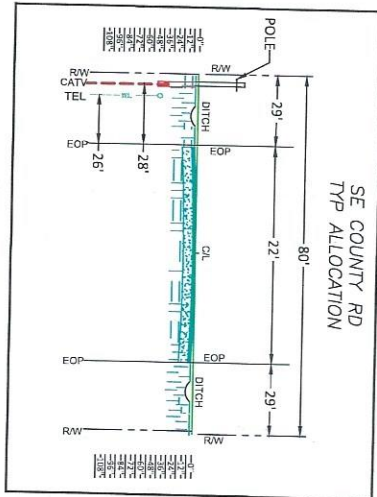
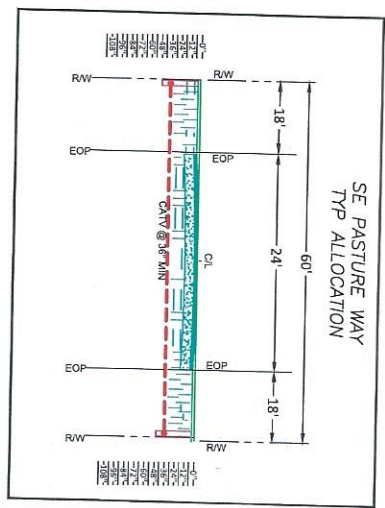
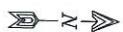

NO BACKREAMER USED  
NO EXPECTED CONFLICTS  
WITH OTHER UTILITIES

LOCATION: 125 SE PASTURE WAY, LAKE CITY, FL 32025	
TOTAL LENGTH OF JOB: 196' UG	
<b>COMCAST</b>	
JOB DESCRIPTION: CATV DIRECTIONAL BORE PLACEMENT	
DRAWN BY: SS	3 OF 4
DATE: 02/13/2023	
SCALE: NTS	

INDEX	SHEET
102-602	4 OF 4