



15

COLUMBIA COUNTY BOARD OF COUNTY COMMISSIONERS
AGENDA ITEM REQUEST FORM

The Board of County Commissioners meets the 1st and 3rd Thursday of each month at 5:30 p.m. in the Columbia County School Board Administrative Complex Auditorium, 372 West Duval Street, Lake City, Florida 32055. All agenda items are due in the Board's office one week prior to the meeting date.

Today's Date: November 28, 2017 Meeting Date: December 7, 2017

Name: Kevin Kirby Department: Public Works

Division Manager's Signature: [Handwritten Signature]

1. Nature and purpose of agenda item:
Utility permit from Comcast for Meeks Street.

Attach any correspondence information, documents and forms for action i.e., contract agreements, quotes, memorandums, etc.

2. Fiscal impact on current budget.

Is this a budgeted item? [X] N/A
[] Yes Account No.
[] No Please list the proposed budget amendment to fund this request

Budget Amendment Number: Fund:

FROM: TO: AMOUNT:

For Use of County Manger Only:

[X] Consent Item [] Discussion Item

**COLUMBIA COUNTY BOARD OF COUNTY COMISSIONERS
UTILITY PERMIT**

Date: 11/27/2017 Permit No. _____ County Road 261 NW Meeks St Section No. _____

Permittee FCG/Comcast

Address 13453 N. Main St. Suite 206, Jacksonville FL 32218 Telephone Number (904) 551-7859

Requesting permission from Columbia County, Florida, hereinafter called the County, to contract, operate and maintain Proposed aerial CATV facilities, project begins at Pole #1, aerial overlash W 237 ft to Pole #2,

aerial overlash 76 ft to Pole #3 to end project.

FROM: ASAP TO: 60 days

Submitted for the Utility Owner by: Jennifer Sanders - Authorized Comcast Agent Jennifer Sanders 11/27/2017
Typed Name & Title Signature Date

1. Permittee declares that prior to filing this application it has determined the location of all existing utilities, both aerial and underground and the accurate locations are shown on the plans attached hereto and made a part of this application. Proposed work is within corporate limits of Municipality: YES () NO (). If YES: LAKE CITY () FORT WHITE (). A letter of notification was mailed on 11/27/2017 to the following utility owners _____

FP&L

2. The Columbia County Public Works Director shall be notified twenty-four (24) hours prior to starting work and again immediately upon completion of work. The Public Works Director is _____, located at _____ Telephone Number _____. The PERMITTEE's employee responsible for Maintenance of Traffic is _____ Telephone Number _____ (This name may be provided at the time of the 24 hour notice to starting work.)

3. This PERMITTEE shall commence actual construction in good faith within _____ days after issuance of permit, and shall be completed within _____ days after permitted work has begun. If the beginning date is more than 60 days from date of permit approval, then PERMITTEE must review the permit with the Columbia County Public Works Director to make sure no changes have occurred in the transportation facility that would affect the permitted construction.

4. The construction and maintenance of such utility shall not interfere with the property and rights of a prior PERMITTEE.

5. It is expressly stipulated that this permit is a license for permissive use only and that the placing of utilities upon public property pursuant to this permit shall not operate to create or vest any property right in said holder.

6. Pursuant to Section 337-403(1), Florida Statutes, whenever necessary for the construction, repair, improvement, maintenance, safe and efficient operation, alteration or relocation of all, or any portion of said transportation facility as determined by the Columbia County Public Works Director and/or County Engineer, any or all utilities and appurtenances authorized hereunder, shall be immediately removed from said transportation facility or reset or

relocated thereon as required by the Columbia County Public Works Director and/or County Engineer and at the expense of the PERMITTEE.

7. In case of non-compliance with the County's requirements in effect as of the approval date of this permit, this permit void and the facility will have to be brought into compliance or removed from the right of way at no cost to the County.

8. It is understood and agreed that the rights and privileges herein set out are granted only to the extent of the County's right, title and interest in the land to be entered upon and used by the PERMITTEE, and the PERMITTEE will, at all times, and to the extent permitted by law, assume all risk of and indemnify, defend, and save harmless Columbia County, Florida from any and all loss, damage, cost or expense arising in any manner on account of the exercise or attempted exercise by said PERMITTEE of the aforesaid right and privileges.

9. During construction, all safety regulations of the County shall be observed and the PERMITTEE must take measures, including pacing and the display of safety devices that may be necessary in order to safely conduct the public through the project area in accordance with the Federal Manual on Uniform Traffic Control Devices, as amended for highways.

10. Should the PERMITTEE be desirous of keeping its utilities in place and out of service, the PERMITTEE, by execution of this permit acknowledges its present and continuing ownership of its utilities located between _____ and _____ within the County's right of way as set forth above. PERMITTEE, as its sole expense, shall promptly remove said out of service utilities whenever Columbia County Public Works Director and/or County Engineer determines said removal is in the public interest.

11. Special instructions: Minimum cover of thirty inches (30") will be required at all locations. Columbia County will not be financially responsible for any damage to facilities with less than thirty inches (30") cover. Cables shall not be located within driveway ditches.

12. Additional Stipulations: _____

It is understood and agreed that commencement by the PERMITTEE is acknowledgment and acceptance of the binding nature of these specialist instructions.

Submitted By: _____
Permittee

Place Corporate Seal

Signature and Title

Attested

**COMCAST PERMIT REQUEST FOR
261 NW MEEKS ST, LAKE CITY, FL.**

THESE PLANS WERE PREPARED UNDER THE
RESPONSIBLE CHARGE OF COMCAST FULL TIME
EMPLOYEE MR. LARRY PAYNE AND
ARE EXEMPT FROM THE SIGNING AND SEALING
REQUIREMENTS PRESCRIBED IN
SECTION 471 OF THE FLORIDA STATUTES

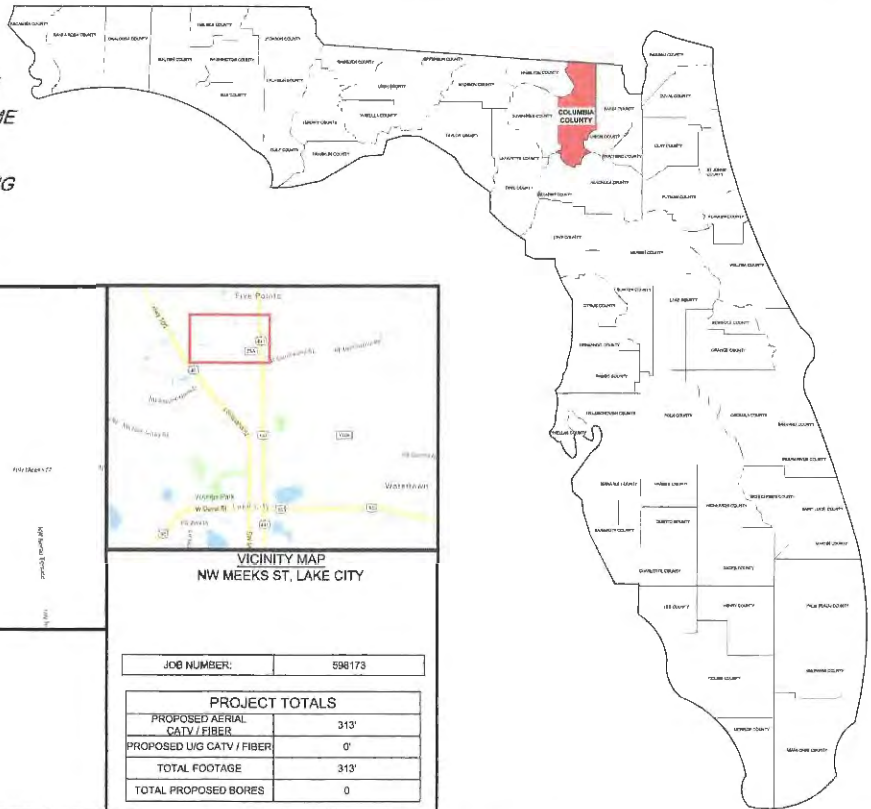

VICINITY MAP
NW MEEKS ST, LAKE CITY

**JOB SITE:
NW MEEKS ST
LAKE CITY, FL 32024**

JOB NUMBER:	598173
PROJECT TOTALS	
PROPOSED AERIAL CATV / FIBER	313'
PROPOSED UG CATV / FIBER	0'
TOTAL FOOTAGE	313'
TOTAL PROPOSED BORES	0

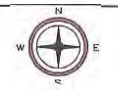

**COLUMBIA COUNTY
RIGHT-OF-WAY
PERMIT**

RIGHT OF WAY	CONCRETE POLE
AERIAL CATV	WOOD POLE
UNDERGROUND CATV	RISER POLE
BURIED POWER	PEDESTAL
TELEPHONE	VAULT
GAS	WATER
SEWER	

CONCRETE POLE	PROPOSED AERIAL CATV / FIBER
WOOD POLE	FACILITIES IN COLUMBIA COUNTY, FLORIDA
RISER POLE	VICINITY VIEW
PEDESTAL	CITY: LAKE CITY
VAULT	STREET NO: 261
WATER	TOP COUNTY: COLUMBIA
	SCALE: NOT TO SCALE STATE: FLORIDA

NOTES

ALL PROPOSED CONSTRUCTION WILL BE PER THE COLUMBIA COUNTY SPECIFICATIONS AS WELL AS ALL NECESSARY SAFETY CODES.

ALL PROPOSED CATV WILL BE WITHIN THE COLUMBIA COUNTY RIGHT-OF-WAY.

ALL PROPOSED UNDERGROUND CATV WILL BE BURIED A MINIMUM OF 36" DEEP EXCEPT ROAD BORES 48" DEEP AND DRIVEWAY BORES AT 36" DEEP.

ALL PROPOSED UNDERGROUND CATV ROAD BORES WILL USE CITY APPROVED DIRECTIONAL BORE MACHINE, AS WELL AS CITY APPROVED CONDUIT.

ALL PROPOSED CATV ROAD BORES WILL EXTEND A MINIMUM OF 8' BEYOND THE EDGE OF PAVEMENT.

ALL PROPOSED CATV DRIVEWAY BORES WILL EXTEND A MINIMUM OF 6' BEYOND THE EDGE OF PAVEMENT.

ALL PROPOSED BORES WILL BE IN A (4' X 4' X 4') PIT AND WILL USE (2) 2" HDPE CONDUIT AT 48" DEPTH USING A 5 1/4" DRILL HEAD.

ALL PROPOSED AERIAL WILL BE .700" DIAMETER AND WILL BE LASHED TO .250" STEEL STRAND CABLE USING .125" STANDARD GALVANIZED LASHING WIRE.

ALL PROPOSED AERIAL CATV CROSSING ROADWAYS WILL HAVE MINIMUM MID-SPAN HEIGHT OF 18'-0"

ALL PROPOSED AERIAL CATV CROSSING DRIVEWAYS WILL HAVE MINIMUM MID-SPAN HEIGHT OF 16'-0"

LOCATES WILL BE REQUIRED IN ALL PROPOSED UNDERGROUND AREAS AT LEAST 48 HRS PRIOR TO CONSTRUCTION.

NOTIFICATIONS TO ALL UTILITIES INVOLVED WILL BE MADE PRIOR TO CONSTRUCTION.

ALL DISTURBED AREA WITHIN THE RIGHT OF WAY WILL BE RESTORED TO ORIGINAL OR BETTER CONDITION BY GRADING AND RE-SODDING. SOD ALL AREAS DISTURBED BY CONSTRUCTION WITH BERMUDA SOD." "ALL CRACKED SIDEWALK IS TO BE REPLACED FROM JOINT TO JOINT WITHIN 7 DAYS OF WORK COMPLETION."

WORK OPERATIONS ARE TO BE MINDFUL NOT TO DAMAGE THE PAVER SIDEWALK WHEN POSITIONING EQUIPMENT. ANY DAMAGE INCLUDING TRACK MARKS WILL BE REPAIRED OR REPLACED BY THE CONTRACTOR.

CONSTRUCTION NOTES

IN ORDER TO REDUCE THE DISRUPTION AND COST OF UTILITY DAMAGES OCCURRING IN THE RIGHT-OF-WAY AND EASEMENTS. THE PERMITTEE SHALL PREVENT DAMAGES TO EXISTING UTILITIES CAUSED BY THE WORK THROUGH FIELD VERIFICATION OF THE LOCATION OF THE EXISTING UTILITIES IN CASE OF OPEN EXCAVATION. VERIFICATION MAY BE PERFORMED DURING THE PERMITTEES WORK. IN THE CASE OF DIRECTIONAL DRILLING, VERIFICATION SHALL TAKE PLACE PRIOR TO MOBILIZATION OF THE DRILLING EQUIPMENT.

THE PERMITTEE SHALL VERIFY THE LOCATION OF THE EXISTING UTILITIES AS NEEDED TO AVOID CONTACT WITH DETECTION EQUIPMENT OR OTHER ACCEPTABLE MEANS. SUCH METHODS MAY INCLUDE BUT SHALL NOT BE LIMITED TO "SOFT DIG"- EQUIPMENT AND GROUND PENETRATING RADAR (GPR). THE EXCAVATOR SHALL BE HELD LIABLE FOR DAMAGES CAUSED TO CITY'S / COUNTIES / STATE INFRASTRUCTURE AND THE EXISTING FACILITIES OF THE OTHER UTILITY COMPANIES

ALL UTILITIES LOCATED BY VISUAL INSPECTION, TO BE VERIFIED BY LOCATES
EOT REPRESENTS EDGE OF TRAVEL NOT TRUE EDGE OF PAVEMENT
E/P REPRESENTS THE TRUE EDGE OF PAVEMENT
EOD REPRESENTS THE EDGE OF DIRT
HAND DIG TRENCHES 36" DEEP ACROSS DIRT ROAD

RIGHT OF WAY
AERIAL CATV
UNDERGROUND CATV
BURIED POWER
TELEPHONE
GAS
SEWER
WATER

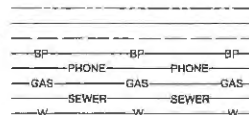

- ⊙ CONCRETE POLE
- × WOOD POLE
- Ⓡ RIBBER POLE
- PEDESTAL
- Ⓥ VAULT
- Ⓥ AMPHIB

PROPOSED AERIAL CATV / FIBER FACILITIES IN COLUMBIA COUNTY, FLORIDA			
CONSTRUCTION NOTES		CITY:	DAKE CITY
STREET NO:	2 OF 2	COUNTY:	COLUMBIA
SCALE:	TO SCALE	STATE:	FLORIDA

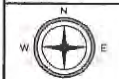

**COLUMBIA COUNTY
RIGHT-OF-WAY
PERMIT**

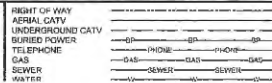

NW MEEKS ST, LAKE CITY



40' RIGHT OF WAY

POLE # 3
11' FROM EOP
EXISTING WOOD

POLE # 2
11' FROM EOP
EXISTING WOOD

PRIMARY O/H
SECONDARY O/H
PROPOSED AERIAL CATV / FIBER O/L

POLE # 1
8' FROM EOP
EXISTING WOOD

261

BEGIN PROJECT
PROPOSED AERIAL
CATV / FIBER FACILITIES
GPS COORDINATES
30.214246
82.640590

NW SAWYER TERRACE

12' GRASS
8' LANE
12' GRASS

237'

16' GRASS
9' LANE
9' LANE

16' GRASS

50' RIGHT OF WAY

NW OAKLAND AVE

316

NW JEB TERRACE

342

NW MEEKS ST

337

END PROJECT
PROPOSED AERIAL
CATV / FIBER FACILITIES
GPS COORDINATES
30.214247
82.641583



COLUMBIA COUNTY
RIGHT-OF-WAY
PERMIT

RIGHT OF WAY	---
AERIAL CATV	---
UNDERGROUND CATV	---
BURIED POWER	---
TELEPHONE	---
GAS	---
SEWER	---
WATER	---

⊙	CONCRETE POLE
⊗	WOOD POLE
⊕	RISER POLE
⊖	PEDESTAL
⊘	VAULT
⊙	MANHOLE

PROPOSED AERIAL CATV / FIBER FACILITIES IN COLUMBIA COUNTY, FLORIDA			
PLAN VIEW	CITY:	LAKE CITY	
SHEET NO:	1 OF 7	COUNTY:	COLUMBIA
SCALE:	1" = 40'	STATE:	FLORIDA

NW MEEKS ST, LAKE CITY
AERIAL TYPICAL
PARALLEL

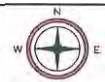
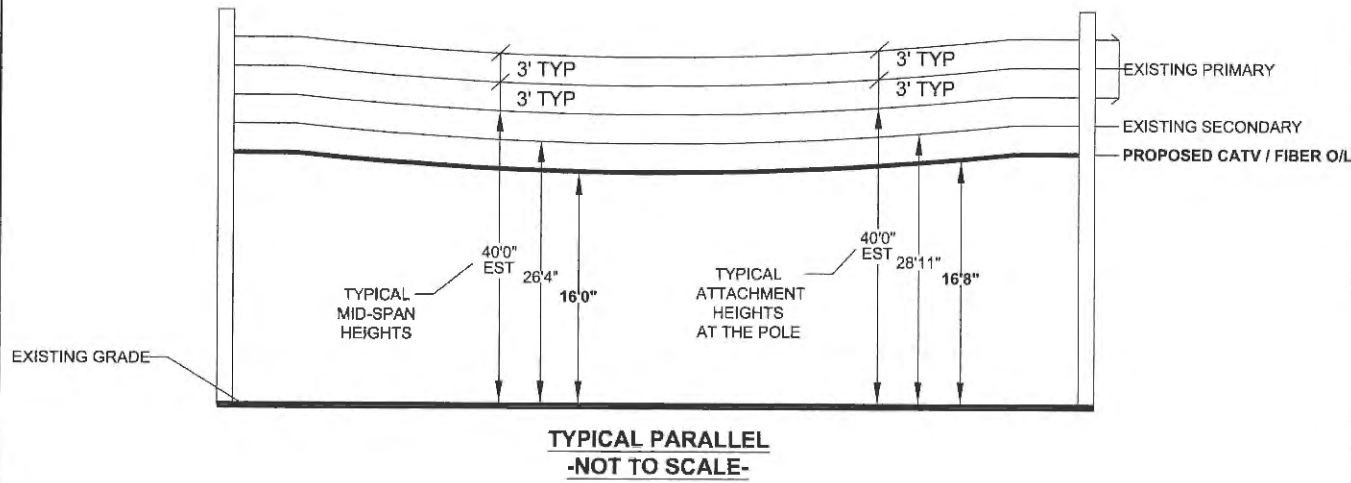

COLUMBIA COUNTY
RIGHT-OF-WAY
PERMIT

RIGHT OF WAY	---
AERIAL CATV	—●—
UNDERGROUND CATV	—○—
BURIED POWER	—SP—
TELEPHONE	—PH—
GAS	—GAS—
SEWER	—SEWER—
WATER	—W—

⊙	CONCRETE POLE
×	WOOD POLE
⊗	RISER POLE
⊠	PEDESTAL
∇	VAULT
∩	ANKER

PROPOSED AERIAL CATV / FIBER FACILITIES IN COLUMBIA COUNTY, FLORIDA

AERIAL TYPICALS & DETAILS CITY: LAKE CITY
 STREET NO. 4 OF PARALLEL COUNTY: COLUMBIA
 SCALE: TO SCALE STATE: FLORIDA

NW SAWYER TERRACE, LAKE CITY
AERIAL TYPICAL
CROSSING

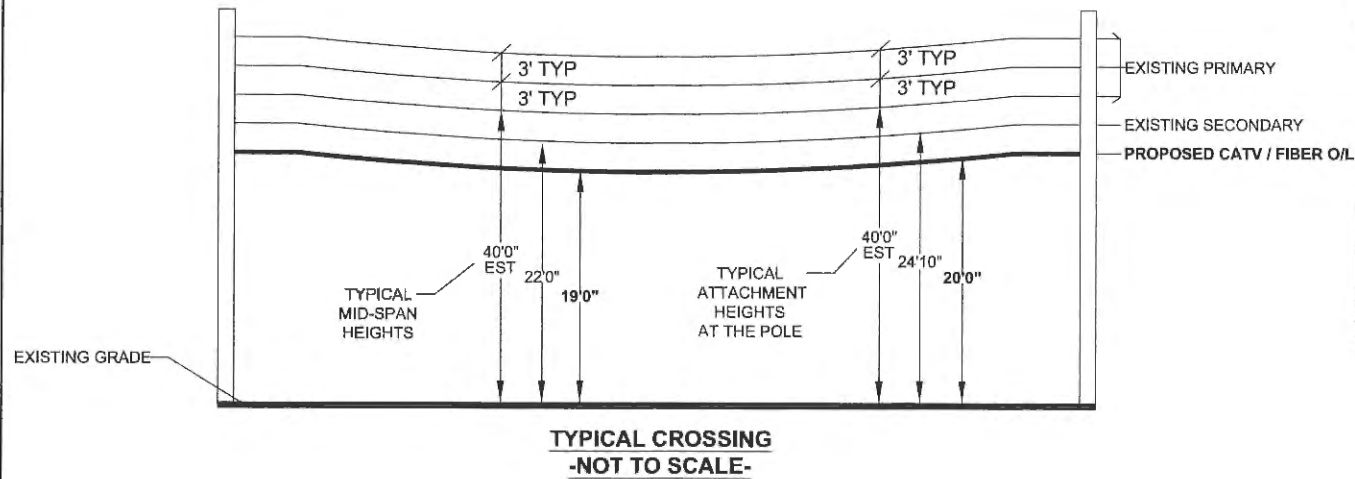

TYPICAL CROSSING
-NOT TO SCALE-

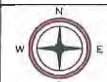

COLUMBIA COUNTY
RIGHT-OF-WAY
PERMIT

RIGHT OF WAY
 AERIAL CATV
 UNDERGROUND CATV
 BURIED POWER
 TELEPHONE
 GAS
 SEWER
 WATER

CONCRETE POLE
 WOOD POLE
 RISER POLE
 PEDESTAL
 VAULT
 UNLINED

PROPOSED AERIAL CATV / FIBER
 FACILITIES IN COLUMBIA COUNTY, FLORIDA
 AERIAL TYPICAL & DETAILS CITY: LAKE CITY
 SHEET NO. 3 OF 7 CROSSING COUNTY: COLUMBIA
 SCALE: TO SCALE STATE: FLORIDA

**NW MEEKS ST
COUNTY PERMIT
MOT CASES**

**MID-BLOCK SIDEWALK
CLOSURE**

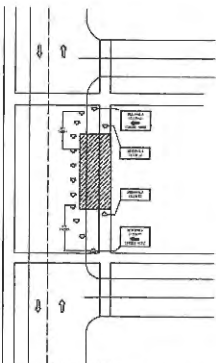

- GENERAL NOTES**
1. ONLY THE SIGNS CONTROLLING PEDESTRIAN FLOWS ARE SHOWN. OTHER WORK ZONE SIGNS WILL BE NEEDED TO CONTROL TRAFFIC ON STREETS.
 2. TEMPORARY WALKWAYS SHALL BE A MINIMUM OF 4' WIDE AND KEPT FREE OF ANY OBSTRUCTIONS AND HAZARDS SUCH AS HOLES, DEBRIS, MUD, CONSTRUCTION EQUIPMENT, STORED MATERIALS AND ETC. (FOR DETAILS SEE INDEX 800)
 3. POST MOUNTED SIGNS LOCATED NEAR OR ADJACENT TO A SIDEWALK SHALL HAVE A 7' MINIMUM CLEARANCE FROM THE BOTTOM OF SIGN TO THE SIDEWALK.
 4. THE STATE OF FLORIDA PROHIBITS MID-BLOCK CROSSING OF PEDESTRIANS WHEN AN ALTERNATE ROUTE IS NOT FEASIBLE. CONTRACTOR SHALL PROVIDE AN ADA COMPLIANT PEDESTRIAN PATHWAY THROUGH THE WORK ZONE WHEN SIDEWALK IS CLOSED.
- CONDITIONS**
WHERE ANY VEHICLE, EQUIPMENT, WORKERS OR THEIR ACTIVITIES ENCRoACH ON THE SIDEWALK FOR A PERIOD OF MORE THAN 60 MINUTES

TWO-LANE, TWO-WAY WORK OUTSIDE SHOULDER

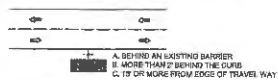

601 M.O.T

MULTILANE WORK OUTSIDE SHOULDER

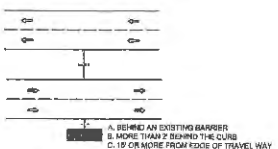

611 M.O.T

**MULTILANE WORK WITHIN TRAVEL WAY
MEDIAN OR OUTSIDE LANE**

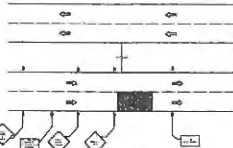

613 M.O.T

WORK IN VICINITY OF RAILROAD CROSSING

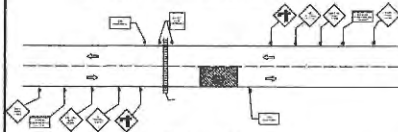

635 M.O.T

TWO-LANE, TWO-WAY WORK ON SHOULDER

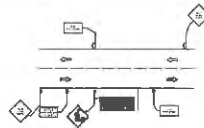

602 M.O.T

MULTILANE WORK ON SHOULDER

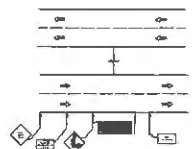

612 M.O.T

TEMPORARY ROAD CLOSURE 5 MINUTES OR LESS

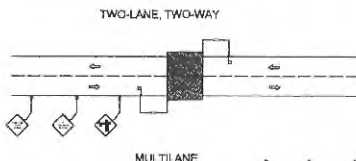

625 M.O.T

TRAFFIC CONTROL NOTES

THE EXISTING POSTED SPEED SHALL REMAIN AS THE REGULATORY SPEED FOR EACH PHASE OF WORK. NO SPEED REDUCTION SHALL BE ALLOWED UNLESS PRIOR APPROVAL FROM THE ENGINEER.

ROAD TYPE	10'	15'	20'
URBAN (POST SPEED)	300	300	300
RURAL	300	300	300
EXPRESSWAY / FREEWAY	1000	1000	2000

MAINTENANCE OF TRAFFIC REQUIREMENTS

1. ANY MODIFICATIONS OF THIS MAINTENANCE OF TRAFFIC PLAN SHALL BE SUBMITTED TO THE COLUMBIA COUNTY TRAFFIC ENGINEERING DIVISION FOR REVIEW AND APPROVAL PRIOR TO IMPLEMENTATION.
2. PROJECT WORK HOURS ARE BETWEEN 7:00 AM TO 7:00 PM ON RESIDENTIAL STREETS AND 8:00 AM TO 4:00 PM ON COLLECTION OR ARTERIAL STREETS.
3. CONTRACTOR MUST MAINTAIN EXISTING SIGNS. IF SIGNS ARE DAMAGED DUE TO HIS ACTIVITY, THE CONTRACTOR IS REQUIRED TO REPLACE THEM IN ACCORDANCE WITH CURRENT COUNTY STANDARD SPECIFICATIONS IMMEDIATELY.
4. THIRTY FOOT RADI ARE REQUIRED AT ALL INTERSECTIONS WHERE THE ROADWAY IS REBUILT.
5. ACCESS TO ALL STREETS AND DRIVEWAYS TO BE MAINTAINED AT ALL TIMES.
6. IF SIDEWALKS ARE DISTURBED AND HAVE TO BE REPLACED, LANDSCAPE RAMPS ARE TO BE INSTALLED.
7. THE CONTRACTOR SHALL CONFINE HIS ACTIVE WORK AREA TO NO MORE THAN ONE BLOCK AT A TIME.
8. THE ROADWAY SHALL BE RESTORED TO AT LEAST A LUMBEROCK SURFACE BEFORE IT IS OPENED TO TRAFFIC AND REOPEN THE CONTRACTOR MOVES ON TO THE NEXT CONSTRUCTION ZONE.
9. DUST CONTROL MEASURES SHALL BE IMPLEMENTED ON ALL UNPAVED SURFACES UNTIL PAVED.
10. IN CASE CONSTRUCTION PHASING IS NOT SHOWN ON PLANS OR IF CONTRACTOR WANTS TO ALTER THE PHASING SHOWN, CONTRACTOR IS TO SUBMIT PHASING PLAN WITH A PROPOSED CONSTRUCTION SCHEDULE TO TRAFFIC ENGINEERING PRIOR TO CONSTRUCTION.
11. CONTRACTOR SHALL NOTIFY TRAFFIC ENGINEERING DIVISION A MINIMUM OF 3 WORKING DAYS PRIOR TO IMPLEMENTATION OF THE M.O.T.
12. TRAFFIC SIGNAL VEHICLE LOOPS SHALL BE RESTORED TO PROPER OPERATION WITHIN 96 HOURS OF BEING DESTROYED OR DAMAGED.



5934 RICHARD ST
JACKSONVILLE, FLORIDA 32218

**COLUMBIA COUNTY
RIGHT-OF-WAY
PERMIT**

- RIGHT OF WAY**
- ADRIAL CATV
 - UNDERGROUND CATV
 - BURIED POWER
 - TELEPHONE
 - GAS
 - SEWER
 - WATER

- CONCRETE POLE
- WOOD POLE
- RISER POLE
- PEDESTAL
- VAULT
- AM/PMR

**PROPOSED AERIAL CATV / FIBER
FACILITIES IN COLUMBIA COUNTY, FLORIDA**

TRAFFIC CONTROL RULES CITY: LAKE CITY
SHEET NO. 6 OF COUNTY: COLUMBIA
SCALE: NOT TO SCALE STATE: FLORIDA

**THE FOLLOWING DESIGN STANDARDS
 ARE IN ACCORDANCE WITH THE
 FLORIDA DEPARTMENT OF TRANSPORTATION
 2017 600 INDEX
 AND APPLY TO
 NW MEEKS ST, LAKE CITY, FL.**

- DESIGN STANDARD INDEX NO 602 (TWO LANE, TWO WAY, WORK ON SHOULDER)
- DESIGN STANDARD INDEX NO 625 (TEMPORARY ROAD CLOSURE 5 MINUTES OR LESS)



**COLUMBIA COUNTY
 RIGHT-OF-WAY
 PERMIT**

RIGHT OF WAY
 AERIAL CATV
 UNDERGROUND CATV
 BURIED POWER
 TELEPHONE
 GAS
 SEWER
 WATER

⊕ CONCRETE POLE
 X WOOD POLE
 ⊗ RISER POLE
 ⊕ PEDESTAL
 ▣ VAULT
 ▽ RAILROAD

PROPOSED AERIAL CATV / FIBER
 FACILITIES IN COLUMBIA COUNTY, FLORIDA
 TRAFFIC CONTROL RULES (CITY): LAKE CITY
 SHEET NO. 1 OF COUNTY: COLUMBIA
 SCALE: TO SCALE STATE: FLORIDA



November 24, 2017

Columbia County Public Works Department
Attn: Connie Brecheen
607 NW Quinten St
Lake City, FL 32055

Comcast is submitting this permit request for **261 NW Meeks St, Lake City, FL.**

If you have any questions or concerns about our drawing please feel free to contact me at the number and/or email below.

Thank you,

David McElroy
Authorized Comcast Agent
602-318-5808
david@fibercoregroup.com