

## **POTABLE WATER SUPPLY SPECIFICATIONS**

### **DESCRIPTION OF WORK:**

Provide a complete, operational and automatic potable water supply system in accordance with all applicable rules and regulations. The system shall include, but shall not be limited to, well, well pump complete with control panel, well head assembly, one hydropneumatic tank, one chlorinator, all electrical work and field piping appurtenant thereto. Electrical power 480-volt, 3-phase shall be installed to the control panel by the electrical contractor.

Equipment and Materials: The Contractor shall furnish and install:

- one 6" well
- one 15 hp well pump, well head, including piping, sampling point, meter, check valve and gate valve
- 5,000 gallon pressure tank
- All piping to the tank
- Liquid chlorination system

The Contractor shall take precautions to avoid contamination of the well supply. The Contractor shall be responsible for disinfection of the well after construction of the well pump and well head appurtenances.

### **WELL:**

The Contractor shall drill one 10" diameter bore hole to facilitate placement of 6" well casing. The 6" well casing shall be placed in the center of the bore hole. The 2" annular space shall be fully grouted beginning at the bottom of the casing proceeding to the top of the casing.

### **WELL PUMP:**

Furnish and install one 6", 15 hp submersible pump, being able to discharge a minimum of 225 gallons per minute at 200' of Total Dynamic Head, with a 480-volt, 3-phase motor.

### **HYDROPNEUMATIC TANK:**

Furnish and install a 5,000 gallon underground fiberglass hydro-pneumatic tank. Minimum inlet and outlet piping shall be 6" and shall be located at opposite ends of the tank.

The tank shall incorporate pressure sensors, and low water electrodes to control the operation of the well pump, and an air compressor package system capable of automatic operation and controlled by the air pressure inside the tank. Control system

shall include audible low water level alarm. The tank pressures shall be adjusted at installation to provide for adequate system supply and pressure with the following sequence:

The pneumatic tank shall be filled by the well pump which is turned on by a low pressure sensor and turned off by a high pressure sensor. After the tank has filled, the compressor will start by pressure sensor and air volume will continue to charge the tank. When the water level reaches a minimum level, the air compressor will shut off allowing the well pump to recharge the system. The system then recycles. The tank pressure control shall be adjusted at installation to provide a minimum system pressure of 35 psi.

#### **LIQUID CHLORINATION SYSTEM:**

A chemical feed system for liquid chlorine shall be installed as detailed on the drawings.

The system shall consist of the following: chemical metering pump; two solution tanks; liquid chlorine; and associated valves and piping required for a complete operating system. The Contractor shall furnish the initial liquid chlorine supply and demonstrate that the system is operating properly.

The system shall be self-priming, flooded suction configuration with factory installed bulkhead assembly, tank stand and pump mounting platform.

Solution tanks shall be constructed of high quality industrial grade polyethylene. Tank lids shall be high strength, rigid and feature a fitted, covered feed hole for easy chemical replenishment.

Feed piping and valves shall be arranged such that both tanks may be used together or separately.



# HALL'S PUMP & WELL SERVICE PROPOSAL / ADDENDUM

~~NONANTOP MINISTRIES~~  
**JOB:** MEADE MINISTRY INC.

**LOCATION:** WALTER LITTLE ROAD

**DESCRIPTION:** ADDITION OF POTABLE WATER SERVICE LINES TO CHURCH BUILDING, FIRE PUMP DISCHARGE (BLOW OFF) LINE, PRESSURIZING LINE FOR THE FIRE PUMP SYSTEM, AND STEEL CHASE PIPES UNDER THE DRIVE WAYS FOR FUTURE USE.

**WE PROPOSE TO CONSTRUCT THE ABOVE SAID  
ADDENDUM AS FOLLOWS:**

## POTABLE WATER SERVICE LINES:

PIPING ABOVE GROUND: 3" AND LARGER- DUCTILE IRON  
2" AND SMALLER- GALVANIZED

PIPING BELOW GROUND: PVC SCHEDULE 40 PLASTIC

VALVES BELOW GROUND: SQUARE TOP- IRON BODY GATE

VALVES ABOVE GROUND: 3" AND LARGER: WHEEL TOP- IRON  
BODY

2" AND SMALLER: FULL PORT- BRASS

**SPECIFICATIONS:** All steel piping above ground will be of 150# class or greater, with flanged and gasket joints (3" and larger) or NPS threads (2" and smaller). All PVC plastic piping (below ground) will be assembled with solvent weld joints (primed and glued according to the manufacture's specifications) and set at a minimum level of 18" below grade. Where PVC piping must cross under drive ways it will be installed in a steel pipe sleeve. All gate valves installed under ground will be set with cast iron valve covers with adjustable tops to grade level.



**PROPOSED WORK DESCRIPTION;** Potable water main will be constructed of 6" piping and set at an approximate depth of 36" below grade. There will be three 3" supply lines furnished for the Church Building; set at a depth between 18" and 24". Each line will terminate with a gate valve for the Plumber to connect to. There will be two valves on the system for future use (one 3" on the east side and one 4" on the west side).

We will install an 8 gauge solid copper wire in the trench with the PVC pipe to enable a locator to detect the water lines.

#### **FIRE PUMP DISCHARGE LINE**



**PIPING ABOVE GROUND:** 8" FLANGED BLACK STEEL  
**PIPING BELOW GROUND:** 8" PVC SCHEDULE 40 PLASTIC

**SPECIFICATIONS:** All steel piping above ground will be of 150# class or greater with flanged and gasket joints. All PVC plastic piping will be assembled with solvent weld joints (primed and glued to the manufacturer's specifications), and set in ground a minimum of 30" below grade.

**PROPOSED WORK DESCRIPTION:** Discharge line will be constructed of 8" piping and set at an approximate depth of 36". The line will run from the Fire Pump and terminate inside the Storm Drain.

#### **PRESSURIZING LINE FOR THE FIRE PUMP**



**PIPING ABOVE GROUND:** 2" GALVANIZED STEEL  
**PIPING BELOW GROUND:** 2" PVC SCHEDULE 40 PLASTIC

**SPECIFICATIONS:** All galvanized piping above ground will be 300# class or greater, with NPS threads. All PVC plastic piping below ground will be assembled with solvent weld joints (primed and glued according to the manufacturer's specifications) and set at a minimum level of 18" below grade.



52

# PROPOSAL AND ACCEPTANCE

Hall's Pump and Well Service  
1724 N. First St.  
Lake City, FL 32055

PROPOSAL SUBMITTED TO <u>Meade Ministries</u>		PHONE	DATE <u>1-18-95</u>
STREET		JOB NAME	
CITY, STATE AND ZIP CODE <u>Lake City, FL</u>		JOB LOCATION	
ARCHITECT <u>B &amp; B Engineering</u>	DATE OF PLANS		JOB PHONE

We hereby submit specifications and estimates for:

- one 6" well
- one 15 hp well pump, well head, including piping, sampling point, meter, check valve and gate valve
- 5,000 gallon pressure tank
- All piping to the tank
- Liquid chlorination system

- INCLUDES ENGINEERING

Note: Proposal does not include cost for permits or Water Test. WILL DO PERMITS & TESTS

APPROX \$250<sup>00</sup> DEP \$275 SPRING - + \$600 WATER TESTS

Proposal will be done according to plans & specifications furnished by B & B Engineering.  
WE WILL NEED A COVER FOR CHLORINE FEED PUMP

APPROX. 200' IF MORE WILL DO @ N/C. PER DOW 2/16/95

We Propose hereby to furnish material and labor — complete in accordance with above specifications, for the sum of:

PROGRESS PAYMENTS

Payment to be made as follows:

\$ 41,500.00  
dollars (\$ 41,500.00)

All material is guaranteed to be as specified. All work to be completed in a workman-like manner according to standard practices. Any alteration or deviation from above specifications involving extra costs will be executed only upon written orders, and will become an extra charge over and above the estimate. All agreements contingent upon strikes, accidents or delays beyond our control. Owner to carry fire, tornado and other necessary insurance. Our workers are fully covered by Workmen's Compensation Insurance.

Authorized Signature Ronald D. Hall  
Note: This proposal may be withdrawn by us if not accepted within \_\_\_\_\_ days.

Acceptance of Proposal - The above prices, specifications and conditions are satisfactory and are hereby accepted. You are authorized to do the work as specified. Payment will be made as outlined above.

Signature \_\_\_\_\_  
Signature \_\_\_\_\_

Date of Acceptance \_\_\_\_\_

52

**N3**  
**NICHOLAS  
PAUL  
GEISLER**  
**ARCHITECT**  
N.C.A.R.B. Certified ■ 1758 NW Brown Road  
■ Lake City, FL 32055  
■ 386/365-4355

26 SEPTEMBER 2012

BUILDING OFFICIAL  
COLUMBIA COUNTY, BUILDING DEPT.  
COLUMBIA COUNTY COURTHOUSE ANNEX  
LAKE CITY, FLORIDA 32055

RE: BELMONT ACADEMEY  
PERMIT Nr.: \_\_\_\_\_

DEAR SIR:

PER YOUR REQUEST, ATTACHED IS A SUMMARY OF THE PLUMBING FIXTURE REQUIREMENTS FOR THE ABOVE REFERENCED PROJECT. ALONG WITH THE SUMMARY IS A TABULATION OF THE EXISTING AND PROPOSED NEW PLUMBING FIXTURES, INCLUDING CODE REFERENCES FOR BOTH THE OCCUPANCY LOAD AND THE MINIMUM PLUMBING FIXTURE REQUIREMENTS.

BASED ON THE CODE AND THE TABULATED FIXTURE COUNT, THIS PROJECT MEETS OR EXCEEDS THE ESTABLISHED MINIMUM PLUMBING FIXTURE REQUIREMENTS OF THE 2010 FLORIDA BUILDING CODE - PLUMBING.

SHOULD YOU HAVE ANY FURTHER QUESTIONS WITH THIS, PLEASE CALL FOR ASSISTANCE.

YOURS TRULY,  
NICHOLAS PAUL GEISLER, ARCHITECT AR0001005

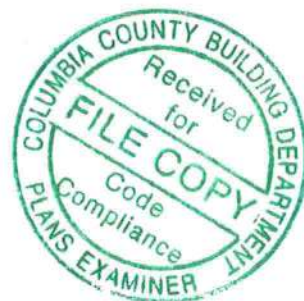



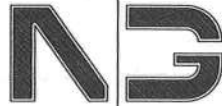

**NICHOLAS  
PAUL  
GEISLER**  
**ARCHITECT**  
N.C.A.R.B. Certified

1758 NW Brown Road  
Lake City, FL 32055  
386/365-4355

## 2010 FBC-BUILDING, TABLE 1004.1.1

MAXIMUM FLOOR AREA ALLOWABLE PER OCCUPANT

OCCUPANCY CLASSIFICATION	FLOOR AREA	MAX ALLOWABLE AREA PER OCCUPANT	NUMBER OF OCCUPANTS
CLASSROOMS	10552.1	@ 1/20 SF	526.1
ADMINISTRATION	692.9	@ 1/100 SF	6.9
CONFERENCE	293.6	@ 1/15 SF	19.6
REST ROOMS	271.4	@ 1/50 SF	5.4
CORRIDOR	4217.1	* @ 1/300 SF	14.1
SERVICE BUILDING	617.4	@ 1/300 SF	2.1
	1404.3	* @ 1/500 SF	2.8
GROUND FLOOR	18050.0		577.0
MECH. EQUIP. LOFT	1530.1	@ 1/300 SF	5.1
I/T LOFT	702.3	@ 1/300 SF	2.3
TOTAL BUILDING	20283.0		584.4
*NOT DEFINED IN TABLE			

## 2010 FBC-PLUMBING, TABLE 403.1

MAXIMUM NUMBER OF REQUIRED PLUMBING FIXTURES

OCCUPANCY CLASSIFICATION	WATER CLOSETS MALE / FEMALE	LAVATORIES MALE / FEMALE	DRINKING FOUNTAIN	SERVICE SINK
EDUCATIONAL	1/50	1/50	1/100	1
BUSINESS	1/50	1/40	1/100	-
EDUCATIONAL, MALE	$526.1/2 = 263.05/50 = 6$ WATER CLOSETS, 6 LAVATORIES			
EDUCATIONAL, FEMALE	$526.1/2 = 263.05/50 = 6$ WATER CLOSETS, 6 LAVATORIES			
EDUCATIONAL, DF	$526.1/100 = 5.26$ DRINKING FOUNTAINS			
EDUCATIONAL, SS:	1 SERVICE SINK			
BUSINESS, MALE	$6.9 + 19.6/2 = 13.25/50 = 1$ WATER CLOSET, 1 LAVATORY			
BUSINESS, FEMALE	$6.9 + 19.6/2 = 13.25/40 = 1$ WATER CLOSET, 1 LAVATORY			
BUSINESS, DF	$26.5/100 = 0.27$ DRINKING FOUNTAINS			
BUSINESS, SS:	-			

### TOTAL FIXTURES REQUIRED:

FIXTURES MALE: 7 WATER CLOSETS, 7 LAVATORIES

FIXTURES FEMALE: 7 WATER CLOSETS, 7 LAVATORIES

DRINKING FOUNTAINS =  $5.26 + 0.27 = 5.53 = 6$  DRINKING FOUNTAINS

SERVICE SINKS: 1 SERVICESINK

RE: BELMONT ACADEMEY  
PERMIT Nr.: \_\_\_\_\_

*[Signature]*  
AR7005 26 Sep 2012

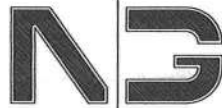

**NICHOLAS  
PAUL  
GEISLER**  
**ARCHITECT**  
N.C.A.R.B. Certified

1758 NW Brown Road  
Lake City, FL 32055  
386/365-4355

## PROPOSED PLUMBING FIXTURES

EXISTING PARK FIXTURES and PROPOSED BELMONT ACADEMEY FIXTURES

LOCATION	H/C M/F	W/C M/F	LAV M/F	DF	SS	UNISEX H/C W/C	UNISEX LAV
PARK REST ROOM	1/1	7/5	5/5	2	1		
BELMONT ACADEMEY				4	2	7	7
TOTAL FIXTURES	1/1	7/5	5/5	6	3	7	7

NEW and EXISTING HANDICAP FACILITIES MEET THE REQUIREMENTS OF THE CODES IN EFFECT AT THE TIME OF PERMITTING, RESPECTIVELY

TOTAL POSSIBLE WATERCLOSET FACILITIES, MALE = 15 OPPERTUNITIES  
TOTAL POSSIBLE LAVATORY FACILITIES, MALE = 12 OPPERTUNITIES

TOTAL POSSIBLE WATERCLOSET FACILITIES, FEMALE = 13 OPPERTUNITIES  
TOTAL POSSIBLE LAVATORY FACILITIES, FEMALE = 12 OPPERTUNITIES

THE TOTAL PLUMBING FIXTURE COUNT MEETS OR EXCEEDS THE REQUIREMENTS OF TABLE 403.1 OF THE 2010 FBC PLUMBING CODE.

RE: BELMONT ACADEMEY  
PERMIT Nr.: \_\_\_\_\_

*[Signature]*  
AR7005 26 Sep 2012



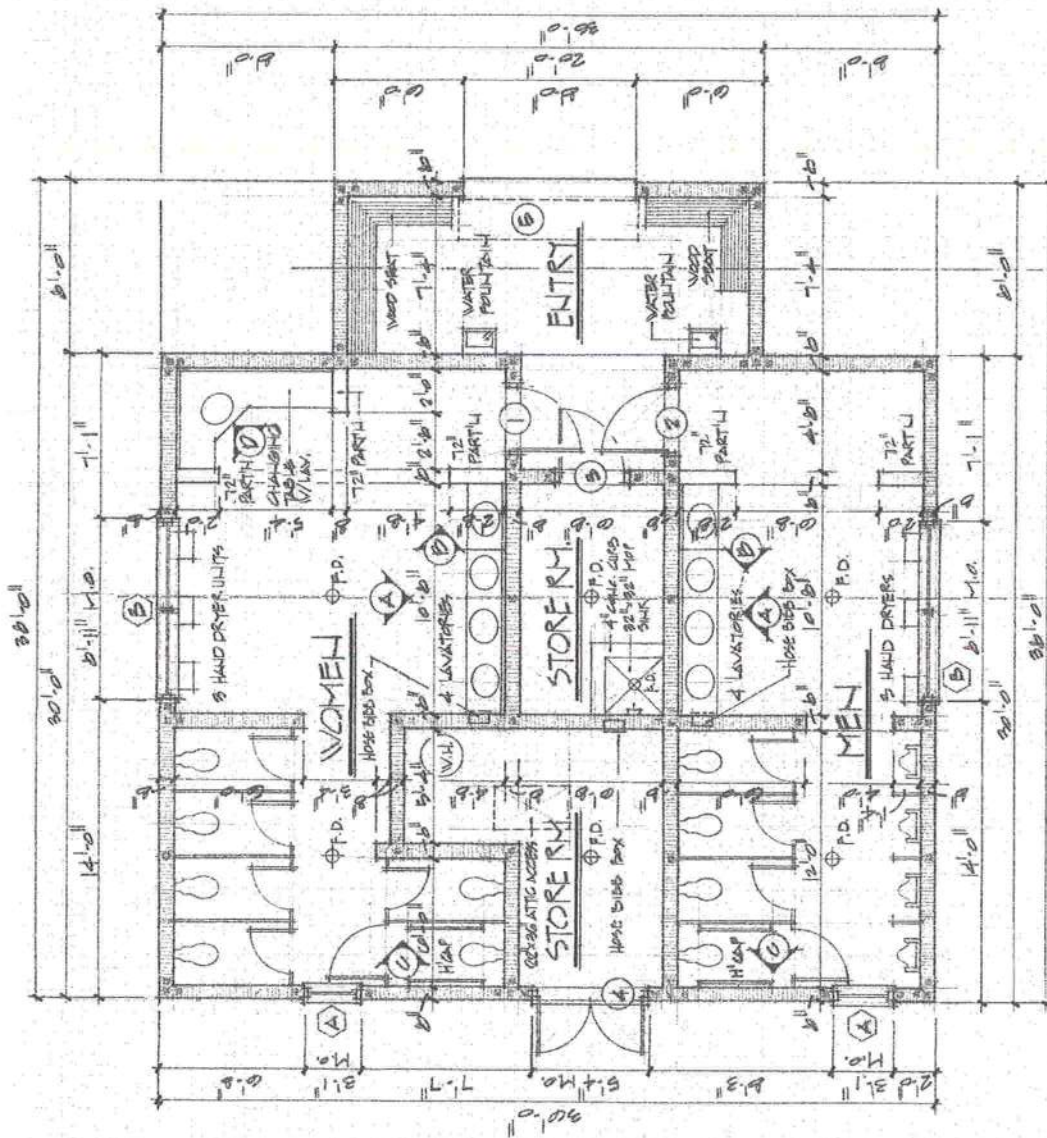

FLOOR PLAN

1/4" = 1'-0"

NOTES:

1. DOOR HARDWARE TO BE SULLAGE "D" SERIES, 26-D FINISH.
2. DOORS 1 & 2 TO HAVE PUSH/PULL SET WITH DEADBOLT AT 50" AFF.
3. DOOR 3 TO HAVE "ORBIT" HANDLESET WITH DEADBOLT AT 50" AFF.
4. DOOR 4 TO HAVE "ORBIT" HANDLESET WITH KEY-IN-KNOB ON ONE SIDE AND THROW PIN AT HEAD AND THRESHOLD OF OTHER. PROVIDE 11" ASTROGLASS AND COVER PLATE OVER STRIKE PLATE.
5. ALL DOORS TO HAVE METAL THRESHOLDS MEETING HICAP ACCESS REQS.
6. TOILET PARTITIONS TO BE "POLYMAR-HD" AS MFGD BY SANTANA PRODUCTS CO., RICHMOND, VA.

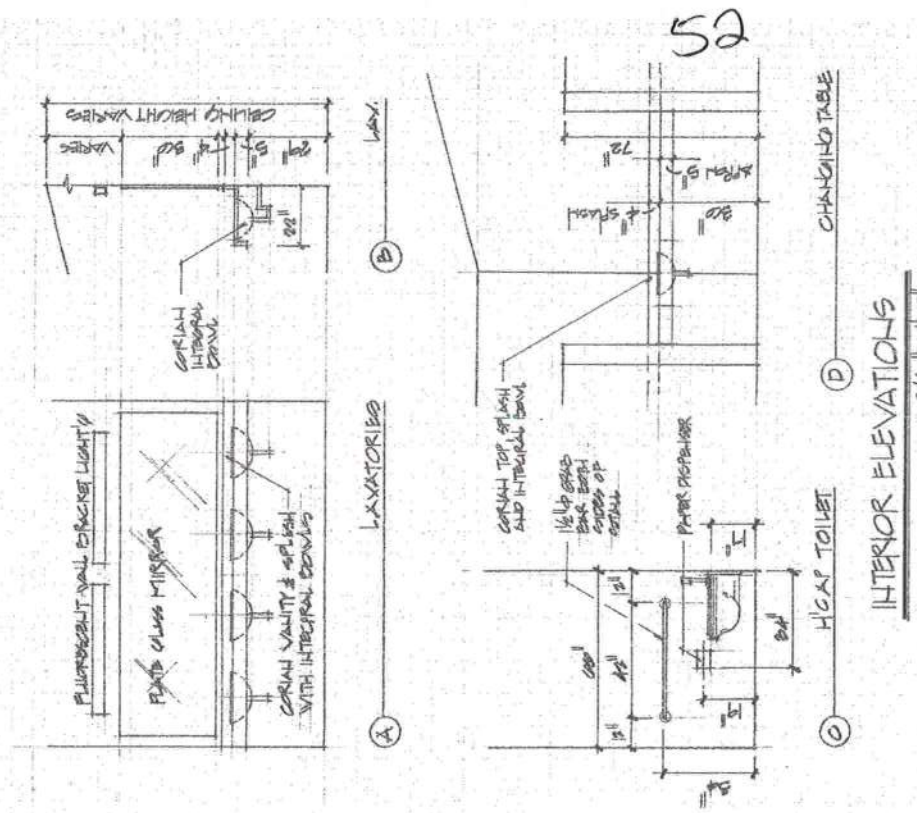

INTERIOR ELEVATIONS

3/8" = 1'-0"

DOOR & WINDOW SCHEDULE

MARK	DIMENSIONS	DESCRIPTION
①	3'-0" x 7'-0" x 1 1/2"	FLUSH STEEL DOOR WITH ORNATE METAL FRAME
②	3'-0" x 7'-0" x 1 1/2"	"
③	3'-0" x 7'-0" x 1 1/2"	"
④	3'-0" x 7'-0" x 1 1/2"	"
⑤	3'-0" x 7'-0" x 1 1/2"	"
⑥	3'-0" x 7'-0" x 1 1/2"	"
⑦	3'-0" x 7'-0" x 1 1/2"	"
⑧	3'-0" x 7'-0" x 1 1/2"	"
⑨	3'-0" x 7'-0" x 1 1/2"	"
⑩	3'-0" x 7'-0" x 1 1/2"	"
⑪	3'-0" x 7'-0" x 1 1/2"	"
⑫	3'-0" x 7'-0" x 1 1/2"	"
⑬	3'-0" x 7'-0" x 1 1/2"	"
⑭	3'-0" x 7'-0" x 1 1/2"	"
⑮	3'-0" x 7'-0" x 1 1/2"	"
⑯	3'-0" x 7'-0" x 1 1/2"	"
⑰	3'-0" x 7'-0" x 1 1/2"	"
⑱	3'-0" x 7'-0" x 1 1/2"	"
⑲	3'-0" x 7'-0" x 1 1/2"	"
⑳	3'-0" x 7'-0" x 1 1/2"	"
㉑	3'-0" x 7'-0" x 1 1/2"	"
㉒	3'-0" x 7'-0" x 1 1/2"	"
㉓	3'-0" x 7'-0" x 1 1/2"	"
㉔	3'-0" x 7'-0" x 1 1/2"	"
㉕	3'-0" x 7'-0" x 1 1/2"	"
㉖	3'-0" x 7'-0" x 1 1/2"	"
㉗	3'-0" x 7'-0" x 1 1/2"	"
㉘	3'-0" x 7'-0" x 1 1/2"	"
㉙	3'-0" x 7'-0" x 1 1/2"	"
㉚	3'-0" x 7'-0" x 1 1/2"	"
㉛	3'-0" x 7'-0" x 1 1/2"	"
㉜	3'-0" x 7'-0" x 1 1/2"	"
㉝	3'-0" x 7'-0" x 1 1/2"	"
㉞	3'-0" x 7'-0" x 1 1/2"	"
㉟	3'-0" x 7'-0" x 1 1/2"	"
㊱	3'-0" x 7'-0" x 1 1/2"	"
㊲	3'-0" x 7'-0" x 1 1/2"	"
㊳	3'-0" x 7'-0" x 1 1/2"	"
㊴	3'-0" x 7'-0" x 1 1/2"	"
㊵	3'-0" x 7'-0" x 1 1/2"	"
㊶	3'-0" x 7'-0" x 1 1/2"	"
㊷	3'-0" x 7'-0" x 1 1/2"	"
㊸	3'-0" x 7'-0" x 1 1/2"	"
㊹	3'-0" x 7'-0" x 1 1/2"	"
㊺	3'-0" x 7'-0" x 1 1/2"	"
㊻	3'-0" x 7'-0" x 1 1/2"	"
㊼	3'-0" x 7'-0" x 1 1/2"	"
㊽	3'-0" x 7'-0" x 1 1/2"	"
㊾	3'-0" x 7'-0" x 1 1/2"	"
㊿	3'-0" x 7'-0" x 1 1/2"	"



5561



Technical drawing of a fixture, showing three views: front, side, and top. The drawing is labeled "FIXTURE DETAILS".

**Front View (Left):** Shows a base with a total width of 54" and a central section with a width of 4".

**Side View (Right):** Shows a base with a total depth of 33" 20" and a central section with a depth of 19" 19".

**Top View (Bottom):** Shows a base with a total width of 40" 10" max and a central section with a width of 17" 11".

Hand-drawn architectural sketch of a building facade. The sketch includes the following handwritten notes and annotations:

- Top Left:** "4'6" HIG 1/4" PINE DOOR 1/2" CARPENTRY UNFINISHED, PROPOSED" with an arrow pointing to the door area.
- Top Center:** "2x14" T & B CAR. FINISHED" with an arrow pointing to the horizontal trim above the door.
- Center:** "1x6 JOISTS AT 16" O.C." with an arrow pointing to the vertical structural elements.
- Bottom Left:** "1x6 GABLE END WALL CARPENTRY" with an arrow pointing to the lower left corner.
- Bottom Center:** "1x6 P.T. PINE ANCHORED REZELONE" with an arrow pointing to the horizontal trim below the door.
- Bottom Right:** "2x4 CARP. BLACK W/ALL (6'8" TALL)" and "W/ CARPENT & FINISHED END BEAM" with arrows pointing to the right side of the structure.

PARTIAL REVISED FLOOR PLAN

A hand-drawn architectural floor plan of a building with a gabled roof. The plan is oriented with the gable end on the left. The main body of the building is divided into three sections: a 'MEN' room on the left, a 'STORE ROOM' in the center, and a 'WOMEN' room on the right. The roof is shown with a cross-hatched pattern. Key structural details and dimensions are labeled:

- Roof Details:**
  - At the gable end (left): 'VELUX SKYLIGHT MODEL TP5-2' (labeled 1), '1/4" x 10"', and '7" x 10" GUTTERS AT 10' O.C.'.
  - Along the side wall (top): 'VELUX SKYLIGHT MODEL TP5-2' (labeled 2), '1/4" x 10"', and '7" x 10" GUTTERS AT 10' O.C.'.
- Interior Rooms and Features:**
  - Men's Room:** Contains a toilet and a sink.
  - Store Room:** Labeled '12' x 8' 10" O.C.' and '20' x 20' SAME'. It has a 'BACK WALL BEHIND' and a 'TOILET TO MEN'S CLOSET'.
  - Women's Room:** Contains a toilet and a sink.
  - Central Corridor:** Labeled '5' x 4' HALLWAY'.
- Other Labels:**
  - 'WALL BEHIND' is labeled on the left side of the central corridor.
  - '12' x 8' 10" O.C.' is labeled near the top of the store room.
  - '20' x 20' SAME' is labeled near the top of the store room.

Handwritten notes at the top right of the drawing include 'SEE' and '1/4" x 10"'. The title 'PARTIAL REVISED F' is written vertically on the left side.

FLOOR FRAMING PLAN

DETAIL