

RESIDENTIAL ENERGY CONSERVATION CODE DOCUMENTATION CHECKLIST**Florida Department of Business and Professional Regulation
Simulated Performance Alternative (Performance) Method**

Applications for compliance with the 2020 Florida Building Code, Energy Conservation via the Residential Simulated Performance Alternative shall include:

- ☐ This checklist
- ☐ Form R405-2020 report
- ☐ Input summary checklist that can be used for field verification (usually four pages/may be greater)
- ☐ Energy Performance Level (EPL) Display Card (one page)
- ☐ HVAC system sizing and selection based on ACCA Manual S or per exceptions provided in Section R403.7
- ☐ Mandatory Requirements (five pages)

Required prior to CO:

- ☐ Air Barrier and Insulation Inspection Component Criteria checklist (Table R402.4.1.1 - one page)
- ☐ A completed 2020 Envelope Leakage Test Report (usually one page); exception in R402.4 allows dwelling units of R-2 Occupancies and multiple attached single family dwellings to comply with Section C402.5
- ☐ If Form R405 duct leakage type indicates anything other than "default leakage", then a completed 2020 Duct Leakage Test Report - Performance Method (usually one page)

FLORIDA ENERGY EFFICIENCY CODE FOR BUILDING CONSTRUCTION

Florida Department of Business and Professional Regulation - Residential Performance Method

Project Name: Norris Peeler Street: City, State, Zip: Lake City, FL, Owner: Peeler Design Location: FL, Gainesville		Builder Name: Norris Construction Permit Office: Permit Number: Jurisdiction: County: Columbia(Florida Climate Zone 2)	
---	--	--	--

1. New construction or existing New (From Plans) 2. Single family or multiple family Detached 3. Number of units, if multiple family 1 4. Number of Bedrooms 3 5. Is this a worst case? No 6. Conditioned floor area above grade (ft²) 2696 Conditioned floor area below grade (ft²) 0 7. Windows(154.0 sqft.) Description Area a. U-Factor: Dbl, U=0.33 154.00 ft² SHGC: SHGC=0.21 b. U-Factor: N/A ft² SHGC: c. U-Factor: N/A ft² SHGC: Area Weighted Average Overhang Depth: 6.143 ft Area Weighted Average SHGC: 0.210 8. Skylights Description Area U-Factor:(AVG) N/A N/A ft² SHGC(AVG): N/A 9. Floor Types Insulation Area a. Slab-On-Grade Edge Insulation R= 0.0 2696.20 ft² b. N/A ft² c. N/A ft²	10. Wall Types(1988.3 sqft.) Insulation Area a. Frame - Wood, Exterior R=13.0 1988.30 ft² b. N/A R= ft² c. N/A R= ft² d. N/A R= ft² 11. Ceiling Types(2696.2 sqft.) Insulation Area a. Flat ceiling under att (Vented) R=38.0 2696.20 ft² b. N/A R= ft² c. N/A R= ft² 12. Ducts, location & insulation level R ft² a. Sup: Attic, Ret: Attic, AH: Main 6 539 b. c. 13. Cooling Systems kBtu/hr Efficiency a. Central Unit 60.0 SEER:14.00 14. Heating Systems kBtu/hr Efficiency a. Electric Heat Pump 60.0 HSPF:8.20 15. Hot Water Systems a. Electric Tankless Cap: 1 gallons EF: 0.920 b. Conservation features 16. Credits None None
---	--

Glass/Floor Area: 0.057	Total Proposed Modified Loads: 54.53	PASS
	Total Baseline Loads: 55.07	

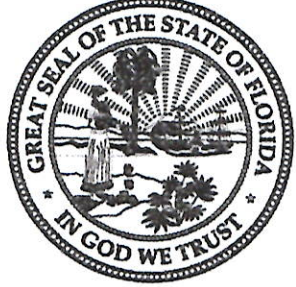
I hereby certify that the plans and specifications covered by this calculation are in compliance with the Florida Energy Code. PREPARED BY: <u>Scott Davis</u> DATE: <u>7/25/22</u> I hereby certify that this building, as designed, is in compliance with the Florida Energy Code. OWNER/AGENT: _____ DATE: _____	Review of the plans and specifications covered by this calculation indicates compliance with the Florida Energy Code. Before construction is completed this building will be inspected for compliance with Section 553.908 Florida Statutes. <div style="text-align: center;">  </div> BUILDING OFFICIAL: _____ DATE: _____
--	--

- Compliance requires certification by the air handler unit manufacturer that the air handler enclosure qualifies as certified factory-sealed in accordance with R403.3.2.1.
- Default duct leakage does not require a Duct Leakage Test Report.
- Compliance requires an Air Barrier and Insulation Inspection Checklist in accordance with R402.4.1.1 and this project requires a PERFORMANCE envelope leakage test report with envelope leakage no greater than 5.00 ACH50 (R402.4.1.2).

INPUT SUMMARY CHECKLIST REPORT

PROJECT

Title:	Norris Peeler	Bedrooms:	3	Address type:	Street Address
Building Type:	User	Conditioned Area:	2696	Lot #:	---
Owner:	Peeler	Total Stories:	1	Block/SubDivision:	---
Builder Name:	Norris Construction	Worst Case:	No	PlatBook:	---
Permit Office:		Rotate Angle:	0	Street:	
Jurisdiction:		Gross Ventilation:		County:	Columbia
Family Type:	Detached	Whole House Fan:		City, State, Zip:	Lake City, FL,
New/Existing:	New (From Plans)	Terrain:	Rural		
Year Construct:	2022	Shielding:	Moderate/Rural		
Comment:					

CLIMATE

✓ Design Location	Tmy Site	Design Temp 97.5%	2.5%	Int Design Temp Winter	Summer	Heating Degree Days	Design Moisture	Daily temp Range
___ FL, Gainesville	FL_GAINESVILLE_REGIONA	32	92	70	75	1305.5	51	Medium

BLOCKS

✓ Number	Name	Area	Volume
___ 1	Block1	2696	24266 cu ft

SPACES

✓ Number	Name	Area	Volume	Kitchen	Occupants	Bedrooms	Finished	Cooled	Heated
___ 1	Main	2696	24266	Yes	3	3	Yes	Yes	Yes

FLOORS

(Total Exposed Area = 2696 sq.ft.)

✓ #	Floor Type	Space	Exposed Perim	Perimeter R-Value	Area	U-Factor	Joist R-Value	Tile	Wood	Carpet
___ 1	Slab-On-Grade Edge Ins	Main	221	0	2696.2 ft	0.578	---	0.25	0.50	0.25

ROOF

✓ #	Type	Materials	Roof Area	Gable Area	Roof Color	Rad Barr	Solar Absor.	SA Tested	Emitt	Emitt Tested	Deck Insul.	Pitch (deg)
___ 1	Gable or shed	Metal	3015 ft²	674 ft²	Medium	N	0.96	No	0.9	No	0	26.57

ATTIC

✓ #	Type	Ventilation	Vent Ratio (1 in)	Area	RBS	IRCC
___ 1	Full attic	Vented	300	2696.2 ft²	N	N

CEILING

(Total Exposed Area = 2696 sq.ft.)

✓ #	Ceiling Type	Space	R-Value	Ins. Type	Area	U-Factor	Framing Frac.	Truss Type
___ 1	Flat ceiling under attic(Vented)	Main	38.0	Blown	2696.2ft²	0.046	0.23	Wood

INPUT SUMMARY CHECKLIST REPORT

WALLS

(Total Exposed Area = 1988 sq.ft.)

✓ #	Ornt	Adjacent To	Wall Type	Space	Cavity R-Value	Width Ft In	Height Ft In	Area sq.ft.	U-Factor	Sheath R-Value	Frm. Frac.	Solar Absor.	Below Grade
1	N	Exterior	Frame-Wood	Main	13.0	29.0 12	9.0 0	269.9	0.084	1	0.23	0.75	0 %
2	N	Exterior	Frame-Wood	Main	13.0	30.0 1	9.0 0	271.0	0.084	1	0.23	0.75	0 %
3	E	Exterior	Frame-Wood	Main	13.0	50.0 5	9.0 0	453.8	0.084	1	0.23	0.75	0 %
4	S	Exterior	Frame-Wood	Main	13.0	60.0 0	9.0 0	540.0	0.084	1	0.23	0.75	0 %
5	W	Exterior	Frame-Wood	Main	13.0	50.0 5	9.0 0	453.8	0.084	1	0.23	0.75	0 %

DOORS

(Total Exposed Area = 67 sq.ft.)

✓ #	Ornt	Adjacent To	Door Type	Space	Storms	U-Value	Width Ft In	Height Ft In	Area
1	N	Exterior	Insulated	Main	None	0.46	5.00 0	6.00 8	33.3ft²
2	S	Exterior	Insulated	Main	None	0.46	3.00 0	6.00 8	20.0ft²
3	W	Exterior	Insulated	Main	None	0.46	2.00 0	6.00 8	13.3ft²

WINDOWS

(Total Exposed Area = 154 sq.ft.)

✓ #	Ornt	Wall ID	Frame	Panels	NFRC U-Factor	SHGC	Imp	Storm	Total Area (ft²)	Same Units	Width (ft)	Height (ft)	--Overhang-- Depth (ft)	Sep. (ft)	Interior Shade	Screen
1	N	1	Metal	Double (Tinted)	Y 0.33	0.21	N	N	9.0	1	3.00	3.00	1.5	2.0	Drapes/blinds	None
2	N	1	Metal	Double (Tinted)	Y 0.33	0.21	N	N	6.0	1	2.00	3.00	1.5	2.0	Drapes/blinds	None
3	N	1	Metal	Double (Tinted)	Y 0.33	0.21	N	N	15.0	1	3.00	5.00	1.5	2.0	Drapes/blinds	None
4	N	2	Metal	Double (Tinted)	Y 0.33	0.21	N	N	9.0	1	3.00	3.00	12.0	2.0	Drapes/blinds	None
5	E	3	Metal	Double (Tinted)	Y 0.33	0.21	N	N	30.0	2	3.00	5.00	1.5	2.0	Drapes/blinds	None
6	E	3	Metal	Double (Tinted)	Y 0.33	0.21	N	N	6.0	1	2.00	3.00	1.5	2.0	Drapes/blinds	None
7	S	4	Metal	Double (Tinted)	Y 0.33	0.21	N	N	45.0	3	3.00	5.00	10.0	2.0	Drapes/blinds	None
8	S	4	Metal	Double (Tinted)	Y 0.33	0.21	N	N	25.0	1	5.00	5.00	10.0	2.0	Drapes/blinds	None
9	S	4	Metal	Double (Tinted)	Y 0.33	0.21	N	N	3.0	1	3.00	1.00	10.0	2.0	Drapes/blinds	None
10	W	5	Metal	Double (Tinted)	Y 0.33	0.21	N	N	6.0	1	2.00	3.00	1.5	2.0	Drapes/blinds	None

INFILTRATION

✓ #	Scope	Method	SLA	CFM50	ELA	EqLA	ACH	ACH50	Space(s)	Infiltration Test Volume
1	Wholehouse	Proposed ACH(50)	0.00029	2022	110.94	208.28	0.1027	5.0	All	24266 cu ft

MASS

✓ #	Mass Type	Area	Thickness	Furniture Fraction	Space
1	Default(8 lbs/sq.ft.)	0 ft²	0 ft	0.30	Main

HEATING SYSTEM

✓ #	System Type	Subtype/Speed	AHRI #	Efficiency	Capacity kBtu/hr	---Geothermal HeatPump--- Entry Power Volt	Ducts Current	Block
1	Electric Heat Pump	Split/Single		HSPF: 8.20	60.0	0.00 0.00 0.00	sys#1	1

INPUT SUMMARY CHECKLIST REPORT

COOLING SYSTEM

✓ #	System Type	Subtype/Speed	AHRI #	Efficiency	Capacity kBtu/hr	Air Flow cfm	SHR	Duct	Block
1	Central Unit	Split/Single		SEER:14.0	60.0	1800	0.75	sys#1	1

HOT WATER SYSTEM

✓ #	System Type	Subtype	Location	EF(UEF)	Cap	Use	SetPnt	Fixture Flow	Pipe Ins.	Pipe length
1	Electric	Tankless	Exterior	0.92 (0.92)	1.00 gal	60 gal	120 deg	Standard	None	99
	Recirculation System	Recirc Control Type	Loop length	Branch length	Pump power	DWHR	Facilities Connected	Equal Flow	DWHR Eff	Other Credits
1	No		NA	NA	NA	No	NA	NA	NA	None

DUCTS

✓ Duct #	Location	Supply R-Value	Area	Return R-Value	Area	Leakage Type	Air Handler	CFM 25 TOT	CFM 25 OUT	QN	RLF	HVAC # Heat Cool
1	Attic	6.0	539 ft²	Attic	6.0	135 ft²	Default Leakage	Main	(Default)	(Default)		1 1

TEMPERATURES

Programable Thermostat: N				Ceiling Fans: N											
Cooling	<input type="checkbox"/> Jan	<input type="checkbox"/> Feb	<input type="checkbox"/> Mar	<input type="checkbox"/> Apr	<input type="checkbox"/> May	<input checked="" type="checkbox"/> Jun	<input checked="" type="checkbox"/> Jul	<input checked="" type="checkbox"/> Aug	<input checked="" type="checkbox"/> Sep	<input type="checkbox"/> Oct	<input type="checkbox"/> Nov	<input type="checkbox"/> Dec			
Heating	<input checked="" type="checkbox"/> Jan	<input checked="" type="checkbox"/> Feb	<input checked="" type="checkbox"/> Mar	<input type="checkbox"/> Apr	<input type="checkbox"/> May	<input type="checkbox"/> Jun	<input type="checkbox"/> Jul	<input type="checkbox"/> Aug	<input type="checkbox"/> Sep	<input type="checkbox"/> Oct	<input checked="" type="checkbox"/> Nov	<input checked="" type="checkbox"/> Dec			
Venting	<input type="checkbox"/> Jan	<input type="checkbox"/> Feb	<input checked="" type="checkbox"/> Mar	<input checked="" type="checkbox"/> Apr	<input type="checkbox"/> May	<input type="checkbox"/> Jun	<input type="checkbox"/> Jul	<input type="checkbox"/> Aug	<input type="checkbox"/> Sep	<input checked="" type="checkbox"/> Oct	<input checked="" type="checkbox"/> Nov	<input type="checkbox"/> Dec			
Thermostat Schedule: HERS 2006 Reference				Hours											
Schedule Type				1	2	3	4	5	6	7	8	9	10	11	12
___ Cooling (WD)	AM	78	78	78	78	78	78	78	78	78	78	78	78	78	78
	PM	78	78	78	78	78	78	78	78	78	78	78	78	78	78
___ Cooling (WEH)	AM	78	78	78	78	78	78	78	78	78	78	78	78	78	78
	PM	78	78	78	78	78	78	78	78	78	78	78	78	78	78
___ Heating (WD)	AM	68	68	68	68	68	68	68	68	68	68	68	68	68	68
	PM	68	68	68	68	68	68	68	68	68	68	68	68	68	68
___ Heating (WEH)	AM	68	68	68	68	68	68	68	68	68	68	68	68	68	68
	PM	68	68	68	68	68	68	68	68	68	68	68	68	68	68

ENERGY PERFORMANCE LEVEL (EPL) DISPLAY CARD

ESTIMATED ENERGY PERFORMANCE INDEX* = 99

The lower the Energy Performance Index, the more efficient the home.

, Lake City, FL,

1. New construction or existing	New (From Plans)	10. Wall Types(1988.3 sqft.)	Insulation	Area
2. Single family or multiple family	Detached	a. Frame - Wood, Exterior	R=13.0	1988.30 ft ²
3. Number of units, if multiple family	1	b. N/A	R=	ft ²
4. Number of Bedrooms	3	c. N/A	R=	ft ²
5. Is this a worst case?	No	d. N/A	R=	ft ²
6. Conditioned floor area above grade (ft ²)	2696	11. Ceiling Types(2696.2 sqft.)	Insulation	Area
Conditioned floor area below grade (ft ²)	0	a. Flat ceiling under att (Vented)	R=38.0	2696.20 ft ²
7. Windows**	Description	b. N/A	R=	ft ²
a. U-Factor:	Dbl, U=0.33	c. N/A	R=	ft ²
SHGC:	SHGC=0.21	12. Ducts, location & insulation level	R	ft ²
b. U-Factor:	N/A	a. Sup: Attic, Ret: Attic, AH: Main	6	539
SHGC:	N/A	b.		
c. U-Factor:	N/A	c.		
SHGC:		13. Cooling Systems	kBtu/hr	Efficiency
Area Weighted Average Overhang Depth:	6.143 ft	a. Central Unit	60.0	SEER:14.00
Area Weighted Average SHGC:	0.210	14. Heating Systems	kBtu/hr	Efficiency
8. Skylights	Description	a. Electric Heat Pump	60.0	HSPF:8.20
U-Factor:(AVG)	N/A	15. Hot Water Systems		
SHGC(AVG):	N/A	a. Electric Tankless	Cap: 1 gallons	
9. Floor Types	Insulation		EF: 0.920	
a. Slab-On-Grade Edge Insulation	R= 0.0	b. Conservation features		
b. N/A		16. Credits		None
c. N/A				None

I certify that this home has complied with the Florida Energy Efficiency Code for Building Construction through the above energy saving features which will be installed (or exceeded) in this home before final inspection. Otherwise, a new EPL Display Card will be completed based on installed Code compliant features.

Builder Signature: _____ Date: _____
 Address of New Home: _____
 City/FL Zip: Lake City, FL,



*Note: This is not a Building Energy Rating. If your Index is below 70, your home may qualify for energy efficient mortgage (EEM) incentives if you obtain a Florida Energy Rating. For information about the Florida Building Code, Energy Conservation, contact the Florida Building Commission's support staff.

**Label required by Section R303.1.3 of the Florida Building Code, Energy Conservation, if not DEFAULT.

Florida Building Code, Energy Conservation, 7th Edition (2020)
Mandatory Requirements for Residential Performance, Prescriptive and ERI Methods

ADDRESS:

Lake City, FL

Permit Number:

MANDATORY REQUIREMENTS - See individual code sections for full details.

SECTION R401 GENERAL

- ☐ **R401.3 Energy Performance Level (EPL) display card - (Mandatory).** The building official shall require that an energy performance level (EPL) display card be completed and certified by the builder to be accurate and correct before final approval of the building for occupancy. Florida law (Section 553.9085, Florida Statutes) requires the EPL display card to be included as an addendum to each sales contract for both presold and nonpresold residential buildings. The EPL display card contains information indicating the energy performance level and efficiencies of components installed in a dwelling unit. The building official shall verify that the EPL display card completed and signed by the builder accurately reflects the plans and specifications submitted to demonstrate code compliance for the building. A copy of the EPL display card can be found in Appendix RD.

SECTION R402 BUILDING THERMAL ENVELOPE

- ☐ **R402.4 Air leakage (Mandatory).** The building thermal envelope shall be constructed to limit air leakage in accordance with the requirements of Sections R402.4.1 through R402.4.5.

Exception: Dwelling units of R-2 Occupancies and multiple attached single family dwellings shall be permitted to comply with Section C402.5.

- ☐ **R402.4.1 Building thermal envelope.** The building thermal envelope shall comply with Sections R402.4.1.1 and R402.4.1.2. The sealing methods between dissimilar materials shall allow for differential expansion and contraction.

- ☐ **R402.4.1.1 Installation.** The components of the building thermal envelope as listed in Table R402.4.1.1 shall be installed in accordance with the manufacturer's instructions and the criteria listed in Table R402.4.1.1, as applicable to the method of construction. Where required by the code official, an approved third party shall inspect all components and verify compliance.

- ☐ **R402.4.1.2 Testing.** The building or dwelling unit shall be tested and verified as having an air leakage rate not exceeding seven air changes per hour in Climate Zones 1 and 2, and three air changes per hour in Climate Zones 3 through 8. Testing shall be conducted in accordance with ANSI/RESNET/ICC 380 and reported at a pressure of 0.2 inch w.g. (50 pascals). Testing shall be conducted by either individuals as defined in Section 553.993(5) or (7), Florida Statutes, or individuals licensed as set forth in Section 489.105(3)(f), (g) or (i) or an approved third party. A written report of the results of the test shall be signed by the party conducting the test and provided to the code official. Testing shall be performed at any time after creation of all penetrations of the building thermal envelope.

Exception: Testing is not required for additions, alterations, renovations, or repairs, of the building thermal envelope of existing buildings in which the new construction is less than 85 percent of the building thermal envelope.

During testing:

1. Exterior windows and doors, fireplace and stove doors shall be closed, but not sealed, beyond the intended weatherstripping or other infiltration control measures.
2. Dampers including exhaust, intake, makeup air, backdraft and flue dampers shall be closed, but not sealed beyond intended infiltration control measures.
3. Interior doors, if installed at the time of the test, shall be open.
4. Exterior doors for continuous ventilation systems and heat recovery ventilators shall be closed and sealed.
5. Heating and cooling systems, if installed at the time of the test, shall be turned off.
6. Supply and return registers, if installed at the time of the test, shall be fully open.

- ☐ **R402.4.2 Fireplaces.** New wood-burning fireplaces shall have tight-fitting flue dampers or doors, and outdoor combustion air. Where using tight-fitting doors on factory-built fireplaces listed and labeled in accordance with UL 127, the doors shall be tested and listed for the fireplace. Where using tight-fitting doors on masonry fireplaces, the doors shall be listed and labeled in accordance with UL 907.

- ☐ **R402.4.3 Fenestration air leakage.** Windows, skylights and sliding glass doors shall have an air infiltration rate of no more than 0.3 cfm per square foot (1.5 L/s/m²), and swinging doors no more than 0.5 cfm per square foot (2.6 L/s/m²), when tested according to NFRC 400 or AAMA/WDMA/CSA 101/I.S.2/A440 by an accredited, independent laboratory and listed and labeled by the manufacturer.

Exception: Site-built windows, skylights and doors.

- ☐ **R402.4.4 Rooms containing fuel - burning appliances.** In Climate Zones 3 through 8, where open combustion air ducts provide combustion air to open combustion fuel burning appliances, the appliances and combustion air opening shall be located outside the building thermal envelope or enclosed in a room, isolated from inside the thermal envelope. Such rooms shall be sealed and insulated in accordance with the envelope requirements of Table R402.1.2, where the walls, floors and ceilings shall meet not less than the basement wall R-value requirement. The door into the room shall be fully gasketed and any water lines and ducts in the room insulated in accordance with Section R403. The combustion air duct shall be insulated where it passes through conditioned space to a minimum of R-8.

Exceptions:

1. Direct vent appliances with both intake and exhaust pipes installed continuous to the outside.
2. Fireplaces and stoves complying with Section R402.4.2 and Section R1006 of the Florida Building Code, Residential.

MANDATORY REQUIREMENTS (Continued)

- ☐ **R402.4.5 Recessed lighting.** Recessed luminaires installed in the building thermal envelope shall be sealed to limit air leakage between conditioned and unconditioned spaces. All recessed luminaires shall be IC-rated and labeled as having an air leakage rate not more than 2.0 cfm (0.944 L/s) when tested in accordance with ASTM E283 at a 1.57 psf (75 Pa) pressure differential. All recessed luminaires shall be sealed with a gasket or caulk between the housing and the interior wall or ceiling covering.

SECTION R403 SYSTEMS

R403.1 Controls

- ☐ **R403.1.1 Thermostat provision (Mandatory).** At least one thermostat shall be provided for each separate heating and cooling system
- ☐ **R403.1.3 Heat pump supplementary heat (Mandatory).** Heat pumps having supplementary electric-resistance heat shall have controls that, except during defrost, prevent supplemental heat operation when the heat pump compressor can meet the heating load.

- ☐ **R403.3.2 Sealing (Mandatory).** All ducts, air handlers, filter boxes and building cavities that form the primary air containment passageways for air distribution systems shall be considered ducts or plenum chambers, shall be constructed and sealed in accordance with Section C403.2.9.2 of the Commercial Provisions of this code and shall be shown to meet duct tightness criteria below.

Duct tightness shall be verified by testing in accordance with ANSI/RESNET/ICC 380 by either individuals as defined in Section 553.993(5) or (7), Florida Statutes, or individuals licensed as set forth in Section 489.105(3)(f), (g) or (i), Florida Statutes, to be "substantially leak free" in accordance with Section R403.3.3.

- ☐ **R403.3.2.1 Sealed air handler.** Air handlers shall have a manufacturer's designation for an air leakage of no more than 2 percent of the design airflow rate when tested in accordance with ASHRAE 193.

- ☐ **R403.3.3 Duct testing (Mandatory).** Ducts shall be pressure tested to determine air leakage by one of the following methods:
 1. Rough-in test: Total leakage shall be measured with a pressure differential of 0.1 inch w.g. (25 Pa) across the system, including the manufacturer's air handler enclosure if installed at the time of the test. All registers shall be taped or otherwise sealed during the test.
 2. Postconstruction test: Total leakage shall be measured with a pressure differential of 0.1 inch w.g. (25 Pa) across the entire system, including the manufacturer's air handler enclosure. Registers shall be taped or otherwise sealed during the test.**Exceptions;**

1. A duct air leakage test shall not be required where the ducts and air handlers are located entirely within the building thermal envelope.
2. Duct testing is not mandatory for buildings complying by Section 405 of this code. Duct leakage testing is required for Section R405 compliance where credit is taken for leakage, and a duct air leakage Q_n to the outside of less than 0.080 (where Q_n = duct leakage to the outside in cfm per 100 square feet of conditioned floor area tested at 25 Pascals) is indicated in the compliance report for the proposed design.

A written report of the results of the test shall be signed by the party conducting the test and provided to the code official

- ☐ **R403.3.5 Building cavities (Mandatory).** Building framing cavities shall not be used as ducts or plenums

- ☐ **R403.4 Mechanical system piping insulation (Mandatory).** Mechanical system piping capable of carrying fluids above 105°F (41°C) or below 55°F (13°C) shall be insulated to a minimum of R-3.

- ☐ **R403.4.1 Protection of piping insulation.** Piping insulation exposed to weather shall be protected from damage, including that caused by sunlight, moisture, equipment maintenance and wind, and shall provide shielding from solar radiation that can cause degradation of the material. Adhesive tape shall not be permitted.

- ☐ **R403.5.1 Heated water circulation and temperature maintenance systems (Mandatory).** If heated water circulation systems are installed, they shall be in accordance with Section R403.5.1.1. Heat trace temperature maintenance systems shall be in accordance with Section R403.5.1.2. Automatic controls, temperature sensors and pumps shall be accessible. Manual controls shall be readily accessible.

- ☐ **R403.5.1.1 Circulation systems.** Heated water circulation systems shall be provided with a circulation pump. The system return pipe shall be a dedicated return pipe or a cold water supply pipe. Gravity and thermosiphon circulation systems shall be prohibited. Controls for circulating hot water system pumps shall start the pump based on the identification of a demand for hot water within the occupancy. The controls shall automatically turn off the pump when the water in the circulation loop is at the desired temperature and when there is no demand for hot water.

- ☐ **R403.5.1.2 Heat trace systems.** Electric heat trace systems shall comply with IEEE 515.1 or UL 515. Controls for such systems shall automatically adjust the energy input to the heat tracing to maintain the desired water temperature in the piping in accordance with the times when heated water is used in the occupancy.

MANDATORY REQUIREMENTS (Continued)

☐ **R403.5.5 Heat traps (Mandatory).** Storage water heaters not equipped with integral heat traps and having vertical pipe risers shall have heat traps installed on both the inlets and outlets. External heat traps shall consist of either a commercially available heat trap or a downward and upward bend of at least 3 1/2 inches (89 mm) in the hot water distribution line and cold water line located as close as possible to the storage tank.

☐ **R403.5.6 Water heater efficiencies (Mandatory).**

☐ **R403.5.6.1.1 Automatic controls.** Service water-heating systems shall be equipped with automatic temperature controls capable of adjustment from the lowest to the highest acceptable temperature settings for the intended use. The minimum temperature setting range shall be from 100°F to 140°F (38°C to 60°C).

☐ **R403.5.6.1.2 Shut down.** A separate switch or a clearly marked circuit breaker shall be provided to permit the power supplied to electric service systems to be turned off. A separate valve shall be provided to permit the energy supplied to the main burner(s) of combustion types of service water-heating systems to be turned off.

☐ **R403.5.6.2 Water-heating equipment.** Water-heating equipment installed in residential units shall meet the minimum efficiencies of Table C404.2 in Chapter 4 of the Florida Building Code, Energy Conservation, Commercial Provisions, for the type of equipment installed. Equipment used to provide heating functions as part of a combination system shall satisfy all stated requirements for the appropriate water-heating category. Solar water heaters shall meet the criteria of Section R403.5.6.2.1.

☐ **R403.5.6.2.1 Solar water-heating systems.** Solar systems for domestic hot water production are rated by the annual solar energy factor of the system. The solar energy factor of a system shall be determined from the Florida Solar Energy Center Directory of Certified Solar Systems. Solar collectors shall be tested in accordance with ISO Standard 9806, Test Methods for Solar Collectors, and SRCC Standard TM-1, Solar Domestic Hot Water System and Component Test Protocol. Collectors in installed solar water-heating systems should meet the following criteria:

1. Be installed with a tilt angle between 10 degrees and 40 degrees of the horizontal; and
2. Be installed at an orientation within 45 degrees of true south.

☐ **R403.6 Mechanical ventilation (Mandatory).** The building shall be provided with ventilation that meets the requirements of the Florida Building Code, Residential, or Florida Building Code, Mechanical, as applicable, or with other approved means of ventilation including: Natural, Infiltration or Mechanical means. Outdoor air intakes and exhausts shall have automatic or gravity dampers that close when the ventilation system is not operating.

☐ **R403.6.1 Whole-house mechanical ventilation system fan efficacy.** When installed to function as a whole-house mechanical ventilation system, fans shall meet the efficacy requirements of Table R403.6.1.

☐ **Exception:** Where an air handler that is integral to tested and listed HVAC equipment is used to provide whole-house mechanical ventilation, the air handler shall be powered by an electronically commutated motor.

☐ **R403.6.2 Ventilation Air.** Residential buildings designed to be operated at a positive indoor pressure or for mechanical ventilation shall meet the following criteria:

1. The design air change per hour minimums for residential buildings in ASHRAE 62.2, Ventilation for Acceptable Indoor Air Quality, shall be the maximum rates allowed for residential applications.
2. No ventilation or air-conditioning system make-up air shall be provided to conditioned space from attics, crawlspaces, attached enclosed garages or outdoor spaces adjacent to swimming pools or spas.
3. If ventilation air is drawn from enclosed space(s), then the walls of the space(s) from which air is drawn shall be insulated to a minimum of R-11 and the ceiling shall be insulated to a minimum of R-19, space permitting, or R-10 otherwise.

☐ **R403.7 Heating and cooling equipment.**

☐ **R403.7.1 Equipment sizing (Mandatory).** Heating and cooling equipment shall be sized in accordance with ACCA Manual S based on the equipment loads calculated in accordance with ACCA Manual J or other approved heating and cooling calculation methodologies, based on building loads for the directional orientation of the building. The manufacturer and model number of the outdoor and indoor units (if split system) shall be submitted along with the sensible and total cooling capacities at the design conditions described in Section R302.1. This Code does not allow designer safety factors, provisions for future expansion or other factors that affect equipment sizing. System sizing calculations shall not include loads created by local intermittent mechanical ventilation such as standard kitchen and bathroom exhaust systems. New or replacement heating and cooling equipment shall have an efficiency rating equal to or greater than the minimum required by federal law for the geographic location where the equipment is installed.

MANDATORY REQUIREMENTS (Continued)

TABLE R403.6.1
WHOLE-HOUSE MECHANICAL VENTILATION SYSTEM FAN EFFICACY

FAN LOCATION	AIRFLOW RATE MINIMUM (CFM)	MINIMUM EFFICACY* (CFM/WATT)	AIRFLOW RATE MAXIMUM (CFM)
HRV or ERV	Any	1.2 cfm/watt	Any
Range hoods	Any	2.8 cfm/watt	Any
In-line fan	Any	2.8 cfm/watt	Any
Bathroom, utility room	10	1.4 cfm/watt	<90
Bathroom, utility room	90	2.8 cfm/watt	Any

For SI: 1 cfm = 28.3 L/min.

a. When tested in accordance with HVI Standard 916

- ☐ **R403.7.1.1 Cooling equipment capacity.** Cooling only equipment shall be selected so that its total capacity is not less than the calculated total load but not more than 1.15 times greater than the total load calculated according to the procedure selected in Section R403.7, or the closest available size provided by the manufacturer's product lines. The corresponding latent capacity of the equipment shall not be less than the calculated latent load. The published value for AHRI total capacity is a nominal, rating-test value and shall not be used for equipment sizing. Manufacturer's expanded performance data shall be used to select cooling-only equipment. This selection shall be based on the outdoor design dry-bulb temperature for the load calculation (or entering water temperature for water-source equipment), the blower CFM provided by the expanded performance data, the design value for entering wet-bulb temperature and the design value for entering dry-bulb temperature.

Design values for entering wet-bulb and dry-bulb temperatures shall be for the indoor dry bulb and relative humidity used for the load calculation and shall be adjusted for return side gains if the return duct(s) is installed in an unconditioned space.

Exceptions:

1. Attached single- and multiple-family residential equipment sizing may be selected so that its cooling capacity is less than the calculated total sensible load but not less than 80 percent of that load.
2. When signed and sealed by a Florida-registered engineer, in attached single- and multiple-family units, the capacity of equipment may be sized in accordance with good design practice.

R403.7.1.2 Heating equipment capacity.

- ☐ **R403.7.1.2.1 Heat pumps.** Heat pump sizing shall be based on the cooling requirements as calculated according to Section R403.7.1.1, and the heat pump total cooling capacity shall not be more than 1.15 times greater than the design cooling load even if the design heating load is 1.15 times greater than the design cooling load.
- ☐ **R403.7.1.2.2 Electric resistance furnaces.** Electric resistance furnaces shall be sized within 4 kW of the design requirements calculated according to the procedure selected in Section R403.7.1.
- ☐ **R403.7.1.2.3 Fossil fuel heating equipment.** The capacity of fossil fuel heating equipment with natural draft atmospheric burners shall not be less than the design load calculated in accordance with Section R403.7.1.
- ☐ **R403.7.1.3 Extra capacity required for special occasions.** Residences requiring excess cooling or heating equipment capacity on an intermittent basis, such as anticipated additional loads caused by major entertainment events, shall have equipment sized or controlled to prevent continuous space cooling or heating within that space by one or more of the following options:
1. A separate cooling or heating system is utilized to provide cooling or heating to the major entertainment areas.
 2. A variable capacity system sized for optimum performance during base load periods is utilized.
- ☐ **R403.8 Systems serving multiple dwelling units (Mandatory).** Systems serving multiple dwelling units shall comply with Sections C403 and C404 of the Florida Building Code, Energy Conservation—Commercial Provisions in lieu of Section R403.
- ☐ **R403.9 Snow melt and ice system controls (Mandatory).** Snow- and ice-melting systems, supplied through energy service to the building, shall include automatic controls capable of shutting off the system when the pavement temperature is above 50°F (10°C), and no precipitation is falling and an automatic or manual control that will allow shutoff when the outdoor temperature is above 40°F (4.8°C).
- ☐ **403.10 Pools and permanent spa energy consumption (Mandatory).** The energy consumption of pools and permanent spas shall be in accordance with Sections R403.10.1 through R403.10.5.
- ☐ **R403.10.1 Heaters.** The electric power to heaters shall be controlled by a readily accessible on-off switch that is an integral part of the heater mounted on the exterior of the heater, or external to and within 3 feet (914 mm) of the heater. Operation of such switch shall not change the setting of the heater thermostat. Such switches shall be in addition to a circuit breaker for the power to the heater. Gas-fired heaters shall not be equipped with continuously burning ignition pilots.

MANDATORY REQUIREMENTS (Continued)

- ☐ **R403.10.2 Time switches.** Time switches or other control methods that can automatically turn off and on according to a preset schedule shall be installed for heaters and pump motors. Heaters and pump motors that have built-in time switches shall be in compliance with this section.
- Exceptions:**
1. Where public health standards require 24-hour pump operation.
 2. Pumps that operate solar- and waste-heat-recovery pool heating systems
 3. Where pumps are powered exclusively from on-site renewable generation.
- ☐ **R403.10.3 Covers.** Outdoor heated swimming pools and outdoor permanent spas shall be equipped with a vapor-retardant cover on or at the water surface or a liquid cover or other means proven to reduce heat loss.
- Exception:** Where more than 70 percent of the energy for heating, computed over an operation season, is from site-recovered energy, such as from a heat pump or solar energy source, covers or other vapor-retardant means shall not be required
- ☐ **R403.10.4 Gas- and oil-fired pool and spa heaters.** All gas- and oil-fired pool and spa heaters shall have a minimum thermal efficiency of 82 percent for heaters manufactured on or after April 16, 2013, when tested in accordance with ANSI Z 21.56. Pool heaters fired by natural or LP gas shall not have continuously burning pilot lights.
- ☐ **R403.10.5 Heat pump pool heaters.** Heat pump pool heaters shall have a minimum COP of 4.0 when tested in accordance with AHRI 1160, Table 2, Standard Rating Conditions-Low Air Temperature. A test report from an independent laboratory is required to verify procedure compliance. Geothermal swimming pool heat pumps are not required to meet this standard.
- ☐ **R403.11 Portable spas (Mandatory).** The energy consumption of electric-powered portable spas shall be controlled by the requirements of APSP-14
- ☐ **R403.13 Dehumidifiers (Mandatory).** If installed, a dehumidifier shall conform to the following requirements:
1. The minimum rated efficiency of the dehumidifier shall be greater than 1.7 liters/ kWh if the total dehumidifier capacity for the house is less than 75 pints/day and greater than 2.38 liters/kWh if the total dehumidifier capacity for the house is greater than or equal to 75 pints/day.
 2. The dehumidifier shall be controlled by a sensor that is installed in a location where it is exposed to mixed house air.
 3. Any dehumidifier unit located in unconditioned space that treats air from conditioned space shall be insulated to a minimum of R-2.
 4. Condensate disposal shall be in accordance with Section M1411.3.1 of the Florida Building Code, Residential.
- ☐ **R403.13.1 Ducted dehumidifiers.** Ducted dehumidifiers shall, in addition to conforming to the requirements of Section R403.13, conform to the following requirements:
1. If a ducted dehumidifier is configured with return and supply ducts both connected into the supply side of the cooling system, a backdraft damper shall be installed in the supply air duct between the dehumidifier inlet and outlet duct.
 2. If a ducted dehumidifier is configured with only its supply duct connected into the supply side of the central heating and cooling system, a backdraft damper shall be installed in the dehumidifier supply duct between the dehumidifier and central supply duct.
 3. A ducted dehumidifier shall not be ducted to or from a central ducted cooling system on the return duct side upstream from the central cooling evaporator coil.
 4. Ductwork associated with a dehumidifier located in unconditioned space shall be insulated to a minimum of R-6.

SECTION R404 ELECTRICAL POWER AND LIGHTING SYSTEMS

- ☐ **R404.1 Lighting equipment (Mandatory).** Not less than 90 percent of the lamps in permanently installed luminaires shall have an efficacy of at least 45 lumens-per-watt or shall utilize lamps with an efficacy of not less than 65 lumens-per-watt.
- R404.1.1 Lighting equipment (Mandatory).** Fuel gas lighting systems shall not have continuously burning pilot lights.

2020 - AIR BARRIER AND INSULATION INSPECTION COMPONENT CRITERIA

TABLE 402.4.1.1

AIR BARRIER AND INSULATION INSPECTION COMPONENT CRITERIA^a

Project Name: Norris Peeler		Builder Name: Norris Construction		CHECK
Street:		Permit Office:		
City, State, Zip: Lake City, FL,		Permit Number:		
Owner: Peeler		Jurisdiction:		
Design Location: FL, Gainesville		County: Columbia(Florida Climate Zone 2)		
COMPONENT	AIR BARRIER CRITERIA	INSULATION INSTALLATION CRITERIA		
General requirements	A continuous air barrier shall be installed in the building envelope. The exterior thermal envelope contains a continuous air barrier. Breaks or joints in the air barrier shall be sealed.	Air-permeable insulation shall not be used as a sealing material.		
Ceiling/attic	The air barrier in any dropped ceiling/soffit shall be aligned with the insulation and any gaps in the air barrier shall be sealed. Access openings, drop down stairs or knee wall doors to unconditioned attic spaces shall be sealed.	The insulation in any dropped ceiling/soffit shall be aligned with the air barrier.		
Walls	The junction of the foundation and sill plate shall be sealed. The junction of the top plate and the top of exterior walls shall be sealed. Knee walls shall be sealed.	Cavities within corners and headers of frame walls shall be insulated by completely filling the cavity with a material having a thermal resistance of R-3 per inch minimum. Exterior thermal envelope insulation for framed walls shall be installed in substantial contact and continuous alignment with the air barrier.		
Windows, skylights and doors	The space between window/door jambs and framing, and skylights and framing shall be sealed.			
Rim joists	Rim joists shall include the air barrier.	Rim joists shall be insulated.		
Floors (including above-garage and cantilevered floors)	The air barrier shall be installed at any exposed edge of insulation.	Floor framing cavity insulation shall be installed to maintain permanent contact with the underside of subfloor decking, or floor framing cavity insulation shall be permitted to be in contact with the top side of sheathing, or continuous insulation installed on the underside of floor framing and extends from the bottom to the top of all perimeter floor framing members.		
Crawl space walls	Exposed earth in unvented crawl spaces shall be covered with a Class I vapor retarder with overlapping joints taped.	Where provided instead of floor insulation, insulation shall be permanently attached to the crawlspace walls.		
Shafts, penetrations	Duct shafts, utility penetrations, and flue shafts opening to exterior or unconditioned space shall be sealed.			
Narrow cavities		Batts in narrow cavities shall be cut to fit, or narrow cavities shall be filled by insulation that on installation readily conforms to the available cavity spaces.		
Garage separation	Air sealing shall be provided between the garage and conditioned spaces.			
Recessed lighting	Recessed light fixtures installed in the building thermal envelope shall be sealed to the finished surface.	Recessed light fixtures installed in the building thermal envelope shall be air tight and IC rated.		
Plumbing and wiring		Batt insulation shall be cut neatly to fit around wiring and plumbing in exterior walls, or insulation that on installation readily conforms to available space shall extend behind piping and wiring.		
Shower/tub on exterior wall	The air barrier installed at exterior walls adjacent to showers and tubs shall separate them from the showers and tubs.	Exterior walls adjacent to showers and tubs shall be insulated.		
Electrical/phone box on exterior walls	The air barrier shall be installed behind electrical or communication boxes or air-sealed boxes shall be installed.			
HVAC register boots	HVAC supply and return register boots that penetrate building thermal envelope shall be sealed to the sub-floor, wall covering or ceiling penetrated by the boot.			
Concealed sprinklers	When required to be sealed, concealed fire sprinklers shall only be sealed in a manner that is recommended by the manufacturer. Caulking or other adhesive sealants shall not be used to fill voids between fire sprinkler cover plates and walls or ceilings.			

a. In addition, inspection of log walls shall be in accordance with the provisions of ICC-400.

7/26/2022 8:21:11 AM

Residential System Sizing Calculation

Peeler

Lake City, FL

Summary

Project Title:
Norris Peeler

7/26/2022

Location for weather data: Gainesville, FL - Defaults: Latitude(29.7) Altitude(152 ft.) Temp Range(M)			
Humidity data: Interior RH (50%) Outdoor wet bulb (76F) Humidity difference(47gr.)			
Winter design temperature(MJ8 99%)	33 F	Summer design temperature(MJ8 99%)	92 F
Winter setpoint	70 F	Summer setpoint	75 F
Winter temperature difference	37 F	Summer temperature difference	17 F
Total heating load calculation	29528 Btuh	Total cooling load calculation	23326 Btuh
Submitted heating capacity	% of calc Btuh	Submitted cooling capacity	% of calc Btuh
Total (Electric Heat Pump)	203.2 60000	Sensible (SHR = 0.75)	245.4 45000
Heat Pump + Auxiliary(0.0kW)	203.2 60000	Latent	300.8 15000
		Total (Electric Heat Pump)	257.2 60000

WINTER CALCULATIONS

Winter Heating Load (for 2696 sqft)

Load component		Load
Window total	154 sqft	1880 Btuh
Wall total	1768 sqft	5549 Btuh
Door total	67 sqft	1135 Btuh
Ceiling total	2696 sqft	2532 Btuh
Floor total	2696 sqft	9649 Btuh
Infiltration	66 cfm	2692 Btuh
Duct loss		6091 Btuh
Subtotal		29528 Btuh
Ventilation	Ex:0 cfm; Sup:0 cfm	0 Btuh
TOTAL HEAT LOSS		29528 Btuh

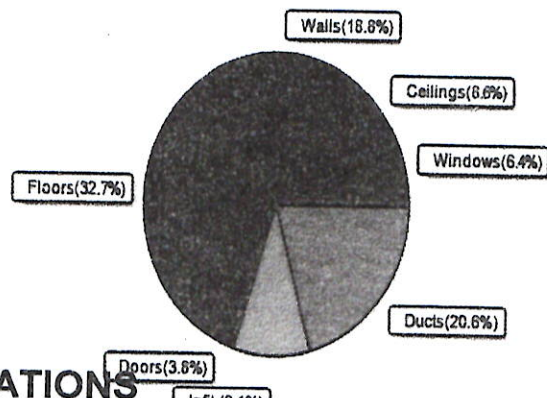

SUMMER CALCULATIONS

Summer Cooling Load (for 2696 sqft)

Load component		Load
Window total	154 sqft	1651 Btuh
Wall total	1768 sqft	3525 Btuh
Door total	67 sqft	859 Btuh
Ceiling total	2696 sqft	2874 Btuh
Floor total		0 Btuh
Infiltration	50 cfm	928 Btuh
Internal gain		1890 Btuh
Duct gain		6613 Btuh
Sens.Ventilation	Ex:0 cfm; Sup:0 cfm	0 Btuh
Blower Load		0 Btuh
Total sensible gain		18339 Btuh
Latent gain(ducts)		1601 Btuh
Latent gain(infiltration)		1585 Btuh
Latent gain(ventilation)		0 Btuh
Latent gain(internal/occupants/other)		1800 Btuh
Total latent gain		4987 Btuh
TOTAL HEAT GAIN		23326 Btuh

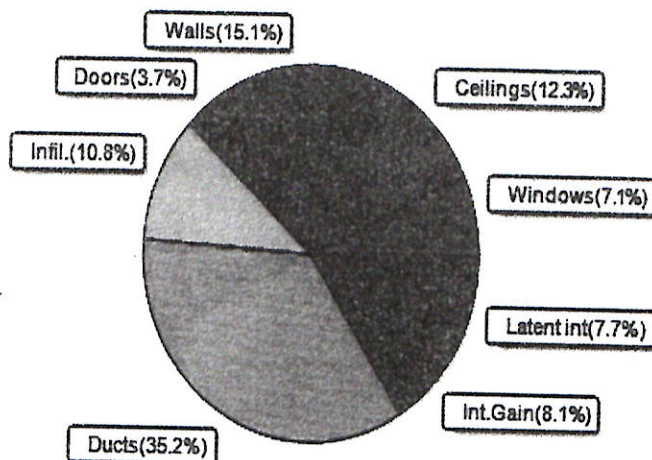

8th Edition

EnergyGauge® System Sizing

PREPARED BY: *Scott Davis*

DATE: *7/25/22*

System Sizing Calculations - Winter

Residential Load - Whole House Component Details

Peeler

Lake City, FL

Project Title:
Norris Peeler
Building Type: User

7/26/2022

Reference City: Gainesville, FL (Defaults) Winter Temperature Difference: 37.0 °F (MJ8 99%)
Winter Setpoint: 70 °F (Required Manual J default)

Component Loads for Whole House

Window	Panes/Type	Frame	U	Orientation	Area(sqft)	X	HTM=	Load
1	2, NFRC 0.21	Metal	0.33	N	9.0		12.2	110 Btuh
2	2, NFRC 0.21	Metal	0.33	N	6.0		12.2	73 Btuh
3	2, NFRC 0.21	Metal	0.33	N	15.0		12.2	183 Btuh
4	2, NFRC 0.21	Metal	0.33	N	9.0		12.2	110 Btuh
5	2, NFRC 0.21	Metal	0.33	E	30.0		12.2	366 Btuh
6	2, NFRC 0.21	Metal	0.33	E	6.0		12.2	73 Btuh
7	2, NFRC 0.21	Metal	0.33	S	45.0		12.2	549 Btuh
8	2, NFRC 0.21	Metal	0.33	S	25.0		12.2	305 Btuh
9	2, NFRC 0.21	Metal	0.33	S	3.0		12.2	37 Btuh
10	2, NFRC 0.21	Metal	0.33	W	6.0		12.2	73 Btuh
Window Total					154.0(sqft)			1880 Btuh
Walls	Type	Ornt.	Ueff.	R-Value (Cav/Sh)	Area X		HTM=	Load
1	Frame - Wood	- Ext	(0.085)	13.0/1.0	240		3.14	753 Btuh
2	Frame - Wood	- Ext	(0.085)	13.0/1.0	229		3.14	718 Btuh
3	Frame - Wood	- Ext	(0.085)	13.0/1.0	418		3.14	1311 Btuh
4	Frame - Wood	- Ext	(0.085)	13.0/1.0	447		3.14	1403 Btuh
5	Frame - Wood	- Ext	(0.085)	13.0/1.0	434		3.14	1364 Btuh
Wall Total					1768(sqft)			5549 Btuh
Doors	Type	Storm	Ueff.		Area X		HTM=	Load
1	Insulated - Exterior, n		(0.460)		33		17.0	567 Btuh
2	Insulated - Exterior, n		(0.460)		20		17.0	340 Btuh
3	Insulated - Exterior, n		(0.460)		13		17.0	227 Btuh
Door Total					67(sqft)			1135Btuh
Ceilings	Type/Color/Surface		Ueff.	R-Value	Area X		HTM=	Load
1	Flat ceil/M/Metal		(0.025)	38.0/0.0	2696		0.94	2532 Btuh
Ceiling Total					2696(sqft)			2532Btuh
Floors	Type		Ueff.	R-Value	Size X		HTM=	Load
1	Slab On Grade		(1.180)	0.0	221.0 ft(perim.)		43.7	9649 Btuh
Floor Total					2696 sqft			9649 Btuh
Envelope Subtotal:								20745 Btuh
Infiltration	Type	Wholehouse	ACH	Volume(cuft)	Wall Ratio		CFM=	Load
	Natural		0.16	24266	1.00		66.5	2692 Btuh
Duct load	Average sealed, R6.0, Supply(Att), Return(Att) (DLM of 0.260)							6091 Btuh
All Zones	Sensible Subtotal All Zones							29528 Btuh