



STATE OF FLORIDA  
DEPARTMENT OF ENVIRONMENTAL PROTECTION  
ONSITE SEWAGE TREATMENT AND DISPOSAL  
SYSTEM (OSTDS)

PERMIT NO. 24-0460

DATE PAID: 6/5/24

FEE PAID: 600.25

RECEIPT #: 2325007

APPLICATION FOR CONSTRUCTION PERMIT

APPLICATION FOR:

☒ New System ☐ Existing System ☐ Holding Tank ☐ Innovative  
☐ Repair ☐ Abandonment ☐ Temporary ☒ Carport

APPLICANT: Charles Crawford

EMAIL: ce\_crawford2003@yahoo.com

AGENT: \_\_\_\_\_

TELEPHONE: 229-326-3368

MAILING ADDRESS: 197 SW California Ter Fort White FL 32038

TO BE COMPLETED BY APPLICANT OR APPLICANT'S AUTHORIZED AGENT. SYSTEMS MUST BE CONSTRUCTED BY A PERSON LICENSED PURSUANT TO 489.105(3)(m) OR 489.552, FLORIDA STATUTES. IT IS THE APPLICANT'S RESPONSIBILITY TO PROVIDE DOCUMENTATION OF THE DATE THE LOT WAS CREATED OR PLATTED (MM/DD/YY) IF REQUESTING CONSIDERATION OF STATUTORY GRANDFATHER PROVISIONS.

PROPERTY INFORMATION

OSTDS REMEDIATION PLAN? [ Y / N ]

LOT: 600 <sup>unit 14</sup> BLOCK: \_\_\_\_\_ SUBDIVISION: Three Rivers Estates PLATTED: \_\_\_\_\_

PROPERTY ID #: 00-00-00-00926-000 ZONING: B I/M OR EQUIVALENT: [ Y / N ]

PROPERTY SIZE: 0.88 ACRES WATER SUPPLY: ☒ PRIVATE PUBLIC [ ] ☐ ≤2000GPD [ ] ☐ >2000GPD

IS SEWER AVAILABLE AS PER 381.0065, FS? ☒ Y [ ] N ] DISTANCE TO SEWER: 40 FT

PROPERTY ADDRESS: 197 SW California Ter Fort White FL 32038

DIRECTIONS TO PROPERTY: \_\_\_\_\_

BUILDING INFORMATION

☒ RESIDENTIAL

[ ] COMMERCIAL

Unit No.	Type of Establishment	No. of Bedrooms	Building Area Sqft	Commercial/Institutional System Design Table I, Chapter 62-6, FAC
1	<u>Carport</u>	<u>0</u>	<u>1440</u>	
2				
3				
4				

[ ] Floor/Equipment Drains [ ] Other (Specify) \_\_\_\_\_

SIGNATURE: Mary Crawford DATE: 6/4/24

DEP 4015, 06-21-2022 (Obsoletes previous editions which may not be used)

Incorporated 62-6.004, FAC



Home 14' Each Side Lot line N+S

Home 225' Each Side Lot line E+W

Carport 20' Lot line S

Carport 35' Lot line N

Carport to Septic 40' Apart

Well to carport 15' Apart

Home 52 x 28

Well 35' From Home

Septic 10' From Home

Carport 30 x 48

STATE OF FLORIDA  
DEPARTMENT OF ENVIRONMENTAL PROTECTION  
APPLICATION FOR CONSTRUCTION PERMIT

Permit Application Number

24-0440

PART II - SITEPLAN

Scale: Each block represents 10 feet and 1 inch = 40 feet.

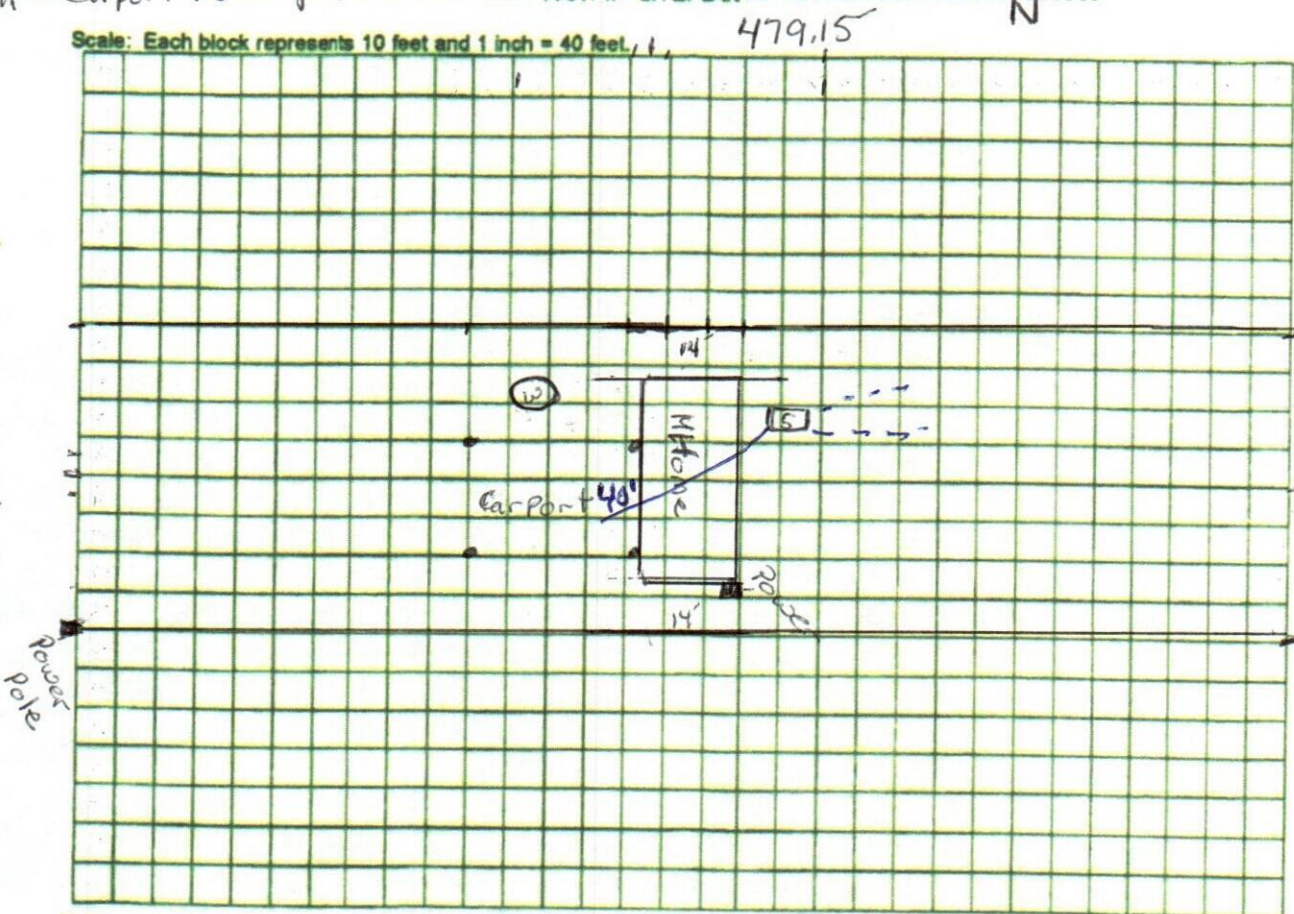

Notes:

479.35

S

Site Plan submitted by:

Mary Crawford

Plan Approved

Not Approved

Date

6/10/24

By

County Health Department

ALL CHANGES MUST BE APPROVED BY THE COUNTY HEALTH DEPARTMENT

DEP 4015, 06-21-2022 (Obsoletes previous editions which may not be used)

Incorporated: 62-6.004, F.A.C.