

DATE 04/05/2004

Columbia County Building Permit

PERMIT

This Permit Expires One Year From the Date of Issue

000021695

APPLICANT HUEY HAWKINS PHONE 497-3991
 ADDRESS 6855 SW ELIM CHURCH RD FORT WHITE FL 32038
 OWNER ELIM BAPTIST CHURCH PHONE 497-3991
 ADDRESS 3435 SW ELIM CHURCH RD FORT WHITE FL 32038
 CONTRACTOR OWNER/MIKE HERLONG PHONE 497-1162
 LOCATION OF PROPERTY 47 SOUTH LEFT ELIM CHURCH RD RIGHT INTO THE CHURCH

TYPE DEVELOPMENT CD,CHURCH FELL-HALL ESTIMATED COST OF CONSTRUCTION 150000.00
 HEATED FLOOR AREA TOTAL AREA 5000.00 HEIGHT 12.00 STORIES 1
 FOUNDATION CONCRETE WALLS FRAMED ROOF PITCH 5/12 FLOOR SLAB
 LAND USE & ZONING A-3 MAX. HEIGHT 35
 Minimum Set Back Requirements: STREET-FRONT 30.00 REAR 25.00 SIDE 25.00
 NO. EX.D.U. 2 FLOOD ZONE X DEVELOPMENT PERMIT NO. _____

PARCEL ID 22-6S-16-03918-000 SUBDIVISION _____
 LOT _____ BLOCK _____ PHASE _____ UNIT _____ TOTAL ACRES 13.00

NA
 Culvert Permit No. Culvert Waiver Contractor's License Number Applicant/Owner/Contractor
 EXISTING 04-0058-N BK RK N
 Driveway Connection Septic Tank Number LU & Zoning checked by Approved for Issuance New Resident

COMMENTS: FLOOR ONE FOOT ABOVE THE ROADNO. ON F.7cSPW-77 PermitCheck # or Cash 7621**FOR BUILDING & ZONING DEPARTMENT ONLY**

(footer/Slab)

Temporary Power _____ date/app. by _____ Foundation _____ date/app. by _____ Monolithic _____ date/app. by _____
 Under slab rough-in plumbing _____ date/app. by _____ Slab _____ date/app. by _____ Sheathing/Nailing _____ date/app. by _____
 Framing _____ date/app. by _____ Rough-in plumbing above slab and below wood floor _____ date/app. by _____
 Electrical rough-in _____ date/app. by _____ Heat & Air Duct _____ date/app. by _____ Peri. beam (Lintel) _____ date/app. by _____
 Permanent power _____ date/app. by _____ C.O. Final _____ date/app. by _____ Culvert _____ date/app. by _____
 M/H tie downs, blocking, electricity and plumbing _____ date/app. by _____ Pool _____ date/app. by _____
 Reconnection _____ date/app. by _____ Pump pole _____ date/app. by _____ Utility Pole _____ date/app. by _____
 M/H Pole _____ date/app. by _____ Travel Trailer _____ date/app. by _____ Re-roof _____ date/app. by _____

BUILDING PERMIT FEE \$ 750.00 CERTIFICATION FEE \$ 25.00 SURCHARGE FEE \$ 25.00
 MISC. FEES \$.00 ZONING CERT. FEE \$ 50.00 FIRE FEE \$ _____ WASTE FEE \$ _____
 FLOOD ZONE DEVELOPMENT FEE \$ _____ CULVERT FEE \$ _____ TOTAL FEE 850.00

INSPECTORS OFFICE [Signature] CLERKS OFFICE CX

NOTICE: IN ADDITION TO THE REQUIREMENTS OF THIS PERMIT, THERE MAY BE ADDITIONAL RESTRICTIONS APPLICABLE TO THIS PROPERTY THAT MAY BE FOUND IN THE PUBLIC RECORDS OF THIS COUNTY. AND THERE MAY BE ADDITIONAL PERMITS REQUIRED FROM OTHER GOVERNMENTAL ENTITIES SUCH AS WATER MANAGEMENT DISTRICTS, STATE AGENCIES, OR FEDERAL AGENCIES.

"WARNING TO OWNER: YOUR FAILURE TO RECORD A NOTICE OF COMMENCEMENT MAY RESULT IN YOUR PAYING TWICE FOR IMPROVEMENTS TO YOUR PROPERTY. IF YOU INTEND TO OBTAIN FINANCING, CONSULT WITH YOUR LENDER OR AN ATTORNEY BEFORE RECORDING YOUR NOTICE OF COMMENCEMENT."

This Permit Must Be Prominently Posted on Premises During Construction

PLEASE NOTIFY THE COLUMBIA COUNTY BUILDING DEPARTMENT AT LEAST 24 HOURS IN ADVANCE OF EACH INSPECTION, IN ORDER THAT IT MAY BE MADE WITHOUT DELAY OR INCONVENIENCE, PHONE 758-1008. THIS PERMIT IS NOT VALID UNLESS THE WORK AUTHORIZED BY IT IS COMMENCED WITHIN 6 MONTHS AFTER ISSUANCE.

The Issuance of this Permit Does Not Waive Compliance by Permittee with Deed Restrictions.

21695

Columbia County Building Permit Application 3/19/04 0403-32 GT

Application Approved by - Zoning Official BLK Date 05.04.04 Plans Examiner RJ Date _____
 Flood Zone X Development Permit N/A Zoning A-3 Land Use Plan Map Category A-3
 Comments _____

Applicants Name Huey R. Hawkins Phone (386) 497-3991
 Address 6855 SW Elm Church Rd.
 Owners Name Elm Baptist Church Phone _____
 911 Address 3435 SW Elm Church Rd.
 Contractors Name Mike Herlong Phone 497-1162
 Address SW Herlong Rd, Ft. White, Fla 32038
 Fee Simple Owner Name & Address Elm Baptist Church Rd.
 Bonding Co. Name & Address _____
 Architect/Engineer Name & Address Huey R. Hawkins, 6855 SW Elm Church Rd.
 Mortgage Lenders Name & Address None
 Property ID Number 22-65-16-03918 Estimated Cost of Construction \$150,000
 Subdivision Name Individual Parcel Lot _____ Block _____ Unit _____ Phase _____
 Driving Directions 1 mile east of SR47 on SW Elm Church Rd.

Type of Construction Church Fellowship Hall Number of Existing Dwellings on Property 2
 Total Acreage _____ Lot Size _____ Do you need a - Culvert Permit or Culvert Waiver or Have an Existing Drive
 Actual Distance of Structure from Property Lines - Front 600' Side 150' Side 150' Rear 80'
 Total Building Height 12' Number of Stories 1 Heated Floor Area 5,000 Roof Pitch 5/12

Application is hereby made to obtain a permit to do work and installations as indicated. I certify that no work or installation has commenced prior to the issuance of a permit and that all work be performed to meet the standards of all laws regulating construction in this jurisdiction.

OWNERS AFFIDAVIT: I hereby certify that all the foregoing information is accurate and all work will be done in compliance with all applicable laws and regulating construction and zoning.

WARNING TO OWNER: YOUR FAILURE TO RECORD A NOTICE OF COMMENCEMENT MAY RESULT IN YOU PAYING TWICE FOR IMPROVEMENTS TO YOUR PROPERTY. IF YOU INTEND TO OBTAIN FINANCING, CONSULT WITH YOUR LENDER OR ATTORNEY BEFORE RECORDING YOUR NOTICE OF COMMENCEMENT.

[Signature]
 Owner/Builder or Agent (Including Contractor)

STATE OF FLORIDA
 COUNTY OF COLUMBIA

Sworn to (or affirmed) and subscribed before me
 this 10 day of MARCH 20 04.
 Personally known ✓ or Produced Identification _____

[Signature]
 Contractor Signature
 Contractors License Number AC 0102956
 Competency Card Number _____

NOTARY [Signature]
 DALE R. BURD
 Commission # DD0134600
 Expires 7/18/2006
 Bonded through
 (800) 432-1261 Florida Notary Assn., Inc.
 Notary Signature

NOTICE OF COMMENCEMENT FORM

COLUMBI Inst: 2004005348 Date: 03/10/2004 Time: 08:42

DC, P. DeWitt Cason, Columbia County B: 1003 F: 737

THE UNDERSIGNED hereby gives notice that improve
with Chapter 713, Florida Statutes, the following infor

Tax Parcel ID Number 22-65-16-03198-000

1. Description of property: (legal description of the property and street address or 911 address)
3435 S.W. Elim Church Rd.
18 acres in the SE 1/4 of Section 22 and the NE 1/4 of
Section 27, all in Township 6 South, Range 16 East.
2. General description of improvement: Church Fellowship Hall
3. Owner Name & Address Elim Baptist Church
3435 SW Elim Church Rd Interest in Property 100%
4. Name & Address of Fee Simple Owner (if other than owner): Same
5. Contractor Name Mike Herlong Phone Number 497-1162
Address SW Herlong Rd., Fort White, Fla 32038
6. Surety Holders Name None Phone Number _____
Address _____
Amount of Bond _____
7. Lender Name None Phone Number _____
Address _____
8. Persons within the State of Florida designated by the Owner upon whom notices or other documents may be served as provided by section 718.13 (1)(a) 7; Florida Statutes:
Name Huey R. Hawkins Phone Number (386) 497-3991
Address 6855 SW Elim Church Rd.
9. In addition to himself/herself the owner designates Huey R. Hawkins, ~~6855 SW Elim Church Rd.~~ of 6855 SW Elim Church Rd. to receive a copy of the Lienor's Notice as provided in Section 713.13 (1) -
(a) 7. Phone Number of the designee (386) 497-3991
10. Expiration date of the Notice of Commencement (the expiration date is 1 (one) year from the date of recording, (Unless a different date is specified) March 9, 2005

NOTICE AS PER CHAPTER 713, Florida Statutes:

The owner must sign the notice of commencement and no one else may be permitted to sign in his/her stead.

Gary J. MacManus, Trustee
Signature of Owner

Sworn to (or affirmed) and subscribed before
day of March 8, 2004

NOTARY STAMP/SEAL

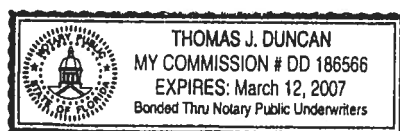

Thomas J. Duncan
Signature of Notary



**SUWANNEE
RIVER
WATER
MANAGEMENT
DISTRICT**

9225 CR 49
LIVE OAK, FLORIDA 32060
TELEPHONE: (386) 362-1001
TELEPHONE: 800-226-1088
FAX (386) 362-1058

NOTICED GENERAL PERMIT

PERMITTEE:

ELIM BAPTIST CHURCH
3435 SOUTHWEST ELIM CHURCH ROAD
FORT WHITE, FL 32038

PERMIT NUMBER: ERP96-0095M

DATE ISSUED: 02/11/2004

DATE EXPIRES: 02/11/2006

COUNTY: COLUMBIA

TRS: S22/T6S/R16E

PROJECT: ELIM BAPTIST CHURCH MODIFICATION

Approved entity to whom operation and maintenance may be transferred pursuant to rule 40B-4.1130,
Florida Administrative Code (F.A.C.):

ELIM BAPTIST CHURCH
3435 SOUTHWEST ELIM CHURCH ROAD
FORT WHITE, FL 32038

Post-it* Fax Note	7671	Date	2/19/04	# of pages	▶
To	Huey Hawkins	From	Teroy Marshall		
Co./Dept.		Co.	SRWMD		
Phone #		Phone #			
Fax #	386-755-6167	Fax #			

Based on information provided, the Suwannee River Water Management District's (District) rules have been adhered to and an environmental resource noticed general permit is in effect for the permitted activity description below:

Construction and operation of a surfacewater management system serving 5,000 square feet of impervious surface on a total project area of 18 acres in a manner consistent with the application package submitted by Elim Baptist Church on January 27, 2004.

It is your responsibility to insure that adverse off-site impacts do not occur either during or after construction. Any additional construction or alterations not authorized by this permit may result in flood control or water quality problems both on and off site and will be a violation of District rule.

You or any other substantially affected persons are entitled to request an administrative hearing pursuant to ss.120.57(1), Florida Statutes (F.S.), and s.40B-1.511, F.A.C., if they object to the District's actions. Failure to request a hearing within 14 days will constitute a waiver of your right to request such a hearing. In addition, the District will presume that permittee waives Chapter 120, F.S., rights to object or appeal the action upon commencement of construction authorized by the permit.

Permit No.: ERP96-0095M

Project: ELM BAPTIST CHURCH MODIFICATION

Page 2 of 4

This permit is issued under the provisions of chapter 373, F.S., chapter 40B-4, and chapter 40B-400, F.A.C. A noticed general permit authorizes the construction, operation, maintenance, alteration, abandonment, or removal of certain minor surface water management systems. This permit authorizes the permittee to perform the work necessary to construct, operate, and maintain the surface water management system shown on the application and other documents included in the application. This is to notify you of District's agency action concerning Notice Of Intent. This action is taken pursuant to rule 40B-4 and 40B-400, F.A.C.

General Conditions for All Noticed General Permits:

1. The terms, conditions, requirements, limitations, and restrictions set forth in this section are general permit conditions and are binding upon the permittee for all noticed general permits in Part II of this chapter. These conditions are enforceable under Part IV of chapter 373, F.S.
2. The general permit is valid only for the specific activity indicated. Any deviation from the specified activity and the conditions for undertaking that activity shall constitute a violation of the permit. A violation of the permit is a violation of Part IV of chapter 373, F.S., and may result in suspension or revocation of the permittee's right to conduct such activity under the general permit. The District may also begin legal proceedings seeking penalties or other remedies as provided by law for any violation of these conditions.
3. This general permit does not eliminate the necessity to obtain any required federal, state, local and special District authorizations prior to the start of any construction, alteration, operation, maintenance, removal or abandonment authorized by this permit.
4. This general permit does not convey to the permittee or create in the permittee any property right, or any interest in real property, nor does it authorize any entrance upon or activities on property which is not owned or controlled by the permittee, or convey any rights or privileges other than those specified in the general permit and Part II of this chapter.
5. This general permit does not relieve the permittee from liability and penalties when the permitted activity causes harm or injury to human health or welfare, animal, plant or aquatic life, or property. It does not allow the permittee to cause pollution in contravention of Florida Statutes and District rules.
6. The permittee is hereby advised that s.253.77, F.S., states that a person may not commence any excavation, construction or other activity involving the use of sovereign or other lands of the state, the title to which is vested in the Board of Trustees of the Internal Improvement Trust Fund without obtaining the required lease, license, easement, or other form of consent authorizing the proposed use. Therefore, the permittee is responsible for obtaining any necessary authorizations from the

Permit No.: ERP96-0095M

Project: ELIM BAPTIST CHURCH MODIFICATION

Page 3 of 4

Board of Trustees prior to commencing activity on sovereignty lands or other state-owned lands.

7. The authorization to conduct activities pursuant to general permit may be modified, suspended or revoked in accordance with chapter 120, and s.373.429, F.S.

8. This permit shall not be transferred to a third party except pursuant to s.40B-4.1130, F.A.C. The permittee transferring the general permit shall remain liable for any corrective actions that may be required as a result of any permit violations prior to sale, conveyance, or other transfer of ownership or control of the permitted system or the real property at which the permitted system is located.

9. Upon reasonable notice to the permittee, District staff with proper identification shall have permission to enter, inspect, sample and test the permitted system to insure conformity with the plans and specifications approved by the permit.

10. The permittee shall maintain any permitted system in accordance with the plans submitted to the District and authorized by this general permit.

11. A permittee's right to conduct a specific noticed activity under this noticed general permit is authorized for a duration of two years.

12. Construction, alteration, operation, maintenance, removal and abandonment approved by this general permit shall be conducted in a manner which does not cause violations of state water quality standards, including any antidegradation provisions of s.62-4.242(1)(a) and (b), 62-4.242(2) and (3), and 62-302.300, F.A.C., and any special standards for Outstanding Florida Waters and Outstanding National Resource Waters. The permittee shall implement best management practices for erosion, turbidity and other pollution control to prevent violation of state water quality standards.

Temporary erosion control measures such as sodding, mulching, and seeding shall be implemented and shall be maintained on all erodible ground areas prior to and during construction. Permanent erosion control measures such as sodding and planting of wetland species shall be completed within seven days of any construction activity. Turbidity barriers shall be installed and maintained at all locations where the possibility of transferring suspended solids into wetlands or other surface waters exists due to the permitted activity. Turbidity barriers shall remain in place and shall be maintained in a functional condition at all locations until construction is completed and soils are stabilized and vegetation has been established. Thereafter the permittee shall be responsible for the removal of the barriers. The permittee shall correct any erosion or shoaling that causes adverse impacts to the water resources.

13. The permittee shall hold and save the District harmless from any and all damages, claims or liabilities which may arise by reason of the construction, alteration, operation, maintenance, removal, abandonment or use of any system authorized by the general permit.

Permit No.: ERP96-0095M

Project: ELIM BAPTIST CHURCH MODIFICATION

Page 4 of 4

14. The permittee shall immediately notify the District in writing of any previously submitted information that is later discovered to be inaccurate.

15. The permittee shall perform all construction authorized in a manner so as to minimize adverse impacts to fish, wildlife, natural environmental values, and water quality. The permittee shall institute necessary measures during construction including riprap, reinforcement, or compaction of any fill materials placed around newly installed structures, to minimize erosion, turbidity, nutrient loading, and sedimentation in the receiving waters.

16. The permit is issued based on the information submitted by the applicant which reasonably demonstrates that adverse off-site water resource impacts will not be caused by the permitted activity. It is the responsibility of the permittee to insure that such adverse impacts do not in fact occur either during or after construction.

WITHIN 30 DAYS AFTER COMPLETION OF THE PROJECT, THE PERMITTEE SHALL NOTIFY THE DISTRICT, IN WRITING, THAT THE FACILITIES ARE COMPLETE.

Approved by Emilie Belf Date Approved 2-11-04
District Staff

CAM112M01 S .CamaUSA Appraisal System
 3/10/2004 8:53 Legal Description Maintenance
 Year T Property Sel
 2004 R 22-6S-16-03918-000

Columbia County
 28600 Land 001
 AG 000
 Bldg 000
 Xfea 000

--
ELIM BAPTIST CHURCH

28600 TOTAL B

1	5 AC IN SW COR OF SE1/4 OF	SE1/4 & 6 AC LYING S OF	2
3	BELLAMY RD IN E1/2 OF E1/2 OF	SW1/4 OF SE1/4.	4
5			6
7			8
9			10
11			12
13			14
15			16
17			18
19			20
21			22
23			24
25			26
27			28

Mnt 3/04/1996 TERR

F1=Task F3=Exit F4=Prompt F10=GoTo PGUP/PGDN F24=MoreKeys

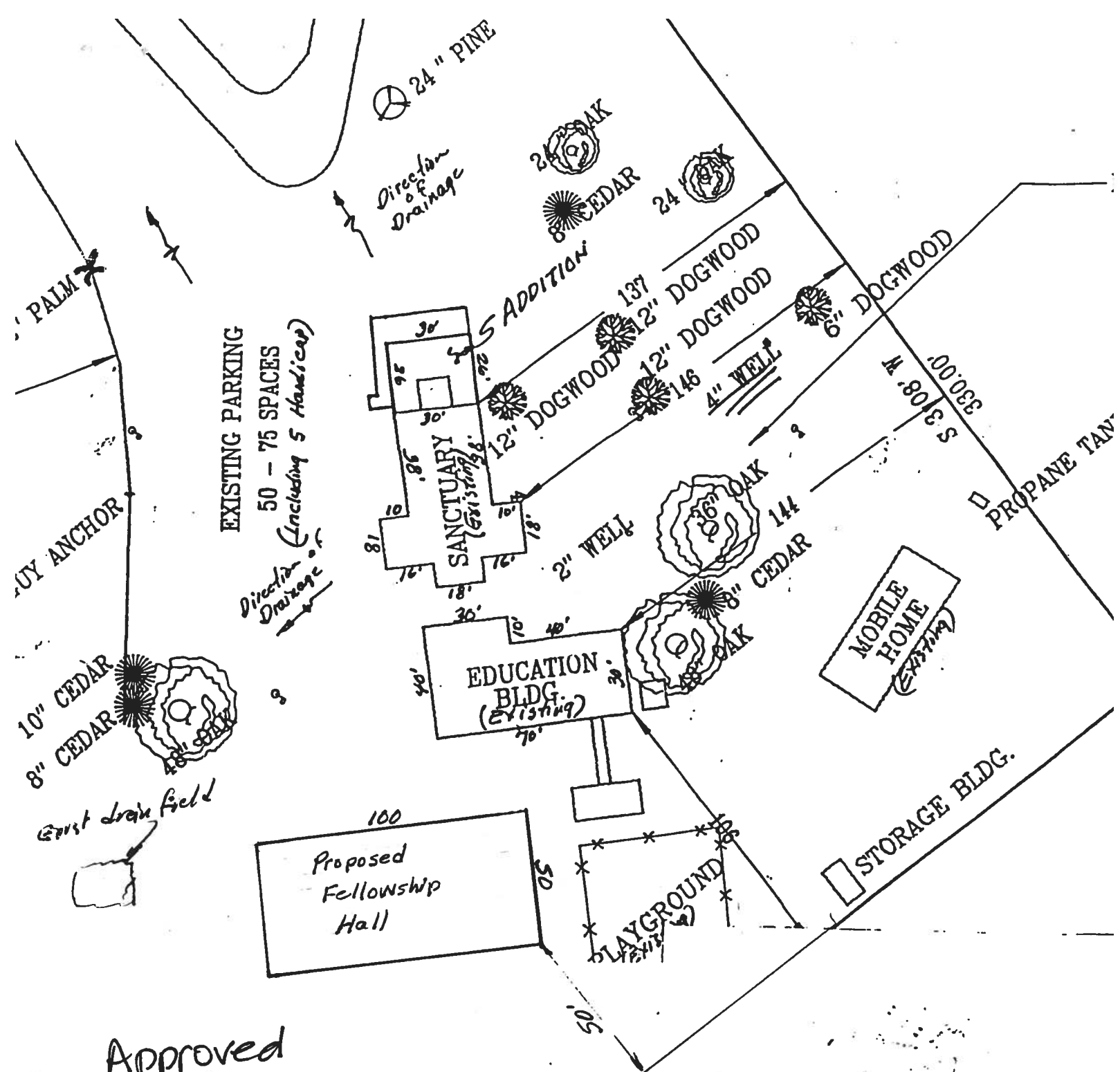

Approved
Salbi Graddy 1.20.04

Commence at the Southwest corner of the SE 1/4 of the SE 1/4, Section 22, Township 6 South, Range 16 East and run thence N 88 50 W along the South line of said Section 22, 363.0 feet for a POINT OF BEGINNING thence run N 3 08 E, 930.60 feet to Bellamy Road, thence run S 49 52 E along said Bellamy Road, 1,478.62 feet to the intersection of said South line of Section 22, thence run N 88 50 W along said South line of Section 22, 494.0 feet, thence run S 3 08 W, 330 feet, thence run N 88 50 W, parallel to said South line of Section 22, 687.89 feet, thence N 3 08 E, 330.0 feet to the POINT OF BEGINNING. Said lands being a part of the SE 1/4 of Section 22, and the NE 1/4 of Section 27, all in Township 6 South, Range 16 East and containing 18.0 Acres, more or less.



STATE OF FLORIDA
DEPARTMENT OF HEALTH

APPLICATION FOR ONSITE SEWAGE DISPOSAL SYSTEM CONSTRUCTION PERMIT

Permit Application Number 04-0058N

----- PART II - SITE PLAN -----

Scale: Each block represents 5 feet and 1 inch = 50 feet.

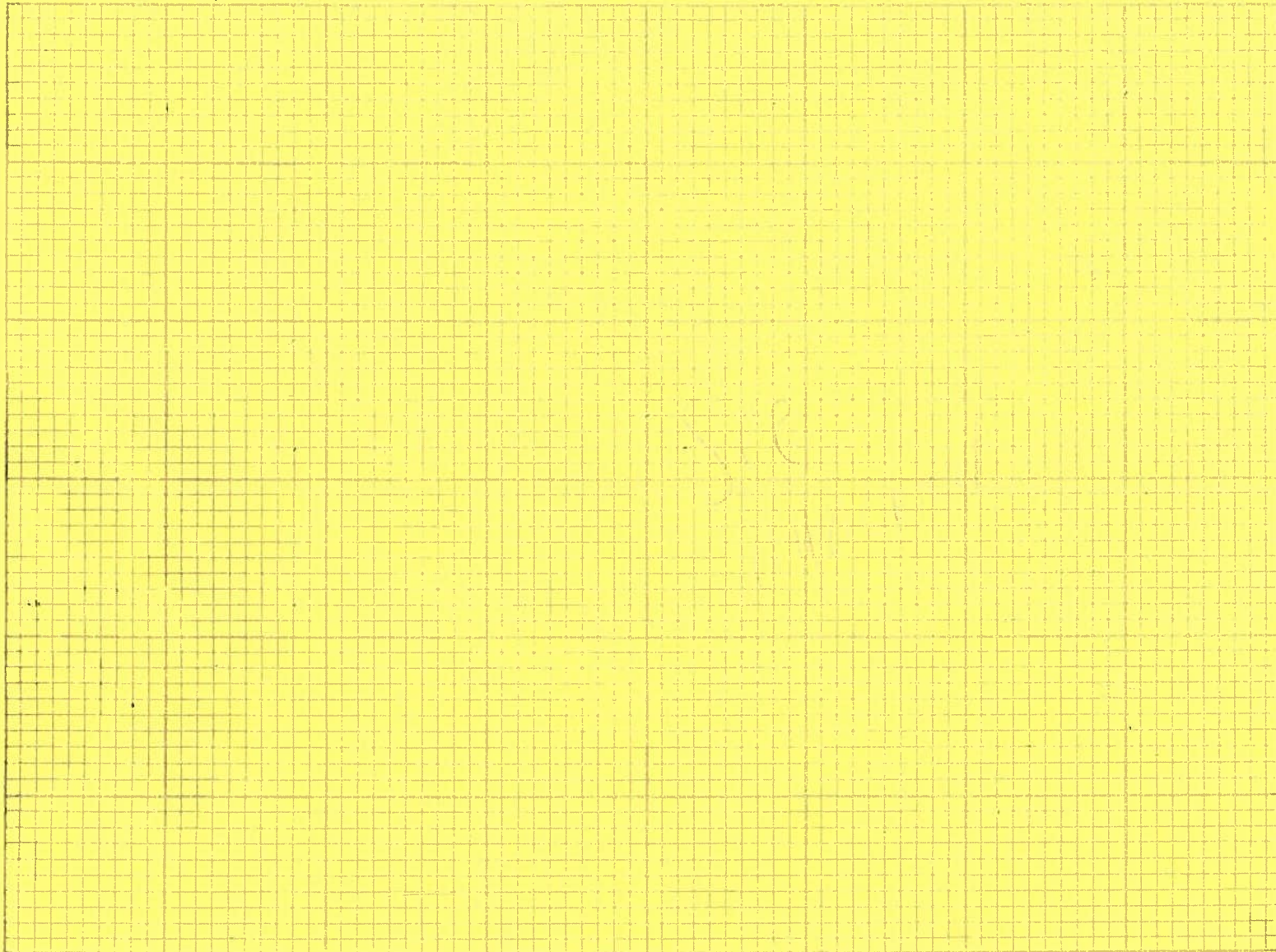

Notes: _____

Site Plan submitted by X [Signature] _____ Title _____

Plan Approved ✓ _____ Not Approved _____ Date _____

By _____ County Health Department

ALL CHANGES MUST BE APPROVED BY THE COUNTY HEALTH DEPARTMENT

0403-32



APPROXIMATE SCALE IN FEET



NATIONAL FLOOD INSURANCE PROGRAM

FIRM
FLOOD INSURANCE RATE MAP

COLUMBIA
COUNTY,
FLORIDA
(UNINCORPORATED AREAS)

PANEL 225 OF 290

PANEL LOCATION

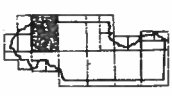

COMMUNITY-PANEL NUMBER
120070 0225 B

EFFECTIVE DATE:
JANUARY 6, 1988



Federal Emergency Management Agency

This is an official copy of a portion of the above referenced flood map. It was extracted using F-MIT Version 1.0. This map does not reflect changes or amendments which may have been made subsequent to the date on the title block. Further information about National Flood Insurance Program flood hazard maps is available at www.fema.gov/nifis4.

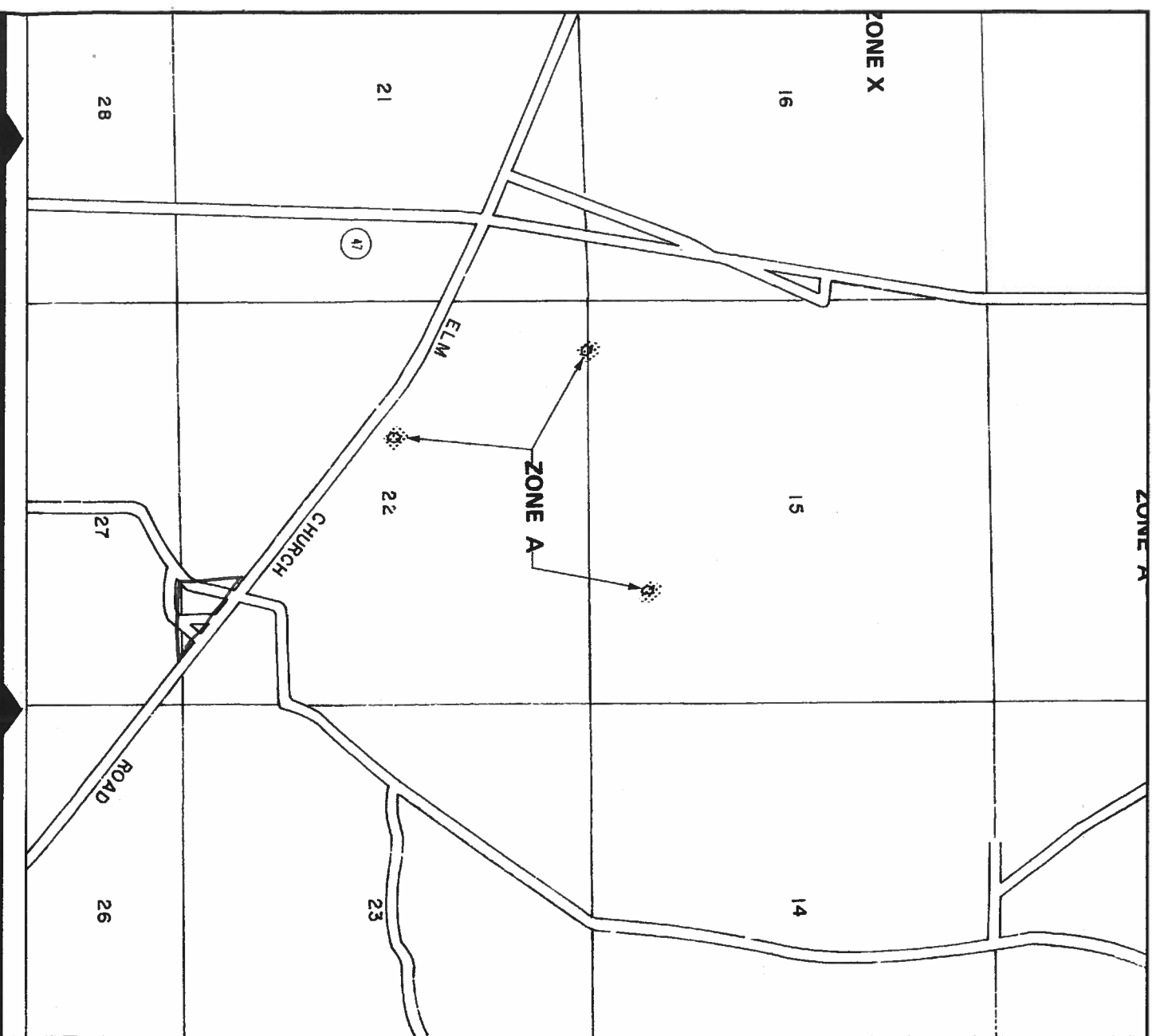

ENERGY EFFICIENCY CODE FOR BUILDING CONSTRUCTION

Florida Department of Community Affairs

EnergyGauge FlaCom v1.22 FORM 400A-2001

Whole Building Performance Method for Commercial Buildings

Jurisdiction: COLUMBIA COUNTY, COLUMBIA COUNTY, FL (221000)

Short Desc: 401201

Project: Elim Baptist Church Fellowship Hall

Owner:

Address:

CR 238

City: Fort White

State: FL

Zip: 0

Type: Assembly

Class: New Finished building

PermitNo: 0 21695

Storeys: 1

GrossArea: 5000

Net Area: 5000

Max Tonnage: 14 (if different, write in)

Compliance Summary

Component	Design	Criteria	Result
Gross Energy Use	89.83	100.00	PASSES
Other Envelope Requirements - A			PASSES
LIGHTING CONTROLS			PASSES
EXTERNAL LIGHTING			PASSES
HVAC SYSTEM			PASSES
PLANT			PASSES
WATER HEATING SYSTEMS			PASSES
PIPING SYSTEMS			PASSES
Met all required compliance from Check List?			Yes/No/NA

IMPORTANT NOTE: An input report Print-Out from EnergyGauge FlaCom of this design building must be submitted along with this Compliance Report.

COMPLIANCE CERTIFICATION:

<p>I hereby certify that the plans and specifications covered by this calculation are in compliance with the Florida Energy Efficiency Code.</p> <p><i>Mark Disosway</i></p> <p>PREPARED BY: <u>Mark Disosway P.E.</u></p> <p>DATE: <u>21 JAN 04</u></p> <p>I hereby certify that this building is in compliance with the Florida Energy Efficiency Code.</p> <p>OWNER AGENT: _____</p> <p>DATE: _____</p>	<p>Review of the plans and specifications covered by this calculation indicates compliance with the Florida Energy Code. Before construction is completed, this building will be inspected for compliance in accordance with Section 553.908, F.S.</p> <p>BUILDING OFFICIAL: _____</p> <p>DATE: _____</p>
<p>If required by Florida law, I hereby certify (*) that the system design is in compliance with the Florida Energy Code.</p> <p>ARCHITECT : _____</p> <p>ELECTRICAL SYSTEM DESIGNER: _____</p> <p>LIGHTING SYSTEM DESIGNER: _____</p> <p>MECHANICAL SYSTEM DESIGNER: _____</p> <p>PLUMBING SYSTEM DESIGNER: _____</p>	

(*) Signature is required where Florida Law requires design to be performed by registered design professionals.
Typed names and registration numbers may be used where all relevant information is contained on signed/sealed plans.

Project: 401201
 Title: Elim Baptist Church Fellowship Hall
 Type: Assembly
 Location: COLUMBIA COUNTY, COLUMBIA COUNTY, FL (221000)
 (WEA File: JACKS

Whole Building Compliance

	Design	Reference
Total	89.83	100.00
ELECTRICITY	89.83	100.00
AREA LIGHTS	19.39	22.66
MISC EQUIPMT	2.05	2.05
SPACE COOL	20.20	26.88
SPACE HEAT	5.83	6.05
VENT FANS	42.36	42.36
Credits & Penalties (if any): Modified Points: = 89.84		
PASSES		

Project: 401201
 Title: Elim Baptist Church Fellowship Hall
 Type: Assembly
 Location: COLUMBIA COUNTY, COLUMBIA COUNTY, FL (221000)
 (WEA File: JACKS

Other Envelope Requirements

Item	Zone	Description	Design	Limit	Meet Req.
Pr0Zo1Rf1	Hall	Exterior Roof - Max Uo Limit	0.03	0.09	Yes
Meets Other Envelope Requirements					

Project: 401201
Title: Elim Baptist Church Fellowship Hall
Type: Assembly
Location: COLUMBIA COUNTY, COLUMBIA COUNTY,
 FL (221000)
(WEA File: JACKS

External Lighting Compliance

Description	Category	Allowance (W/Unit)	Area or Length or No. of Units (Sqft or ft)	ELPA (W)	CLP (W)
Ext Light 1	Exit (with or without Canopy)	25.00	3.0	75	60
Ext Light 2	Exit (with or without Canopy)	25.00	3.0	75	60
Ext Light 3	Exit (with or without Canopy)	25.00	6.0	150	60
Ext Light 4	Entrance (w/ Canopy) Light traffic-hospital, office, school etc	4.00	160.0	640	120

Design: 300 (W)

Allowance: 940 (W)

PASSES

Project: 401201
Title: Elim Baptist Church Fellowship Hall
Type: Assembly
Location: COLUMBIA COUNTY, COLUMBIA COUNTY, FL (221000)
(WEA File: JACKS

Lighting Controls Compliance

Acronym	Ashrae ID	Description	Area (sq.ft)	No. of Tasks	Design CP	Min CP	Compli- ance
Common	7	Food Service - Leisure Dining	3,230	1	7	4	PASSES
Kitchen	9	Food Service - Kitchen	455	0	1	1	PASSES
Lobby	21	Lobby (General) - Reception and Waiting	312	1	2	2	PASSES
Bath	13	Toilet and Washroom	498	1	2	2	PASSES
Hall	2	Corridor	76	1	2	2	PASSES
Stor/Mech	4	Electrical Mechanical Equipment Room - General	428	1	2	2	PASSES

PASSES

Project: 401201
 Title: Elim Baptist Church Fellowship Hall
 Type: Assembly
 Location: COLUMBIA COUNTY, COLUMBIA COUNTY, FL (221000)
 (WEA File: JACKS

System Report Compliance

Pr0Sy1	System 1	Constant Volume Packaged System					No. of Units
							1
Component	Category	Capacity	Design Eff	Eff Criteria	Design IPLV	IPLV Criteria	Compliance
Cooling System	Air Cooled 135000 to 760000 Btu/h Cooling Capacity		10.00	8.50	8.00	7.50	PASSES
Heating System	Air Cooled HP > 135000 Btu/h Cooling Capacity		3.00	2.90			PASSES
Air Handling System - Supply	Air Handler (Supply) - Constant Volume		0.80	0.80			PASSES
Air Handling System - Return	Air Handler (Return) - Constant Volume		0.80	0.80			PASSES
Air Distribution System	ADS System		6.00	6.00			PASSES
							PASSES

Plant Compliance

Description	Installed No	Size	Design Eff	Min Eff	Design IPLV	Min IPLV	Category	Compliance
								None

Project: 401201
 Title: Elim Baptist Church Fellowship Hall
 Type: Assembly
 Location: COLUMBIA COUNTY, COLUMBIA COUNTY, FL (221000)
 (WEA File: JACKS

Water Heater Compliance

Description	Type	Category	Design Eff	Min Eff	Design Loss	Max Loss	Compliance
Water Heater 1	Storage Water Heater - Gas	< 100 Gal & <= 75000 [Btu/h]	0.55	0.54			PASSES
							PASSES

Project: 401201
Title: Elim Baptist Church Fellowship Hall
Type: Assembly
Location: COLUMBIA COUN

Piping System Compliance

Category	Pipe Dia [inches]	Is Runout?	Operating Temp [F]	Ins Cond [Btu-in/hr .SF.F]	Ins Thick [in]	Req Ins Thick [in]	Compliance
Heating System (Steam, Steam Condensate, & Hot Water)	0.75	True	105.00	0.28	0.64	0.63	PASSES

PASSES

Project: 401201
Title: Elim Baptist Church Fellowship Hall
Type: Assembly
Location: COLUMBIA COUN

Other Required Compliance

Category	Section	Requirement (write N/A in box if not applicable)	Check
Infiltration	406.1	Infiltration Criteria have been met	<input type="checkbox"/>
System	407.1	HVAC Load sizing has been performed	<input type="checkbox"/>
Ventilation	409.1	Ventilation criteria have been met	<input type="checkbox"/>
ADS	410.1	Duct sizing and Design have been performed	<input type="checkbox"/>
T & B	410.1	Testing and Balancing will be performed	<input type="checkbox"/>
Electrical	413.1	Metering criteria have been met	<input type="checkbox"/>
Motors	414.1	Motor efficiency criteria have been met	<input type="checkbox"/>
Lighting	415.1	Lighting criteria have been met	<input type="checkbox"/>
O & M	102.1	Operation/maintenance manual will be provided to owner	<input type="checkbox"/>
Roof/Ceil	404.1	R-19 for Roof Deck with supply plenums beneath it	<input type="checkbox"/>
Report	101	Input Report Print-Out from EnergyGauge FlaCom attached?	<input type="checkbox"/>

ENERGY EFFICIENCY CODE FOR BUILDING CONSTRUCTION

Florida Department of Community Affairs

EnergyGauge FlaCom v1.22

INPUT DATA REPORT**Project Information****Project Name:** 401201**Orientation:** NorthEast**Project Title:** Elim Baptist Church Fellowship Hall**Building Type:** Assembly**Address:** CR 238**Building Classification:** New Finished building**State:** FL**No. of Storeys:** 1**Zip:** 0**GrossArea:** 5000**Owner:****Zones**

No	Acronym	Description	Type	Load Profile	Area [sf]	Multiplier	Total Area [sf]	
1	Hall	Fellowship Hall	CONDITIONED	FlaCom Assembly	5000.1	1	5000.1	<input type="checkbox"/>

Spaces

No	Acronym	Description	Type	Depth [ft]	Width [ft]	Height [ft]	Multi plier	Total Area [sf]	Total Volume [cf]
----	---------	-------------	------	---------------	---------------	----------------	----------------	--------------------	----------------------

1/20/2004

EnergyGauge FlaCom FLCCSB v1.22

1

In Zone: Hall										
1	Common	Common	Food Service - Leisure Dining	50.00	64.60	10.00	1	3230.0	32300.0	<input type="checkbox"/>
2	Kitchen	Kitchen	Food Service - Kitchen	20.17	22.58	10.00	1	455.4	4554.2	<input type="checkbox"/>
3	Lobby	Bathroom Lobby	Lobby (General) - Reception and Waiting	13.83	22.58	10.00	1	312.4	3123.9	<input type="checkbox"/>
4	Bath	M+W Restrooms	Toilet and Washroom	16.00	31.10	11.00	1	497.6	5473.6	<input type="checkbox"/>
5	Hall	Hall	Corridor	16.60	4.60	10.00	1	76.4	763.6	<input type="checkbox"/>
6	Stor/Mech	storage /mechanical	Electrical Mechanical Equipment Room - General	33.20	12.90	11.00	1	428.3	4711.1	<input type="checkbox"/>

Lighting

No	Type	Power [W]	Control Type	No. of Ctrl pts	
In Zone: Hall					
In Space: Common					
1	Suspended Fluorescent	5600.00	Manual On/Off	7	<input type="checkbox"/>
In Space: Kitchen					
1	Suspended Fluorescent	960.00	Manual On/Off	1	<input type="checkbox"/>
In Space: Lobby					
1	Suspended Fluorescent	480.00	Manual On/Off	2	<input type="checkbox"/>
In Space: Bath					
1	Suspended Fluorescent	640.00	Manual On/Off	2	<input type="checkbox"/>
In Space: Hall					
1	Incandescent	60.00	Manual On/Off	2	<input type="checkbox"/>
In Space: Stor/Mech					
1	Suspended Fluorescent	640.00	Manual On/Off	2	<input type="checkbox"/>

1/20/2004

EnergyGauge FlaCom FLCCSB v1.22

2

Walls												
No	Description	Type	Width [ft]	H (Effec) [ft]	Multi plier	Area [sf]	Direction	Conductance [Btu/hr. sf. F]	Heat Capacity [Btu/sf.F]	Dens. [lb/cf]	R-Value [h.s.f.F/Btu]	
In Zone: Hall												
1	Front	Siding/.5in Sheathing/R-19 Batt/.5in GYP	100.00	10.00	1	1000.0	NorthEast	0.0473	1.8974	14.65	21.15	<input type="checkbox"/>
2	right	Siding/.5in Sheathing/R-19 Batt/.5in GYP	50.00	11.00	1	550.0	SouthEast	0.0473	1.8974	14.65	21.15	<input type="checkbox"/>
3	Left	Siding/.5in Sheathing/R-19 Batt/.5in GYP	50.00	11.00	1	550.0	North	0.0473	1.8974	14.65	21.15	<input type="checkbox"/>
4	SW Rear	Siding/.5in Sheathing/R-19 Batt/.5in GYP	100.00	10.00	1	1000.0	SouthWest	0.0473	1.8974	14.65	21.15	<input type="checkbox"/>

Windows												
No	Description	Type	Shaded	UCen [Btu/hr sf F]	SC	Vis.Tr	W [ft]	H (Effec) [ft]	Multi plier	Total Area [sf]		
In Zone: Hall												
In Wall: NE Front												
1	3050	SINGLE CLEAR	Yes	1.0018	0.95	0.88	3.00	5.00	2	30.0		<input type="checkbox"/>
In Wall: NW Right												
1	3050	SINGLE CLEAR	No	1.0018	0.95	0.88	3.00	5.00	2	30.0		<input type="checkbox"/>
In Wall: SW Rear												
1	3050	SINGLE CLEAR	Yes	1.0018	0.95	0.88	3.00	5.00	2	30.0		<input type="checkbox"/>
2	3030	SINGLE CLEAR	Yes	1.0018	0.95	0.88	3.00	3.00	1	9.0		<input type="checkbox"/>

Doors												
No	Description	Type	Shaded?	Width [ft]	H (Effec) [ft]	Multi plier	Area [sf]	Cond. [Btu/hr. sf. F]	Dens. [lb/cf]	Heat Cap. [Btu/sf. F]	R-Value [h.s.f.F/Btu]	

1/20/2004

EnergyGauge FlaCom FLCCSB v1.22

3

In Zone: Hall												
In Wall: NE Front												
1	3070	Aluminum door, 1.25 in. polystyrene	Yes	3.00	7.00	2	21.0	0.1919	43.67	0.53	5.21	<input type="checkbox"/>
2	3070	Aluminum door, 1.25 in. polystyrene	Yes	3.00	7.00	1	21.0	0.1919	43.67	0.53	5.21	<input type="checkbox"/>
In Wall: NW Right												
1	3070	Aluminum door, 1.25 in. polystyrene	No	3.00	7.00	1	21.0	0.1919	43.67	0.53	5.21	<input type="checkbox"/>
In Wall: SE Left												
1	3070	Aluminum door, 1.25 in. polystyrene	No	3.00	7.00	1	21.0	0.1919	43.67	0.53	5.21	<input type="checkbox"/>

Roofs												
No	Description	Type	Width [ft]	H (Effec) [ft]	Multi plier	Area [sf]	Tilt [deg]	Cond. [Btu/hr. Sf. F]	Heat Cap [Btu/sf. F]	Dens. [lb/cf]	R-Value [h.s.f.F/Btu]	
In Zone: Hall												
1	Pr0Zo1Rf	Shngl/1/2"WD Deck/WD Truss/9" Batt/Gyp Brd	100.00	50.00	1	5000.0	0.00	0.0320	1.50	8.22	31.24	<input type="checkbox"/>

Skylights												
No	Description	Type	UCen [Btu/hr sf F]	Shading Coeff	Vis.Trans	W [ft]	H (Effec) [ft]	Multiplier	Area [Sf]	Total Area [Sf]		
In Zone: In Roof:												
												<input type="checkbox"/>

1/20/2004

EnergyGauge FlaCom FLCCSB v1.22

4

Floors										
No	Description	Type	Width [ft]	H (Effec [ft]	Multi plier	Area [sf]	Cond. [Btu/hr. sf. F]	Heat Cap. [Btu/sf. F]	Dens. [lb/cf]	R-Value [h.sf.F/Btu]
In Zone: 1	Hall Pr0Zo1Fl1	1 ft. soil, concrete floor, Vinyl	100.00	50.00	1	5000.0	0.2000	54.00	108.00	5.00

Systems										
Pr0Sy1	System 1	Constant Volume Packaged System							No. Of Units	1
Component	Category	Capacity	Efficiency	IPLV						
1	Cooling System (Air Cooled 135000 to 760000 Btu/h Cooling Capacity)	172439.00	10.00	8.00						<input type="checkbox"/>
2	Heating System (Air Cooled HP > 135000 Btu/h Cooling Capacity)	48524.00	3.00							<input type="checkbox"/>
3	Air Handling System -Supply (Air Handler (Supply) - Constant Volume)	4800.00	0.80							<input type="checkbox"/>
4	Air Handling System - Return (Air Handler (Return) - Constant Volume)	4800.00	0.80							<input type="checkbox"/>
5	Air Distribution System (ADS System)		6.00							<input type="checkbox"/>

Plant					
Equipment	Category	Size	Inst.No	Eff.	IPLV

Water Heaters				
W-Heater Description	Capacit Cap.Unit	I/P Rt.	Efficienc	Loss
1 Storage Water Heater - Gas	40 Gal	40000 [Btu/h]	0.5500 [EF]	[% /hr]

1/20/2004

EnergyGauge FlaCom FLCCSB v1.22

5

Ext-Lighting				
Description	Categories.	Area/Len/No. of units [sf/ft/No]	Wattage [W]	
1 Ext Light 1	Exit (with or without Canopy)	3.00	60.00	<input type="checkbox"/>
2 Ext Light 2	Exit (with or without Canopy)	3.00	60.00	<input type="checkbox"/>
3 Ext Light 3	Exit (with or without Canopy)	6.00	60.00	<input type="checkbox"/>
4 Ext Light 4	Entrance (w/ Canopy) Light traffic-hospital, office, school etc	160.00	120.00	<input type="checkbox"/>

Piping						
No	Type	Operating Temperature [F]	Insulation Conductivity [Btu-in/h.sf.F]	Nomonal pipe Diameter [in]	Insulation Thickness [in]	Is Runout?
1	Heating System (Steam, Steam Condensate, & Hot Wat	105.00	0.28	0.75	0.64	Yes <input type="checkbox"/>

Fenestration Used							
Name	Glass Type	No. of Panels	Glass Conductance [Btu/h.sf.F]	SC	VLT	Frame Conductance [Btu/h.sf.F]	Frame Absorptance
ApLbWnd1	SINGLE CLEAR	1	1.0018	0.9500	0.8810	0.4340	0.7000

Materials Used							
Mat No	Acronym	Description	Only R-Value Used	RValue [h.sf.F/Btu]	Thickness [ft]	Conductivity [Btu/h.ft.F]	Density [lb/cf]
18	Mat18	2 in. Wood	No	2.3857	0.1670	0.0700	37.00

1/20/2004

EnergyGauge FlaCom FLCCSB v1.22

6

264	Matl264	ALUMINUM, 1/16 IN	No	0.0002	0.0050	26.0000	480.00	0.1000	<input type="checkbox"/>
214	Matl214	POLYSTYRENE, EXP., 1-1/4IN,	No	5.2100	0.1042	0.0200	1.80	0.2900	<input type="checkbox"/>
187	Matl187	GYP OR PLAS BOARD, 1/2IN	No	0.4533	0.0417	0.0920	50.00	0.2000	<input type="checkbox"/>
206	Matl206	CELLULOSE, FILL, 5.5IN, R- 20	No	20.8318	0.4583	0.0220	3.00	0.3300	<input type="checkbox"/>
151	Matl151	CONC HW, DRD, 140LB, 4IN	No	0.4403	0.3333	0.7570	140.00	0.2000	<input type="checkbox"/>
178	Matl178	CARPET W/RUBBER PAD	Yes	1.2300					<input type="checkbox"/>
265	Matl265	Soil, 1 ft	No	2.0000	1.0000	0.5000	100.00	0.2000	<input type="checkbox"/>
48	Matl48	6 in. Heavyweight concrete	No	0.5000	0.5000	1.0000	140.00	0.2000	<input type="checkbox"/>
123	Matl123	CONC BLOCK MW, 8IN, HOLLOW	No	1.7227	0.6667	0.3870	53.00	0.2000	<input type="checkbox"/>
159	Matl159	CONC HW-UNDRD-140LB-4IN	No	0.3202	0.3333	1.0410	140.00	0.2000	<input type="checkbox"/>
57	Matl57	3/4 in. Plaster or gypsum	No	0.1488	0.0625	0.4200	100.00	0.2000	<input type="checkbox"/>
72	Matl72	AIR LAYER, 3/4IN OR LESS, VERT. WALLS	Yes	0.9000					<input type="checkbox"/>
267	Matl267	0.75" stucco	No	0.1563	0.0625	0.4000	16.00	0.2000	<input type="checkbox"/>
266	Matl266	2x4@16" oc + R11 Batt	No	8.3343	0.2917	0.0350	9.70	0.2000	<input type="checkbox"/>
215	Matl215	POLYSTYRENE, EXP., 2IN,	No	8.3350	0.1667	0.0200	1.80	0.2900	<input type="checkbox"/>
105	Matl105	CONC BLK HW, 8IN, HOLLOW	No	1.1002	0.6667	0.6060	69.00	0.2000	<input type="checkbox"/>
256	Matl256	WOOD, SOFT, 1-1/2IN	No	1.8939	0.1250	0.0660	32.00	0.3300	<input type="checkbox"/>
268	Matl268	0.625" stucco	No	0.1302	0.0521	0.4000	16.00	0.2000	<input type="checkbox"/>
42	Matl42	8 in. Lightweight concrete block	No	2.0212	0.6670	0.3300	38.00	0.2000	<input type="checkbox"/>
269	Matl269	.75" ISO BTWN24" oc	No	2.2321	0.0625	0.0280	4.19	0.3000	<input type="checkbox"/>
86	Matl86	BRICK, COMMON, 4IN	No	0.8012	0.3333	0.4160	120.00	0.2000	<input type="checkbox"/>
211	Matl211	POLYSTYRENE, EXP., 1/2I N,	No	2.0850	0.0417	0.0200	1.80	0.2900	<input type="checkbox"/>
12	Matl12	3 in. Insulation	No	10.0000	0.2500	0.0250	2.00	0.2000	<input type="checkbox"/>
218	Matl218	POLYURETHANE, EXP., 1/2 IN,	No	3.2077	0.0417	0.0130	1.50	0.3800	<input type="checkbox"/>
23	Matl23	6 in. Insulation	No	20.0000	0.5000	0.0250	5.70	0.2000	<input type="checkbox"/>
4	Matl4	Steel siding	No	0.0002	0.0050	26.0000	480.00	0.1000	<input type="checkbox"/>
271	Matl271	2x4@24" oc + R11 Batt	No	10.4179	0.2917	0.0280	7.11	0.2000	<input type="checkbox"/>

1/20/2004

EnergyGauge FlaCom FLCCSB v1.22

7

272	Matl272	Panel with 7/16" panels	Yes	0.9044					<input type="checkbox"/>
273	Matl273	Hollow core flush (1.375")	Yes	1.2777					<input type="checkbox"/>
274	Matl274	Solid core flush (1.375")	Yes	1.7141					<input type="checkbox"/>
275	Matl275	Panel with 7/16" panels (1.375")	Yes	1.0019					<input type="checkbox"/>
276	Matl276	Hollow core flush (1.75")	Yes	1.3239					<input type="checkbox"/>
277	Matl277	Panel with 1-1/8" panels (1.75")	Yes	1.7141					<input type="checkbox"/>
278	Matl278	Solid core flush (1.75")	Yes	1.6500					<input type="checkbox"/>
279	Matl279	Solid core flush (2.25")	Yes	2.8537					<input type="checkbox"/>
280	Matl280	Fiberglass/Mineral wool core	Yes	0.8167					<input type="checkbox"/>
281	Matl281	Paper Honeycomb core	Yes	0.9357					<input type="checkbox"/>
282	Matl282	Solid Urethane foam core	Yes	1.6500					<input type="checkbox"/>
283	Matl283	Solid mineral fiberboard core	Yes	1.7816					<input type="checkbox"/>
284	Matl284	Polystyrene core (18 ga steel) 1	Yes	2.0071					<input type="checkbox"/>
285	Matl285	Polyurethane core (18 ga steel) 2	Yes	2.5983					<input type="checkbox"/>
286	Matl286	Polyurethane core (24 ga steel) 1	Yes	2.5983					<input type="checkbox"/>
287	Matl287	Polyurethane core (24 ga steel) 2	Yes	4.1500					<input type="checkbox"/>
288	Matl288	Solid Urethane foam core	Yes	4.1500					<input type="checkbox"/>
81	Matl81	ASPHALT-ROOFING, ROLL	Yes	0.1500					<input type="checkbox"/>
244	Matl244	PLYWOOD, 1/2IN	No	0.6318	0.0417	0.0660	34.00	0.2900	<input type="checkbox"/>
185	Matl185	CLAY TILE, PAVER, 3/8IN	No	0.0301	0.0313	1.0410	120.00	0.2000	<input type="checkbox"/>
82	Matl82	ASPHALT-SHINGLE AND SIDING	Yes	0.4400					<input type="checkbox"/>
11	Matl11	2 in. Insulation	No	6.6800	0.1670	0.0250	2.00	0.2000	<input type="checkbox"/>
47	Matl47	2 in. Heavyweight concrete	No	0.1670	0.1670	1.0000	140.00	0.2000	<input type="checkbox"/>
95	Matl95	CONC BLOCK HW-4IN-HOLLOW	No	0.7107	0.3333	0.4690	101.00	0.2000	<input type="checkbox"/>
248	Matl248	ROOF GRAVEL OR SLAG 1/2IN	No	0.0500	0.0417	0.8340	55.00	0.4000	<input type="checkbox"/>
94	Matl94	BUILT-UP ROOFING, 3/8IN	No	0.3366	0.0313	0.0930	70.00	0.3500	<input type="checkbox"/>
1001	ApLbMatl001	LINOLEUM TILE	Yes	0.5000					<input type="checkbox"/>
1003	ApLbMatl003	ASB-CEM BOARD, 1/4IN	No	0.0603	0.0208	0.3450	120.00	0.2000	<input type="checkbox"/>

1/20/2004

EnergyGauge FlaCom FLCCSB v1.22

8

1004	ApLbMat1004	6 in. Insulation	No	20.0000	0.5000	0.0250	5.70	0.2000	<input type="checkbox"/>
------	-------------	------------------	----	---------	--------	--------	------	--------	--------------------------

Constructs Used									
No	Name	Simple Construct	Massless Construct	Conductance [Btu/h.sf.F]	Heat Capacity [Btu/sf.F]	Density [lb/cf]	RValue [h.sf.F/Btu]		
1002	Aluminum door, 1.25 in. polystyrene	No	No	0.19	0.53	43.67	5.2104	<input type="checkbox"/>	
	Layer	Material No.	Material	Thickness [ft]	Framing Factor				
	1	264	ALUMINUM, 1/16 IN	0.0050	0.00	<input type="checkbox"/>			
	2	214	POLYSTYRENE, EXP., 1-1/4IN,	0.1042	0.00	<input type="checkbox"/>			
	3	264	ALUMINUM, 1/16 IN	0.0050	0.00	<input type="checkbox"/>			
No	Name	Simple Construct	Massless Construct	Conductance [Btu/h.sf.F]	Heat Capacity [Btu/sf.F]	Density [lb/cf]	RValue [h.sf.F/Btu]		
1005	1 ft. soil, concrete floor, Vinyl	No	No	0.20	54.00	108.00	5.0000	<input type="checkbox"/>	
	Layer	Material No.	Material	Thickness [ft]	Framing Factor				
	1	265	Soil, 1 ft	2.0000	0.00	<input type="checkbox"/>			
	2	48	6 in. Heavyweight concrete	0.5000	0.00	<input type="checkbox"/>			
	3	1001	LINOLEUM TILE		0.00	<input type="checkbox"/>			

1/20/2004

EnergyGauge FlaCom FLCCSB v1.22

9

1038	Shngl/1/2"WD Deck/WD Truss/9" Batt/Gyp Brd	No	No	0.03	1.50	8.22	31.2351	<input type="checkbox"/>
------	--	----	----	------	------	------	---------	--------------------------

No	Name	Simple Construct	Massless Construct	Conductance [Btu/h.sf.F]	Heat Capacity [Btu/sf.F]	Density [lb/cf]	RValue [h.sf.F/Btu]		
	Layer	Material No.	Material	Thickness [ft]	Framing Factor				
	1	81	ASPHALT-ROOFING, ROLL		0.00	<input type="checkbox"/>			
	2	244	PLYWOOD, 1/2IN	0.0417	0.00	<input type="checkbox"/>			
	3	12	3 in. Insulation	0.2500	0.00	<input type="checkbox"/>			
	4	23	6 in. Insulation	0.5000	0.00	<input type="checkbox"/>			
	5	187	GYP OR PLAS BOARD, 1/2IN	0.0417	0.00	<input type="checkbox"/>			
No	Name	Simple Construct	Massless Construct	Conductance [Btu/h.sf.F]	Heat Capacity [Btu/sf.F]	Density [lb/cf]	RValue [h.sf.F/Btu]		
1048	Siding/.5in Sheathing/R-19 Batt/.5in GYP	No	No	0.05	1.90	14.65	21.1454	<input type="checkbox"/>	
	Layer	Material No.	Material	Thickness [ft]	Framing Factor				
	1	1003	ASB-CEM BOARD, 1/4IN	0.0208	0.00	<input type="checkbox"/>			
	2	244	PLYWOOD, 1/2IN	0.0417	0.00	<input type="checkbox"/>			
	3	1004	6 in. Insulation	0.5000	0.00	<input type="checkbox"/>			
	4	187	GYP OR PLAS BOARD, 1/2IN	0.0417	0.00	<input type="checkbox"/>			

1/20/2004

EnergyGauge FlaCom FLCCSB v1.22

10

FORM N-1 Commercial Load Calculations

Building/Room

Assembly

Name 401201 Elim Baptist Church Fellowship Hall

Phone

Address CR 238 Fort White, FL

Contractor

Phone

Address

1. Cooling Design Conditions

Correction

Latitude	29			
Time	3:00pm	Daily Range	18	-1
Inside db (F)	75	Inside %RH	60	
Outside db (F)	93	Outside %RH	77	
Outside db @3pm	93	Time Correct.	0	
Grains (50%)	51	T.D. =	18	-2

2. Solar Radiation Heat Gain Through Glass**Cooling Load**

	Exposure	Sq. Ft.	Solar Factor	Shading Factor	Sensible	Latent
Clear, 2pane	NE	30	39	0.81	948	
Light. wt. bldg.	NW	30	47	0.81	1142	
	SE	0	67	0.81	0	
	SW	39	109	0.81	3443	

3. Transmission Gains

Glass	ETD	Exposure	Sq. Ft.	U Factor	db dT or Equiv.	
Clear, 2pane		All	99	0.65	18	1158
Walls	C	NE	907	0.05	15	680
Siding, R19	C	NW	499	0.05	23	574
	C	SE	529	0.05	36	952
	C	SW	961	0.05	17	817
Doors	use t.d.	All	147	0.36	18	953
Steel						
Roof/Ceiling	RC1	All	5000	0.03	81	12150
Shingles, 7/16"OSB, R30						

4. Internal Heat Gain

a. Occupants		Number	Sensible	Latent		
		65	255	325	16575	21125
b. Lights & Others			Watts			
	Incandescent Lights		60	3.4	204	
	Fluorescent Lights		5120	4.1	20992	
	Name	Sensible	Latent	Usage Factor		

Appliances

5. Infiltration

		ft3/min	db dT	dGrains		
Doors		220	18	51	4356	7630
Neutral, avg.	Bldg.	333	18	51	6593	11548

6. Subtotal Cooling Load from Space

66004	40303
-------	-------

7. Supply Duct Heat Gain

Gain Factor	Line 6 Sensible Gain
0.03	66004

8. Room, Zone, or Block Design Load

		Lines 6+7	
		67985	40303

Supply dT	19	Line 8 Sens.	67985	Cooling cfm =	3253
-----------	----	--------------	-------	---------------	------

9. Ventilation

	cfm/occupant	ft3/min	db dT	dGrains		
Non Smoking	10	650	18	51	12870	22542

10. Return Air Load From Lighting And Roof

11. Return Duct Heat Gain	Line 6 Sensible Gain	Gain Factor	
	66004	0.00	0

12. Total Cooling Loads on Equipment (Btuh)

12.0	80855	62845
------	-------	-------

13. Heating Design Conditions

Inside db = 75 Outside db= 31 dT= 44

14. Transmission Losses

Glass	ETD	Exposure	ft2	U Factor	db dT	Heating Load
Clear, 2pane		All	99	0.62	44	2701
Walls	C	NE	907	0.05	44	1995
Siding, R19	C	NW	499	0.05	44	1098
	C	SE	529	0.05	44	1164
	C	SW	961	0.05	44	2114
Doors	use t.d.	All	147	0.36	44	2328
Steel						
Roof/Ceiling	RC1	All	5000	0.03	44	6600
Shingles, 7/16"OSB, R30						

15. Infiltration

		ft3/min	db dT	
door	Doors	380	44	18392
Neutral, avg.	Bldg.	500	44	24200

16. Sub Total Heating Load for Space

36392

17. Supply Duct Heat Loss

Loss Factor	Line 16 Sensible	
0.05	36392	1820

18. Ventilation

ft3/min	db dT	
650	44	31460

19. Humidification

2225

20. Return Duct Heat Loss

Loss Factor	Line 16 Sensible	
0.00	36392	0

21. Total Heating Load on Equipment (Btuh)

3.4 40437

Notice of Treatment

Applicator Florida Pest Control & Chemical Co.

Address _____

City _____ **Phone** _____

Site Location Subdivision _____

Lot# _____ **Block#** _____ **Permit#** _____

Address _____

AREAS TREATED

Area Treated	Date	Time	Gal.	<u>Print Technician's</u> <u>Name</u>
Main Body	_____	_____	_____	_____
Patio/s #	_____	_____	_____	_____
Stoop/s #	_____	_____	_____	_____
Porch/s #	_____	_____	_____	_____
Brick Veneer	_____	_____	_____	_____
Extension Walls	_____	_____	_____	_____
A/C Pad	_____	_____	_____	_____
Walk/s #	_____	_____	_____	_____
Exterior of Foundation	_____	_____	_____	_____
Driveway Apron	_____	_____	_____	_____
Out Building	_____	_____	_____	_____
Tub Trap/s	_____	_____	_____	_____
(Other)	_____	_____	_____	_____

Name of Product Applied _____ %

Remarks _____

Applicator - White • Permit File - Canary • Permit Holder - Pink