

(TYP.) INTERIOR BEARING WALL
ONE STORY WOOD FRAME w/ RODS

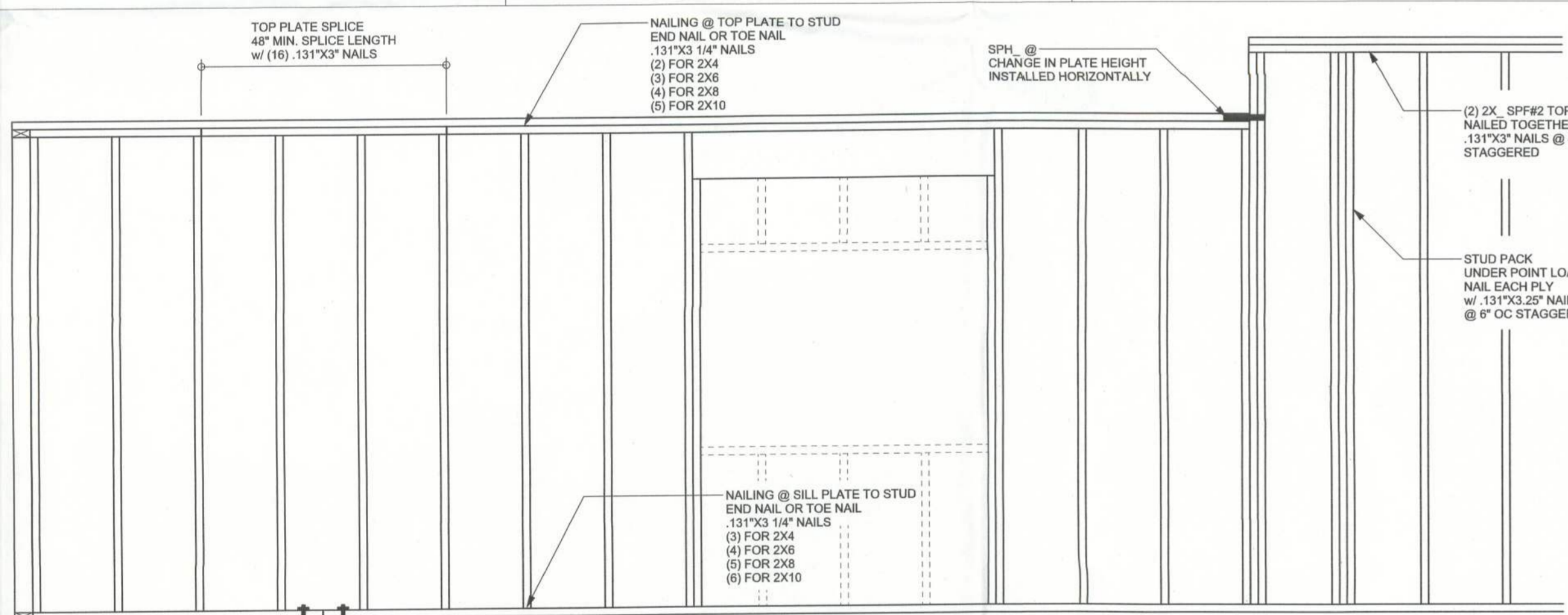

(TYP.) WALL CONNECTIONS
ONE STORY WOOD FRAME

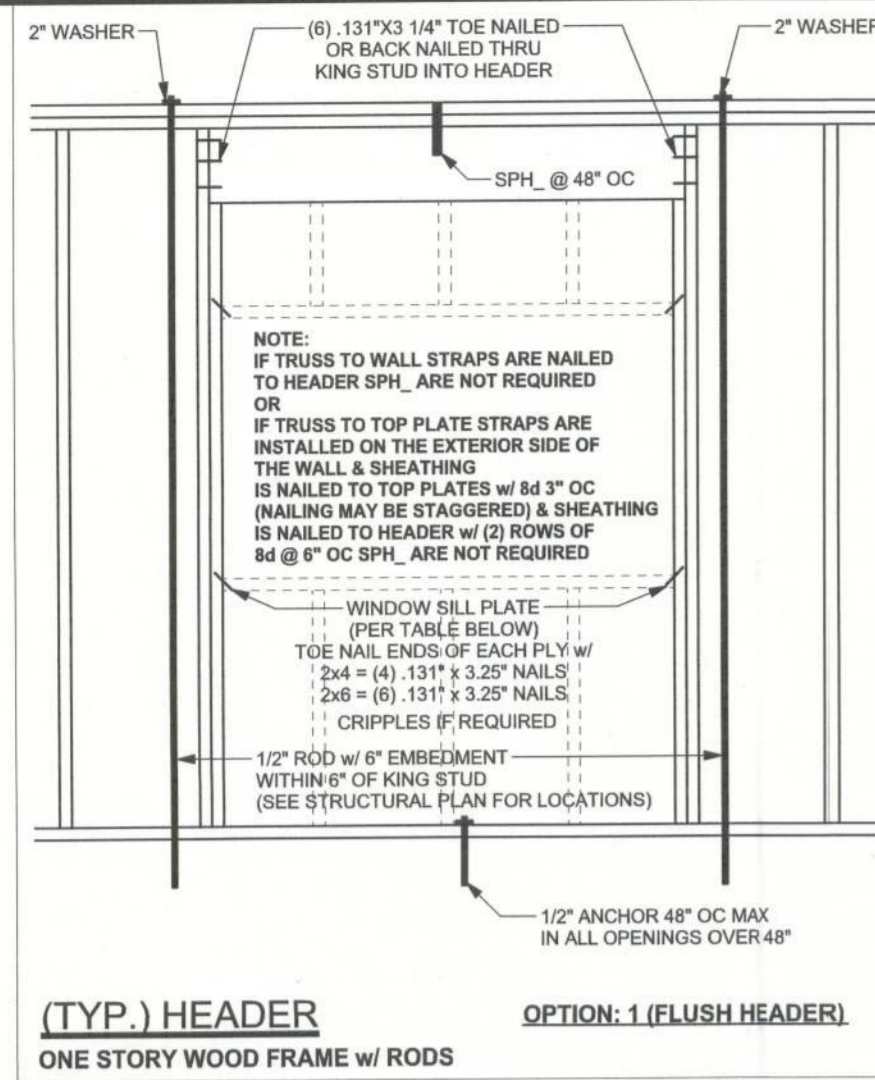
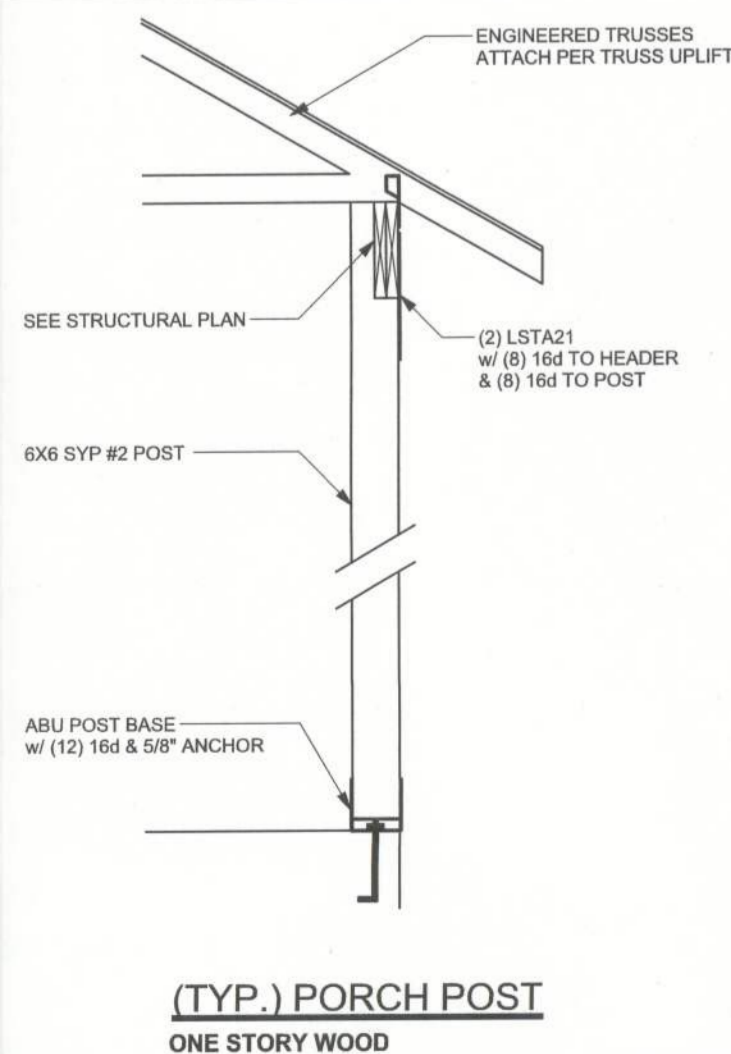

(TYP.) HEADER
ONE STORY WOOD FRAME w/ RODS

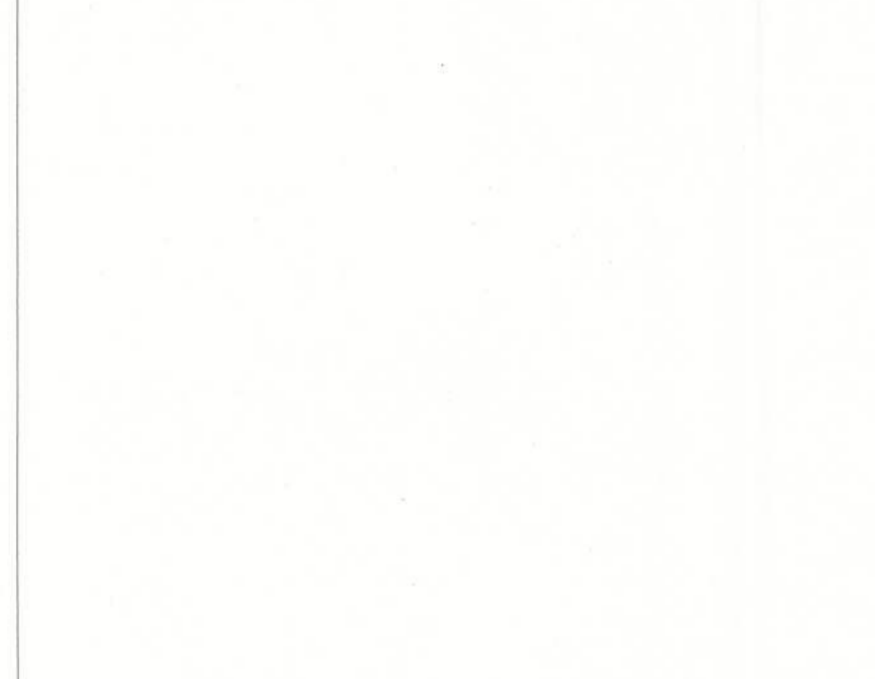

(TYP.) HEADER
ONE STORY WOOD FRAME w/ RODS

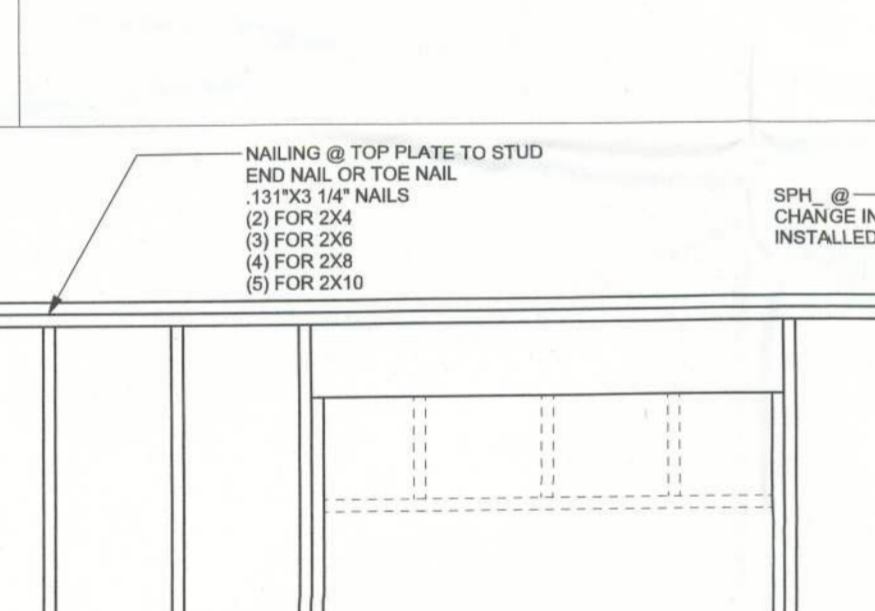

(TYP.) HEADER
ONE STORY WOOD FRAME w/ RODS

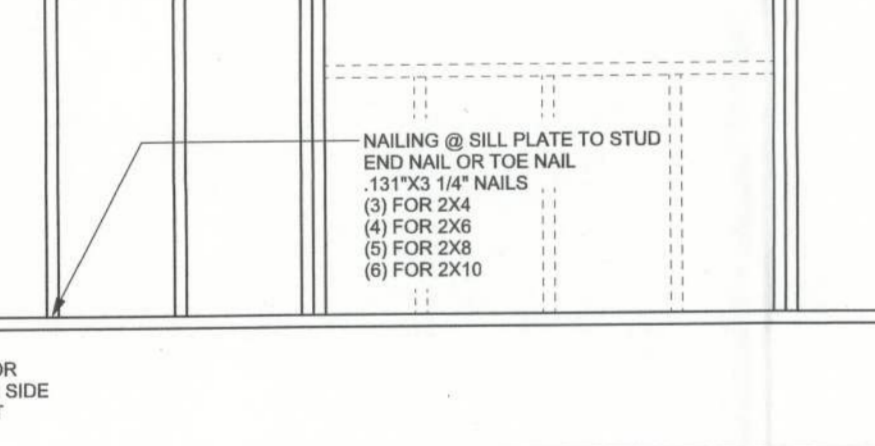

(TYP.) HEADER
ONE STORY WOOD FRAME w/ RODS

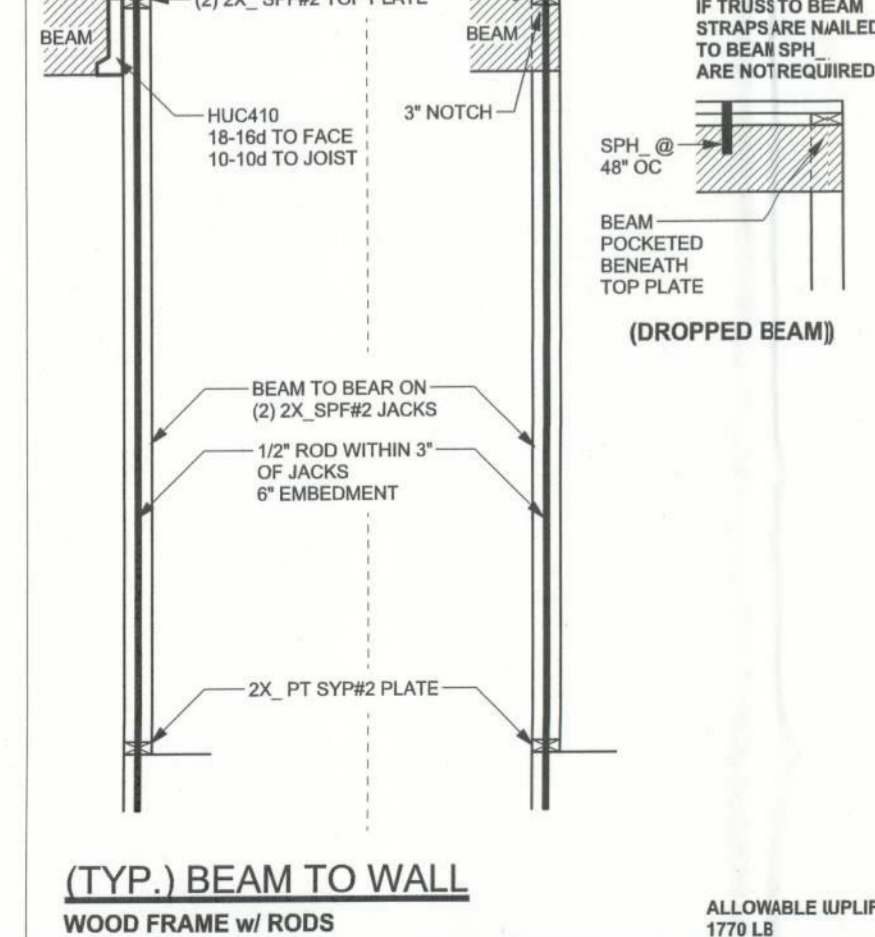

(TYP.) BEAM TO WALL
WOOD FRAME w/ RODS

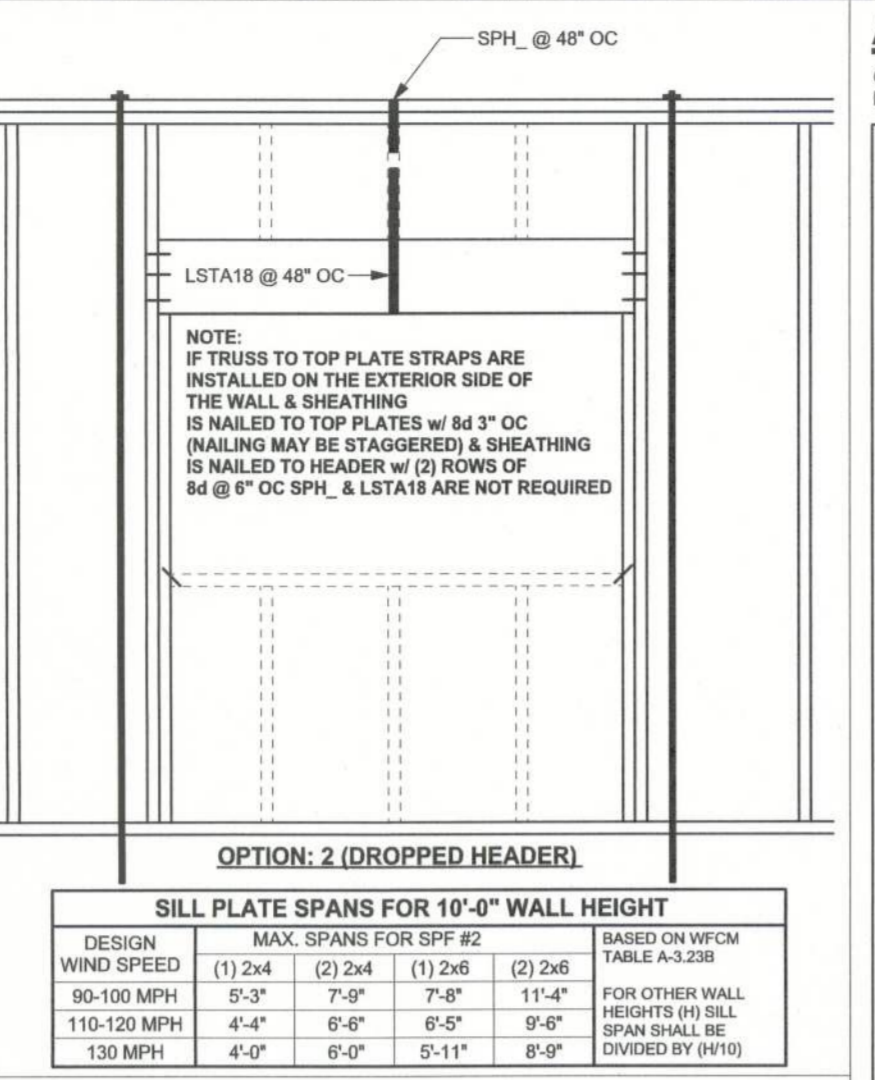

OPTION: 2 (DROPPED HEADER)



OPTION: 2 (DROPPED HEADER)

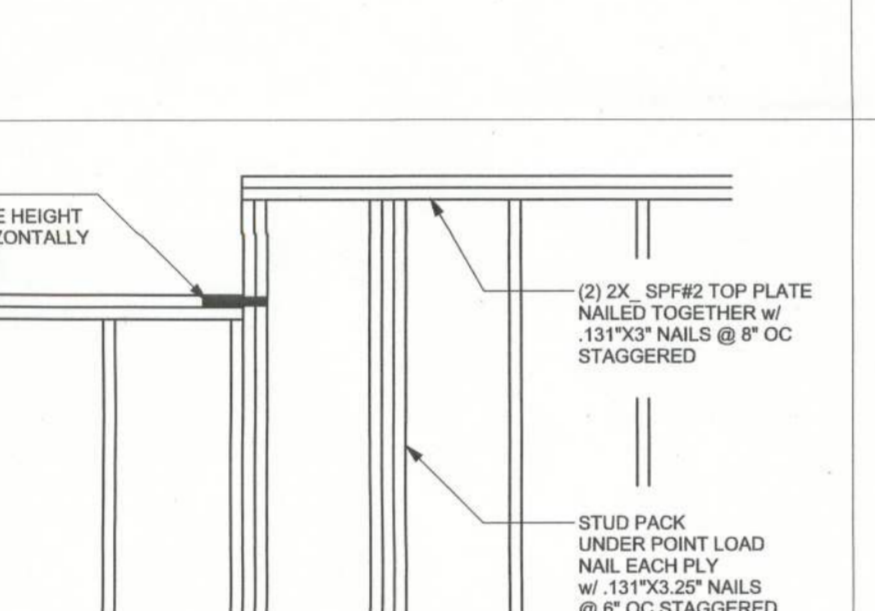

OPTION: 2 (DROPPED HEADER)

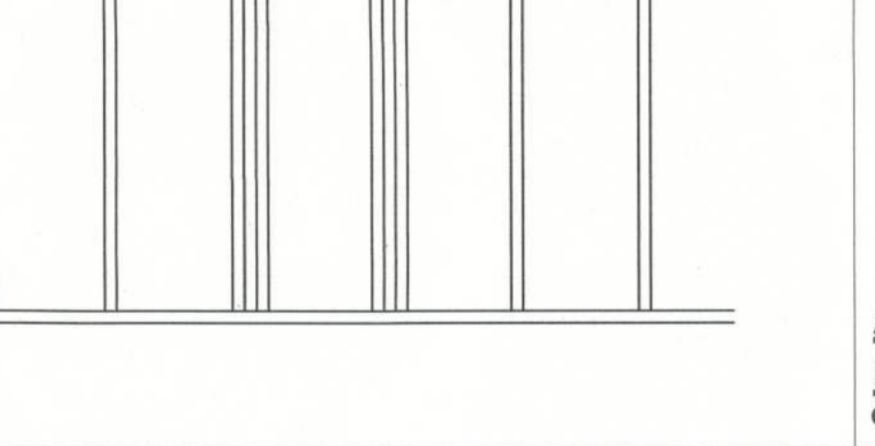

OPTION: 2 (DROPPED HEADER)

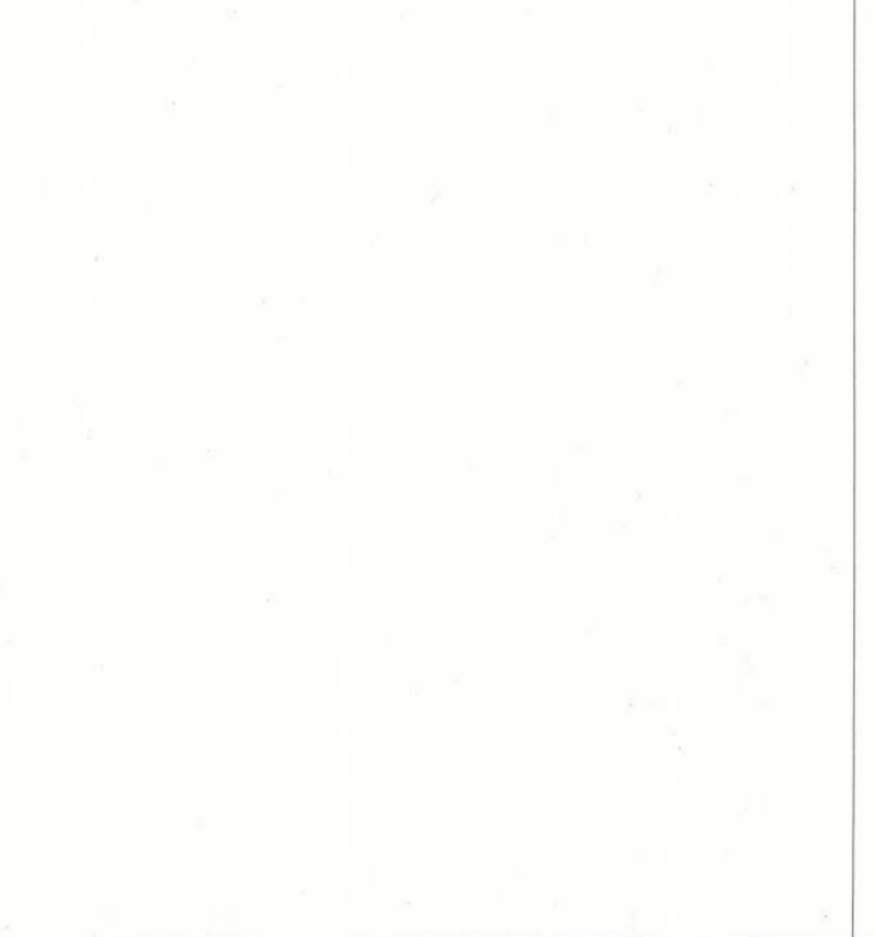

OPTION: 2 (DROPPED HEADER)

ANCHOR TABLE
OBTAIN UPLIFT REQUIREMENTS FROM TRUSS
MANUFACTURER'S ENGINEERING

TRUSS CONNECTOR	UPLIFT SYP	UPLIFT SPF	F1 SYP	F2 SYP	F1 SPF	F2 SPF	TO RAFTER/TRUSS	TO PLATES
H5	455	265	115	200	100	170	4-8d x 1 1/2"	4-8d x 1 1/2"
H3	415	290	125	160	105	140	4-8d x 1 1/2"	4-8d x 1 1/2"
H2.5	415	365	150	150	130	130	5-8d x 1 1/2"	5-8d x 1 1/2"
H2.5A	480	480	110	110	110	110	5-8d x 1 1/2"	5-8d x 1 1/2"
H6	950	820					8-8d	8-8d
H8	745	565					5-10d x 1 1/2"	5-10d x 1 1/2"
H14-1	1465	1050	515	265	480	245	12-8d x 1 1/2"	13-8d
H14-2	1465	1050	515	265	480	245	12-8d x 1 1/2"	15-8d
H10	990	850	585	525	505	450	8-8d x 1 1/2"	8-8d x 1 1/2"
H10-2	760	655	455	395	390	340	8-10d	6-10d
H16	1470	1265					2-10d x 1 1/2"	10-10d x 1 1/2"
H16-2	1470	1265					2-10d x 1 1/2"	10-10d x 1 1/2"
LTS12 - LTS20	1000	620					6-10d x 1 1/2"	6-10d x 1 1/2"
MTS12 - MTS30	1000	860					7-10d x 1 1/2"	7-10d x 1 1/2"
HTS16 - HTS30	1450	1245					12-10d x 1 1/2"	12-10d x 1 1/2"
HEAVY GIRDER TIEDOWNS								
LGT2	2050	1785	700	170	700	170	14-16d	14-16d
LGT3-SDS2.5	3685	2655	795	410	795	410	12-SDS 1/4" x 2 1/2"	26-16dS
LGT4-SDS3	4060	3660	2000	675	2000	675	12-SDS 1/4" x 3"	36-16dS
MGT	3965	3330					22-10d	5/8" ANCHOR
HGT-2	10980	6485					18-10d	2-5/8" ANCHOR
HGT-3	10530	9035					18-10d	2-5/8" ANCHOR
HGT-4	9250	9250					18-10d	2-5/8" ANCHOR
STUD STRAP CONNECTOR								
SSP DOUBLE TOP PLATE	435	435					3-10d	4-10d
SSP SINGLE SILL PLATE	455	420					1-10d	4-10d
DSP DOUBLE TOP PLATE	825	825					6-10d	8-10d
DSP SINGLE SILL PLATE	825	800					2-10d	8-10d
SP1	585	535					4-10d	6-10d
SP2	1065	605					6-10d	6-10d
SP4	885	760					6-10d x 1 1/2"	
SPH4	1240	1065					10-10d x 1 1/2"	
SP6	885	760					6-10d x 1 1/2"	
SPH6	1240	1065					10-10d x 1 1/2"	
LSTA18	1235	1110						16-10d
LSTA21	1235	1235						16-10d
CS20	1030	1030						14-10d
CS16	1705	1705						22-10d
STUD ANCHORS								
LTT19	1350	1305					8-16d	1/2" ANCHOR
LTT131	2310	2310					18-10d x 1 1/2"	5/8" ANCHOR
HD2A	2775	2570					2-5/8" BOLTS	5/8" ANCHOR
HTT16	4175	3695					18-16d	5/8" ANCHOR
HTT22	5260	5250					32-16d	5/8" ANCHOR
ABU44	2200	2200					12-16d	5/8" ANCHOR
ABU66	2300	2300					12-16d	5/8" ANCHOR
ABU88	2320	2320					18-16d	2-5/8" ANCHOR

(1) w/ INSTALLATION OF 4-16dS OPTIONAL NAIL HOLES
(2) FOR SYP GIRDER & SPF STUDS

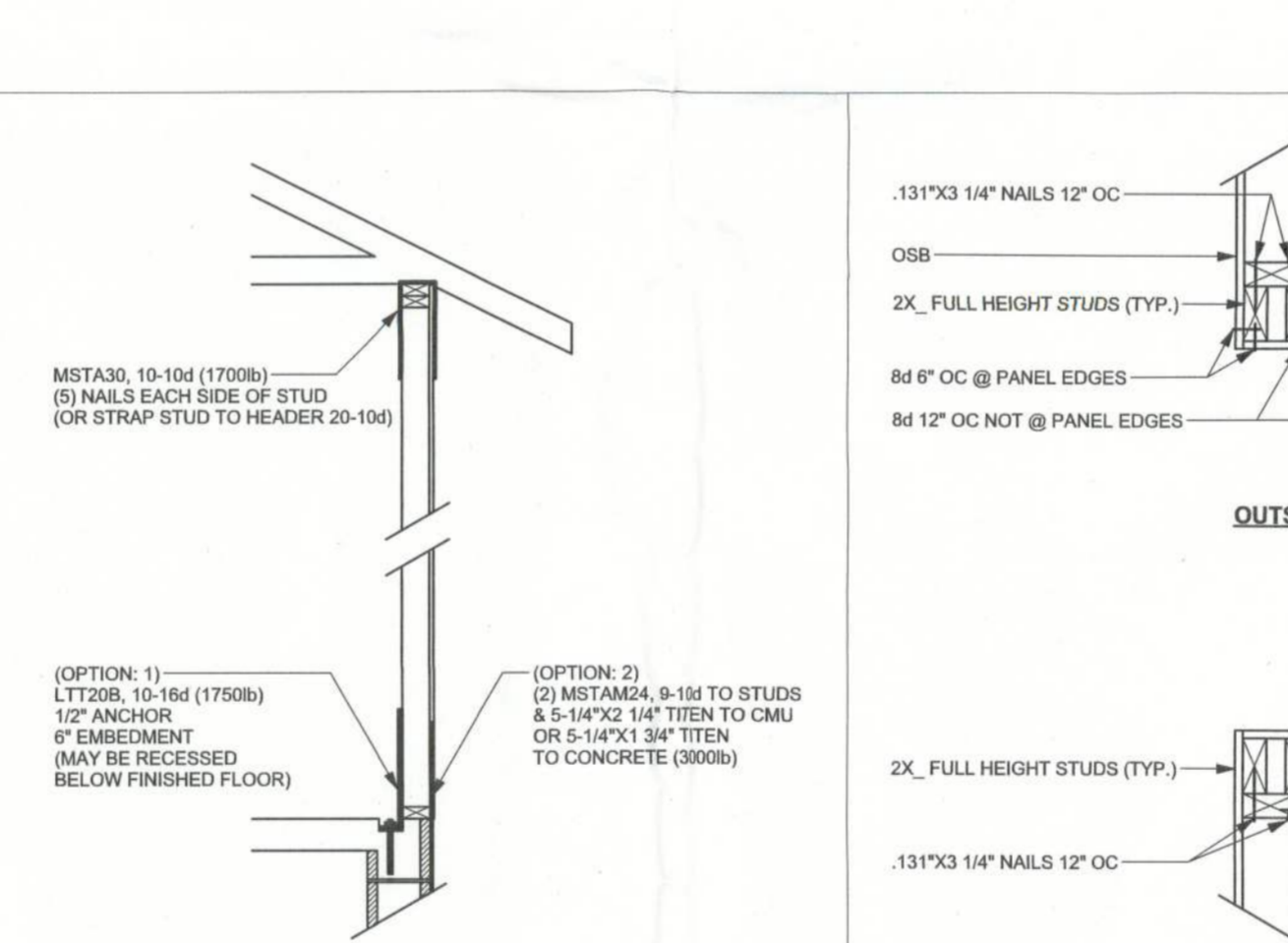

**ALTERNATE CONNECTION WHERE
ROD CANNOT BE PLACED IN WALL**
ONE STORY WOOD FRAME w/ RODS

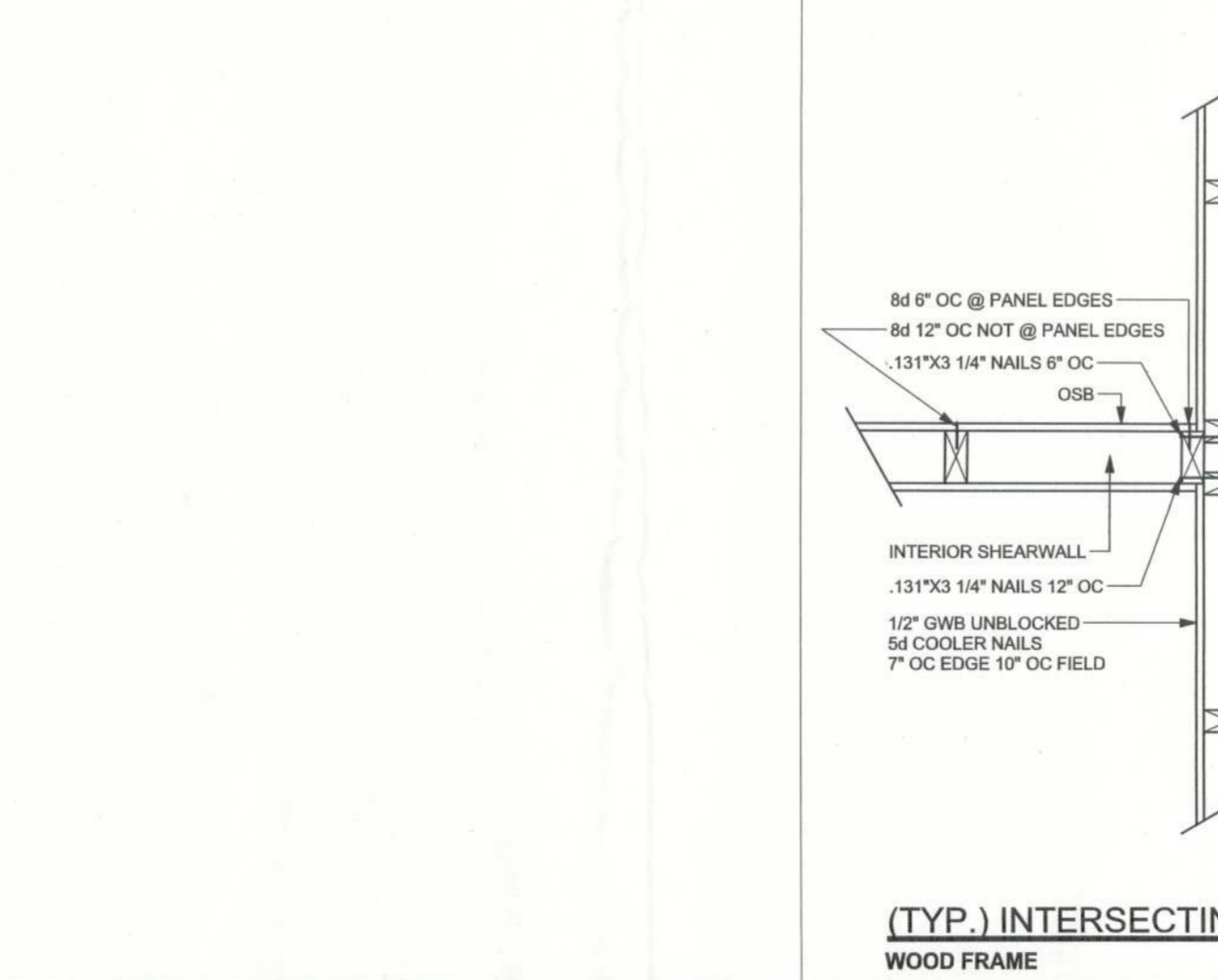

(TYP.) CORNER FRAMING
WOOD FRAME

**EXTERIOR WALL STUD TABLE
FOR SPF #2 STUDS**

(1) 2x4 @ 16" OC	TO 10'-6" STUD HEIGHT
(1) 2x4 @ 12" OC	TO 11'-7" STUD HEIGHT
(1) 2x6 @ 16" OC	TO 16'-10" STUD HEIGHT
(1) 2x6 @ 12" OC	TO 18'-7" STUD HEIGHT

THIS STUD HEIGHT TABLE IS PER WFCM 2001, TABLE 3.2.0B.
EXTERIOR LOAD BEARING & NON LOAD BEARING STUD LENGTHS
RESISTING INTERIOR ZONE WINDLOADS 110 MPH EXPOSURE C.
STUD SPACINGS SHALL BE MULTIPLIED BY 0.85 FOR FRAMING
LOCATED WITHIN 4 FEET OF CORNERS FOR END ZONE LOADING.
EXAMPLE 16" O.C. x 0.85 = 13.6" O.C.

GRADE & SPECIES TABLE

	Fb (psi)	E (10 ⁶ psi)
2x8	SYP #2	1200
2x10	SYP #2	1050
2x12	SYP #2	975
GLB	24F-V3 SP	2400
LSL	TIMBERSTRAND	1700