



STATE OF FLORIDA  
DEPARTMENT OF ENVIRONMENTAL PROTECTION  
ONSITE SEWAGE TREATMENT AND DISPOSAL  
SYSTEM (OSTDS)

PERMIT NO. 23-0801  
DATE PAID: 11/21/23  
FEE PAID: 400.00  
RECEIPT #: 2022924

PA-S/Bmodif

APPLICATION FOR CONSTRUCTION PERMIT

APPLICATION FOR:

☐ New System ☒ Existing System ☐ Holding Tank ☐ Innovative  
☐ Repair ☐ Abandonment ☐ Temporary ☒ Modif

APPLICANT: Cortney Koppel

EMAIL: \_\_\_\_\_

AGENT: Kimberly Koon

TELEPHONE: 386-688-2345

MAILING ADDRESS: 1154 NW Noegel Rd Lake city Fl 32055

TO BE COMPLETED BY APPLICANT OR APPLICANT'S AUTHORIZED AGENT. SYSTEMS MUST BE CONSTRUCTED BY A PERSON LICENSED PURSUANT TO 489.105(3) (m) OR 489.552, FLORIDA STATUTES. IT IS THE APPLICANT'S RESPONSIBILITY TO PROVIDE DOCUMENTATION OF THE DATE THE LOT WAS CREATED OR PLATTED (MM/DD/YY) IF REQUESTING CONSIDERATION OF STATUTORY GRANDFATHER PROVISIONS.

PROPERTY INFORMATION

OSTDS REMEDIATION PLAN? [ Y / N ]

LOT: 1 BLOCK: \_\_\_\_\_ SUBDIVISION: DOGWOOD ACRES PLATTED: \_\_\_\_\_

PROPERTY ID #: 10-7S-17-09974-324 (37034) ZONING: \_\_\_\_\_ I/M OR EQUIVALENT: [ Y / N ]

PROPERTY SIZE: 2.22 ACRES WATER SUPPLY: [ x ] PRIVATE PUBLIC [ ] <=2000GPD [ ] >2000GPD

IS SEWER AVAILABLE AS PER 381.0065, FS? [ Y / N ] DISTANCE TO SEWER: \_\_\_\_\_ FT

PROPERTY ADDRESS: 285 SE RATTLER CTHIGH SPRINGS, FL 32643

DIRECTIONS TO PROPERTY: Take exit 414 I-75 South for US -41 S/ US-441 S.  
TR Towards High Springs. TL Diamondback Glen, TR SE Rattler ct  
Dead end to property

BUILDING INFORMATION

[ x ] RESIDENTIAL

[ ] COMMERCIAL

Unit No.	Type of Establishment	No. of Bedrooms	Building Area Sqft	Commercial/Institutional System Design Table I, Chapter 62-6, FAC
1	<u>camper to be removed</u>	<u>2</u>	<u>600</u>	
2	<u>Mobile home</u>	<u>3</u>	<u>1780</u>	
3				
4				

[ ] Floor/Equipment Drains [ ] Other (Specify) \_\_\_\_\_

SIGNATURE: Kimberly Koon

DATE: 11/20/23

DEP 4015, 06-21-2022 (Obsoletes previous editions which may not be used)

Incorporated 62-6.004, FAC

Courtney Hoppel  
285 SE Rattler Ct.  
High Springs FL 32643

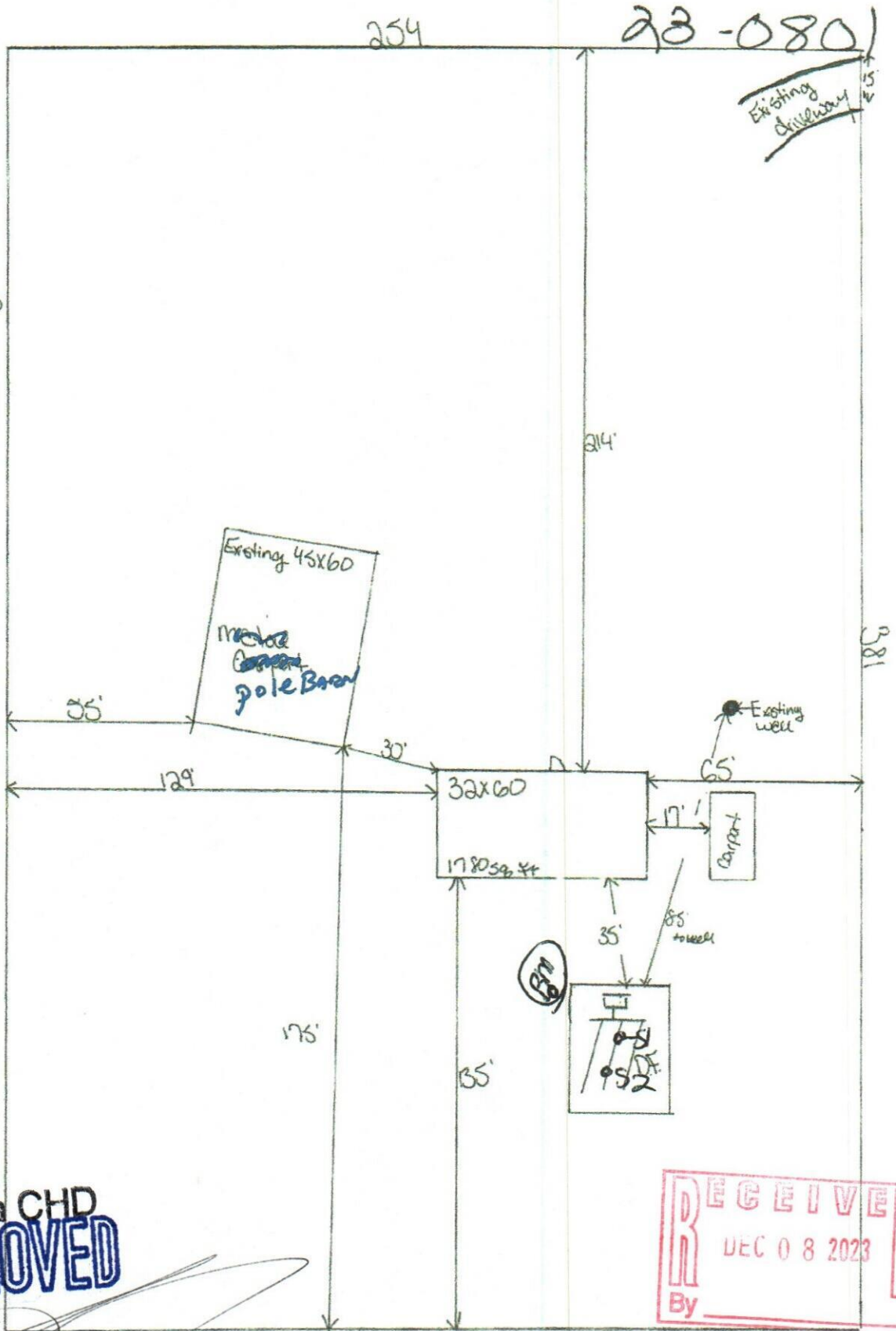

Columbia CHD  
**APPROVED**

**RECEIVED**  
DEC 08 2023  
By \_\_\_\_\_

*Robert D. [Signature]*  
12-8-2023

North  
1"=40'  
220ac  
Down by:  
Kimberly Ann  
11/3/23





STATE OF FLORIDA  
DEPARTMENT OF HEALTH  
ONSITE SEWAGE TREATMENT AND DISPOSAL  
SYSTEM

PERMIT #: 12-SC-2825954  
APPLICATION #: AP2022964  
DATE PAID: 11/29/23  
FEE PAID: 605.14  
RECEIPT #: \_\_\_\_\_  
DOCUMENT #: PR2032912

CONSTRUCTION PERMIT FOR: OSTDS Existing Modification  
APPLICANT: CORTNEY\*\*23-0801 KOPPEL  
PROPERTY ADDRESS: 285 SE RATTLER High Springs, FL 32643  
LOT: 1 BLOCK: \_\_\_\_\_ SUBDIVISION: DOGWOOD ACRES  
PROPERTY ID #: 09974-324 [SECTION, TOWNSHIP, RANGE, PARCEL NUMBER]  
[OR TAX ID NUMBER]

SYSTEM MUST BE CONSTRUCTED IN ACCORDANCE WITH SPECIFICATIONS AND STANDARDS OF SECTION 381.0065, F.S., AND CHAPTER 64E-6, F.A.C. DEPARTMENT APPROVAL OF SYSTEM DOES NOT GUARANTEE SATISFACTORY PERFORMANCE FOR ANY SPECIFIC PERIOD OF TIME. ANY CHANGE IN MATERIAL FACTS, WHICH SERVED AS A BASIS FOR ISSUANCE OF THIS PERMIT, REQUIRE THE APPLICANT TO MODIFY THE PERMIT APPLICATION. SUCH MODIFICATIONS MAY RESULT IN THIS PERMIT BEING MADE NULL AND VOID. ISSUANCE OF THIS PERMIT DOES NOT EXEMPT THE APPLICANT FROM COMPLIANCE WITH OTHER FEDERAL, STATE, OR LOCAL PERMITTING REQUIRED FOR DEVELOPMENT OF THIS PROPERTY.

SYSTEM DESIGN AND SPECIFICATIONS

T [ 900 ] GALLONS / GPD Ex. Septic Tank CAPACITY  
A [ ] GALLONS / GPD N/A CAPACITY  
N [ ] GALLONS GREASE INTERCEPTOR CAPACITY [MAXIMUM CAPACITY SINGLE TANK:1250 GALLONS]  
K [ ] GALLONS DOSING TANK CAPACITY [ ] GALLONS @ [ ] DOSES PER 24 HRS #Pumps [ ]

D [ 375 ] SQUARE FEET Drainfield SYSTEM  
R [ ] SQUARE FEET N/A SYSTEM  
A TYPE SYSTEM: [X] STANDARD [ ] FILLED [ ] MOUND [ ]  
I CONFIGURATION: [X] TRENCH [ ] BED [ ]

N  
F LOCATION OF BENCHMARK: POWER POLE SE OF SITE.

I ELEVATION OF PROPOSED SYSTEM SITE [ 24.00 ] [ INCHES ] FT [ ] [ ABOVE / BELOW ] BENCHMARK/REFERENCE POINT  
E BOTTOM OF DRAINFIELD TO BE [ 52.00 ] [ INCHES ] FT [ ] [ ABOVE / BELOW ] BENCHMARK/REFERENCE POINT

L  
D FILL REQUIRED: [ 0.00 ] INCHES EXCAVATION REQUIRED: [ 0.00 ] INCHES

O  
T  
H  
E  
R  
The system is sized for 3 bedrooms with a maximum occupancy of 6 persons (2 per bedroom), for a total estimated flow of 300 gpd.  
115sqft of drainfield is to be added to the existing 260sqft to bring system up to 300GPD code totaling 375sqft of primary drainfield.

SPECIFICATIONS BY: Robert Ford TITLE: Master Contractor

APPROVED BY: Dustin W Jones TITLE: Environmental Specialist II Columbia CHD

DATE ISSUED: 12/07/2023 EXPIRATION DATE: 06/07/2025

DEP 4015, 06-21-2022 (Obsoletes previous editions which may not be used)  
Incorporated 62-6.004, FAC