

Doc's already uploaded.

PERMIT APPLICATION / MANUFACTURED HOME INSTALLATION APPLICATION

For Office Use Only (Revised 7-1-15) Zoning Official LW Building Official _____
AP# 44857 Date Received 3/30/2020 By MG Permit # _____
Flood Zone X Development Permit _____ Zoning A-3 Land Use Plan Map Category Ag
Comments _____
FEMA Map# _____ Elevation _____ Finished Floor _____ River _____ In Floodway _____
☐ Recorded Deed or ☐ Property Appraiser PO ☐ Site Plan ☐ EH # _____ ☐ Well letter OR
☐ Existing well ☐ Land Owner Affidavit ☐ Installer Authorization ☐ FW Comp. letter ☒ App Fee Paid
☐ DOT Approval ☐ Parent Parcel # _____ ☐ STUP-MH _____ ☐ 911 App
☐ Ellsville Water Sys ☐ Assessment _____ ☐ Out County ☐ In County ☐ Sub VF Form

Property ID # 01754-001 Subdivision N/A Lot# N/A

- New Mobile Home ☒ Used Mobile Home _____ MH Size 32x52 Year 2020
- Applicant Jessie Shepard Phone # 386-963-4298
- Address 3360 150th Pl Lake City FL 32024
- Name of Property Owner Jessie R. Newton Phone# 352-895-7763
- 911 Address 521 Scarborough Ln Lake City FL 32055
- Circle the correct power company FL Power & Light Clay Electric
(Circle One) - Suwannee Valley Electric - Duke Energy
- Name of Owner of Mobile Home Jessie R. Newton Phone # 352-895-7743
Address 104 Sniper Dr. Hawthorne FL 32460
- Relationship to Property Owner Self
- Current Number of Dwellings on Property 0
- Lot Size 24AC Total Acreage 24AC
- Do you : Have Existing Drive or Private Drive or need Culvert Permit or Culvert Waiver (Circle one)
(Currently using) (Blue Road Sign) (Putting in a Culvert) (Not existing but do not need a Culvert)
- Is this Mobile Home Replacing an Existing Mobile Home NO
- Driving Directions to the Property Head NE on road toward NE Justice St (C)
NE Madison St (R) US-4 in NW Main Blvd (R) NW Scarborough Ave

Name of Licensed Dealer/Installer William R. Price Phone # 386-963-4298
Installers Address 3360 150th Pl Lake City FL 32024
License Number 14-1041936 Installation Decal # 70009

Legend

Roads

- Roads
- others
- Dirt
- Interstate
- Main
- Other
- Paved
- Private
- LidarElevations



SRWMD Wetlands



Parcels

2018 Flood Zones

0.2 PCT ANNUAL CHANCE

A

Columbia County, FLA - Building & Zoning Property Map

Printed: Wed Apr 15 2020 08:57:57 GMT-0400 (Eastern Daylight Time)

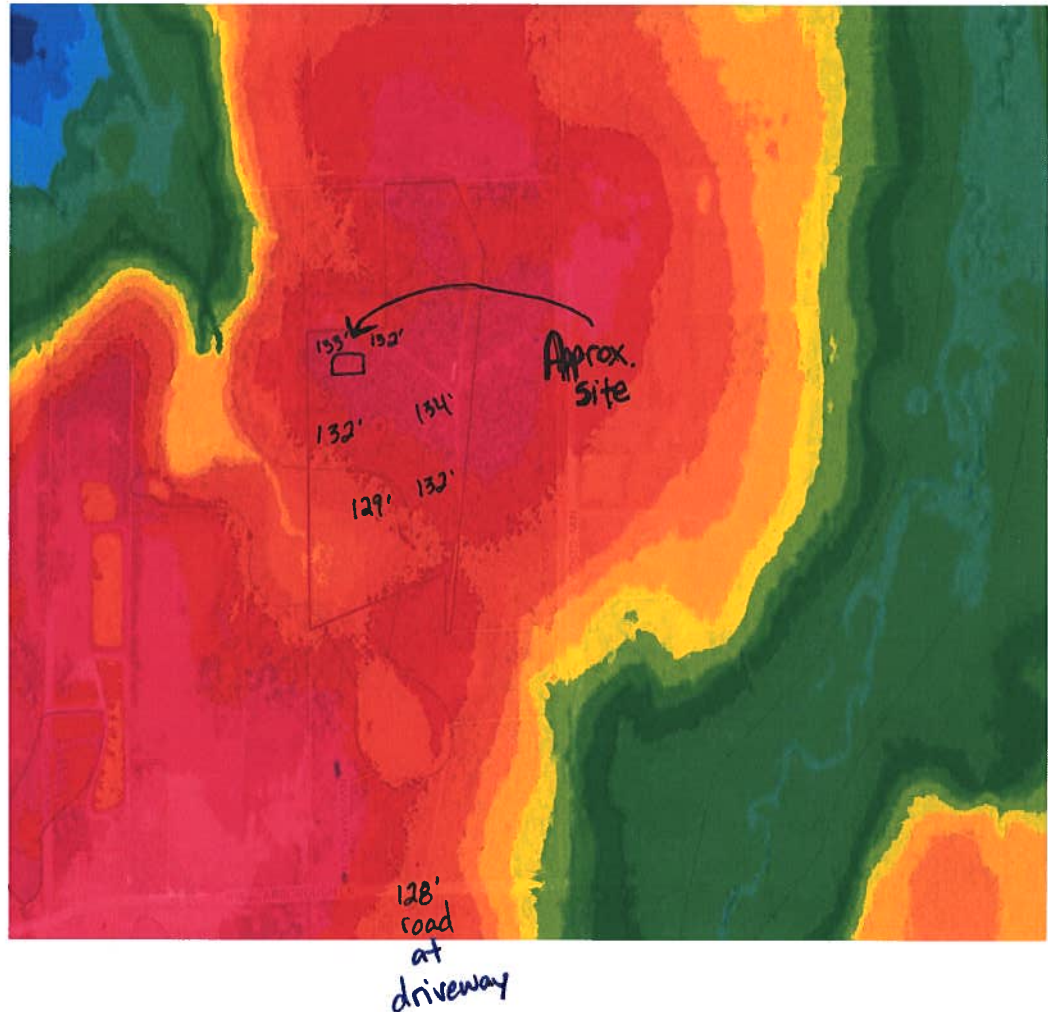

Parcel Information

Parcel No: 27-2S-16-01754-001

Owner: NEWTON JESSIE R

Subdivision:

Lot:

Acres: 24.72381

Deed Acres: 24 Ac

District: District 1 Ronald Williams

Future Land Uses: Agriculture - 3

Flood Zones: A,

Official Zoning Atlas: A-3

All data, information, and maps are provided "as is" without warranty or any representation of accuracy, timeliness of completeness. Columbia County, FL makes no warranties, express or implied, as to the use of the information obtained here. There are no implied warranties of merchantability or fitness for a particular purpose. The requester acknowledges and accepts all limitations, including the fact that the data, information, and maps are dynamic and in a constant state of maintenance, and update.