

DATE 04/25/2006

Columbia County Building Permit

PERMIT
000024430

This Permit Expires One Year From the Date of Issue

APPLICANT GREG BERRY PHONE 850-769-7883
ADDRESS 5206 KIRKLAND LAKE PANAMA CITY FL 32404
OWNER LAKE CITY MOTEL 8, MANHATTAN LOAN CO PHONE 752-6450
ADDRESS 3954 SW SR 47 LAKE CITY FL 32024
CONTRACTOR GREG BERRY PHONE 752-6450
LOCATION OF PROPERTY 47S, TO MOTEL 8, ON RIGHT @ 242

TYPE DEVELOPMENT RE-ROOF EXISTING BLG ESTIMATED COST OF CONSTRUCTION 79000.00
HEATED FLOOR AREA TOTAL AREA HEIGHT STORIES 2
FOUNDATION WALLS ROOF PITCH FLOOR
LAND USE & ZONING CHI MAX. HEIGHT 35
Minimum Set Back Requirments: STREET-FRONT REAR SIDE
NO. EX.D.U. 1 FLOOD ZONE NA DEVELOPMENT PERMIT NO.

PARCEL ID 30-4S-17-08887-000 SUBDIVISION
LOT BLOCK PHASE UNIT TOTAL ACRES 4.88

CCC057892
Culvert Permit No. Culvert Waiver Contractor's License Number Applicant/Owner/Contractor
EXISTING X06-0142 LH JH N
Driveway Connection Septic Tank Number LU & Zoning checked by Approved for Issuance New Resident

COMMENTS: RE-ROOF EXISTING BUSINESS, NOC ON FILE

Check # or Cash 1513

FOR BUILDING & ZONING DEPARTMENT ONLY

(footer/Slab)

Temporary Power date/app. by Foundation date/app. by Monolithic date/app. by
Under slab rough-in plumbing date/app. by Slab date/app. by Sheathing/Nailing date/app. by
Framing date/app. by Rough-in plumbing above slab and below wood floor date/app. by
Electrical rough-in date/app. by Heat & Air Duct date/app. by Peri. beam (Lintel) date/app. by
Permanent power date/app. by C.O. Final date/app. by Culvert date/app. by
M/H tie downs, blocking, electricity and plumbing date/app. by Pool date/app. by
Reconnection date/app. by Pump pole date/app. by Utility Pole date/app. by
M/H Pole date/app. by Travel Trailer date/app. by Re-roof date/app. by

BUILDING PERMIT FEE \$ 395.00 CERTIFICATION FEE \$ 0.00 SURCHARGE FEE \$ 0.00
MISC. FEES \$ 0.00 ZONING CERT. FEE \$ FIRE FEE \$ 0.00 WASTE FEE \$
FLOOD DEVELOPMENT FEE \$ FLOOD ZONE FEE \$ CULVERT FEE \$ TOTAL FEE 395.00
INSPECTORS OFFICE L. JH CLERKS OFFICE CN

NOTICE: IN ADDITION TO THE REQUIREMENTS OF THIS PERMIT, THERE MAY BE ADDITIONAL RESTRICTIONS APPLICABLE TO THIS PROPERTY THAT MAY BE FOUND IN THE PUBLIC RECORDS OF THIS COUNTY. AND THERE MAY BE ADDITIONAL PERMITS REQUIRED FROM OTHER GOVERNMENTAL ENTITIES SUCH AS WATER MANAGEMENT DISTRICTS, STATE AGENCIES, OR FEDERAL AGENCIES.

"WARNING TO OWNER: YOUR FAILURE TO RECORD A NOTICE OF COMMENCEMENT MAY RESULT IN YOUR PAYING TWICE FOR IMPROVEMENTS TO YOUR PROPERTY. IF YOU INTEND TO OBTAIN FINANCING, CONSULT WITH YOUR LENDER OR AN ATTORNEY BEFORE RECORDING YOUR NOTICE OF COMMENCEMENT."

This Permit Must Be Prominently Posted on Premises During Construction

PLEASE NOTIFY THE COLUMBIA COUNTY BUILDING DEPARTMENT AT LEAST 24 HOURS IN ADVANCE OF EACH INSPECTION, IN ORDER THAT IT MAY BE MADE WITHOUT DELAY OR INCONVIENCE, PHONE 758-1008. THIS PERMIT IS NOT VALID UNLESS THE WORK AUTHORIZED BY IT IS COMMENCED WITHIN 6 MONTHS AFTER ISSUANCE.

The Issuance of this Permit Does Not Waive Compliance by Permittee with Deed Restrictions.

APR-25-2006 03:284 FROM:

TO:17709391419

P.1

FROM :COLUMBIA CO BUILDING + ZONING FAX NO. :386-758-2164

Apr. 24 2006 12:06PM P2

Columbia County Building Permit Application

Revised 9-23-04

For Office Use Only Application # 0604-76 Date Received 4/25/06 By LH Permit # 24430
Application Approved by - Zoning Official _____ Date _____ Plans Examiner _____ Date _____
Flood Zone _____ Development Permit _____ Zoning _____ Land Use Plan Map Category _____
Comments NOC Super 8 Motel

Applicant's Name Manhattan Loan Company Phone 386-752-6450
Address 3954 54th State Rd 47, Lake City, FL 32024
Owners Name Manhattan Loan Company Phone 386-752-6450
911 Address 3954 54th State Rd 47, Lake City, FL 32024
Contractors Name Greg's Roofing of Bay County Phone 850-769-7883
Address 5206 Kirkland Lake, Panama City, FL 32404
Fee Simple Owner Name & Address _____
Bonding Co. Name & Address _____
Architect/Engineer Name & Address _____
Mortgage Lenders Name & Address Zions Bank, 144th Main, Lake City, UT.
Circle the correct power company - FL Power & Light - Clay Elec. - Suwannee Valley Elec. - Progressive Energy
Property ID Number 30-45-17-08897-000 Estimated Cost of Construction \$79,000
Subdivision Name _____ Lot _____ Block _____ Unit _____ Phase _____
Driving Directions NW of I-75 & State Road 47, about 10 miles south of downtown Lake City
Type of Construction Masonry or Concrete slab Number of Existing Dwellings on Property 3
Total Acreage 4.88 Lot Size _____ Do you need a - Current Permit or Current Worker or Have an Existing Drive
Actual Distance of Structure from Property Lines - Front _____ Side _____ Side _____ Rear _____
Total Building Height _____ Number of Stories 2 Heated Floor Area 2 Roof Pitch _____

Application is hereby made to obtain a permit to do work and installations as indicated. I certify that no work or installation has commenced prior to the issuance of a permit and that all work be performed to meet the standards of all laws regulating construction in this jurisdiction.

OWNERS AFFIDAVIT: I hereby certify that all the foregoing information is accurate and all work will be done in compliance with all applicable laws and regulating construction and zoning.

WARNING TO OWNER: YOUR FAILURE TO RECORD A NOTICE OF COMMENCEMENT MAY RESULT IN YOU PAYING TWICE FOR IMPROVEMENTS TO YOUR PROPERTY. IF YOU INTEND TO OBTAIN FINANCING, CONSULT WITH YOUR LENDER OR ATTORNEY BEFORE RECORDING YOUR NOTICE OF COMMENCEMENT.

Owner Builder or Agent (including Contractor) Ken C. Kloss
STATE OF FLORIDA
COUNTY OF COLUMBIA
Sworn to (or affirmed) and subscribed before me
this 25th day of April, 2006
Personally known _____ or Produced Identification _____



Contractor Signature Greg By
Contractors License Number CC057892
Competency Card Number _____
NOTARY STAMP/SEAL

Notary Signature _____



STATE OF FLORIDA

AC# 1432817

DEPARTMENT OF BUSINESS AND
PROFESSIONAL REGULATION

CCC057892

06/03/04 030700485

CERTIFIED ROOFING CONTRACTOR
BERRY, GREGORY LADON
GREG'S ROOFING OF BAY CO INC

IS CERTIFIED under the provisions of Ch.489 FS.

Expiration date: AUG 31, 2006

L04060301297

PRODUCT APPROVAL SPECIFICATION SHEET

As required by Florida Statute 553.842 and Florida Administrative Code 8B-72, please provide the information and approval numbers on the building components listed below if they will be utilized on the construction project for which you are applying for a building permit. We recommend you contact your local product supplier should you not know the product approval number for any of the applicable listed products. Statewide approved products are listed online @ www.floridabuilding.org

Category/Subcategory	Manufacturer	Product Description	Approval Number(s)
1. EXTERIOR DOORS			
A. SWINGING			
B. SLIDING			
C. SECTIONAL/ROLL UP			
D. OTHER			
2. WINDOWS			
A. SINGLE/DOUBLE HUNG			
B. HORIZONTAL SLIDER			
C. CASEMENT			
D. FIXED			
E. MULLION			
F. SKYLIGHTS			
G. OTHER			
3. PANEL WALL			
A. SIDING			
B. SOFFITS			
C. STOREFRONTS			
D. GLASS BLOCK			
E. OTHER			
4. ROOFING PRODUCTS			
A. ASPHALT SHINGLES	TAMKO	HERITAGE 30	FL 1956
B. NON-STRUCT METAL			
C. ROOFING TILES			
D. SINGLE PLY ROOF			
E. OTHER UNDERLAYMENT	INTER WRAP	TITANIUM	FL 1468
5. STRUCT COMPONENTS			
A. WOOD CONNECTORS			
B. WOOD ANCHORS			
C. TRUSS PLATES			
D. INSULATION FORMS			
E. LINTELS			
F. OTHERS			
6. NEW EXTERIOR ENVELOPE PRODUCTS			
A.			

The products listed below did not demonstrate product approval at plan review. I understand that at the time of inspection of these products, the following information must be available to the inspector on the jobsite: 1) copy of the product approval, 2) performance characteristics which the product was tested and certified to comply with, 3) copy of the applicable manufacturers installation requirements. Further, I understand these products may have to be removed if approval cannot be demonstrated during inspection.

APPLICANT SIGNATURE

25 April 06
DATE

@ CAM112M01 S CamaUSA Appraisal System
 4/25/2006 13:13 Legal Description Maintenance
 Year T Property Sel
 2006 R 30-4S-17-08887-000
 SUPER 8 OF LAKE CITY
 MANHATTAN LOAN COMPANY

	Columbia	County
345420	Land	001 *
	AG	000
944105	Bldg	002 *
70924	Xfea	005 *
1360449	TOTAL	B*

1	COMM NW COR OF NW1/4 OF NW1/4,,	RUN E 1020.15 FT TO W R/W OF ..	2
3	I-75,, SE ALONG R/W 260.53 FT ..	FOR POB,, CONT S'LY ALONG R/W ..	4
5	935.34 FT,, W 196.16 FT,, S 150 ..	FT,, W 250.02 FT,, N 600.03 ..	6
7	FT,, NE 637.09 FT TO POB ..	PART OF NW1/4 OF NW1/4 ..	8
9	(PARCEL A) ORB 489-24 ..	(LAKE CITY INN) ORB 707-805 ..	10
11	WD 1025-824,, WD 1025-921 ..	(CORRECTIVE DEED ORB 1029-622)	12
13			14
15			16
17			18
19			20
21			22
23			24
25			26
27			28

Mnt 1/11/2005 LARRY

F1=Task F3=Exit F4=Prompt F10=GoTo PgUp/PgDn F24=More

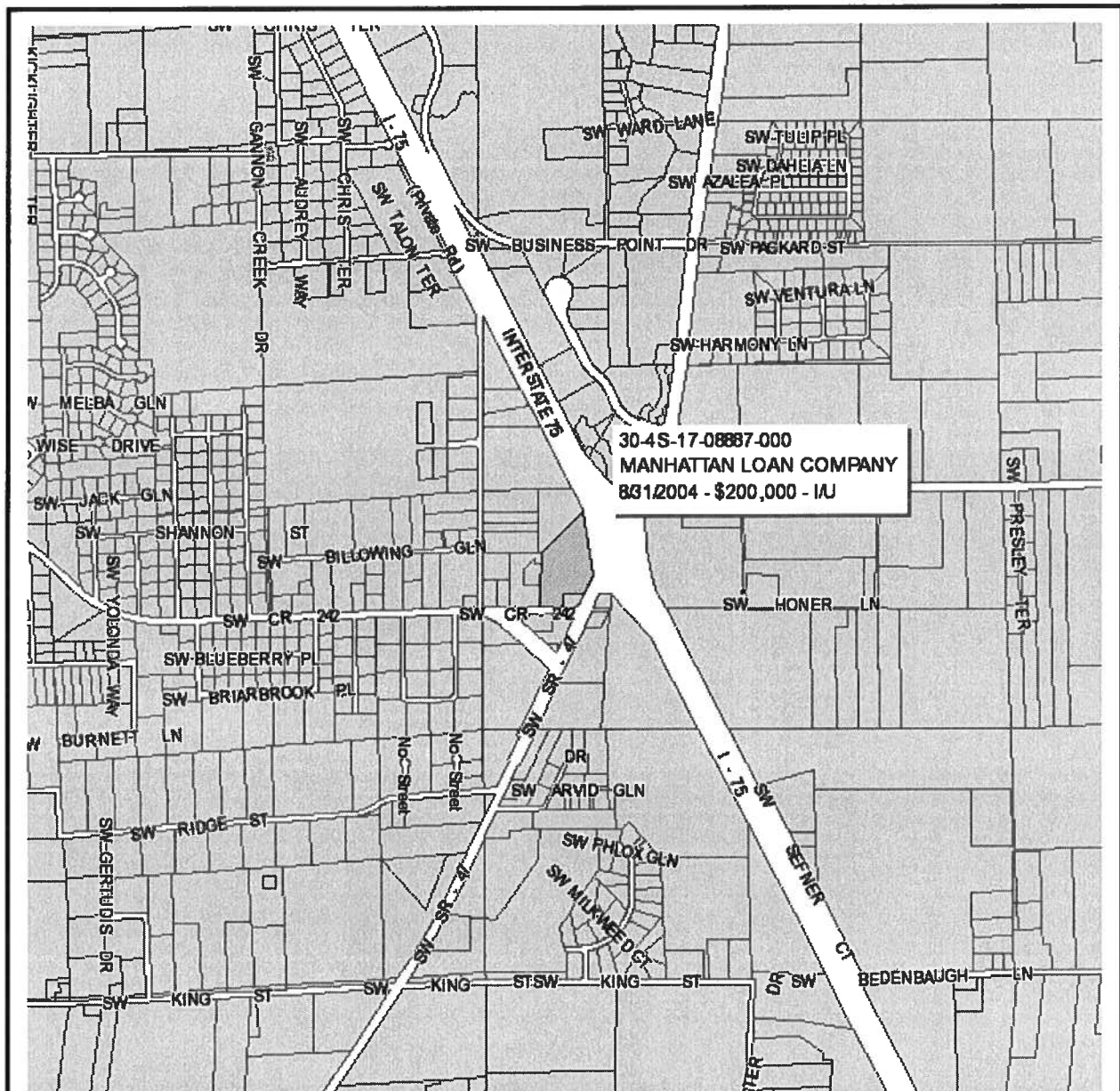

Columbia County Property Appraiser

J. Doyle Crews, CFA - Lake City, Florida - 386-758-1083

PARCEL: 30-4S-17-08887-000 - HOTELS AND (003900)

COMM NW COR OF NW1/4 OF NW1/4, RUN E 1020.15 FT TO W R/W OF I-75, SE ALONG R/W 260.53 FT

Name: MANHATTAN LOAN COMPANY	LandVal	\$345,420.00
Site: SUPER 8 OF LAKE CITY	BldgVal	\$944,105.00
Mail: 2200 NORTHLAKE PKWY STE 277	ApprVal	\$1,360,449.00
TUCKER, GA 30084	JustVal	\$1,360,449.00
Sales 8/31/2004 \$200,000.00 / U	Assd	\$1,360,449.00
Info 8/31/2004 \$1,400,000.00 / U	Exmpt	\$0.00
1/16/1990 \$950,000.00 / Q	Taxable	\$1,360,449.00

0 0.1 0.2 0.3 mi



This information, GIS Map Updated: 4/6/2006, was derived from data which was compiled by the Columbia County Property Appraiser Office solely for the governmental purpose of property assessment. This information should not be relied upon by anyone as a determination of the ownership of property or market value. No warranties, expressed or implied, are provided for the accuracy of the data herein, its use, or its interpretation. Although it is periodically updated, this information may not reflect the data currently on file in the Property Appraiser's office. The assessed values are NOT certified values and therefore are subject to change before being finalized for ad valorem assessment purposes.

**NOTICE OF COMMENCEMENT FORM
COLUMBIA COUNTY, FLORIDA**

*****THIS DOCUMENT MUST BE RECORDED AT THE COUNTY
CLERKS OFFICE BEFORE YOUR FIRST INSPECTION.*****

THE UNDERSIGNED hereby gives notice that improvement will be made to certain real property, and in accordance with Chapter 713, Florida Statutes, the following information is provided in this Notice of Commencement.

Tax Parcel ID Number 30-45-17-08887-000

PERMIT NUMBER 24430

1. Description of property: (legal description of the property and street address or 911 address)

Route 5, Box 3005 (NWQ of I-75 @ SR 47
Rake City, FL 32024
County Parcel # 30-45-17-08887-000

2. General description of improvement: Motel complex containing a one-story
commercial building, and a two-story guest rooms building

3. Owner Name & Address: Manhattan Swan Company
2200 Northlake Pkwy, Tucker, Ga

Interest in Property Owner

4. Name & Address of Fee Simple Owner (if other than owner):

5. Contractor Name Greg's Roofing of Bay County

Phone Number 850-769-7883

Address 5206 Kirkland Rd, Panama City, FL 32404

6. Surety Holders Name

Address

Amount of Bond

Inst:2006010413 Date:05/01/2006 Time:09:42

DC, P. DeWitt Cason, Columbia County B:1082 P:271

7. Lender Name

Address

8. Persons within the State of Florida designated by the Owner upon whom notices or other documents may be served as provided by section 718.13 (1)(a) 7: Florida Statutes:

Name Scott Harrell

Phone Number 770-329-3612

Address 6523 US Hwy 19, New Port Richey, FL 34652

9. In addition to himself/herself the owner designates

_____ of _____ to receive a copy of the Lienor's Notice as provided in Section 713.13 (1) -

(a) 7. Phone Number of the designee

10. Expiration date of the Notice of Commencement (the expiration date is 1 (one) year from the date of recording, (Unless a different date is specified))

NOTICE AS PER CHAPTER 713, Florida Statutes:

The owner must sign the notice of commencement and no one else may be permitted to sign in his/her stead.

Scott Harrell, President
Signature of Owner

Sworn to (or affirmed) and subscribed before me on April 20, 2006

