



STATE OF FLORIDA
DEPARTMENT OF ENVIRONMENTAL PROTECTION
ONSITE SEWAGE TREATMENT AND DISPOSAL
SYSTEM (OSTDS)

PERMIT NO. 24-0009
DATE PAID: 1-12-24
FEE PAID: 185.80
RECEIPT #: 2033047

APPLICATION FOR CONSTRUCTION PERMIT

APPLICATION FOR:

☒ New System ☐ Existing System ☐ Holding Tank ☐ Innovative
☒ Repair ☐ Abandonment ☐ Temporary ☐

APPLICANT: Don Downs EMAIL: liveoakspoiled@aol.com

AGENT: Suwannee Septic and Sitework TELEPHONE: 239-910-7555

MAILING ADDRESS: 18081 185th Rd Live Oak, FL 32060

TO BE COMPLETED BY APPLICANT OR APPLICANT'S AUTHORIZED AGENT. SYSTEMS MUST BE CONSTRUCTED BY A PERSON LICENSED PURSUANT TO 489.105(3)(m) OR 489.552, FLORIDA STATUTES. IT IS THE APPLICANT'S RESPONSIBILITY TO PROVIDE DOCUMENTATION OF THE DATE THE LOT WAS CREATED OR PLATTED (MM/DD/YY) IF REQUESTING CONSIDERATION OF STATUTORY GRANDFATHER PROVISIONS.

PROPERTY INFORMATION

OSTDS REMEDIATION PLAN? [Y / ☒ N]

LOT: 12 BLOCK: 03551603457 D12 SUBDIVISION: Plantation Park PLATTED: 12/31/2017

PROPERTY ID #: 12-46-17-08332-038 ZONING: Res I/M OR EQUIVALENT: ☐ ☒

PROPERTY SIZE: 1.05 ACRES WATER SUPPLY: ☒ PRIVATE PUBLIC ☐ ≤2000GPD ☐ >2000GPD

IS SEWER AVAILABLE AS PER 381.0065, FS? [Y / ☒] DISTANCE TO SEWER: 500+ FT

PROPERTY ADDRESS: 375 SW Kimdale Loop. Lake City, FL 32025

DIRECTIONS TO PROPERTY: Turn right on Hwy 90 heading West. Turn left on SW Sisters Welcome Rd. Turn right on SW Kings St. Turn left on SW Mauldin St. Turn left on SW Dockery Ln. Turn right on SW Kimdale Loop.

BUILDING INFORMATION

☒ RESIDENTIAL ☐ COMMERCIAL

Unit No	Type of Establishment	No. of Bedrooms	Building Area Sqft	Commercial/Institutional System Design Table I, Chapter 62-6, FAC
1	Manufactured home	2	620	<u>Orig Attached</u>
2				
3				
4				

[] Floor/Equipment Drains [] Other (Specify) _____

SIGNATURE: Don Downs DATE: 1/2/2024

DEP 4015, 06-21-2022 (Obsoletes previous editions which may not be used)

Incorporated 62-6.004, FAC

Permit Application Number:

29-0029

Scale: Each block represents 10 feet and 1 inch = 40 feet.

This image shows a full page of blank graph paper. The grid consists of small squares formed by thin green lines. There are approximately 20 columns and 25 rows of squares across the page. The background is white, and the grid covers almost the entire area, leaving a small margin at the top and bottom.

Notes:

Site Plan submitted by:

Dal Cruto

Plan Approved.

Not Approved

Date _____

1/11/24

By _____

✓ 300

1582

Columbia

County Health Department

Incorporated: 62-6.004, F.A.C.

24-0029

1"=60'

Don Downs
375 SW Kimdale Loop
Lake City, FL 32025
03-55-16-03457-012

No offsite features
within 75'

456.59

449.26

Home w/
Septic & city
water

Home w/
Septic & city water

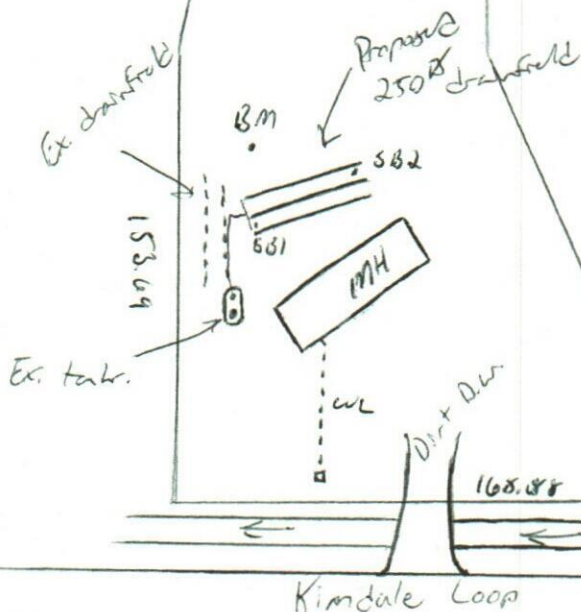

Septic Site Plan
drawn by
M. J. [Signature]
1/5/24
CEMP # 23-2182