



STATE OF FLORIDA
DEPARTMENT OF ENVIRONMENTAL PROTECTION
ONSITE SEWAGE TREATMENT AND DISPOSAL
SYSTEM (OSTDS)

PERMIT NO. 24-0441
DATE PAID: 5/24/24
FEE PAID: 400.00
RECEIPT #: 2072905

APPLICATION FOR CONSTRUCTION PERMIT

APPLICATION FOR:

☐ New System ☒ Existing System ☐ Holding Tank ☐ Innovative
☐ Repair ☐ Abandonment ☐ Temporary ☐

APPLICANT: Karen McKee EMAIL: Karenmckee@yahoo.com

AGENT: Self TELEPHONE: 716 5600151

MAILING ADDRESS: 2903 SW. Pinemount Rd, Lake City, Florida 32024

TO BE COMPLETED BY APPLICANT OR APPLICANT'S AUTHORIZED AGENT. SYSTEMS MUST BE CONSTRUCTED BY A PERSON LICENSED PURSUANT TO 489.105(3)(m) OR 489.552, FLORIDA STATUTES. IT IS THE APPLICANT'S RESPONSIBILITY TO PROVIDE DOCUMENTATION OF THE DATE THE LOT WAS CREATED OR PLATTED (MM/DD/YY) IF REQUESTING CONSIDERATION OF STATUTORY GRANDFATHER PROVISIONS.

PROPERTY INFORMATION

OSTDS REMEDIATION PLAN? ☐ Y ☒ N

LOT: _____ BLOCK: _____ SUBDIVISION: _____ PLATTED: _____

PROPERTY ID #: 08-45-16-02816-033 ZONING: _____ I/M OR EQUIVALENT: ☐ Y ☒ N

PROPERTY SIZE: 7.84 ACRES WATER SUPPLY: ☒ PRIVATE PUBLIC ☐ <=2000GPD ☐ >2000GPD

IS SEWER AVAILABLE AS PER 381.0065, FS? ☐ Y ☒ N DISTANCE TO SEWER: _____ FT

PROPERTY ADDRESS: 2903 SW. Pinemount Road, Lake City, Florida 32024

DIRECTIONS TO PROPERTY: From US 90 (toward Live Oak) - turn left on SW County Rd 252B, in 262', turn right onto SW Deputy J Davis Lane - .9m turn left onto SW. Pinemount Rd. Drive 2.1 miles, on left before Christian Academy

BUILDING INFORMATION

☒ RESIDENTIAL

☐ COMMERCIAL

Unit No.	Type of Establishment	No. of Bedrooms	Building Area Sqft	Commercial/Institutional System Design Table I, Chapter 62-6, FAC
1	<u>enclosed carport</u>	<u>2</u>	<u>600</u>	
2				
3				
4				

☐ Floor/Equipment Drains ☐ Other (Specify) _____

SIGNATURE: [Signature] DATE: 24 May 2024

DEP 4015, 06-21-2022 (Obsoletes previous editions which may not be used)

Incorporated 62-6.004, FAC

Page 1 of 4

STATE OF FLORIDA
DEPARTMENT OF ENVIRONMENTAL PROTECTION
APPLICATION FOR CONSTRUCTION PERMIT

Permit Application Number 24-0442

----- PART II - SITEPLAN -----

Scale: Each block represents 10 feet and 1 inch = 40 feet.

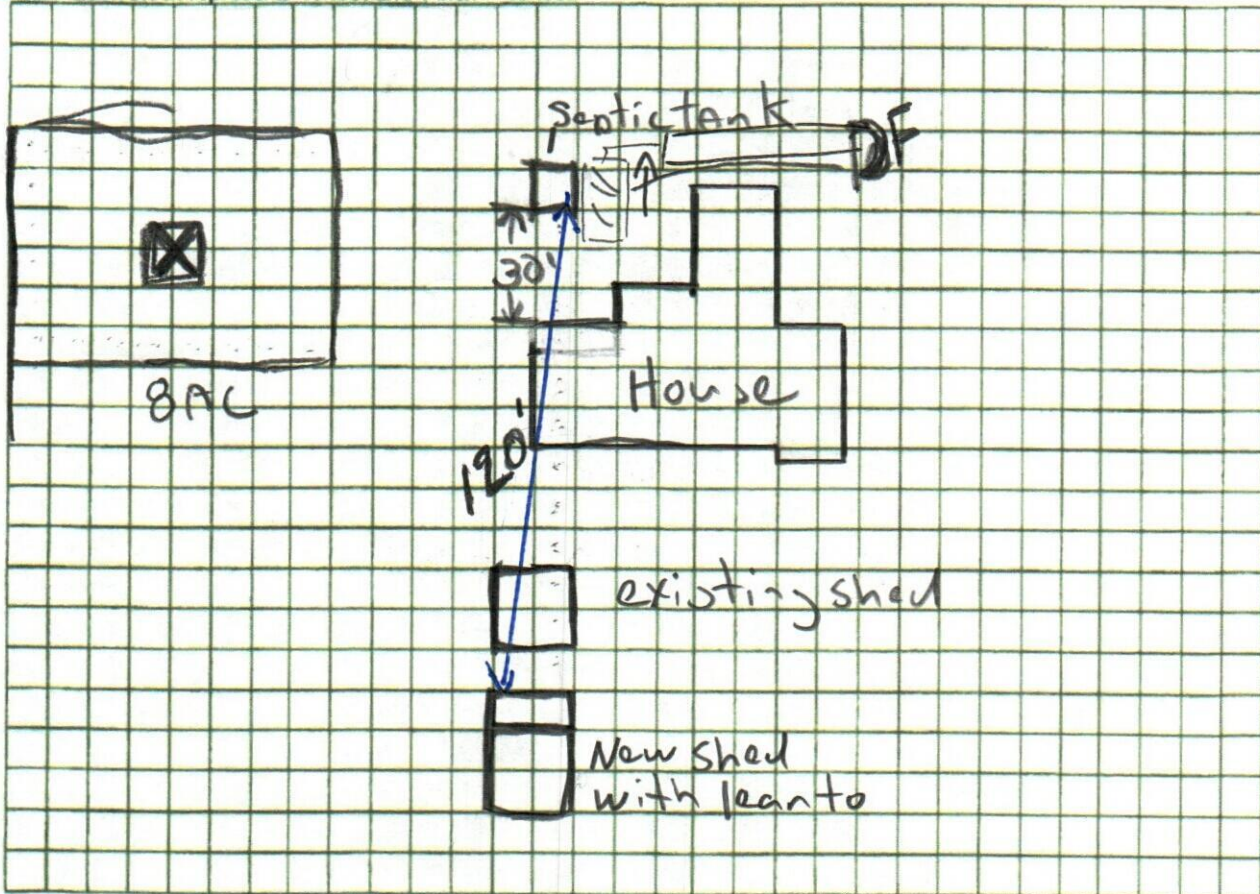

Notes: _____

Site Plan submitted by: [Signature]

Plan Approved ✓

Not Approved _____

Date 5/30/24

By [Signature]

ES2

Columbia

County Health Department

ALL CHANGES MUST BE APPROVED BY THE COUNTY HEALTH DEPARTMENT

DEP 4015, 06-21-2022 (Obsoletes previous editions which may not be used)

Incorporated: 62-6.004, F.A.C.