

2nd Floor Framing PLAN

SCALE: 1/4" = 1'-0"

WOOD STRUCTURAL NOTES

1. TEMPORARY BRACING OF THE STRUCTURE DURING ERECTION, REQUIRED FOR SAFE AND STABLE CONSTRUCTION, SHALL BE THE SOLE RESPONSIBILITY OF THE CONTRACTOR SO ENGAGED. TEMPORARY & PERMANENT BRACING OF ROOF TRUSSES SHALL BE AS PER THE STANDARD GUIDELINES OF THE "TRUSS PLATE INSTITUTE".
2. ALL TRUSSES SHALL BE DESIGNED BY A LICENSED PROFESSIONAL ENGINEER & SHALL BE SIGNED AND SEALED BY SAME. TRUSS DESIGN SHALL INCLUDE PLACEMENT PLANS, TRUSS DETAILS, TRUSS TO TRUSS CONNECTIONS & THE STANDARD SPECIFICATIONS & RECOMMENDATIONS OF INSTALLATION OF THE "TRUSS PLATE INSTITUTE".
3. WOOD STUDS IN EXTERIOR WALLS & INTERIOR BEARING WALLS SHALL BE NOT LESS THAN #2 HEM-FIR OR BETTER.
4. CONNECTORS FOR WOOD FRAMING SHALL BE GALVANIZED METAL OR BLACK METAL AS MANUFACTURED OR AS CALLED FOR IN THE PLANS AND BE OF A DESIGN SUITABLE FOR THE LOADS AND USE INTENDED. REFER TO THE JOINT REINFORCEMENT SCHEDULE FOR PRINCIPLE CONNECTIONS.

FRAMING ANCHOR SCHEDULE

APPLICATION	MANUFACTURER	CAP.
RAFTER TO WALL:	USP HDPT2, W/ 6 - 10d NAILS	960°
TJI TO WALL:	USP HDPT2, W/ 6 - 10d NAILS	960°
RAFTER TO RIDGE:	SIMPSON L68U210, W/ L6TA18	815°
TJI TO RIDGE:	SIMPSON L68U135, W/ L6TA18	815°
PORCH RAFTER TO BEAM:	USP HDPT2, W/ 6 - 10d NAILS	960°
PORCH RAFTER TO MAIN ROOF:	SIMPSON H6	950°
PORCH RAFTER TO DORMER WALL:	SIMPSON H8	145°
MISC. JOINTS	SIMPSON A34	315°/240°

NOTE:
ALL ANCHORS SHALL BE SECURED W/ NAILS AS PRESCRIBED BY THE MANUFACTURER FOR MAXIMUM JOINT STRENGTH, UNLESS NOTED OTHERWISE.

NOTE:
REFER TO THE INCLUDED STRUCTURAL DETAILS FOR ADDITIONAL ANCHORS/ JOINT REINFORCEMENT AND FASTENERS.

NOTE:
ALL UNLISTED JOINTS IN THE LOAD PATH SHALL BE REINFORCED WITH SIMPSON A34 FRAMING ANCHORS, TYPICAL T.O.

NOTE:
"SEMCO" PRODUCT APPROVAL:
MIAMI/DADE COUNTY REPORT #35-081815

NOTE:
"SIMPSON" PRODUCT APPROVALS:
MIAMI/DADE COUNTY REPORT #31-010705, #36-112611, #33-062304
SBCCI NER-443, NER-393

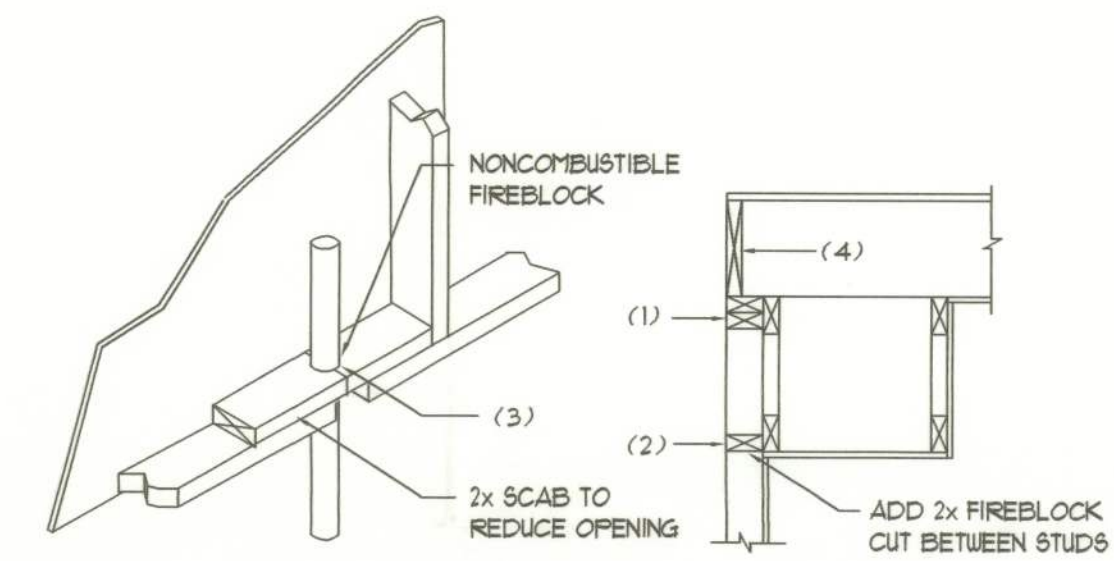

PENETRATIONS

SOFFIT/DROPPED CLG.

FIREBLOCKING NOTES:

- FIREBLOCKING SHALL BE INSTALLED IN WOOD FRAME CONSTRUCTION IN THE FOLLOWING LOCATIONS:
1. IN CONCEALED SPACES OF STUD WALLS & PARTITIONS INCLUDING FURRED SPACES AT CEILING AND FLOOR LEVELS.
 2. AT ALL INTERCONNECTIONS BETWEEN CONCEALED VERTICAL AND HORIZONTAL SPACES SUCH AS OCCUR AT SOFFITS, DROP CEILINGS, COVE CEILINGS, ETC.
 3. AT OPENINGS AROUND VENTS, PIPES, DUCTS, CHIMNEYS AND FIREPLACES AT CEILING AND FLOOR LEVELS WITH "FYTROPANEL MULTIFLEX SEALANT".
 4. AT ALL INTERCONNECTIONS BETWEEN CONCEALED VERTICAL STUD WALL OR PARTITION SPACES AND CONCEALED SPACES CREATED BY AN ASSEMBLY OF FLOOR JOISTS, FIREBLOCKING SHALL BE PROVIDED FOR THE FULL DEPTH OF THE JOISTS AT THE ENDS AND OVER THE SUPPORTS.

Fire Stopping DETAILS

SCALE: NONE

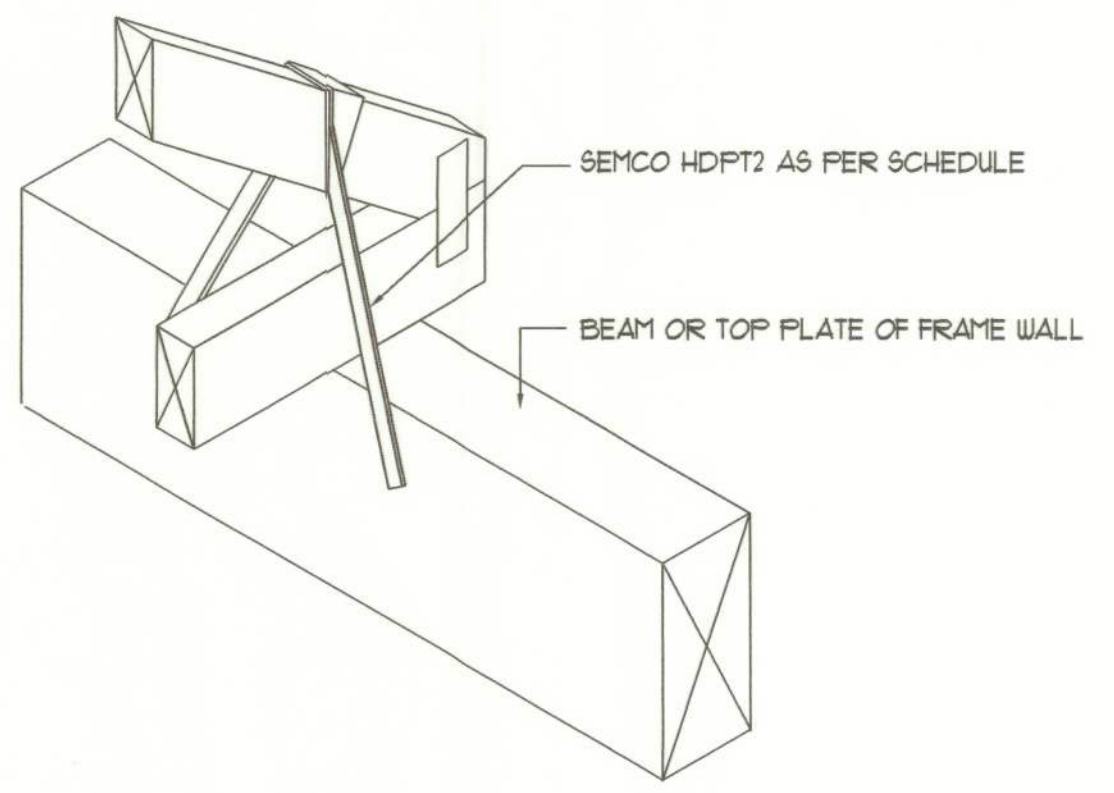

SEMCO HDPT2

SCALE: 1/2" = 1'-0" TRUSS TO WOOD BEAM

FLORIDA BUILDING CODE

Compliance Summary

TYPE OF CONSTRUCTION
 Roof: Gable Construction, Conventional Framing @ 16" O.C., Wood Trusses @ 24" O.C.
 Walls: 2x6 Wood Studs @ 16" O.C.
 Floor: 4" THK. Concrete Slab W/ Fibermesh Concrete Additive
 Foundation: Continuous Footer/Stem Wall

ROOF DECKING
 Material: 1/2" CD Plywood or 1/6" OSB.
 Sheet Size: 48"x96" Sheets Perpendicular to Roof Framing
 Fasteners: 8d Common Nails per schedule on sheet SD.4

SHEAR WALLS
 Material: 1/6" OSB, "WindStorm" Wall Sheathing
 Sheet Size: 48" x 125 1/8" Sheets Placed Vertical (trimmed as required)
 Fasteners: 8d Common Nails @ 4" O.C. Edges & 8" O.C. Interior
 Dragstrut: Double Top Plate (5YP) W/ 16d Nails @ 12" O.C.
 Wall Studs: 2x4 Hem Fir Studs @ 16" O.C.

HURRICANE UPLIFT CONNECTORS
 Roof Framing Anchors: "USP" HDPT2 @ Ea. Truss End (Typ. U.O.N.)
 Wall Tension: Wall Sheathing Nailing Is Adequate - 8d @ 4" O.C. Top & Bot.
 Anchor Bolts: 1/2" A307 Bolts @ 48" O.C. - 1st Bolt 6" from corner
 Corner Hold-down Device: (1) HD5a @ each corner
 Porch Column Base Connector: Simpson ABU44 @ each column
 Porch Column to Beam Connector: Simpson EPC44/PC44 @ each column

FOOTINGS AND FOUNDATIONS
 Footing: 20"x12" Cont. W/ 2-#5 Bars Cont. & wire chairs @ 32" O.C.
 Stemwall: 8" C11W W/ 1-#5 Vertical Dowel @ 48" O.C.

ALL WIND LOADS ARE IN ACCORDANCE WITH SECTION 1606, FLORIDA BUILDING CODE, 2004 EDITION.	
BASIC WIND SPEED:	110 MPH
WIND IMPORTANCE FACTOR (I):	I = 1.00
BUILDING CATEGORY:	CATEGORY II
WIND EXPOSURE:	"B"
INTERNAL PRESSURE COEFFICIENT:	+/- 0.18
MUFRS PER TABLE 1606.2A (FBC 2001)	ROOF: - 23.1 PSF
DESIGN WIND PRESSURES:	WALLS: + 26.6 PSF
	EAVES: - 32.3 PSF
COMPONENTS & CLADDING PER TABLES 1606.2B & 1606.2C (FBC 2001)	OPNGS: + 21.8 / - 23.1 PSF
DESIGN WIND PRESSURES:	EAVES: - 68.3 PSF
	ROOF: + 19.3 / - 25.5 PSF

REVISIONS

Wm C. Foster
 ALTERNATE CONVENTIONAL ROOF FRAMING OF RESIDENCE FOR:
ED & JUDY FOSTER
 PROJECT ADDRESS: 410 SE MYRTLE DOROTHY TERRACE, LAKE CITY, FLORIDA 32075

10 OCT 2005
 AR0007005

NICHOLAS PAUL GEISLER
 ARCHITECT
 N.C.A.R.B. Certified
 1758 NW Brown Rd.
 Lake City, FL 32055
 386-755-9021

JOINT VENTURED WITH

© **WILLIAM MYERS DESIGN**
 P.O. BOX 513
 LAKE CITY, FL 32068
 (386) 758-8406
 will@willmyers.net



JOB NUMBER
2K547
 DATE:
26 SEP 2005

SHEET NUMBER
SD.1
 OF 4 SHEETS