

April 13, 2023

Chambliss Steel Buildings
C/O MCM Inc.
155 SW August Glenn
Lake City, FL 32025

Subject: Parcel # 09553-055 - Elevation Letter

Dear Mr. Chambliss:

Daniel & Gore, LLC has performed a vertical survey on Parcel 09553-055, Columbia County, Florida from a benchmark being a FDOT concrete monument 2908002 BM (elevation – 96.92', NAVD 1988) and have determined the following:

- The elevation of the Finished Floor is at 68.3'.
- The elevation of the ground elevation at the NW corner of the building is at 67.9'.
- The elevation of the ground elevation at the NE corner of the building is at 67.6'.
- The elevation of the ground elevation at the SE corner of the building is at 67.6'.

If you have any questions, please call me.

Sincerely,

Scott Daniel, PSM

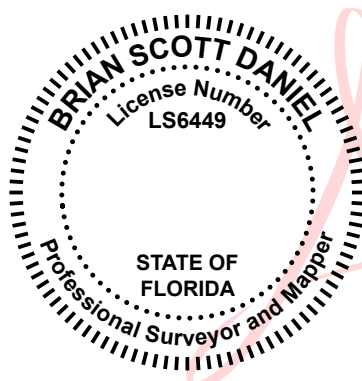

Digitally signed
by Brian S Daniel
Date: 2023.04.13
13:53:42 -04'00'