

COLUMBIA COUNTY

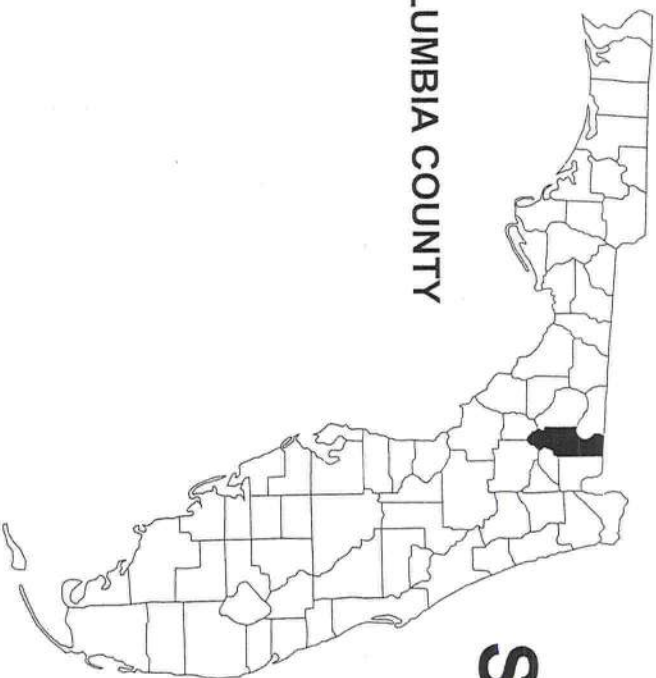

MINI STORAGE SITE EXPANSION 2 COLUMBIA COUNTY, FL SECTION 18, TOWNSHIP 4S, RANGE 17E



PROJECT LOCATION

PLANS PREPARED FOR:

MINI STORAGE & RECORD STORAGE OF LAKE CITY
442 SW SAINT MARGARET ST
LAKE CITY, FL 32025
386-752-7092



- SHEET INDEX**
- | | |
|----------------------|----|
| COVER SHEET | 1 |
| NOTES | 2 |
| EXISTING CONDITIONS | 3 |
| OVERALL SITE PLAN | 4 |
| SITE PLAN | 5 |
| STORMWATER PLAN | 6 |
| GRADING PLAN | 7 |
| LANDSCAPE PLAN | 8 |
| EROSION CONTROL PLAN | 9 |
| MISC. DETAILS | 10 |
| FIRE DEPARTMENT PLAN | NA |

THIS DOCUMENT HAS BEEN DIGITALLY SIGNED AND
SEALED BY:

ON THE DATE ADJACENT TO THE SEAL
PRINTED COPIES OF THIS DOCUMENT ARE NOT
CONSIDERED SIGNED AND SEALED. THE
SIGNATURE MUST BE VERIFIED IN THE
ELECTRONIC DOCUMENTS.

NORTH FLORIDA PROFESSIONAL SERVICES, INC.
P.O. BOX 3823
LAKE CITY, FL 32056
CERTIFICATE OF AUTHORIZATION: 29011
GREGORY G. BAILEY, P.E. NO. 43858

THE ABOVE NAMED PROFESSIONAL ENGINEER SHALL BE RESPONSIBLE FOR THE
FOLLOWING SHEETS IN ACCORDANCE WITH RULE 61G15-23.004, F.A.C.

FOR COUNTY SUBMITTAL ONLY
NOT FOR CONSTRUCTION
1/9/20

COVER SHEET



North Florida Professional Services, Inc.
P.O. BOX 3823 P.O. BOX 180998
Lake City, FL 32025 Tallahassee, FL 32318
Ph. 386-752-4675 Ph. 877-335-1525
Fax. 386-752-4674 Fax 1 in 29011

REVISIONS:

JOB NUMBER: L180115MIN
DESIGNED BY: KB DRAFTED BY: KB CHECKED BY: GB
DATE: 12/20/19
ENGINEER OF RECORD
GREGORY G. BAILEY
P.E. NO. 43858

SHEET NO. 1

GENERAL NOTES

1. THE CONTRACTOR SHALL VERIFY ALL EXISTING CONDITIONS AND DIMENSIONS AT THE JOB SITE TO INSURE THAT ALL NEW WORK WILL FIT IN THE MANNER INTENDED ON THE PLANS. SHOULD ANY CONDITIONS EXIST THAT ARE CONTRARY TO THOSE SHOWN ON THE PLANS, THE CONTRACTOR SHALL NOTIFY THE ENGINEER AND THE COLUMBIA COUNTY, FLORIDA (DEPARTMENT OF GROWTH MANAGEMENT) OF SUCH DIFFERENCES IMMEDIATELY AND PRIOR TO PROCEEDING WITH THE WORK.
2. THE CONTRACTOR SHALL COMPLY WITH ALL CONDITIONS AS SET FORTH BY THE ISSUED SUWANNEE RIVER WATER MANAGEMENT DISTRICT ENVIRONMENTAL RESOURCE PERMIT.
3. THE CONTRACTOR SHALL MAINTAIN THE CONSTRUCTION SITE IN A SECURE MANNER. ALL OPEN TRENCHES AND EXCAVATED AREAS SHALL BE PROTECTED FROM ACCESS BY THE GENERAL PUBLIC.
4. BOUNDARY INFORMATION SHOWN, WAS OBTAINED FROM A BOUNDARY SURVEY PREPARED BY BRITT SURVEYING.
5. ANY PUBLIC LAND CORNER WITHIN THE LIMITS OF CONSTRUCTION SHALL BE PROTECTED. IF A CORNER MONUMENT IS IN DANGER OF BEING DESTROYED AND HAS NOT BEEN PROPERLY REFERENCED, THE CONTRACTOR SHOULD NOTIFY THE ENGINEER.
6. THE SITE IS LOCATED IN SECTION 18, TOWNSHIP 4 SOUTH, RANGE 17 EAST, COLUMBIA COUNTY, FLORIDA.
7. THE CONTRACTOR SHALL IMPLEMENT ALL COMPONENTS OF THE EROSION AND SEDIMENTATION CONTROL PLAN PRIOR TO ANY EARTH DISTURBING ACTIVITIES. ALL COMPONENTS SHALL BE MAINTAINED BY THE CONTRACTOR UNTIL ALL VEGETATION IS ESTABLISHED, THE ENTIRE PROJECT AREA IS STABILIZED AND THE OWNER HAS ACCEPTED OPERATION AND MAINTENANCE.
8. ALL DISTURBED AREAS NOT SODDED SHALL BE SEEDED WITH A MIXTURE OF LONG-TERM VEGETATION AND QUICK GROWING SHORT-TERM VEGETATION FOR THE FOLLOWING CONDITIONS. FOR THE MONTHS FROM SEPTEMBER THROUGH MARCH, THE MIX SHALL CONSIST OF 70 POUNDS PER ACRE OF LONG-TERM SEED AND 20 POUNDS PER ACRE OF WINTER RYE. FOR THE MONTHS OF APRIL THOUGH AUGUST, THE MIX SHALL CONSIST OF 70 PER ACRE OF LONG-TERM SEED AND 20 POUNDS PER ACRE OF MILLET.
9. THE LOCATION OF THE UTILITIES SHOWN IN THE PLANS ARE APPROXIMATE ONLY. THE EXACT LOCATION SHALL BE DETERMINED BY THE CONTRACTOR DURING CONSTRUCTION. CONTRACTOR SHALL PROTECT ALL UTILITIES WITHIN THE PROJECT AREAS.
10. ALL SITE CONSTRUCTION SHALL BE IN ACCORDANCE WITH THE COLUMBIA COUNTY LAND DEVELOPMENT REGULATIONS.
11. CONTRACTOR SHALL REVIEW AND BECOME FAMILIAR WITH ALL REQUIRED UTILITY CONNECTIONS PRIOR TO BIDDING. CONTRACTOR SHALL PROVIDE ALL WORK AND MATERIALS REQUIRED TO COMPLETE CONNECTION TO THE EXISTING UTILITIES. THIS INCLUDES BUT IS NOT LIMITED TO MANHOLE CORING, WET TAPS, PAVEMENT REPAIRS AND DIRECTIONAL BORING.
12. CONTRACTOR SHALL COORDINATE ALL WORK WITH OTHER CONTRACTORS WITHIN PROJECT AREA.
13. CONTRACTOR SHALL PROVIDE ACTUAL INVERT ELEVATIONS ON ALL DRAINAGE STRUCTURES, INCLUDING CULVERTS, PRIOR TO PLACING ANY BASE MATERIAL. DEVIATIONS FROM THE PLANS SHALL BE APPROVED BY THE ENGINEER BEFORE CONTINUING WORK.
14. THIS PROJECT IS TO BE CONSTRUCTED IN ACCORDANCE WITH THE F.D.O.T. STANDARD SPECIFICATIONS FOR ROAD AND BRIDGE CONSTRUCTION (CURRENT EDITION) AND THE F.D.O.T. DESIGN STANDARDS (CURRENT EDITION), AWWA SPECIFICATIONS, AND COLUMBIA COUNTY DEVELOPMENT STANDARDS UNLESS OTHERWISE NOTED.

15. IF UNSUITABLE MATERIAL IS ENCOUNTERED DURING GRADING, CONTRACTOR SHALL REMOVE UNSUITABLE MATERIAL TO A DEPTH OF 24" BELOW FINISHED GRADE WITHIN THE CONSTRUCTION LIMITS.
16. THE CONTRACTOR SHALL NOTIFY THE COUNTY AT LEAST 48 HOURS PRIOR TO BEGINNING OF CONSTRUCTION.
17. CONTRACTOR SHALL PROVIDE AN AS-BUILT SURVEY MEETING THE REQUIREMENTS OF CHAPTER 61G17 F.A.C. FOR THE STORMWATER MANAGEMENT SYSTEMS. INCLUDE HORIZONTAL AND VERTICAL DIMENSIONAL DATA SO THAT IMPROVEMENTS ARE LOCATED AND DELINEATED RELATIVE TO THE BOUNDARY. PROVIDE SUFFICIENT DETAILED DATA TO DETERMINE WHETHER THE IMPROVEMENTS WERE CONSTRUCTED IN ACCORDANCE WITH THE PLANS. A COPY OF THE AS-BUILT SURVEY (IN PAPER AND DIGITAL AUTOCAD FORMAT) MUST BE SUBMITTED TO THE ENGINEER.
18. IF DURING CONSTRUCTION OR OPERATION OF THE STORM WATER MANAGEMENT SYSTEM, A STRUCTURAL FAILURE IS OBSERVED THAT HAS THE POTENTIAL TO CAUSE THE DIRECT DISCHARGE OF SURFACE WATER INTO THE FLORIDIAN AQUIFER SYSTEM, CORRECTIVE ACTIONS DESIGNED OR APPROVED BY A REGISTERED PROFESSIONAL SHALL BE TAKEN AS SOON AS PRACTICAL TO CORRECT THE FAILURE. A REPORT PREPARED BY A REGISTERED PROFESSIONAL MUST BE PROVIDED AS SOON AS PRACTICAL TO THE DEPARTMENT FOR REVIEW AND APPROVAL THAT PROVIDES REASONABLE ASSURANCE THAT THE BREACH WILL BE PERMANENTLY CORRECTED.

EROSION CONTROL NOTES

1. THIS EROSION AND SEDIMENTATION CONTROL PLAN COMPLIES WITH THE REQUIREMENTS OF THE "FLORIDA DEVELOPMENT MANUAL" AND THE "FLORIDA EROSION AND SEDIMENT CONTROL INSPECTOR'S MANUAL".
2. THE CONTRACTOR SHALL ADHERE TO COLUMBIA COUNTY, SRWMD, AND OTHER GOVERNING AUTHORITIES FOR EROSION AND SEDIMENT CONTROL REGULATIONS. IF THE CONTRACTOR NEEDS TO CHANGE THIS PLAN TO MORE EFFECTIVELY CONTROL EROSION AND SEDIMENTATION, THE CONTRACTOR SHALL USE BMP's FROM THE "FLORIDA EROSION AND SEDIMENT CONTROL INSPECTOR'S MANUAL".
3. THE CONTRACTOR SHALL ADJUST AND REVISE THIS PLAN TO MEET ACTUAL FIELD CONDITIONS. ANY REVISIONS SHALL BE APPROVED BY THE REVIEWING AGENCIES.
4. SEDIMENT AND EROSION CONTROL FACILITIES, STORM DRAINAGE FACILITIES AND DETENTION BASINS SHALL BE INSTALLED PRIOR TO ANY OTHER CONSTRUCTION.
5. EROSION CONTROL MEASURES SHALL BE INSPECTED WEEKLY AND AFTER EACH RAINFALL AND REPLACED AS NECESSARY.
6. SEDIMENT AND EROSION CONTROL MEASURES SHALL NOT BE REMOVED UNTIL ALL CONSTRUCTION IS COMPLETE AND UNTIL A PERMANENT GROUND COVER HAS BEEN ESTABLISHED.
7. ALL OPEN DRAINAGE SWALES SHALL BE GRASSED AND RIPRAP SHALL BE PLACED AS REQUIRED TO CONTROL EROSION.
8. SILT FENCES SHALL BE LOCATED ON SITE TO PREVENT SEDIMENT AND EROSION FROM LEAVING PROJECT LIMITS.
9. CONTRACTOR SHALL PLACE A DOUBLE ROW OF SILT FENCE IN AREAS WHERE RUNOFF FROM DISTURBED AREAS MAY ENTER WETLANDS.
10. DURING CONSTRUCTION AND AFTER CONSTRUCTION IS COMPLETE, ALL STRUCTURES SHALL BE CLEANED OF ALL DEBRIS AND EXCESS SEDIMENT.
11. ALL GRADED AREAS SHALL BE STABILIZED IMMEDIATELY WITH A TEMPORARY FAST-GROWING COVER AND/OR MULCH.
12. A PAD OF RUBBLE RIP RAP SHALL BE PLACED AT THE BOTTOM OF ALL COLLECTION FLUMES AND COLLECTION PIPE OUTLETS. GRANITE OR LIMESTONE RIPRAP IS REQUIRED, NO BROKEN CONCRETE WILL BE ACCEPTED.
13. ALL SIDE SLOPES STEEPER THAN 3:1 SHALL BE ADEQUATELY PROTECTED FROM EROSION THROUGH THE USE OF HAY BALES OR SODDING.
14. ALL STABILIZATION PRACTICES SHALL BE INITIATED AS SOON AS PRACTICABLE IN AREAS OF THE JOB WHERE CONSTRUCTION ACTIVITIES HAVE TEMPORARILY OR PERMANENTLY STOPPED, BUT IN NO CASE SHALL THE DISTURBED AREA BE LEFT UNPROTECTED FOR MORE THAN SEVEN DAYS.
15. ALL WASTE GENERATED ON THE PROJECT SHALL BE DISPOSED OF BY THE CONTRACTOR IN AREAS PROVIDED BY CONTRACTOR.
16. LOADED HAUL TRUCKS SHALL BE COVERED WITH TARPS.
17. EXCESS DIRT SHALL BE REMOVED DAILY.
18. THIS PROJECT SHALL COMPLY WITH ALL WATER QUALITY STANDARDS. PERMIT REQUIRED FROM SRWMD HAS BEEN OBTAINED.
19. QUALIFIED PERSONNEL SHALL INSPECT THE AREA USED FOR STORAGE OF STOCKPILES, THE SILT FENCE AND STRAW BALES, THE LOCATION WHERE VEHICLES ENTER OR EXIT THE SITE, AND THE DISTURBED AREAS THAT HAVE NOT BEEN FINALLY STABILIZED, AT LEAST ONCE EVERY SEVEN CALENDAR DAYS AND WITHIN 24 HOURS OF THE END OF A STORM OF 0.5 INCHES OR GREATER.
20. SITES THAT HAVE BEEN FINALLY STABILIZED WITH SOD OR GRASSING SHALL BE INSPECTED AT LEAST ONCE EVERY WEEK.

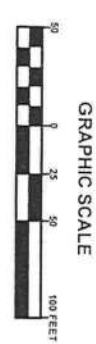
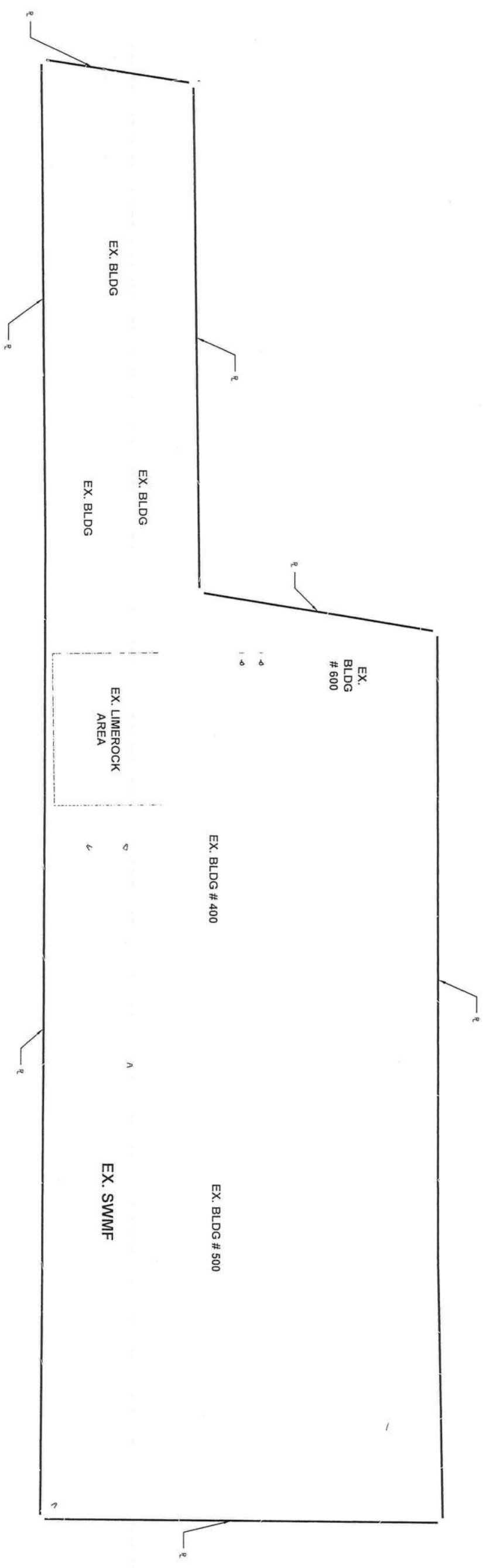

| |
|---------------------------------------|
| JOB NUMBER: L180115MIN |
| DESIGNED BY: KB |
| DRAFTED BY: KB |
| CHECKED BY: GB |
| ENGINEER OF RECORD: GREGORY G. BAILEY |
| P.E. NO. 43858 |

| |
|-----------|
| REVISIONS |
| |
| |
| |

EXISTING CONDITIONS
MINI STORAGE SITE EXPANSION 2
COLUMBIA COUNTY, FL

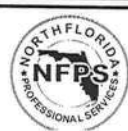

North Florida Professional Services, Inc.
P.O. BOX 3823
Lake City, FL 32025
Ph. 386-752-4675
Fax. 386-752-4674
P.O. BOX 180998
Tallahassee, FL 32318
Ph. 877-335-1525
Eng. Lic. 29011

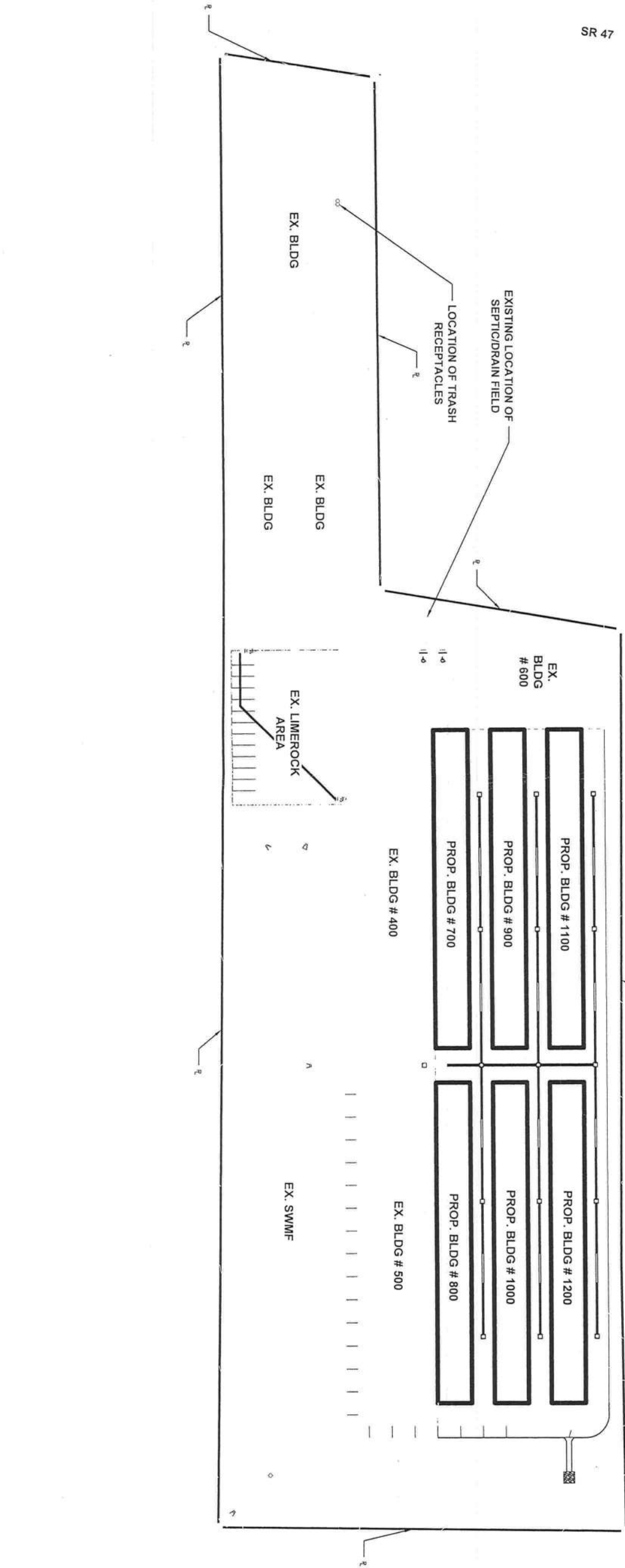

| SITE DATA TABLE | | | | | |
|---|----------------------|---------------------------|---------|-----------|-----------|
| MINI STORAGE SITE EXPANSION | | | | | |
| PARCEL ID NUMBER | 18-4S-17-08479-005 | | | | |
| ZONING | COMMERCIAL INTENSIVE | | | | |
| LAND USE | COMMERCIAL | | | | |
| CITY COUNCIL DISTRICT NUMBER | 5 | | | | |
| PHYSICAL ADDRESS | 2529 STATE ROAD 47 | | | | |
| PROJECT PROPERTY BOUNDARY | | SQ. FT. | ACRES | % OF SITE | % OF LOC. |
| TOTAL PROPERTY BOUNDARY AREA | 344560 | 7.91 | 100.00% | 100.00% | 100.00% |
| PROJECT AREA / LIMITS OF CONSTRUCTION (LOC) | 344560 | 7.91 | 100.00% | 100.00% | 100.00% |
| BOTH ON-SITE & OFF-SITE | 344560 | 7.91 | 100.00% | 100.00% | 100.00% |
| EXISTING IMPERVIOUS AREA ON-SITE | | | | | |
| EXISTING ASPHALT PAVEMENT | 81102 | 1.86 | 23.54% | 23.54% | |
| EXISTING CONCRETE | 3356 | 0.08 | 0.97% | 0.97% | |
| EXISTING BUILDING | 45175 | 1.04 | 13.11% | 13.11% | |
| EXISTING STORMWATER MANAGEMENT FACILITY | 65308 | 1.50 | 18.95% | 18.95% | |
| TOTAL EXISTING IMPERVIOUS AREA ON-SITE | 194941 | 4.48 | 56.58% | 56.58% | |
| PROPOSED IMPERVIOUS AREA ON-SITE | | | | | |
| EXISTING ASPHALT PAVEMENT TO REMAIN | 81102 | 1.86 | 23.54% | 23.54% | |
| EXISTING CONCRETE TO REMAIN | 3356 | 0.08 | 0.97% | 0.97% | |
| EXISTING BUILDING TO REMAIN | 45175 | 1.04 | 13.11% | 13.11% | |
| EXISTING STORMWATER MANAGEMENT FACILITY TO REMAIN | 65308 | 1.50 | 18.95% | 18.95% | |
| PROPOSED ASPHALT PAVEMENT | 42515 | 0.98 | 12.34% | 12.34% | |
| PROPOSED CONCRETE | 240 | 0.01 | 0.07% | 0.07% | |
| PROPOSED BUILDING | 50400 | 1.16 | 14.63% | 14.63% | |
| PROPOSED STORMWATER MANAGEMENT FACILITY | 0 | 0.00 | 0.00% | 0.00% | |
| TOTAL PROPOSED IMPERVIOUS AREA ON-SITE | 289096 | 6.61 | 83.61% | 83.61% | |
| REQURED PARKING LANDSCAPE AREA ON-SITE | 56464 | 1.30 | 16.39% | 16.39% | |
| PROPOSED PARKING LANDSCAPE AREA ON-SITE | 4252 | 0.10 | 1.23% | 1.23% | |
| REQURED PARKING | 9000 | 0.21 | 2.61% | 2.61% | |
| PROVIDED PARKING | | | | | |
| | | 34 SPACES + 0 H.C. SPACES | | | |
| | | 34 SPACES + 0 H.C. SPACES | | | |

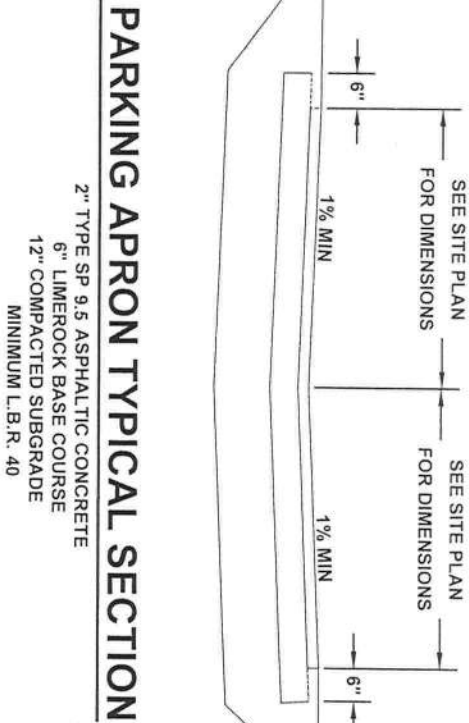

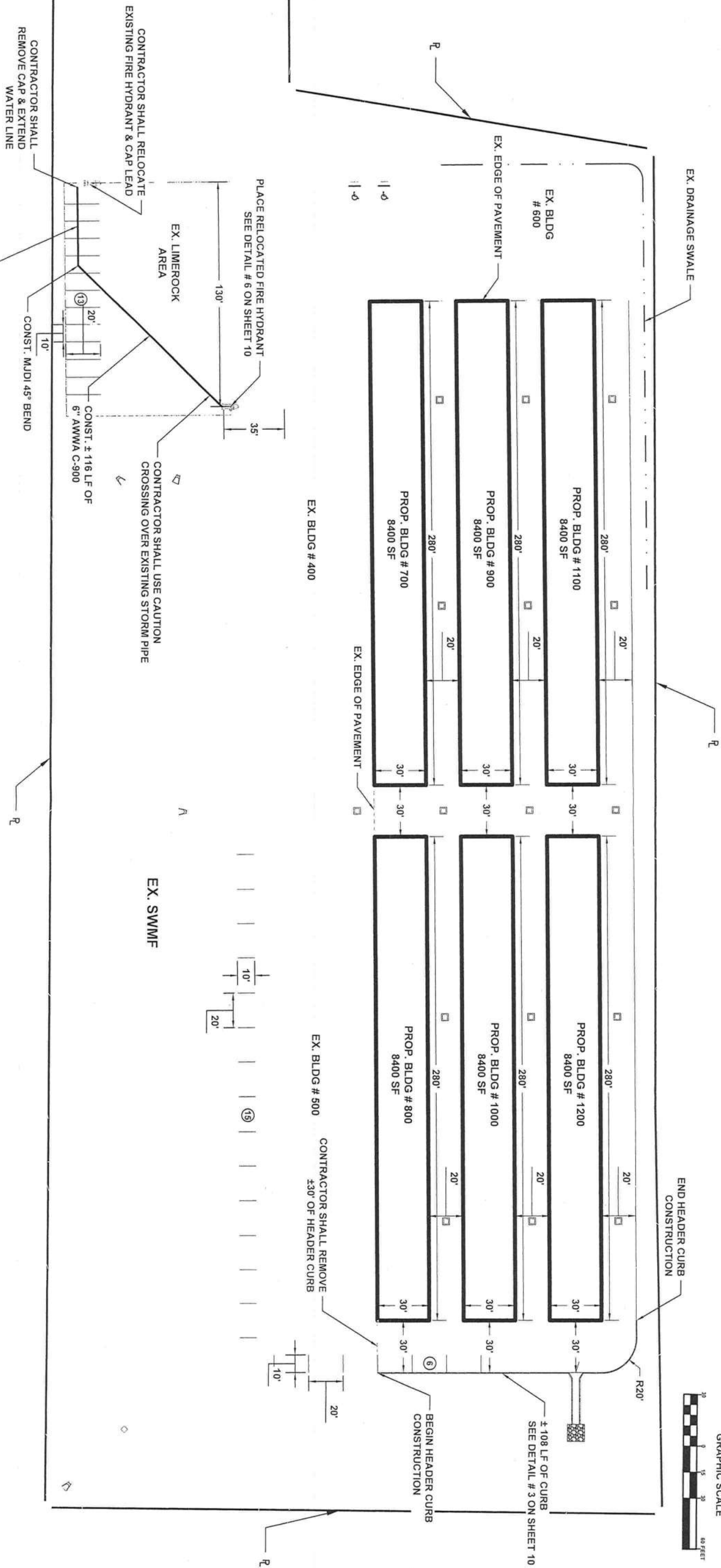

NOTE:
ALL STORMWATER PIPES SHALL BE
A2000 PVC OR EQUIVALENT.

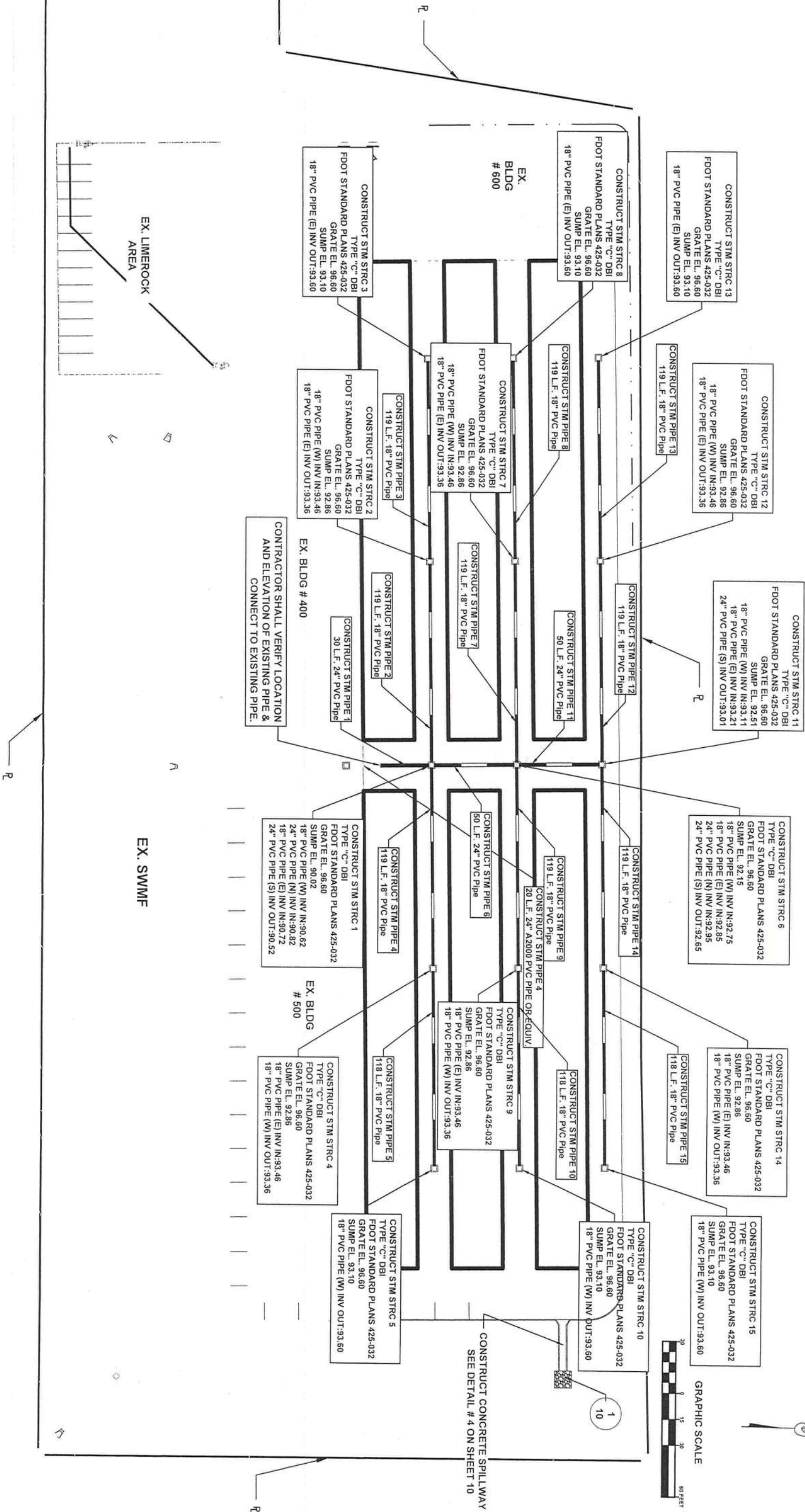

STORMWATER PLAN
MINI STORAGE SITE EXPANSION 2
COLUMBIA COUNTY, FL



North Florida Professional Services, Inc.
P.O. BOX 3823
Lake City, FL 32025
Ph. 877-335-4675
Fax. 386-752-4674
P.O. BOX 180998
Tallahassee, FL 32318
Ph. 877-335-1525
Eng. Lic. 29011

* CONTRACTOR SHALL VERIFY EXISTING PAVEMENT ELEVATION ALONG BUILDING PERIMETER. ACTUAL FFE SHALL BE ADJUSTED TO PROVIDE 0.06' - 0.10' LIP.

TC = TOP OF CURB
EP = EDGE OF PAVEMENT
→ = FLOW ARROW

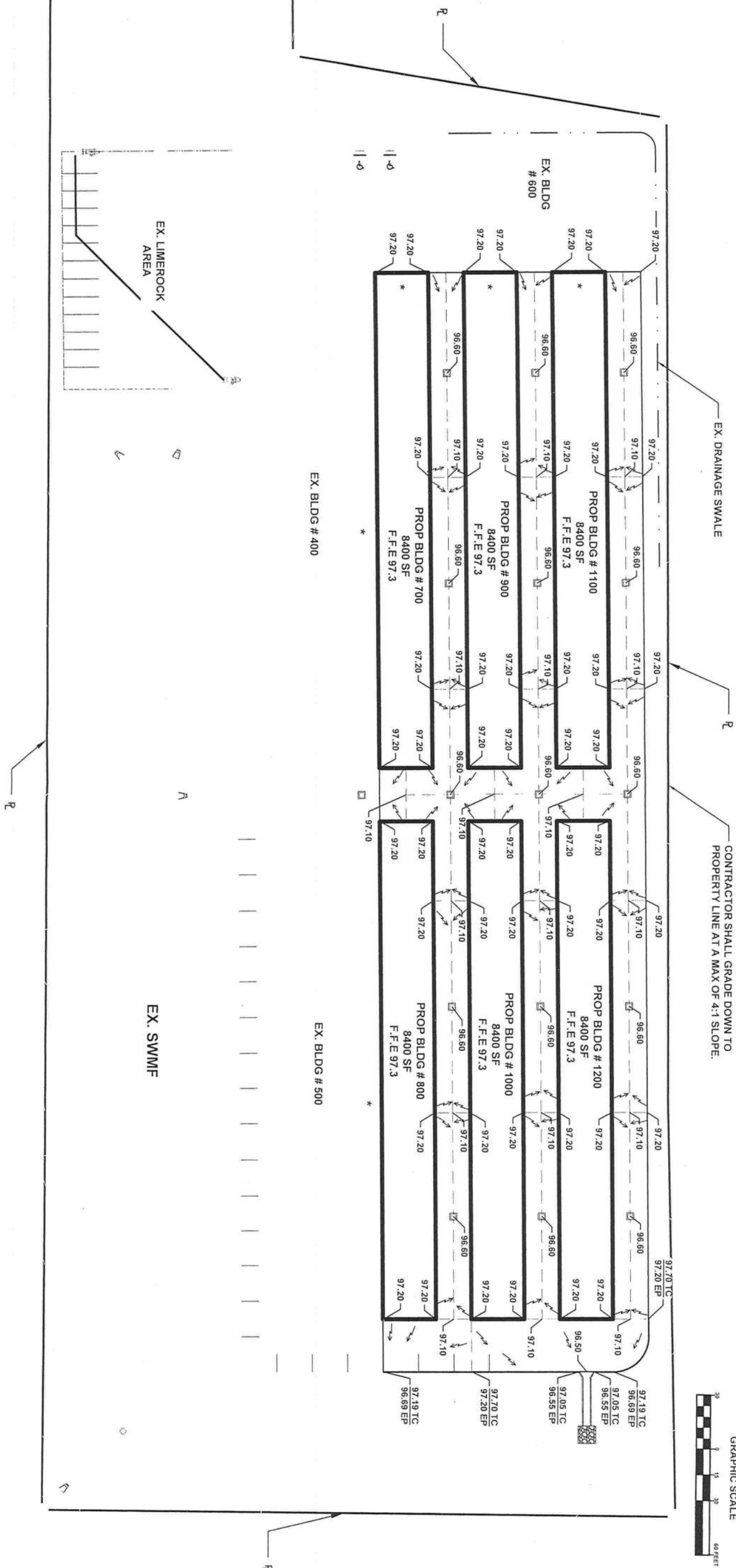

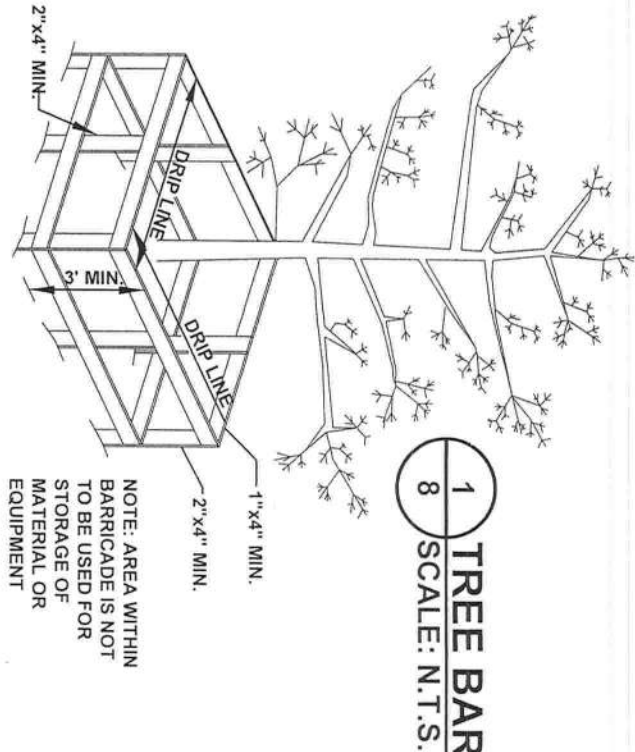

| TREE AND SHRUBBERY REQUIREMENTS | | | | |
|---------------------------------|----------------|------------------------|-----|-------|
| MAP SYMBOL | COMMON NAME | SCIENTIFIC NAME | NO. | NOTES |
| | SOD/GRASS | -- | -- | |
| | CREPE MYRTLE | LAGERSTROEMIA | 5 | |
| | SWEET VIBURNUM | VIBURNUM ODORATISSIMUM | 141 | |

LANDSCAPE REQUIREMENTS
REQUIRED OFF STREET LANDSCAPE AREA = 4,252 SF
PROPOSED OFF STREET LANDSCAPE AREA = 9,000 SF
REQUIRED # OF 4' TREES = 1/200 SF REQUIRED
LANDSCAPED AREA 4,252 SF / 200 = 22 TREES
TREES PROVIDED = 146

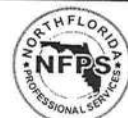
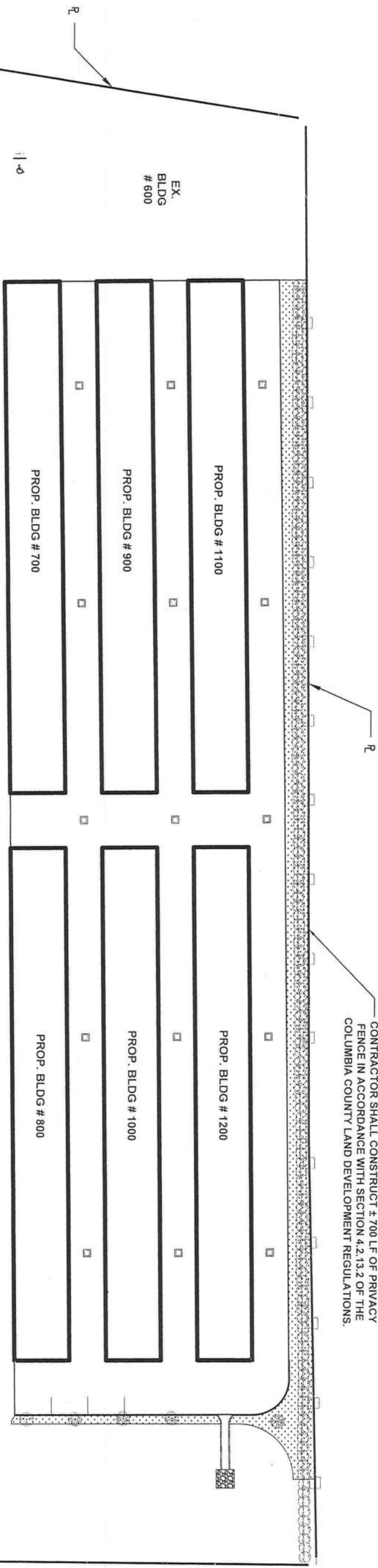

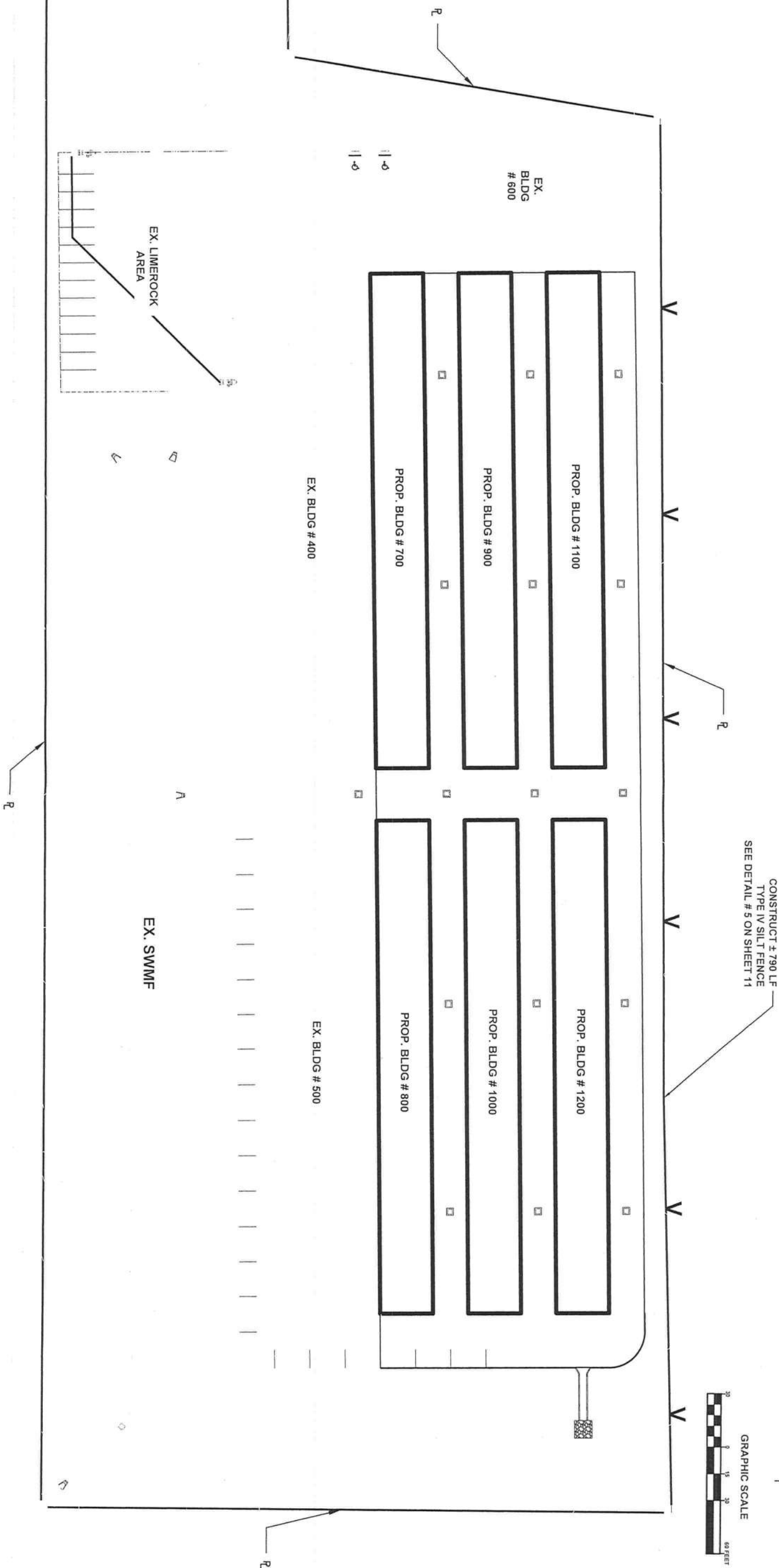

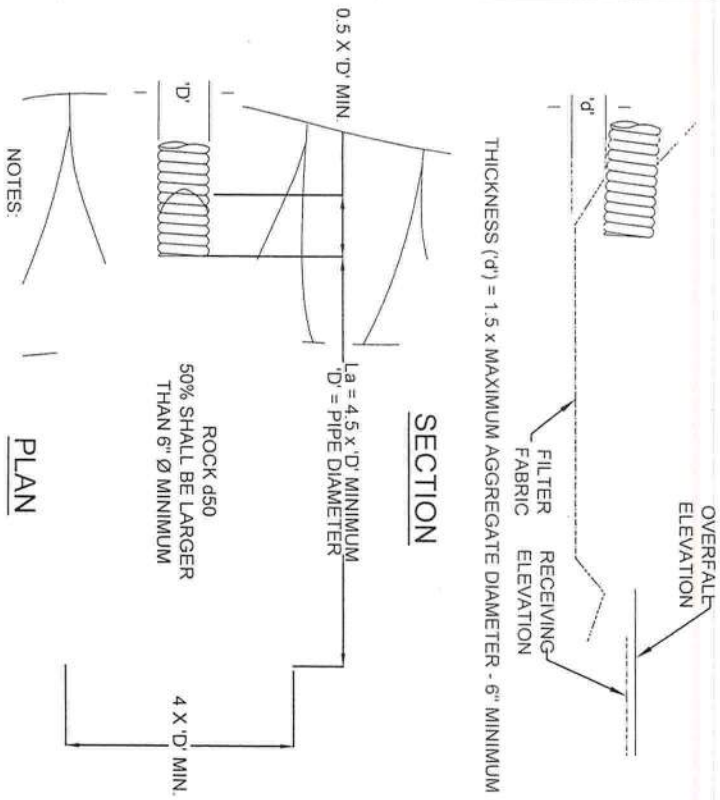

1 ENERGY DISSIPATER DETAIL
10 SCALE: N.T.S.

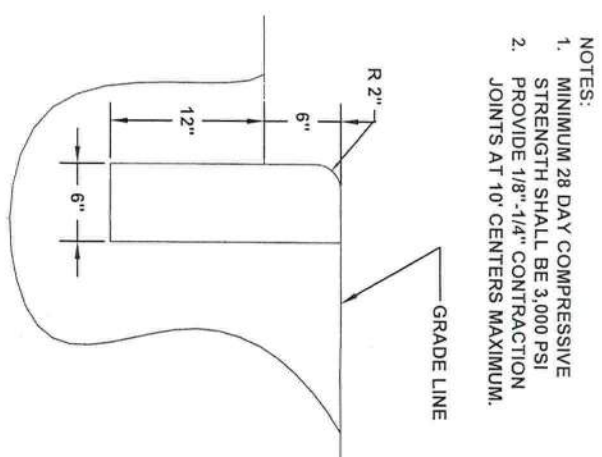

2 HEADER CURB DETAIL
10 SCALE: N.T.S.

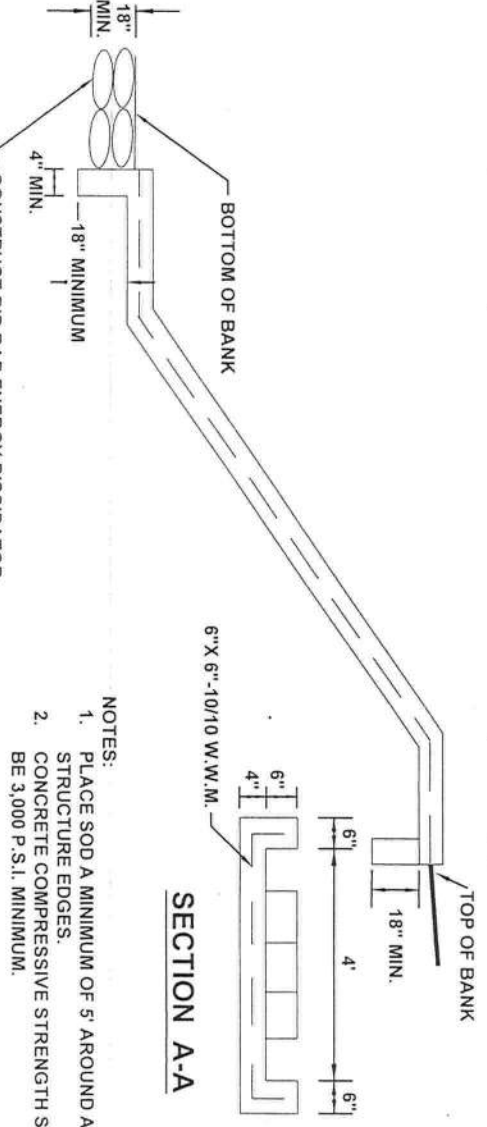

4 CONCRETE SPILLWAY DETAIL
10 SCALE: N.T.S.

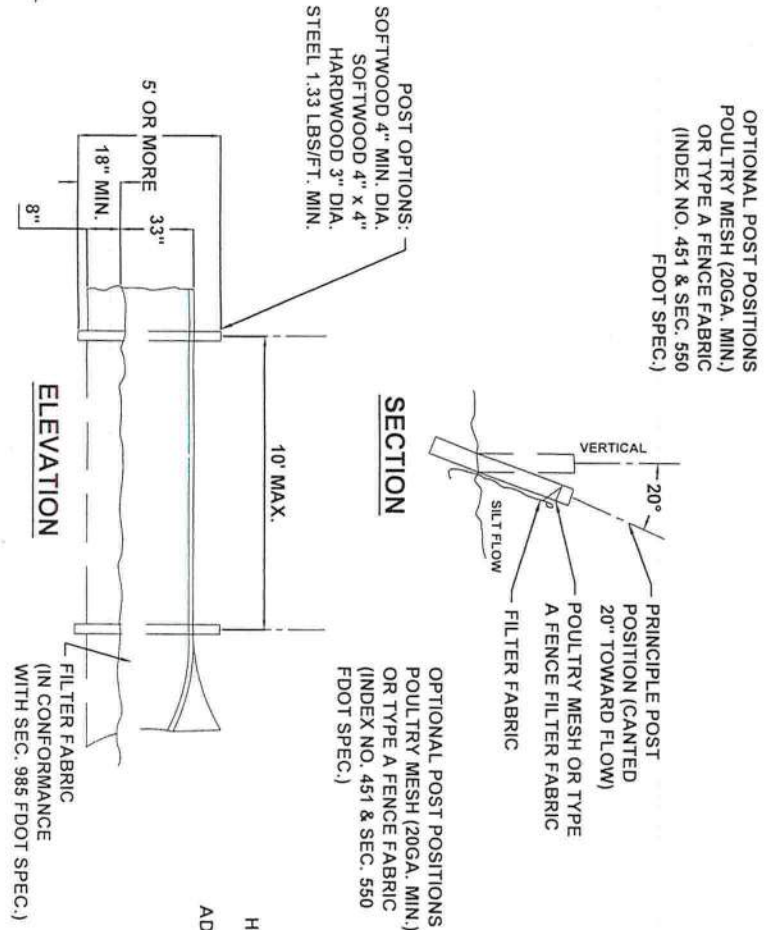

5 TYPE IV SILT FENCE
10 SCALE: N.T.S.

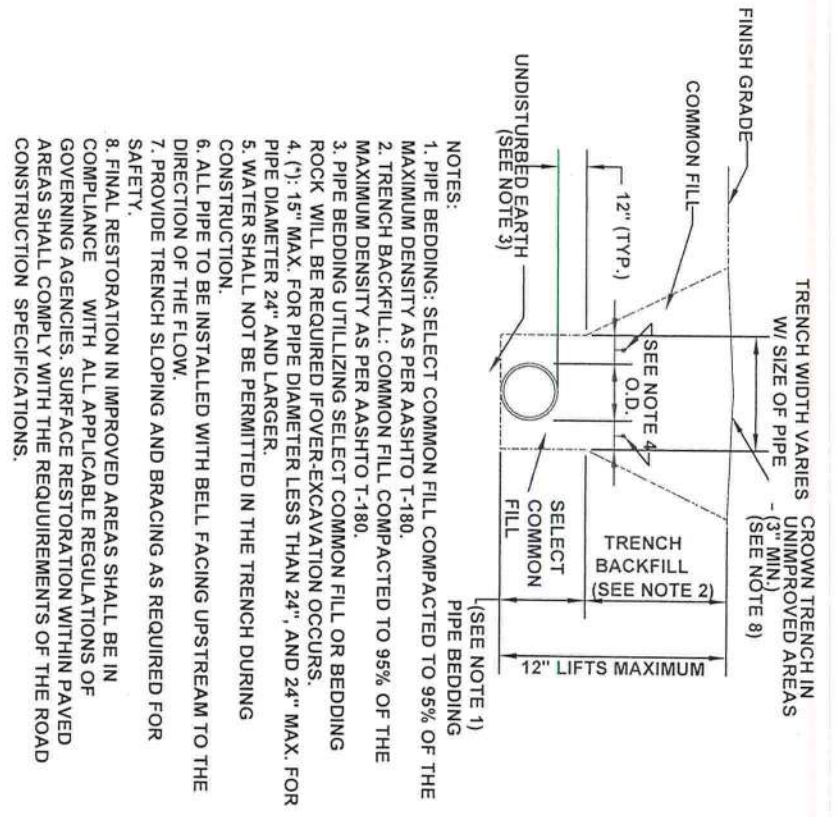

3 TRENCH AND BACKFILL DETAILS
10 SCALE: N.T.S.

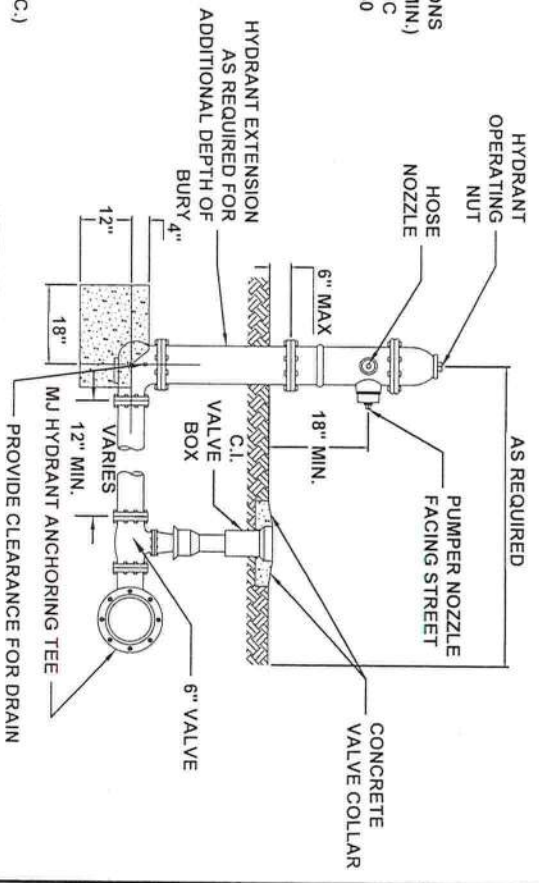

6 FIRE HYDRANT ASSEMBLY
10 SCALE: N.T.S.

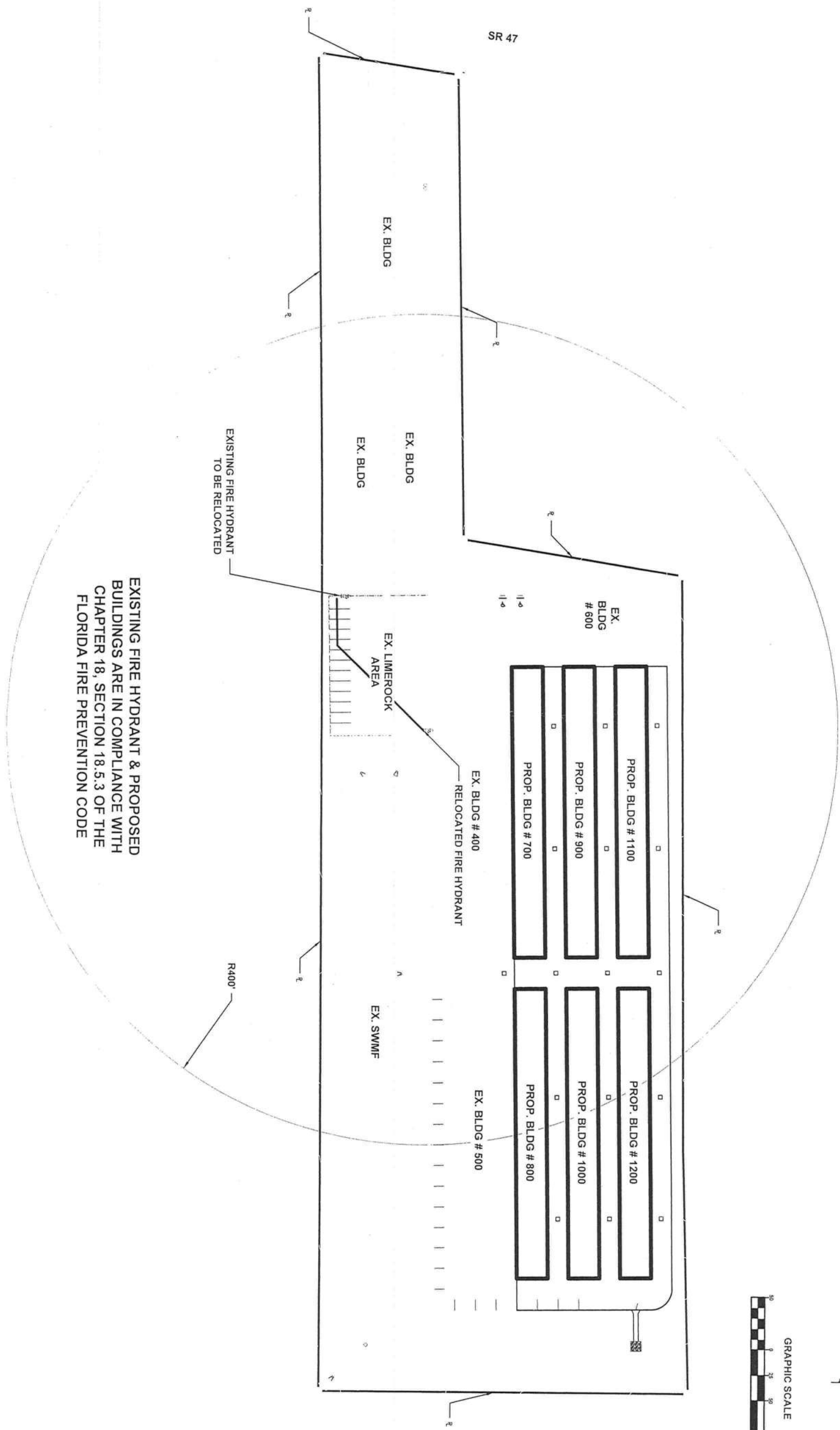

A map of New York State with Columbia County highlighted in black. The text "COLUMBIA COUNTY" is printed vertically in bold, black, sans-serif capital letters to the right of the map.

| Sheet List Table | |
|---|--------------|
| SHEET TITLE | SHEET NUMBER |
| COVER | 01 |
| GENERAL NOTES | 02 |
| 3 ELECT. - FIREWALL PLAN BLDG 1100 & 1200 | 03 |

NORTH & SOUTH ELEVATIONS

EAST & WEST ELEVATIONS

BUILDING NOS. 1100 & 1200 ELEVATIONS

**MINI-STORAGE AND RECORD
STORAGE OF LAKE CITY
442 SW SAINT MARGARET ST
LAKE CITY, FL 32025
(386) 752-7092**



| REVISIONS | | DATE |
|---|--|---|
| DESCRIPTION | | |
| <div></div> <p>NORTH FLORIDA PROFESSIONAL SERVICES, INC. P.O. BOX 3823 LAKE CITY, FL 32056 PH. 386-752-4675 LIC NO. LB8356</p> <p>2551 BLAIRSTONE PINES DR. TALLAHASSEE, FL 32301 WWW.NFPS.NET CA# 29011</p> | | <p>JOB NUMBER: L180175-1BP</p> <p>EOR: ROBERT PHILIP BISHOP, JR P.E. NO.: 38546</p> |
| <p>COVER</p> <p>LAKE CITY MINI-STORAGE COLUMBIA COUNTY, FLORIDA</p> | | <p>SHEET NO.</p> <p>01</p> |

THE OFFICIAL RECORD OF THIS SHEET IS THE ELECTRONIC FILE DIGITALLY SIGNED AND SEALED UNDER RULE 61G15-23.004, F.A.C.

GENERAL CONSTRUCTION NOTES

GENERAL NOTES

1. CONTRACTOR SHALL VERIFY ALL DIMENSIONS AND DETAILS SHOWN, NOTIFY THE ENGINEER OF ANY CHANGES OR MODIFICATIONS TO THE PLANS.
2. ALL CONSTRUCTION, EQUIPMENT AND FINISHES SHALL MEET OR EXCEED ALL LOCAL CODES, FLORIDA BUILDING CODE, NFPA 101 LIFE SAFETY CODE AND ALL OTHER GOVERNING CODES AND REVISIONS.
3. DO NOT USE ANY MATERIALS CONTAINING ASBESTOS.
4. THE CONTRACTOR SHALL VERIFY ALL DIMENSIONS AND DETAILS SHOWN AND NOTIFY THE ENGINEER OF ANY CHANGES OR MODIFICATIONS.
5. THE CONTRACTOR SHALL VERIFY ALL EXISTING CONDITIONS AND DIMENSIONS AT THE JOB SITE TO INSURE THAT ALL NEW WORK WILL FIT IN THE MANNER INTENDED AND ON THE PLANS. SHOULD ANY CONDITIONS EXIST THAT ARE CONTRARY TO THOSE SHOWN ON THE PLANS, THE CONTRACTOR SHALL NOTIFY THE ENGINEER OF SUCH DIFFERENCES IMMEDIATELY AND PRIOR TO PROCEEDING WITH THE WORK.
6. ANY WOOD OR TIMBER THAT COMES IN CONTACT WITH CONCRETE OR MASONRY SHALL BE PRESSURE TREATED.
7. SEE STRUCTURAL DRAWINGS FOR ALL SIZES, SHAPES AND CONDITIONS OF ALL STRUCTURAL MEMBERS, CONNECTIONS FOOTINGS, BRACING, AND REINFORCING
8. ALL INTERIOR FINISHES SHALL MEET THE REQUIREMENTS OF THE FLORIDA BUILDING CODE AND LIFE SAFETY CODE, NFPA 101 SECTION 7.14.
9. ALL FLOOR FINISHES SHALL BE LEVEL AND SHALL AVOID ANY CHANGES IN ELEVATION GREATER THAN 1/2" INCLUDING DOOR THRESHOLDS AND STEP DOWNS AT EXTERIOR AND INTERIOR DOORS.
10. FOUNDATION WATER-PROOFING AND MOISTURE BARRIER TO CONSIST OF 6-MIL PLASTIC POLYETHYLENE. ALL LAPS SHALL BE A MINIMUM OF 12".
11. FINAL LOCATION, SIZE AND PLACEMENT OF ALL PLUMBING, ELECTRICAL AND MECHANICAL COMPONENTS SHALL BE DETERMINED BY A LICENSED ELECTRICAL OR MECHANICAL CONTRACTOR IN ACCORDANCE WITH CHAPTER 471 FLORIDA STATUTES.

STRUCTURAL NOTES

- STRUCTURAL DESIGN CRITERIA
1. ALL WORK HAS BEEN DESIGNED FOR THE FOLLOWING LOADS AND SPECIFICATIONS APPLIED IN ACCORDANCE WITH THE LATEST EDITIONS OF THE FLORIDA BUILDING CODE AND ACI 318.
 2. DESIGN LOADS:
 - 2.1 WIND LOAD = 120 MPH



| REVISIONS | | DATE |
|--|--|------|
| DESCRIPTION | | |
| <div><div></div><div><div><div><div><div><div></div><div></div><div></div><div></div><div></div></div><div><div><div></div><div></div><div></div></div></div><div><div><div></div><div></div><div></div></div><div><div><div></div><div></div><div></div></div></div><div><div><div></div><div></div><div></div></div><div><div><div></div><div></div><div></div></div></div><div><div><div></div><div></div><div></div></div><div><div><div></div><div></div><div></div></div></div><div><div><div></div><div></div><div></div></div><div><div><div></div><div></div><div></div></div></div><div><div><div></div><div></div><div></div></div><div><div><div></div><div></div><div></div></div></div><div><div><div></div><div></div><div></div></div><div><div><div></div><div></div><div></div></div></div><div><div><div></div><div></div><div></div></div><div><div><div></div><div></div><div></div></div></div><div><div><div></div><div></div><div></div></div><div><div><div></div><div></div><div></div></div></div><div><div><div></div><div></div><div></div></div><div><div><div></div><div></div><div></div></div></div><div><div><div></div><div></div><div></div></div><div><div><div></div><div></div><div></div></div></div><div><div><div></div><div></div><div></div></div><div><div><div></div><div></div><div></div></div></div><div><div><div></div><div></div><div></div></div><div><div><div></div><div></div><div></div></div></div><div><div><div></div><div></div><div></div></div><div><div><div></div><div></div><div></div></div></div><div><div><div></div><div></div><div></div></div><div><div><div></div><div></div><div></div></div></div><div><div><div></div><div></div><div></div></div><div><div><div></div><div></div><div></div></div></div><div><div><div></div><div></div><div></div></div><div><div><div></div><div></div><div></div></div></div><div><div><div></div><div></div><div></div></div><div><div><div></div><div></div><div></div></div></div><div><div><div></div><div></div><div></div></div><div><div><div></div><div></div><div></div></div></div><div><div><div></div><div></div><div></div></div><div><div><div></div><div></div><div></div></div></div><div><div><div></div><div></div><div></div></div><div><div><div></div><div></div><div></div></div></div><div><div><div></div><div></div><div></div></div><div><div><div></div><div></div><div></div></div></div><div><div><div></div><div></div><div></div></div><div><div><div></div><div></div><div></div></div></div><div><div><div></div><div></div><div></div></div><div><div><div></div><div></div><div></div></div></div><div><div><div></div><div></div><div></div></div><div><div><div></div><div></div><div></div></div></div><div><div><div></div><div></div><div></div></div><div><div><div></div><div></div><div></div></div></div><div><div><div></div><div></div><div></div></div><div><div><div></div><div></div><div></div></div></div><div><div><div></div><div></div><div></div></div><div><div><div></div><div></div><div></div></div></div><div><div><div></div><div></div><div></div></div><div><div><div></div><div></div><div></div></div></div><div><div><div></div><div></div><div></div></div><div><div><div></div><div></div><div></div></div></div><div><div><div></div><div></div><div></div></div><div><div><div></div><div></div><div></div></div></div><div><div><div></div><div></div><div></div></div><div><div><div></div><div></div><div></div></div></div><div><div><div></div><div></div><div></div></div><div><div><div></div><div></div><div></div></div></div><div><div><div></div><div></div><div></div></div><div><div><div></div><div></div><div></div></div></div><div><div><div></div><div></div><div></div></div><div><div><div></div><div></div><div></div></div></div><div><div><div></div><div></div><div></div></div><div><div><div></div><div></div><div></div></div></div><div><div><div></div><div></div><div></div></div><div><div><div></div><div></div><div></div></div></div><div><div><div></div><div></div><div></div></div><div><div><div></div><div></div><div></div></div></div><div><div><div></div><div></div><div></div></div><div><div><div></div><div></div><div></div></div></div><div><div><div></div><div></div><div></div></div><div><div><div></div><div></div><div></div></div></div><div><div><div></div><div></div><div></div></div><div><div><div></div><div></div><div></div></div></div><div><div><div></div><div></div><div></div></div><div><div><div></div><div></div><div></div></div></div><div><div><div></div><div></div><div></div></div><div><div><div></div><div></div><div></div></div></div><div><div><div></div><div></div><div></div></div><div><div><div></div><div></div><div></div></div></div><div><div><div></div><div></div><div></div></div><div><div><div></div><div></div><div></div></div></div><div><div><div></div><div></div><div></div></div><div><div><div></div><div></div><div></div></div></div><div><div><div></div><div></div><div></div></div><div><div><div></div><div></div><div></div></div></div><div><div><div></div><div></div><div></div></div><div><div><div></div><div></div><div></div></div></div><div><div><div></div><div></div><div></div></div><div><div><div></div><div></div><div></div></div></div><div><div><div></div><div></div><div></div></div><div><div><div></div><div></div><div></div></div></div><div><div><div></div><div></div><div></div></div><div><div><div></div><div></div><div></div></div></div><div><div><div></div><div></div><div></div></div><div><div><div></div><div></div><div></div></div></div><div><div><div></div><div></div><div></div></div><div><div><div></div><div></div><div></div></div></div><div><div><div></div><div></div><div></div></div><div><div><div></div><div></div><div></div></div></div><div><div><div></div><div></div><div></div></div><div><div><div></div><div></div><div></div></div></div><div><div><div></div><div></div><div></div></div><div><div><div></div><div></div><div></div></div></div><div><div><div></div><div></div><div></div></div><div><div><div></div><div></div><div></div></div></div><div><div><div></div><div></div><div></div></div><div><div><div></div><div></div><div></div></div></div><div><div><div></div><div></div><div></div></div><div><div><div></div><div></div><div></div></div></div><div><div><div></div><div></div><div></div></div><div><div><div></div><div></div><div></div></div></div><div><div><div></div><div></div><div></div></div><div><div><div></div><div></div><div></div></div></div><div><div><div></div><div></div><div></div></div><div><div><div></div><div></div><div></div></div></div><div><div><div></div><div></div><div></div></div><div><div><div></div><div></div><div></div></div></div><div><div><div></div><div></div><div></div></div><div><div><div></div><div></div><div></div></div></div><div><div><div></div><div></div><div></div></div><div><div><div></div><div></div><div></div></div></div><div><div><div></div><div></div><div></div></div><div><div><div></div><div></div><div></div></div></div><div><div><div></div><div></div><div></div></div><div><div><div></div><div></div><div></div></div></div><div><div><div></div><div></div><div></div></div><div><div><div></div><div></div><div></div></div></div><div><div><div></div><div></div><div></div></div><div><div><div></div><div></div><div></div></div></div><div><div><div></div><div></div><div></div></div><div><div><div></div><div></div><div></div></div></div><div><div><div></div><div></div><div></div></div><div><div><div></div><div></div><div></div></div></div><div><div><div></div><div></div><div></div></div><div><div><div></div><div></div><div></div></div></div><div><div><div></div><div></div><div></div></div><div><div><div></div><div></div><div></div></div></div><div><div><div></div><div></div><div></div></div><div><div><div></div><div></div><div></div></div></div><div><div><div></div><div></div><div></div></div><div><div><div></div><div></div><div></div></div></div><div><div><div></div><div></div><div></div></div><div><div><div></div><div></div><div></div></div></div><div><div><div></div><div></div><div></div></div><div><div><div></div><div></div><div></div></div></div><div><div><div></div><div></div><div></div></div><div><div><div></div><div></div><div></div></div></div><div><div><div></div><div></div><div></div></div><div><div><div></div><div></div><div></div></div></div><div><div><div></div><div></div><div></div></div><div><div><div></div><div></div><div></div></div></div><div><div><div></div><div></div><div></div></div><div><div><div></div><div></div><div></div></div></div><div><div><div></div><div></div><div></div></div><div><div><div></div><div></div><div></div></div></div><div><div><div></div><div></div><div></div></div><div><div><div></div><div></div><div></div></div></div><div><div><div></div><div></div><div></div></div><div><div><div></div><div></div><div></div></div></div><div><div><div></div><div></div><div></div></div><div><div><div></div><div></div><div></div></div></div><div><div><div></div><div></div><div></div></div><div><div><div></div><div></div><div></div></div></div><div><div><div></div><div></div><div></div></div><div><div><div></div><div></div><div></div></div></div><div><div><div></div><div></div><div></div></div><div><div><div></div><div></div><div></div></div></div><div><div><div></div><div></div><div></div></div><div><div><div></div><div></div><div></div></div></div><div><div><div></div><div></div><div></div></div><div><div><div></div><div></div><div></div></div></div><div><div><div></div><div></div><div></div></div><div><div><div></div><div></div><div></div></div></div><div><div><div></div><div></div><div></div></div><div><div><div></div><div></div><div></div></div></div><div><div><div></div><div></div><div></div></div><div><div><div></div><div></div><div></div></div></div><div><div><div></div><div></div><div></div></div><div><div><div></div><div></div><div></div></div></div><div><div><div></div><div></div><div></div></div><div><div><div></div><div></div><div></div></div></div><div><div><div></div><div></div><div></div></div><div><div><div></div><div></div><div></div></div></div><div><div><div></div><div></div><div></div></div><div><div><div></div><div></div><div></div></div></div><div><div><div></div><div></div><div></div></div><div><div><div></div><div></div><div></div></div></div><div><div><div></div><div></div><div></div></div><div><div><div></div><div></div><div></div></div></div><div><div><div></div><div></div><div></div></div><div><div><div></div><div></div><div></div></div></div><div><div><div></div><div></div><div></div></div><div><div><div></div><div></div><div></div></div></div><div><div><div></div><div></div><div></div></div><div><div><div></div><div></div><div></div></div></div><div><div><div></div><div></div><div></div></div><div><div><div></div><div></div><div></div></div></div><div><div><div></div><div></div><div></div></div><div><div><div></div><div></div><div></div></div></div><div><div><div></div><div></div><div></div></div><div><div><div></div><div></div><div></div></div></div><div><div><div></div><div></div><div></div></div><div><div><div></div><div></div><div></div></div></div><div><div><div></div><div></div><div></div></div><div><div><div></div><div></div><div></div></div></div><div><div><div></div><div></div><div></div></div><div><div><div></div><div></div><div></div></div></div><div><div><div></div><div></div><div></div></div><div><div><div></div><div></div><div></div></div></div><div><div><div></div><div></div><div></div></div><div><div><div></div><div></div><div></div></div></div><div><div><div></div><div></div><div></div></div><div><div><div></div><div></div><div></div></div></div><div><div><div></div><div></div><div></div></div><div><div><div></div><div></div><div></div></div></div><div><div><div></div><div></div><div></div></div><div><div><div></div><div></div><div></div></div></div><div><div><div></div><div></div><div></div></div><div><div><div></div><div></div><div></div></div></div><div><div><div></div><div></div><div></div></div><div><div><div></div><div></div></div></div></div></div></div></div></div></div></div></div></div></div></div></div></div></div></div></div></div></div></div></div></div></div></div></div></div></div></div></div></div></div></div></div></div></div></div></div></div></div></div></div></div></div></div></div></div></div></div></div></div></div></div></div></div></div></div></div></div></div></div></div></div></div></div></div></div></div></div></div></div></div></div></div></div></div></div></div></div></div></div></div></div></div></div></div></div></div></div></div></div></div></div></div></div></div></div></div></div></div></div></div></div></div></div></div></div></div></div></div></div></div></div></div></div></div></div></div></div></div></div> | | |



NORTH FLORIDA PROFESSIONAL SERVICES, INC.
P.O. BOX 3823
LAKE CITY, FL 32056
PH. 386-752-4675
LIC NO. LB8356

2551 BLAIRSTONE PINES DR.
TALLAHASSEE, FL 32301
WWW.NFPS.NET
CA# 29011

JOB NUMBER:
L180115-1BP
EOR:
ROBERT PHILIP
BISHOP, JR
P.E. NO.:
38546

GENERAL NOTES
LAKE CITY MINI-STORAGE
COLUMBIA COUNTY, FLORIDA

SHEET
NO.

02

CODE DATA:
FLORIDA BUILDING CODE 2017 6TH EDITION
DESIGN WIND SPEED: 120 MPH
RISK CATEGORY: II
EXPOSURE: B

NOTE: SEE SITE PLAN FOR BUILDING
LOCATION & ORIENTATION

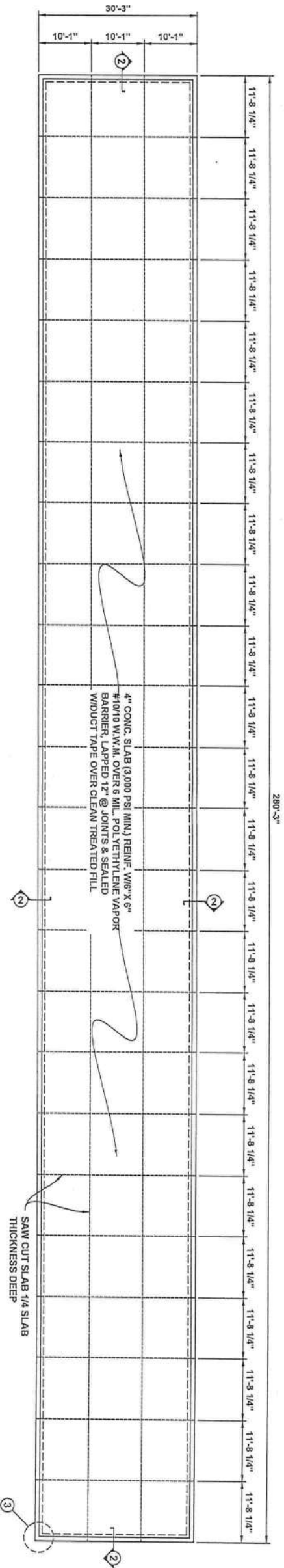

FOUNDATION PLAN BUILDING NOS. 1100 & 1200
SCALE: NTS

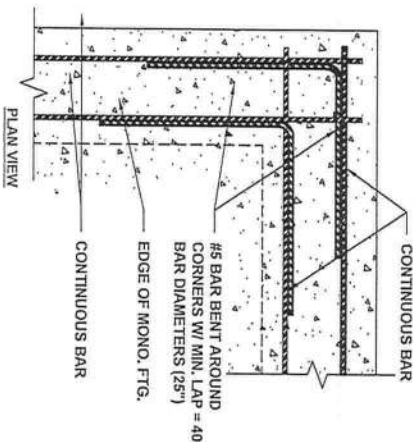
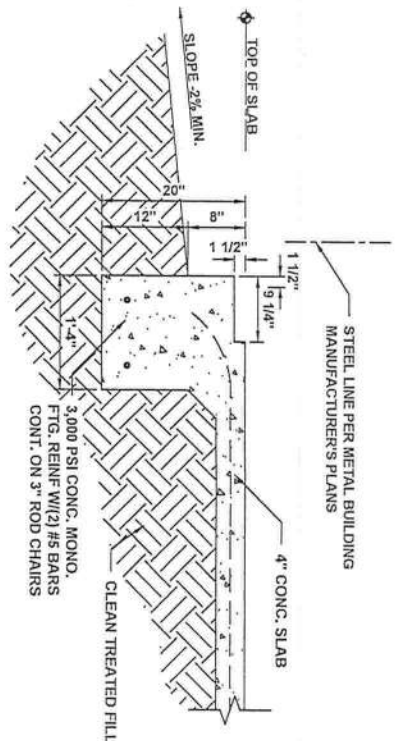
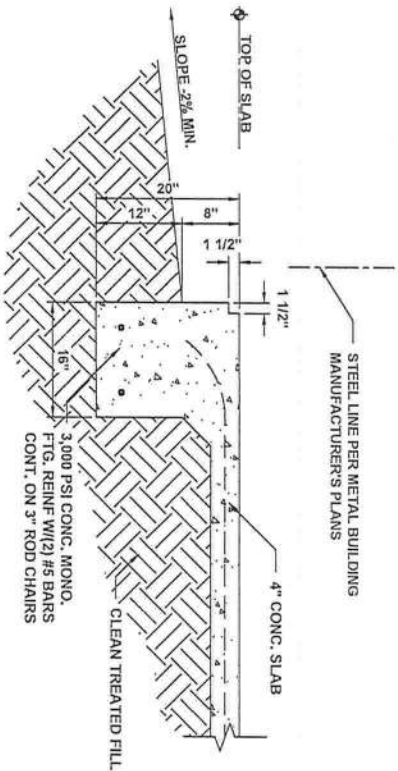

REVISIONS

NORTH FLORIDA PROFESSIONAL SERVICES, INC.

P.O. BOX 3823
LAKE CITY, FL 32056
PH. 386-752-4675
LIC NO. LB8356

2551 BLAIRSTONE PINES DR.
TALLAHASSEE, FL 32301
WWW.NFPS.NET
CA# 29011

JOB NUMBER:
L180115-1BP
EOR:
ROBERT PHILIP
BISHOP, JR.
P.E. NO.:
38546

FOUNDATION PLAN
LAKE CITY MINI-STORAGE
COLUMBIA COUNTY, FLORIDA

SHEET
NO.

04

THE OFFICIAL RECORD OF THIS SHEET IS THE ELECTRONIC FILE DIGITALLY SIGNED AND SEALED UNDER RULE 61G15-23.004, F.A.C.

- ELECTRICAL NOTES:
1. WIRE, CONDUIT, & PANEL SIZES TO BE DETERMINED BY ELECT. CONTRACTOR.
 2. EXTERIOR LIGHT FIXTURES AS CHOSEN BY OWNER.

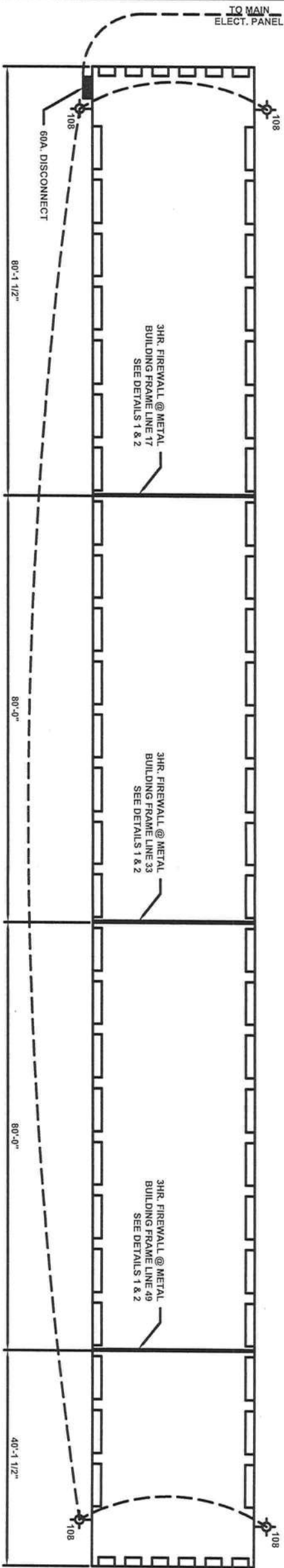

ELEC. - FIREWALL PLAN BLDG NOS. 1100 & 1200
SCALE: NTS

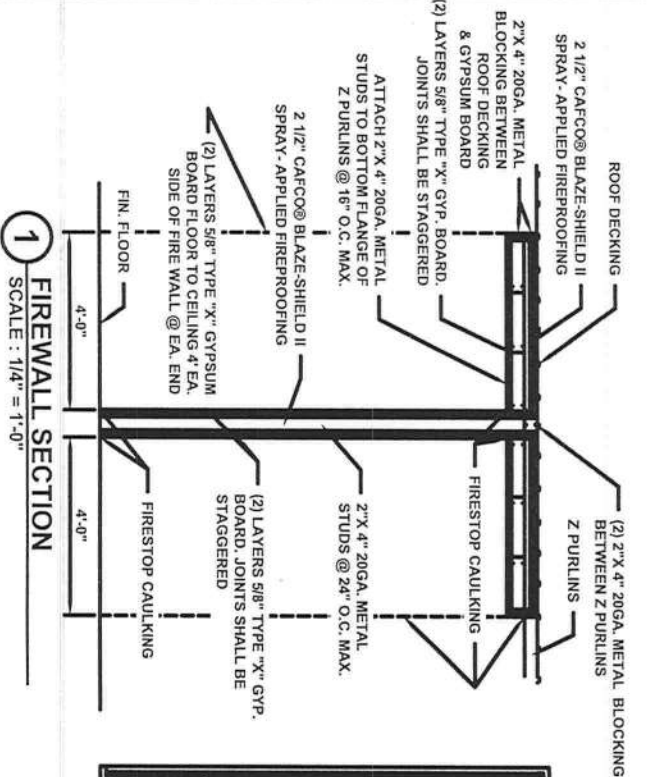

2 FIREWALL SECTION
SCALE: 1/4" = 1'-0"

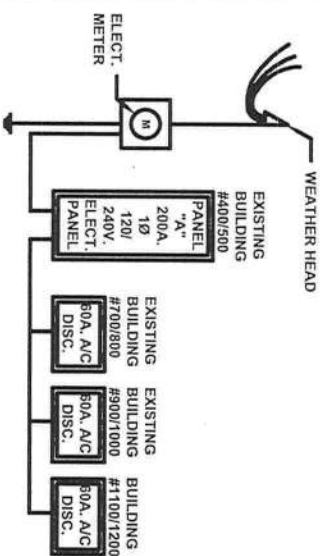
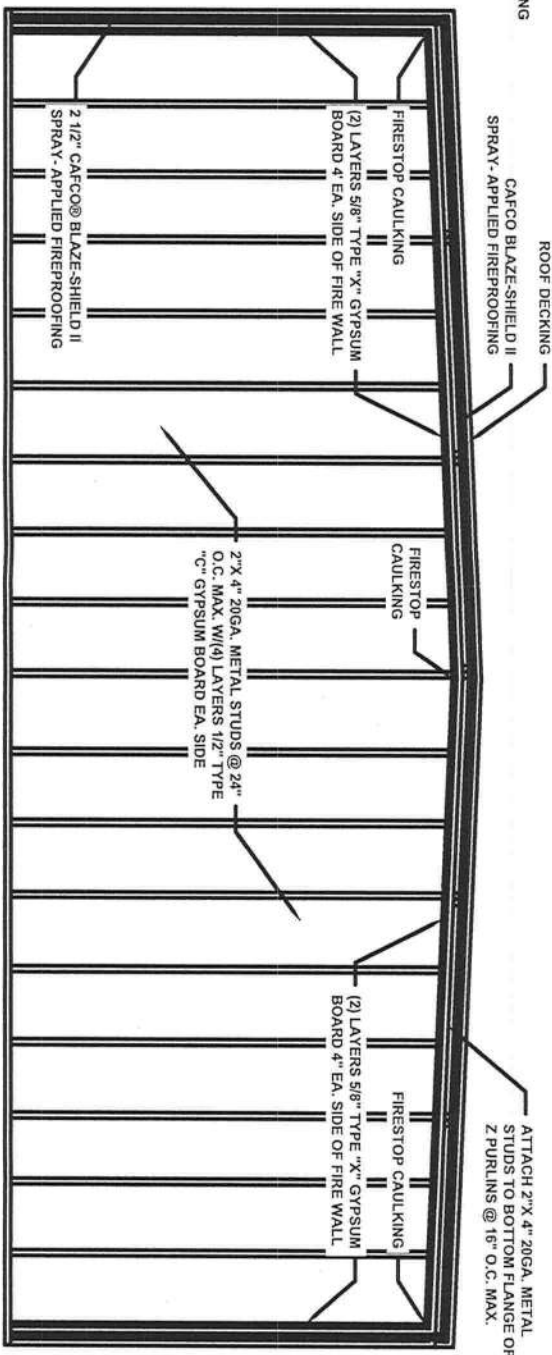

ELECTRIC RISER DIAGRAM
SCALE: NTS

| DATE | REVISIONS |
|------|-------------|
| | DESCRIPTION |



NORTH FLORIDA PROFESSIONAL SERVICES, INC.
P.O. BOX 3823
LAKE CITY, FL 32056
PH. 386-752-4675
LIC NO. LB8356

JOB NUMBER:
L180115-1BP
EOR:
ROBERT PHILIP
BISHOP, JR
P.E. NO.:
38546

ELECT. - FIREWALL PLAN BLDG 1100 & 1200
LAKE CITY MINI-STORAGE
COLUMBIA COUNTY, FLORIDA

SHEET NO. 03

THIS BUILDING IS DESIGNED WITH IMPORTANCE FACTORS REQUIRED FOR MINOR STORAGE FACILITIES. MINOR STORAGE FACILITIES ARE THOSE WHICH REPRESENT A LOW HAZARD TO HUMAN LIFE IN THE EVENT OF FAILURE. THIS PROJECT IS STATED TO BE A MINOR STORAGE MINI-WAREHOUSE FACILITY AND CERTAIN STORAGE FACILITIES ARE ACCEPTABLE UNDER THE LOW HAZARD DEFINITION. IT IS THE RESPONSIBILITY OF THE CUSTOMER TO VERIFY THIS IS ACCEPTABLE TO LOCAL CODE AUTHORITIES HAVING JURISDICTION. MANUFACTURER BEARS NO RESPONSIBILITY FOR USE OF REDUCED LOAD IMPORTANCE FACTORS.

STORAGE SYSTEMS
A division of Vulcan Steel Structures, Inc.
500 Vulcan Parkway Adel, Georgia 31620

CUSTOMER: MINI STORAGE & RECORD STORAGE of LAKE
JOB NUMBER: 28303
STREET ADDRESS: 2529 SW STATE ROAD
CITY, STATE, ZIP LAKE CITY, FL 32025
PROJECT NAME: 30X280X10 MINIS

NOTE : 2 IDENTICAL BUILDINGS

ENGINEER'S STAMP

ENGINEER'S STAMP

VANESSA L. BANKS
LICENSEE
No. 83970
STATE OF FLORIDA
PROFESSIONAL ENGINEER

1/11/24



| MEMBER TABLE | | | |
|--------------|---------|------------|--|
| MARK | PART | LENGTH | |
| S-1 | 4X20C16 | 10'-2" | |
| S-2 | 4X20C16 | 10'-4 1/2" | |
| S-3 | 4X20C16 | 10'-7" | |
| S-4 | 4X20C16 | 10'-1 1/4" | |

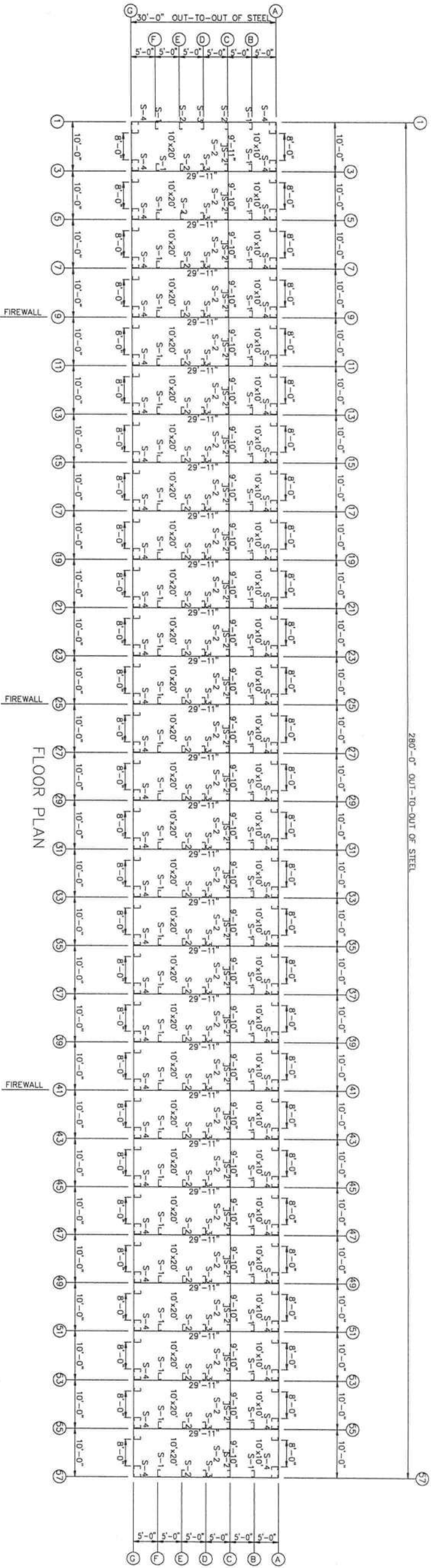

ALL (PC-*) COLUMNS ARE 4X20C16
ALL (DJ-*) COLUMNS ARE 4X20C16
SAI = 2X4X16GA ANGLE
PAI = 2X4X16GA ANGLE

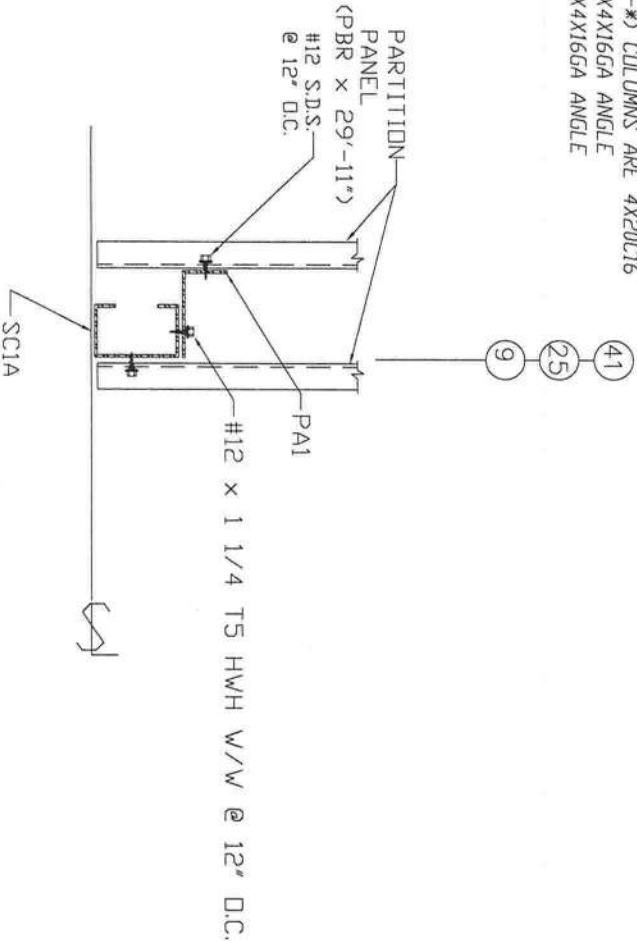

NOTE: SEE WALL ELEVATIONS
FOR FRAME PART MARKS

DETAIL AT FIREWALL

| REVISIONS | | | | DRAWING STATUS | | | | ORIGINAL SIGNATURE/REQUIRED | | | |
|-----------|-------------|------|-----|----------------|------|------|--|------------------------------|-------------------------------|--------------|-----------|
| REV. | DESCRIPTION | DATE | DLR | DATE | CHKR | APPD | | VULCAN STEEL STRUCTURES, INC | MINI STORAGE & RECORD STORAGE | FLOOR PLAN | |
| | | | | | | | | PROJECT | 30X280X10 MINIS | DESIGN | |
| | | | | | | | | ID | 28303 | DRAFT | MF |
| | | | | | | | | PROJECT | 2529 SW STATE ROAD | DATE: 1/9/24 | CHECK: VB |
| | | | | | | | | ADDRESS | | SHEET | E1 |



| TRIM TABLE | | | |
|------------|-------|--------|---------|
| QID | MARK | LENGTH | DETAIL |
| 1 | WMC | 2'-0" | TRIM_31 |
| 2 | WMP24 | 7'-0" | TRIM_31 |
| 3 | JCT4 | 8'-0" | TRIM_33 |
| 4 | WMC | 1'-0" | TRIM_31 |
| 5 | WCP12 | 7'-0" | TRIM_29 |
| 6 | CTR | 3'-3" | TRIM_40 |
| 7 | RVRE | 6" | TRIM_12 |
| 8 | SET | 10'-9" | TRIM_30 |
| 9 | HT | 19'-0" | TRIM_30 |
| 10 | JTR | 7'-3" | TRIM_30 |

| MEMBER TABLE | | | |
|--------------|----------|-------------|--|
| MARK | PART | LENGTH | |
| S-4 | 4X20C16 | 10'-1 1/4" | |
| DJ-1 | 4X20C16 | 10'-1 1/4" | |
| TC-2 | 4X25CH16 | 19'-11 3/4" | |
| TC-3 | 4X25CH16 | 20'-0 7/8" | |
| DH-1 | 4X20C16 | 7'-11 1/2" | |
| G-3 | 4X20C16 | 8'-0" | |

| CONNECTION PLATES | |
|-----------------------------|-----------|
| <input type="checkbox"/> ID | MARK/PART |
| <input type="checkbox"/> 1 | BC-1 |
| <input type="checkbox"/> 2 | MC-1 |
| <input type="checkbox"/> 3 | MC-1 |

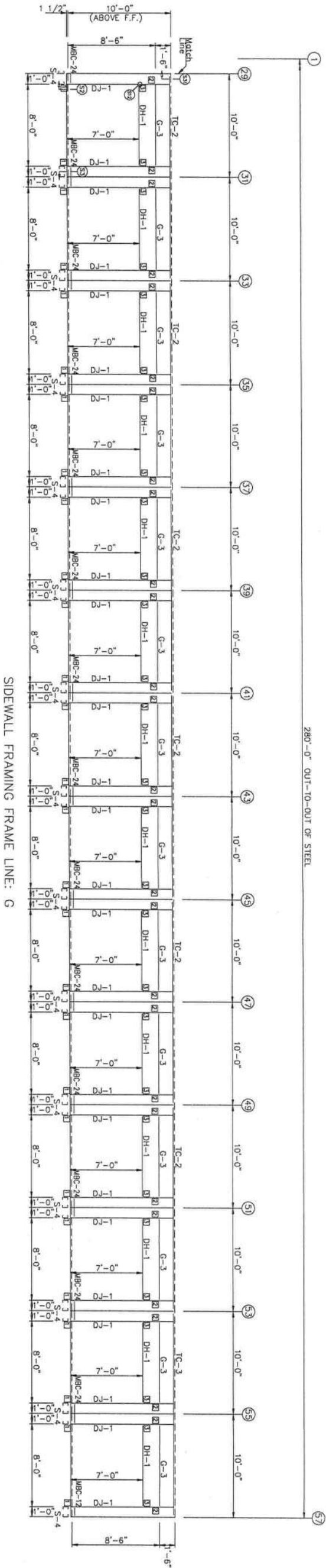

SIDEWALL FRAMING FRAME LINE: G

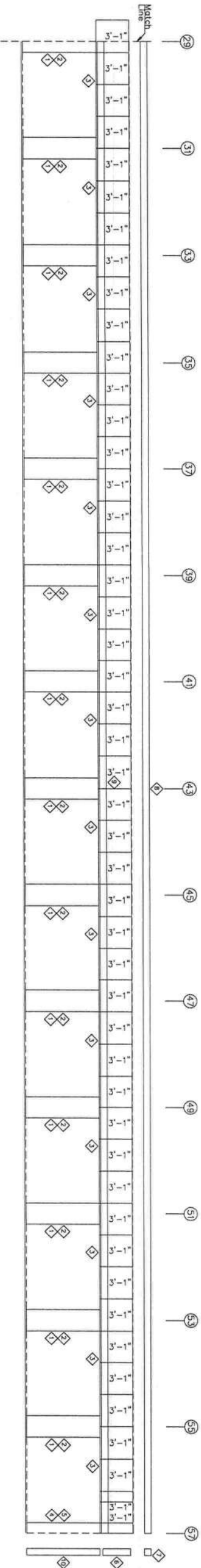

SIDEWALL SHEETING & TRIM FRAME LINE: G

PANELS: 26 Ga. PR - Light Stone

SEAL



ORIGINAL SIGNATURE REQUIRED

| REVISIONS | | | | | DRAWING STATUS | | | | | VULCAN STEEL STRUCTURES, INC | | |
|-----------|-------------|------|-----|------|----------------|------|--------------------------|--------------------------|--------------------------|------------------------------|--------------------|-------------------------------|
| REV. | DESCRIPTION | DATE | DLR | DATE | CHKR | APPD | <input type="checkbox"/> | <input type="checkbox"/> | <input type="checkbox"/> | PROJECT | 30X280X10 MINIS | MINI STORAGE & RECORD STORAGE |
| | | | | | | | <input type="checkbox"/> | <input type="checkbox"/> | <input type="checkbox"/> | ID | 28303 | SIDEWALL DRAWING |
| | | | | | | | <input type="checkbox"/> | <input type="checkbox"/> | <input type="checkbox"/> | PROJECT | 2529 SW STATE ROAD | DRAFT: MF |
| | | | | | | | <input type="checkbox"/> | <input type="checkbox"/> | <input type="checkbox"/> | ADDRESS | | CHECK: VB |
| | | | | | | | <input type="checkbox"/> | <input type="checkbox"/> | <input type="checkbox"/> | | | DATE: 1/ 9/24 |
| | | | | | | | <input type="checkbox"/> | <input type="checkbox"/> | <input type="checkbox"/> | | | SHEET |
| | | | | | | | <input type="checkbox"/> | <input type="checkbox"/> | <input type="checkbox"/> | | | E4 |

| TRIM TABLE | | | |
|------------|-------|--------|---------|
| ID | MARK | LENGTH | DETAIL |
| 1 | WMC | 1'-0" | TRIM_31 |
| 2 | WCP12 | 7'-0" | TRIM_33 |
| 3 | JCT4 | 8'-0" | TRIM_31 |
| 4 | WMC | 2'-0" | TRIM_31 |
| 5 | WMP24 | 7'-0" | TRIM_29 |
| 6 | CTR | 3'-3" | TRIM_40 |
| 7 | RYRE | 6" | TRIM_12 |
| 8 | SET | 10'-9" | TRIM_33 |
| 9 | H1 | 19'-0" | TRIM_33 |
| 10 | JTR | 7'-3" | TRIM_30 |

| MEMBER TABLE | | | |
|--------------|----------|-------------|--|
| MARK | PART | LENGTH | |
| S-4 | 4X20C16 | 10'-1 1/4" | |
| DJ-1 | 4X20C16 | 10'-1 1/4" | |
| TC-2 | 4X25CH16 | 19'-11 3/4" | |
| TC-3 | 4X25CH16 | 20'-0 7/8" | |
| DH-1 | 4X20C16 | 7'-11 1/2" | |
| G-3 | 4X20C16 | 8'-0" | |

| CONNECTION PLATES | |
|---------------------------------------|--|
| <input type="checkbox"/> ID MARK/PART | |
| 1 MC-1 | |
| 2 MC-1 | |

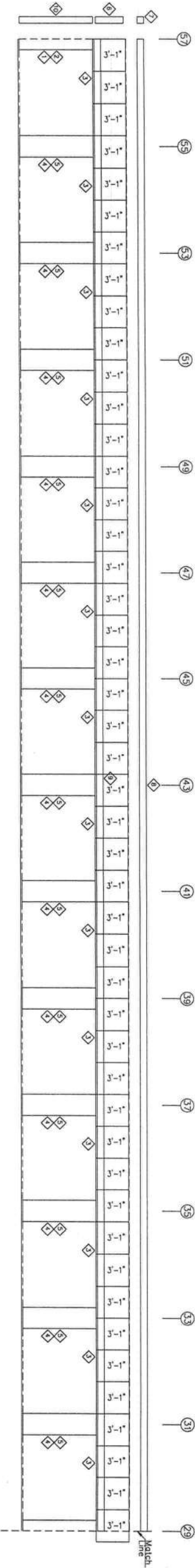
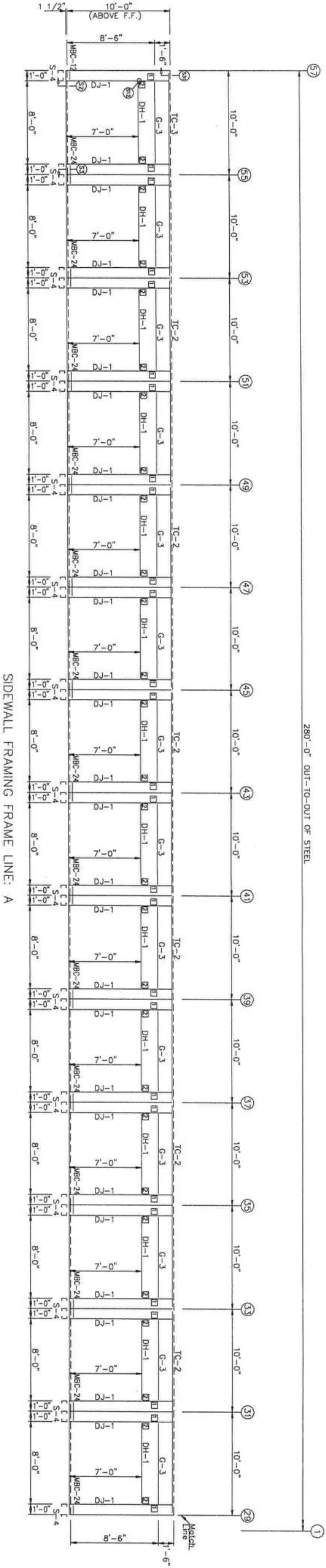

| REVISIONS | | | | DRAWING STATUS | | | | VULCAN STEEL STRUCTURES, INC. | |
|-----------|-------------|------|-----|----------------|------|------|--|-------------------------------|--------------------|
| REV. | DESCRIPTION | DATE | DLR | DATE | CHKR | APPR | | PROJECT | 30X280X10 MINIS |
| | | | | | | | | ID | 28303 |
| | | | | | | | | PROJECT | 2529 SW STATE ROAD |
| | | | | | | | | ADDRESS | |

ORIGINAL SIGNATURE REQUIRED

1/11/24

MINI STORAGE & RECORD STORAGE

SIDEWALL DRAWING

DESIGN: DRAFT: MC

CHECK: VB

DATE: 1/ 9/24

SHEET

ES

TRIM TABLE

| QID | MARK | LENGTH | DETAIL |
|-----|------|--------|-----------|
| 1 | RVRT | 15'-4" | TRIM - 11 |
| 2 | RVPB | 1'-4" | TRIM - 39 |

MEMBER TABLE

| MARK | PART | LENGTH |
|------|---------|-------------|
| S-1 | 4X20C16 | 10'-2" |
| S-2 | 4X20C16 | 10'-4" 1/2" |
| S-3 | 4X20C16 | 10'-7" |
| G-1 | 4X20C16 | 4'-7 1/2" |
| G-2 | 4X20C16 | 4'-9 1/2" |

CONNECTION PLATE:

| QID | MARK/PART |
|-----|-----------|
| 1 | BC-1 |
| 2 | MC-1 |

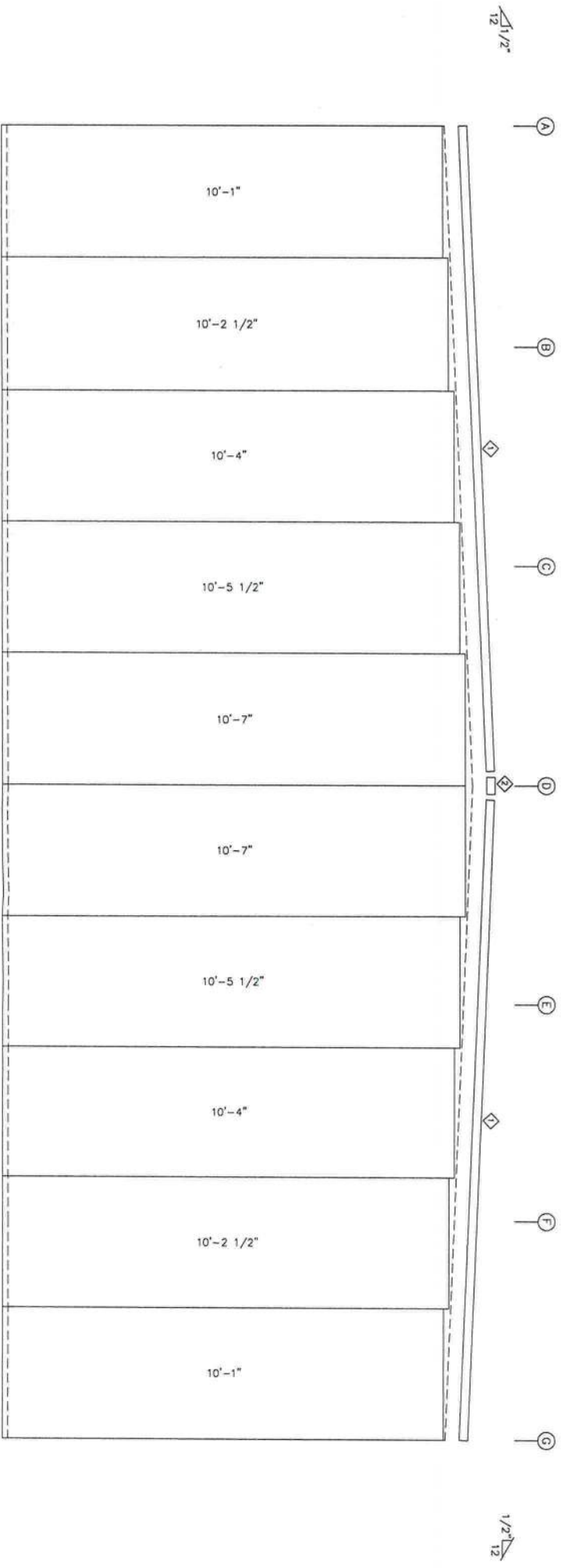
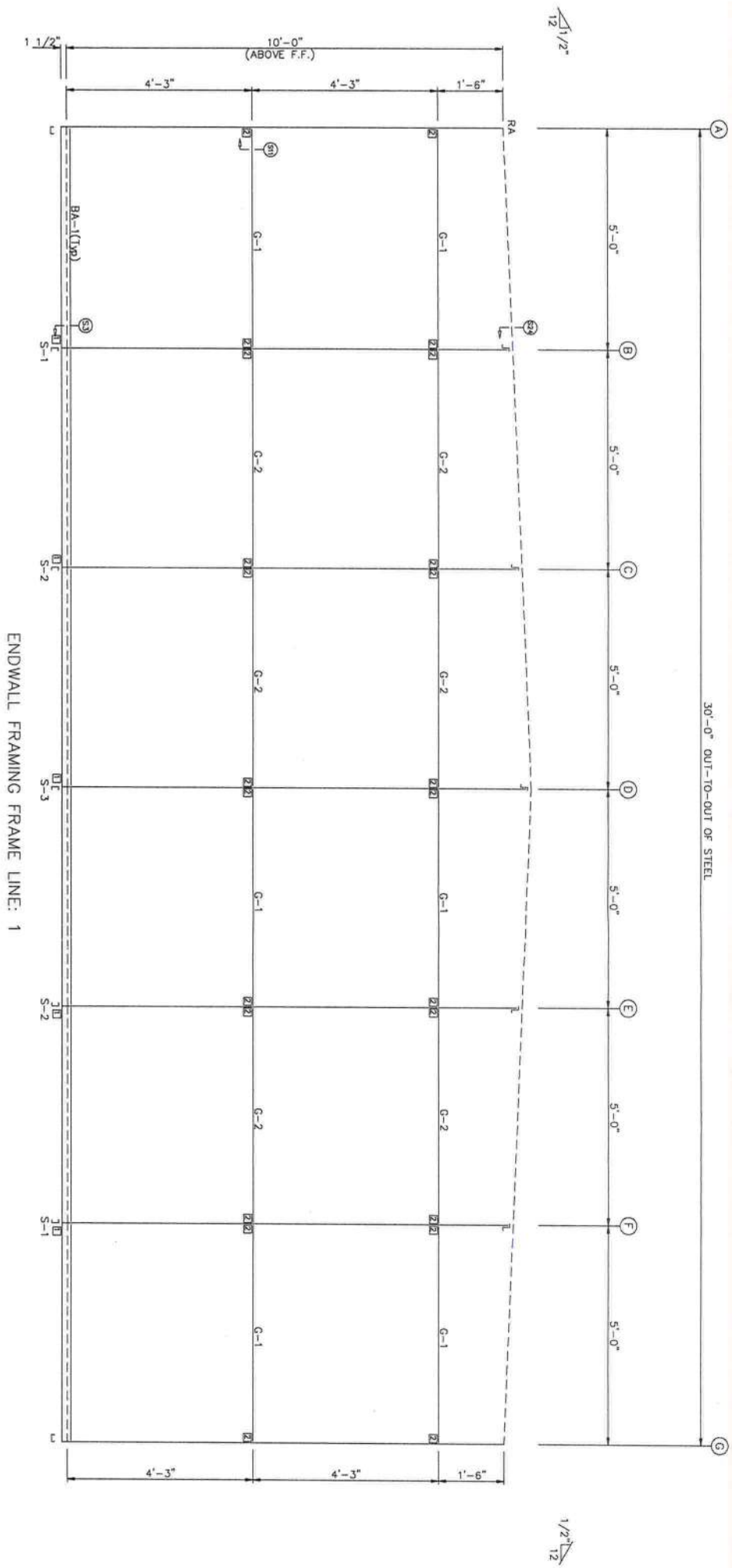

ENDWALL SHEETING & TRIM FRAME LINE: 1

PANELS: 26 Gps. PR - Light Stone

REVISIONS

| REV. | DESCRIPTION | DATE | DLR | DATE | CHKR | APPD |
|------|-------------|------|-----|------|------|------|
| | | | | | | |
| | | | | | | |
| | | | | | | |

DRAWING STATUS

| |
|--|
| <input type="checkbox"/> FINAL ERECTION |
| <input checked="" type="checkbox"/> FOR CONSTRUCTION |
| <input type="checkbox"/> FOR APPROVAL |
| <input type="checkbox"/> OTHER, EXPLAIN |

| |
|------------------------------|
| VULCAN STEEL STRUCTURES, INC |
| PROJECT 30X280X10 MINIS |
| ID 28303 |
| PROJECT 2529 SW STATE ROAD |
| ADDRESS |

| |
|-------------------------------|
| MINI STORAGE & RECORD STORAGE |
| ENDWALL DRAWING |
| DESIGN: DRAFT: MF CHECK: VB |
| DATE: 1/ 9/24 SHEET E7 |



