

ROOF VENTILATION:
R806.2 Minimum vent area
The minimum net free ventilating area shall be 1/150 of the area of the vented space.
Exception: The minimum net free ventilation area shall be 1/300 of the vented space provided one or more of the following conditions are met:
1. In Climate Zones 6, 7 and 8, a Class I or II vapor retarder is installed on the warm-in-winter side of the ceiling.
2. At least 40 percent and not more than 50 percent of the required ventilating area is provided by ventilators located in the upper portion of the attic or rafter space.
Upper ventilators shall be located no more than 3 feet below the ridge or highest point of the space, measured vertically, with the balance of the required ventilation provided by eave or cornice vents. Where the location of wall or roof framing members conflicts with the installation of upper ventilators, installation more than 3 feet below the ridge or highest point of the space shall be permitted.



FRONT ELEVATION
SCALE: 1/4" = 1'-0"



REAR ELEVATION
SCALE: 1/4" = 1'-0"



LEFT ELEVATION
SCALE: 1/4" = 1'-0"



RIGHT ELEVATION
SCALE: 1/4" = 1'-0"

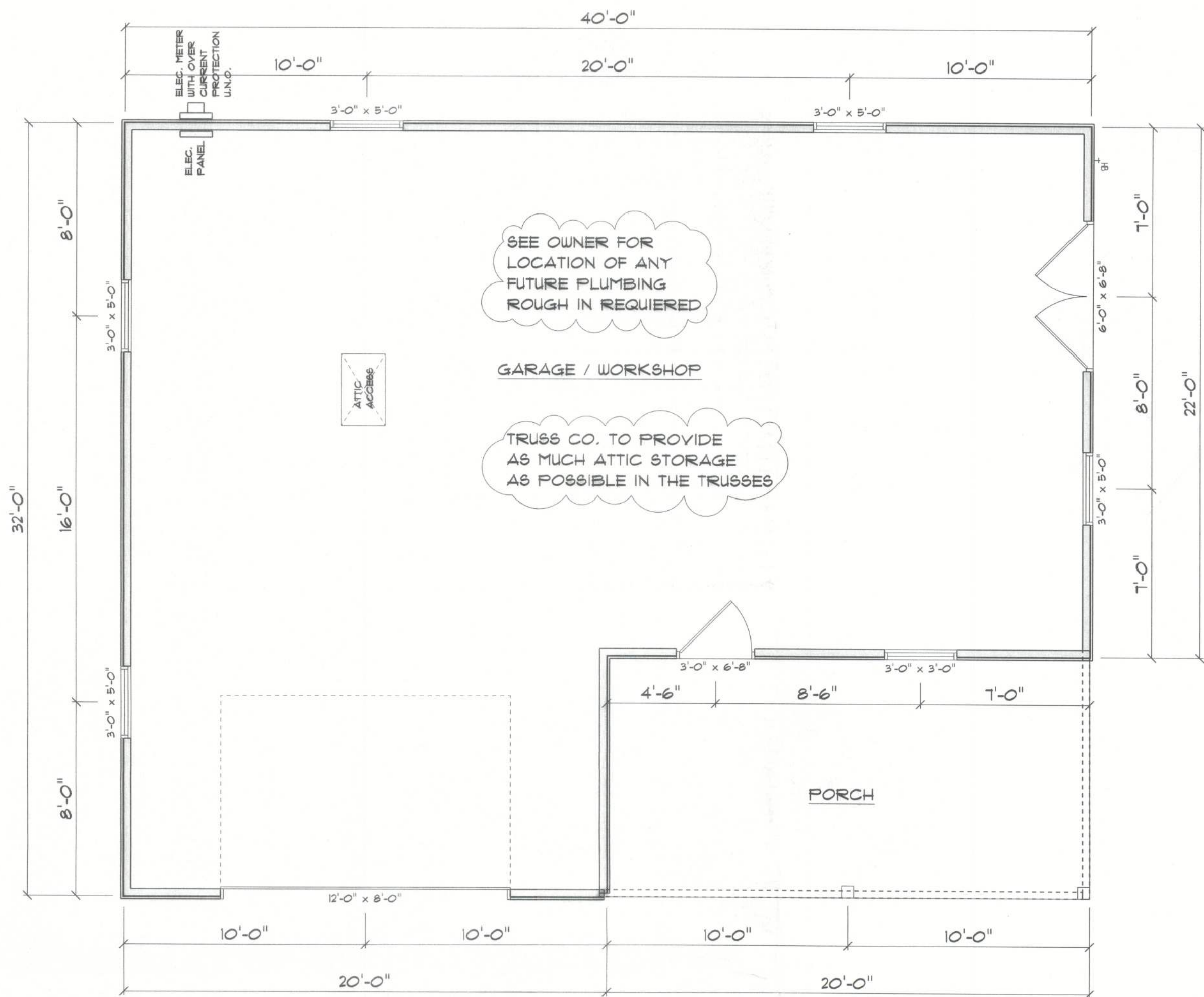

FLOOR PLAN
SCALE: 1/4" = 1'-0"
ALL CEILING HEIGHTS TO BE 10'-0" UNLESS NOTED OTHERWISE

AREA SCHEDULE	
NAME	AREA
Garage	1080 sq ft.
Porch	200 sq ft.
Total Under Roof	1280 sq ft.

Bob Nichol Garage / Workshop

PROJECT ADDRESS:
217 SW Dragonfly Ct, Lake City, FL 32024

FL PE 53915
This item has been digitally signed and sealed by Mark Disosway P.E. on digital signature date. Printed copies of this document are not considered signed and sealed. The digital signature must be verified on original copies.



DIMENSIONS:
Stated dimensions supercede scaled dimensions. Refer all questions to Mark Disosway, P.E. for resolution. Do not proceed without clarification.

COPYRIGHTS AND PROPERTY RIGHTS:
Mark Disosway, P.E. hereby expressly reserves its common law copyrights and property right in these instruments of service. This document is not to be reproduced, altered or copied in any form or manner without first the express written permission and consent of Mark Disosway.

CERTIFICATION: I hereby certify that I have examined this plan, and that the applicable portions of the plan, relating to wind engineering comply with the 7th Edition Florida Building Code Residential (2020) to the best of my knowledge.

LIMITATION: This design is valid for one building, at specified location.

Mark Disosway P.E.
163 SW Midtown Place
Suite 103
Lake City, Florida 32025
386.754.5419
disoswaydesign@gmail.com

JOB NUMBER:
230385

1
OF 4 SHEETS

