

DATE 08/20/2004

Columbia County Building Permit

PERMIT

This Permit Expires One Year From the Date of Issue

000022217

APPLICANT DONALD MCDIARMID PHONE 497-2655
ADDRESS 334 SW ELIM CHURCH ROAD FT. WHITE FL 32038
OWNER DONALD & BRENDA MCDIARMID PHONE 497-2655
ADDRESS 334 SW ELIM CHURCH ROAD FT. WHITE FL 32038
CONTRACTOR CHESTER KNOWLES PHONE 755-6441
LOCATION OF PROPERTY 441 S, TR ON CR 18, TR ON 131, TL ON ELIM CHURCH RD,
PROPERTY ON RIGHT ACROSS FROM HATCH'S BLUEBERRY SIGN
TYPE DEVELOPMENT MH, UTILITY ESTIMATED COST OF CONSTRUCTION .00
HEATED FLOOR AREA TOTAL AREA HEIGHT .00 STORIES
FOUNDATION WALLS ROOF PITCH FLOOR
LAND USE & ZONING A-3 MAX. HEIGHT
Minimum Set Back Requirments: STREET-FRONT 30.00 REAR 25.00 SIDE 25.00
NO. EX.D.U. 0 FLOOD ZONE X DEVELOPMENT PERMIT NO.

PARCEL ID 30-6S-17-09813-008 SUBDIVISION
LOT BLOCK PHASE UNIT TOTAL ACRES 5.00

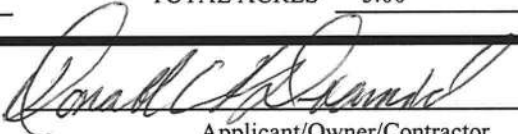
 IH0000509 
Culvert Permit No. Culvert Waiver Contractor's License Number Applicant/Owner/Contractor
EXISTING 04-0705 BK RK Y
Driveway Connection Septic Tank Number LU & Zoning checked by Approved for Issuance New Resident

COMMENTS: ONE FOOT ABOVE THE ROAD

Check # or Cash 1014

FOR BUILDING & ZONING DEPARTMENT ONLY

(footer/Slab)

Temporary Power Foundation Monolithic
 date/app. by date/app. by date/app. by
Under slab rough-in plumbing Slab Sheathing/Nailing
 date/app. by date/app. by date/app. by
Framing Rough-in plumbing above slab and below wood floor
 date/app. by date/app. by date/app. by
Electrical rough-in Heat & Air Duct Peri. beam (Lintel)
 date/app. by date/app. by date/app. by
Permanent power C.O. Final Culvert
 date/app. by date/app. by date/app. by
M/H tie downs, blocking, electricity and plumbing Pool
 date/app. by date/app. by date/app. by
Reconnection Pump pole Utility Pole
 date/app. by date/app. by date/app. by
M/H Pole Travel Trailer Re-roof
 date/app. by date/app. by date/app. by

BUILDING PERMIT FEE \$.00 CERTIFICATION FEE \$.00 SURCHARGE FEE \$.00
MISC. FEES \$ 200.00 ZONING CERT. FEE \$ 50.00 FIRE FEE \$ WASTE FEE \$
FLOOD ZONE DEVELOPMENT FEE \$ CULVERT FEE \$ TOTAL FEE 250.00

INSPECTORS OFFICE  CLERKS OFFICE 

NOTICE: IN ADDITION TO THE REQUIREMENTS OF THIS PERMIT, THERE MAY BE ADDITIONAL RESTRICTIONS APPLICABLE TO THIS PROPERTY THAT MAY BE FOUND IN THE PUBLIC RECORDS OF THIS COUNTY. AND THERE MAY BE ADDITIONAL PERMITS REQUIRED FROM OTHER GOVERNMENTAL ENTITIES SUCH AS WATER MANAGEMENT DISTRICTS, STATE AGENCIES, OR FEDERAL AGENCIES.

"WARNING TO OWNER: YOUR FAILURE TO RECORD A NOTICE OF COMMENCEMENT MAY RESULT IN YOUR PAYING TWICE FOR IMPROVEMENTS TO YOUR PROPERTY. IF YOU INTEND TO OBTAIN FINANCING, CONSULT WITH YOUR LENDER OR AN ATTORNEY BEFORE RECORDING YOUR NOTICE OF COMMENCEMENT."

This Permit Must Be Prominently Posted on Premises During Construction

PLEASE NOTIFY THE COLUMBIA COUNTY BUILDING DEPARTMENT AT LEAST 24 HOURS IN ADVANCE OF EACH INSPECTION. IN ORDER THAT IT MAY BE MADE WITHOUT DELAY OR INCONVENIENCE, PHONE 758-1008. THIS PERMIT IS NOT VALID UNLESS THE WORK AUTHORIZED BY IT IS COMMENCED WITHIN 6 MONTHS AFTER ISSUANCE.

The Issuance of this Permit Does Not Waive Compliance by Permittee with Deed Restrictions.

WARRANTY DEED

(STATUTORY FORM - SECTION 689.02, F.S.)

This document prepared by and to be returned to:

Gary D. Grunder
Grunder & Petteway, P. A.
23349 NW CR 236, Suite 10
High Springs, Florida, 32643

Tax Parcel Number:
A portion of R09813-008

THIS INDENTURE made July 21, 2004,

BETWEEN Joseph M. Rudofski and Debra A. Rudofski, husband and wife, whose post office address is 189 SW Elim Church Road, Ft White, Florida, 32038, herein called Grantor, and

Donald C. McDiarmid and Brenda K. McDiarmid, husband and wife, whose post office address is 14406 Tustenuggee Road, Ft. White, Florida, 32038, herein called Grantee,

Witnesseth that said grantor, for and in consideration of the sum of TEN AND NO/100 (\$10.00) Dollars, and other good and valuable considerations to said grantor in hand paid by said grantee, the receipt whereof is hereby acknowledged, has granted, bargained and sold to the said grantee, and grantee's heirs and assigns forever, the following described land, situate, lying and being in the county(ies) of Columbia state of Florida, to wit:

A part of Section 30, Township 6 South, Range 17 East, being more particularly described as follows:

Commence at the intersection of the West line of the SE 1/4 of said Section 30 and the Northerly right-of-way line of State Road No. 18 and run North 00 deg. 13 min. 14 sec. West, along said West line of the SE 1/4, 796.36 feet to the Point of Beginning; thence continue North 00 deg. 13 min. 14 sec. West, along said West line of the SE 1/4, 487.10 feet to the South right-of-way line of Elim Church Road; thence South 86 deg. 19 min. 43 sec. East, along said South right-of-way line, 448.17 feet; thence South 00 deg. 13 min. 14 sec. East, 487.10 feet; thence North 86 deg. 19 min. 43 sec. West, 448.17 feet to the Point of Beginning. *OK*

AND SAID GRANTOR does hereby fully warrant the title to said land, and will defend the same against the lawful claims of all persons whomsoever.

Grantor and grantee are used for singular or plural, as context requires.

In Witness Whereof, grantor has hereunto set grantor's hand and seal the day and year first above written.

Signed, sealed and delivered in our presence:

Summer Cauik
Witness: Print Name Summer Cauik
Sarah S. Nystrom
Witness: Print Name Sarah S. Nystrom

Joseph M. Rudofski
Joseph M. Rudofski

Summer Cauik
Witness: Print Name Summer Cauik
Sarah S. Nystrom
Witness: Print Name Sarah S. Nystrom

Debra A. Rudofski
Debra A. Rudofski

State of Florida
County of Alachua

The foregoing instrument was acknowledged before me this 20th day of July, 2004 by
Debra A. Rudofski who

- ☐ is personally known to me
☒ who has produced a valid Florida driver's license as identification
☐ who produced _____ as identification

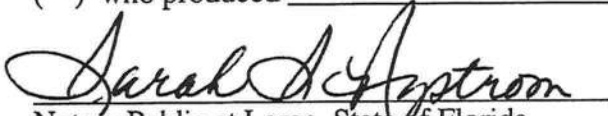
Notary Public at Large, State of Florida

(SEAL)

OFFICIAL SEAL
SARAH S. NYSTROM
NOTARY PUBLIC - STATE OF FLORIDA
COMMISSION # DD818718
My Commission Exp. April 18, 2008

State of Florida
County of Alachua

The foregoing instrument was acknowledged before me this 21st day of July, 2004 by
Joseph M. Rudofski who

- ☒ is personally known to me
☐ who has produced a valid Florida driver's license as identification
☐ who produced _____ as identification

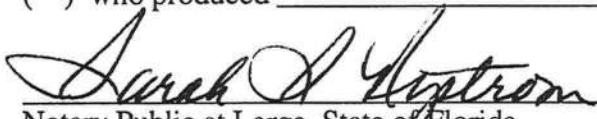
Notary Public at Large, State of Florida

(SEAL)

OFFICIAL SEAL
SARAH S. NYSTROM
NOTARY PUBLIC - STATE OF FLORIDA
COMMISSION # DD818718
My Commission Exp. April 18, 2008

7447

PERMIT APPLICATION / MANUFACTURED HOME INSTALLATION APPLICATION

For Office Use Only		Zoning Official <u>BLK 19.08.04</u>		Building Official <u>BLK 8-20-04</u>	
AP# <u>0408-43</u>	Date Received <u>8/12/04</u>	By <u>G</u>	Permit # <u>22217</u>		
Flood Zone <u>X</u>	Development Permit <u>N/A</u>	Zoning <u>A-3</u>	Land Use Plan Map Category <u>A-3</u>		
Comments _____					
<input checked="" type="checkbox"/> Site Plan with Setbacks shown <input checked="" type="checkbox"/> Environmental Health Signed Site Plan <input checked="" type="checkbox"/> Env. Health Release <input checked="" type="checkbox"/> Need a Culvert Permit <input checked="" type="checkbox"/> Need a Waiver Permit <input checked="" type="checkbox"/> Well letter provided <input checked="" type="checkbox"/> Existing Well					

- Property ID 30-68-17-09813-008 Must have a copy of the property deed
- New Mobile Home ☒ Used Mobile Home _____ Year _____
- Subdivision Information _____
- Applicant DONALD CM McDIARMID Phone # 386-497-2655
- Address 334 S.W. GLIM CHURCH RD FT. WHITE FL 32038
- Name of Property Owner DONALD / Brenda McDiarmid Phone# 497-2655
- 911 Address 334 S.W. GLIM CHURCH RD FT. WHITE FL. 32038
- Name of Owner of Mobile Home SAME Phone # SAME
- Address SAME
- Relationship to Property Owner SAME
- Current Number of Dwellings on Property 0
- Lot Size _____ Total Acreage 5
- Explain the current driveway Existing
- Driving Directions 441 South, TR ON CR 18, TR ON 131, Then T.L. ON Elin Church Rd go .2 miles property on Right across from HATCH's Blueberry Sign.
- Is this Mobile Home Replacing an Existing Mobile Home NO (Assessments pd)
- Name of Licensed Dealer/Installer Jessie L. Chester Knowles Phone # 955-6441
- Installers Address PO BOX 328 LAKE CITY FL 32056
- License Number IH 0000509 Installation Decal # 226856

CK#1014



STATE OF FLORIDA
DEPARTMENT OF HEALTH

APPLICATION FOR ONSITE SEWAGE DISPOSAL SYSTEM CONSTRUCTION PERMIT

Permit Application Number

04-0705-N

PART II - SITE PLAN

Scale: Each block represents 5 feet and 1 inch = 100 feet.

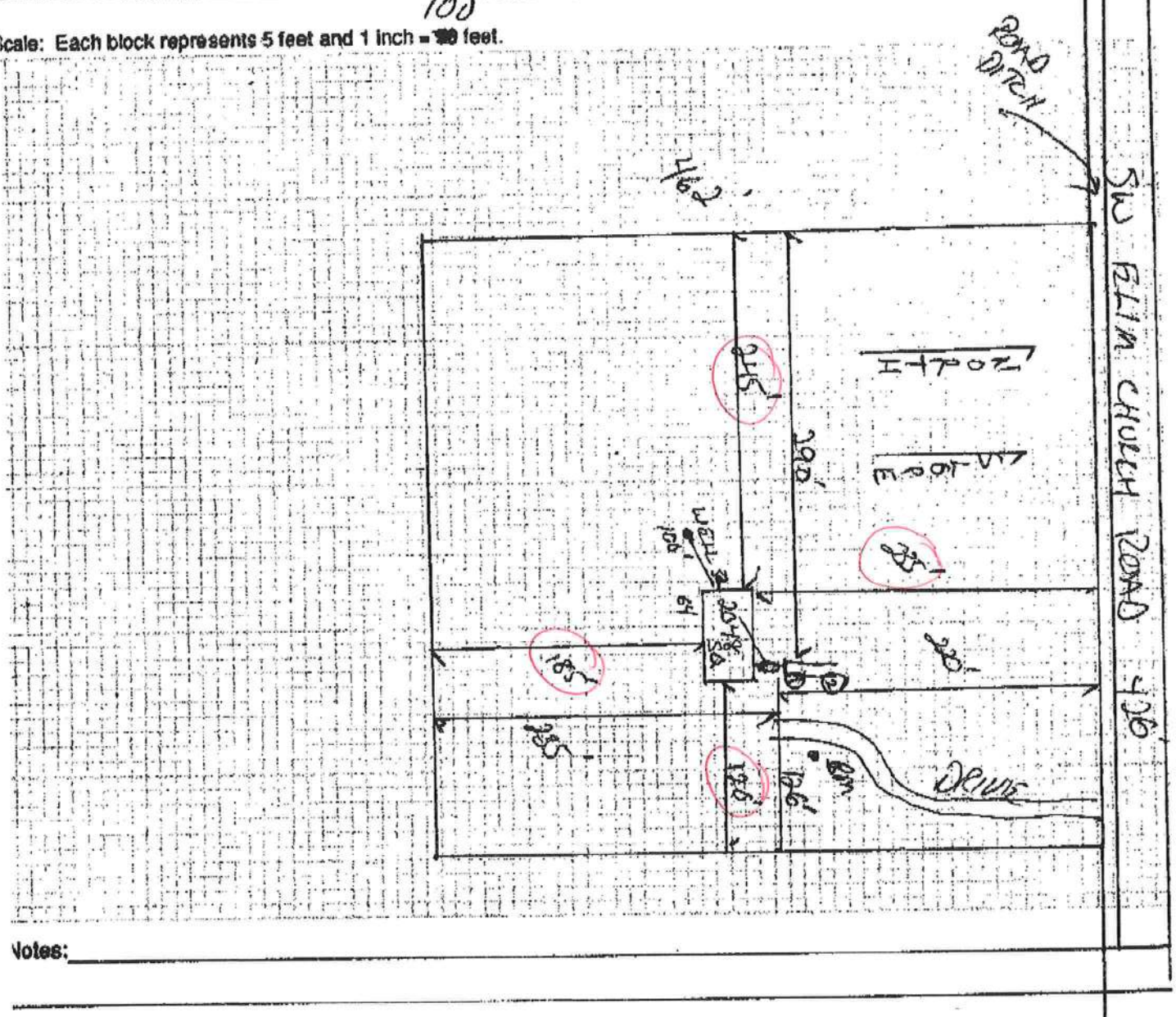

Notes:

Site Plan submitted by:

Rocky D. F. O.

Signature

Master Contractor

Title

Plan Approved ☒Not Approved ☐

Date 6.24.04

By

Sallie A. Gaddy - Est Columbia

County Health Department

ALL CHANGES MUST BE APPROVED BY THE COUNTY HEALTH DEPARTMENT

LETTER OF AUTHORIZATION TO PULL PERMITS

I, "Jessie L. Chester Knowles", DO HEREBY GRANT

DONALD M. DIARMIDA, AUTHORIZATION TO PULL THE NECESSARY

PERMITS REQUIRED FOR THE DELIVERY AND SET OF A MANUFACTURED

HOME IN Columbia COUNTY, FLORIDA.

Jessie L. Chester Knowles

THIS FOREGOING INSTRUMENT WAS ACKNOWLEDGED BEFORE ME THIS

11TH DAY OF August, 2004, BY _____

Jessie L. "Chester" Knowles, WHO IS PERSONALLY KNOWN TO ME.

STATE OF FLORIDA
COUNTY OF Columbia

Robin D. King Harris
NOTARY PUBLIC



PERMIT NUMBER

Installer Jessie L. Chester Krallos License #

Address of home being installed

Manufacturer Skylife Length x width 32x64 Box

NOTE: if home is a single wide fill out one half of the blocking plan if home is a triple or quad wide sketch in remainder of home

I understand Lateral Arm Systems cannot be used on any home (new or used) where the sidewall ties exceed 5 ft 4 in.

Installer's initials

Typical pier spacing

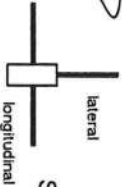

Show locations of Longitudinal and Lateral Systems (use dark lines to show these locations)

marriage wall piers within 2' of end of home per Rule 15C

See ATTACHED Factory blocking diagram

New Home ☒ Used Home ☐

Home installed to the Manufacturer's Installation Manual ☒

Home is installed in accordance with Rule 15-C ☐

Single wide ☐ Wind Zone II ☒ Wind Zone III ☐

Double wide ☒ Installation Decal # 226856

Triple/Quad ☐ Serial # ORDER

PIER SPACING TABLE FOR USED HOMES

Load bearing capacity (sq in)	16" x 16" (256)	18 1/2" x 18 1/2" (342)	20" x 20" (400)	22" x 22" (484)	24" x 24" (576)	26" x 26" (676)
1000 psf	3'	4'	5'	6'	7'	8'
1500 psf	4'6"	6'	7'	8'	8'	8'
2000 psf	6'	8'	8'	8'	8'	8'
2500 psf	7'6"	8'	8'	8'	8'	8'
3000 psf	8'	8'	8'	8'	8'	8'
3500 psf	8'	8'	8'	8'	8'	8'

* Interpolated from Rule 15C-1 pier spacing table.

PIER PAD SIZES

POPULAR PAD SIZES

Pad Size	Sq In
16 x 16	256
16 x 18	288
18.5 x 18.5	342
16 x 22.5	360
17 x 22	374
13 1/4 x 26 1/4	348
20 x 20	400
17 3/16 x 25 3/16	441
17 1/2 x 25 1/2	446
24 x 24	576
26 x 26	676

23'2x31'2

N/A

I-beam pier pad size

Perimeter pier pad size

Other pier pad sizes (required by the mfg.)

16x16

Draw the approximate locations of marriage wall openings 4 foot or greater. Use this symbol to show the piers.

List all marriage wall openings greater than 4 foot and their pier pad sizes below.

ANCHORS

Opening

Pier pad size

4 ft 5 ft

FRAME TIES

within 2' of end of home spaced at 5' 4" oc

TIEDOWN COMPONENTS

OTHER TIES

Longitudinal Stabilizing Device (LSD)

Manufacturer

Longitudinal Stabilizing Device w/ Lateral Arms

Manufacturer

Oliver Technology

Number

24

Longitudinal

Marriage wall

Shearwall

N/A

weight over 5000# prepared 3 of above

POCKET PENETROMETER TEST

The pocket penetrometer tests are rounded down to _____ psf or check here to declare 1000 lb. soil ☒ without testing.

X 1.0 X 1.0 X 1.0

POCKET PENETROMETER TESTING METHOD

1. Test the perimeter of the home at 6 locations.
2. Take the reading at the depth of the footer.
3. Using 500 lb. increments, take the lowest reading and round down to that increment.

X 1.0 X 1.0 X 1.0

TORQUE PROBE TEST

The results of the torque probe test is N/A under 10 ft system inch pounds or check here if you are declaring 5' anchors without testing. A test showing 275 inch pounds or less will require 4 foot anchors.

Note: A state approved lateral arm system is being used and 4 ft. anchors are allowed at the sidewall locations. 1 under stand 5 ft anchors are required at all centerline tie points where the torque test reading is 275 or less and where the mobile home manufacturer may requires anchors with 4000 lb holding capacity.

gfk Installer's initials

ALL TESTS MUST BE PERFORMED BY A LICENSED INSTALLER

Installer Name

Date Tested

Jessie L. Chestnut
8-10-04

Electrical

Connect electrical conductors between multi-wide units, but not to the main power source. This includes the bonding wire between multi-wide units. Pg. 15C-1

Plumbing

Connect all sewer drains to an existing sewer tap or septic tank. Pg. 15C-1
Connect all potable water supply piping to an existing water meter, water tap, or other independent water supply systems. Pg. 15C-1

Site Preparation

Debris and organic material removed ☒ Swale ☐ Pad ☐ Other ☐
Water drainage: Natural ☒ Swale ☐ Pad ☐ Other ☐

Fastening multi wide units

Floor: Type Fastener: 4x5 Length: 6" Spacing: 24"
Walls: Type Fastener: SCWD Length: 4" Spacing: 24"
Roof: Type Fastener: 4x5 Length: 6" Spacing: 48"
For used homes a min 30 gauge, 8" wide, galvanized metal strip will be centered over the peak of the roof and fastened with galv. roofing nails at 2" on center on both sides of the centerline.

Gas/Ket (weatherproofing requirement)

I understand a properly installed gasket is a requirement of all new and used homes and that condensation, mold, mildew and buckled marriage walls are a result of a poorly installed or no gasket being installed. I understand a strip of tape will not serve as a gasket.

Installer's initials

Type gasket

Pg.

Roll form

Installed:

Between Floors Yes ☒

Between Walls Yes ☒

Bottom of ridgebeam Yes ☒

Weatherproofing

The bottomboard will be repaired and/or taped. Yes ☒ Pg. 15C-1
Siding on units is installed to manufacturer's specifications. Yes ☒
Fireplace chimney installed so as not to allow intrusion of rain water. Yes ☒

Miscellaneous

Skirting to be installed. Yes ☒ No ☐
Dryer vent installed outside of skirting. Yes ☐ N/A ☒
Range downflow vent installed outside of skirting. Yes ☐ N/A ☒
Drain lines supported at 4 foot intervals. Yes ☒
Electrical crossovers protected. Yes ☒
Other: 15C-1 STATE CODE PAGE # MAY
BE MAY NOT BE IN INSTALLATION MANUAL

Installer verifies all information given with this permit worksheet is accurate and true based on the

manufacturer's installation instructions and or Rule 15C-1 & 2

Installer Signature

Jessie L. Chestnut Date 8-10-04

Mediarmid

Stack Pyramid 3-23 1/2 x 3 1/2 Pads weight exceed 5000#

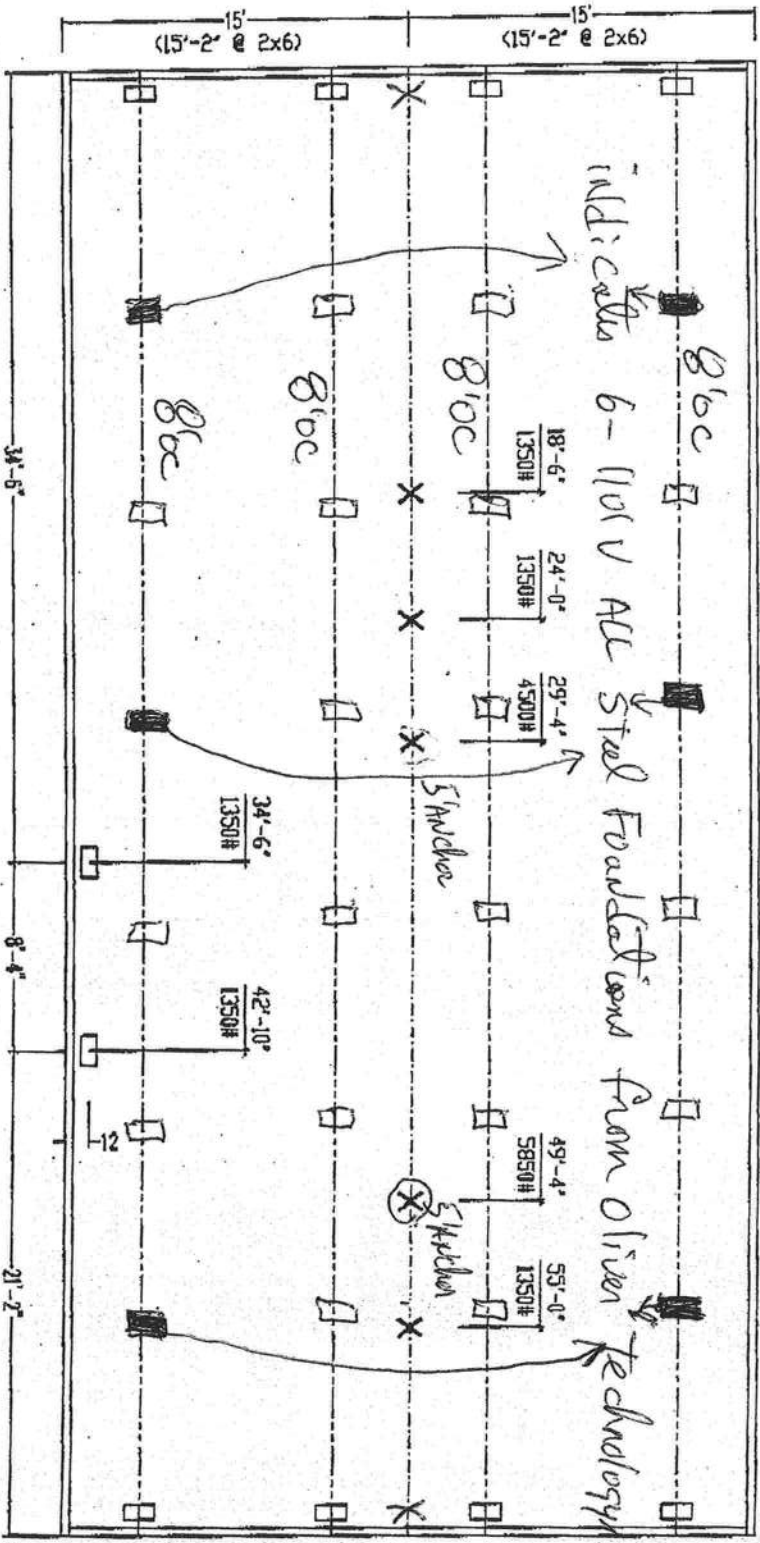
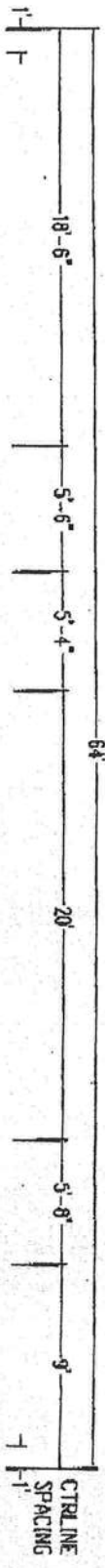

FLORIDA ONLY PIER POINT LAYOUT (PIERS @ I-BEAM & CENTERLINE WITHOUT PERIMETER FOUNDATION)

20 PSF ROOF ZONE

X COLUMN SUPPORTS - SEE ABOVE DIAGRAM FOR LOCATIONS & LOAD REQUIREMENTS @ 20# ROOF ZONE. SEE TABLE 4 OF INSTALLATION MANUAL FOR FLOORING SIZES.

I-BEAM PIER SUPPORTS - 8' MAX SPACING - SEE INSTALLATION MANUAL TABLE 2 FOR SPACING AND TABLE 4 FOR FLOORING SIZES.

NOTE: CONTACT MANUFACTURING DIVISION FOR LOCATION OF OPTIONAL PAINT DOORS OR OTHER LARGE OPENINGS.

DIVISIONS		REVIEWS		BOX LENGTH		DESCRIPTION AT X-3/2		SKYLINE	
111	341	562							CREATING PER YEAR DAYS 12/31/2003 BOOK 2010S 210
112	344	553							
115	345	571							
125	356	561							
131	525	812							
143 X	651								SHEET OF DRAWING NUMBER
163	656								
171	658								
181	538								
64'-0"				6432-30K-2B-CATH				5728-CIL	

Mobile Home Installers Affidavit

Florida Statute Section 320.8249 Requires Mobile Home Installers to be Licensed:

Any person who engages in mobile home installation shall obtain a mobile home installers license from the Bureau of Mobile Home and Recreational Vehicle construction of the Department of Highway Safety and Motor Vehicles Pursuant to this section.

I, Jessie L. Chester Knowles, License No. IH 0000509
Please Type or Print

do hereby state that the installation of the manufactured home at

911 Address of the Job site

Will be done under my supervision.

Jessie L. Chester Knowles
signature

Sworn to and subscribed before me this _____ day of _____ A.D. 2000

Notary Public: Robin D. King Harris My Commission Expires: 09-07-07
Signature Date

Personally Known: ✓

Produce Valid Identification: _____

Stamp or seal



PURCHASE AGREEMENT

SHOWCASE HOMES

DIRECT

DATE OF BIRTH

HIM:

HER:

P. O. Box 2736 • Hwy. 252 S. • Pinemount Road

Lake City, FL 32056

386-758-9538 Office • 386-758-6889 Fax

Toll Free: 1-888-313-2899

DRIVER'S LICENSE

HIM:

HER:

Locally Owned and Operated

PHONE:

SOLD TO <u>DONALD C McDIARMID</u>		PHONE: <u>386-497-2655</u>		DATE <u>5-27-04</u>	
ADDRESS <u>189 S.W. ELIN CHURCH RD</u>		COUNTY <u>COLUMBIA</u>		SALESMAN <u>Kent</u>	
Subject to the Terms and Conditions Stated on Both Sides of this Agreement Seller Agrees to Sell and the Purchaser Agrees to Purchase the Following Described Property:					
MAKE <u>SKYline</u>	MODEL <u>Ramada</u>	B. ROOMS <u>3</u>	FLOOR SIZE <u>1,641</u> W. <u>32</u>	HITCH SIZE <u>1,68</u> W. <u>32</u>	STOCK NUMBERS
SERIAL NUMBER <u>SP Order</u>	<input checked="" type="checkbox"/> NEW <input type="checkbox"/> USED	COLOR	PROPOSED DELIVERY DATE	KEY NUMBERS	HUD label number
OPTIONAL EQUIPMENT, LABOR AND ACCESSORIES			PRICE OF UNIT <u>\$66,942.00</u>		
Set up			OPTIONAL EQUIPMENT		
4 for Heat Pump			COST OF SET-UP PARTS		
Vinyl Skirt			SUB-TOTAL <u>66,942.00</u>		
Cedar Steps			SALES TAX <u>406.70</u>		
			NON-TAXABLE ITEMS <u>450.00</u>		
			VARIOUS FEES AND INSURANCE		
			1. CASH PRICE <u>\$71,459.00</u>		
			TRADE-IN ALLOWANCE \$		
			LESS BAL DUE ON ABOVE \$		
			NET ALLOWANCE		
			CASH DOWN PAYMENT <u>1000.00</u>		
			CASH AS AGREED SEE "REMARKS" <u>\$22,000.00</u>		
			2. LESS TOTAL CREDITS		
			3. UNPAID BALANCE OF CASH SALE PRICE <u>\$49,459.00</u>		
			Title to said equipment shall remain in the Seller until the agreed purchase price therefor is paid in full <input type="checkbox"/> in cash or by the execution of a <input type="checkbox"/> Retail Installment Contract, or a Security Agreement and its acceptance by a financing agency; thereupon title to the within described unit passes to the buyer as of the date of either full cash payment or on the signing of said credit instruments even though the actual physical delivery may not be made until a later date.		
			IT IS MUTUALLY UNDERSTOOD THAT THIS AGREEMENT IS SUBJECT TO NECESSARY CORRECTIONS, AND ADJUSTMENTS CONCERNING CHANGES IN NET PAYOFF ON TRADE-IN TO BE MADE AT THE TIME OF SETTLEMENT.		
			S.S.# <u>/ /</u> Name		
			S.S.# <u>/ /</u> Name		
BALANCE CARRIED TO OPTIONAL EQUIPMENT \$			There is no assurance a mobile home can remain level when placed upon any surface other than of blacktop or concrete.		
DESCRIPTION OF TRADE-IN			Purchasers certify that the matter printed on the back hereof has been read and agreed to as a part of this agreement the same as though it were printed above the signatures; that buyers are of statutory age or older; or have been legally emancipated; that the within described merchandise, the optional equipment and accessories thereon and, insurance if included, has been voluntarily purchased. The property being traded in is free from all encumbrances whatsoever, except as noted above. Purchaser agrees each paragraph and provision of this contract on both front and back is severable; if one portion thereof is invalid the remaining portion shall, nevertheless, remain in full force and effect.		
MAKE	MODEL	BEDROOMS	SIZE		
			X		
TITLE NO	SERIAL NO	COLOR			
AMOUNT DUE TO SELLER					
TRADE-IN DEBT TO BE PAID BY <input type="checkbox"/> DEALER <input type="checkbox"/> CUSTOMER					

I, OR WE, HEREBY ACKNOWLEDGE RECEIPT OF A COPY OF THIS ORDER

0408-43



APPROXIMATE SCALE IN FEET
1000 0 1000

NATIONAL FLOOD INSURANCE PROGRAM

FIRM
FLOOD INSURANCE RATE MAP

COLUMBIA
COUNTY,
FLORIDA
(UNINCORPORATED AREAS)

PANEL 260 OF 290

PANEL LOCATION

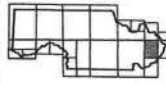

COMMUNITY-PANEL NUMBER
120070 0260 B
EFFECTIVE DATE:
JANUARY 6, 1988



Federal Emergency Management Agency

This is an official copy of a portion of the above referenced flood map. It was extracted using F-MIT Version 1.0. This map does not reflect changes or amendments which may have been made subsequent to the date on the title block. Further information about National Flood Insurance Program flood hazard maps is available at www.fema.gov/mit/tsd.

Print Date: 8/19/2004 (printed at scale and type A)

R 16 E
R 17 E

ROAD 30

RCH

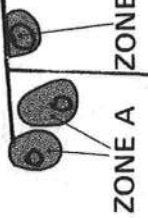
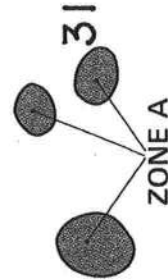
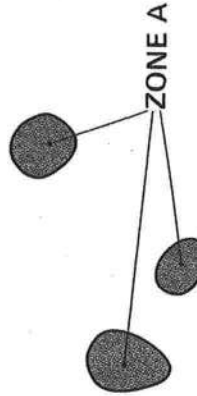
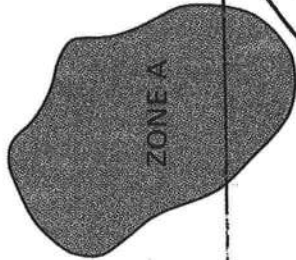

BEI



NORTH FLORIDA WATER SYSTEMS, INC.

11814 NW 202 STREET
ALACHUA, FLORIDA 32615

(386) 462-PUMP (7867)

(386) 454-PUMP (7867)

PHONE

497-2655/708-932-8126

DATE

6/23/04

NAME

Don McDiarmid

ADDRESS

189 SW Elm Church Rd

334 Elm Ct Rd

FT White 32038

FT White 32038

QTY.	DESCRIPTION	PRICE	AMOUNT
	Well 130'		
	Casing 120'		
	Water Level 80'		
	pump Setting 115'		
	4" well 100', 1 1/2 hp Stainless		
	pump, 240 gallon wellmate tank	2950 00	
30'	Drilling @ 12.00 FT		360 00
	12 12 month Full Warrantly		
	ON System, 5yr ON tank,		
	Excludes ANTS-Freeze		
	Thank you call anytime		
	454-7867 (pump)		
		TAX	
RECEIVED BY	PS # 6/23/04	TOTAL	3310 00

5% INTEREST WILL BE CHARGED
AFTER 30 DAYS.

THANK YOU