

## Columbia County Property Appraiser

Jeff Hampton

## 2021 Working Values

updated: 4/15/2021

Retrieve Tax Record

2020 TRIM (pdf)

Property Card

Parcel List Generator

Show on GIS Map

Print

Parcel: &lt;&lt; 03-6S-17-09594-000 (35169) &gt;&gt;

Aerial Viewer Pictometry Google Maps

## Owner &amp; Property Info

Show Search Results

Owner	SOUTHWEST GEORGIA OIL COMPANY INC P O BOX 1510 BAINBRIDGE, GA 39818		
Site	14170 US HIGHWAY 441		
Description*	COMM NW COR OF SE1/4, RUN E 1177.29 FT TO US-41, S 14 FT FOR POB, CONT S 467 FT, W 467 FT, N 467 FT, E 467 FT TO POB. & COMM SW COR OF NW1/4, RUN E 3412.84 FT, S 59.26 FT FOR POB W 134.10 FT, S 633.69 FT, E 351.08 FT, N 210.41 FT, W 216.91 FT, N 423.76 FT TO POB. 186-376, 535-686, 634-445, PB 1284-1029, DC 1293-23, WD 1293-2074, AG 1293-2089, 2094,2186,2191, TR 1358-106 <<<less		
Area	10.86 AC	S/T/R	03-6S-17
Use Code**	CONV STORE/GAS (1126)	Tax District	3

\*The Description above is not to be used as the Legal Description for this parcel in any legal transaction.

\*\*The Use Code is a FL Dept. of Revenue (DOR) code and is not maintained by the Property Appraiser's office. Please contact your city or county Planning &amp; Zoning office for specific zoning information.

## Property &amp; Assessment Values

2020 Certified Values		2021 Working Values	
Mkt Land	\$935,439	Mkt Land	\$935,440
Ag Land	\$0	Ag Land	\$0
Building	\$1,040,434	Building	\$1,029,464
XFOB	\$212,991	XFOB	\$212,991
Just	\$2,188,864	Just	\$2,177,895
Class	\$0	Class	\$0
Appraised	\$2,188,864	Appraised	\$2,177,895
SOH Cap [?]	\$0	SOH Cap [?]	\$0
Assessed	\$2,188,864	Assessed	\$2,177,895
Exempt	\$0	Exempt	\$0
Total Taxable	county:\$2,188,864 city:\$2,188,864 other:\$2,188,864 school:\$2,188,864	Total Taxable	county:\$2,177,895 city:\$0 other:\$0 school:\$2,177,895

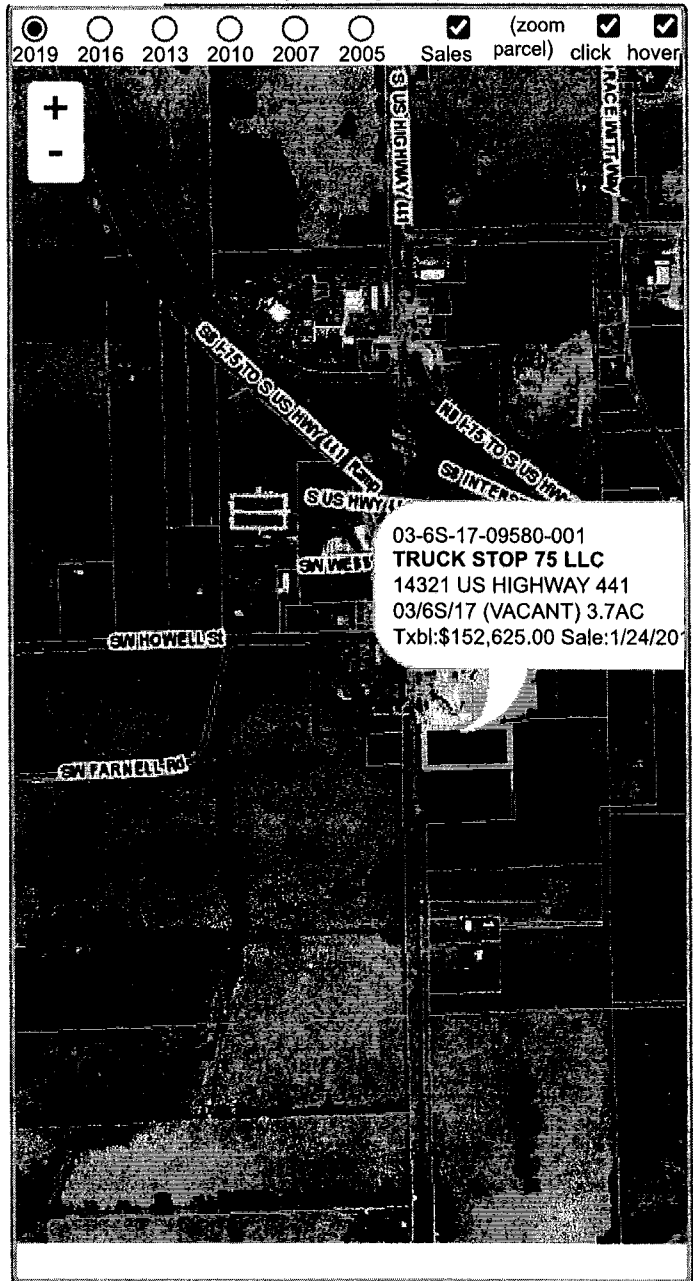

## Sales History

Show Similar Sales within 1/2 mile

Fill out Sales Questionnaire

Sale Date	Sale Price	Book/Page	Deed	V/I	Qualification (Codes)	RCode
4/12/2018	\$240,000	1358/0106	TR	I	Q	03
4/28/2015	\$19,812,600	1293/2074	WD	I	U	43
10/6/1987	\$125,000	0634/0445	WD	V	Q	
6/29/1965	\$5,818	0186/0376	WD	V	Q	01

## Building Characteristics

Bldg Sketch	Description*	Year Blt	Base SF	Actual SF	Bldg Value
Sketch	NBHD CONVE (4300)	2010	8210	17981	\$1,029,464