

DATE 2/8/2004

**Columbia County Building Permit**

PERMIT

This Permit Expires One Year From the Date of Issue

000021882

APPLICANT JACKIE NORRIS PHONE 386.758.3663  
ADDRESS 351 NW CORWIN GLEN LAKE CITY FL 32055  
OWNER JACQUELINE NORRIS PHONE 386.758.3663  
ADDRESS 351 NW CORWIN GLEN LAKE CITY FL 32055  
CONTRACTOR JOHN/JACKIE NORRIS PHONE 758-3663  
LOCATION OF PROPERTY 41-N TO FIDDLERS LANE, L, GO TO CREDO, 1/2 MILE TO CORWIN  
NEXT TO LAST LOTN LEFT.  
TYPE DEVELOPMENT SFD & UTILITY ESTIMATED COST OF CONSTRUCTION 75600.00  
HEATED FLOOR AREA 1512 TOTAL AREA HEIGHT 14.00 STORIES 1  
FOUNDATION CONC WALLS FRAMED ROOF PITCH 5'12 FLOOR CONC  
LAND USE & ZONING A-3 MAX. HEIGHT 35  
Minimum Set Back Requirments: STREET-FRONT 30.00 REAR 25.00 SIDE 25.00  
NO. EX.D.U. 1 FLOOD ZONE XPP DEVELOPMENT PERMIT NO.

PARCEL ID 34-2S-16-01844-110 SUBDIVISION WOODGLEN  
LOT 10 BLOCK PHASE UNIT TOTAL ACRES 5.00

Culvert Permit No. Culvert Waiver Contractor's License Number Applicant/Owner/Contractor  
EXISTING 04-0544-E BLK RTJ N  
Driveway Connection Septic Tank Number LU & Zoning checked by Approved for Issuance New Resident

COMMENTS: NOC ON FILE

1 FOOT ABOVE ROAD

M/H TO BE REMOVED. Check # or Cash 3069

**FOR BUILDING & ZONING DEPARTMENT ONLY**

(footer/Slab)

Temporary Power date/app. by Foundation date/app. by Monolithic date/app. by  
Under slab rough-in plumbing date/app. by Slab date/app. by Sheathing/Nailing date/app. by  
Framing date/app. by Rough-in plumbing above slab and below wood floor date/app. by  
Electrical rough-in date/app. by Heat & Air Duct date/app. by Peri. beam (Lintel) date/app. by  
Permanent power date/app. by C.O. Final date/app. by Culvert date/app. by  
M/H tie downs, blocking, electricity and plumbing date/app. by Pool date/app. by  
Reconnection date/app. by Pump pole date/app. by Utility Pole date/app. by  
M/H Pole date/app. by Travel Trailer date/app. by Re-roof date/app. by

BUILDING PERMIT FEE \$ 380.00 CERTIFICATION FEE \$ .00 SURCHARGE FEE \$ .00  
MISC. FEES \$ .00 ZONING CERT. FEE \$ 50.00 FIRE FEE \$ WASTE FEE \$  
FLOOD ZONE DEVELOPMENT FEE \$ CULVERT FEE \$ TOTAL FEE 430.00  
INSPECTORS OFFICE CLERKS OFFICE

NOTICE: IN ADDITION TO THE REQUIREMENTS OF THIS PERMIT, THERE MAY BE ADDITIONAL RESTRICTIONS APPLICABLE TO THIS PROPERTY THAT MAY BE FOUND IN THE PUBLIC RECORDS OF THIS COUNTY. AND THERE MAY BE ADDITIONAL PERMITS REQUIRED FROM OTHER GOVERNMENTAL ENTITIES SUCH AS WATER MANAGEMENT DISTRICTS, STATE AGENCIES, OR FEDERAL AGENCIES.

"WARNING TO OWNER: YOUR FAILURE TO RECORD A NOTICE OF COMMENCEMENT MAY RESULT IN YOUR PAYING TWICE FOR IMPROVEMENTS TO YOUR PROPERTY. IF YOU INTEND TO OBTAIN FINANCING, CONSULT WITH YOUR LENDER OR AN ATTORNEY BEFORE RECORDING YOUR NOTICE OF COMMENCEMENT."

**This Permit Must Be Prominently Posted on Premises During Construction**

PLEASE NOTIFY THE COLUMBIA COUNTY BUILDING DEPARTMENT AT LEAST 24 HOURS IN ADVANCE OF EACH INSPECTION, IN ORDER THAT IT MAY BE MADE WITHOUT DELAY OR INCONVENIENCE, PHONE 758-1008. THIS PERMIT IS NOT VALID UNLESS THE WORK AUTHORIZED BY IT IS COMMENCED WITHIN 6 MONTHS AFTER ISSUANCE.

The Issuance of this Permit Does Not Waive Compliance by Permittee with Deed Restrictions.



# Columbia County Building Permit Application

**For Office Use Only** Application # 0405-03 Date Received 5-3-04 By lt Permit # 21882  
Application Approved by - Zoning Official BLK Date 18.05.04 Plans Examiner \_\_\_\_\_ Date \_\_\_\_\_  
Flood Zone X per plat + Development Permit N/A Zoning A-3 Land Use Plan Map Category A-3  
Comments \_\_\_\_\_

Applicants Name John Norris Phone (386) 758-3663  
Address 351 NW Corwin Gln Lake City FL 32055  
Owners Name John Norris Phone \_\_\_\_\_  
911 Address 351 NW Corwin Gln Lake City, FL 32055  
Contractors Name Self Phone \_\_\_\_\_  
Address \_\_\_\_\_  
Fee Simple Owner Name & Address \_\_\_\_\_  
Bonding Co. Name & Address \_\_\_\_\_  
Architect/Engineer Name & Address Freeman 305 East Duval St. Lake City  
Mortgage Lenders Name & Address Columbia County Bank  
Property ID Number 34-25-16-01844-110 Estimated Cost of Construction \$65,000  
Subdivision Name Wood Gln Plat. Sec. 34, 25, 16 E Lot 10 Block \_\_\_\_\_ Unit \_\_\_\_\_ Phase \_\_\_\_\_  
Driving Directions \_\_\_\_\_

Type of Construction new Construction Number of Existing Dwellings on Property 1  
Total Acreage 5 Lot Size \_\_\_\_\_ Do you need a - Culvert Permit or Culvert Waiver or Have an Existing Driv  
Actual Distance of Structure from Property Lines - Front 360<sup>345</sup> Side 90<sup>120</sup> Side 168<sup>200</sup> Rear 209.01<sup>299</sup>  
Total Building Height 14' Number of Stories 1 Heated Floor Area 1512 Roof Pitch 5'12"

Application is hereby made to obtain a permit to do work and installations as indicated. I certify that no work or installation has commenced prior to the issuance of a permit and that all work be performed to meet the standards of all laws regulating construction in this jurisdiction.

**OWNERS AFFIDAVIT:** I hereby certify that all the foregoing information is accurate and all work will be done in compliance with all applicable laws and regulating construction and zoning.

**WARNING TO OWNER:** YOUR FAILURE TO RECORD A NOTICE OF COMMENCEMENT MAY RESULT IN YOU PAYING TWICE FOR IMPROVEMENTS TO YOUR PROPERTY. IF YOU INTEND TO OBTAIN FINANCING, CONSULT WITH YOUR LENDER OR ATTORNEY BEFORE RECORDING YOUR NOTICE OF COMMENCEMENT.

John Norris  
Owner Builder or Agent (Including Contractor)

STATE OF FLORIDA  
COUNTY OF COLUMBIA

Sworn to (or affirmed) and subscribed before me  
this \_\_\_\_\_ day of \_\_\_\_\_ 20\_\_\_\_.  
Personally known \_\_\_\_\_ or Produced Identification \_\_\_\_\_

Contractor Signature \_\_\_\_\_  
Contractors License Number \_\_\_\_\_  
Competency Card Number \_\_\_\_\_

NOTARY STAMP/SEAL

Notary Signature \_\_\_\_\_





STATE OF FLORIDA  
DEPARTMENT OF HEALTH

APPLICATION FOR ONSITE SEWAGE DISPOSAL SYSTEM CONSTRUCTION PERMIT

Permit Application Number 04-0544E

PART II - SITE PLAN

Scale: Each block represents 5 feet and 1 inch = 50 feet.

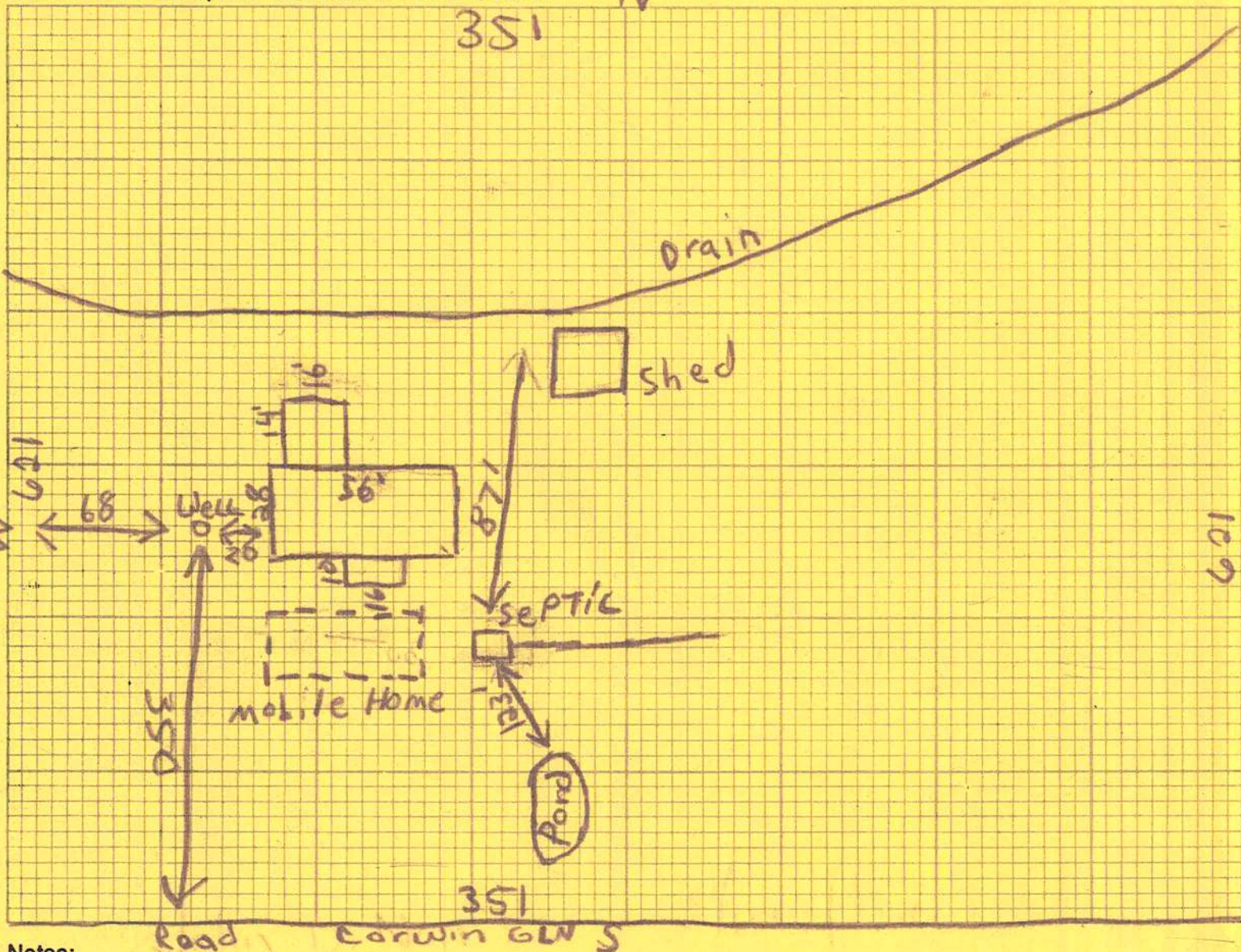

Notes:

Site Plan submitted by:

Plan Approved ☒

By

Signature

Not Approved ☐

OWNER  
Title

Date 5-12-04

County Health Department

ALL CHANGES MUST BE APPROVED BY THE COUNTY HEALTH DEPARTMENT



NOTICE OF COMMENCEMENT FORM  
COLUMBIA COUNTY, FLORIDA

THE UNDERSIGNED hereby gives notice that improvement will be made to certain real property, and in accordance with Chapter 713, Florida Statutes, the following information is provided in this Notice of Commencement.

Tax Parcel ID Number RO 1844-110 Inst: 2004009973 Date: 05/03/2004 Time: 12:04  
6 DC, P. DeWitt Cason, Columbia County B: 1014 P: 192

1. Description of property: (legal description of the property and street address or G.L. address)  
34-25-16 0200/0200  
Lot 10 Wood Glen S.D  
GRB 852-1360, 852-1364  
A part of the E 1/2 of SE 1/4, Section 25, Township 5 South  
Range 17 East, Columbia County Florida
2. General description of improvement: New Construction
3. Owner Name & Address John + Jacqueline Norris 351 NW Corwin Gl  
Lake City, FL 32055 Interest in Property \_\_\_\_\_
4. Name & Address of Fee Simple Owner (if other than owner): \_\_\_\_\_
5. Contractor Name John D. Norris Phone Number \_\_\_\_\_  
Address \_\_\_\_\_
6. Surety Holders Name \_\_\_\_\_ Phone Number \_\_\_\_\_  
Address \_\_\_\_\_  
Amount of Bond \_\_\_\_\_
7. Lender Name Columbia County Bank Phone Number 754-8888  
Address Lake City FL 32055
8. Persons within the State of Florida designated by the Owner upon whom notices or other documents may be served as provided by section 718.13 (1)(a) 7; Florida Statutes:  
Name \_\_\_\_\_ Phone Number \_\_\_\_\_  
Address \_\_\_\_\_
9. In addition to himself/herself the owner designates \_\_\_\_\_ of \_\_\_\_\_  
to receive a copy of the Lienor's Notice as provided in Section 713.13 (1) -  
(a) 7. Phone Number of the designee \_\_\_\_\_
10. Expiration date of the Notice of Commencement (the expiration date is 1 (one) year from the date of recording, (Unless a different date is specified) \_\_\_\_\_

**NOTICE AS PER CHAPTER 713, Florida Statutes:**

The owner must sign the notice of commencement and no one else may be permitted to sign in his/her stead.

John D. Norris  
Signature of Owner

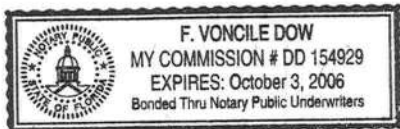

Sworn to (or affirmed) and subscribed before  
day of 3rd May, 2004

NOTARY STAMP/SEAL

F. Voncile Dow  
Signature of Notary



FLORIDA ENERGY EFFICIENCY CODE  
FOR BUILDING CONSTRUCTION

Florida Department of Community Affairs  
Residential Whole Building Performance Method A

Project Name:	Columbia Model	Builder:	John Norris
Address:	Lot: 10, Sub: Woodglen, Plat: Sec 34, 2 S, 16 E	Permitting Office:	Columbia
City, State:	Lake City, FL	Permit Number:	21882
Owner:	John Norris	Jurisdiction Number:	221000
Climate Zone:	North		

1. New construction or existing	New	12. Cooling systems	
2. Single family or multi-family	Single family	a. Central Unit	Cap: 24.0 kBtu/hr
3. Number of units, if multi-family	1		SEER: 10.00
4. Number of Bedrooms	3	b. N/A	
5. Is this a worst case?	Yes	c. N/A	
6. Conditioned floor area (ft²)	1512 ft²		
7. Glass area & type	Single Pane Double Pane	13. Heating systems	
a. Clear glass, default U-factor	79.0 ft² 14.0 ft²	a. Electric Heat Pump	Cap: 24.0 kBtu/hr
b. Default tint	0.0 ft² 0.0 ft²		HSPF: 6.80
c. Labeled U or SHGC	0.0 ft² 0.0 ft²	b. N/A	
8. Floor types		c. N/A	
a. Slab-On-Grade Edge Insulation	R=0.0, 160.0(p) ft		
b. N/A		14. Hot water systems	
c. N/A		a. Electric Resistance	Cap: 50.0 gallons
9. Wall types			EF: 0.92
a. Frame, Wood, Exterior	R=13.0, 1280.0 ft²	b. N/A	
b. N/A		c. Conservation credits	
c. N/A		(HR-Heat recovery, Solar	
d. N/A		DHP-Dedicated heat pump)	
e. N/A		15. HVAC credits	
10. Ceiling types		(CF-Ceiling fan, CV-Cross ventilation,	
a. Under Attic	R=30.0, 1512.0 ft²	HF-Whole house fan,	
b. N/A		PT-Programmable Thermostat,	
c. N/A		MZ-C-Multizone cooling,	
11. Ducts		MZ-H-Multizone heating)	
a. Sup: Unc. Ret: Unc. AH: Interior	Sup. R=6.0, 54.0 ft		
b. N/A			

Glass/Floor Area: 0.06	Total as-built points: 22201	PASS
	Total base points: 24920	

I hereby certify that the plans and specifications covered by this calculation are in compliance with the Florida Energy Code.

PREPARED BY: William H. Freeman

DATE: 4/20/04

I hereby certify that this building, as designed, is in compliance with the Florida Energy Code.

OWNER/AGENT:

DATE:

Review of the plans and specifications covered by this calculation indicates compliance with the Florida Energy Code. Before construction is completed this building will be inspected for compliance with Section 553.908 Florida Statutes.

BUILDING OFFICIAL:

DATE:



SUMMER CALCULATIONS  
Residential Whole Building Performance Method A - Details

ADDRESS: Lot: 10, Sub: Woodglen, Plat: Sec 34, 2 S, 16 E, Lake City, FL, PERMIT #:

BASE				AS-BUILT								
GLASS TYPES .18 X Conditioned X BSPM = Points Floor Area				Type/SC	Overhang Ornt Len Hgt		Area X SPM X SOF = Points					
.18	1512.0	20.04	5454.1	Single, Clear	N	14.0	4.0	9.0	21.73	0.59	116.0	
				Single, Clear	N	1.5	6.0	15.0	21.73	0.94	305.9	
				Single, Clear	S	1.5	6.0	30.0	40.81	0.86	1048.2	
				Single, Clear	S	6.0	6.0	25.0	40.81	0.52	531.1	
				Double, Clear	W	1.5	4.0	5.0	38.52	0.82	157.5	
				Double, Clear	SW	1.5	5.0	9.0	40.16	0.84	302.5	
				As-Built Total:				93.0	2461.2			
WALL TYPES Area X BSPM = Points				Type	R-Value		Area X SPM = Points					
Adjacent	0.0	0.00	0.0	Frame, Wood, Exterior	13.0		1280.0	1.50	1920.0			
Exterior	1280.0	1.70	2176.0									
Base Total: 1280.0 2176.0				As-Built Total:				1280.0	1920.0			
DOOR TYPES Area X BSPM = Points				Type	Area X SPM = Points							
Adjacent	0.0	0.00	0.0	Exterior Wood			40.0	6.10	244.0			
Exterior	80.0	6.10	488.0	Exterior Wood			40.0	6.10	244.0			
Base Total: 80.0 488.0				As-Built Total:				80.0	488.0			
CEILING TYPES Area X BSPM = Points				Type	R-Value		Area X SPM X SCM = Points					
Under Attic	1512.0	1.73	2615.8	Under Attic	30.0		1512.0	1.73 X 1.00	2615.8			
Base Total: 1512.0 2615.8				As-Built Total:				1512.0	2615.8			
FLOOR TYPES Area X BSPM = Points				Type	R-Value		Area X SPM = Points					
Slab	160.0(p)	-37.0	-5920.0	Slab-On-Grade Edge Insulation	0.0		160.0(p)	-41.20	-6592.0			
Raised	0.0	0.00	0.0									
Base Total: -5920.0				As-Built Total:				160.0	-6592.0			
INFILTRATION Area X BSPM = Points				Area X SPM = Points								
1512.0 10.21 15437.5				1512.0 10.21 15437.5								

SUMMER CALCULATIONS

Residential Whole Building Performance Method A - Details

ADDRESS: Lot: 10, Sub: Woodglen, Plat: Sec 34, 2 S, 16 E, Lake City, FL, PERMIT #:

BASE				AS-BUILT							
Summer Base Points: 20251.4				Summer As-Built Points: 16330.5							
Total Summer Points	X	System Multiplier	= Cooling Points	Total Component	X	Cap Ratio	X Duct Multiplier (DM x DSM x AHU)	X System Multiplier	X Credit Multiplier	= Cooling Points	
20251.4		0.4266	8639.2	16330.5		1.000	(1.090 x 1.147 x 0.91)	0.341	1.000	6341.1	
				16330.5		1.00	1.138	0.341	1.000	6341.1	



WINTER CALCULATIONS  
Residential Whole Building Performance Method A - Details

ADDRESS: Lot: 10, Sub: Woodglen, Plat: Sec 34, 2 S, 16 E, Lake City, FL, PERMIT #:

BASE				AS-BUILT							
GLASS TYPES											
.18 X Conditioned X BWPM = Points Floor Area				Type/SC	Overhang Ornt Len Hgt			Area X WPM X WOF = Points			
.18	1512.0	12.74	3467.3	Single, Clear	N	14.0	4.0	9.0	33.22	1.03	307.2
				Single, Clear	N	1.5	6.0	15.0	33.22	1.00	499.5
				Single, Clear	S	1.5	6.0	30.0	20.24	1.12	678.6
				Single, Clear	S	6.0	6.0	25.0	20.24	2.73	1382.2
				Double, Clear	W	1.5	4.0	5.0	20.73	1.05	109.1
				Double, Clear	SW	1.5	5.0	9.0	16.74	1.09	164.3
				As-Built Total:			93.0		3140.8		
WALL TYPES											
Area X BWPM = Points				Type	R-Value			Area X WPM = Points			
Adjacent	0.0	0.00	0.0	Frame, Wood, Exterior							
Exterior	1280.0	3.70	4736.0		13.0			1280.0 3.40 4352.0			
Base Total:				As-Built Total:			1280.0		4352.0		
DOOR TYPES											
Area X BWPM = Points				Type				Area X WPM = Points			
Adjacent	0.0	0.00	0.0	Exterior Wood				40.0 12.30 492.0			
Exterior	80.0	12.30	984.0	Exterior Wood				40.0 12.30 492.0			
Base Total:				As-Built Total:			80.0		984.0		
CEILING TYPES											
Area X BWPM = Points				Type	R-Value			Area X WPM X WCM = Points			
Under Attic	1512.0	2.05	3099.6	Under Attic	30.0			1512.0 2.05 X 1.00 3099.6			
Base Total:				As-Built Total:			1512.0		3099.6		
FLOOR TYPES											
Area X BWPM = Points				Type	R-Value			Area X WPM = Points			
Slab	160.0(p)	8.9	1424.0	Slab-On-Grade Edge Insulation							
Raised	0.0	0.00	0.0		0.0			160.0(p) 18.80 3008.0			
Base Total:				As-Built Total:			160.0		3008.0		
INFILTRATION											
Area X BWPM = Points							Area X WPM = Points				
	1512.0	-0.59	-892.1				1512.0 -0.59 -892.1				



WINTER CALCULATIONS

Residential Whole Building Performance Method A - Details

ADDRESS: Lot: 10, Sub: Woodglen, Plat: Sec 34, 2 S, 16 E, Lake City, FL, PERMIT #:

BASE				AS-BUILT							
Winter Base Points: 12818.8				Winter As-Built Points: 13692.3							
Total Winter Points	X	System Multiplier	= Heating Points	Total Component	X	Cap Ratio	X Duct Multiplier	X System Multiplier	X Credit Multiplier	= Heating Points	
							(DM x DSM x AHU)				
12818.8		0.6274	8042.5	13692.3	1.000	1.000	(1.069 x 1.169 x 0.93)	0.501	1.000	7979.9	
				13692.3	1.00		1.162	0.501	1.000	7979.9	



WATER HEATING & CODE COMPLIANCE STATUS  
Residential Whole Building Performance Method A - Details

ADDRESS: Lot: 10, Sub: Woodglen, Plat: Sec 34, 2 S, 16 E, Lake City, FL, PERMIT #:

BASE				AS-BUILT					
WATER HEATING									
Number of Bedrooms	X	Multiplier	= Total	Tank Volume	EF	Number of Bedrooms	X Tank Ratio	Multiplier X	Credit = Total Multiplier
3		2746.00	8238.0	50.0	0.92	3	1.00	2626.61	1.00 7879.8
				As-Built Total:					7879.8

CODE COMPLIANCE STATUS							
BASE				AS-BUILT			
Cooling Points	+	Heating Points	+ Hot Water Points = Total Points	Cooling Points	+	Heating Points	+ Hot Water Points = Total Points
8639		8043	8238 24920	6341		7980	7880 22201

PASS





# Code Compliance Checklist

## Residential Whole Building Performance Method A - Details

ADDRESS: Lot: 10, Sub: Woodglen, Plat: Sec 34, 2 S, 16 E, Lake City, FL, PERMIT #:

6A-21 INFILTRATION REDUCTION COMPLIANCE CHECKLIST

COMPONENTS	SECTION	REQUIREMENTS FOR EACH PRACTICE	CHECK
Exterior Windows & Doors	606.1.ABC.1.1	Maximum: .3 cfm/sq.ft. window area; .5 cfm/sq.ft. door area.	
Exterior & Adjacent Walls	606.1.ABC.1.2.1	Caulk, gasket, weatherstrip or seal between: windows/doors & frames, surrounding wall; foundation & wall sole or sill plate; joints between exterior wall panels at corners; utility penetrations; between wall panels & top/bottom plates; between walls and floor. EXCEPTION: Frame walls where a continuous infiltration barrier is installed that extends from, and is sealed to, the foundation to the top plate.	
Floors	606.1.ABC.1.2.2	Penetrations/openings >1/8" sealed unless backed by truss or joint members. EXCEPTION: Frame floors where a continuous infiltration barrier is installed that is sealed to the perimeter, penetrations and seams.	
Ceilings	606.1.ABC.1.2.3	Between walls & ceilings; penetrations of ceiling plane of top floor; around shafts, chases, soffits, chimneys, cabinets sealed to continuous air barrier; gaps in gyp board & top plate; attic access. EXCEPTION: Frame ceilings where a continuous infiltration barrier is installed that is sealed at the perimeter, at penetrations and seams.	
Recessed Lighting Fixtures	606.1.ABC.1.2.4	Type IC rated with no penetrations, sealed; or Type IC or non-IC rated, installed inside a sealed box with 1/2" clearance & 3" from insulation; or Type IC rated with < 2.0 cfm from conditioned space, tested.	
Multi-story Houses	606.1.ABC.1.2.5	Air barrier on perimeter of floor cavity between floors.	
Additional Infiltration reqts	606.1.ABC.1.3	Exhaust fans vented to outdoors, dampers; combustion space heaters comply with NFPA, have combustion air.	

6A-22 OTHER PRESCRIPTIVE MEASURES (must be met or exceeded by all residences.)

COMPONENTS	SECTION	REQUIREMENTS	CHECK
Water Heaters	612.1	Comply with efficiency requirements in Table 6-12. Switch or clearly marked circuit breaker (electric) or cutoff (gas) must be provided. External or built-in heat trap required.	
Swimming Pools & Spas	612.1	Spas & heated pools must have covers (except solar heated). Non-commercial pools must have a pump timer. Gas spa & pool heaters must have a minimum thermal efficiency of 78%.	
Shower heads	612.1	Water flow must be restricted to no more than 2.5 gallons per minute at 80 PSIG.	
Air Distribution Systems	610.1	All ducts, fittings, mechanical equipment and plenum chambers shall be mechanically attached, sealed, insulated, and installed in accordance with the criteria of Section 610. Ducts in unconditioned attics: R-6 min. insulation.	
HVAC Controls	607.1	Separate readily accessible manual or automatic thermostat for each system.	
Insulation	604.1, 602.1	Ceilings-Min. R-19. Common walls-Frame R-11 or CBS R-3 both sides. Common ceiling & floors R-11.	



# ENERGY PERFORMANCE LEVEL (EPL) DISPLAY CARD

**ESTIMATED ENERGY PERFORMANCE SCORE\* = 84.7**

**The higher the score, the more efficient the home.**

John Norris, Lot: 10, Sub: Woodglen, Plat: Sec 34, 2 S, 16 E, Lake City, FL,

1. New construction or existing	New	12. Cooling systems	
2. Single family or multi-family	Single family	a. Central Unit	Cap: 24.0 kBtu/hr
3. Number of units, if multi-family	1		SEER: 10.00
4. Number of Bedrooms	3	b. N/A	
5. Is this a worst case?	Yes	c. N/A	
6. Conditioned floor area (ft <sup>2</sup> )	1512 ft <sup>2</sup>		
7. Glass area & type	Single Pane Double Pane	13. Heating systems	
a. Clear - single pane	79.0 ft <sup>2</sup> 14.0 ft <sup>2</sup>	a. Electric Heat Pump	Cap: 24.0 kBtu/hr
b. Clear - double pane	0.0 ft <sup>2</sup> 0.0 ft <sup>2</sup>		HSPF: 6.80
c. Tint/other SHGC - single pane	0.0 ft <sup>2</sup> 0.0 ft <sup>2</sup>	b. N/A	
d. Tint/other SHGC - double pane		c. N/A	
8. Floor types		14. Hot water systems	
a. Slab-On-Grade Edge Insulation	R=0.0, 160.0(p) ft	a. Electric Resistance	Cap: 50.0 gallons
b. N/A			EF: 0.92
c. N/A		b. N/A	
9. Wall types		c. Conservation credits	
a. Frame, Wood, Exterior	R=13.0, 1280.0 ft <sup>2</sup>	(HR-Heat recovery, Solar	
b. N/A		DHP-Dedicated heat pump)	
c. N/A		15. HVAC credits	
d. N/A		(CF-Ceiling fan, CV-Cross ventilation,	
e. N/A		HF-Whole house fan,	
10. Ceiling types		PT-Programmable Thermostat,	
a. Under Attic	R=30.0, 1512.0 ft <sup>2</sup>	MZ-C-Multizone cooling,	
b. N/A		MZ-H-Multizone heating)	
c. N/A			
11. Ducts			
a. Sup: Unc. Ret: Unc. AH: Interior	Sup. R=6.0, 54.0 ft		
b. N/A			

I certify that this home has complied with the Florida Energy Efficiency Code For Building Construction through the above energy saving features which will be installed (or exceeded) in this home before final inspection. Otherwise, a new EPL Display Card will be completed based on installed Code compliant features.

Builder Signature: \_\_\_\_\_ Date: \_\_\_\_\_

Address of New Home: \_\_\_\_\_ City/FL Zip: \_\_\_\_\_



*\*NOTE: The home's estimated energy performance score is only available through the FLA/RES computer program. This is not a Building Energy Rating. If your score is 80 or greater (or 86 for a US EPA/DOE EnergyStar<sup>TM</sup> designation), your home may qualify for energy efficiency mortgage (EEM) incentives if you obtain a Florida Energy Gauge Rating. Contact the Energy Gauge Hotline at 321/638-1492 or see the Energy Gauge web site at [www.fsec.ucf.edu](http://www.fsec.ucf.edu) for information and a list of certified Raters. For information about Florida's Energy Efficiency Code For Building Construction, contact the Department of Community Affairs at 850/487-1824.*

EnergyGauge® (Version: FLRCPB v3.30)



**FOR OWNER/BUILDER WHEN ACTING AS THEIR OWN CONTRACTOR AND CLAIMING EXEMPTION OF CONTRACTOR LICENSING REQUIREMENTS IN ACCORDANCE WITH FLORIDA STATUTES, ss. 489.103(7).**

State law requires construction to be done by licensed contractors. You have applied for a permit under an exemption to that law. The exemption allows you, as the owner of your property, to act as your own contractor with certain restrictions even though you do not have a license. You must provide direct, onsite supervision of the construction yourself. You may build or improve a one-family or two-family residence or a farm outbuilding. You may also build or improve a commercial building, provided your costs do not exceed \$25,000. The building or residence must be for your own use or occupancy. It may not be built or substantially improved for sale or lease. If you sell or lease a building you have built or substantially improved yours within 1 year after the construction is complete, the law will presume that you built or substantially improved it for sale or lease, which is a violation of this exemption. You may not hire an unlicensed person to act as your contractor or to supervise people working on your building. It is your responsibility to make sure that people employed by you have licenses required by state law and by county or municipal licensing ordinances. You may not delegate responsibility for supervising work to a licensed contractor who is not licensed to perform the work being done. Any person working on your building who is not licensed must work under your direct supervision and must be employed by you, which means that you must deduct F.I.C.A. and withholding tax and provide workers' compensation for that employee, all as prescribed by law. Your construction must comply with all applicable laws, ordinances, building codes, and zoning regulations.

**TYPE OF CONSTRUCTION**

- ☒ Single Family Dwelling  
☐ Farm Outbuilding

- ☐ Two-Family Residence  
☐ Other \_\_\_\_\_

**NEW CONSTRUCTION OR IMPROVEMENT**

- ☒ New Construction ☐ Addition, Alteration, Modification or other Improvement

I, JACKIE NORRIS, have been advised of the above disclosure statement for exemption from contractor licensing as an owner/builder. I agree to comply with all requirements provided for in Florida Statutes ss.489.103(7) allowing this exception for the construction permitted by Columbia County Building Permit Number 21882

Jackie Norris  
Signature

05-18-04  
Date

**FOR BUILDING USE ONLY**

I hereby certify that the above listed owner/builder has been notified of the disclosure statement in Florida Statutes ss 489.103(7).

Date 5-18-04 Building Official/Representative David K. Williams



# COLUMBIA COUNTY OFFICE OF OCCUPANCY

COLUMBIA COUNTY, FLORIDA

## Department of Building and Zoning Inspection

*This Certificate of Occupancy is issued to the below named permit holder for the building and premises at the below named location, and certifies that the work has been completed in accordance with the Columbia County Building Code.*

Parcel Number 34-2S-16-01844-110

Building permit No. 000021882

Use Classification SFD & UTILITY

Fire:

Permit Holder JOHN/JACKIE NORRIS

Waste:

Owner of Building JACQUELINE NORRIS

Total:

.00

Location: 351 NW CORWIN GLEN(WOODGLEN, LOT 10)

Date: 07/14/2004



Building Inspector

POST IN A CONSPICUOUS PLACE  
(Business Places Only)





FOUNDED 1949

## CORPORATE HEADQUARTERS:

P.O. BOX 5389  
116 N.W. 16TH AVENUE  
GAINESVILLE, FL 32602-5369

(352) 376-2661  
FAX (352) 376-2791

SCIENTIFIC PEST CONTROL DIRECTED BY GRADUATE ENTOMOLOGISTS

Complete Pest Control Service  
Member Florida & National Pest Control Associations

10889

Reply to: 536 SE Baya Dr  
Lake City, FL 32025  
Phone (386) 752-1703 Fax (386) 752-0171

# TERMITE TREATMENT CERTIFICATION

Owner:	Permit Number:
JOHN MORRIS	21882
Lot:	Block:
10	
Subdivision:	Street Address:
WOODGLEN	351 NW CORWIN GLEN
City:	County:
Lake City	Columbia
General Contractor:	Area Treated:
PETE GIEBEIG CONSTRUCTION	EXTERIOR OF FOUNDATION
Date:	Time:
07/12/04	10:30 AM
Name of applicator	Applicator ID Number:
JAMES D PARKER	JE55238
Product Used: Active Ingredient % Concentration	Number of gallons used:
Dursban TC: Chlorpyrifos: 0.5%	73
Method of termite prevention treatment: Soil Treatment	

The building has received a complete treatment for the prevention of subterranean termites. Treatment is in accordance with rules and laws established by the Florida Department of Agriculture and Consumer Services.

This form is proof of complete treatment for Certificate of Occupancy or Closing.

**THIS IS PROOF OF WARRANTY**

Warranty and Treatment Certifications Have Been Issued.

Authorized Signature:	Date:
Kathi Schmidt	7/12/04

## BRANCHES:

• Crystal River • Daytona Beach • Ft. Walton Beach • Jacksonville South • Jacksonville West • Lake City • Milton • Ocala • Orlando • Palatka • Panama City • Pensacola • Starke • St. Augustine • Tallahassee • Winter Haven • Leesburg • Kissimmee •