

ARRAY DESCRIPTION						
ROOF	# OF MODULES	AZIMUTH	TILT	TRUSS SIZE	TRUSS SPACING	ROOF MATERIAL
#1	14	90	7/12 (30.26°)	2X4	24"O.C.	COMP SHINGLE
#2	5	180	8/12 (33.69°)	2X4	24"O.C.	COMP SHINGLE

DESIGN SPECIFICATION	
RISK CATEGORY	II
CONSTRUCTION	SFD
ZONING	RESIDENTIAL
SNOW LOAD (ASCE 7-16)	0 PSF
EXPOSURE CATEGORY	B
WIND SPEED (ASCE 7-16)	120 MPH



2023.04.19  
12:59:50 -04'00'

THIS ITEM HAS BEEN DIGITALLY SIGNED AND SEALED BY OMAR TIRADO ON THE DATE ADJACENT TO THE SEAL. PRINTED COPIES OF THIS DOCUMENT ARE NOT VCONSIDERED SIGNED AND SEAL, AND THE SIGNATURE MUST BE VERIFIED ON ANY ELECTRONIC COPIES

ROOF'S GENERAL NOTES

- CONTRACTOR/INSTALLER TO VERIFY ROOF CONDITIONS FOR PROPER INSTALLATION OF THE PV SYSTEM.
- CONTRACTOR/INSTALLER TO NOTIFY THE OWNER IMMEDIATELY OF ANY ROOF DEFICIENCIES AND/OR REPAIR REQUIRED TO INSTALL THE PV SYSTEM.
- EOR DOES NOT ASSUME ANY RESPONSIBILITY FOR THE INSTALLATION OF ANY PV SYSTEM ON DEFICIENT ROOFS.
- CONTRACTOR/INSTALLER ASSUMES ALL RESPONSIBILITY TO INSTALL AS PER MANUFACTURER STANDARDS.

ROOF INSPECTION NOTES

- PV MODULES IN LAYOUTS IS CONSIDERED NON-EXPOSED AFTER COMPLYING WITH THE FOLLOWING STATEMENTS BASED ON ASCE 7-16:
- NO INDIVIDUAL PV MODULE IS MORE THAN 0.5 (MEAN ROOF HEIGHT) AWAY FROM ROOF EDGE OR ANOTHER MODULE.
  - NO INDIVIDUAL PV MODULE IS MORE THAN 4FT AWAY FROM ROOF EDGE OR ANOTHER MODULE.
  - INDIVIDUAL PV MODULE IS MORE THAN 1.5 (MODULE LENGTH) AWAY FROM CLOSEST EXPOSED EDGE.

FRONT OF RESIDENCE

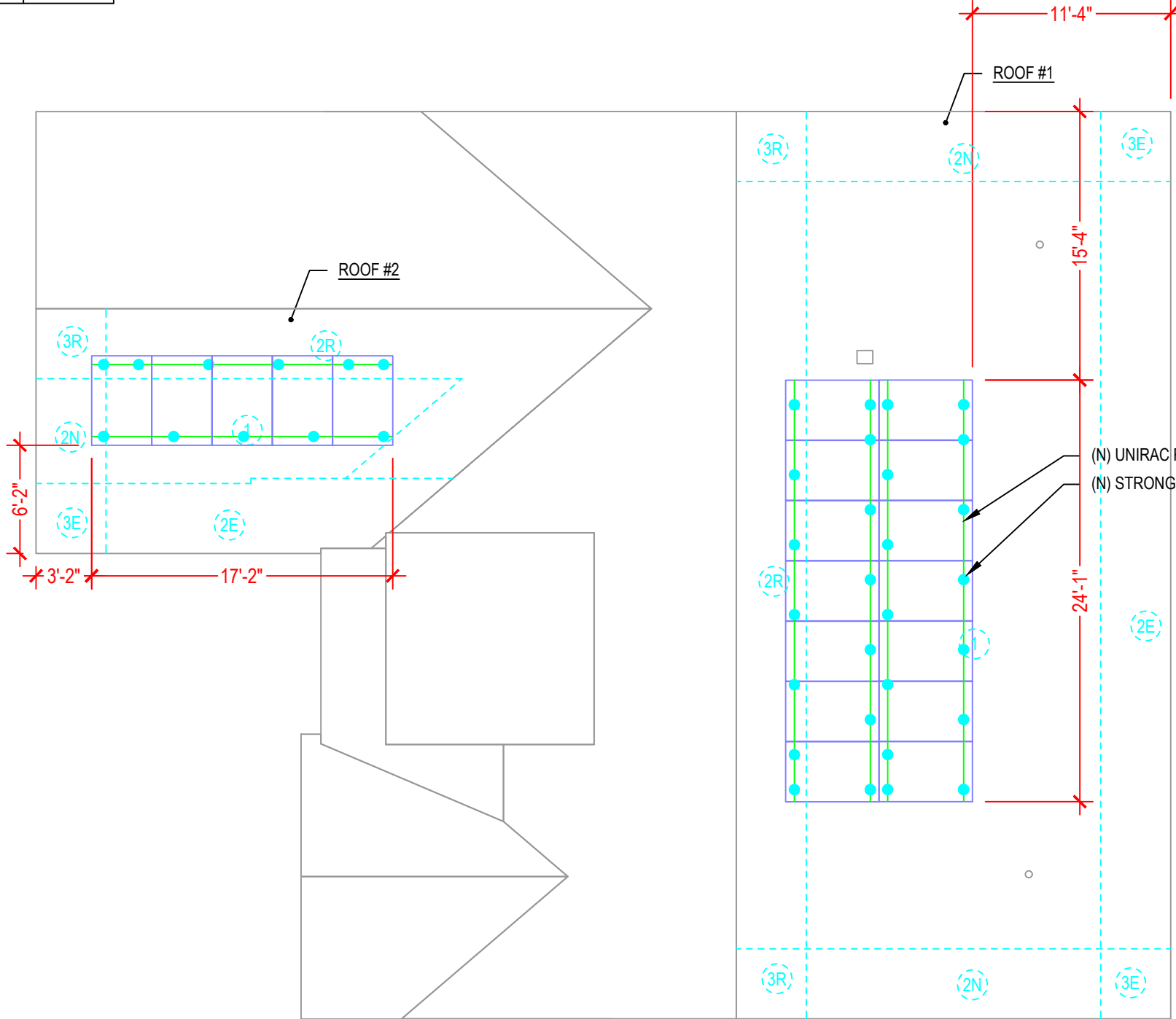

BACK OF RESIDENCE

LEGEND

- (E) - EXISTING  
(N) - NEW

1 | ROOF PLAN AND MODULES

S-0

SCALE: NTS



ATLANTIC KEY ENERGY LLC  
12600 CHALLENGER PARKWAY  
SUITE 200  
ORLANDO, FL 32826  
1 (407) 988-0273



PROJECT NAME & ADDRESS

NANCY TURNER  
RESIDENCE  
PROJECT # P-0074750  
123 NW NOVEMBER CT  
LAKE CITY, FL 32055

SIGNATURE WITH SEAL

REVISIONS

DESCRIPTION	DATE	REV

Drawn by: C.M.

Date: 4/18/2023

SHEET NAME

ROOF PLAN AND  
MODULES

SHEET NUMBER

S-0

STRONGHOLD™ | BUTYL UNIRAC  
BETTER SOLAR STARTS HERE

Unirac's **STRONGHOLD™ Butyl** is efficient, dependable, and optimized for UNIRAC's **NXT UMount™** system. The pre-applied butyl pad removes the need for additional flashing. Just peel the liner, place the attachment, and fasten it to the roof. In addition, the butyl, used throughout the roofing and solar industries for its reliability, conforms to the screws and roof for a robust, dependable seal with no extra work! Couple this with the **NXT UMount™** system, and you have a highly reliable, easy-to-install system with integrated wire management.



- KITTED WITH**
- ONE (1) STRONGHOLD™ Butyl direct-to-deck attachment with pre-applied butyl patch (Extra patches for shimming available.)
  - TWO (2) screws for rafter installation (Additional screws for direct-to-deck applications available.)
  - ONE (1) NXT Rail Clamp

FOR QUESTIONS OR CUSTOMER SERVICE CONTACT: 505-242-6411 | SALES@UNIRAC.COM | WWW.UNIRAC.COM

PART # TABLE	
P/N	DESCRIPTION
SBUTYLM1	STRONGHOLD ATT W/BUTYL, MILL
SBUTYLD1	STRONGHOLD ATT W/BUTYL, DARK

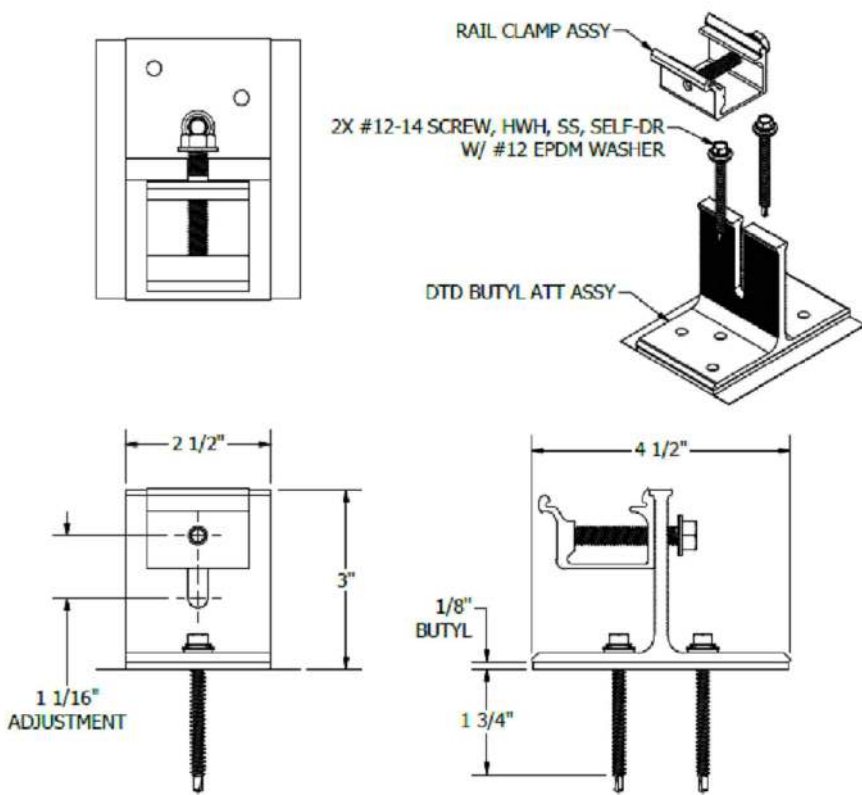

**UNIRAC**  
1411 BROADWAY BLVD. NE  
ALBUQUERQUE, NM 87102 USA  
PHONE: 505.242.6411  
WWW.UNIRAC.COM

PRODUCT LINE:	NXT UMount
DRAWING TYPE:	PARTS
DESCRIPTION:	SH BUTYL ATTACHMENT
REVISION DATE:	2/3/2023

DRAWING NOT TO SCALE  
ALL DIMENSIONS ARE  
NOMINAL  
PRODUCT PROTECTED BY  
ONE OR MORE US PATENTS  
LEGAL NOTICE

NU-A10  
SHEET

PART # TABLE		
P/N	DESCRIPTION	LENGTH
084RLM1	NXT UMount RAIL 84" MILL	84"
084RLD1	NXT UMount RAIL 84" DARK	84"
168RLM1	NXT UMount RAIL 168" MILL	168"
168RLD1	NXT UMount RAIL 168" DARK	168"
208RLM1	NXT UMount RAIL 208" MILL	208"
208RLD1	NXT UMount RAIL 208" DARK	208"
246RLM1	NXT UMount RAIL 246" MILL	246"
246RLD1	NXT UMount RAIL 246" DARK	246"
171RLM1	NXT UMount RAIL 171" MILL	171.50"
171RLD1	NXT UMount RAIL 171" DARK	171.50"

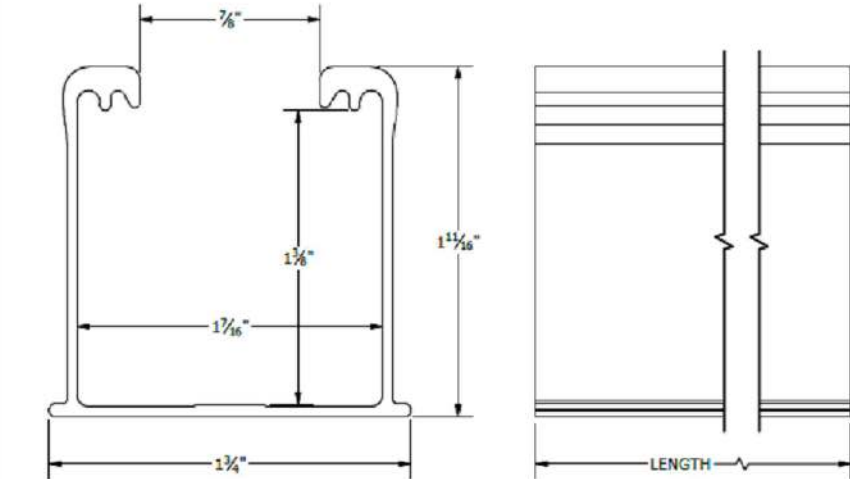

**UNIRAC**  
1411 BROADWAY BLVD. NE  
ALBUQUERQUE, NM 87102 USA  
PHONE: 505.242.6411  
WWW.UNIRAC.COM

PRODUCT LINE:	NXT UMount
DRAWING TYPE:	PART DETAIL
DESCRIPTION:	RAIL
REVISION DATE:	11/17/2022

DRAWING NOT TO SCALE  
ALL DIMENSIONS ARE  
NOMINAL  
PRODUCT PROTECTED BY  
ONE OR MORE US PATENTS  
LEGAL NOTICE

NU-P01  
SHEET

**AKE**  
SOLAR  
ATLANTIC KEY ENERGY LLC  
12600 CHALLENGER PARKWAY  
SUITE 200  
ORLANDO, FL 32826  
1 (407) 988-0273

**Lumio**  
PROJECT NAME & ADDRESS

NANCY TURNER  
RESIDENCE  
PROJECT # P-0074750  
123 NW NOVEMBER CT  
LAKE CITY, FL 32055

SIGNATURE WITH SEAL

REVISIONS		
DESCRIPTION	DATE	REV

Drawn by: C.M.  
Date: 4/18/2023

SHEET NAME  
EQUIPMENT  
SPECIFICATIONS  
SHEET NUMBER

S-1