

7/12 PITCH - 4/12 PITCH - 24" O/H

54-00-00

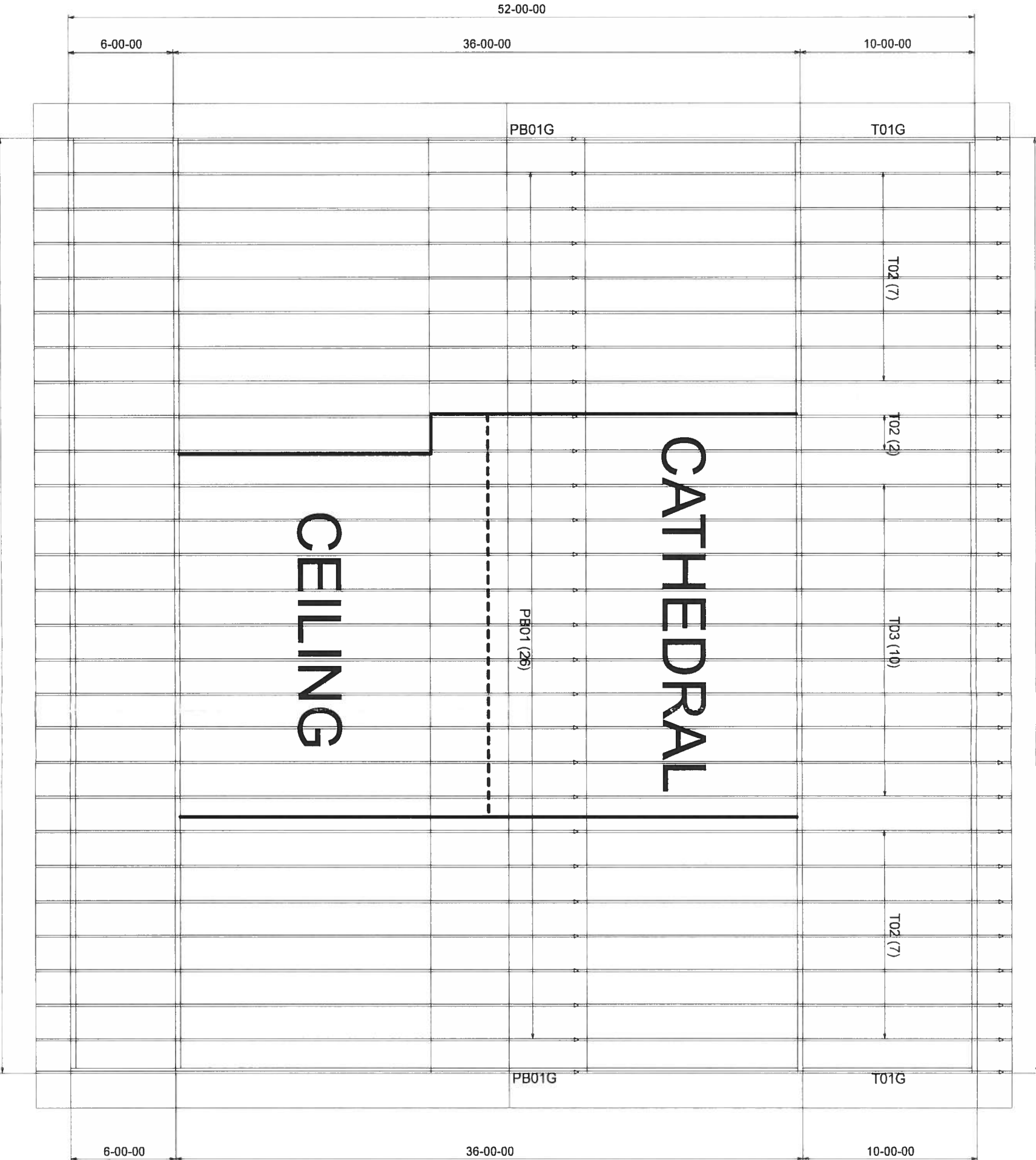

BEARING HEIGHT SCHEDULE

10' 1-1/8"

NOTES:

- 1) REFER TO HIR 91/RECOMMENDATIONS FOR HANDLING INSTALLATION AND TEMPORARY BRACING. REFER TO ENGINEERED DRAWINGS FOR PERMANENT BRACING REQUIRED
- 2) ALL TRUSSES (INCLUDING TRUSSES UNDER VALLEY FRAMING) MUST BE COMPLETELY DECKED OR REFER TO DETAIL V05 FOR ALTERNATE BRACING REQUIREMENTS
- 3) ALL VALLEYS ARE TO BE CONVENTIONALLY FRAMED BY BUILDER
- 4) ALL TRUSSES ARE DESIGNED FOR 2' O.C. MAXIMUM SPACING. UNLESS OTHERWISE NOTED
- 5) ALL WALLS SHOWN ON PLACEMENT PLAN ARE CONSIDERED TO BE LOAD BEARING, UNLESS OTHERWISE NOTED
- 6) 5/12 TRUSSES MUST BE INSTALLED WITH THE TOP BEING UP
- 7) BEARING ADVERT/INTEL. (HPR) TO BE FURNISHED BY BUILDER



Jacksonville
Tampa
Freeport
PHONE 904-772-6100 FAX 904-772-1973
PHONE 813-621-9831 FAX 813-628-8956
PHONE 850-835-4341 FAX 850-835-6835

BUILDER
IC CONSTRUCTION

TECH. NOTES
SORIDE RES.

DATE	BY	REVISION	BY
5-2-19	KLH	Original Estimate /	1667769

FL Approval Codes - Mitek Plates #'s 2197.2 - 2197.4, Versa-Lam #1644-R4 & BCI Joists #1392-R4