



Town of Fort White
P.O. Box 129 Fort White, FL 32038
386-497-2321 Fax: 386-4974946

APPLICATION FOR BUILDING PERMIT/COMPLIANCE

\$50.00 FEE

FILE No. _____ RECPT No. _____

Paid cash 50.00 4/30/25

Applicant's Name: Kelly Bishop Phone: 386-497-21051

Address: 1191 SW Brington Ct. Ft. White FL 32038

Owner's Name: same Phone: same

Address: same

Contractor's Name: Elite Buildings

Address: 4405 NW Real Terr. Lake City

*****Location of property: 04059-2101 (34-65-16-04059-261)

*****Type of development: open carport

Land use & zoning: R5F2

Minimum set-back: Street-front/side 35F/10S 15Rear 10Side
7100 rear 7100 side 700

Legal Description (acres): 51 ACRES Lot 11 BIKD HOLLINGSWORTH
ESTATES

I certify that all work will be performed to meet the standards of all laws regulating construction in this jurisdiction and that all the foregoing information is accurate and all work will be done in compliance with all laws regulating construction and zoning.

K Bishop Contractor's
License Number Applicant/Owner Contractor

Abbie Saloper Date Approved
by Reviewing Clerk 4/30/2025

*****IF PROPERTY IS NOT OWNED BY APPLICANT, A STATEMENT FROM THE OWNER AUTHORIZING USE OF PROPERTY FOR THE TYPE OF DEVELOPMENT STATED ON THIS APPLICATION WILL BE REQUIRED.

File No. _____

Town of Fort White
Building Compliance Check List

Name of Applicant Kathy Bishop

Address 1101 SW Brighton Ct. Ft. White FL 32038

Phone 351-1023-8151

Physical location of site and current zoning Lt. 11 BIK-D Hollingsworth Est.

Type of Construction ☒ New ☐ remodel/renovation/fire damage

Describe Construction install open carport

- ☒ Authorized owner or builder signs compliance application.
☒ Zoning is appropriate for type of construction.
☐ Property will ☒ will not require application to SRWMD for water use/runoff permit.
☐ Property will require curb cut or access/culvert over road right of way from:
____ DOT ____ Columbia County ____ Town of Fort White
☐ Property will ☒ will not require Health Dept. Sanitary WasteWater Permit.
☐ Property will ☒ will not require potable fresh water supply from:
____ private well ____ Town of Fort White municipal water works.
☐ Property will require slab to be at least 1 foot above elevation (crown) of roadway.
☐ Property will ☒ will not require approval of solid waste removal facilities.
☐ Property will ☒ will not require permit for infill or land removal.

- ☒ Applicant understands that a copy of the Town of Fort White Land Use Certification must be taken to Columbia County Building Department for application and issuance of building permit. Certification of land use or zoning by the Town of Fort White is NOT a building permit.

- ☒ **Other steps required for Building Compliance:** *Property Owner will be responsible for submitting a copy of the Columbia County Building Permit to the Town of Fort White.*

The applicant and Town of Fort White Clerk's Office have reviewed the foregoing information and the information is true and correct.

K Bishop
Signature of Applicant

4/29/25
Date

Donna Schaefer
Signature of Reviewing Clerk

Compliance given to applicant on

Date 4/30/2025

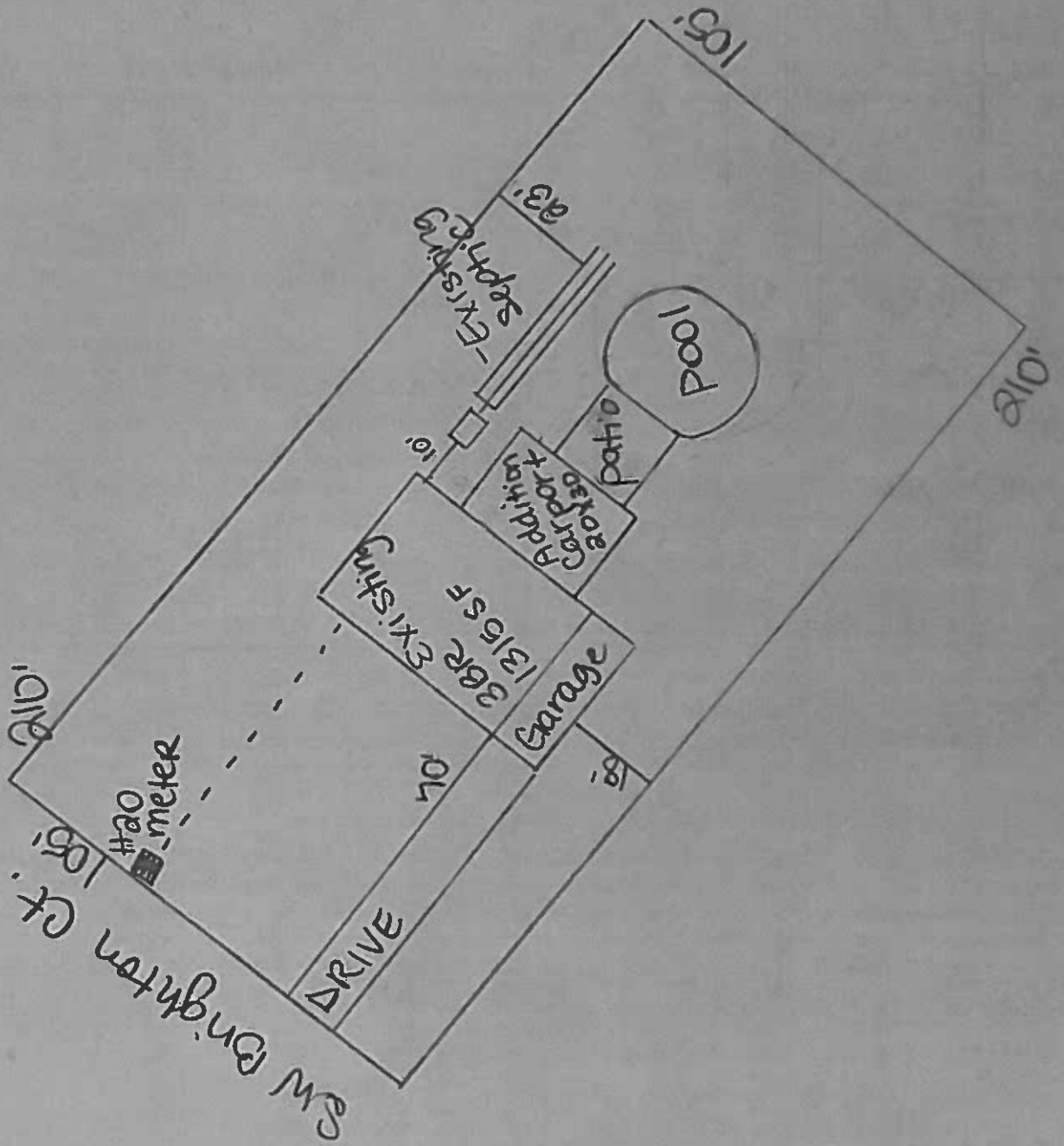

1. Building height shall be measured from the height of the curb, or from the mean ground level if no curb level has been established, to the top plate of the building.
2. Calculation of maximum height shall not include appurtenances or attachments such as chimneys, elevator shafts, antennas, decorative architectural features, steeples, air conditioning equipment enclosures, cupolas, weather vanes, and other similar minor building features. All appurtenances or attachments that are exempt for purposes of calculating the maximum building height shall not be habitable.
3. The following structures shall not be subject to height limits: telecommunications towers, flagpoles, radio towers, and Town-owned water towers.

Table 2.02.03.1 Standards for Building Heights and Setbacks

Zoning District	Maximum Building Height	Minimum Setback (ft.)			
		Front	Side	Side, Street	Rear
A	35	30	25	25	25
RSF-2	35	25	10	10	15
RSF-4	35	20	10	10	15
CN	35	25	10	10	15
DD	65	0	0	0	0
CG	35	20	10	10	15
I	35	20	10	10	15
PD	Defined by PD	Defined by PD	Defined by PD	Defined by PD	Defined by PD