



STATE OF FLORIDA
DEPARTMENT OF HEALTH
ONSITE SEWAGE TREATMENT AND DISPOSAL
SYSTEM
APPLICATION FOR CONSTRUCTION PERMIT

PERMIT NO. 200956
DATE PAID: 12/4/20
FEE PAID: 200.00
RECEIPT #: 1205009

APPLICATION FOR:

[] New System [☒] Existing System [] Holding Tank [] Innovative
[] Repair [] Abandonment [] Temporary []

APPLICANT: Keith Hudson

AGENT: Vince Robinson TELEPHONE: 758-0057

MAILING ADDRESS: 198 NE Ruskin Way L.C. 32055

TO BE COMPLETED BY APPLICANT OR APPLICANT'S AUTHORIZED AGENT. SYSTEMS MUST BE CONSTRUCTED BY A PERSON LICENSED PURSUANT TO 489.105(3)(m) OR 489.552, FLORIDA STATUTES. IT IS THE APPLICANT'S RESPONSIBILITY TO PROVIDE DOCUMENTATION OF THE DATE THE LOT WAS CREATED OR PLATTED (MM/DD/YY) IF REQUESTING CONSIDERATION OF STATUTORY GRANDFATHER PROVISIONS.

PROPERTY INFORMATION

LOT: _____ BLOCK: _____ SUBDIVISION: _____ PLATTED: _____

PROPERTY ID #: 11-43-17-08316-000 HX H3 ZONING: _____ I/M OR EQUIVALENT: [Y / N]

PROPERTY SIZE: 27.74 ACRES WATER SUPPLY: [☒] PRIVATE PUBLIC [] <=2000GPD [] >2000GPD

IS SEWER AVAILABLE AS PER 381.0065, FS? [Y / N] DISTANCE TO SEWER: _____ FT

PROPERTY ADDRESS: 198 NE Ruskin Way Lake City FL 32055

DIRECTIONS TO PROPERTY: _____

BUILDING INFORMATION

[☒] RESIDENTIAL [] COMMERCIAL

Unit No	Type of Establishment	No. of Bedrooms	Building Area Sqft	Commercial/Institutional System Design Table 1, Chapter 64E-6, FAC
1	<u>Carport/Workshop</u>	<u>0</u>	<u>1296</u>	<u>N/A</u>
2				
3				
4				

[] Floor/Equipment Drains [] Other (Specify) _____

SIGNATURE: Keith Hudson DATE: Dec 3, 2020

1891
1892
1893
1894
1895
1896
1897
1898
1899
1900

1891
1892

1893
1894
1895
1896
1897
1898
1899
1900

1891
1892
1893
1894
1895
1896
1897
1898
1899
1900

1891 1892 1893 1894 1895 1896 1897 1898 1899 1900

STATE OF FLORIDA
DEPARTMENT OF HEALTH
APPLICATION FOR CONSTRUCTION PERMIT

Permit Application Number 20-09526

----- PART II - SITEPLAN -----

Scale: Each block represents 10 feet and 1 inch = 40 feet.

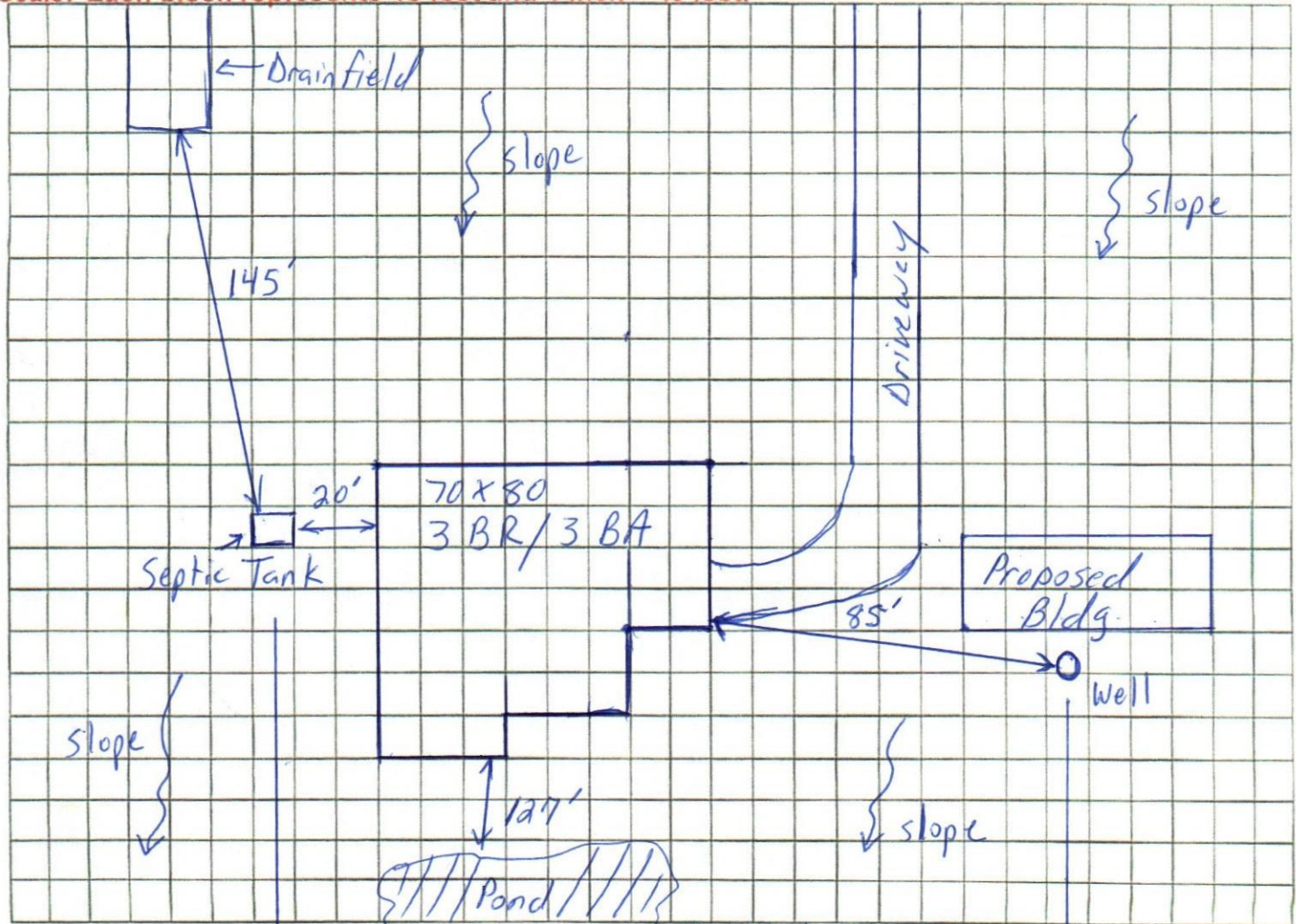

Notes: See Attachment Also

Site Plan submitted by: Vince Rehner TITLE _____ DATE: 12/3/2020
Plan Approved ✓ Not Approved _____ Date 12/11/20
By [Signature] ES2 Columbian County Health Department

ALL CHANGES MUST BE APPROVED BY THE COUNTY HEALTH DEPARTMENT

DATE: 06



Let $y = f(x)$ be a function defined on the interval $[a, b]$. The graph of the function is shown above. The function is continuous and differentiable on the interval $[a, b]$. The derivative of the function at the point (x_0, y_0) is given by the slope of the tangent line at that point.

The derivative of the function at the point (x_0, y_0) is given by the slope of the tangent line at that point. The derivative of the function at the point (x_0, y_0) is given by the slope of the tangent line at that point.