

COVERED PATIO VERSION

REFER TO CIVIL ENGINEERING
DOCUMENTS FOR ALL DIMENSIONING,
SETBACKS AND BUILDING LOCATION



1
A1.01

ARCHITECTURAL SITE PLAN

1" = 10'-0"

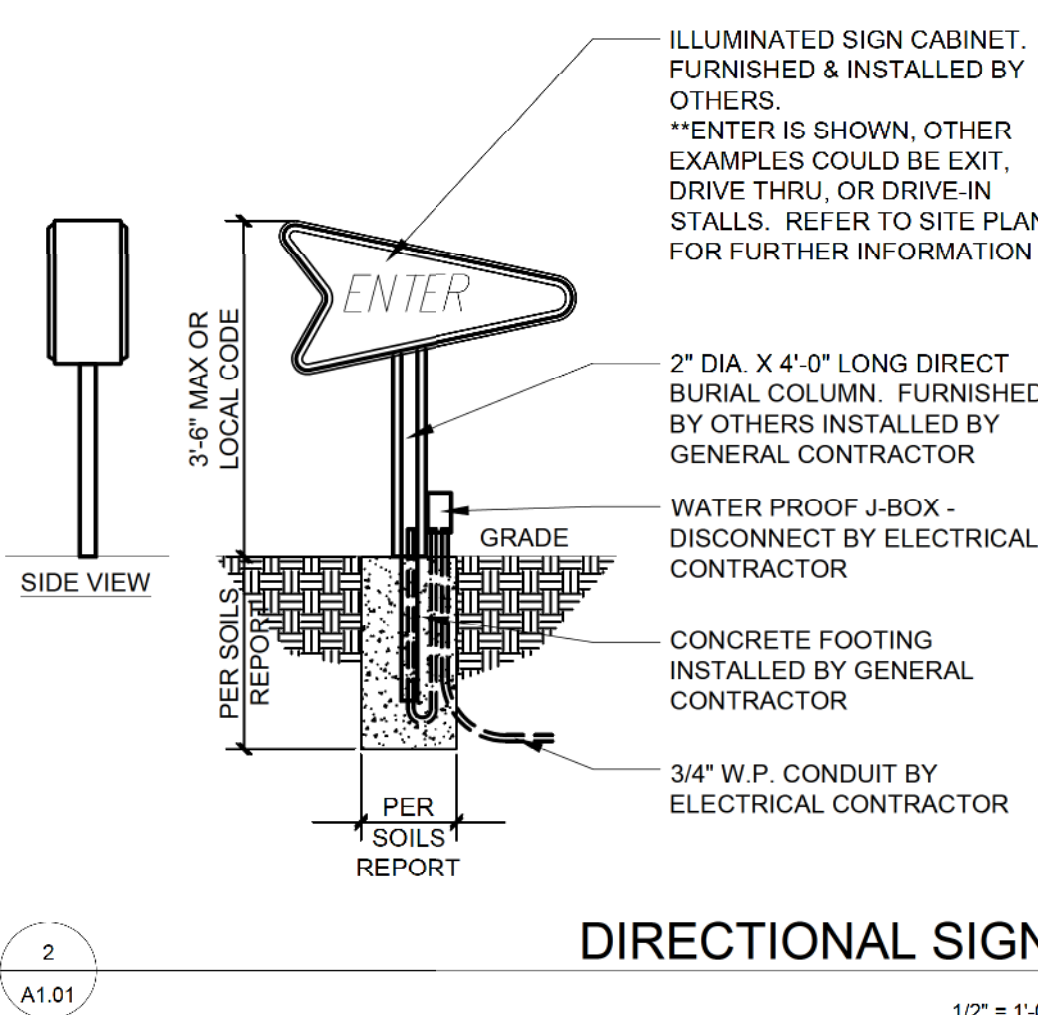

DRAWING LEGEND

GENERAL NOTES
- THE CONTRACTOR SHALL NOT DISTURB ANY ADJACENT PROPERTIES

KEYED NOTES

- 1 DASHED LINE INDICATES 36" CLEAR PATH OF TRAVEL
- 2 TRASH ENCLOSURE - REFER TO 2/A1.02
- 3 CAR HOP CROSSING SIGN - REFER TO CIVIL DRAWINGS
- 4 DASHED LINE INDICATES SOFFIT OVERHANG
- 5 PREMANUFACTURED REMOTE CANOPY - SUPPLIED BY CANOPY VENDOR AND INSTALLED BY GENERAL CONTRACTOR
- 6 PATIO COLUMNS, RAILING AND FENCE - REFER TO 1/A1.03
- 7 BOLLARD - REFER TO CIVIL DRAWINGS
- 8 TRAFFIC FLOW ARROWS (TYPICAL) REFER TO CIVIL DRAWINGS
- 9 4" PAINTED STRIPES (TYPICAL) UNLESS OTHERWISE NOTED BY CIVIL DRAWINGS
- 10 CURB RAMP (TYPICAL) REFER TO CIVIL DRAWINGS
- 11 DRIVE-THRU ORDERING EQUIPMENT - REFER TO 1/A1.02 AND CIVIL DRAWINGS FOR DIMENSIONS
- 12 STALL MENU / STALL CANOPY POST (TYPICAL) REFER TO SHEET A7.02
- 13 POLE MOUNTED FLOOD LIGHTS - VERIFY WITH E1.01 FOR LIGHT LOCATIONS AND INFORMATION. REFER TO STRUCTURAL FOR FOUNDATION DETAIL
- 14 CONCRETE CURB & GUTTER - REFER TO CIVIL DRAWINGS
- 15 CONCRETE WALKS AND PATIO - REFER TO CIVIL DRAWINGS
- 16 PATIO TABLES AND CHAIRS - OWNER SUPPLIED AND GC INSTALLED
- 17 TRASH CAN - OWNER SUPPLIED
- 18 PYLON / MONUMENT SIGN - UNDER SEPARATE PERMIT
- 19 ILLUMINATED DIRECTIONAL SIGN - REFER TO 2/A1.01, G.C. TO PROVIDE POWER.
- 20 HANDICAPPED PARKING SIGN - REFER TO CIVIL DRAWINGS
- 21 PATIO ORDER MENU TO BE WALL MOUNTED TO BUILDING - 39" A.F.F. TO PUSH/CALL BUTTON
- 22 SIDE WALK TRENCH DRAIN - REFER TO 2/A5.02

CONSULTANT:

INR national
restaurant
designers
ARCHITECTS & ENGINEERS
7208 ACC Blvd, 2nd Floor, Raleigh, NC 27617
ph: 919 544 0087 fax: 919 544 9399
A Division of LMHT Associates

CLIENT:

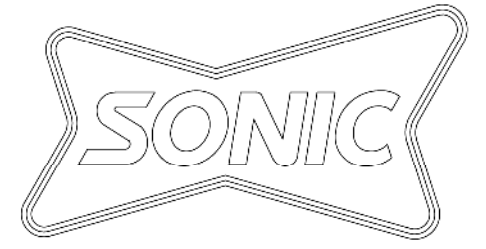

SONIC CORP.
300 JOHNNY BENCH DR
OKLAHOMA CITY, OK 73104
OFFICES: 405-225-5000
FAX: 405-225-5991

PROJECT INFORMATION:

SONIC
B15 PROTOTYPE ALTERNATE
SONIC DRIVE-IN RESTAURANT
LOT #3 GATEWAY CROSSING CENTURION WAY
LAKE CITY, FLORIDA
STORE # -

SEAL:

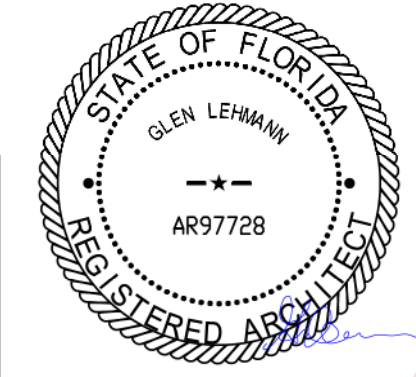

Digitally
signed by Glen
Lehmann
Date:
2022.06.27
14:48:14
-04'00'

PROJECT NO.: 22161
DRAWN BY:
CHECKED BY:

ISSUE: DATE:

REVISION: DATE:

PROJECT LOCATION:
LAKE CITY, FLORIDA

SHEET NUMBER / TITLE:
A1.01
ARCHITECTURAL SITE PLAN

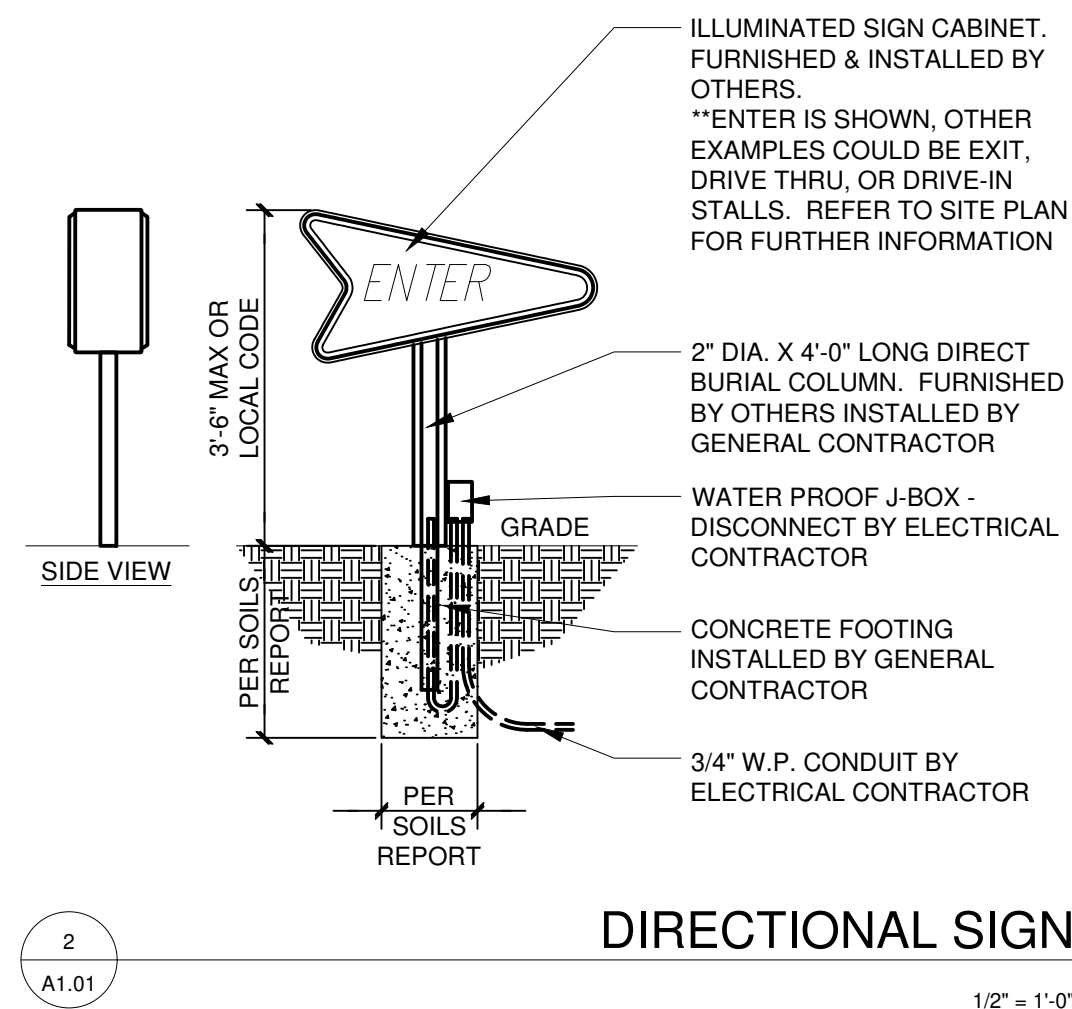
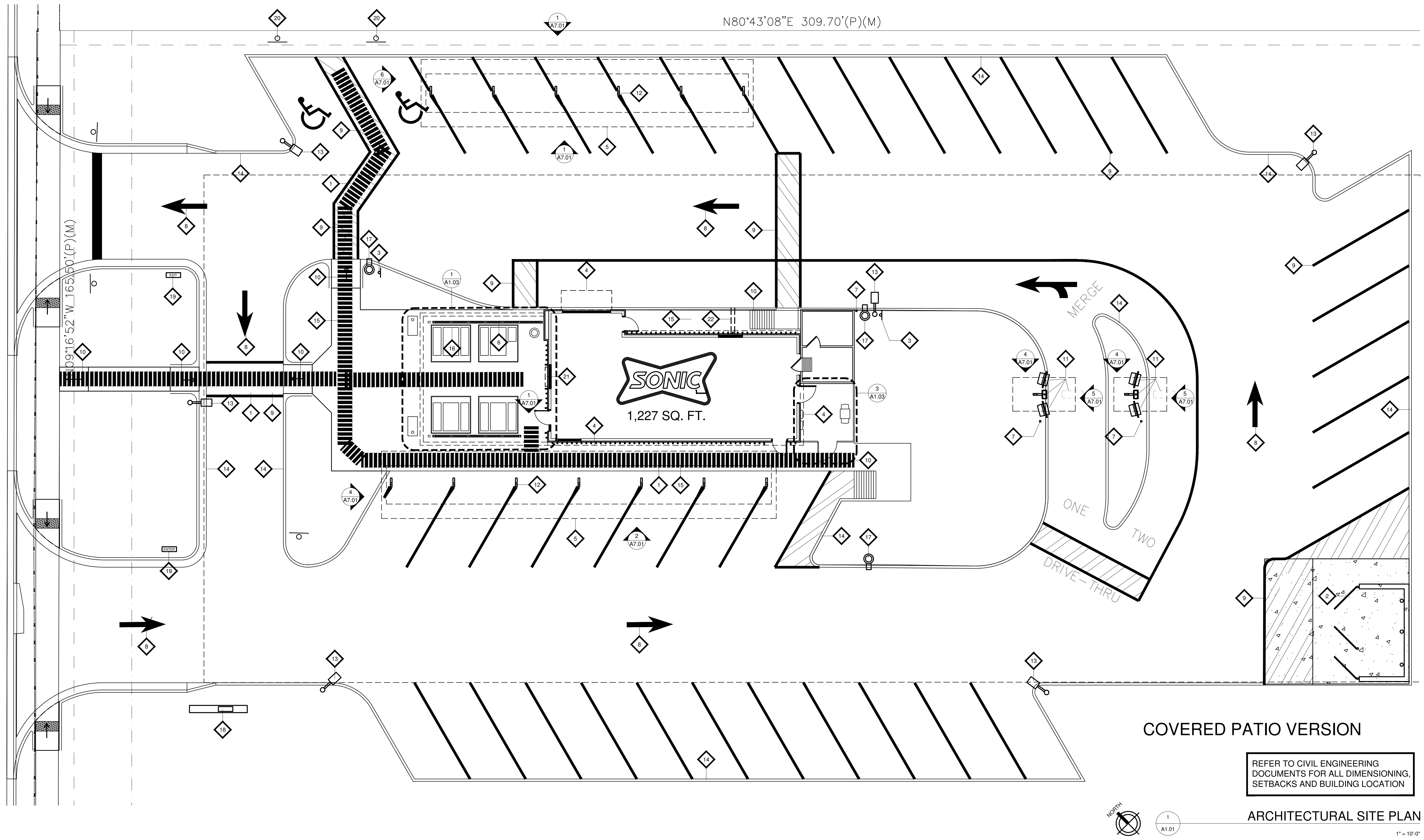

DRAWING LEGEND	
GENERAL NOTES - THE CONTRACTOR SHALL NOT DISTURB ANY ADJACENT PROPERTIES	
KEYED NOTES	
1 DASHED LINE INDICATES 36\"	13 POLE MOUNTED FLOOD LIGHTS - VERIFY WITH E1.01 FOR LIGHT LOCATIONS AND INFORMATION. REFER TO STRUCTURAL FOR FOUNDATION DETAIL
2 TRASH ENCLOSURE - REFER TO 2/A1.02	14 CONCRETE CURB & GUTTER - REFER TO CIVIL DRAWINGS
3 CAR HOP CROSSING SIGN - REFER TO CIVIL DRAWINGS	15 CONCRETE WALKS AND PATIO - REFER TO CIVIL DRAWINGS
4 DASHED LINE INDICATES SOFFIT OVERHANG	16 PATIO TABLES AND CHAIRS - OWNER SUPPLIED AND GC INSTALLED
5 PREMANUFACTURED REMOTE CANOPY - SUPPLIED BY CANOPY VENDOR AND INSTALLED BY GENERAL CONTRACTOR	17 TRASH CAN - OWNER SUPPLIED
6 PATIO COLUMNS, RAILING AND FENCE - REFER TO 1/A1.03	18 PYLON / MONUMENT SIGN - UNDER SEPARATE PERMIT
7 BOLLARD - REFER TO CIVIL DRAWINGS	19 ILLUMINATED DIRECTIONAL SIGN - REFER TO 2/A1.01. G.C. TO PROVIDE POWER.
8 TRAFFIC FLOW ARROWS (TYPICAL) REFER TO CIVIL DRAWINGS	20 HANDICAPPED PARKING SIGN - REFER TO CIVIL DRAWINGS
9 4\"	21 PATIO ORDER MENU TO BE WALL MOUNTED TO BUILDING - 39\"
10 CURB RAMP (TYPICAL) REFER TO CIVIL DRAWINGS	22 SIDE WALK TRENCH DRAIN - REFER TO 2/A5.02
11 DRIVE-THRU ORDERING EQUIPMENT - REFER TO 1/A1.02 AND CIVIL DRAWINGS FOR DIMENSIONS	
12 STALL MENU / STALL CANOPY POST (TYPICAL) REFER TO SHEET A7.02	

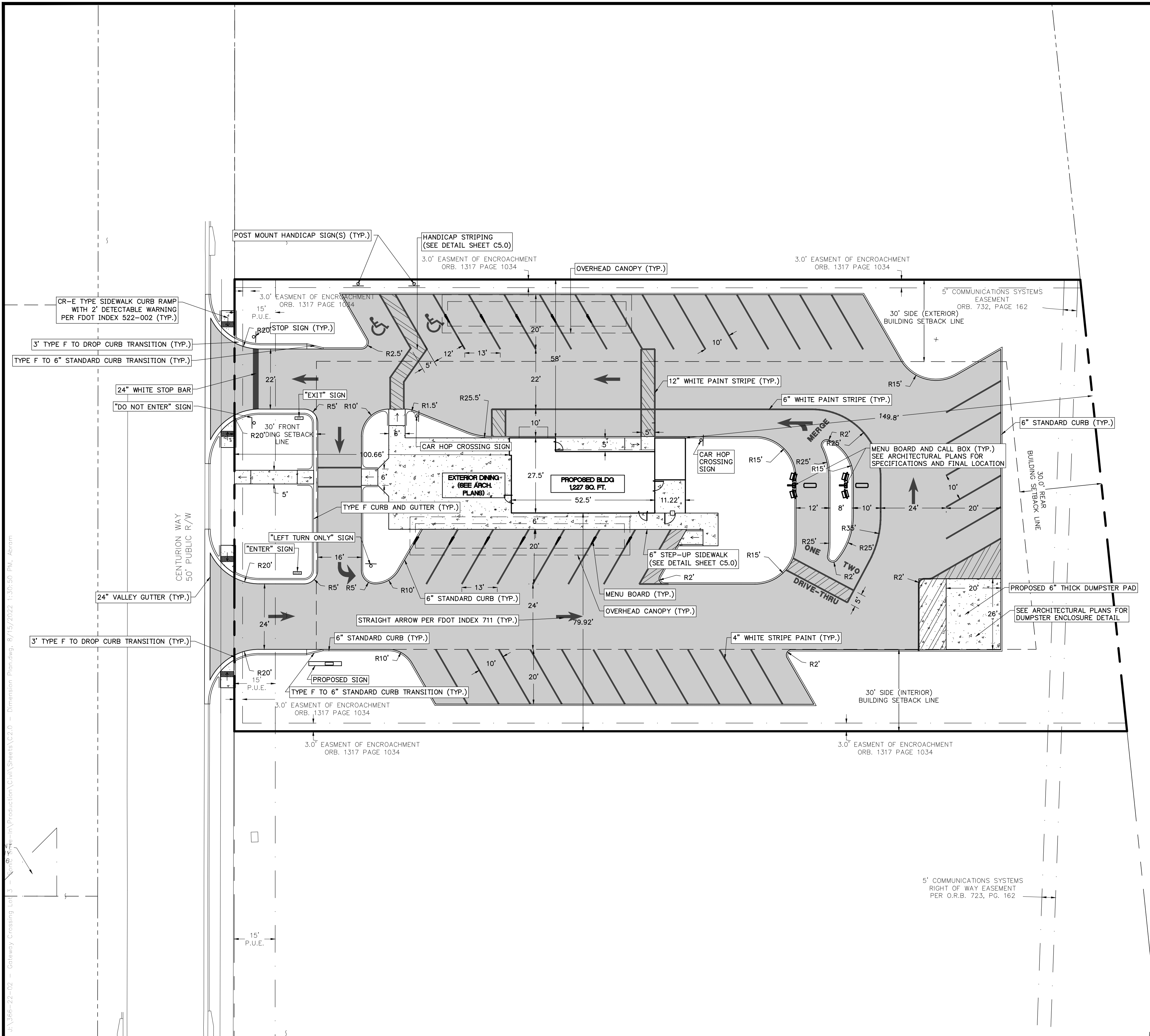

DIMENSION NOTES

- 1. CONTRACTOR SHALL FAMILIARIZE THEMSELVES WITH THE PROJECT SURVEY AND DESIGN DRAWINGS, AND SHALL VERIFY EXISTING SITE CONDITIONS. ANY APPARENT DISCREPANCIES OR ADDITIONAL PERTINENT INFORMATION SHALL BE BROUGHT TO THE PROJECT ENGINEER'S ATTENTION IMMEDIATELY.
- 2. ALL DIMENSIONS AND RADII SHOWN ARE DIMENSIONED TO EDGE OF PAVEMENT OR FACE OF CURB, UNLESS OTHERWISE SPECIFIED.
- 3. ALL STRIPING SHALL CONFORM TO FDOT STANDARD INDEX 711-001.
- 4. TOTAL NUMBER OF PARKING SPACES = 42 (2 HANDICAP PARKING SPACES)

LEGEND

- NEW ASPHALT PAVEMENT
- NEW CONCRETE

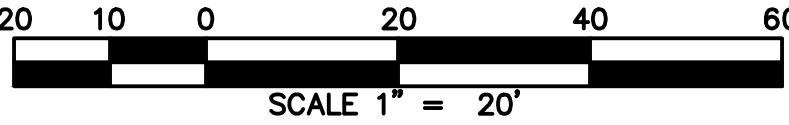
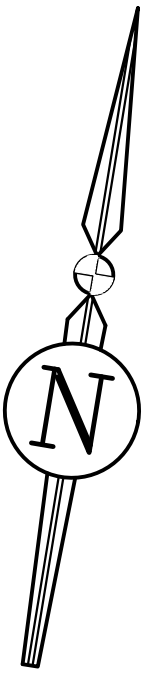

REVISIONS			
NO.	DATE	DESCRIPTION	DRWN APPR

ENGINEER OF RECORD:		CHRISTOPHER A. POTTS, P.E. FLORIDA LICENSE NO. 73842
---------------------	--	---

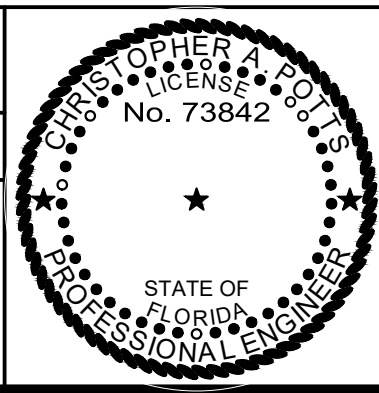

JBPro
CIVIL ENGINEERING | LAND PLANNING
SURVEYING | CONSTRUCTION SERVICES

3530 NW 43rd Street | Gainesville, Florida 32606
4420 US-1 S, Suite 1 | St. Augustine, Florida 32086

Gainesville: (352) 375-8999 | St. Augustine: (904) 789-8999
Toll Free: (844) Go-JBPro | E-mail: contact@jbpro.com

SHEET TITLE:		DATE:	
HIGH COTTON EQUITIES, LLC		JULY 2022	
		PROJECT NO:	
		366-22-02	
CLIENT:		PROJECT:	
SONIC RESTAURANT		SHEET NO:	
LAKE CITY, FLORIDA		C2.0	