

Silverline

BUILDING PRODUCTS CORP.
1 SILVERLINE DRIVE NORTH BRUNSWICK, NJ 08902 PH. 732.435.1000

"SERIES 5500 / 5600 / 5700" SLIDING PATIO DOOR EXTRUDED VINYL WITH NAILING FIN

GENERAL NOTES

1. THIS PRODUCT HAS BEEN EVALUATED AND IS IN COMPLIANCE WITH THE FLORIDA BUILDING CODE EXCLUDING THE "HIGH VELOCITY HURRICANE ZONE".
2. PRODUCT ANCHORS SHALL BE AS LISTED AND SPACED AS SHOWN ON DETAILS. ANCHOR EMBEDMENT TO BASE MATERIAL SHALL BE BEYOND WALL DRESSING OR STUCCO.
3. WHEN USED IN AREAS REQUIRING WIND-BORNE DEBRIS PROTECTION THIS PRODUCT IS REQUIRED TO BE COMPLIED WITH AN IMPACT RESISTANT COVERING THAT COMPLEIES WITH SECTION 1609.1.4 OF THE FLORIDA BUILDING CODE.
4. FOR 2X STUD FRAMING CONSTRUCTION, ANCHORING OF THESE UNITS SHALL BE THE SAME AS THAT SHOWN FOR 2X BUCK MASONRY CONSTRUCTION.
5. CONDITIONS NOT COVERED BY THIS DRAWING ARE SUBJECT TO FURTHER ENGINEERING ANALYSIS.

TABLE OF CONTENTS	
SHEET #	DESCRIPTION
1	TYPICAL ELEVATIONS, DESIGN PRESSURES & GENERAL NOTES
2	HORIZONTAL & VERTICAL CROSS SECTIONS
3	BUCK & FRAME ANCHORING
4	BILL OF MATERIALS & PANEL CROSS SECTIONS

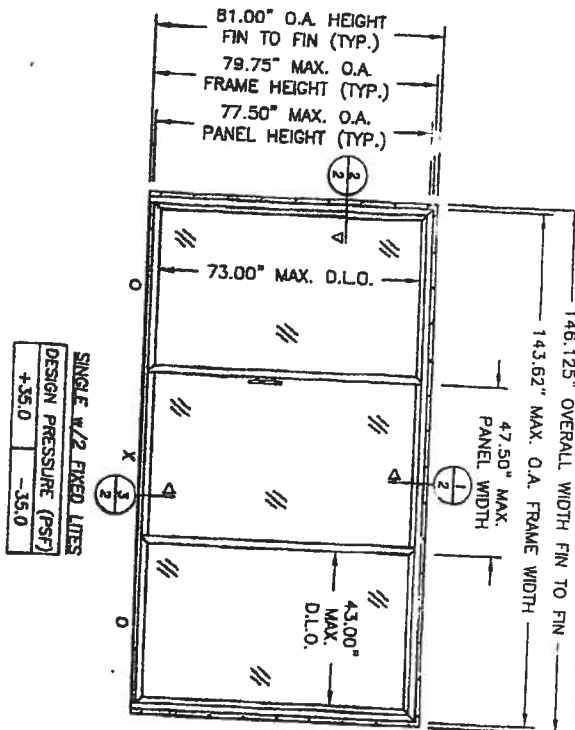
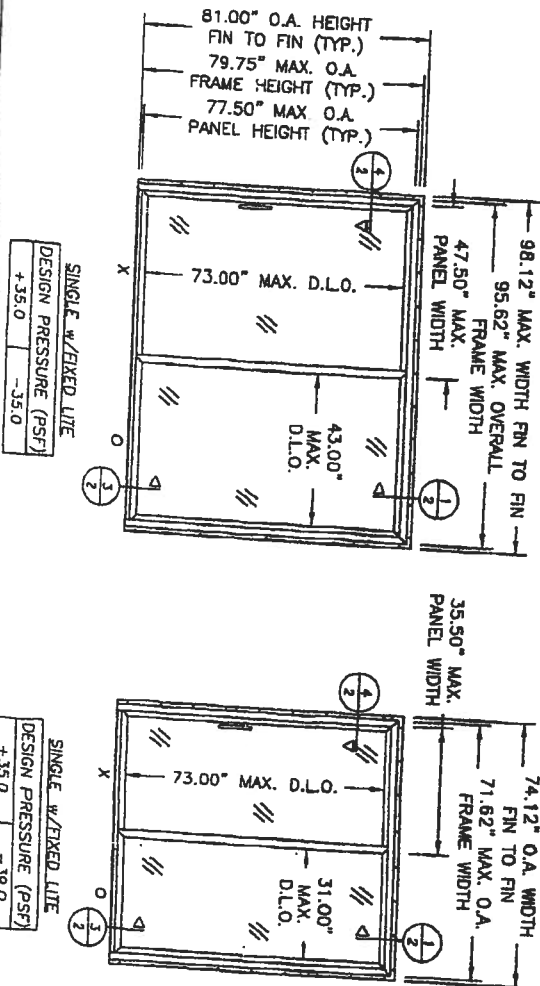

PRODUCT: SILVERLINE 5500 / 5600 / 5700 WITH NAILING FIN EXTRUDED VINYL SLIDING PATIO DOORS		Documents Prepared By: <i>RW</i> BUILDING CONSULTANTS, INC. P.O. Box 230 Valrico FL 33595 Phone No.: 813.629.9197 Florida Board of Professional Engineers Certificate of Authorization No. 8813 <i>Wendell W. Money</i> 10/20/05 Wendell W. Money, P.E. No. 54158	
PART OR ASSEMBLY: TYPICAL ELEVATIONS, DESIGN PRESSURES & GENERAL NOTES		REVISIONS	
DATE: 10/21/05 NO: 1	REVISED TO: 2004 BUILDING CODE	BY:	
SCALE: N.T.S. CHK. BY: T/JH DATE: 12/29/03 DWG. NO.: FL-143		SHEET: 1 OF 4	

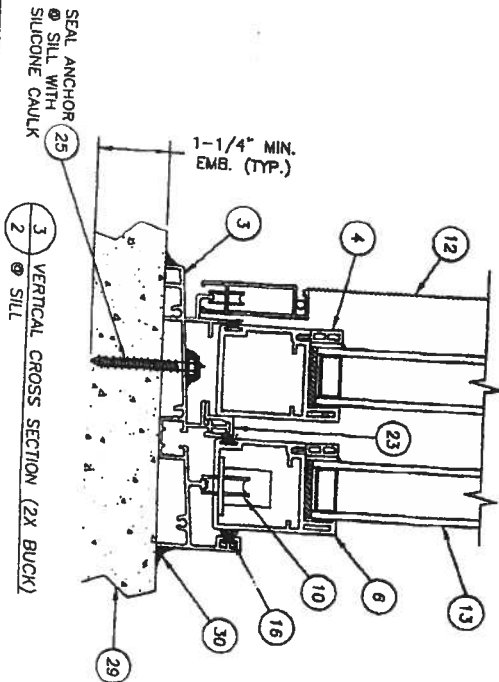
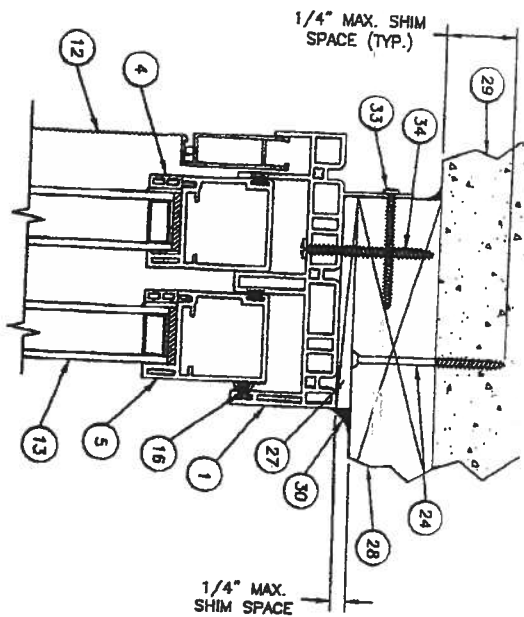
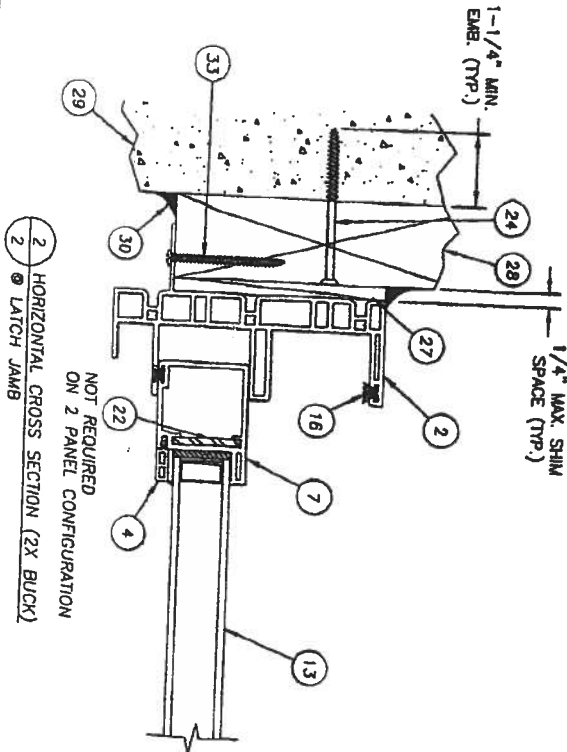
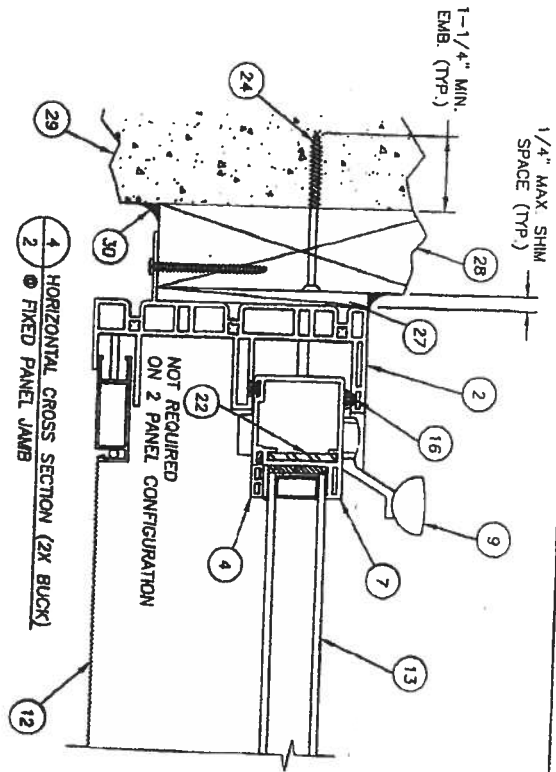

SHEET 2 OF 4		PRODUCT: SILVERLINE 5500 / 5600 / 5700 WITH NAILING PIN EXTRUDED VINYL SLIDING PATIO DOORS PART OR ASSEMBLY: HORIZONTAL & VERTICAL CROSS SECTIONS		Documents Prepared By: RgW BUILDING CONSULTANTS, INC. P.O. Box 230 Vero Beach, FL 33595 Phone No.: 813.659.9197 Florida Board of Professional Engineers Certificate of Authorization No. 9813 Wendell W. Haney, P.E. No. 54158	
DATE: 12/29/03 SCALE: N.T.S. DESIGNED BY: TJH CHECKED BY: RW DRAWING NO.: FL-143		REVISIONS 1 10/21/05 REVISED TO 2004 BUILDING CODE NO. DATE		BY:	

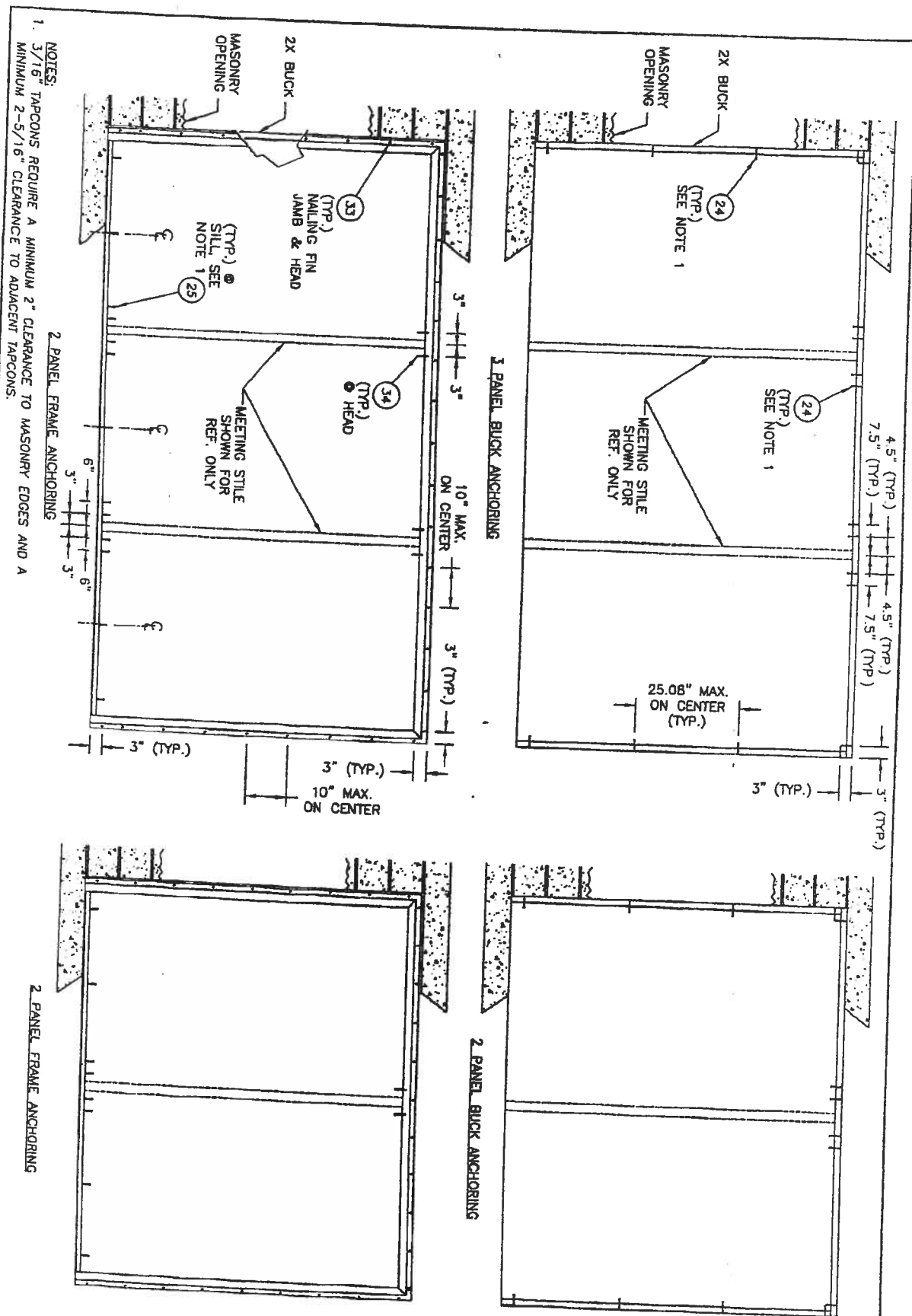
[illegible]

ITEM	DESCRIPTION	MATERIAL
1	EXTRUDED PVC .090" MAIN FRAME HEAD #5551 BY SILVERLINE*	PVC
2	EXTRUDED PVC .090" MAIN FRAME JAMB #5551 BY SILVERLINE*	PVC
3	EXTRUDED PVC .080" SILL #5503 BY SILVERLINE*	PVC
4	EXTRUDED PVC .080" GLAZING BEAD #2317 BY SILVERLINE*	PVC
5	EXTRUDED PVC .090" PANEL TOP RAIL #5504 BY SILVERLINE*	PVC
6	EXTRUDED PVC .090" PANEL BOTTOM RAIL #5504 BY SILVERLINE*	PVC
7	EXTRUDED PVC .090" PANEL LOCK STILES #5504 BY SILVERLINE*	PVC
8	EXTRUDED PVC .090" ACTIVE PANEL INTERLOCK STILE #5508 BY SILVERLINE*	PVC
9	SLIDING PATIO DOOR HANDLE LOCK SET HANDLE #5537, LOCK #5537	PVC
10	SLIDING PATIO DOOR ROLLER ASSEMBLY #11-1835-6878 BY BUILDERS H.W.	-
11	FIXED LITE RETAINING CLIP PLASTIC #5519 BY SILVERLINE	PLASTIC
12	ROLLING PATIO DOOR SCREEN	-
13	GLAZING 1" INSULATED TEMPERED GLASS	GLASS
14	1/8" TEMPERED - 3/4" AIR - 1/8" TEMPERED	GLASS
15	GLAZING COMPOUND (DOOR #1198)	SILICONE
16	INTERLOCK STEEL REINFORCEMENT .050" #5535 BY SILVERLINE	STEEL
17	WEATHER STRIP PILE .270 X .220, PANEL STILES & RAILS (ULTRAFLEX)	PILE
18	#84 X 2" PHX ZINC PLATED SCREW FRAME CORNERS HEAD	STEEL
19	EXTRUDED PVC .080" FIXED PANEL INTERLOCK STILE #5507 BY SILVERLINE*	PVC
20	#84 X 1 1/2" PHX ZINC PLATED SCREW PANEL CORNERS SILL	STEEL
21	GLAZING SHIM	-
22	STEEL STILE REINFORCEMENT .125" #5518 BY SILVERLINE	STEEL
23	EXTRUDED ALUMINUM SILL COVER	ALUM.
24	3/16" X 2-3/4" TAPCON	STEEL
25	3/16" X 1-3/4" H.H. TAPCON	STEEL
26	#10 X 2-1/4" PHX SMS	STEEL
27	1/4" MAX SHIM	WOOD
28	2X BLOCK	WOOD
29	MASONRY	CONCRETE
30	CHALK	SILICONE
31	3/16" X 3-1/4" H.H. TAPCON	STEEL
32	1X BLOCK	WOOD
33	#8 X 2" PHX SMS	STEEL
34	#10 X 2-1/2" PHX SMS	STEEL

* THE APPROVED WHITE RIGID PVC EXTERIOR EXTRUSIONS FOR WINDOWS ARE TO BE PRODUCED BY EXTRUDERS LICENSEES IN "MAA" CERTIFICATION PROGRAMS FOR RIGID PVC EXTRUSIONS.

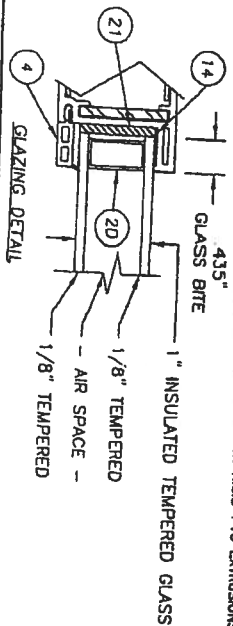

2 VERTICAL CROSS SECTION

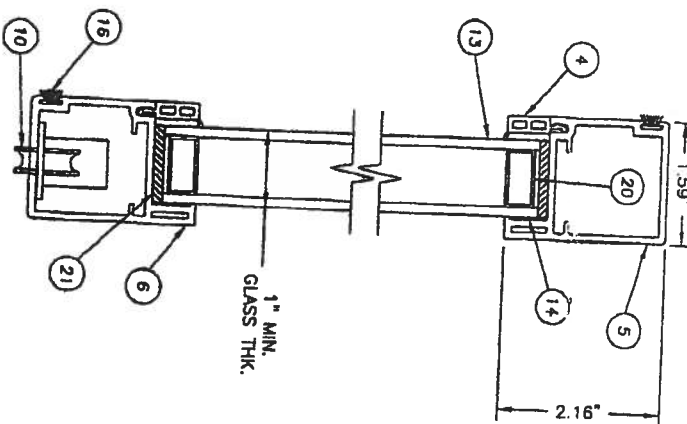

PANEL ELEVATION

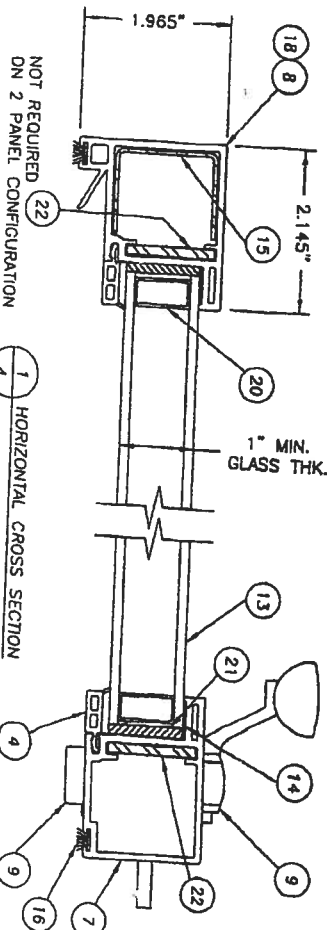
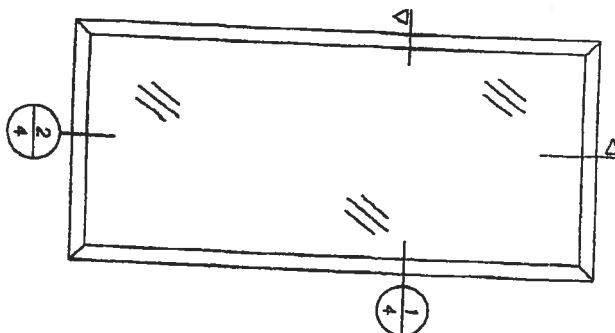

1 HORIZONTAL CROSS SECTION

SHEET 4 OF 4		DRAWING NO. FL-143		CHK. BY: RW		DATE: 12/29/03		SCALE: N.T.S.		PROJECT: SILVERLINE 5500 / 5800 / 5700 WITH NAILING FIN EXTRUDED VINYL SLIDING PATIO DOORS		PART OR ASSEMBLY: BILL OF MATERIALS & PANEL CROSS SECTIONS		Documents Prepared By: R.W. BUILDING CONSULTANTS, INC. P.O. Box 230 Valrico FL 33595 Phone No.: 813.658.8107 Florida Board of Professional Engineers Certificate of Authorization No. 9813	
NO.		DATE		REVISIONS		REVISED TO 2004 BUILDING CODE		AEM		BY		DATE		10/21/05	

R W B C

R W Building Consultants, Inc.

Consulting and Engineering Services for the Building Industry
P.O. Box 230 Valrico, FL 33595 Phone 813.659.9197 Facsimile 813.754.9989
Florida Board of Professional Engineers Certificate of Authorization No. 9813

Product Evaluation Report

Report No.: FL 5600.2
Date: October 21, 2005
Product Category: Exterior Doors
Product sub-category: Sliding
Product Name: 5500/5600/5700 Patio Doors w/ Fin
Manufacturer: Silverline Building Products Corporation
1 Silverline Drive
North Brunswick, NJ 08902
Phone: 732.435.1000 Facsimile: 732.247.6820

Scope: This is a Product Evaluation report issued by R W Building Consultants, Inc. and Wendell W. Haney, P.E. (System ID # 1993) for Silverline Building Products based on Rule Chapter No. 9B-72.070, Method 1d of the State of Florida Product Approval, Department of Community Affairs-Florida Building Commission.

RW Building Consultants and Wendell W. Haney, P.E. do not have nor will acquire financial interest in the company manufacturing or distributing the product or in any other entity involved in the approval process of the product named herein.

This product has been evaluated for use in locations adhering to the Florida Building Code (2004 Edition) and where pressure requirements, as determined by Chapter 16 of The Florida Building Code, do not exceed the following design pressures:

Design Pressure Rating:

Maximum Design Pressure Rating
(See Limitations for size restrictions)

Positive 35.0 PSF

Negative 39.0 PSF

See Drawing No.: FL-143 prepared by R W Building Consultants, Inc. and signed and sealed by Wendell W. Haney, P.E. (FL # 54158) for specific use parameters.

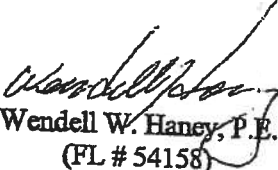
Wendell W. Haney, P.E.
(FL # 54158)
November 29, 2005

Limitations

1. The 5500/5600/5700 Nailing Fin Units Extruded Vinyl Sliding Patio Doors have been evaluated and meets the requirements for use within the State of Florida excluding the "High Velocity Hurricane Zone".
2. When used in areas requiring windborne debris protection this product is required to be protected with an impact resistant covering that complies with Section 1609.1.4 of the Florida Building Code 2004.

3. Size Limitations:

<u>Configurations</u>		<u>MAX. Width</u>	<u>MAX. Height</u>
Single w/ Fixed Lite	XO	74.125"	81.0"
Single w/ Fixed Lite	XO	98.125"	81.0"
Single w/ 2 Fixed Lites	OXO	146.125"	81.0"

4. The Design Pressure Rating for the various size units are as follows:

<u>Configurations</u>		<u>Size</u>	<u>Positive PSF</u>	<u>Negative PSF</u>
Single w/ Fixed Lite	XO	74.125" x 81.0"	+ 35.0	- 39.0
Single w/ Fixed Lite	XO	98.125" x 81.0"	+ 35.0	- 35.0
Single w/ 2 Fixed Lites	OXO	146.125" x 81.0"	+ 35.0	- 35.0

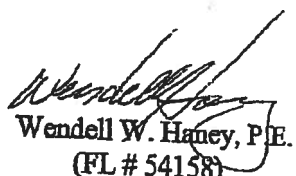
 Wendell W. Haney, P.E.
 (FL # 54158)
 November 29, 2005

Supporting Documents

A Drawing

1. Drawing No. FL-143 titled Silverline 5500/5600/5700 Nailing Fin Units Extruded Vinyl Sliding Patio Doors prepared by R W Building Consultants, Inc. (Florida Board of Professional Engineers Certificate of Authorization No. 9813), signed and sealed by Wendell W. Haney, P.E.

B Test

1. Testing per AAMA / NWWDA 101/I.S. 2-97 as performed by Architectural Testing Inc. and reported in test report number 01-34723.05, dated May 1, 2000, signed by Bruce W. Croak, Director - Product/Physical Testing.
2. Testing per AAMA / NWWDA 101/I.S. 2-97 as performed by Architectural Testing Inc. and reported in test report number 01-39202.01, dated May 14, 2001, signed by Allen N. Reeves, P.E.
3. Plastics testing in accordance with the "High Velocity Hurricane Zone" substantiated by Issuance of Miami-Dade Notice of Acceptance 03-0523.01, expiring August 15, 2007

C Calculations

1. Product anchoring is in accordance with manufacturer's published recommendations as substantiated by tested specimens reported in test report # 01-34723.05 and 01-39202.01.
2. Buck anchor analysis for loading conditions, prepared, signed and sealed by Wendell W. Haney, P.E.
3. Glass Load Resistance Report ASTM E1300-02 prepared by Wendell W. Haney, P.E.

D Other

Certificate of Participation issued by National Accreditation & Management Institute, Inc., certifying that Silverline Building Products, North Brunswick, NJ is manufacturing products within a quality assurance program.

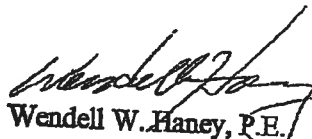
Wendell W. Haney, P.E.
(FL # 54158)
November 29, 2005



NAN YA PLASTICS CORP.
PLASTPRO INC.

9 PEACH TREE HILL ROAD
LIVINGSTON, NEW JERSEY 07039
PH: 800-779-0561 FAX: 973-758-4001

DISTINCTION SERIES

3'0" x 6'8" OPAQUE FIBERGLASS DOOR

INSWING / OUTSWING

GENERAL NOTES

1. THIS PRODUCT HAS BEEN EVALUATED AND IS IN COMPLIANCE WITH THE FLORIDA BUILDING CODE EXCLUDING THE "HIGH VELOCITY HURRICANE ZONE."
2. PRODUCT ANCHORS SHALL BE AS LISTED AND SPACED AS SHOWN ON DETAILS. ANCHOR EMBEDMENT TO BASE MATERIAL SHALL BE BEYOND WALL DRESSING OR STUCCO.
3. WHEN USED IN WIND-BORNE DEBRIS REGIONS THIS PRODUCT COMPLIES WITH SECTION 1609.1.4 OF THE FLORIDA BUILDING CODE AS AN IMPACT RESISTANT PRODUCT AND DOES NOT REQUIRE THE USE OF MEET THE REQUIREMENTS FOR ENHANCED PROTECTION OF ESSENTIAL FACILITIES AS DEFINED IN ASTM E1998.
4. FOR 2X STUD FRAMING CONSTRUCTION, ANCHORING OF THESE UNITS SHALL BE THE SAME AS THAT SHOWN FOR 2X BUCK MASONRY CONSTRUCTION.
5. CONDITIONS NOT COVERED BY THIS DRAWING ARE SUBJECT TO FURTHER ENGINEERING ANALYSIS.

SHEET #	DESCRIPTION
1	TYPICAL ELEVATION, DESIGN PRESSURES & GENERAL NOTES
2	HORIZONTAL & VERTICAL CROSS SECTIONS
3	BUCK & FRAME ANCHORING
4	BILL OF MATERIALS & COMPONENTS

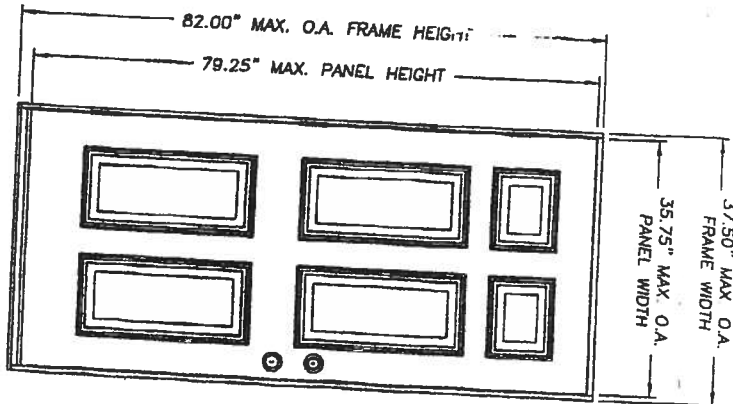

SINGLE OPAQUE DOOR

TYPE	OVERALL FRAME DIMENSION	DESIGN PRESSURE (PSF)
INSWING	37.50" x 82.00"	+65.0
OUTSWING	37.50" x 80.37"	-65.0

PRODUCT: DISTINCTION SERIES 3'0" x 6'8" OPAQUE FIBERGLASS DOOR INSWING / OUTSWING		Documents Prepared By: <i>RW</i> BUILDING CONSULTANTS, INC. P.O. Box 230 Vero Beach, FL 33595 Phone No.: 813.659.9197 Florida Board of Professional Engineers Certificate of Authorization No. 9813 Wendy W. Yancy, P.E. No. 54158							
PART OR ASSEMBLY: TYPICAL ELEVATION, DESIGN PRESSURES & GENERAL NOTES		DATE: 01/13/06 SCALE: N.T.S. DWN. BY: AEM CHK. BY: WWH DRAWING NO.: FL-853							
REVISIONS <table border="1"> <tr> <th>NO.</th> <th>DATE</th> <th>BY</th> </tr> <tr> <td> </td> <td> </td> <td> </td> </tr> </table>		NO.	DATE	BY				SHEET 1 OF 4	
NO.	DATE	BY							

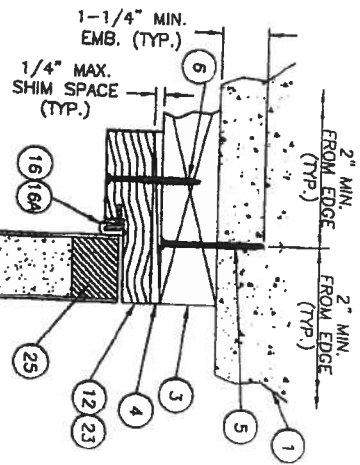
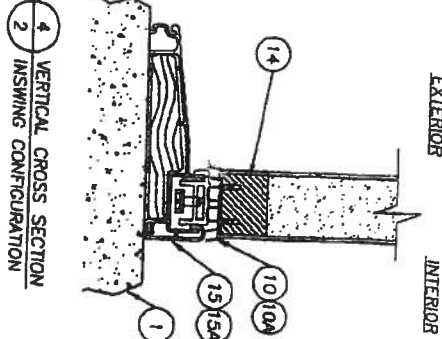
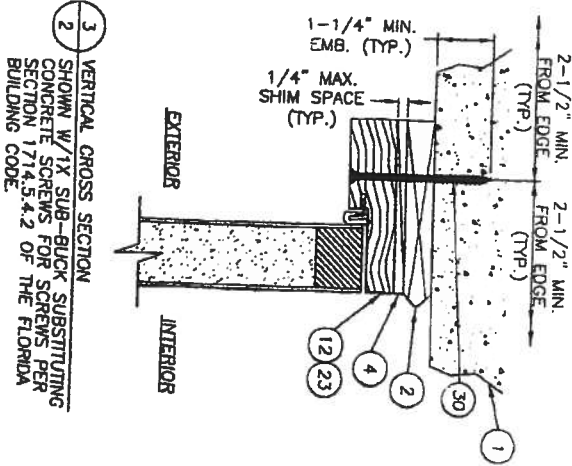
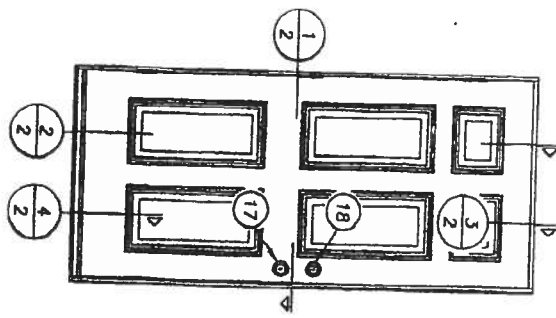

1 HORIZONTAL CROSS SECTION
2 OUTSWING CONFIGURATION

3 VERTICAL CROSS SECTION
2 INSWING CONFIGURATION

1 HORIZONTAL CROSS SECTION
2 OUTSWING CONFIGURATION

3 VERTICAL CROSS SECTION
2 INSWING CONFIGURATION

1 HORIZONTAL CROSS SECTION
2 OUTSWING CONFIGURATION

DATE: 01/13/06		SCALE: N.T.S.		DWG. BY: AEM		CHK. BY: WHH		DRAWING NO.: FL-853	
SHEET 2 OF 4		REVISIONS		BY		DATE		NO.	
PRODUCT:		DISTINCTION SERIES 3'0" x 6'8"		OPAQUE FIBERGLASS DOOR		INSWING / OUTSWING		PART OR ASSEMBLY:	
HORIZONTAL & VERTICAL		CROSS SECTIONS							
Documents Prepared By:		R.W. BUILDING CONSULTANTS, INC.		P.O. Box 230 Vero Beach FL 33585		Phone No.: 813.650.9107		Florida Board of Professional Engineers	
Certificate Of Authorization No. 9813		Wendell W. Money, P.E. No. 54158		2-22-06					

- NOTES:
1. 3/16" TAPCONS REQUIRE A MINIMUM 2" CLEARANCE TO MASONRY EDGES AND A MINIMUM 2-1/4" CLEARANCE TO ADJACENT TAPCONS.
 2. 1/4" TAPCONS REQUIRE A MINIMUM 2-1/2" CLEARANCE TO MASONRY EDGES AND A MINIMUM 3" CLEARANCE TO ADJACENT TAPCONS.
 3. WHEN ANCHORING DOOR FRAME UTILIZING A 1X BUCK THEN ITEM #6 IS SUBSTITUTED WITH ITEM #30 (1/4" X 3-3/4" ELCO ANCHOR).

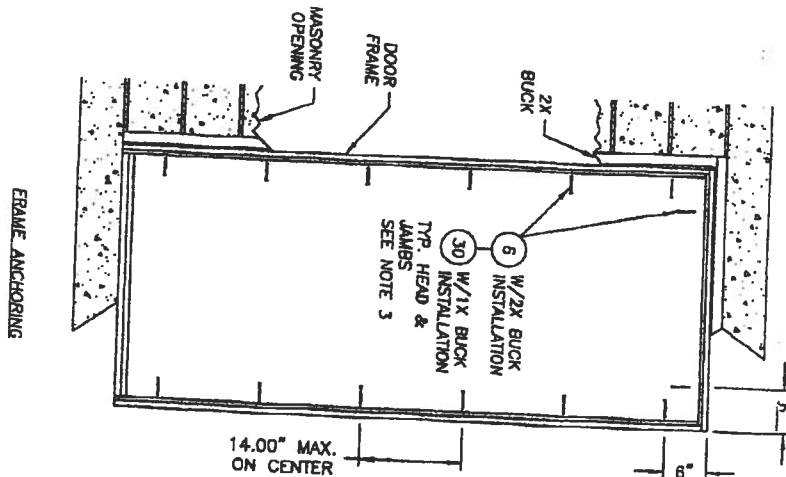
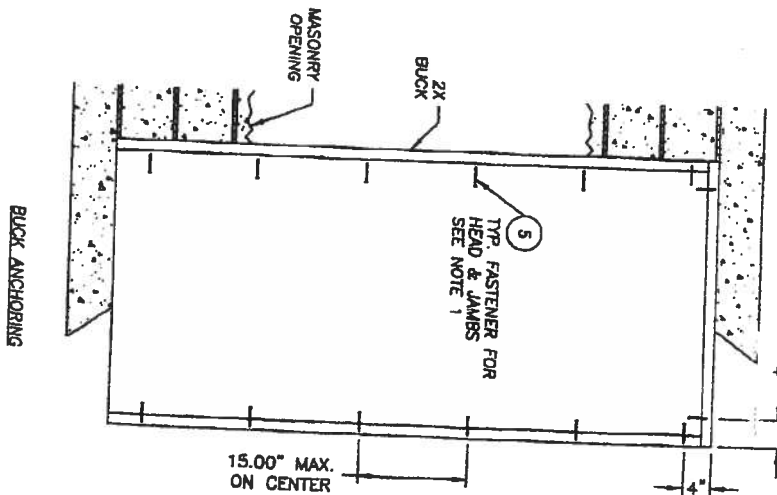
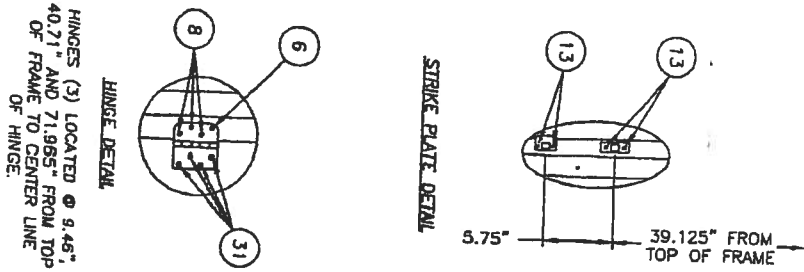

SHEET 3 OF 4		DRAWING NO. FL-853		CHK. BY. WWH		DATE: 01/13/06		SCALE: N.T.S.		DATE: 01/13/06		BY		REVISIONS		PRODUCT: DISTINCTION SERIES 3'0" x 6'8" OPAQUE FIBERGLASS DOOR INSWING / OUTSWING		PART OR ASSEMBLY: BUCK & FRAME ANCHORING		Documents Prepared By: RW BUILDING CONSULTANTS, INC. P.O. Box 230 Venice FL 33585 Phone No.: 813.659.9187 Florida Board of Professional Engineers Certificate Of Authorization No. 9813 Wendell W. Wany, P.E. No. 54158	
--------------	--	--------------------	--	--------------	--	----------------	--	---------------	--	----------------	--	----	--	-----------	--	--	--	--	--	---	--

ITEM	DESCRIPTION	MATERIAL
1	MASONRY	CONC.
2	1X BLOCK	WOOD
3	2X BLOCK	WOOD
4	1/4" MAX. SHIM SPACE	WOOD
5	3/16" x 2-3/4" LARCON	WOOD
6	1/10" x 2-1/2" PPH WOOD SCREW	STEEL
7	3/16" x 2-1/4" LARCON	STEEL
8	19 x 3/4" PPH WOOD SCREW	STEEL
9	DOOR SKIN (MIN. 0.075" THICK)	FIBERGLASS
10	INSWING WNTL DOOR BOTTOM SWEEP BY ENDURA	WNTL
10A	WNTL DOOR BOTTOM SWEEP #1828 BY HOLM MO.	WNTL
11	REINFORCEMENT WOOD FOR LOOKS	WOOD
12	FINGER JOINTED PINE JAMB	WOOD
13	#9 x 2-1/4" PPH WS	STEEL
14	BOTTOM RAIL	FOAM PVC
15	INSWING ADJUSTABLE THRESHOLD BY ENDURA	AL/WOOD
15A	INSWING ADJUSTABLE ALUMINUM THRESHOLD BY DUP	AL/WOOD
16	FORCE 5 WEATHER STRIPPING BY ENDURA	FOAM
16A	COMPRESSION WEATHER STRIP ALON 850 BY SCHLIEREL	FOAM
17	KINKSET KEED ENTRY GRADE 2	STEEL
18	KINKSET DEADBOLT GRADE 2	STEEL
19	NOT USED	-
20	POLYURETHANE FOAM BY ALUMA	FOAM
21	4" x 4" BUTT HINGE	STEEL
22	#8 x 2" PPH WOOD SCREW	STEEL
23	POLY FIBER JAMB	COMP. / WNTL
24	HINGE & LATCH STILE	FOAM PVC
25	TOP RAIL	FOAM PVC
26	NOT USED	-
27	STROKE PLATE	STEEL
28	OUTSWING BUMP THRESHOLD	ALUM.
29	HINGE & LATCH STILE REINFORCEMENT	U.A.
30	1/4" x 3-3/4" LARCON	STEEL
31	#9 x 1" PPH WOOD SCREW	STEEL

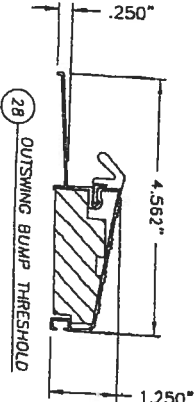
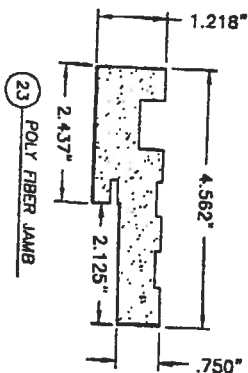
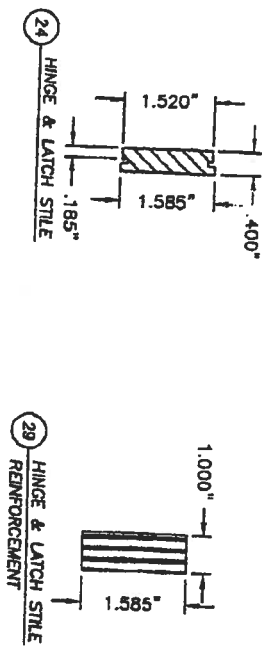
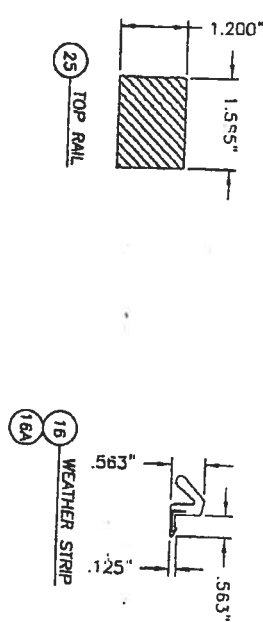
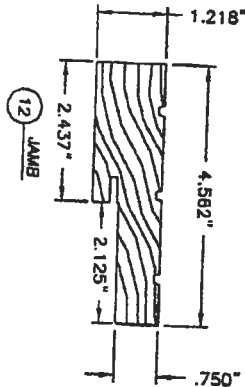
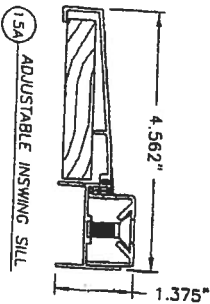
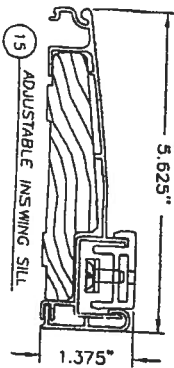

PRODUCT: DISTINCTION SERIES 3'0" x 6'8" OPAQUE FIBERGLASS DOOR INSWING / OUTSWING PART OR ASSEMBLY:		Documents Prepared By: <i>RW</i> BUILDING CONSULTANTS, INC. P.O. Box 230 Valrico FL 33595 Phone No.: 213.859.9187 Florida Board of Professional Engineers Certificate of Authorization: No. 8813 <i>Wardell W. Denny</i> Wardell W. Denny, P.E. No. 54158	
REVISIONS NO. DATE BY		DATE: 01/13/08 SCALE: N.T.S. CHK. BY: AEM DRW. BY: WHH FL-853	
SHEET 4 OF 4		BILL OF MATERIALS & COMPONENTS	

R W B C

R W Building Consultants, Inc.

Consulting and Engineering Services for the Building Industry
P.O. Box 230 Valrico, FL 33595 Phone 813.659.9197 Facsimile 813.754.9989

Florida Board of Professional Engineers Certificate of Authorization No. 9813

Product Evaluation Report

Report No.: FL 6184.1
Date: February 20, 2006
Product Category: Exterior Doors
Product sub-category: Swinging Exterior Door Assemblies
Product Name: Distinction Series 3'0" x 6'8" Opaque Single Fiberglass Door
Inswing / Outswing
Manufacturer: Nan Ya Plastics Corporation
Plastpro Inc.
9 Peach Tree Hill Road
Livingston, NJ 07039
Phone: 800-779-0561 Facsimile: 973-758-4001

Scope: This is a Product Evaluation report issued by R W Building Consultants, Inc. and Wendell W. Haney, P.E. (System ID # 1993) for Nan Ya Plastics Corporation, Plastpro Inc. based on Rule Chapter No. 9B-72.070, Method 1d of the State of Florida Product Approval, Department of Community Affairs-Florida Building Commission.

RW Building Consultants and Wendell W. Haney, P.E. do not have nor will acquire financial interest in the company manufacturing or distributing the product or in any other entity involved in the approval process of the product named herein.

This product has been evaluated for use in locations adhering to the Florida Building Code (2004 Edition) and where pressure requirements, as determined by Chapter 16 of The Florida Building Code, do not exceed the following design pressures:

Design Pressure Rating:

Maximum Design Pressure Rating
(See Limitations for size restrictions)

Positive 65.0 PSF

Negative 70.0 PSF

See Drawing No.: FL 853 prepared by R W Building Consultants, Inc. and signed and sealed by Wendell W. Haney, P.E. (FL # 54158) for specific use parameters.

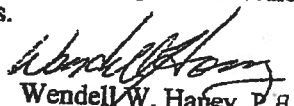
Wendell W. Haney, P.E.
FL No. 54158
February 20, 2006

Limitations

1. The Distinction Series 3'0" x 6'8" Single Opaque Fiberglass Door Inswing / Outswing has been evaluated and meets the requirements for use within the State of Florida excluding the "High Velocity Hurricane Zone".
2. When used in wind-borne debris regions this product complies with Section 1609.1.4 of the Florida Building Code as an Impact resistant product and does not require the use of an external impact resistant covering. This product does not meet the requirements for enhanced protection of essential facilities as defined in ASTM E1996.
3. This product is intended for use where Section R 314.2.4 of the Florida Building Code is applicable.
4. Size Limitations:

Configurations

Single

X

MAX. Width

37.5"

MAX. Height

82.0"

5. See Drawing # FL 853 for Design Pressure Ratings.

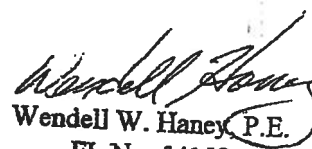

Wendell W. Hancy P.E.

FL No. 54158

February 20, 2006

Supporting Documents

- A Drawing
1. Drawing No. FL 853 titled Distinction Series 3'0" x 6'8" Single Opaque Fiberglass Door Inswing / Outswing prepared by R W Building Consultants, Inc. (Florida Board of Professional Engineers Certificate of Authorization No. 9813), signed and sealed by Wendell W. Haney, P.E.
- B Tests Performed
1. Testing per ASTM E330-02, ASTM E1886/E1996-02, and ASTM E283-91 as performed by Testing Evaluation Laboratories Inc., and reported in test report number TEL 2004-09-24-028, dated September 30, 2004, and signed and sealed by Wendell W. Haney, P.E.
- C Calculations
1. Product anchoring is in accordance with manufacturer's published recommendations as substantiated by tested specimens reported in test report number TEL 2004-09-24-028.
 2. Buck anchor analysis for loading conditions, prepared, signed and sealed by Wendell W. Haney, P.E.
- D Other
1. Certificate of Participation issued by National Accreditation & Management Institute, Inc., certifying that Nan Ya Plastics Corporation, Plastpro Inc is manufacturing products within a quality assurance program.

Wendell W. Haney, P.E.
FL No. 54158
February 20, 2006

Silverline
BUILDING PRODUCTS CORP.

1 SILVERLINE DRIVE NORTH BRUNSWICK, NJ 08902 PH. 732.435.1000

2900 SERIES, MODEL 2900 EXTRUDED VINYL SINGLE HUNG WINDOW

GENERAL NOTES

1. THIS PRODUCT HAS BEEN EVALUATED AND IS IN COMPLIANCE WITH THE 2004 FLORIDA BUILDING CODE EXCLUDING THE "HIGH VELOCITY HURRICANE ZONE".
2. PRODUCT ANCHORS SHALL BE AS LISTED AND SPACED AS SHOWN ON DETAILS. ANCHOR EMBEDMENT TO BASE MATERIAL SHALL BE BEYOND WALL DRESSING OR STUCCO.
3. WHEN USED IN AREAS REQUIRING WIND-BORNE DEBRIS PROTECTION THIS PRODUCT IS REQUIRED TO BE PROTECTED WITH AN IMPACT RESISTANT COVERING THAT COMPLES WITH SECTION 1609.1.4 OF THE FLORIDA BUILDING CODE.
4. FOR 2X STUD FRAMING CONSTRUCTION, ANCHORING OF THESE UNITS SHALL BE THE SAME AS THAT SHOWN FOR 2X BUCK MASONRY CONSTRUCTION.
5. CONDITIONS NOT COVERED BY THIS DRAWING ARE SUBJECT TO FURTHER ENGINEERING ANALYSIS.

SHEET #	DESCRIPTION
1	TYPICAL ELEVATIONS, DESIGN PRESSURES & GENERAL NOTES
2	VERTICAL & HORIZONTAL CROSS SECTIONS 2X BUCK
3	VERTICAL & HORIZONTAL CROSS SECTIONS 1X BUCK
4	BUCK & WINDOW ANCHORING
5	BILL OF MATERIALS, GLAZING DETAIL & COMPONENTS

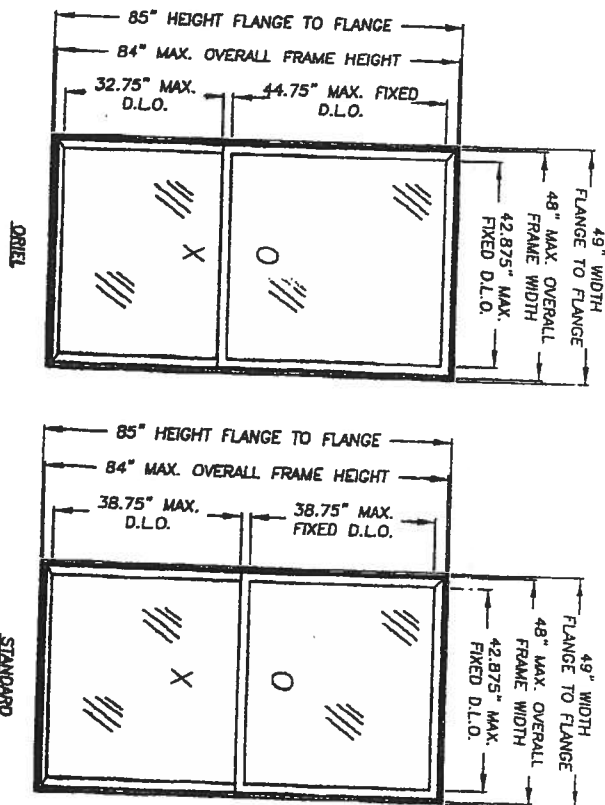

OVERALL FLANGE DIMENSION	OVERALL FRAME DIMENSION	OVERALL DAY LIGHT DIMENSION	GLASS TYPE	DESIGN PRESSURE POS.	NEG.
49.0" x 85.0"	48.0" x 84.0"	(O) 42.875" x 45.00" (X) 42.875" x 33.00" (ORIEL) 42.875" x 39.00"	1/8" ANNEALED AIR	+30.0	-30.0
45.0" x 63.0"	44.0" x 62.0"	(O) 38.875" x 28.00" (X) 38.875" x 28.00"	1/8" ANNEALED AIR	+45.0	-45.0
37.0" x 75.0"	36.0" x 74.0"	(O) 30.875" x 34.00" (X) 30.875" x 34.00"	1/8" ANNEALED AIR	+50.0	-50.0
39.0" x 61.0"	38.0" x 60.0"	(O) 32.875" x 27.00" (X) 32.875" x 27.00"	1/8" ANNEALED AIR	+50.0	-50.0

SHEET 1 OF 5 DATE: 12/27/04 SCALE: N.T.S. DWG. BY: EW CHK. BY: WWH DRAWING NO.: FL-412		PRODUCT: SILVERLINE BUILDING PRODUCTS 2900 SERIES MODEL 2900 SINGLE HUNG WINDOW PART OR ASSEMBLY: TYPICAL ELEVATIONS, DESIGN PRESSURES & GENERAL NOTES		Documents Prepared By: R.W. BUILDING CONSULTANTS, INC. P.O. Box 230 Yairco FL 33595 Phone No.: 813.859.9197 Florida Board of Professional Engineers Certificate Of Authorization No. 9812 Wendell W. Hancy, P.E. NO. 54158	
REVISIONS 1 06/05/06 REVISE 1X INSTALLATION 2 7/25/05 REVISE TO 2004 FBC		BY EW EW BY			

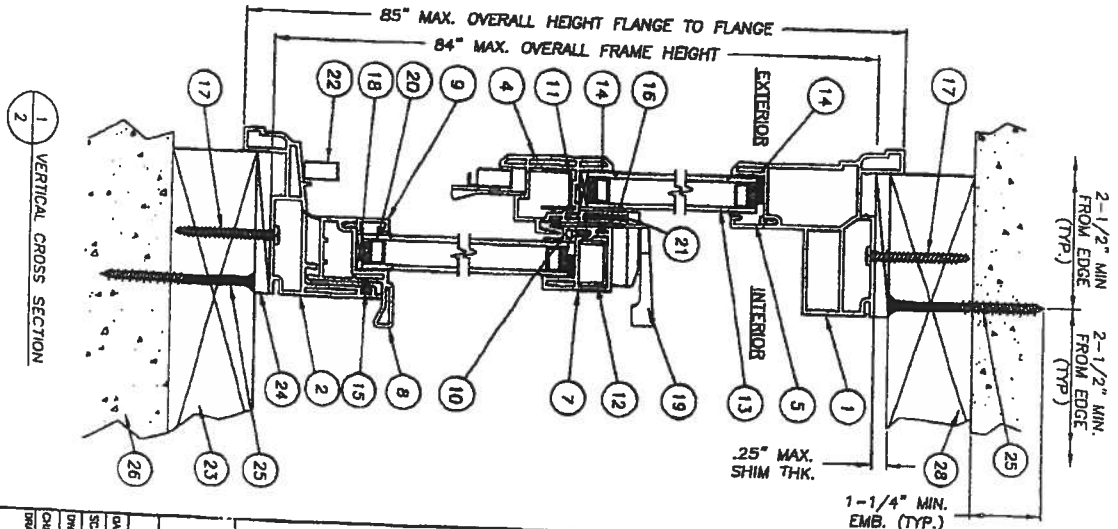
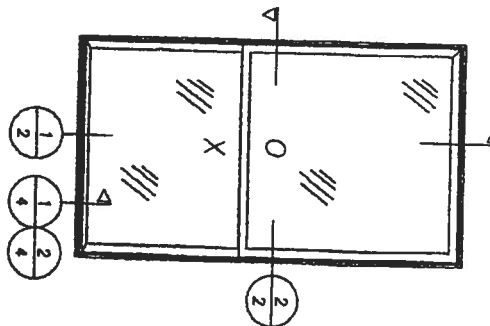
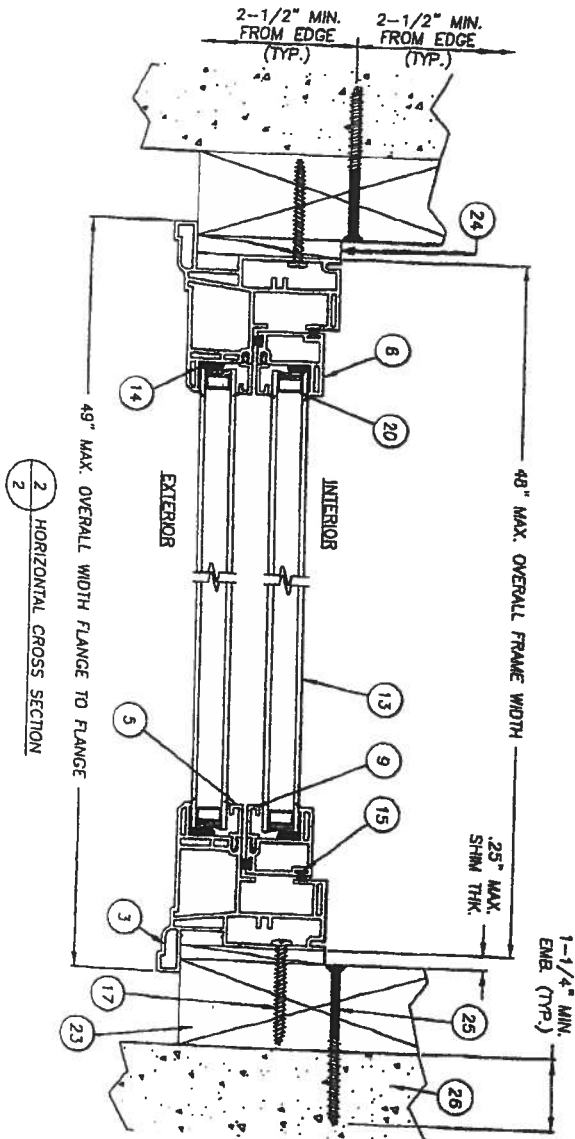

SHEET 2 OF 5		DATE 12/27/04		PRODUCT: SILVERLINE BUILDING PRODUCTS 2900 SERIES MODEL 2900 SINGLE HUNG WINDOW		Documents Prepared By: R.W. BUILDING CONSULTANTS, INC. P.O. Box 230 Valrico FL 33595 Phone No.: 813.650.8187	
SCALE: N.T.S.		2 06/05/06 REVISE 1X INSTALLATION		PART OR ASSEMBLY: VERTICAL & HORIZONTAL CROSS SECTIONS W/2X BUCK		Florida Board of Professional Engineers Certificate Of Authorization No. 9813	
CHK. BY: WWH		1 7/26/05 REVISE TO 2004 FBC		BY: EW		6-21-06	
DRAWING NO.: FL-412		NOI DATE		BY: EW		Wendell W. Haney, P.E. No. 54158	
		REVISIONS					

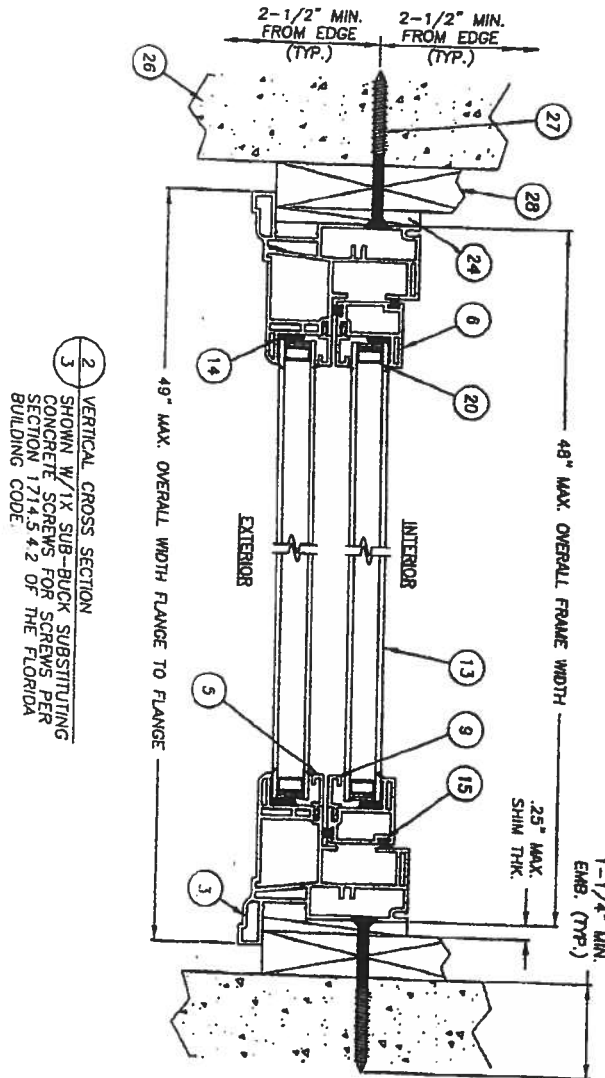

2 VERTICAL CROSS SECTION
3 SHOWN W/1X SUB-BUCK SUBSTITUTING
CONCRETE SCREWS FOR SCREWS PER
SECTION 1714.5.4.2 OF THE FLORIDA
BUILDING CODE.

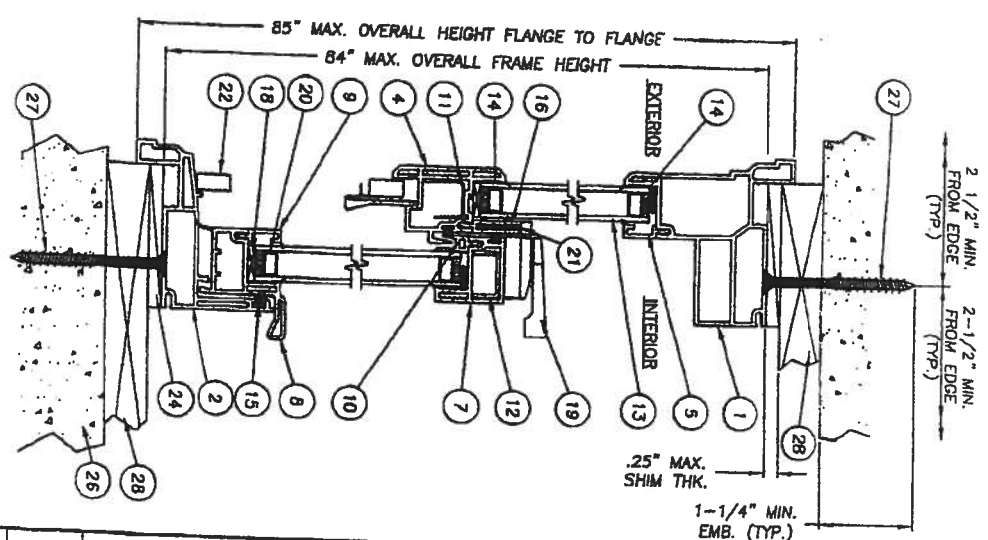
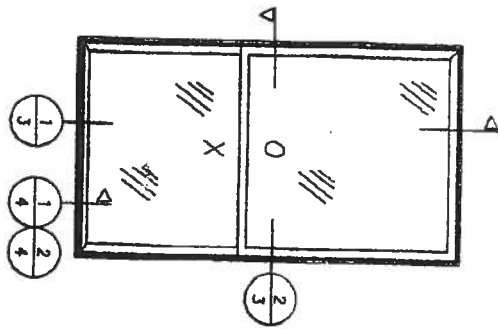

1 VERTICAL CROSS SECTION
3 SHOWN W/1X SUB-BUCK SUBSTITUTING
CONCRETE SCREWS FOR SCREWS PER
SECTION 1714.5.4.2 OF THE FLORIDA
BUILDING CODE.

SHEET 3 OF 5		DATE 12/27/04		SCALE: N.T.S.		DWG. BY: EW		CHK. BY: WHH		DRAWING NO.: FL-412	
NO.		DATE		REVISIONS		BY		BY		BY	
2		08/05/08		REVISE 1X INSTALLATION		EW		EW		EW	
1		7/26/05		REVISE TO 2004 FBC		EW		EW		EW	

PRODUCT:
SILVERLINE BUILDING PRODUCTS
2900 SERIES MODEL 2900
SINGLE HUNG WINDOW

PART OR ASSEMBLY:
VERTICAL & HORIZONTAL
CROSS SECTIONS W/1X BUCK

Documents Prepared By:
R.W. BUILDING CONSULTANTS, INC.
P.O. Box 230 Valrico FL 33595
Phone No.: 813.859.5197
Florida Board of Professional Engineers
Certificate Of Authorization No. 9813
Wendell W. Haney, P.E. No. 54158

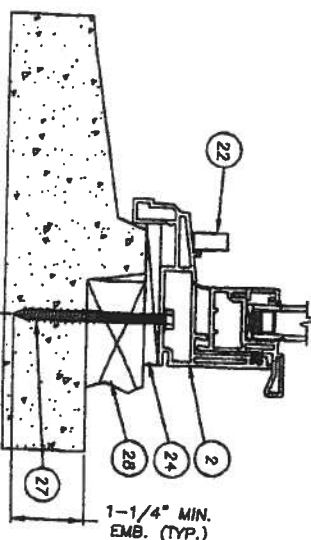
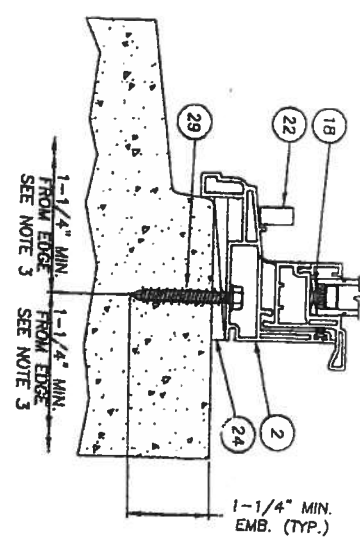
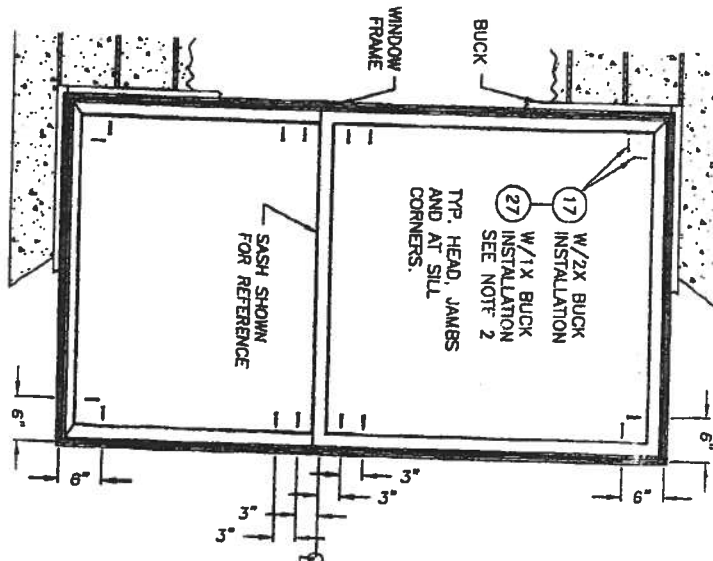
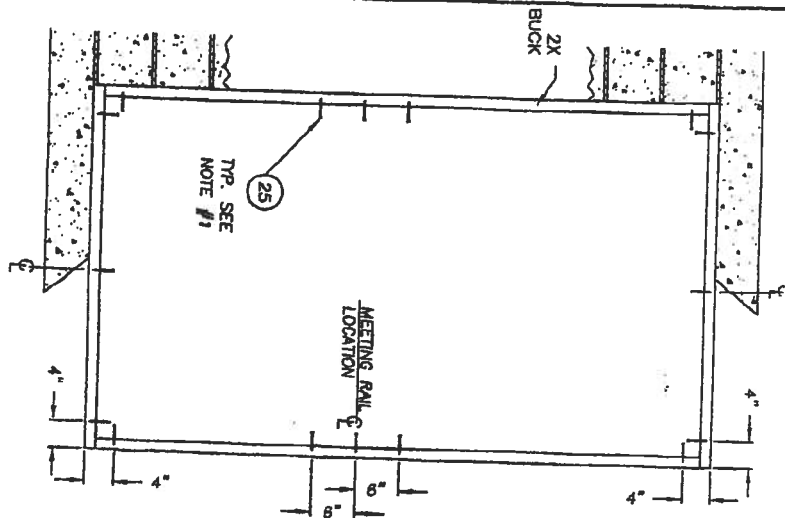

NOTES:

1. 3/16" TAPCONS REQUIRE A MINIMUM 2" CLEARANCE TO MASONRY EDGES AND A MINIMUM 2-1/4" CLEARANCE TO ADJACENT TAPCONS.
2. 1/4" TAPCONS REQUIRE A MINIMUM 2-1/2" CLEARANCE TO MASONRY EDGES AND A MINIMUM 3" CLEARANCE TO ADJACENT TAPCONS.
3. FOR THE MASONRY SILLS SHOWN IN SECTIONS 1 AND 2 THE 1/4" TAPCON ANCHORING CAPACITY HAS BEEN DE-RATED FOR A 1-1/4" EDGE DISTANCE.

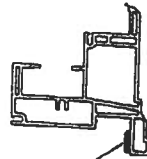

APPLY A GENEROUS BEAD OF COMMERCIAL GRADE CONSTRUCTION ADHESIVE TO THE BACK OF THE FLANGE AROUND THE FULL PERIMETER AS SHOWN.

1-1/4" MIN. FROM EDGE
SEE NOTE 3
1-1/4" MIN. FROM EDGE
SEE NOTE 3
2 SECTION 1 OPTIONAL
4 MASONRY SILL

1-1/4" MIN. FROM EDGE
SEE NOTE 3
1-1/4" MIN. FROM EDGE
SEE NOTE 3
1 SECTION 2 OPTIONAL
4 MASONRY SILL

<p>DATE: 12/27/04 SCALE: N.T.S. OWN. BY: EW CHK. BY: WWH DRAWING NO.: FL-412 SHEET 4 OF 5</p>				<p>PRODUCT: SILVERLINE BUILDING PRODUCTS 2900 SERIES MODEL 2900 SINGLE HUNG WINDOW PART OR ASSEMBLY: BUCK & WINDOW ANCHORING</p>				<p>Documents Prepared By: RW BUILDING CONSULTANTS, INC. P.O. Box 230 Valrico FL 33695 Phone No.: 813.858.9197 Florida Board of Professional Engineers Certificate Of Authorization No. 9813 Wendall W. Haney, P.E. NO. 54158</p>			
<p>REVISIONS</p>				<p>BY: EW BY: EW BY: EW</p>				<p>6-21-06</p>			
<p>2 06/05/06 REVISE 1X INSTALLATION</p>				<p>1 7/26/05 REVISE TO 2004 FBC</p>				<p>NO DATE</p>			

PRODUCT:
SILVERLINE BUILDING PRODUCTS
2900 SERIES MODEL 2900
SINGLE HUNG WINDOW

PART OR ASSEMBLY:
BILL OF MATERIAL, GLAZING
DETAIL & COMPONENTS

RW BUILDING CONSULTANTS, INC.
P.O. Box 230 Vero Beach FL 33595
Phone No.: 813.858.9197
Fla. Board of Professional Engineers
Certificate of Authorization No. 8813

Florida Board of Professional Engineers
Certificate of Authorization No. 8813
Wendell W. Haney 6-2
Wendell W. Haney, P.E. No. 54158

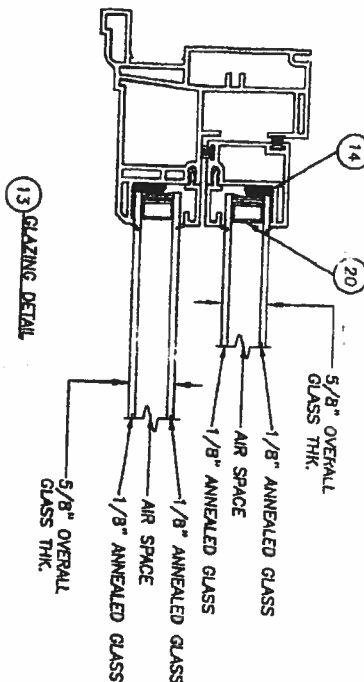

R W B C

R W Building Consultants, Inc.

Consulting and Engineering Services for the Building Industry

P.O. Box 230 Valrico, FL 33595 Phone 813.659.9197 Facsimile 813.754.9989

Florida Board of Professional Engineers Certificate of Authorization No. 9813

Product Evaluation Report

Report No.: FL 4065.1 R2
Date: June 6, 2006
Product Category: Windows
Product sub-category: Single Hung
Product Name: 2900 Series - Model 2900
Extruded Vinyl Single Hung Window
Manufacturer: Silverline Building Products Corporation
One Silverline Drive
North Brunswick, NJ 08902
Phone - 732.435.1000 Facsimile - 732.247.6820

Scope: This is a Product Evaluation report issued by R W Building Consultants, Inc. and Wendell W. Haney, P.E. (System ID # 1993) for Silverline Building Products based on Rule Chapter No. 9B-72.070, Method 1d of the State of Florida Product Approval, Department of Community Affairs-Florida Building Commission.

RW Building Consultants and Wendell W. Haney, P.E. do not have nor will acquire financial interest in the company manufacturing or distributing the product or in any other entity involved in the approval process of the product named herein.

This product has been evaluated for use in locations adhering to the Florida Building Code (2004 Edition) and where pressure requirements, as determined by Chapter 16 of The Florida Building Code, do not exceed the following design pressures:

Design Pressure Rating:

Maximum Design Pressure Rating Positive 50.0 PSF Negative 50.0 PSF
(See Limitations for size restrictions)

See Drawing No.: FL 412 prepared by R W Building Consultants, Inc. and signed and sealed by Wendell W. Haney, P.E. (FL # 54158) for specific use parameters.

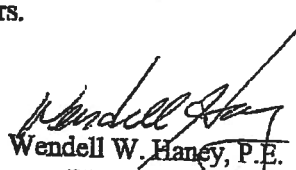

Wendell W. Haney, P.E.
FL No. 54158
June 6, 2006

Limitations

1. The Series 2900 – Model 2900 Extruded Vinyl Single Hung Window has been evaluated and meets the requirements for use within the State of Florida excluding the "High Velocity Hurricane Zone".
2. When used in areas requiring wind-borne debris protection this product is required to be protected with an impact resistant covering that complies with Section 1609.1.4 of the Florida Building Code.
3. Size Limitations:

<u>Configurations</u>	<u>MAX. Width</u>	<u>MAX. Height</u>
Single X	49.0"	85.0"

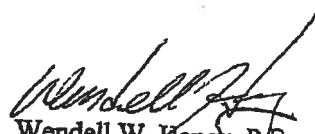
4. See Drawing # FL-412 for Design Pressure Ratings.

Wendell W. Haney, P.E.
FL No. 54158
June 6, 2006

Supporting Documents

A Drawing

1. Drawing No. FL 412 titled Series 2900 – Model 2900 Extruded Vinyl Single Hung Window prepared by R W Building Consultants, Inc. (Florida Board of Professional Engineers Certificate of Authorization No. 9813) signed and sealed by Wendell W. Haney, P.E.

B Tests Performed

1. Testing per ANSI/AAMA/NWDA 101 LS.2 – 97 as performed by Architectural Testing Inc. and reported in test report number 01-36126.01, dated November 23, 1999, signed by Benjamin E. Myers.
2. Testing per ANSI/AAMA/NWDA 101 LS.2 – 97 as performed by Architectural Testing Inc. and reported in test report number 01-34805.01, dated March 8, 1999, signed by Bruce W. Croak.
3. Testing per ANSI/AAMA/NWDA 101 LS.2 – 97 as performed by Architectural Testing Inc. and reported in test report number 01-43155.01, dated January 6, 2003, signed by Joseph A. Reed, P.E.
4. Plastics testing (Extrusion) in accordance with the “High Velocity Hurricane Zone” substantiated by Issuance of Miami-Dade Notice of Acceptance 03-1110.03, expiring August 15, 2007.

C Calculations

1. Product anchor analysis for loading conditions, prepared, signed, and sealed by Wendell W. Haney, P.E. and reported in test report numbers ATI 001-36126.01, ATI 01-34805.01 and ATI 01-43155.01.
2. Buck anchor analysis for loading conditions, prepared, signed and sealed by Wendell W. Haney, P.E.
3. Glass Load Resistance Report ASTM E1300-02 prepared by Wendell W. Haney, P.E.

D Other

1. Certificate of Participation issued by National Accreditation & Management Institute, Inc., certifying that Silverline Building Products Corporation is manufacturing products within a quality assurance program.

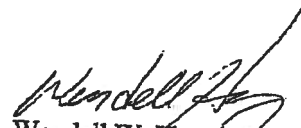
Wendell W. Haney, P.E.
FL No. 54158
June 6, 2006



NAN YA PLASTICS CORP. PLASTPRO INC.

9 PEACH TREE HILL ROAD
LIVINGSTON, NEW JERSEY 07039
PH: 800-779-0561 FAX: 973-758-4001

DISTINCTION SERIES 3'0" x 6'8" OPAQUE FIBERGLASS DOOR WITH SIDELITES INSWING / OUTSWING

GENERAL NOTES

1. THIS PRODUCT HAS BEEN EVALUATED AND IS IN COMPLIANCE WITH THE FLORIDA BUILDING CODE EXCLUDING THE HIGH VELOCITY HURRICANE ZONE.
2. PRODUCT ANCHORS SHALL BE AS LISTED AND SPACED AS SHOWN ON WALL DRESSING OR STUCCO.
3. WHEN USED IN WIND-BORNE DEBRIS REGIONS THE OPAQUE DOOR PANEL COMPLIES WITH SECTION 1609.1.4 OF THE FLORIDA BUILDING CODE AS AN IMPACT RESISTANT PRODUCT AND DOES NOT REQUIRE THE USE OF AN EXTERNAL IMPACT RESISTANT COVERING. THE SIDELITE COMPLIES WITH SECTION 1609.1.4. THIS PRODUCT DOES NOT MEET THE REQUIREMENTS FOR ENHANCED PROTECTION OF ESSENTIAL FACILITIES AS DEFINED IN ASTM E1996.
4. FOR 2X STUD FRAMING CONSTRUCTION, ANCHORING OF THESE UNITS SHALL BE THE SAME AS THAT SHOWN FOR 2X BRICK MASONRY CONSTRUCTION.
5. CONDITIONS NOT COVERED BY THIS DRAWING ARE SUBJECT TO FURTHER ENGINEERING ANALYSIS.

SHEET #	DESCRIPTION
1	TYPICAL ELEVATION, DESIGN PRESSURES & GENERAL NOTES
2	HORIZONTAL & VERTICAL CROSS SECTIONS
3	VERTICAL CROSS SECTIONS
4	BUCK & FRAME ANCHORING
5	BILL OF MATERIALS, GLAZING DETAIL & COMPONENTS

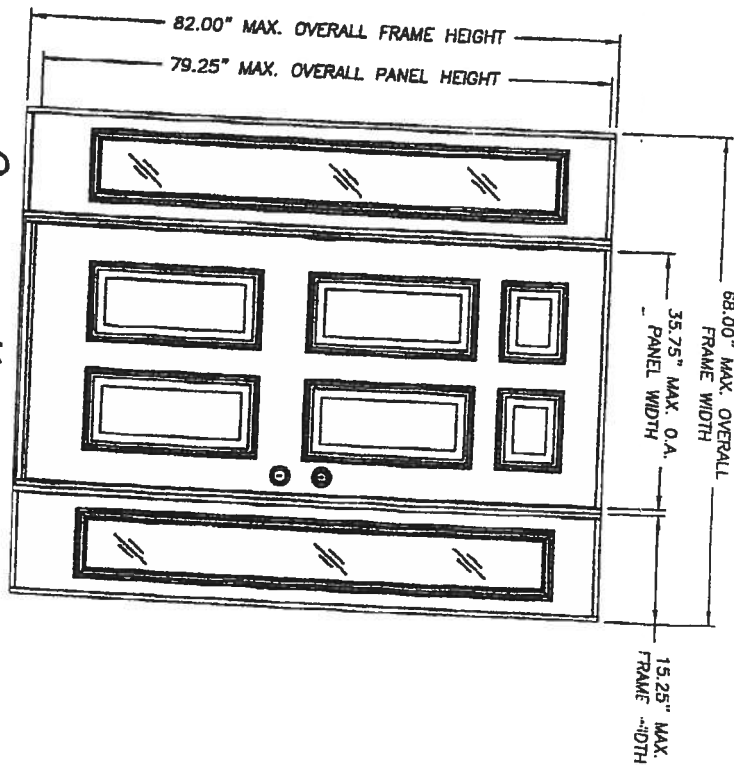

TYPE	OVERALL FRAME DIMENSION	SIDELITE DAYLIGHT DIMENSION	GLASS TYPE	DESIGN PRESSURE (PSF)
INSWING	68.00\" x 82.00\"	7.00\" x 63.00\"	1/8\" TEMP.	+47.0
OUTSWING	80.37\" x 82.00\"	7.00\" x 63.00\"	1/8\" TEMP	-47.0

SINGLE OPAQUE DOOR WITH SIDELITES

DATE 01/13/06	SCALE N.T.S.	DRW. BY EW	CHK. BY WHH	DRAWING NO. FL-826
SHEET 1 OF 5				
PRODUCT: DISTINCTION SERIES 3'0\" x 6'8\" OPAQUE FIBERGLASS DOOR W/SIDELITES IN/OUTSWING		Documents Prepared By: BUILDING CONSULTANTS, INC. P.O. Box 230 Valrico FL 33595 Phone No.: 813.629.9197		
PART OR ASSEMBLY: TYPICAL ELEVATION, DESIGN PRESSURES & GENERAL NOTES		Florida Board of Professional Engineers Certificate of Authorization No. 6813		
REVISIONS		Wendell W. Henry, P.E. No. 54158		

1 HORIZONTAL CROSS SECTION
2 INSWING CONFIGURATION

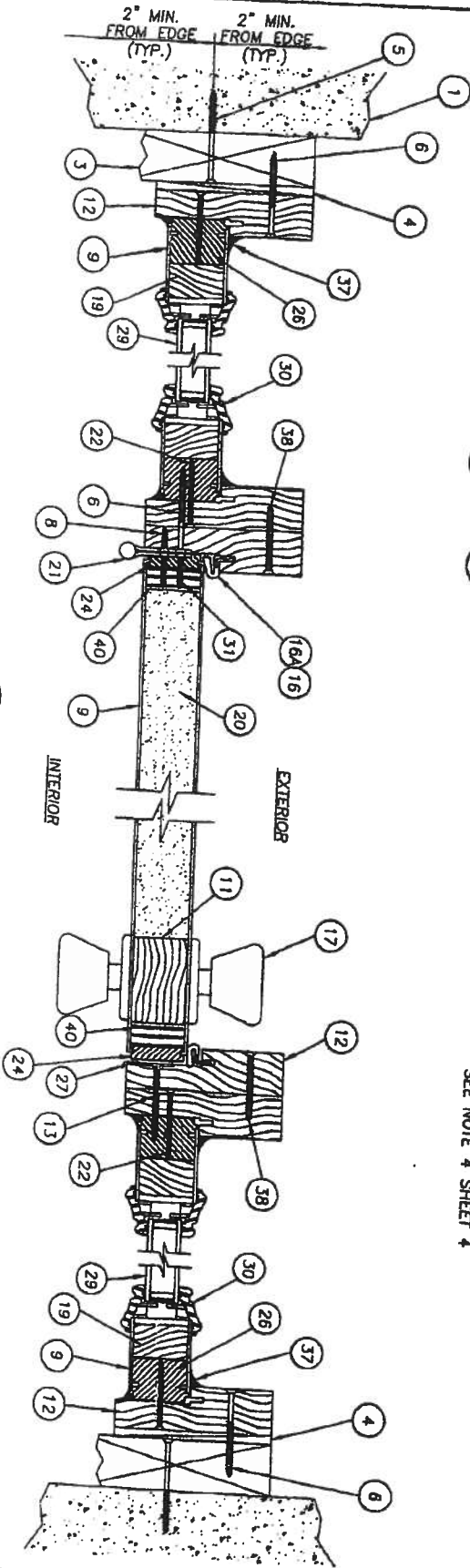

2 VERTICAL CROSS SECTION
SHOWN W/1X SUB-BLOCK
SEE NOTE 4 SHEET 4

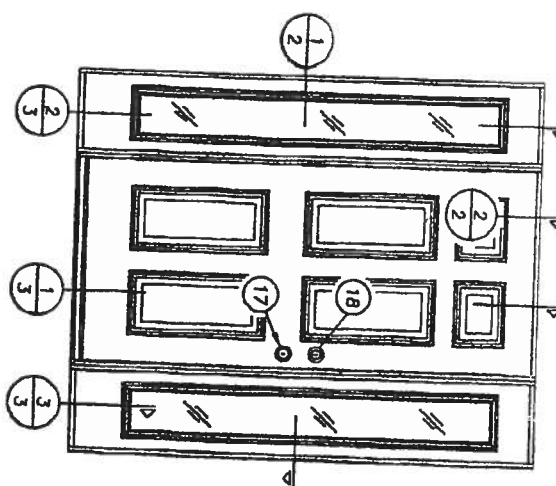
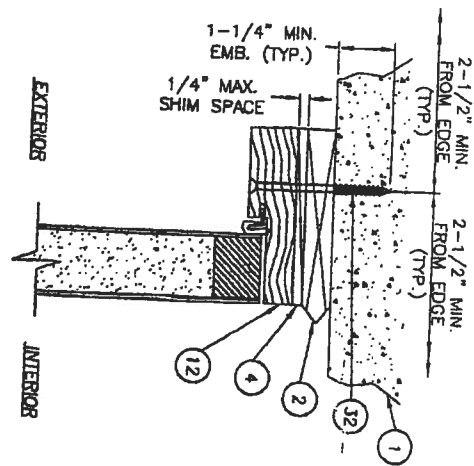

DATE: 01/13/06		SCALE: N.T.S.		DWG. BY: E/W		CHK. BY: WWH		DRAWING NO.: FL-826		SHEET 2 OF 5	
<p>PRODUCT: DISTINCTION SERIES 3'0" x 8'0" OPAQUE FIBERGLASS DOOR W/SIDELITES IN/OUTSWING</p> <p>PART OR ASSEMBLY: HORIZONTAL & VERTICAL CROSS SECTIONS</p> <p>Documents Prepared By: BUILDING CONSULTANTS, INC. P.O. Box 230 Valrico FL 33595 Phone No.: 813.659.9197 Florida Board of Professional Engineers Certificate Of Authorization No. 9813 Wendell W. Money, P.E. No. 54158</p>											

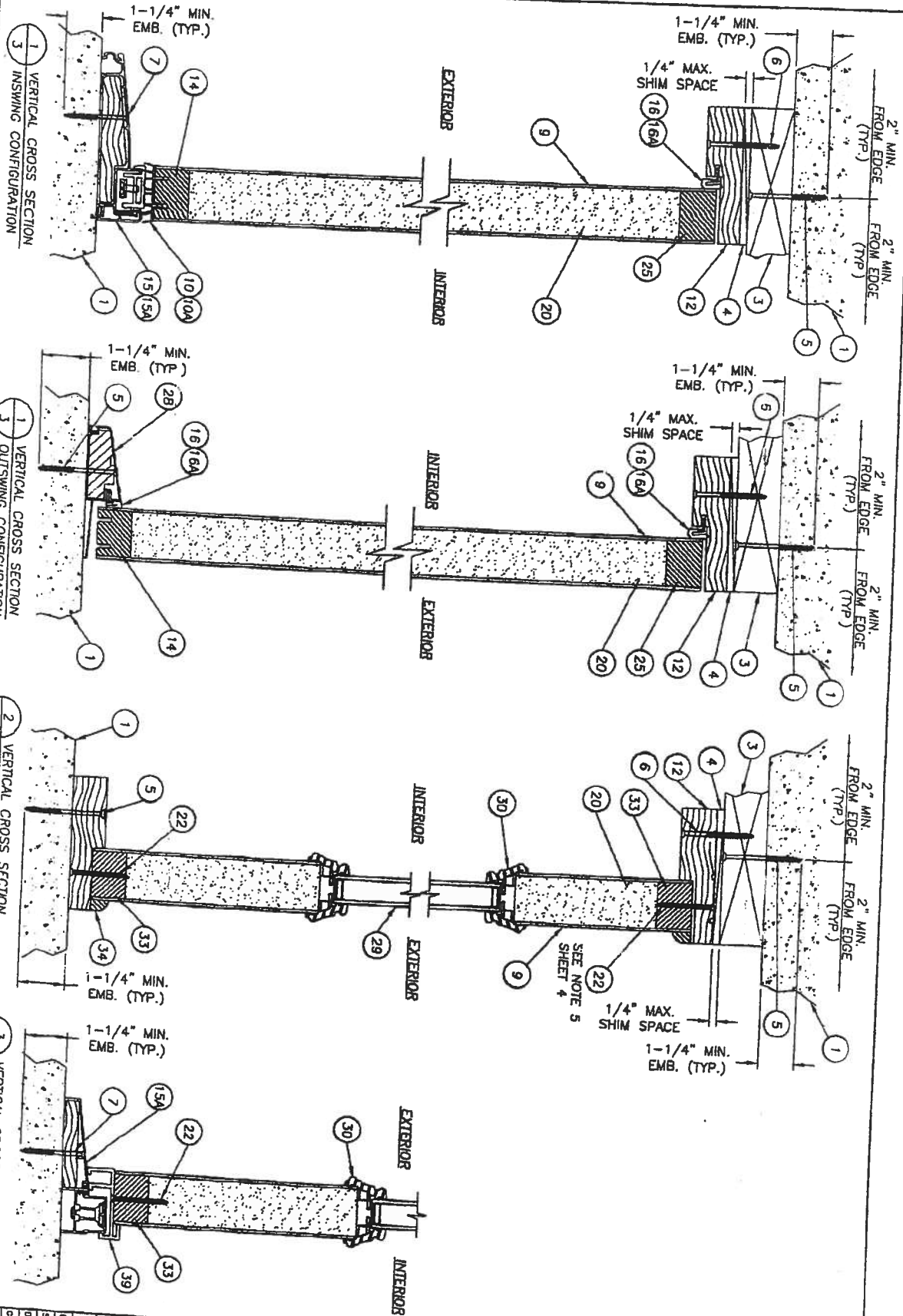

SHEET 3 OF 5		DATE 01/13/06		SCALE: N.T.S.		DWG. BY: E.W.		CHK. BY: W.W.H.		DRAWING NO.: FL-826	
NO.		DATE		BY		REVISIONS		PRODUCT:		Documents Prepared By:	
								DISTINCTION SERIES		BUILDING CONSULTANTS, INC.	
								3'0" x 6'8" OPAQUE FIBERGLASS		P.O. Box 230 Vero Beach, FL 33595	
								DOOR W/ SIDELITES IN/OUTSWING		Phone No.: 813.688.9187	
								PART OR ASSEMBLY:		Florida Board of Professional Engineers	
								VERTICAL CROSS SECTIONS		Certificate Of Authorization No. 9813	
										2-23-06	
										Wendell W. Hickey, P.E. No. 54158	

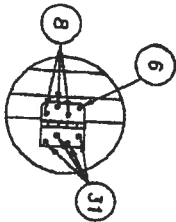
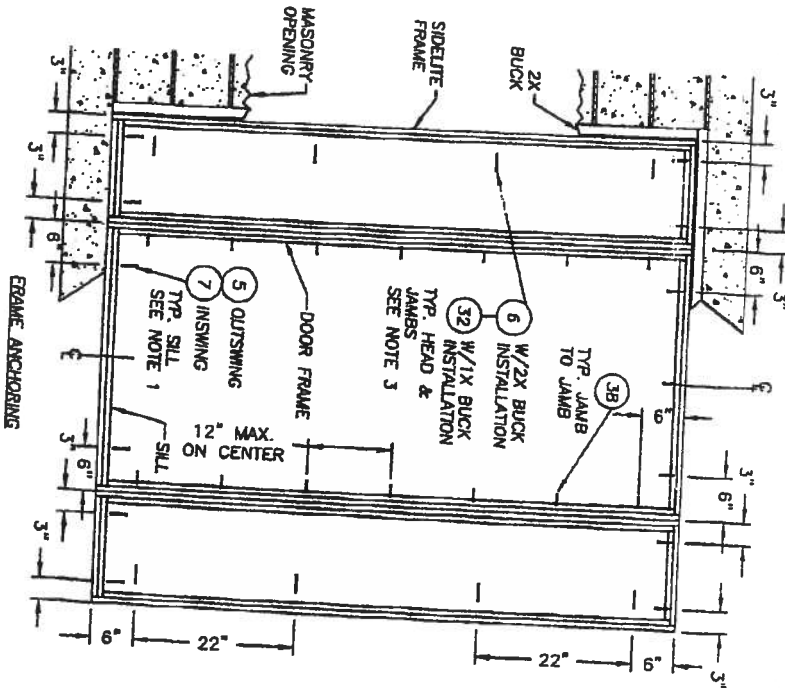
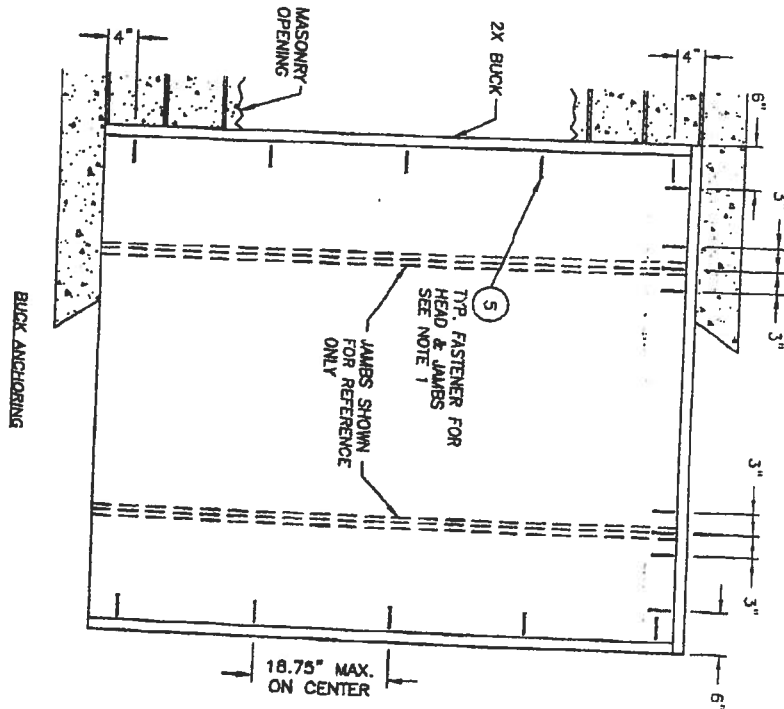

HINGE DETAIL

HINGES (3) LOCATED @ 8.46, 40.71" AND 71.965" FROM TOP OF FRAME TO CENTER LINE OF HINGE.

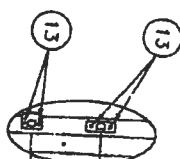

STRIKE PLATE DETAIL

5.75" 39.125" FROM TOP OF FRAME

- NOTES:
1. 3/16" TAPCONS REQUIRE A MINIMUM 2" CLEARANCE TO MASONRY EDGES AND A MINIMUM 2-1/4" CLEARANCE TO ADJACENT TAPCONS.
 2. 1/4" TAPCONS REQUIRE A MINIMUM 2-1/2" CLEARANCE TO MASONRY EDGES AND A MINIMUM 3" CLEARANCE TO ADJACENT TAPCONS.
 3. WHEN ANCHORING DOOR FRAME UTILIZING A 1X BUCK THEN ITEM #6 IS SUBSTITUTED WITH ITEM #32 (1/4" X 3-3/4" ELCO ANCHOR), THE QUANTITY AND SPACING OF ANCHORS DOES NOT CHANGE. SEE NOTE 2.
 4. PER FBC SECTION 1714.5.4.2 FOR SUB-BUCKS LESS THAN 1-1/2" THICK, THE WINDOW SHALL BE ANCHORED THROUGH THE MAIN FRAME DIRECTLY INTO THE MASONRY. TAPCONS ARE SUBSTITUTED FOR THE ANCHORS.
 5. SIDELITE PANEL SECURED TO THE SIDELITE FRAME WITH (4) OF ITEM #22 LOCATED 10", 30.5", 51" AND 71.5" FROM THE TOP OF EACH JAMB AND (2) OF ITEM #22 IN THE HEAD & SILL 3" FROM EACH END.

<p>PRODUCT: DISTINCTION SERIES 3'0" x 6'8" OPAQUE FIBERGLASS DOOR W/SIDELITES IN/OUTSWING</p> <p>PART OR ASSEMBLY: BUCK & FRAME ANCHORING</p>		<p>Documents Prepared By: R.W. BUILDING CONSULTANTS, INC. P.O. Box 230 Valrico FL 33595 Phone No.: 813.659.0197</p> <p>Florida Board of Professional Engineers Certificate Of Authorization No. 9813</p> <p>Wendell W. Haney, P.E. No. 54158</p>	
DATE: 01/13/06	SCALE: N.T.S.	DATE: 01/13/06	SCALE: N.T.S.
CHK. BY: WWH	DATE: 01/13/06	CHK. BY: WWH	DATE: 01/13/06
DRAWING NO.: FL-026		DRAWING NO.: FL-026	
SHEET 4 OF 5		SHEET 4 OF 5	

ITEM	DESCRIPTION	MATERIAL
1	MASONRY	CONC.
2	1X BRICK	WOOD
3	2X BRICK	WOOD
4	SIM 1/4" MAX THK.	WOOD
5	3/16" x 2-1/4" TAPCON	WOOD
6	1/10" x 2-1/2" PH WOOD SCREW	STEEL
7	3/16" x 2-1/4" TAPCON	STEEL
8	1/10" x 2-1/2" PH WOOD SCREW	STEEL
9	DOOR SINK (MIN. 0.075" THICK)	STEEL
10	INSWING WNTL DOOR BOTTOM SWEEP BY ENDURA	FIBERGLASS
10A	WNTL DOOR BOTTOM SWEEP #3628 BY HOLM INC.	WNTL
11	REINFORCEMENT WOOD FOR LOCKS	WOOD
12	FRAMER JOINTED FINE FRAME, HEAD & HINGE JAMBS	WOOD
13	1/8" x 2-1/4" PHILLIPS FLAT HEAD WOOD SCREW	STEEL
14	DOOR BOTTOM RAIL	STEEL
15	INSWING ADJUSTABLE THRESHOLD BY ENDURA	FOAM PVC
15A	INSWING ADJUSTABLE ALUMINUM THRESHOLD BY DUP	AL/WOOD
16	FORCE 5 WEATHER STRIPPING BY ENDURA	FOAM
16A	COMPRESSION WEATHER STRIP ALON 650 BY SCHLITZ	FOAM
17	KWIKSET RETED ENTRY GRADE 2	STEEL
18	KWIKSET DEADBOLT GRADE 2	STEEL
19	CONTINUOUS SIDELITE STILE REINF.	WOOD
20	POLYURETHANE FOAM BY NAPA	FOAM
21	4" x 4" BUTT HINGE	STEEL
22	1/8" x 2" PH WOOD SCREW	STEEL
23	NOT USED	-
24	HINGE & LATCH STILE	FOAM PVC
25	DOOR TOP RAIL	FOAM PVC
26	SIDELITE STILE	FOAM PVC
27	STRIKE PLATE	STEEL
28	OUTSWING BLAMP THRESHOLD	ALUM.
29	1" THICK INSTALLED GLASS	GLASS
30	SWAP IN LIFE FRAME	GLASS
31	1/8" x 1" PH WOOD SCREW	ABS
32	1/4" x 3-1/4" TAPCON	STEEL
33	SIDELITE TOP & BOTTOM RAIL	STEEL
34	SHOE MOLD 5/8" x 3/8"	FOAM PVC
35	GLAZING COMPOUND	WOOD
36	NOT USED	SILICONE
37	SEALANT	-
38	1/10" x 2" SCREW	SILICONE
39	SIDELITE SPACER	STEEL
40	HINGE & LATCH STILE REINFORCEMENT DOOR	PVC

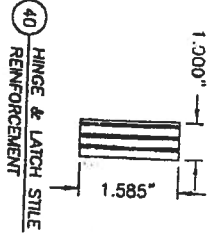
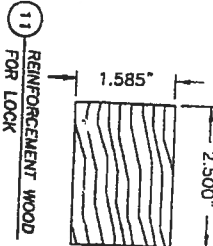
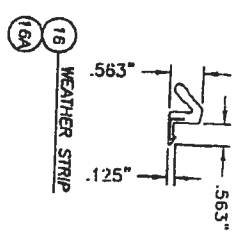
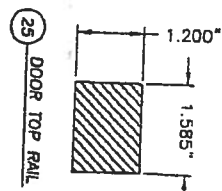
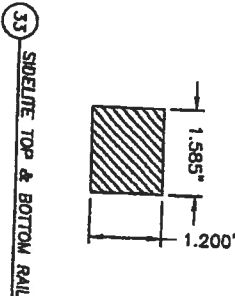
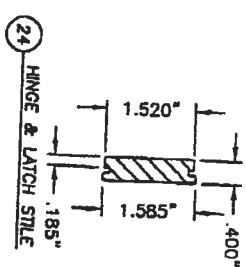
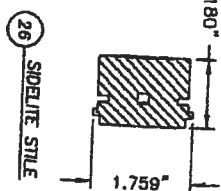
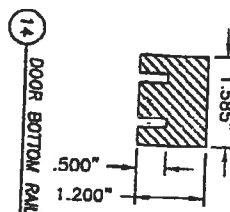
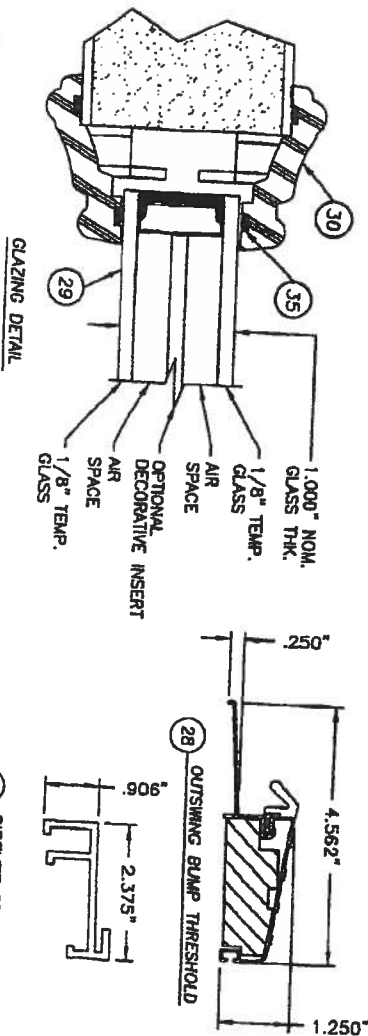
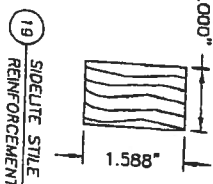
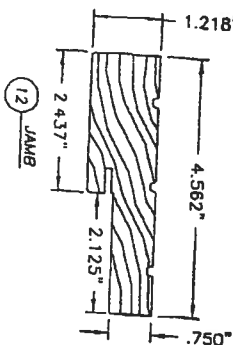
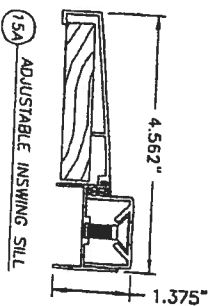
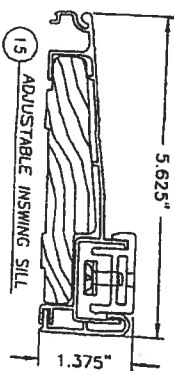

DATE: 01/13/06		SCALE: N.T.S.		DWG. BY: EW		CHK. BY: WWH		DRAWING NO.: FL-826		SHEET: 5 OF 5	
PRODUCT: DISTINCTION SERIES 3'0" x 6'0" STAINLESS STEEL FIBERGLASS DOOR W/SIDELITE IN/OUTSWING PART OR ASSEMBLY: BILL OF MATERIALS, GLAZING DETAIL & COMPONENTS											
Documents Prepared By: R.W. BUILDING CONSULTANTS, INC. P.O. Box 230 Valrico FL 33595 Phone No.: 813.659.5197 Florida Board of Professional Engineers Certificate Of Authorization No. 9813 Wendell W. Henry, P.E. No. 54158											

R W B C

R W Building Consultants, Inc.

Consulting and Engineering Services for the Building Industry

P.O. Box 230 Valrico, FL 33595 Phone 813.659.9197 Facsimile 813.754.9989

Florida Board of Professional Engineers Certificate of Authorization No. 9813

Product Evaluation Report

Report No.: FL 6184.4
Date: February 20, 2006
Product Category: Exterior Doors
Product sub-category: Swinging Exterior Door Assemblies
Product Name: Distinction Series 3'0" x 6'8" Opaque Fiberglass Door
With Sidelites Inswing / Outswing
Manufacturer: Nan Ya Plastics Corporation
Plastpro Inc.
9 Peach Tree Hill Road
Livingston, NJ 07039
Phone: 800-779-0561 Facsimile: 973-758-4001

Scope: This is a Product Evaluation report issued by R W Building Consultants, Inc. and Wendell W. Haney, P.E. (System ID # 1993) for Nan Ya Plastics Corporation, Plastpro Inc. based on Rule Chapter No. 9B-72.070, Method 1d of the State of Florida Product Approval, Department of Community Affairs-Florida Building Commission.

RW Building Consultants and Wendell W. Haney, P.E. do not have nor will acquire financial interest in the company manufacturing or distributing the product or in any other entity involved in the approval process of the product named herein.

This product has been evaluated for use in locations adhering to the Florida Building Code (2004 Edition) and where pressure requirements, as determined by Chapter 16 of The Florida Building Code, do not exceed the following design pressures:

Design Pressure Rating:

Maximum Design Pressure Rating Positive 47.0 PSF Negative 47.0 PSF
(See Limitations for size restrictions)

See Drawing No.: FL 826 prepared by R W Building Consultants, Inc. and signed and sealed by Wendell W. Haney, P.E. (FL # 54158) for specific use parameters.

Wendell W. Haney, P.E.
FL No. 54158
February 20, 2006

Limitations

1. The Distinction Series 3'0" x 6'8" Opaque Fiberglass Door with Sidelites Inswing / Outswing has been evaluated and meets the requirements for use within the State of Florida excluding the "High Velocity Hurricane Zone".
2. When used in wind-borne debris regions The Opaque Door Panel complies with Section 1609.1.4 of the Florida Building Code as an Impact resistant product and does not require the use of an external impact resistant covering; The Sidelites must be protected with an impact resistant covering that complies with section 1609.1.4. This product does not meet the requirements for enhanced protection of essential facilities as defined in ASTM E1996.
3. This product is intended for use where Section R 314.2.4 of the Florida Building Code is applicable.
4. Size Limitations:

<u>Configurations</u>		<u>MAX. Width</u>	<u>MAX. Height</u>
Single with Sidelites	OXO	68.0"	82.0"
5. See Drawing # FL 826 for Design Pressure Ratings.

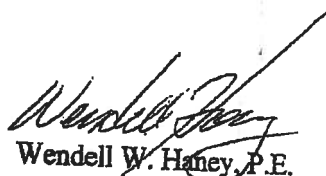
Wendell W. Haney, P.E.
FL No. 54158
February 20, 2006

Supporting Documents

A Drawing
1. Drawing No. FL 826 titled Distinction Series 3'0" x 6'8" Opaque Fiberglass Door with Sidelites Inswing / Outswing prepared by R W Building Consultants, Inc. (Florida Board of Professional Engineers Certificate of Authorization No. 9813), signed and sealed by Wendell W. Haney, P.E.

B Tests Performed
1. Testing per 101/LS.2-NAFS-02 as performed by Testing Evaluation Laboratories Inc., and reported in test report number TEL 05-1126-2, dated January 15, 2006, and signed and sealed by Wendell W. Haney, P.E.
2. Testing per 101/LS.2-97 as performed by Certified Testing Laboratories, and reported in test report number CTLA 900 W3-10, dated January 7, 2006 and signed and sealed by Ramesh Patel, P.E.
3. Testing per ASTM E330-02, ASTM E1886/E1996, and ASTM E283-91 as performed by Testing Evaluation Laboratories Inc., and reported in test report number TEL 2004-09-24-028, dated September 30, 2004, and signed and sealed by Wendell W. Haney, P.E.

C Calculations
1. Product anchoring is in accordance with manufacturer's published recommendations as substantiated by tested specimens reported in test report numbers TEL 2004-09-24-028, TEL 05-1126-2 and CTLA 900 W3-10.
2. Buck anchor analysis for loading conditions, prepared, signed and sealed by Wendell W. Haney, P.E.
3. Glass Load Resistance Report ASTM E1300-02 prepared by Wendell W. Haney, P.E.

D Other
1. Certificate of Participation issued by National Accreditation & Management Institute, Inc., certifying that Nan Ya Plastics Corporation, Plastpro Inc is manufacturing products within a quality assurance program.

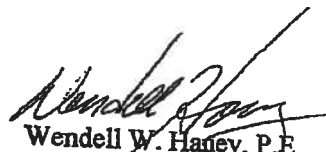
Wendell W. Haney, P.E.
FL No. 54158
February 20, 2006

PRODUCT APPROVAL SPECIFICATION SHEET

Location:

Sw Little Rd Lake city, FL 32029

Project Name:

Amin R. B. Bani

As required by Florida Statute 553.842 and Florida Administrative Code 9B-72, please provide the information and the product approval number(s) on the building components listed below if they will be utilized on the construction project for which you are applying for a building permit on or after April 1, 2004. We recommend you contact your local product supplier should you not know the product approval number for any of the applicable listed products. More information about statewide product approval can be obtained at www.floridabuilding.org

<u>Manufacturer</u>	<u>Category</u>	<u>Product Description</u>	<u>App#</u>	<u>Limits of use</u>
Owens Corning	Roofing	Asphalt Shingles	FL85	Products must be install in accordance with Florida Building Code Non High Velocity Hurricane Zone Areas. All sections of the Florida Building Code that apply to all the counties except Dade and Broward must be followed.
Owens Corning	Panel Walls	Siding	FL920	1. Vinyl siding is limited to Type VI construction, as defined below. SECTION 608 - TYPE VI CONSTRUCTION Type VI is construction in which the exterior bearing and nonbearing walls and partitions, beams, girders, trusses, arches, floors, and roofs and their supports are wholly or partly of wood or other approved materials. Type VI construction may be either protected or unprotected. Fire resistance requirements for structural elements of Type VI construction shall be as specified in Table 600. 2. Owens Corning vinyl siding systems shall not be installed within the High Velocity Hurricane Zones of the Florida Building Code or on Educational Facilities within the State of Florida. 3. Compliance is valid only if the subject profile trade name is current on the VSI Vinyl Siding Certification Program, Certified Products List. The current list can be found at www.vinylsiding.org . 4. Limitations relating to wind load performance are provided in Appendix 1. A. Unless otherwise noted, fasteners for vinyl siding are limited to min. 1½" long x 0.125" shank diameter x minimum 3/8" head diameter galvanized roofing nails. B. Unless otherwise noted nails shall engage the stud framing members. C. Use of the wind load performance worksheets is limited to wall height less than or equal to 30 feet. For elevations exceeding this limitation, design pressures shall be determined in accordance with ASCE 7-98 on a project-specific basis for comparison to wind load resistance data in accordance with ASTM D 5206 and Annex A1 of D 3679 . All

				calculations and analysis shall be completed by a Florida Registered Architect or Professional Engineer. D. Use of the wind load performance worksheets is limited to wall assemblies having either internal or external sheathing. For applications where siding is installed over open studding, the required test pressure shall be determined in accordance with ASCE 7-98 and Section A1.2.3 of ASTM D 3679. All calculations and analysis shall be completed by a Florida Registered Architect or Professional Engineer.
Owens Corning	Panel Walls	Sofit	FL2633	N / A
Owens Corning	Roofing	Cements-Adhesives	FL2276	Tested and approved for use on metal roofs, SBS modified bitumen membranes, built-up roofing and spay polyurethane foam. Not yet submitted to, nor approved by, Dade County for High Velocity Hurricane Zones (HVHZ).
Owens Corning	Roofing	Underlayment	FL1000	N / A
Atrium Window and Doors, NC	Windows	Single Hung	FL1030	(100 SH H-R25 35 X 72), (100 SH H-R25 44 X 60), (200 SH H-R30 48 X 78), (200 SH H-R35 36 X 74), (200 SHHP/OS H-R50 36 X 74), (200 SHHP/OS H-R35 48 X 84)
Silverline Windows	Windows	Single Hung	FL4065	, All Windows are to be Installed per Manufacturers Installation Drawings. Anchor Size, Type and Spacing are determined by the type of construction per Manufacturers Installation Drawings.
Therma-Tru Doors	Ext. Doors	Swinging	FL5268	All use of product is restricted to, and assembly and installation of product must conform to documentation published by Therma-Tru.
Hy-Lite Products.	Windows	Fixed	FL2025	600/800 98x98 F-C30/ 74x74 F-HC40 / 50x50 F-HC80/ 26x82 F-C80 625/825 74x74 F-C35/ 50x50 F-C80/ 26x82 F-C80 Low Profile Builders Series 77x77 F-HC40/ 52x52 F-HC70/ 31x87 F-C80 Glass Block Series Alum. 57x57 F-LC50/ Vinyl 57x57 F-LC80 Prestige Fixed Window 79x79 F-C35/ 55x55 F-C80/ 31x87 F-C80
Simpson Strong-Tie Co.	Structural Components	Wood Connector Anchors (LU26)	FL474	N / A
Simpson Strong-Tie Co.	Structural Components	Wood Connector Anchors (PHD2)	FL503	N / A
Simpson Strong-Tie Co.	Structural Components	Wood Connector Anchors (H10)	FL474	N / A
Simpson Strong-Tie Co.	Structural Components	Wood Connector Anchors (ABU66)	FL474	N / A

Simpson Strong-Tie Co.	Structural Components	Wood Connector Anchors (SP1)	FL474	N / A
Simpson Strong-Tie Co.	Structural Components	Wood Connector Anchors (SP2)	FL474	N / A
Simpson Strong-Tie Co.	Structural Components	Wood Connector Anchors (24" Flat Strap)	FL474	N / A
Trus Joist	Structural Components	Engineered Wood	FL1630	N / A
MiTeck Industries Inc.	Structural Components	Truss Plates	FL2197	N / A
James Hardi Siding	Envelope Products	Cement Fiber Siding	FL889	N / A
Atlas Roofing Corp	Roofing	Roofing Felt	FL1996	N / A
Tyvek		House Wrap	FL2145	N / A
Overhead Door Corp.	Ext. Doors	Garage Door	FL674	N / A
Royal Siding	Panel Walls	Siding	FL976	All siding shall be installed in accordance with the manufacturer's published installation instructions and ASTM D4756 Practice for the installation of Rigid Poly(Vinyl Chloride)(PVC) Siding and Soffit. Siding shall be used only on buildings where combustible exterior walls are permitted.
Royal Siding	Panel Walls	Sofit	FL976	
Clopay	Ext. Doors	Garage Door	FL542	N / A

The products listed below did not demonstrate product approval at plan review. I understand that at the time of inspection of these products, the following information must be available to the inspector on the jobsite; 1) copy of the product approval, 2) the performance characteristics which the product was tested and certified to comply with, 3) copy of the applicable manufacturers installation requirements. I understand these products may have to be removed if approval cannot be demonstrated during inspection.

Contractor or Contractor's Authorized Agent Signature

Print Name Laura Anderson

Date

Location

Permit # (FOR STAFF USE ONLY)

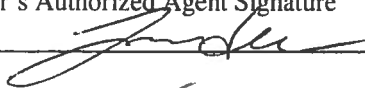
Sw Little Rd
Lake City FL
32024

9-26-07

