

REVISIONS	

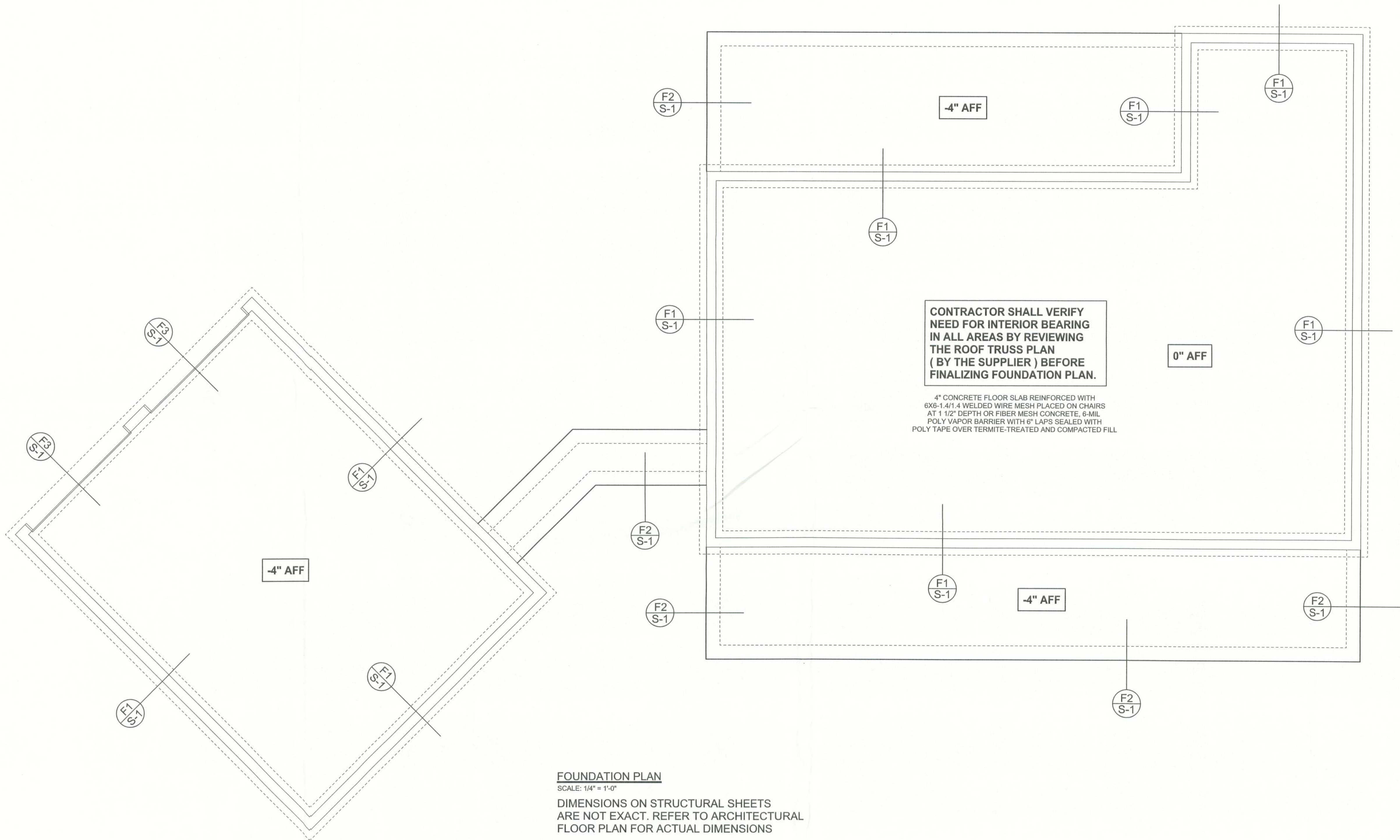

WINDLOAD ENGINEER: Mark Disosway,
PE No.53915, POB 868, Lake City, FL
32056, 386-754-5419

DIMENSIONS:
 Stated dimensions supersede scaled dimensions. Refer all questions to Mark Disosway, P.E. for resolution. Do not proceed without clarification.

COPYRIGHTS AND PROPERTY RIGHTS:
 Mark Disosway, P.E. hereby expressly reserves its common law copyrights and property right in these instruments of service. This document is not to be reproduced, altered or copied in any form or manner without first the express written permission and consent of Mark Disosway.

CERTIFICATION: These plans and "Windload Engineering", Sheet S-1, attached, comply with Florida Building Code 2004, Section 1605 wind loads, to the best of my knowledge.

LIMITATION: This design is valid for one building at specified location. In case of conflict, structural requirements, scope of work, and builder responsibilities on sheet S-1 control.

MARK DISOSWAY
P.E. 53915

Mark Disosway
17006705

SEAL

Duncan Residence

ADDRESS:
 Lot 19 Unit 2 Pine
 Wind Estates S/D
 Columbia County, Florida

Mark Disosway P.E.
 P.O. Box 868
 Lake City, Florida 32056
 Phone: (386) 754 - 5419
 Fax: (386) 269 - 4871

PRINTED DATE:
 October 16, 2005

DRAWN BY: David Disosway CHECKED BY:

FINALS DATE:
 16 / Oct / 05

JOB NUMBER:
 510112

DRAWING NUMBER
S-2
 OF 2 SHEETS