

Cool and Cobb Engineering Company

Date: 5/5/2022

Job: Lake City Chamber - Joey O'Hern

Location: 162 South Marion Ave
Lake City, FL 32025

PUSH PIER DESIGN ANALYSIS

The load requirements for the pilings designed to assist in supporting the identified areas of the subject residence were determined. The selected piling locations and the specific piling are identified on the Pier Identification and Location Plan attached. The calculated total loads on the piles in the specific location, including both dead and live loads are documented in the attached table which is designated as Attachment "A". Based on the total load requirements for each of these piles, the push pier driver is to be employed. The push pier driver should be employed with a calculated load of 23,000 lbs., which will provide pile capacity, including the 2 to 1 safety factor of 46,000 lbs. which is greater than the maximum calculated total load of 23,000 lbs. which occurs on the pile identified as no. 3. Based on this analysis, the use of the push pier driver for the ECP piles with a specific load of 46,000 lbs. and a minimum depth of 15' is approved and certified as meeting all the requirements of the Florida Building Code 2020 7th Edition, and good engineering practice. This is not to be the primary support structure, but a supplement support to assist in support of the weight of the structure, which will reduce the total pressure on the existing soils. After completion of installation, Cool and Cobb Engineering Company shall be supplied with a drilling log of the location and depths of each pile installed so they can evaluate the installation and prepare the "As Built" drawings.

General Notes:

1. A log of each pile to be kept by Contractor noting depth for each pile.
2. Piles installed less than 48" apart are to be battered 10° away from each other.
3. This design is based on the loads of the structure placed on the shallow soils under the structure.
4. No deep soils geotechnical testing information was provided for this design.
5. This design does not address any possible sink hole activity as defined in Florida Statute § 627.706.

5/5/2022

Kenneth F Wheeler, P.E.
State of Florida
Professional Engineer No. 60417



Digitally signed
by Kenneth F
Wheeler
Date: 2022.05.05
10:37:52 -04'00'

This item has been electronically sealed by Kenneth F. Wheeler using a digital signature and date. Printed copies of this document are not considered signed and sealed and the signature must be verified on any electronic copies.

203 W. Main St.
Avon Park, FL 33825
Office: (863) 657-2323
Fax: (863) 657-2324



Foundation Professionals of
Florida
P.O. Box 1625
Lake City, Florida 32056
www.foundationprosfll.com

Project Address
Joey O'Hern
162 South Marion Avenue
Lake City, FL 32025

Created By
Conner Rawlins
(386) 406-2191
01/05/2022

Repair Plan

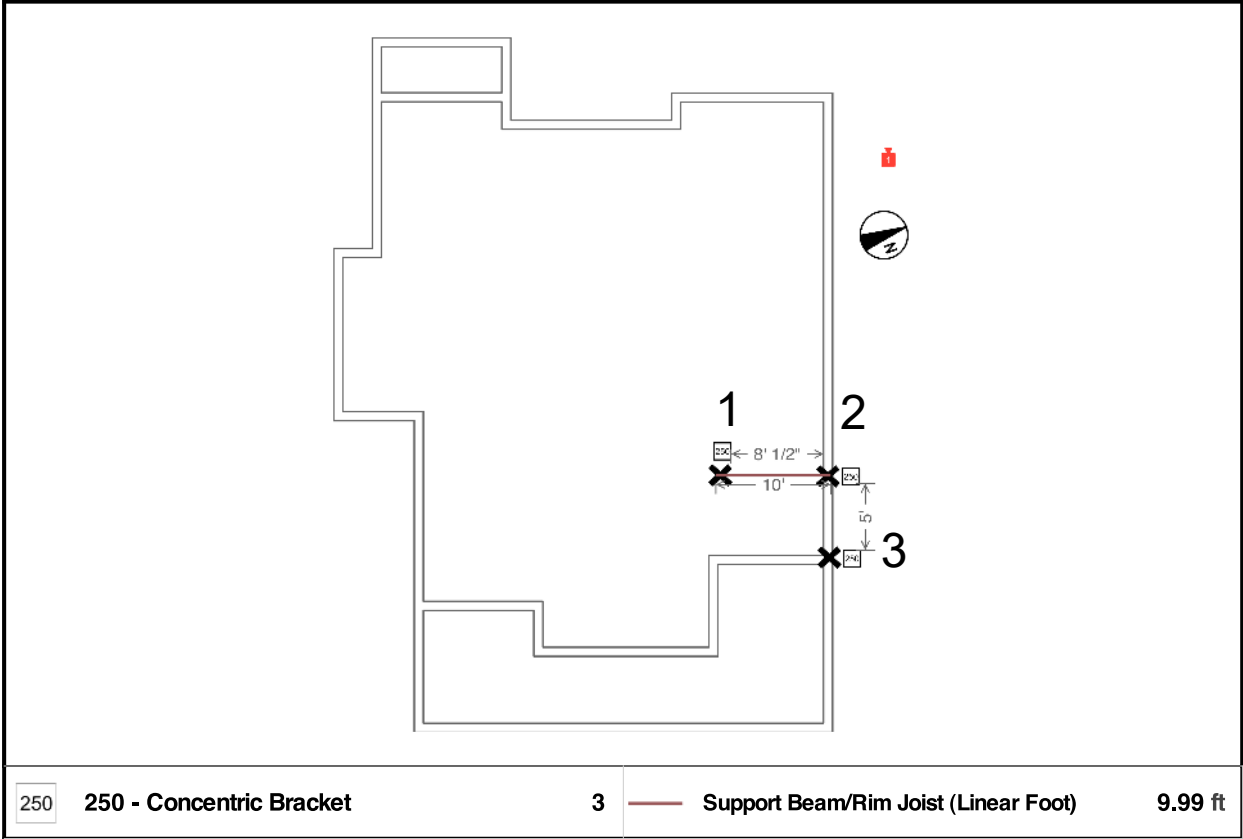

Year structure was built:
1920

Foundation Type:
Crawl Space with CMU/Brick Piers

Construction:
Wood Frame
Two - Story
Veneer:
Wood Siding



Digitally signed
by Kenneth F
Wheeler
Date: 2022.05.05
10:38:13 -04'00'

5/5/2022
Kenneth F. Wheeler, P.E.
PE# 60417

This item has been electronically sealed by Kenneth F. Wheeler using a digital signature and date. Printed copies of this document are not considered signed and sealed and the signature must be verified on any electronic copies.

Cool and Cobb Engineering Co.
203 W. Main St.
Avon Park, FL 33825

Cool and Cobb Engineering Company

Date: 5/5/2022
Job: Joey O'Hern
Location: 162 South Marion Ave
Lake City, FL 32025

Attachment "A"

PILE NO.	Total Load on Pile (Live Load + Dead Load) TOTAL CALCULATE LOAD
1	1,950 lbs
2	1,950 lbs
3	23,000 lbs

This item has been electronically
sealed by Kenneth F. Wheeler
using a digital signature and date.
Printed copies of this document
are not considered signed and
sealed and the signature must be
verified on any electronic copies.

Maximum Total Load on Pile: 23,000 lbs

5/5/2022
Kenneth F Wheeler, P.E.
PE# 60417



Digitally signed
by Kenneth F
Wheeler
Date: 2022.05.05
10:38:31 -04'00'

Cool and Cobb Engineering Co.
203 W. Main St.
Avon Park, FL 33825

PPB-250--Concentric Bracket

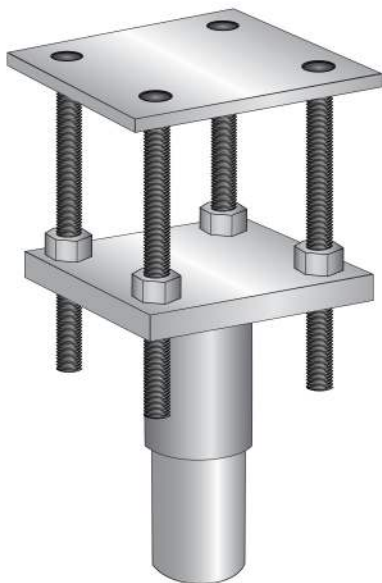

Product Specifications

Anchor Style	Concentric Pier
Component	Pier Bracket
Capacity	54 Kip
Bearing Surface	100 square inches
Lift Capacity	Fully Adjustable for Unlimited Lift
Coating	Black
Standard Package	40
Standard Package Unit	Each Bracket w/ starter section
Weight	62 lbs.
Min Order Qty	1

Notes

Concentric Bracket

5/5/2022
Kenneth F. Wheeler, P.E.
PE# 60417

Cool and Cobb Engineering Co.
203 W. Main St.
Avon Park, FL 33825

ECP Steel Pier™ -- PPB-200 & PPB-250 Under Footing Bracket Pier System

- | | |
|---|--|
| <ul style="list-style-type: none"> • PPB-200 Ultimate Capacity – 50,000 lb • Maximum Proof Load – 37,500 lb • 68 Square Inches Bearing Surface | <ul style="list-style-type: none"> • PPB-250 Ultimate Capacity – 54,000 lb • Maximum Proof Load – 40,500 lb • 100 Square Inches Bearing Surface |
|---|--|
-
- | | |
|--|--|
| <ul style="list-style-type: none"> • Standard Lift – 4" • Fully Adjustable Unlimited Lift Capability • Installs Under Footing • Friction Reduction Collar On Lead Pier Section • 2-7/8" Diameter High Strength, Galvanized Tubular Pier | <ul style="list-style-type: none"> • Installs With Portable Equipment • Installed With Little or No Vibration • Installs To Rock or Verified Load Bearing Stratum • 100% of Piers Proof Tested When Installed • Manufacturer's Warranty |
|--|--|

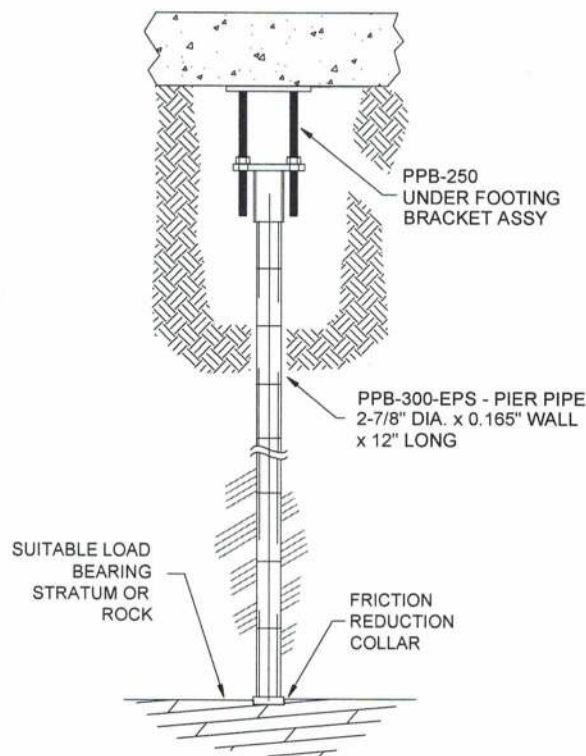

PPB-200 & PPB-250 Under Footing Bracket Details

PPB-250 Under Footing Pier System Application Details

The capacity of the PPB-200 and PPB-250 under foundation support system is a function of the capacity of pier pipe and soil surrounding the pipe, capacity of the load bearing stratum, capacity of the foundation bracket, foundation strength and strength of the bracket to foundation connection. Actual capacities could be lower than the bracket capacity.

Earth Contact Products, LLC reserves the right to change design features, specifications and products without notice, consistent with our efforts toward continuous product improvement. Please check with Earth Contact Products at 972 480-0007 or 913 393-0007 to verify that you are using the most recent specifications.