

Columbia County Building Permit Application

Revised 9-23-04

For Office Use Only Application # 0711-57 Date Received 11-20-07 By GF Permit # 26481
 Application Approved by - Zoning Official CFJ Date 12/4/07 Plans Examiner OK JTH Date 11-28-07
 Flood Zone X Development Permit N/A Zoning A-1 Land Use Plan Map Category A-1
 Comments ~~---~~ - NOC

Applicants Name WILLIAM L. HARPER Phone 386-623-3873
 Address 119 SW HOBBY PL. LAKE CITY, FL. 32024
 Owners Name RANDY AND KELLY BRILLES Phone 386-754-3883
 911 Address 388 SW RAMON CT. LAKE CITY, FL. 32024
 Contractors Name WILLIAM L. HARPER Phone 386-623-3873
 Address 119 SW HOBBY PL. LAKE CITY, FL. 32024

Fee Simple Owner Name & Address _____

Bonding Co. Name & Address _____

Architect/Engineer Name & Address CURTIS E. KEEN 9263 CR. 417 LIVE OAK, FL. 32066

Mortgage Lenders Name & Address CITY MORTGAGE INC. 1000 TECHNOLOGY DR. OFALON, MO. 63368

Circle the correct power company - FL Power & Light - Clay Elec. - Suwannee Valley Elec. - Progressive Energy

Property ID Number 18-45-16-03054-103 HX Estimated Cost of Construction \$20,000.00

Subdivision Name Parcel C Thistledew S/D Lot _____ Block _____ Unit _____ Phase _____

Driving Directions GO HWY 90 WEST TO HWY 252 (Pine mount), GO LEFT, GO TO BIRLEY GO LEFT, GO TO BRIM RD (EKA TOMKINS RD), GO RIGHT, GO TO RAMON CT, GO LEFT, PROPERTY ON RIGHT (BOARD FEENE AND CEDAR TREES) 3rd lot on right

Type of Construction DETACHED GARAGE Number of Existing Dwellings on Property _____

Total Acreage 11.560 Lot Size _____ Do you need a - Culvert Permit or Culvert Waiver or Have an Existing Drive

Actual Distance of Structure from Property Lines - Front 145' ✓ Side 260' ✓ Side 420' ✓ Rear 518' ✓

Total Building Height 16' Number of Stories 1 Heated Floor Area 0 Roof Pitch 6/12
TOTAL 720

Application is hereby made to obtain a permit to do work and installations as indicated. I certify that no work or installation has commenced prior to the issuance of a permit and that all work be performed to meet the standards of all laws regulating construction in this jurisdiction.

OWNERS AFFIDAVIT: I hereby certify that all the foregoing information is accurate and all work will be done in compliance with all applicable laws and regulating construction and zoning.

WARNING TO OWNER: YOUR FAILURE TO RECORD A NOTICE OF COMMENCEMENT MAY RESULT IN YOU PAYING TWICE FOR IMPROVEMENTS TO YOUR PROPERTY. IF YOU INTEND TO OBTAIN FINANCING, CONSULT WITH YOUR LENDER OR ATTORNEY BEFORE RECORDING YOUR NOTICE OF COMMENCEMENT.

Owner Builder or Agent (Including Contractor) _____

STATE OF FLORIDA
COUNTY OF COLUMBIA

Sworn to (or affirmed) and subscribed before me
this 20th day of November 2007.
Personally known ✓ or Produced Identification _____

William L. Harper
Contractor Signature
Contractors License Number RR282811402
Competency Card Number 000258

NOTARY STAMP/SEAL
Paula K Ionescu-Adams
Notary Signature
PAULA K IONESCU-ADAMS
MY COMMISSION # 0003863
Expires: Oct 16, 2010
(407) 398-0153 Florida Notary Service.com

left message 12/4/07
11:31 AM

07Y-0802S

Permit No. _____

Tax Folio No. _____

NOTICE OF COMMENCEMENT

State of Florida
County of Columbia

Inst. 200712023193 Date: 10/15/2007 Time 3:28 PM
DC P. DeWitt Casan, Columbia County Page 1 of 2

The undersigned hereby gives notice that improvement will be made to certain real property, and in accordance with Chapter 713, Florida Statutes, the following information is provided in this Notice of Commencement.

1. Description of property: SEE ATTACHED EXHIBIT "A"
2. General description of improvement: New Construction
Single Family Residence
3. Owner information:
 - a. Name and address: Randy and Kelly Briggs
388 SW Ramon Court Lake City, FL 32024
 - b. Interest in property: _____
 - c. Name and address of fee simple titleholder (if other than Owner): _____
4. Contractor (name and address): Safe Harbor Homes, Inc.
3993 US Highway 90 W
Lake City, FL 32055
 - a. Phone Number: (386) 758-9433
5. Surety:
 - a. Name and address: _____
 - b. Phone Number: _____
 - c. Amount of bond: _____
6. Lender (name and address): CitiMortgage
c/o Granite Loan Management, LLC
10770 E. Briarwood Ave. Suite 280, Centennial, CO 80112
7. Persons within the State of Florida designated by Owner upon whom notices or other documents may be served as provided by Section 713.13(1)(a)7., Florida Statutes:
Name and address: _____
8. In addition to himself or herself, Owner designates Granite Loan Management, LLC of 10770 E. Briarwood Ave. Suite 280, Centennial, CO 80112 to receive a copy of Lienor's Notice as provided in Section 713.13(1)(b), Florida Statutes.
 - a. Phone Number: (888) 456-4888
9. Expiration date 3 years from the date of recording

State of Florida, Columbia County Randy Briggs (Signature of Owner) Kelly Briggs

Sworn to (or affirmed) and subscribed before me this 4th day of Oct 2007, by
(name of person making statement) Randy and Kelly Briggs



Martha Bryan
(Signature of Notary Public, State of Florida)
Martha Bryan
(Print, Type, or Stamp Commissioned Name of Notary Public)

Personally Known _____ OR Produced Identification ✓
Type of Identification Produced Driver's License

EXHIBIT "A"

PARCEL "C", THISTLEDEW SUBDIVISION (UNPLATTED), DESCRIBED AS FOLLOWS:

A PART OF THE E ½ OF THE NE ¼, SECTION 18, TOWNSHIP 4 SOUTH, RANGE 16 EAST, MORE PARTICULARLY DESCRIBED AS FOLLOWS:

COMMENCE AT THE NW CORNER OF THE NE ¼ OF THE NE ¼ AND RUN S 1°41'53" E, ALONG THE WEST LINE OF SAID E ½ OF THE NE ¼, 1342.76 FEET TO THE POINT OF BEGINNING; THENCE CONTINUE S 1°41'53" E, 730.66 FEET; THENCE N 87°45'29" E, 616.47 FEET; THENCE N 84°24'05" E, 83.06 FEET; THENCE N 1°54'47" W, 707.74 FEET; THENCE S 89°14'27" W, 696.75 FEET TO THE POINT OF BEGINNING, COLUMBIA COUNTY, FLORIDA.

SUBJECT TO AN EASEMENT FOR INGRESS AND EGRESS OVER AND ACROSS THE EAST 30 FEET THEREOF.

ALSO:

THE RIGHT OF INGRESS AND EGRESS OVER AND ACROSS A 60 FOOT EASEMENT LYING 30 FEET TO THE RIGHT AND 30 FEET TO THE LEFT OF THE FOLLOWING DESCRIBED CENTERLINE:

COMMENCE AT THE NW CORNER OF THE E ½ OF SAID NE ¼ AND RUN S 1°41'53" E, 25 FEET TO THE SOUTH MAINTAINED RIGHT-OF-WAY OF THOMPkins ROAD; THENCE N 89°14'22" E, 691.80 FEET ALONG SAID RIGHT-OF-WAY FOR A POINT OF BEGINNING OF THE CENTERLINE OF SAID EASEMENT; THENCE S 1°54'47" E ALONG SAID CENTERLINE 2026.0 FEET TO THE POINT OF TERMINATION OF SAID EASEMENT.

02044611
ADVANCE HOMESTEAD TITLE, INC. WARRANTY DEED
(FROM CORPORATION)

THIS INSTRUMENT WAS PREPARED INCIDENTAL TO THE WRITING OF A TITLE INSURANCE POLICY BY AND RETURN TO:
PATRICIA L. SWEET
ADVANCE HOMESTEAD TITLE
100 SW 75TH STREET, STE. J
GAINESVILLE, FLORIDA 32607

Property Appraisers Parcel I.D. (Folio) Number(s):
03054-103

Grantee(s) S.S.#(s):

Inst:2003001821 Date:01/30/2003 Time:11:00
Doc Stamp-Deed : 0.70
YACK DC, P. DeWitt Cason, Columbia County B:973 P:793

SPACE ABOVE THIS LINE FOR PROCESSING DATA

SPACE ABOVE THIS LINE FOR RECORDING DATA

This Warranty Deed Made and executed the 13TH day of JANUARY A. D. 2003 by M. G. MECHANICAL CONTRACTORS, INC.

a corporation existing under the laws of FLORIDA and having its principal place of business at Rt. 13, Box 418, Lake City, FL 32055-9003 hereinafter called the grantor, to RANDY BRIGGS and KELLY M. BRIGGS, f/k/a KELLY BACH, husband and wife whose postoffice address is ROUTE 11 BOX 394-25 LAKE CITY, FL 32024 hereinafter called the grantee:

(Wherever used herein the terms "grantor" and "grantee" include all the parties to this instrument and the heirs, legal representatives and assigns of individuals, and the successors and assigns of corporations)

Witnesseth: That the grantor, for and in consideration of the sum of \$ 10,000 and other valuable considerations, receipt whereof is hereby acknowledged, by these presents does grant, bargain, sell, alien, remise, release, convey and confirm unto the grantee, all that certain land situated in Columbia County, Florida, viz:

SEE EXHIBIT "A" ATTACHED HERETO AND MADE A PART HEREOF.

Together with all the tenements, hereditaments and appurtenances thereto belonging or in anywise appertaining **To Have and to Hold**, the same in fee simple forever.

And the grantor hereby covenants with said grantee that it is lawfully seized of said land in fee simple, that it has good right and lawful authority to sell and convey said land; that it hereby fully warrants the title to said land and will defend the same against the lawful claims of all persons whomsoever; and that said land is free of all encumbrances, except taxes accruing subsequent to December 31, 2002, restrictions, reservations, covenants and easements of record if any.

In Witness Whereof, the grantor has caused these presents to be executed in its name, and its corporate seal to be hereunto affixed, by its proper officers thereunto duly authorized, the day and year first above written.

(Corporate Seal)

ATTEST: _____ Secretary

Signed, sealed and delivered in our presence:

Elyse M. Blake
Witness Signature

Elyse M. Blake
Printed Name

Kathy M. Blake
Witness Signature

Kathy M. Blake
Printed Name

STATE OF FLORIDA
COUNTY OF ALACHUA

The foregoing instrument was acknowledged before me this 13TH day of JANUARY 2003, by TERRY M. KELLY, President of

M. G. MECHANICAL CONTRACTORS, INC.

Florida Corporation.

on behalf of the corporation. He/she is personally known to me or has produced a driver's license as identification and did not take an oath.

M. G. MECHANICAL CONTRACTORS, L.S. INC.

By Terry M. Kelly, President

TERRY M. KELLY, President

Printed Name

Kathy M. Blake
Notary Signature

Kathy M. Blake
Printed Notary Signature

My Commission Expires:



EXHIBIT "A"

Parcel "C", THISTLEDEW SUBDIVISION (Unplatted), described as follows:

A part of the E 1/2 of the NE 1/4, Section 18, Township 4 South, Range 16 East, more particularly described as follows:

Commence at the NW corner of the NE 1/4 of the NE 1/4 and run S.1°41'53"E. along the West line of said E 1/2 of the NE 1/4, 1342.76 feet to the Point of Beginning; thence continue S.1°41'53"E., 730.66 feet; thence N.87°45'29"E., 616.47 feet; thence N.84°24'05"E., 83.06 feet; thence N.1°54'47"W., 707.74 feet; thence S.89°14'27"W., 696.75 feet to the Point of Beginning, Columbia County, Florida.

Subject to an easement for ingress and egress over and across the Eat 30 feet thereof.

ALSO:

The right of ingress and egress over and across a 60 foot easement lying 30 feet to the right and 30 feet to the left of the following described centerline:

Commence at the NW corner of the E 1/2 of said NE 1/4 and run S.1°41'53"E., 25 feet to the South maintained right-of-way of Thompkins Road; thence N.89°14'27"E., 691.80 feet along said right-of-way for a Point of Beginning of the centerline of said easement; thence S.1°54'47"E. along said centerline 2026.0 feet to the Point of Termination of said easement.

Property is subject to a DECLARATION OF COVENANTS AND RESTRICTIONS recorded in the public records of Columbia County, Florida and subject to other restrictions, reservations and easements of record.

Inst:2003001821 Date:01/30/2003 Time:11:00
Doc Stamp-Due: 0.70
mck DC, P. DeWitt Cason, Columbia County B:973 P:794

Columbia County Property Appraiser

DB Last Updated: 10/22/2007

2007 Proposed Values

Parcel: 18-4S-16-03054-103 HX

[Tax Record](#) |
 [Property Card](#) |
 [Interactive GIS Map](#) |
 [Print](#)

Owner & Property Info

Search Result: 1 of 1

Owner's Name BRIGGS RANDY &

Site Address RAMON

Mailing Address
 KELLY BACH BRIGGS
 388 SW RAMON CT
 LAKE CITY, FL 32024

Use Desc. (code) IMPROVED A (005000)

Neighborhood 18416.00 **Tax District** 3

UD Codes MKTA01 **Market Area** 01

Total Land Area 11.560 ACRES

Description
 COMM NW COR OF NE1/4 OF NE1/4, RUN S 1342.76 FT FOR POB, CONT S 730.66 FT, E 616.47 FT, NE 83.06 FT, N 707.74 FT, W 696.75 FT TO POB. (AKA PRCL C THISTLEDEW S/D UNREC) ORB 840-1822, 973-793.

GIS Aerial



Property & Assessment Values

Mkt Land Value	cnt: (2)	\$16,040.00	Just Value	\$114,123.00
Ag Land Value	cnt: (1)	\$2,344.00	Class Value	\$42,547.00
Building Value	cnt: (1)	\$24,163.00	Assessed Value	\$35,461.00
XFOB Value	cnt: (0)	\$0.00	Exempt Value (code: HX)	\$25,000.00
Total Appraised Value		\$42,547.00	Total Taxable Value	\$10,461.00

Sales History

Sale Date	Book/Page	Inst. Type	Sale Vlmp	Sale Qual	Sale RCode	Sale Price
1/13/2003	973/793	WD	I	U	04	\$100.00
8/7/1997	840/1822	AD	V	U	01	\$29,900.00

Building Characteristics

Bldg Item	Bldg Desc	Year Blt	Ext. Walls	Heated S.F.	Actual S.F.	Bldg Value
1	MOBILE HME (000800)	1997	Vinyl Side (31)	924	924	\$24,163.00

Note: All S.F. calculations are based on exterior building dimensions.

Extra Features & Out Buildings

Code	Desc	Year Blt	Value	Units	Dims	Condition (% Good)
NONE						

Land Breakdown

ITW Building Components Group, Inc.

1950 Marley Drive Haines City, FL 33844
Florida Engineering Certificate of Authorization Number: 0 278
Florida Certificate of Product Approval # FL1999
Page 1 of 1 Document ID:ITCH8228Z0515150822

Truss Fabricator: Anderson Truss Company
Job Identification: 7-336--OWNER BUILDER Bill Harper - Briggs -- 623-3873 , **
Truss Count: 2
Model Code: Florida Building Code 2004 and 2006 Supplement
Truss Criteria: ANSI/TPI-2002(STD)/FBC
Engineering Software: Alpine Software, Version 7.36.
Structural Engineer of Record: The identity of the structural EOR did not exist as of
Address: the seal date per section 61615-31.003(5a) of the FAC
Minimum Design Loads: Roof - 40.0 PSF @ 1.25 Duration
Floor - N/A
Wind - 110 MPH ASCE 7-02 -Closed



Notes:

1. Determination as to the suitability of these truss components for the structure is the responsibility of the building designer/engineer of record, as defined in ANSI/TPI 1
2. The drawing date shown on this index sheet must match the date shown on the individual truss component drawing.
3. As shown on attached drawings; the drawing number is preceded by: HCUSR8228

Seal Date: 11/15/2007

-Truss Design Engineer-
James F. Collins Jr.
Florida License Number: 52212
1950 Marley Drive
Haines City, FL 33844

Details: A11015EE-GBLLETIN-

#	Ref	Description	Drawing#	Date
1	49994--A		07319008	11/15/07
2	49995--AGE		07319009	11/15/07



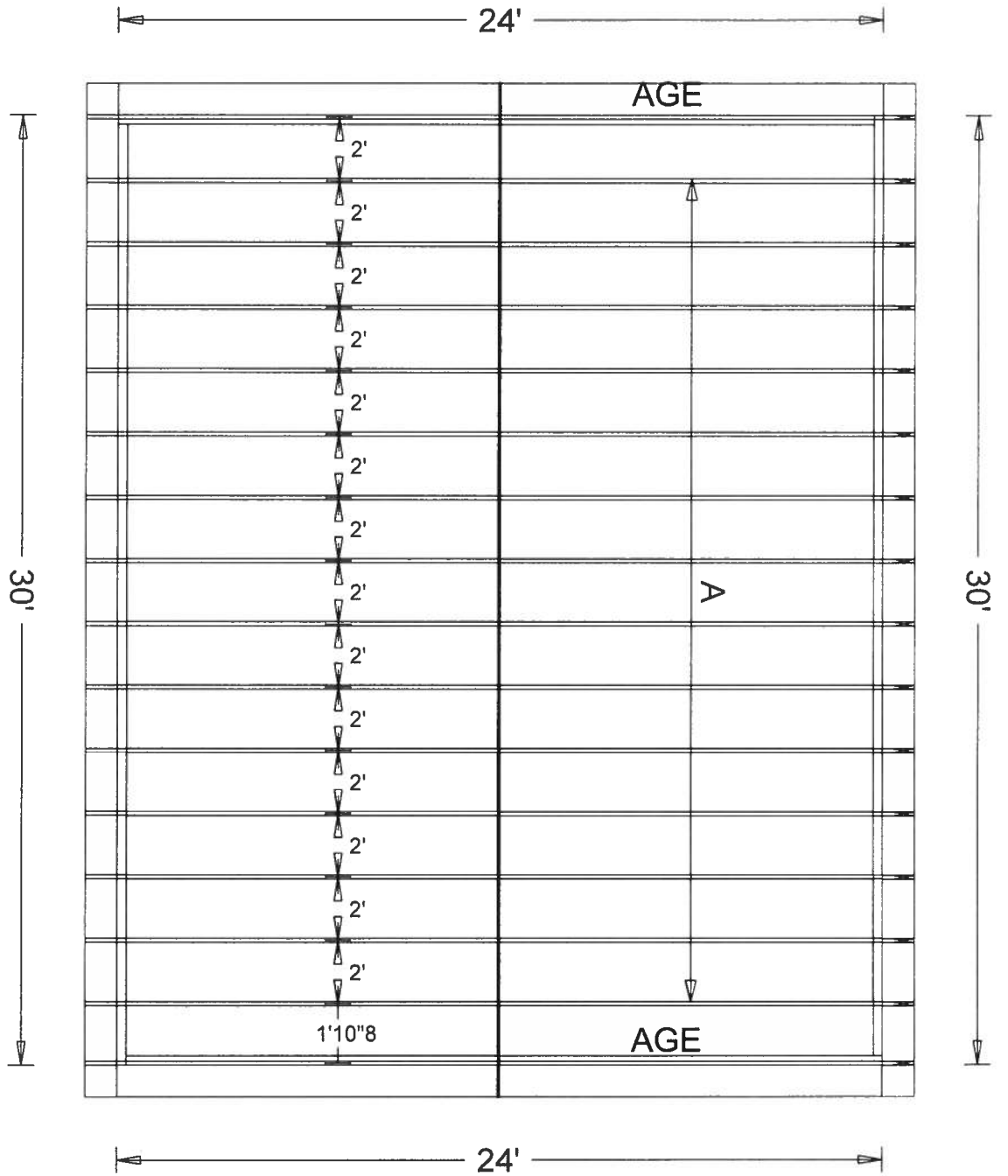

#7-336 Bill Harper / Briggs
11/15/07

Roof Plane Sheathing Area = 930 sq. ft
 Gable Sheathing Area = 161 sq. ft
 Total Sheathing Area = 1091 sq. ft
 Fascia Material = 122 linear ft
 Ridge Cap Material = 32 linear ft

JOB DESCRIPTION: OWNER BUILDER
 /: Bill Harper - Briggs

JOB NO:
 7-336

PAGE NO:
 1 OF 1

(7 336 OWNER BUILDER B111 Harper Briggs 623 3873 , ** A)
 Top chord 2x4 SP #2 Dense
 Bot chord 2x4 SP #2 Dense
 Webs 2x4 SP #3

Deflection meets L/240 live and L/180 total load. Creep increase
 Factor for dead load is 1.50.

110 mph wind, 15.00 ft mean hgt, ASCE 7-02, CLOSED bldg, Located
 anywhere in roof, CAT II, EXP B, wind TC DL=5.0 psf, wind BC
 DL=5.0 psf. $I_w=1.00$ $Gcpl(+/-)=0.18$

Wind reactions based on MWFRS pressures.

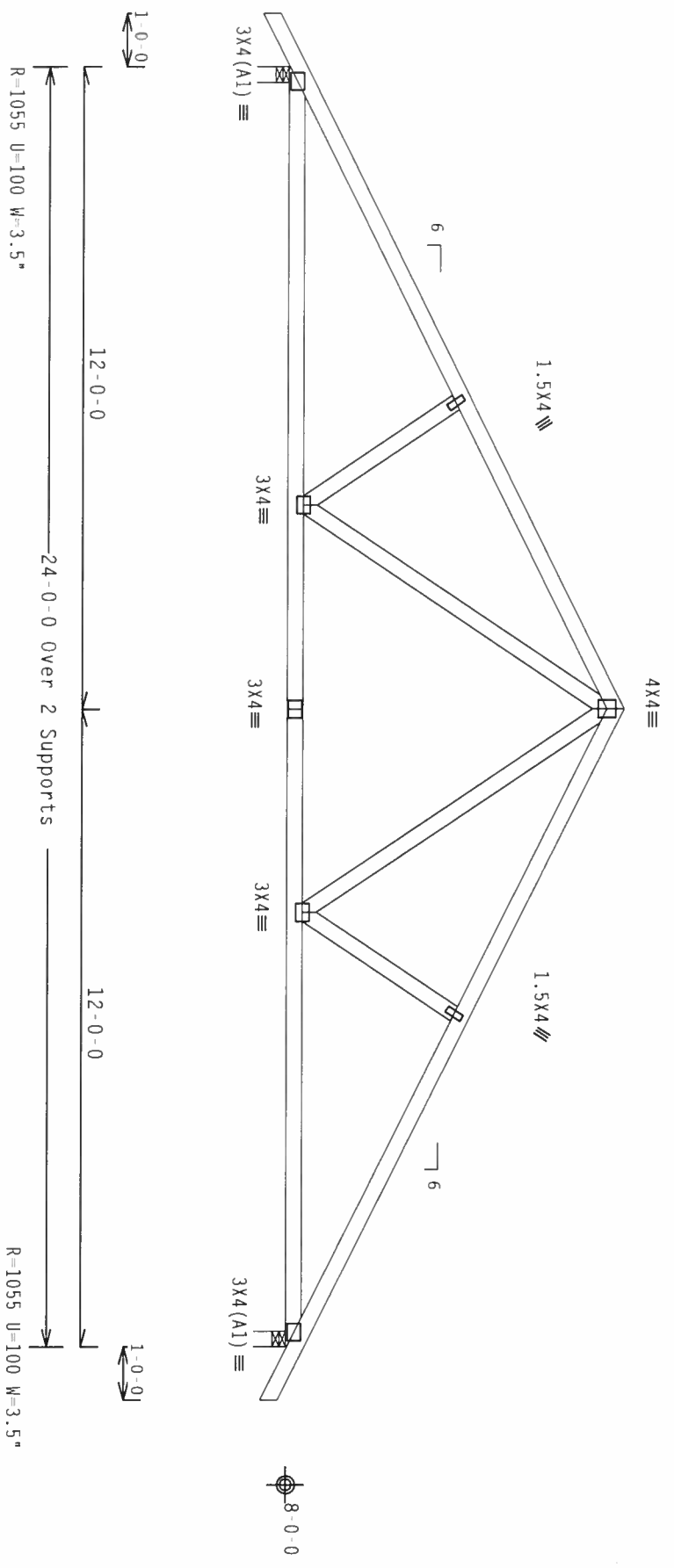

PLT TYP. Wave

Design Crit: TPI-2002(STD) /FBC
 $Cq/RT=1.00(1.25)/10(0)$

7.36.0424

OTY:14 FL/-/4/-/E/-/-

Scale = .3125"/ft.

TC LL	20.0 PSF	REF	R8228- 49994
TC DL	10.0 PSF	DATE	11/15/07
BC DL	10.0 PSF	DRW	HCUR8228 07319008
BC LL	0.0 PSF	HC-ENG	JB/AP
TOT. LD.	40.0 PSF	SECN-	47977
DUR. FAC.	1.25	FROM	DG
SPACING	24.0"	JREF-	1TCH8228Z05

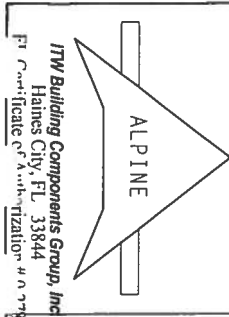

ITW Building Components Group, Inc
 Gaines City, FL 33644
 P1 Certificate of Authorization #00000000

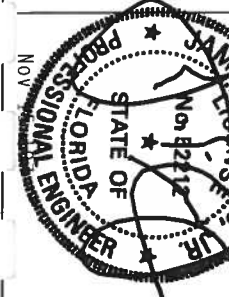

WARNING TRUSSES REQUIRE EXTREME CARE IN FABRICATION, HANDLING, SHIPPING, INSTALLING AND BRACING. REFER TO BCSE (BUILDING COMPONENT SAFETY INFORMATION), PUBLISHED BY TPI (TRUSS PLATE INSTITUTE), 218 NORTH LEE STREET, SUITE 312, ALEXANDRIA, VA 22314, AND WICK (WOOD TRUSS COMPANY), 6800 ENTERPRISE LANE, MADISON, WI 53719 FOR SAFETY PRACTICES PRIOR TO PERFORMING THESE FUNCTIONS. UNLESS OTHERWISE INDICATED TOP CHORD SHALL HAVE PROPERLY ATTACHED STRUCTURAL PANELS AND BOTTOM CHORD SHALL HAVE A PROPERLY ATTACHED RIGID CEILING.

IMPORTANT FURNISH A COPY OF THIS DESIGN TO THE INSTALLATION CONTRACTOR. THE BCG, INC. SHALL NOT BE RESPONSIBLE FOR ANY DEVIATION FROM THIS DESIGN. ANY FAILURE TO BUILD THE TRUSS IN CONFORMANCE WITH TPI OR FABRICATING, HANDLING, SHIPPING, INSTALLING & BRACING OF TRUSSES.

DESIGN CONDITIONS WITH APPLICABLE PROVISIONS OF 905 (QUALITY DESIGN SPEC. BY AIA/AIA) AND TPI.

CONNECTION PLATES ARE MADE OF 201/19/18 GA. (E.A./SS/9) ASTM A653 GRADE 40/60 (F. 670/55) GALV. STEEL. APPLY TO ALL CONNECTIONS. CONNECTIONS LOCATED ON THIS DESIGN, POSITION PER DRAWINGS, FIG. 2.

ANY IMPROVEMENTS OR CHANGES TO THIS DESIGN, POSITION PER DRAWINGS, FIG. 2, SHALL BE APPROVED BY THE DESIGNER. THE DESIGNER'S ACCEPTANCE OF PROFESSIONAL ENGINEERING RESPONSIBILITY SOCIETY FOR THE TRUSS COMPONENTS DRAWING INDICATES THE SUITABILITY AND USE OF THIS COMPONENT FOR ANY BUILDING IS THE RESPONSIBILITY OF THE BUILDING DESIGNER PER ANSI/TPI 1 SEC. 2.

CABLE SPACING	2x4 BRACE SPECIES	GRADE	NO BRACES	1x4 "L" BRACE *		2x4 "L" BRACE *		2x4 "L" BRACE **		2x6 "L" BRACE *		2x6 "L" BRACE **	
				GROUP A	GROUP B	GROUP A	GROUP B	GROUP A	GROUP B	GROUP A	GROUP B	GROUP A	GROUP B
12" O.C.	SPF	#1 / #2	3' 10"	6' 8"	6' 10"	7' 11"	8' 1"	9' 5"	9' 5"	12' 4"	12' 4"	14' 0"	14' 0"
		#3	3' 9"	6' 0"	6' 0"	7' 11"	7' 11"	9' 5"	9' 5"	12' 4"	12' 4"	14' 0"	14' 0"
		STUD	3' 9"	6' 0"	6' 0"	7' 11"	7' 11"	9' 5"	9' 5"	12' 3"	12' 3"	14' 0"	14' 0"
	HF	STANDARD	3' 9"	5' 2"	5' 2"	6' 9"	6' 9"	9' 1"	9' 1"	10' 7"	10' 7"	14' 0"	14' 0"
		#1	4' 3"	6' 8"	7' 2"	7' 11"	8' 6"	9' 5"	10' 2"	12' 5"	13' 5"	14' 0"	14' 0"
		#2	4' 2"	6' 8"	7' 2"	7' 11"	8' 6"	9' 5"	10' 2"	12' 5"	13' 5"	14' 0"	14' 0"
16" O.C.	DFL	#3	4' 0"	6' 2"	6' 2"	7' 11"	8' 1"	9' 5"	9' 11"	12' 5"	12' 6"	14' 0"	14' 0"
		STUD	4' 0"	6' 1"	6' 1"	7' 11"	8' 0"	9' 5"	9' 11"	12' 5"	12' 6"	14' 0"	14' 0"
		STANDARD	3' 10"	5' 3"	5' 3"	6' 11"	6' 11"	9' 4"	9' 4"	10' 10"	10' 10"	14' 0"	14' 0"
	SPF	#1 / #2	4' 5"	7' 8"	7' 10"	9' 1"	9' 4"	10' 10"	11' 1"	14' 0"	14' 0"	14' 0"	14' 0"
		#3	4' 4"	7' 4"	7' 4"	9' 1"	9' 1"	10' 10"	10' 10"	14' 0"	14' 0"	14' 0"	14' 0"
		STUD	4' 4"	7' 4"	7' 4"	9' 1"	9' 1"	10' 10"	10' 10"	14' 0"	14' 0"	14' 0"	14' 0"
HF	STANDARD	4' 4"	6' 4"	6' 4"	8' 4"	8' 4"	10' 10"	10' 10"	12' 11"	12' 11"	14' 0"	14' 0"	
	#1	4' 10"	7' 8"	8' 3"	9' 1"	9' 9"	10' 10"	11' 8"	14' 0"	14' 0"	14' 0"	14' 0"	
	#2	4' 9"	7' 8"	8' 3"	9' 1"	9' 9"	10' 10"	11' 8"	14' 0"	14' 0"	14' 0"	14' 0"	
24" O.C.	DFL	#3	4' 6"	7' 6"	7' 6"	9' 1"	9' 6"	10' 10"	11' 4"	14' 0"	14' 0"	14' 0"	14' 0"
		STUD	4' 6"	7' 6"	7' 6"	9' 1"	9' 6"	10' 10"	11' 4"	14' 0"	14' 0"	14' 0"	14' 0"
		STANDARD	4' 5"	6' 5"	6' 5"	8' 6"	8' 6"	10' 10"	11' 1"	13' 3"	13' 3"	14' 0"	14' 0"
	SPF	#1 / #2	4' 11"	8' 5"	8' 8"	10' 0"	10' 3"	11' 11"	12' 3"	14' 0"	14' 0"	14' 0"	14' 0"
		#3	4' 9"	8' 5"	8' 5"	10' 0"	10' 0"	11' 11"	11' 11"	14' 0"	14' 0"	14' 0"	14' 0"
		STUD	4' 9"	8' 5"	8' 5"	10' 0"	10' 0"	11' 11"	11' 11"	14' 0"	14' 0"	14' 0"	14' 0"
HF	STANDARD	4' 9"	7' 3"	7' 3"	9' 7"	9' 7"	11' 11"	11' 11"	14' 0"	14' 0"	14' 0"	14' 0"	
	#1	5' 4"	8' 5"	9' 1"	10' 0"	10' 9"	11' 11"	12' 10"	14' 0"	14' 0"	14' 0"	14' 0"	
	#2	5' 3"	8' 5"	9' 1"	10' 0"	10' 9"	11' 11"	12' 10"	14' 0"	14' 0"	14' 0"	14' 0"	
12" O.C.	SP	#3	5' 0"	8' 5"	8' 5"	10' 0"	10' 6"	11' 11"	12' 6"	14' 0"	14' 0"	14' 0"	14' 0"
		STUD	5' 0"	8' 5"	8' 5"	10' 0"	10' 6"	11' 11"	12' 6"	14' 0"	14' 0"	14' 0"	14' 0"
		STANDARD	4' 11"	7' 5"	7' 5"	9' 10"	9' 10"	11' 11"	12' 3"	14' 0"	14' 0"	14' 0"	14' 0"

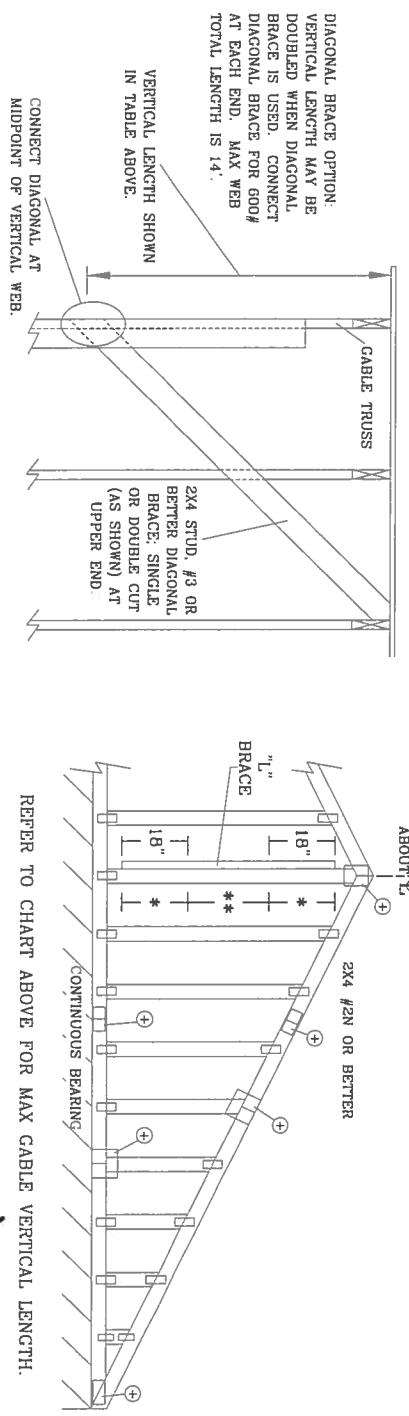

CABLE VERTICAL PLATE SIZES	
VERTICAL LENGTH	NO SPLICE
LESS THAN 4' 0"	1X4 OR 2X3
GREATER THAN 4' 0" BUT LESS THAN 11' 6"	2X4
GREATER THAN 11' 6"	2.5X4

+ REFER TO COMMON TRUSS DESIGN FOR PEAK, SPLICE, AND HEEL PLATES.

GABLE TRUSS DETAIL NOTES:

LIVE LOAD DEFLECTION CRITERIA IS L/240.

PROVIDE UPLIFT CONNECTIONS FOR 80 PSF OVER CONTINUOUS BEARING (5 PSF TC DEAD LOAD).

CABLE END SUPPORTS LOAD FROM 4' 0" OUTLOOKERS WITH 2' 0" OVERHANG, OR 12" PLYWOOD OVERHANG.

ATTACH EACH "L" BRACE WITH 10d NAILS.

* FOR (1) "L" BRACE: SPACE NAILS AT 2' 0" O.C. IN 18" END ZONES AND 4' 0" O.C. BETWEEN ZONES.

** FOR (2) "L" BRACES: SPACE NAILS AT 3' 0" O.C. IN 18" END ZONES AND 6' 0" O.C. BETWEEN ZONES.

"L" BRACING MUST BE A MINIMUM OF 80% OF WEB MEMBER LENGTH.

BRACING GROUP SPECIES AND GRADES:

GROUP A:

- SPRUCE-PINE-FIR: #1 / #2 STANDARD, #3 STUD
- HEM-FIR: #2 STUD, #3 STANDARD
- DOUGLAS FIR-LARCH: #3 STUD, STANDARD
- SOUTHERN PINE: #3 STUD, STANDARD

GROUP B:

- HEM-FIR: #1 & BTR, #1
- SOUTHERN PINE: #1, #2
- DOUGLAS FIR-LARCH: #1, #2

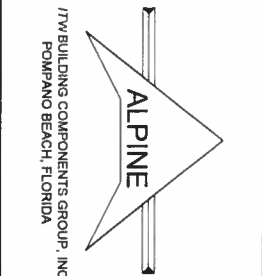

DIAGONAL BRACE OPTION. VERTICAL LENGTH MAY BE DOUBLED WHEN DIAGONAL BRACE IS USED. CONNECT DIAGONAL BRACE FOR 600# AT EACH END. MAX WEB TOTAL LENGTH IS 14'.

VERTICAL LENGTH SHOWN IN TABLE ABOVE.

CONNECT DIAGONAL AT MIDPOINT OF VERTICAL WEB.

2x4 STUD, #3 OR BETTER DIAGONAL BRACE, SINGLE OR DOUBLE CUT (AS SHOWN) AT UPPER END.

REFER TO CHART ABOVE FOR MAX GABLE VERTICAL LENGTH.

SYMM ABOUT L

2x4 #2N OR BETTER BRACE

CONTINUOUS BEARING

WARNING TRUSSES REQUIRE EXTREME CARE IN FABRICATING, HANDLING, SHIPPING, INSTALLING AND BRACING. REFER TO BEST BUILDING COMPONENT SAFETY INFORMATION PUBLISHED BY THE TRUSS COUNCIL OF AMERICA FOR THE PROPER STRUTTING AND BRACING OF TRUSSES. ALL TRUSS CONNECTIONS MUST BE MADE IN ACCORDANCE WITH THE TRUSS MANUFACTURER'S DESIGN. ALL TRUSSES ARE MADE OF GALV. STEEL. APPLY PLATES TO EACH FACE OF TRUSS AND, UNLESS OTHERWISE INDICATED ON THIS DESIGN, POSITION PER DRAWINGS 160A-Z. A SEAL ON THIS DRAWING INDICATES ACCEPTANCE OF PROFESSIONAL ENGINEERING RESPONSIBILITY SOLELY FOR THE TRUSS COMPONENT DESIGN SHOWN. THE RESPONSIBILITY AND USE OF THIS COMPONENT FOR ANY BUILDING IS THE RESPONSIBILITY OF THE BUILDING DESIGNER. PER ANSI/TPI 1 SEC. 2

IMPORTANT FURNISH COPY OF THIS DESIGN TO INSTALLATION CONTRACTOR. ITV BEG, INC. SHALL NOT BE RESPONSIBLE FOR ANY DEVIATION FROM THIS DESIGN. ANY FAILURE TO BUILD THE TRUSS IN ACCORDANCE WITH THE FABRICATING, HANDLING, SHIPPING, INSTALLING & BRACING OF TRUSSES. ALL TRUSS CONNECTIONS MUST BE MADE IN ACCORDANCE WITH THE TRUSS MANUFACTURER'S DESIGN. ALL TRUSSES ARE MADE OF GALV. STEEL. APPLY PLATES TO EACH FACE OF TRUSS AND, UNLESS OTHERWISE INDICATED ON THIS DESIGN, POSITION PER DRAWINGS 160A-Z. A SEAL ON THIS DRAWING INDICATES ACCEPTANCE OF PROFESSIONAL ENGINEERING RESPONSIBILITY SOLELY FOR THE TRUSS COMPONENT DESIGN SHOWN. THE RESPONSIBILITY AND USE OF THIS COMPONENT FOR ANY BUILDING IS THE RESPONSIBILITY OF THE BUILDING DESIGNER. PER ANSI/TPI 1 SEC. 2

ITV BUILDING COMPONENTS GROUP, INC.
FOURFORD BEACH, FLORIDA

NO. 52212
DATE 2/23/07
DRWG A11015E0207

MAX. TOT. LD. 60 PSF
MAX. SPACING 24.0"

REF ASCE7-02-GAB11015
DATE 2/23/07
DRWG A11015E0207
-ENG

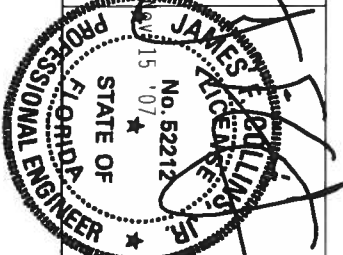

GABLE DETAIL FOR LEFT-IN VERTICALS

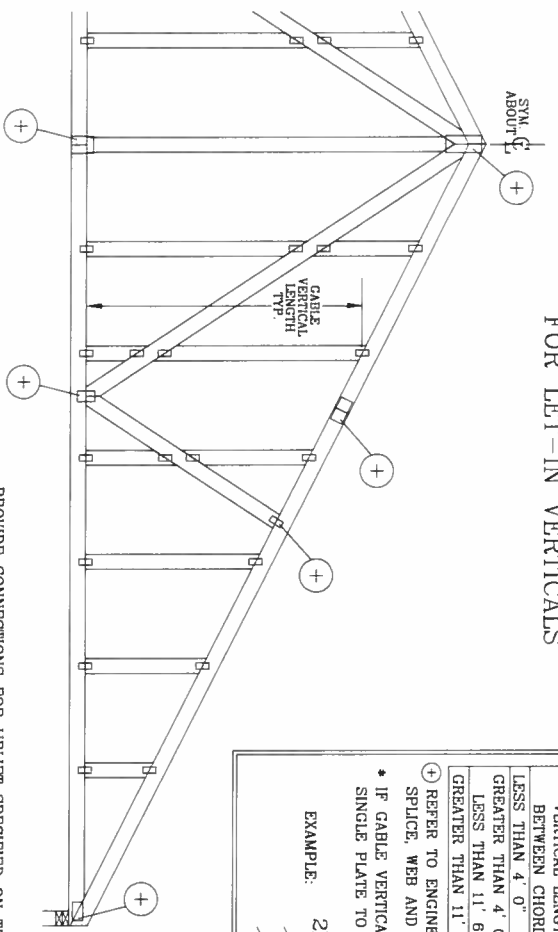

VERTICAL LENGTH BETWEEN CHORDS	PLATE SIZE	IF PLATES OVERLAP*
LESS THAN 4' 0"	1X4 OR 2X3	2X6
GREATER THAN 4' 0" BUT LESS THAN 11' 6"	2X4	2X6
GREATER THAN 11' 6"	2.5X4	2.5X6

* REFER TO ENGINEERED TRUSS DESIGN FOR PEAK SPLICE, WEB AND HEEL PLATES.

IF GABLE VERTICAL PLATES OVERLAP, USE A SINGLE PLATE TO SPAN THE WEB.

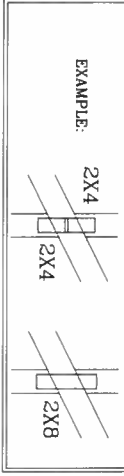

PROVIDE CONNECTIONS FOR UPLIFT SPECIFIED ON THE ENGINEERED TRUSS DESIGN. ATTACH EACH "T" REINFORCING MEMBER WITH

HAND DRIVEN NAILS:
10d COMMON (0.148" X 3" MIN) TOENAILS AT 4" O.C. PLUS
(4) 16d COMMON (0.162" X 3.5" MIN) TOENAILS IN TOP AND BOTTOM CHORD.

GUN DRIVEN NAILS:
8d COMMON (0.131" X 2.5" MIN) TOENAILS AT 4" O.C. PLUS
(4) TOENAILS IN TOP AND BOTTOM CHORD.

THIS DETAIL TO BE USED WITH THE APPROPRIATE ALPINE GABLE DETAIL FOR ASCE OR SBCCI WIND LOAD.

- ASCE 7-93 GABLE DETAIL DRAWINGS
A11015EN0207, A10015EN0207, A09015EN0207, A08015EN0207, A07015EN0207, A11030EN0207, A10030EN0207, A09030EN0207, A08030EN0207, A07030EN0207
- ASCE 7-98 GABLE DETAIL DRAWINGS
A13015EC0207, A12015EC0207, A11015EC0207, A10015EC0207, A08515EC0207, A13030EC0207, A12030EC0207, A11030EC0207, A10030EC0207, A08530EC0207
- ASCE 7-02 GABLE DETAIL DRAWINGS
A13015EB0207, A12015EB0207, A11015EB0207, A10015EB0207, A08515EB0207, A13030EB0207, A12030EB0207, A11030EB0207, A10030EB0207, A08530EB0207
- ASCE 7-05 GABLE DETAIL DRAWINGS
A13015ES0207, A12015ES0207, A11015ES0207, A10015ES0207, A08515ES0207, A13030ES0207, A12030ES0207, A11030ES0207, A10030ES0207, A08530ES0207

SEE APPROPRIATE ALPINE GABLE DETAIL (ASCE OR SBCCI WIND LOAD) FOR MAXIMUM UNREINFORCED GABLE VERTICAL LENGTH.

THIS DRAWING REPLACES DRAWINGS GAB98117 876.719 & HC26294035

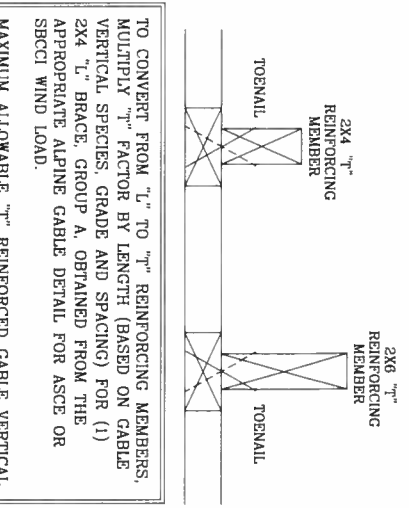

TO CONVERT FROM "T" TO "T" REINFORCING MEMBERS, MULTIPLY "T" FACTOR BY LENGTH (BASED ON GABLE VERTICAL SPECIES, GRADE AND SPACING) FOR (1) 2X4 "T" BRACE GROUP A, OBTAINED FROM THE APPROPRIATE ALPINE GABLE DETAIL FOR ASCE OR SBCCI WIND LOAD.

MAXIMUM ALLOWABLE "T" REINFORCED GABLE VERTICAL LENGTH IS 14' FROM TOP TO BOTTOM CHORD.
WEB LENGTH INCREASE W / "T" BRACE

WIND SPEED AND MRH	"T" REINF. MBR. SIZE	SBCCI	ASCE
110 MPH	2x4	10 %	10 %
15 FT	2x6	40 %	50 %
110 MPH	2x4	10 %	10 %
30 FT	2x6	50 %	50 %
100 MPH	2x4	10 %	10 %
15 FT	2x6	30 %	50 %
100 MPH	2x4	10 %	10 %
30 FT	2x6	40 %	40 %
90 MPH	2x4	20 %	10 %
15 FT	2x6	20 %	40 %
80 MPH	2x4	10 %	10 %
30 FT	2x6	30 %	50 %
15 FT	2x6	10 %	20 %
80 MPH	2x4	20 %	10 %
30 FT	2x6	20 %	40 %
70 MPH	2x4	0 %	20 %
15 FT	2x6	0 %	20 %
70 MPH	2x4	10 %	20 %
30 FT	2x6	10 %	30 %

EXAMPLE:
ASCE WIND SPEED = 100 MPH
MEAN ROOF HEIGHT = 30 FT
GABLE VERTICAL = 24' O.C. SP #3
"T" REINFORCING MEMBER SIZE = 2X4
"T" BRACE INCREASE (FROM ABOVE) = 10% = 1.10
(1) 2X4 "T" BRACE LENGTH = 6' 7"
MAXIMUM "T" REINFORCED GABLE VERTICAL LENGTH = 1.10 x 6' 7" = 7' 3"

THIS DRAWING REPLACES DRAWINGS GAB98117 876.719 & HC26294035



ITW BUILDING COMPONENTS GROUP, INC.
POMPANO BEACH, FLORIDA

WARNING TRUSSES REQUIRE EXTREME CARE IN FABRICATING, HANDLING, SHIPPING, INSTALLING AND BRACING. REFER TO BEST BUILDING COMPONENT SAFETY INFORMATION, PUBLISHED BY THE TRUSS COUNCIL OF AMERICA, 6300 ENTERPRISE LN, HANSON, VA 22149 AND VTEC (WOOD TRUSS CONSTRUCTION) AMERICAN UNLESS OTHERWISE INDICATED. TOP CHORD SHALL HAVE PROPERLY ATTACHED STRUCTURE PANELS AND BOTTOM CHORD SHALL HAVE A PROPERLY ATTACHED RIGID CEILING.

IMPORTANT FURNISH COPY OF THIS DESIGN TO INSTALLATION CONTRACTOR. ITW BCG, INC. SHALL NOT BE RESPONSIBLE FOR ANY DEVIATION FROM THIS DESIGN, ANY FAILURE TO BUILD THE TRUSSES OR CONFORMANCE WITH THE TRUSS MANUFACTURING, HANDLING, SHIPPING, INSTALLING & BRACING OF THE DESIGN CONTRACTOR WITH APPLICABLE PROVISIONS OF NDS (NATIONAL DESIGN SPEC. BY AIA/ASA AND THE I/A) BEG CONNECTOR PLATES ARE MADE OF 2018/16GA (V.A.H.S.S) AS PER 40/60 (V.A.K.H.S.S). DESIGN POSITION PER DRAWING. DESIGN LENGTH PER DRAWING. DESIGN ACCEPTANCE OF PROFESSIONAL ENGINEERING RESPONSIBILITY SOLELY FOR THE TRUSS COMPONENT DESIGN SHOWN. THE SUITABILITY AND USE OF THIS COMPONENT FOR ANY BUILDING IS THE RESPONSIBILITY OF THE BUILDING DESIGNER. PER ANSI/TPI 1 SEC. 2.

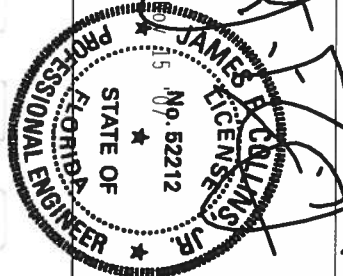

MAX TOT. LD.	60 PSF
DUR. FAC.	ANY
MAX SPACING	24' 0"
REF	LEFT-IN VERT
DATE	2/23/07
DRWG	GBLLETTIN0207
-ENG	DLI/KAR

New Construction Subterranean Termite Soil Treatment Record

OMB Approval No. 2502-0525

This form is completed by the licensed Pest Control Company.

Public reporting burden for this collection of information is estimated to average 15 minutes per response, including the time for reviewing instructions, searching existing data sources, gathering and maintaining the data needed, and completing and reviewing the collection of information. This information is mandatory and is required to obtain benefits. HUD may not collect this information, and you are not required to complete this form, unless it displays a currently valid OMB control number.

Section 24 CFR 200.926d(b)(3) requires that the sites for HUD insured structures must be free of termite hazards. This information collection requires the builder to certify that an authorized Pest Control company performed all required treatment for termites, and that the builder guarantees the treated area against infestation for one year. Builders, pest control companies, mortgage lenders, homebuyers, and HUD as a record of treatment for specific homes will use the information collected. The information is not considered confidential.

This report is submitted for informational purposes to the builder on proposed (new) construction cases when soil treatment for prevention of subterranean termite infestation is specified by the builder, architect, or required by the lender, architect, FHA, or VA.

All contracts for services are between the Pest Control Operator and builder, unless stated otherwise.

26481

Section 1: General Information (Treating Company Information)

Company Name: Aspen Pest Control, Inc.
Company Address: 301 NW Cole Terrace City Lake City State FL Zip 32055
Company Business License No. JF102476 Company Phone No. 386-765-3611
FHA/VA Case No. (if any) _____

Section 2: Builder Information

Company Name: W.L. Harper Company Phone No. _____

Section 3: Property Information

Location of Structure(s) Treated (Street Address or Legal Description, City, State and Zip) 388 SW Ramon Ct. Lake City, FL 32055
Type of Construction (More than one box may be checked) Slab Basement Crawl Other _____
Approximate Depth of Footing: Outside 1" Inside 1" Type of Fill Monolithic

Section 4: Treatment Information

Date(s) of Treatment(s) 12/11/07
Brand Name of Product(s) Used Terminator
EPA Registration No. 7969-210
Approximate Final Mix Solution % .06%
Approximate Size of Treatment Area: Sq. ft. 720 Linear ft. _____ Linear ft. of Masonry Voids _____
Approximate Total Gallons of Solution Applied 70 gals.
Was treatment completed on exterior? Yes No
Service Agreement Available? Yes No

Note: Some state laws require service agreements to be issued. This form does not preempt state law.

Attachments (List) _____

Comments _____

Name of Applicator(s) S. Gregory Certification No. (if required by State law) JF104376

The applicator has used a product in accordance with the product label and state requirements. All treatment materials and methods used comply with state and federal regulations.

Authorized Signature [Signature] Date 12/11/07

Warning: HUD will prosecute false claims and statements. Conviction may result in criminal and/or civil penalties. (18 U.S.C. 1001, 1010, 1012; 31 U.S.C. 3729, 3802)

Form NPCA-99-B may still be used

form HUD-NPCA-99-B (04/2003)

PRODUCT APPROVAL SPECIFICATION SHEET

As required by Florida Statute 553.842 and Florida Administrative Code 9B-72, please provide the information and approval numbers on the building components listed below if they will be utilized on the construction project for which you are applying for a building permit. We recommend you contact your local product supplier should you not know the product approval number for any of the applicable listed products. Statewide approved products are listed online @ www.floridabuilding.org

Category/Subcategory	Manufacturer	Product Description	Approval Number(s)
1. EXTERIOR DOORS			
A. SWINGING	RELIABILT	EXTERIOR SWINGING DOOR	FL 18 (3446)
B. SLIDING			
C. SECTIONAL/ROLL UP			
D. OTHER (GARAGE DOOR)	RELIABILT	SECTIONAL GARAGE DOOR	FL 697
2. WINDOWS			
A. SINGLE/DOUBLE HUNG			
B. HORIZONTAL SLIDER	BETTER BILT	SING. HUNG W WINDOWS (11124)	FL 663 (7085)
C. CASEMENT	(M.I. HOME PRODUCTS)		
D. FIXED			
E. MULLION			
F. SKYLIGHTS			
G. OTHER			
3. PANEL WALL			
A. SIDING			
B. SOFFITS			
C. STOREFRONTS			
D. GLASS BLOCK			
E. OTHER			
4. ROOFING PRODUCTS			
A. ASPHALT SHINGLES			
B. NON-STRUCT METAL			
C. ROOFING TILES			
D. SINGLE PLY ROOF			
E. OTHER			
5. STRUCT COMPONENTS			
A. WOOD CONNECTORS			
B. WOOD ANCHORS			
C. TRUSS PLATES			
D. INSULATION FORMS			
E. LINTELS			
F. OTHERS			
6. NEW EXTERIOR ENVELOPE PRODUCTS			
A.			

The products listed below did not demonstrate product approval at plan review. I understand that at the time of inspection of these products, the following information must be available to the inspector on the jobsite; 1) copy of the product approval, 2) performance characteristics which the product was tested and certified to comply with, 3) copy of the applicable manufacturers installation requirements. Further, I understand these products may have to be removed if approval cannot be demonstrated during inspection.

 APPLICANT SIGNATURE

11/20/2007
 DATE