



STATE OF FLORIDA
DEPARTMENT OF ENVIRONMENTAL PROTECTION
ONSITE SEWAGE TREATMENT AND DISPOSAL
SYSTEM (OSTDS)

PERMIT NO. 25-0842
DATE PAID: 4/14/25
FEE PAID: 60.00
RECEIPT #: 2207561

APPLICATION FOR CONSTRUCTION PERMIT

APPLICATION FOR:

☐ New System ☒ Existing System ☐ Holding Tank ☐ Innovative
☐ Repair ☐ Abandonment ☐ Temporary ☐

APPLICANT: David Morrell EMAIL: provisionpermitting@gmail.com
AGENT: Sonja North TELEPHONE: 386-365-7640
MAILING ADDRESS: 212 SW Cottage Glen Lake City FL 32024

TO BE COMPLETED BY APPLICANT OR APPLICANT'S AUTHORIZED AGENT. SYSTEMS MUST BE CONSTRUCTED BY A PERSON LICENSED PURSUANT TO 489.105(3)(m) OR 489.552, FLORIDA STATUTES. IT IS THE APPLICANT'S RESPONSIBILITY TO PROVIDE DOCUMENTATION OF THE DATE THE LOT WAS CREATED OR PLATTED (MM/DD/YY) IF REQUESTING CONSIDERATION OF STATUTORY GRANDFATHER PROVISIONS.

PROPERTY INFORMATION

OSTDS REMEDIATION PLAN? ☐ Y / ☐ N

LOT: _____ BLOCK: _____ SUBDIVISION: _____ PLATTED: _____

PROPERTY ID #: D3-4S-16-02741-003 ZONING: _____ I/M OR EQUIVALENT: ☐ Y / ☐ N

PROPERTY SIZE: 18.73 ACRES WATER SUPPLY: ☒ PRIVATE PUBLIC ☐ ≤ 2000 GPD ☐ > 2000 GPD

IS SEWER AVAILABLE AS PER 381.0065, FS? ☐ Y / ☐ N DISTANCE TO SEWER: _____ FT

PROPERTY ADDRESS: 212 SW Cottage Glen Lake City FL 32024

DIRECTIONS TO PROPERTY: R on US-90 W, L on CR 252B,
L on SW Cottage Glen, property on R

BUILDING INFORMATION

☒ RESIDENTIAL ☐ COMMERCIAL

| Unit No | Type of Establishment | No. of Bedrooms | Building Area Sqft | Commercial/Institutional System Design Table I, Chapter 62-6, FAC |
|---------|-----------------------|-----------------|--------------------|---|
| 1 | Pool Pavilion | 0 | 590 | |
| 2 | | | | |
| 3 | | | | |
| 4 | | | | |

☐ Floor/Equipment Drains ☐ Other (Specify) _____

SIGNATURE: Sonja North DATE: _____

STATE OF FLORIDA
DEPARTMENT OF ENVIRONMENTAL PROTECTION
APPLICATION FOR CONSTRUCTION PERMIT

Permit Application Number

25-0842

----- PART II - SITEPLAN -----

Scale: Each block represents 10 feet and 1 inch = 40 feet.

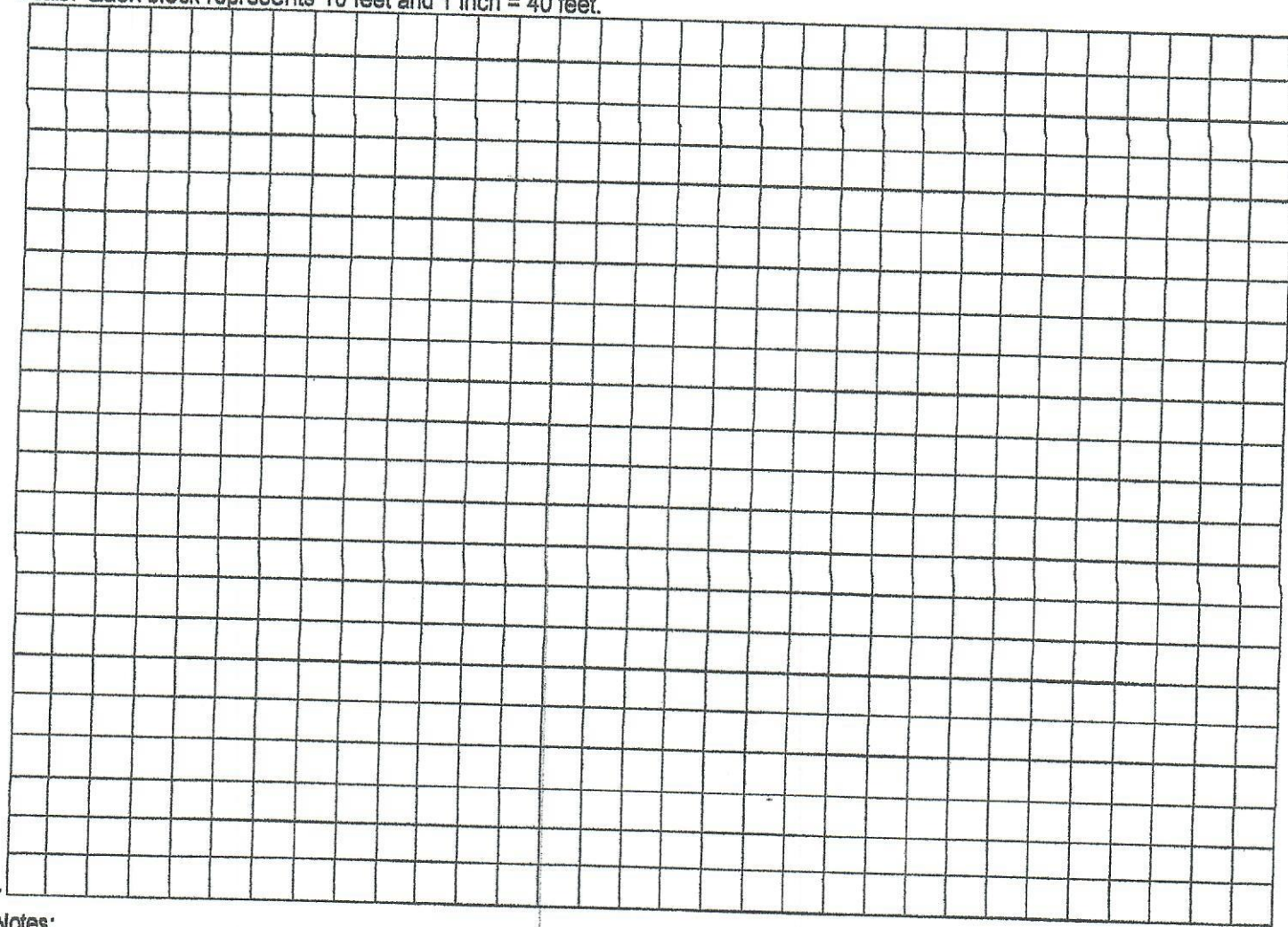

Notes: _____

Site Plan submitted by: Sara Noh

Plan Approved _____ Not Approved _____ Date _____

By _____ County Health Department

ALL CHANGES MUST BE APPROVED BY THE COUNTY HEALTH DEPARTMENT

DEP 4015, 06-21-2022 (Obsoletes previous editions which may not be used)

Incorporated: 62-6.004, F.A.C.

STATE OF FLORIDA
DEPARTMENT OF ENVIRONMENTAL PROTECTION
APPLICATION FOR CONSTRUCTION PERMIT

Permit Application Number

25-0342

PART II - SITEPLAN

Scale: Each block represents 10 feet and 1 inch = 40 feet.

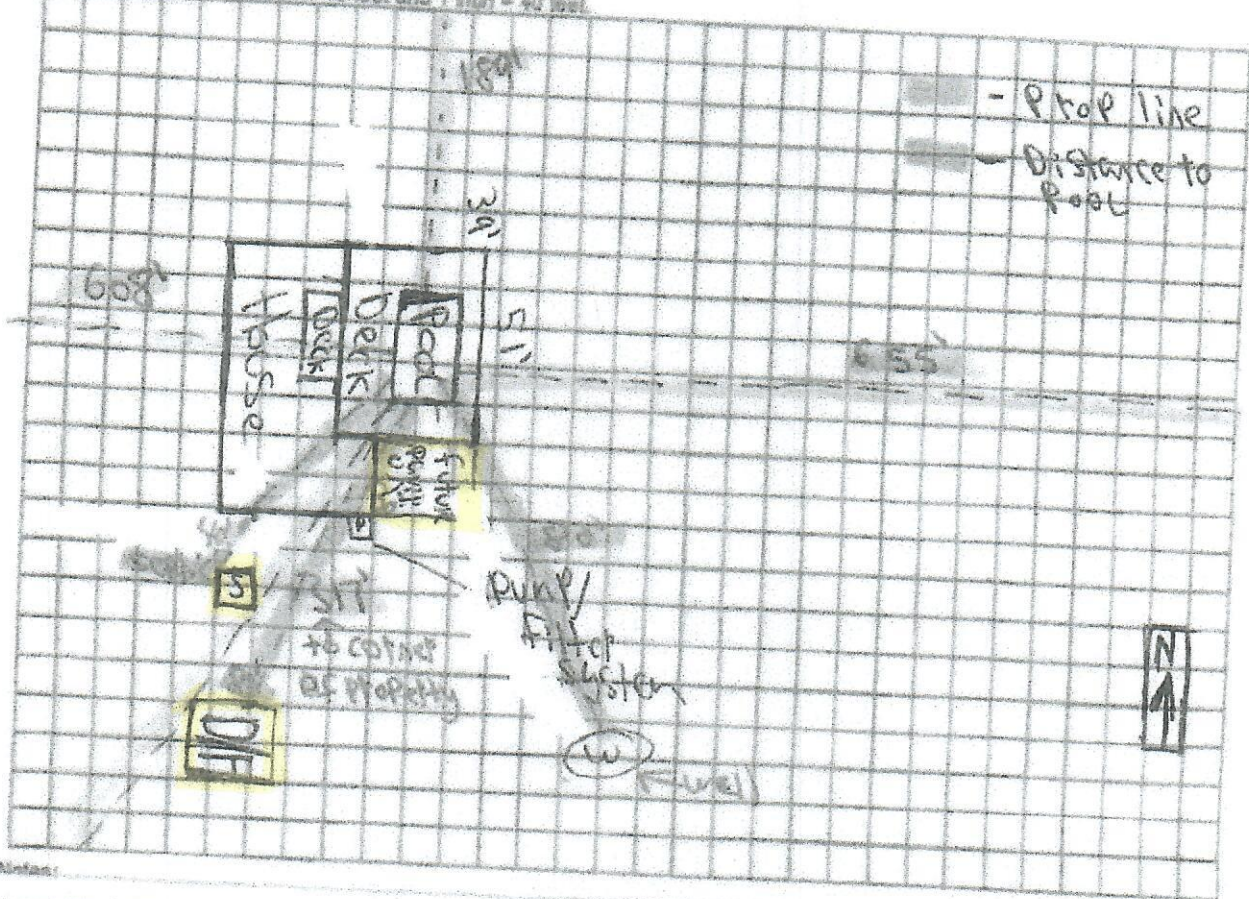

Site Plan submitted by:

Sara North

Plan Approved

[Signature]

Not Approved

Columb

Date 4/15/25

County Health Department

ALL CHANGES MUST BE APPROVED BY THE COUNTY HEALTH DEPARTMENT

DEP 4015, 06-21-2022 (Obsoletes previous editions which may not be used)
Incorporated: 62-6.004, F.A.C.