



STATE OF FLORIDA
DEPARTMENT OF HEALTH
ONSITE SEWAGE TREATMENT AND DISPOSAL
SYSTEM
APPLICATION FOR CONSTRUCTION PERMIT

PERMIT NO. 22-0359
DATE PAID: 7/20/22
FEE PAID: 600.00
RECEIPT #: 1829518

APPLICATION FOR:

☐ New System ☒ Existing System ☐ Holding Tank ☐ Innovative
☐ Repair ☐ Abandonment ☐ Temporary ☐

APPLICANT: B Simple Investment Properties, Inc

AGENT: Josh Sullivan

TELEPHONE: 352-443-3139

MAILING ADDRESS: 15815 129th Road McAlpin FL, 32062

TO BE COMPLETED BY APPLICANT OR APPLICANT'S AUTHORIZED AGENT. SYSTEMS MUST BE CONSTRUCTED BY A PERSON LICENSED PURSUANT TO 489.105(3)(m) OR 489.552, FLORIDA STATUTES. IT IS THE APPLICANT'S RESPONSIBILITY TO PROVIDE DOCUMENTATION OF THE DATE THE LOT WAS CREATED OR PLATTED (MM/DD/YY) IF REQUESTING CONSIDERATION OF STATUTORY GRANDFATHER PROVISIONS.

PROPERTY INFORMATION

LOT: _____ BLOCK: _____ SUBDIVISION: _____ PLATTED: _____

PROPERTY ID #: 21-35-16-02215-016 ZONING: single family 0100 I/M OR EQUIVALENT: ☐ Y ☐ N

PROPERTY SIZE: 1 ACRES WATER SUPPLY: ☒ PRIVATE PUBLIC ☐ ☐ <=2000GPD ☐ >2000GPD

IS SEWER AVAILABLE AS PER 381.0065, FS? ☒ Y ☐ N DISTANCE TO SEWER: _____ FT

PROPERTY ADDRESS: 2170 NW Turner Ave, Lake City FL, 32055

DIRECTIONS TO PROPERTY: Go west on NE Franklin street, turn right on NW Main Blvd, then turn left on NW Bascorn Norris Dr, then turn right on NW Lake Jeffery RD, then turn left on NW Nish Rd, then turn left on NW Turner Ave.

House is on the right

BUILDING INFORMATION

☒ RESIDENTIAL ☐ COMMERCIAL

Unit No	Type of Establishment	No. of Bedrooms	Building Area Sqft	Commercial/Institutional System Design Table 1, Chapter 64E-6, FAC
1	<u>Doublewide Mobile home</u>	<u>3</u>	<u>1,792</u>	<u>Resepect (onsite mh)</u>
2				
3				<u>ORIGINAL ATTACHED</u>
4				

☐ Floor/Equipment Drains ☐ Other (Specify) _____

SIGNATURE: _____

DATE: 4-20-2022

STATE OF FLORIDA
DEPARTMENT OF HEALTH
APPLICATION FOR CONSTRUCTION PERMIT

Permit Application Number

22-0359

PART II - SITEPLAN

Scale: Each block represents 10 feet and 1 inch = 40 feet.

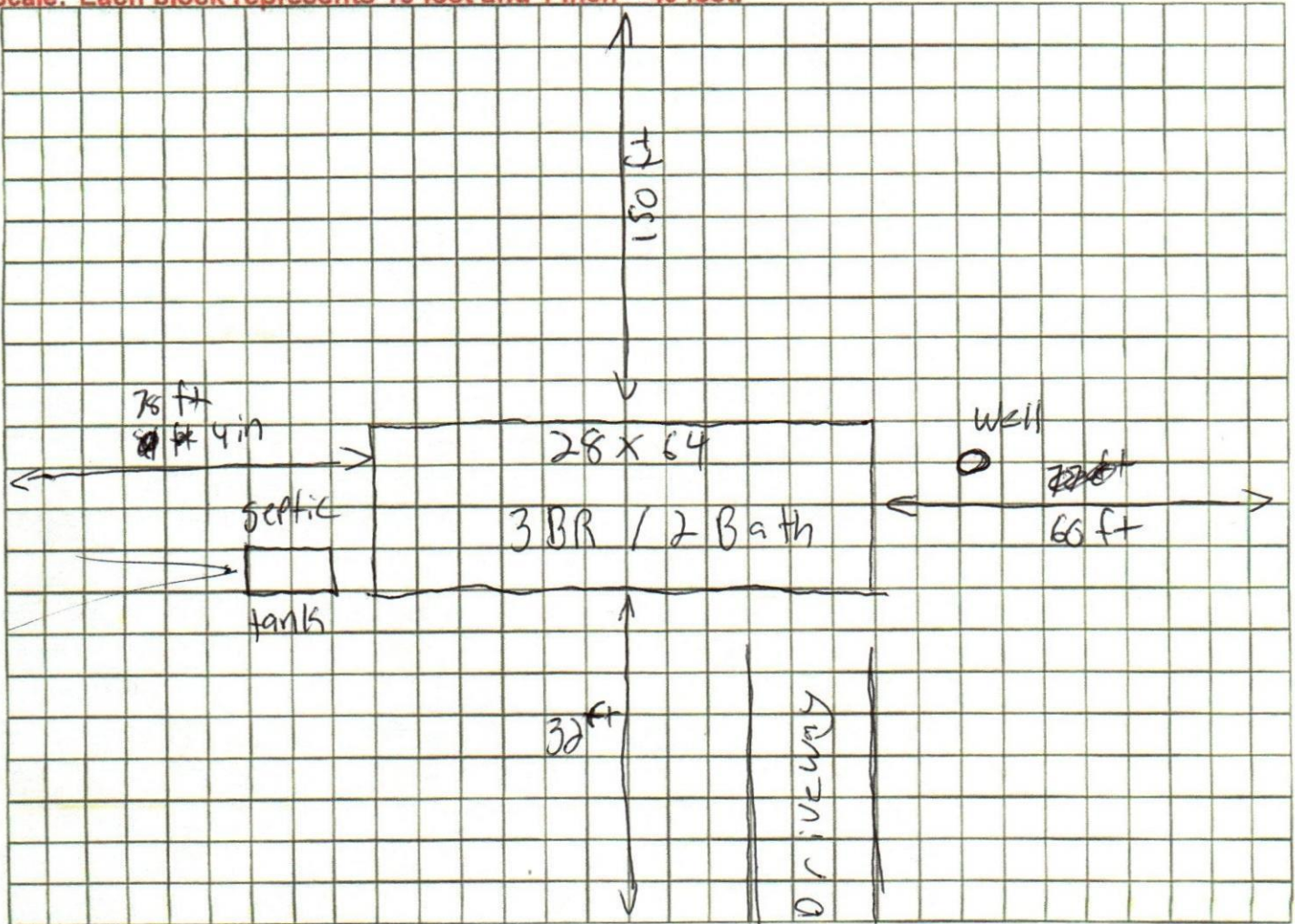

Notes: from the septic to the well is 86 ft 4 in
1 AC

Site Plan submitted by:

[Signature]

TITLE

DATE:

4-20-2022

Plan Approved

[Signature]

Not Approved

Columbia CHD

Date

5/2/22

By

County Health Department

ALL CHANGES MUST BE APPROVED BY THE COUNTY HEALTH DEPARTMENT