

Avis Budget
Push Through

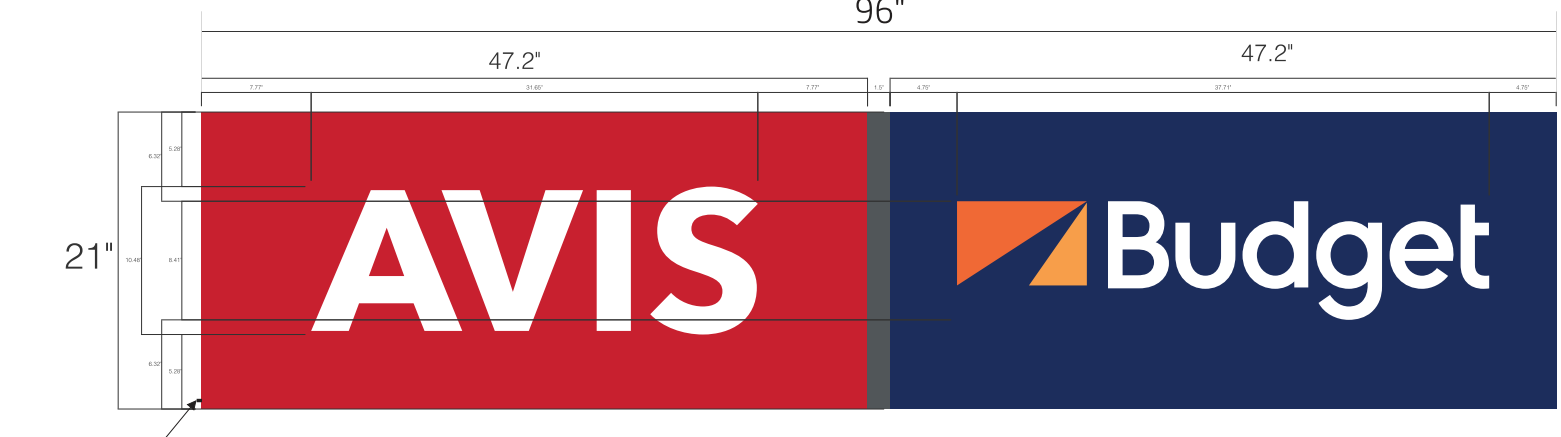

DISCONNECT SWITCH

COPY AREA: 14 SF

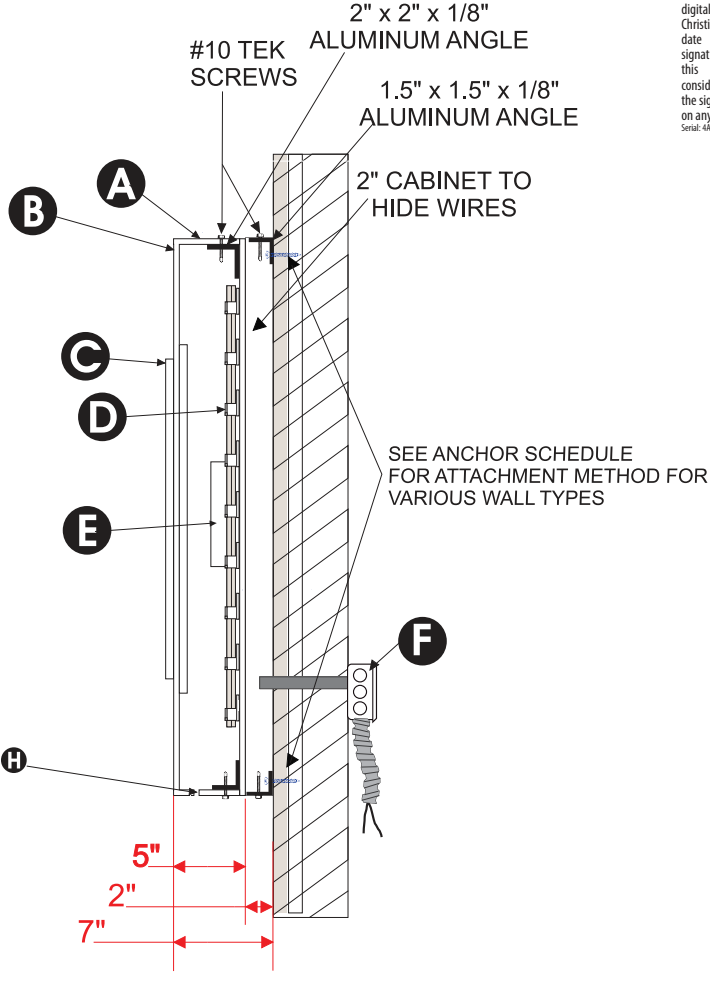

- A. 5" .080 ALUMINUM RETURN PAINTED AVIS RED AND BUDGET BLUE
- B. .125" ALUMINUM FACE PAINTED AVIS RED AND BUDGET BLUE
- C. 3/4" WHITE PUSH-THRU ACRYLIC
- D. WHITE LED LIGHTING
- E. SELF CONTAINED POWER SUPPLY
- F. LETTER INTERIOR PAINTED WHITE
- G. ELECTRICAL PRIMARY THRU 1/2" SEALTITE AND WHIPS AS REQUIRED
- H. 1/4" WEEP HOLES AT LOWEST POINTS

ALL WALL PENETRATIONS PROPERLY SEALED

ANCHOR SCHEDULE		**ALL FASTENERS SHALL BE SPACED EVENLY**
WALL MATERIAL	ANCHOR TYPE	QTY or SPACING
CONCRETE (3ksi) or HOLLOW MASONRY	1/4" THREADED RODS WITH MIN 2" EMBED IN ADHESIVE	--NOT APPLICABLE--
	1/4" TAPCONS (OR EQUIV) WITH 1.75" EMBED	MIN (6) TOTAL
	1/4" EXPANSION ANCHORS WITH 2.5" EMBED	MIN (6) TOTAL
1/2" PLYWOOD (NO ACCESS BEHIND)	1/4" TOGGLE BOLTS	MIN (6) TOTAL
	1/4" WOOD SCREWS, FULL EMBED	MIN (6) TOTAL
METAL STUDS / PANELS	#14 METAL SCREWS TO MIN 18ga STEEL OR 0.090" ALUM	MIN (6) TOTAL
HOLLOW WALL + BLOCKING	1/4" THRU BOLTS OR LAGS TO SOLID BLOCKING BEHIND	MIN (6) TOTAL

This document has been digitally signed and sealed by Christian Langley, PE on the date noted in this digital signature. Printed copies of this document are not considered signed & sealed, & the signature must be verified on any electronic copies. Serial: 44 49 9F 53 22 18 30 10 22 90 96 67

Digitally signed by Christian Langley
Date: 2022.03.10 13:59:35 -05'00'

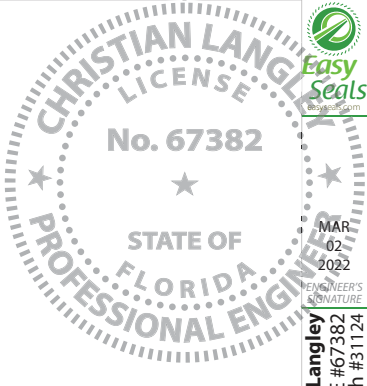

ELECTRICAL NOTES
TOTAL AMPS: 1.1
1-120V / 20 AMP CIRCUIT REQUIRED

GENERAL NOTES:
THIS SIGN IS TO BE INSTALLED IN ACCORDANCE WITH THE REQUIREMENTS OF ARTICLE 600 OF THE CURRENT NATIONAL ELECTRICAL CODE.
1. GROUNDED AND BONDED PER NEC 600.7 / NEC 250
2. EXISTING BRANCH CIRCUIT IN COMPLIANCE WITH NEC 600.5 NOT TO EXCEED 20 AMPS
3. SIGN IS TO BE UL LISTED PER NEC 600.3
4. UL DISCONNECT SWITCH PER NEC 600.6 - REQUIRED PER SIGN COMPONENT BEFORE LEAVING MANUFACTURER.

WHITE SIGN CO.
www.WhiteSignCompany.com

JOB#: 6707
CLIENT:
AVIS BUDGET GROUP
2941 W US WHY 90 STE 105
LAKE CITY, FL 32055

PROJECT:
ILLUMINATED CABINET W/
PUSH THROUGH LETTERING

DATE: 03/01/22
REVISIONS:

DESIGNER: MG

SHEET NO: 1

General • Design is in accordance with the requirements of the Fla Bldg Code 7th Ed (2020) for use within & outside the High Velocity Hurricane Zone (HVHZ). • This engineering certifies only the structural integrity of those systems, components, and/or other construction explicitly specified herein. • Electrical notes, details, & specifications are provided by and are the sole responsibility of the electrical contractor. No electrical review has been performed and no certification of such is intended. • Structural design meets requirements of ACI 318-14, AISI 360-16, ADM1-15, & NDS-18, as applicable. • Steel components shall be coated, painted, or otherwise protected against corrosion per FBC Sec 2203.2/2222.6. • Alum components in contact with steel or embedded in concrete shall be painted or protected as prescribed in ADM1-15(1a), or plastic/neoprene spacers provided. • All exposed fasteners shall be S.S. or have a protective coating for corrosion protection. • All welding shall comply with AWS requirements. • Steel welds: E70xx electrodes. • Aluminum welds: 4043 filler alloy. • Alum extrusions: 6063-T6 or stronger, U.N.O.