

Mobile Home Permit Worksheet

Application Number: _____

Date: _____

POCKET PENETROMETER TEST

The pocket penetrometer tests are rounded down to _____ psf or check here to declare 1000 lb. soil XX without testing.

x 1000 x 1000 x 1000

POCKET PENETROMETER TESTING METHOD

1. Test the perimeter of the home at 6 locations.
2. Take the reading at the depth of the footer.
3. Using 500 lb. increments, take the lowest reading and round down to that increment.

x 1000 x 1000 x 1000

TORQUE PROBE TEST

The results of the torque probe test is N/A inch pounds or check here if you are declaring 5' anchors without testing _____. A test showing 275 inch pounds or less will require 5 foot anchors.

Note: A state approved lateral arm system is being used and 4 ft. anchors are allowed at the sidewall locations. I understand 5 ft anchors are required at all centerline tie points where the torque test reading is 275 or less and where the mobile home manufacturer may requires anchors with 4000 lb holding capacity.

WPA Installer's initials

ALL TESTS MUST BE PERFORMED BY A LICENSED INSTALLER

Installer Name

William Price

Date Tested

8/15/24

Electrical

Connect electrical conductors between multi-wide units, but not to the main power source. This includes the bonding wire between multi-wide units. Pg. 1

Plumbing

Connect all sewer drains to an existing sewer tap or septic tank. Pg. 1

Connect all potable water supply piping to an existing water meter, water tap, or other independent water supply systems. Pg. 1

Site Preparation

Debris and organic material removed _____

Water drainage: Natural _____ Swale _____ Pad XX Other _____

Fastening multi wide units

Floor: Type Fastener: 1/4" x 3" screws Length: _____ Spacing: 18"
Walls: Type Fastener: 1/4" x 3" screws Length: _____ Spacing: 18"
Roof: Type Fastener: 1/4" x 3" screws Length: _____ Spacing: 18"

For used homes a min. .30 gauge, 8" wide, galvanized metal strip will be centered over the peak of the roof and fastened with galv. roofing nails at 2" on center on both sides of the centerline.

Gasket (weatherproofing requirement)

I understand a properly installed gasket is a requirement of all new and used homes and that condensation, mold, mildew and buckled marriage walls are a result of a poorly installed or no gasket being installed. I understand a strip of tape will not serve as a gasket.

Installer's initials

WPA

Type gasket

FOAM

Installed:

Between Floors Yes ✓

Between Walls Yes ✓

Bottom of ridgebeam Yes ✓

Weatherproofing

The bottomboard will be repaired and/or taped. Yes ✓ Pg. _____

Siding on units is installed to manufacturer's specifications. Yes ✓

Fireplace chimney installed so as not to allow intrusion of rain water. Yes ✓

Miscellaneous

Skirting to be installed. Yes ✓ No ✓

Dryer vent installed outside of skirting. Yes ✓ N/A ✓

Range downflow vent installed outside of skirting. Yes ✓ N/A ✓

Drain lines supported at 4 foot intervals. Yes ✓

Electrical crossovers protected. Yes ✓

Other: _____

Installer verifies all information given with this permit worksheet is accurate and true based on the manufacturer's installation instructions and or Rule 15C-1 & 2

Installer Signature

Date

Mobile Home Permit Worksheet

Application Number: _____

Date: _____

Installer: William Price License # 14-1041434

Address of home being installed

7800 Old Central Tex
Fort Worth TX 76103

Manufacturer

Champion

Length x width

48x24

NOTE: if home is a single wide fill out one half of the blocking plan if home is a triple or quad wide sketch in remainder of home

I understand Lateral Arm Systems cannot be used on any home (new or used) where the sidewall ties exceed 5 ft 4 in.

Installer's Initials

WEP

Typical pier spacing

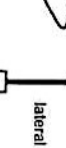

Show locations of Longitudinal and Lateral Systems (use dark lines to show these locations)

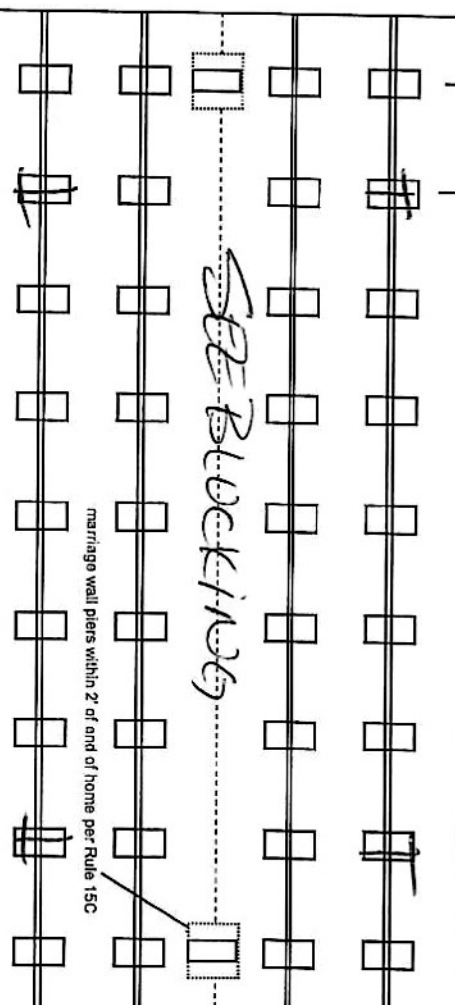

471102V
Oliver System

New Home ☒ Used Home ☐

Home installed to the Manufacturer's Installation Manual Home is installed in accordance with Rule 15-C ☒

Single wide ☐ Wind Zone II ☒ Wind Zone III ☐

Double wide ☒ Installation Decal # 1100231

Triple/Quad ☐ Serial # 7800

PIER SPACING TABLE FOR USED HOMES

Load bearing capacity	Footer size (sq in)	16' x 16" (256)	18 1/2" x 18 1/2" (342)	20" x 20" (400)	22" x 22" (484)*	24" x 24" (576)*	26" x 26" (676)
1000 psf	3'	4'	5'	6'	7'	8'	8'
1500 psf	4' 6"	6'	7'	8'	9'	10'	10'
2000 psf	6'	8'	9'	10'	11'	12'	12'
2500 psf	7' 6"	9'	10'	11'	12'	13'	13'
3000 psf	8'	10'	11'	12'	13'	14'	14'
3500 psf	8'	10'	11'	12'	13'	14'	14'

* interpolated from Rule 15C-1 pier spacing table.

PIER PAD SIZES

I-beam pier pad size 17x25

Perimeter pier pad size 14x16

Other pier pad sizes (required by the mfg.) _____

POPULAR PAD SIZES

Pad Size	Sq In
16 x 16	256
16 x 18	288
18.5 x 18.5	342
16 x 22.5	360
17 x 22	374
13 1/4 x 26 1/4	348
20 x 20	400
17 3/16 x 25 3/16	441
17 1/2 x 25 1/2	446
24 x 24	576
26 x 26	676

Draw the approximate locations of marriage wall openings 4 foot or greater. Use this symbol to show the piers.

List all marriage wall openings greater than 4 foot and their pier pad sizes below.

Opening large Pier pad size 23x31

ANCHORS

FRAME TIES

4 ft 16 5 ft 16

TIEDOWN COMPONENTS

OTHER TIES

Longitudinal Stabilizing Device (LSD) Manufacturer _____

Longitudinal Stabilizing Device w/ Lateral Arms Manufacturer Oliver Tech

Sidewall Longitudinal Marriage wall Shearwall _____

Number _____

12.1

48'-0"

12.1

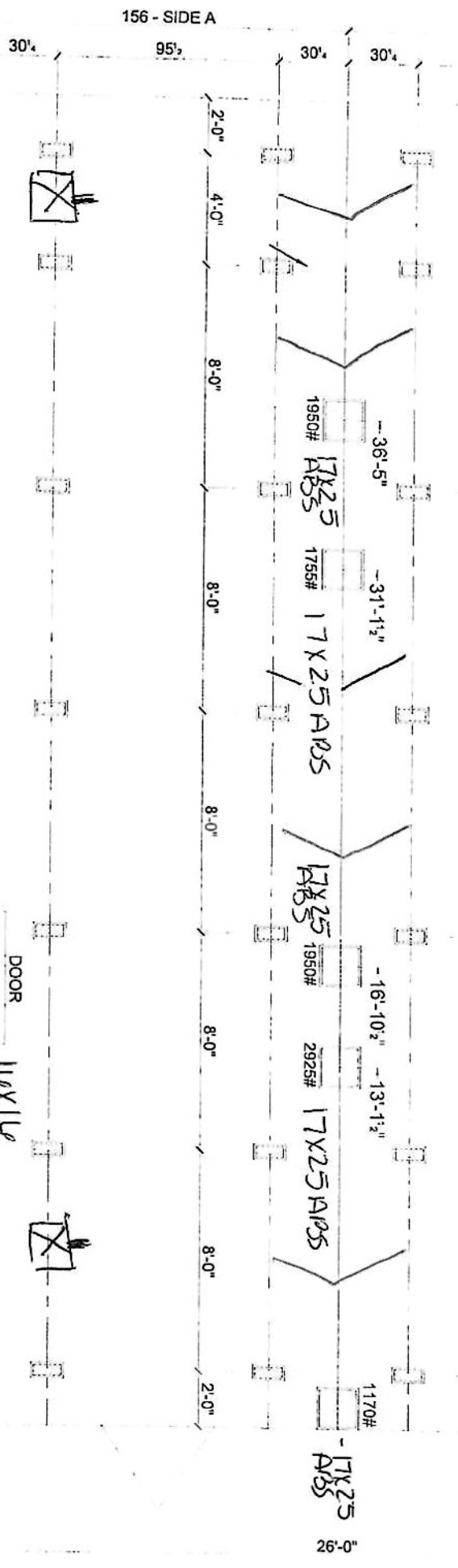
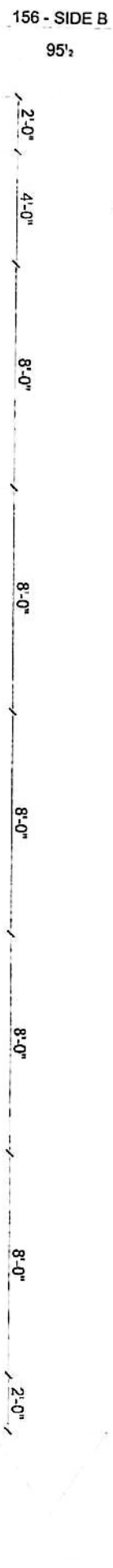
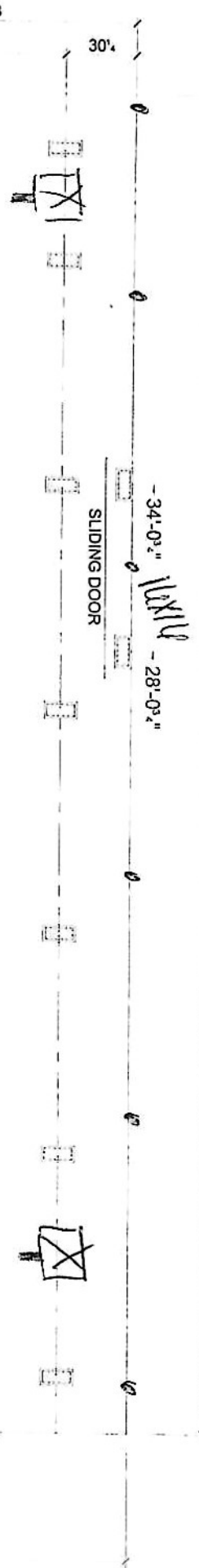

12.1
tie columns - 48' anchor 5 1/4" dia
MARRIAGE LINE OPENING SUPPORT PIERTYP. - 17X25 ARBS OR 23X31 ARBS OR 17X25 ARBS triple stacked

SUPPORT PIERTYP - 17X25 ARBS w/ 8x8x16 5' dia
FOUNDATION NOTES: 1) - Oliver system 2) double frame tie - 48' anchors from end then
- THIS DRAWING IS DESIGNED FOR THE STANDARD WIND ZONE AND IS TO BE USED IN CONJUNCTION WITH THE INSTALLATION MANUAL AND ITS SUPPLEMENTS.
- FOOTINGS ARE SHOWN FOR EXAMPLE ONLY QUANTITY AND SPACING MAY VARY BASED ON PAD TYPE, SOIL CONDITION, ETC.
- FOOTINGS ARE REQUIRED AT SUPPORT POSTS, SEE INSTALLATION MANUAL FOR REQUIREMENTS.

ScotBilt
HOMES, INC.

2848302GSM

GRANDSLAM
28 X 52 - 3BR 2 BATH

DATE	4-27-2021	AREA	1,144 SQ. FT.	TOTAL SQUARE FOOTAGE	1,144 SQ. FT.
VERSION	B				
					0 SQ. FT.

Dentis

28x48

Commercial
Homeowner

License Number: IH / 1041936 / 1 Name: WILLIAM R PRICE

Order #: 6208

Label #: 110239

Manufacturer:

(Check Size of Home)

Homeowner:

Year Model:

Single _____

Address:

Length & Width:

Double _____

City/State/Zip:

Type Longitudinal System:

Triple _____

Phone #:

Type Lateral Arm System:

HUD Label #:

Date Installed:

New Home: _____ Used Home: _____

Soil Bearing / PSF:

Installed Wind Zone:

Data Plate Wind Zone:

Torque Probe / in-lbs:

Permit #:

Note:

STATE OF FLORIDA
INSTALLATION CERTIFICATION LABEL

110239

LABEL #

DATE OF INSTALLATION

WILLIAM R PRICE

NAME

IH / 1041936 / 1

6208

LICENSE #

ORDER #

CERTIFIES THAT THE INSTALLATION OF THIS MOBILE HOME IS
IN ACCORDANCE WITH FLORIDA STATUTES 320.8249, 320.8325
AND RULES OF THE HIGHWAY SAFETY AND MOTOR VEHICLES.

INSTRUCTIONS

PLEASE WRITE DATE OF
INSTALLATION AND AFFIX
LABEL NEXT TO HUD LABEL.
USE PERMANENT INK PEN
OR MARKER ONLY.
COMPLETE INFORMATION
ABOVE AND KEEP ON FILE
FOR A MINIMUM OF 2 YEARS.
YOU ARE REQUIRED TO
PROVIDE COPIES WHEN
REQUESTED.