

Mobile Home Permit Worksheet

Installer: ROY M. HARVEY License # IH1122397

Address of home being installed _____

Manufacturer CLAYTON Length x width 15'X 76'

NOTE: if home is a single wide fill out one half of the blocking plan if home is a triple or quad wide sketch in remainder of home I understand Lateral Arm Systems cannot be used on any home (new or used) where the sidewall ties exceed 5 ft 4 in.

Installer's initials JMH

Typical pier spacing

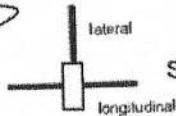
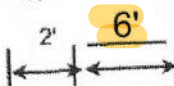

Show locations of Longitudinal and Lateral Systems (use dark lines to show these locations)

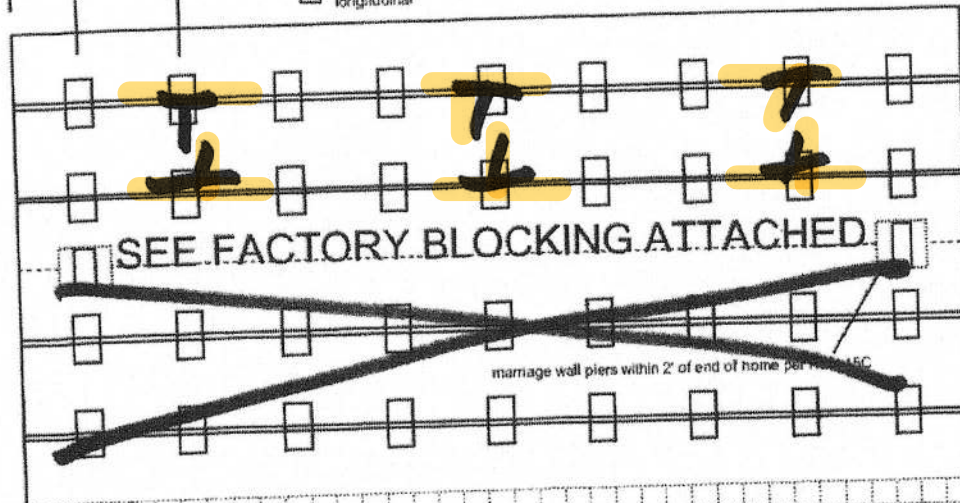

SEE FACTORY BLOCKING ATTACHED

marriage wall piers within 2' of end of home per Rule 15C



Anthony Isler

09-14-2022

Permit Number: _____

Date: 9/1/02

New Home ☒

Used Home ☐

Home installed to the Manufacturer's Installation Manual ☒
Home is installed in accordance with Rule 15-C ☐

Single wide ☒

Wind Zone II ☒

Wind Zone III ☐

Double wide ☐

Installation Decal # _____

Triple/Quad ☐

Serial # _____

PIER SPACING TABLE FOR USED HOMES

Load bearing capacity	Footer size (sq in)	16" x 16" (256)	18 1/2" x 18 1/2" (342)	20" x 20" (400)	22" x 22" (484)*	24" X 24" (576)*	26" x 26" (676)
1000 psf		3'	4'	5'	6'	7'	8'
1500 psf		4' 6"	6'	7'	8'	8'	8'
2000 psf		6'	8'	8'	8'	8'	8'
2500 psf		7' 6"	8'	8'	8'	8'	8'
3000 psf		8'	8'	8'	8'	8'	8'
3500 psf		8'	8'	8'	8'	8'	8'

* interpolated from Rule 15C-1 pier spacing table.

PIER PAD SIZES

I-beam pier pad size 17"X 25

Perimeter pier pad size _____

Other pier pad sizes (required by the mfg.) _____

Draw the approximate locations of marriage wall openings 4 foot or greater. Use this symbol to show the piers.

List all marriage wall openings greater than 4 foot and their pier pad sizes below.

Opening _____

Pier pad size _____

POPULAR PAD SIZES

Pad Size	Sq In
16 x 16	256
16 x 18	288
18.5 x 18.5	342
16 x 22.5	360
17 x 22	374
13 1/4 x 26 1/4	348
20 x 20	400
17 3/16 x 25 3/16	441
17 1/2 x 25 1/2	446
24 x 24	576
26 x 26	676

ANCHORS

4 ft ☒ 5 ft _____

FRAME TIES

within 2' of end of home spaced at 5' 4" oc

OTHER TIES

Number _____

Longitudinal Stabilizing Device (LSD) Manufacturer OLIVER TECH

Longitudinal Stabilizing Device w/ Lateral Arms Manufacturer OLIVER TECH

Sidewall _____

Longitudinal _____

Marriage wall _____

Shearwall _____

Mobile Home Permit Worksheet

POCKET PENETROMETER TEST

The pocket penetrometer tests are rounded down to 1500 psf or check here to declare 1000 lb. soil _____ without testing.

x 1700 x 1700 x 1700

POCKET PENETROMETER TESTING METHOD

1. Test the perimeter of the home at 6 locations.
2. Take the reading at the depth of the footer.
3. Using 500 lb. increments, take the lowest reading and round down to that increment.

x 1700 x 1700 x 1700

TORQUE PROBE TEST

The results of the torque probe test is NA inch pounds or check here if you are declaring 5' anchors without testing _____. A test showing 275 inch pounds or less will require 5 foot anchors.

Note: A state approved lateral arm system is being used and 4 ft. anchors are allowed at the sidewall locations. I understand 5 ft anchors are required at all centerline tie points where the torque test reading is 275 or less and where the mobile home manufacturer may require anchors with 4000 lb. loading capacity.

Installer's initials _____

ALL TESTS MUST BE PERFORMED BY A LICENSED INSTALLER

Installer Name ROY M. HARVEY

Date Tested 8-22-02

Electrical

Connect electrical conductors between multi-wide units, but not to the main power source. This includes the bonding wire between multi-wide units. Pg. NA

Plumbing

Connect all sewer drains to an existing sewer tap or septic tank. Pg. 98

Connect all potable water supply piping to an existing water meter, water tap, or other independent water supply systems. Pg. 98

Permit Number: _____

Date: 9-1-02

Site Preparation

Debris and organic material removed YES
Water drainage: Natural Swale Pad Other _____

Fastening multi wide units

Floor: Type Fastener: _____ Length: _____ Spacing: _____
Walls: Type Fastener: _____ Length: _____ Spacing: _____
Roof: Type Fastener: _____ Length: _____ Spacing: _____
For used homes a min. 30 gauge, 8" wide, galvanized metal strip will be centered over the peak of the roof and fastened with galv. roofing nails at 2" on center on both sides of the centerline.

Gasket (weatherproofing requirement)

I understand a properly installed gasket is a requirement of all new and used homes and that condensation, mold, mildew and buckled marriage walls are a result of a poorly installed or no gasket being installed. I understand a strip of tape will not serve as a gasket.

Installer's initials _____

Type gasket _____
Pg. _____

Installed NA
Between Floors Yes _____
Between Walls Yes _____
Bottom of ridgebeam Yes _____

Weatherproofing

The bottomboard will be repaired and/or taped. Yes X Pg. 112
Siding on units is installed to manufacturer's specifications. Yes _____
Fireplace chimney installed so as not to allow intrusion of rain water. Yes _____

Miscellaneous

Skirting to be installed. Yes X No _____
Dryer vent installed outside of skirting. Yes X N/A _____
Range downflow vent installed outside of skirting. Yes _____ N/A _____
Drain lines supported at 4 foot intervals. Yes X _____
Electrical crossovers protected. Yes NA _____
Other: _____

Installer verifies all information given with this permit worksheet is accurate and true based on the manufacturer's installation instructions and or Rule 15C-1 & 2

Installer Signature _____

Date 9-1-02

1500 LB SOIL.....16'X 76'
I BEAM PADS.....17"X 25..... 6'o/c
VECTOR STABILIZING SYSTEM
4' ANCHORS @ 5'4" OR LESS

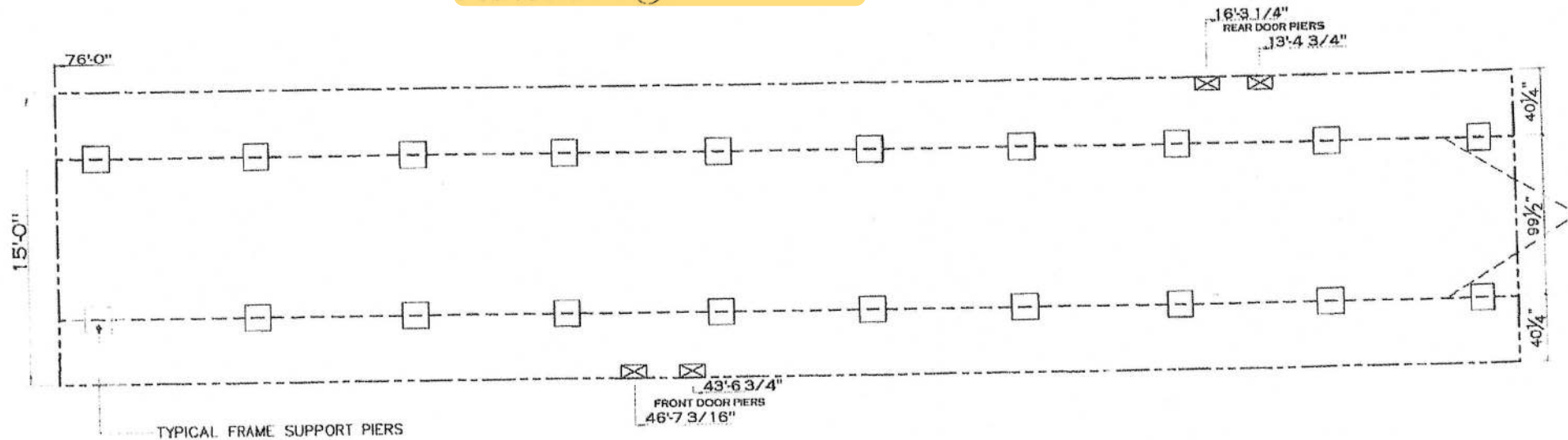

20 lb ROOF LOAD SIDEWALL OPENING PIER LOAD 16' BOX WIDTH	SIDEWALL OPENING (FT) REQUIRED PIER LOAD (LBS)					
	3	4	5	6	8	10
	1244	1413	1581	1750	2088	2425

*FOR 30 lb & 40 lb ROOF LOAD REFER TO TABLES 7 & 7a IN THE INSTALLATION MANUAL.

SERVICE DROP LEGEND	
[E]	= ELECTRICAL DROP
[W]	= WATER INLET
[D]	= DWV PLUMBING DROP
[G]	= GAS INLET

PIER LEGEND	
[]	= PIER MAIN BEAM
oo	= PIER PERIMETER
■	= PIER PORCH/RECESSED ENTRY

NOTES:

1. REFER TO TABLES 6 AND 6a IN THE INSTALLATION MANUAL FOR LOAD ON FRAME PIER FOOTINGS FOR HOMES THAT DO NOT REQUIRE PERIMETER BLOCKING. REFER TO TABLES 7 AND 7a IN THE INSTALLATION MANUAL FOR LOAD ON FRAME PIER FOOTINGS FOR HOMES THAT REQUIRE PERIMETER BLOCKING. REFER TO TABLES 10 AND 10a TO DETERMINE FOOTING SIZE FOR ALL PIERS.
2. REFER TO TABLE 9 FOR PIER CONFIGURATION AND MAXIMUM ALLOWABLE HEIGHTS. CROSS REFERENCE THE PIER HEIGHT WITH THE MAXIMUM ALLOWABLE FLOOR HEIGHT LISTED IN THE FRAME TIEDOWN CHARTS (TABLE 18, 19, AND 20).
3. THE MAXIMUM SPACING FOR FRAME SUPPORT PIERS FOR 8" I-BEAMS IS 8 FEET, 10" & 12" I-BEAMS IS 10 FEET.
4. SERVICE DROP LOCATIONS IDENTIFIED ARE APPROXIMATE.
5. FLOOR WIDTH SHOWN IS FOR STANDARD PRODUCT ONLY. CONTACT THE MFG FOR SPECIFICATIONS OF OPTION.

1,140 SQ.FT. (STD PLAN "CONDITIONED")

CMH MANUFACTURING Product Designer: Alex Whaley	Model #: CEA167G3AH	Drawing #:
	Date: 1.25.19 Scale: N.T.S.	CE-5010-76-3
16x76' 5y		

3/26/2020 8:23 AM

FRAME PIERS

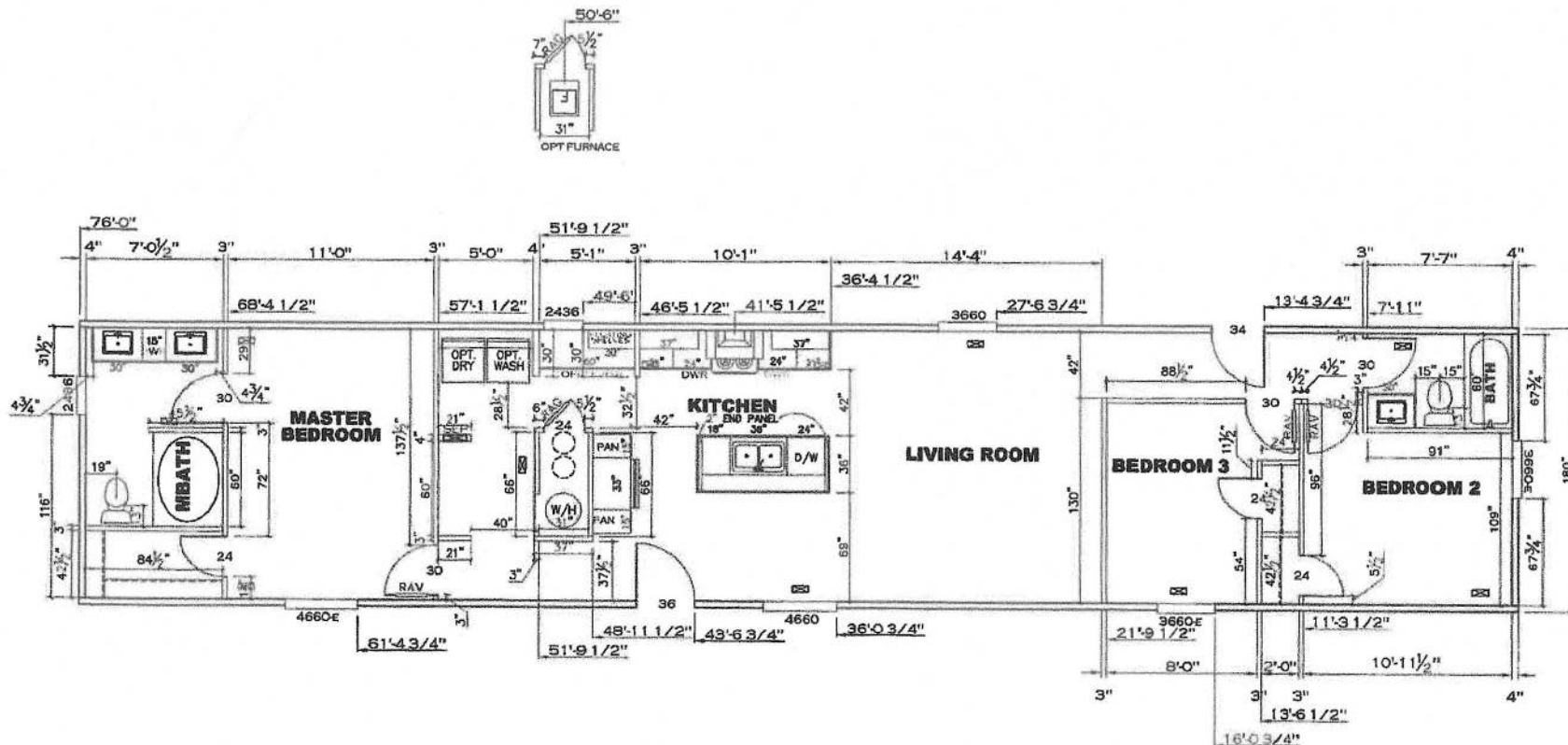

NOTE ALL FLOOR REGISTERS ARE 4x10 UNLESS OTHERWISE NOTED

1,140 SQ.FT. (STD PLAN "CONDITIONED")

REV:3/26/2020 8:23 AM

CMH MANUFACTURING	Model #: CEA16763AH	Drawing #:
	Date: 1.25.11	Scale: N.T.S. CE-5010-76-3
Product Designer: Alex Whaley	16'x76' Sydney	
FLOOR PLAN		