



STATE OF FLORIDA
DEPARTMENT OF HEALTH
ONSITE SEWAGE TREATMENT AND DISPOSAL
SYSTEM
APPLICATION FOR CONSTRUCTION PERMIT

PERMIT NO. 21-02158
DATE PAID: 2/14/21
FEE PAID: 68.00
RECEIPT #: 1439150

APPLICATION FOR:

☐ New System ☒ Existing System ☐ Holding Tank ☐ Innovative
☐ Repair ☐ Abandonment ☐ Temporary ☐

APPLICANT: Senn, David and Pamela

AGENT: Sparks Construction Inc

TELEPHONE: 386-755-9314

MAILING ADDRESS: 426 Sw commerce Dr. STE 130 Lake City, FL 32025

TO BE COMPLETED BY APPLICANT OR APPLICANT'S AUTHORIZED AGENT. SYSTEMS MUST BE CONSTRUCTED BY A PERSON LICENSED PURSUANT TO 489.105(3) (m) OR 489.552, FLORIDA STATUTES. IT IS THE APPLICANT'S RESPONSIBILITY TO PROVIDE DOCUMENTATION OF THE DATE THE LOT WAS CREATED OR PLATTED (MM/DD/YY) IF REQUESTING CONSIDERATION OF STATUTORY GRANDFATHER PROVISIONS.

PROPERTY INFORMATION

LOT: 22 BLOCK: N/A SUBDIVISION: Blackberry Farms PLATTED: _____

PROPERTY ID #: 17-3S-16-02168-122 ZONING: Res I/M OR EQUIVALENT: ☐ Y / ☒ N

PROPERTY SIZE: 2.54 ACRES WATER SUPPLY: ☒ PRIVATE PUBLIC ☐ ≤ 2000 GPD ☐ > 2000 GPD

IS SEWER AVAILABLE AS PER 381.0065, FS? ☐ Y / ☒ N DISTANCE TO SEWER: N/A FT

PROPERTY ADDRESS: 679 NW Blackberry Circle, Lake City, FL 32055

DIRECTIONS TO PROPERTY: Drive HWY 90 W, Right on Lake Jeffery Rd, Left on Nash Rd, Right on Blackberry Circle, keep left at fork, property on right around corner.

BUILDING INFORMATION

☒ RESIDENTIAL ☐ COMMERCIAL

Unit No	Type of Establishment	No. of Bedrooms	Building Area Sqft	Commercial/Institutional System Design Table 1, Chapter 64E-6, FAC
1	<u>Detached garage</u>	<u>0</u>	<u>624</u>	<u>21-0215</u>
2	_____	_____	_____	_____
3	_____	_____	_____	_____
4	_____	_____	_____	_____

☐ Floor/Equipment Drains ☐ Other (Specify) _____

SIGNATURE: [Signature] agent DATE: 3/18/21

**Application for Onsite Sewage Disposal System
Construction Permit. Part II Site Plan**

Permit Application Number: 21-0268

ALL CHANGES MUST BE APPROVED BY THE COUNTY HEALTH UNIT

NORTH

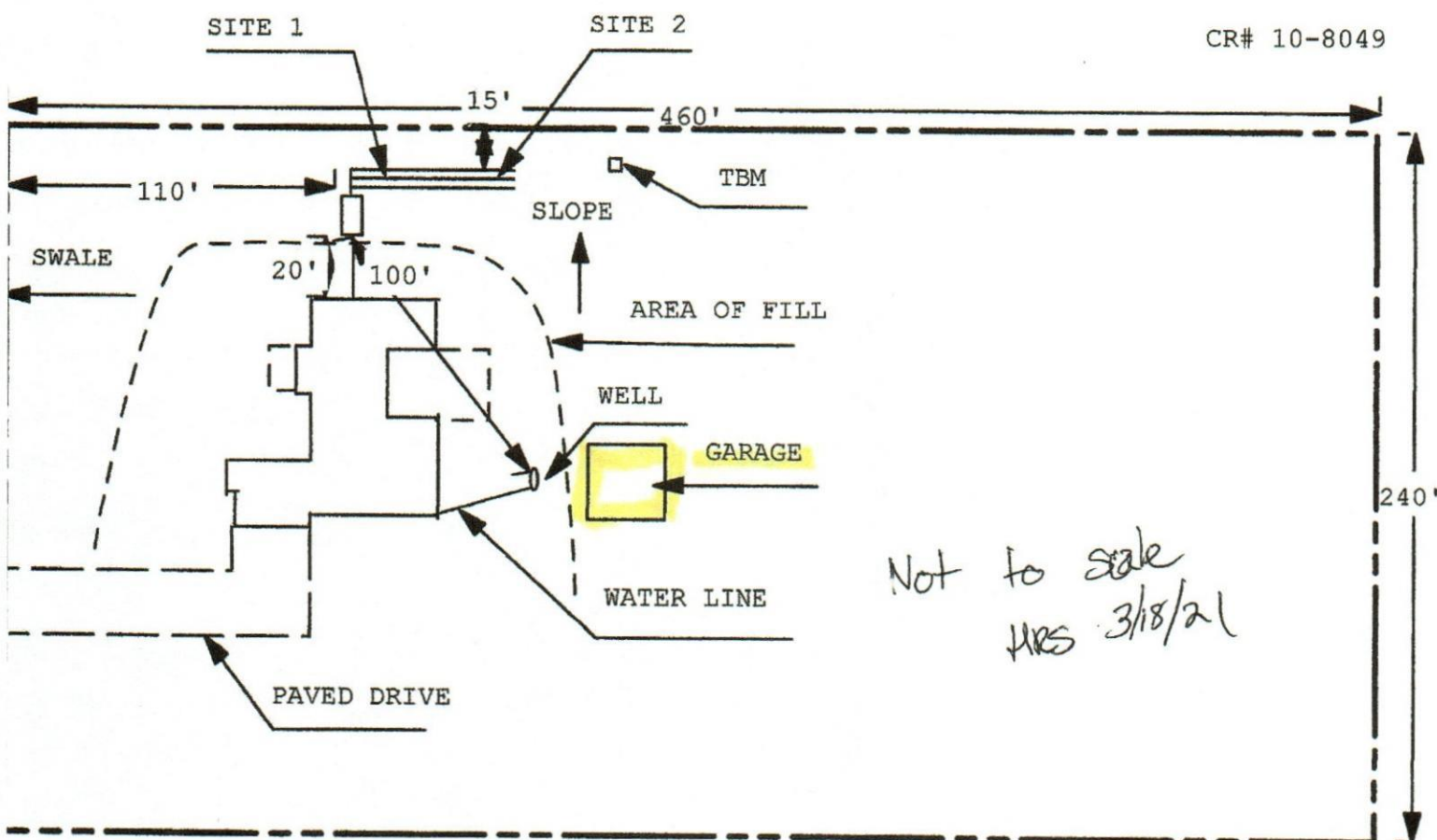

NO WELLS WITHIN 100'

1 INCH = 60 FEET

Site Plan Submitted By Paul Llay Date 3/3/21
Plan Approved ☒ Not Approved ☐ Date 3/3/21

by Sallie Ford Env Health Director 3.22.21 CPHU

Notes: _____
