

Mobile Home Permit Worksheet

Application Number: _____

Date: _____

POCKET PENETROMETER TEST

The pocket penetrometer tests are rounded down to _____ psf or check here to declare 1000 lb. soil X without testing.

X 1000 X _____ X 1000

POCKET PENETROMETER TESTING METHOD

1. Test the perimeter of the home at 6 locations.
2. Take the reading at the depth of the footer.
3. Using 500 lb. increments, take the lowest reading and round down to that increment.

X 1000 X 1000 X 1000

TORQUE PROBE TEST

The results of the torque probe test is 280 inch pounds or check here if you are declaring 5' anchors without testing. A test showing 275 inch pounds or less will require 5 foot anchors.

Note: A state approved lateral arm system is being used and 4 ft. anchors are allowed at the sidewall locations. I understand 5 ft anchors are required at all centerline tie points where the torque test reading is 275 or less and where the mobile home manufacturer may requires anchors with 4000 lb. holding capacity.

WFT Installer's initials

ALL TESTS MUST BE PERFORMED BY A LICENSED INSTALLER

Installer Name William Rine

Date Tested 3/13/24

Electrical

Connect electrical conductors between multi-wide units, but not to the main power source. This includes the bonding wire between multi-wide units. Pg. ✓

Plumbing

Connect all sewer drains to an existing sewer tap or septic tank. Pg. ✓

Connect all potable water supply piping to an existing water meter, water tap, or other independent water supply systems. Pg. ✓

Site Preparation

Debris and organic material removed 90%
Water drainage: Natural Swale Pad X Other _____

Fastening multi wide units

Floor: _____ Type Fastener: 1/4" x 3" Length: _____ Spacing: 2'-18" c/wt
Walls: _____ Type Fastener: 1/4" x 3" Length: _____ Spacing: 2'-18" c/wt
Roof: _____ Type Fastener: 1/4" x 3" Length: _____ Spacing: 2'-18" c/wt
For used homes a min. 30 gauge, 8" wide, galvanized metal strip will be centered over the peak of the roof and fastened with galv. roofing nails at 2" on center on both sides of the centerline.

Gasket (weatherproofing requirement)

I understand a properly installed gasket is a requirement of all new and used homes and that condensation, mold, mildew and buckled marriage walls are a result of a poorly installed or no gasket being installed. I understand a strip of tape will not serve as a gasket.

Installer's initials WFT

Type gasket FOAM
Pg. 3

Installed: _____
Between Floors Yes ✓
Between Walls Yes ✓
Bottom of ridgebeam Yes ✓

Weatherproofing

The bottomboard will be repaired and/or taped. Yes ✓ Pg. _____
Siding on units is installed to manufacturer's specifications. Yes ✓
Fireplace chimney installed so as not to allow intrusion of rain water. Yes ✓

Miscellaneous

Skirting to be installed. Yes ✓ No _____
Dryer vent installed outside of skirting. Yes ✓ N/A _____
Range downflow vent installed outside of skirting. Yes ✓ N/A _____
Drain lines supported at 4 foot intervals. Yes ✓ N/A _____
Electrical crossovers protected. Yes ✓ _____
Other: _____

Installer verifies all information given with this permit worksheet is accurate and true based on the manufacturer's installation instructions and or Rule 15C-1 & 2

Installer Signature [Signature]

Date 3/13/24

Mobile Home Permit Worksheet

Application Number: _____

Date: _____

Installer: William Pyle License # 14-1041936

Address of home being installed _____

Lake City FL 32024

Manufacturer Turn Home Length x width 60x32

NOTE: if home is a single wide fill out one half of the blocking plan
if home is a triple or quad wide sketch in remainder of home
I understand Lateral Arm Systems cannot be used on any home (new or used)
where the sidewall ties exceed 5 ft 4 in.

Installer's initials WPP

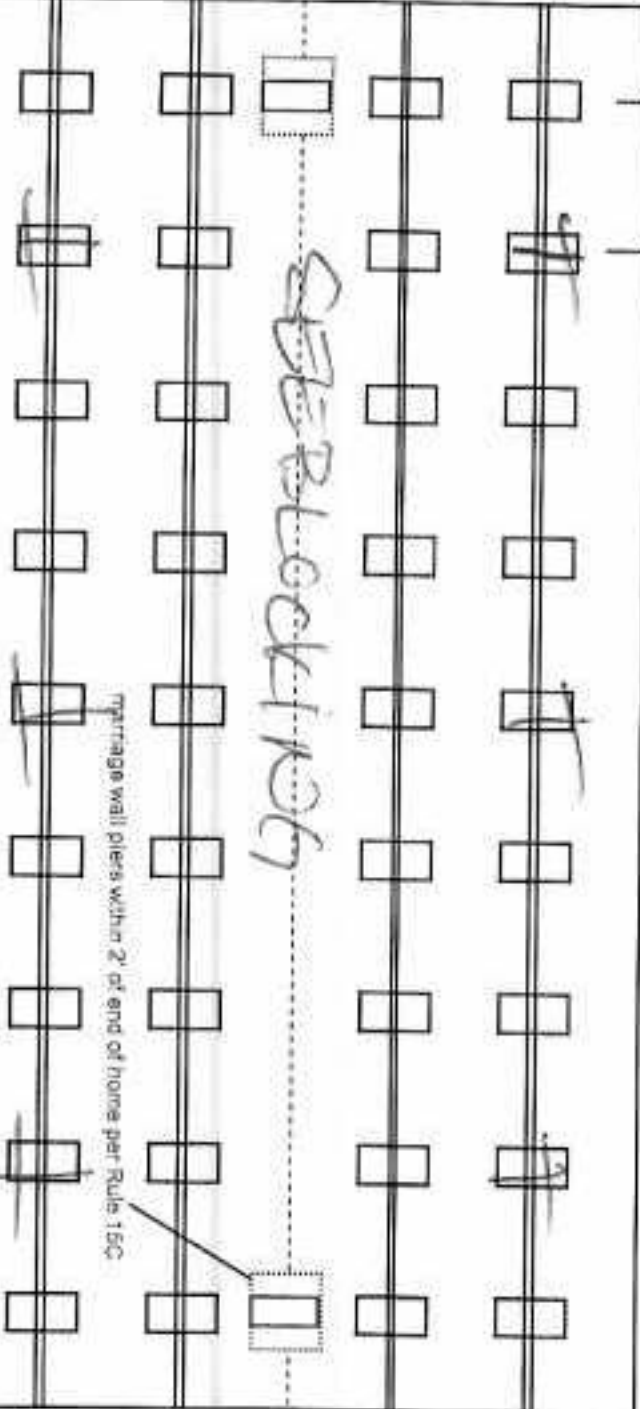
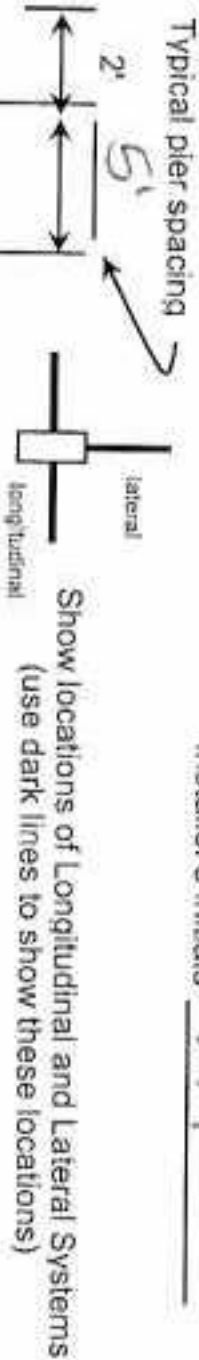

New Home ☐ Used Home ☒

Home installed to the Manufacturer's Installation Manual
Home is installed in accordance with Rule 15-C

Single wide ☐ Wind Zone II ☒ Wind Zone III ☐

Double wide ☒ Installation Decal # 101972

Triple/Quad ☐ Serial # FLTHCT3203121411

PIER SPACING TABLE FOR USED HOMES

Load bearing capacity	Footer size (sq in)	16" x 16" (256)	18 1/2" x 18 1/2" (342)	20" x 20" (400)	22" x 22" (484)*	24" x 24" (576)*	26" x 26" (676)
1000 psf	3'	4'	5'	6'	7'	8'	8'
1500 psf	4' 6"	6'	7'	8'	9'	10'	11'
2000 psf	6'	8'	9'	10'	11'	12'	13'
2500 psf	7' 6"	9'	10'	11'	12'	13'	14'
3000 psf	8'	10'	11'	12'	13'	14'	15'
3500 psf	8'	10'	11'	12'	13'	14'	15'

* interpolated from Rule 15C-1 pier spacing table.

PIER PAD SIZES

I-beam pier pad size 17x25

Perimeter pier pad size 14x16

Other pier pad sizes (required by the mfg.) _____

Draw the approximate locations of marriage wall openings 4 foot or greater. Use this symbol to show the piers.

List all marriage wall openings greater than 4 foot and their pier pad sizes below.

POPULAR PAD SIZES

Pad Size	Sq In
16 x 16	256
16 x 18	288
18.5 x 18.5	342
16 x 22.5	360
17 x 22	374
13 1/4 x 26 1/4	348
20 x 20	400
17 3/16 x 25 3/16	441
17 1/2 x 25 1/2	446
24 x 24	576
26 x 26	676

ANCHORS

Opening _____ Pier pad size _____

large 23x31

FRAME TIES

within 2' of end of home spaced at 5' 4" oc

TIEDOWN COMPONENTS

Longitudinal Stabilizing Device (LSD)

Manufacturer _____

Longitudinal Stabilizing Device w/ Lateral Arms

OTHER TIES

Sidewall _____

Longitudinal _____

Marriage wall _____

SW Hunter Leigh Place

Lake City FL 33762

Parcel# 65- 65-17-04 007-201

2006 Telephone

FILE # 132-03126AB

4 Dec 210044

dsbOSq-ft

8

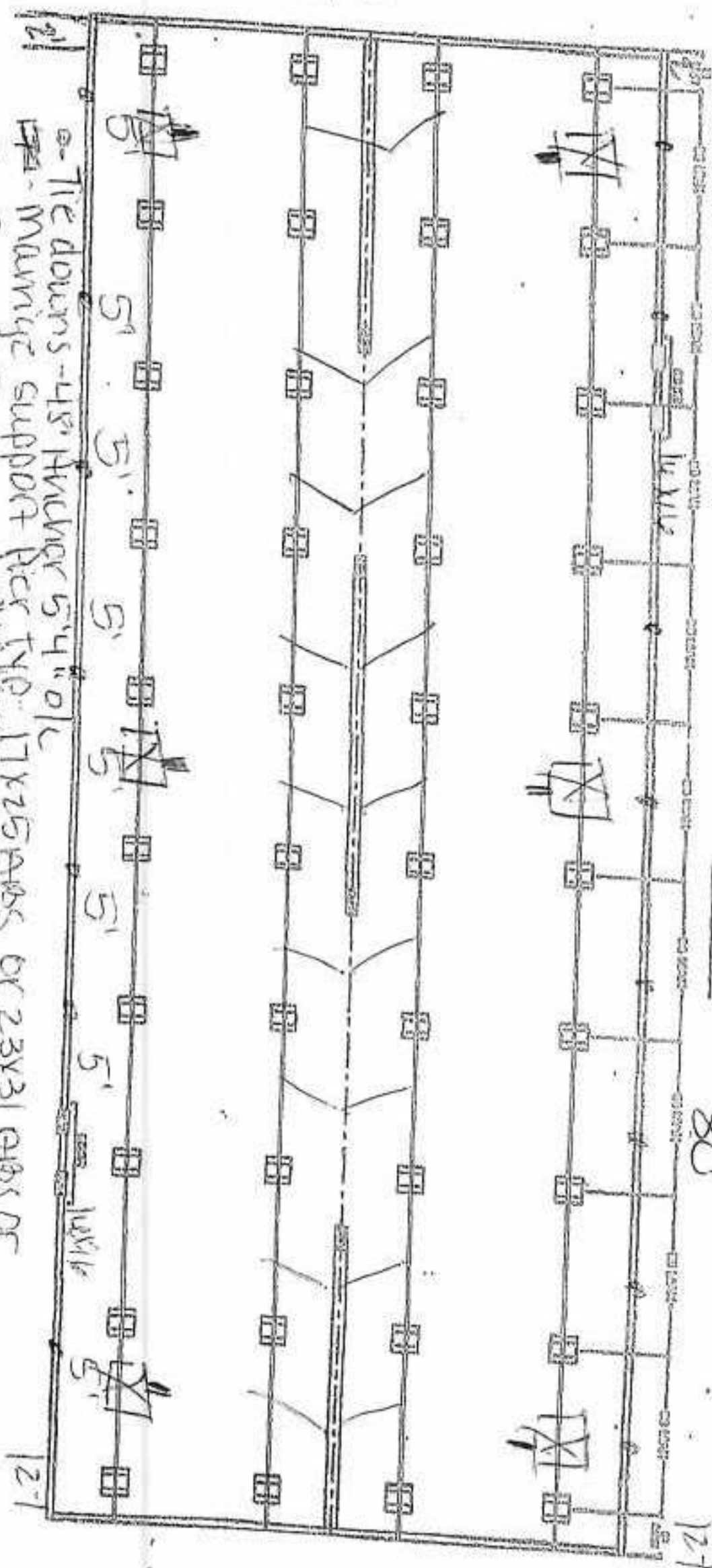

IX - Diver System

> Double frame 7E-48 HVDS from end of run 12/01c

* All pen meter ladders - 16 x 16

- *-All center line (shear wall) anchors led