

ROOF SHEATHING NAILING ZONES
(HIP ROOF)

ROOF SHEATHING NAILING ZONES
(GABLE ROOF)

ROOF SHEATHING FASTENINGS			
NAILING ZONE	SHEATHING TYPE	FASTENER	SPACING
1			6 in. o.c. EDGE 12 in. o.c. FIELD
2	1/16" O.S.B. OR 15/32 CDX	2 1/2"x0.131" RING SHANK NAILS OR 3"x0.120" RING SHANK NAILS	6 in. o.c. EDGE 12 in. o.c. FIELD
3			4 in. o.c. GABLE ENDWALL OR GABLE TRUSS 6 in. o.c. EDGE 12 in. o.c. FIELD

Roof Nail Pattern DET.

SCALE: NONE

B

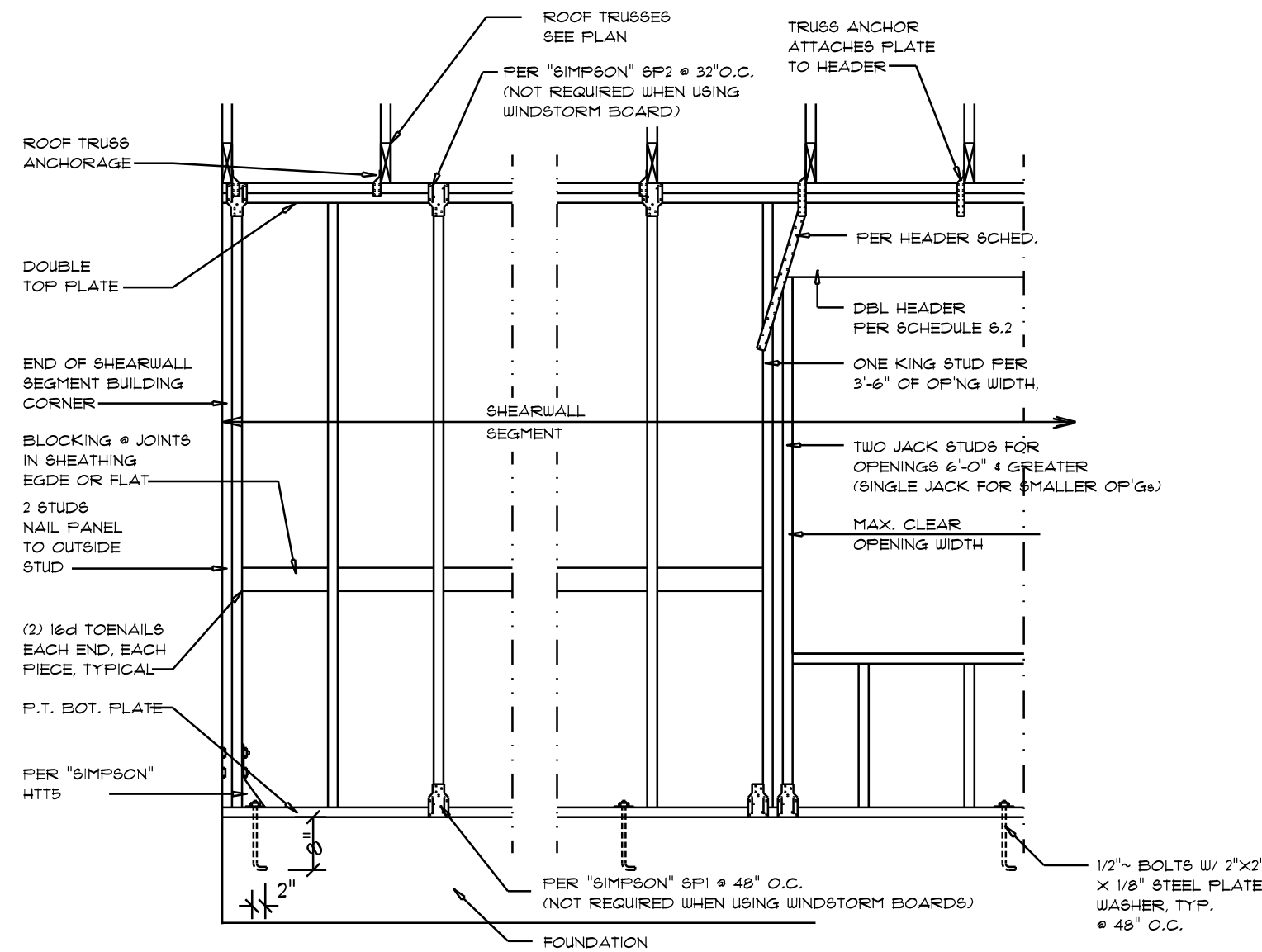

SHEARWALL NOTES:

- ALL SHEARWALLS SHALL BE TYPE 2 SHEARWALLS.
- THE WALL SHALL BE ENTIRELY SHEATHED WITH 1/4" WINDSTORM BD INCLUDING AREAS ABOVE AND BELOW OPENINGS.
- ALL SHEATHING SHALL BE ATTACHED TO FRAMING ALONG ALL FOUR EDGES WITH JOINTS FOR ADJACENT PANELS OCCURRING OVER COMMON FRAMING MEMBERS OR ALONG BLOCKING.
- NAIL SPACING SHALL BE 6" O.C. EDGES AND 12" O.C. IN THE FIELD.
- TYPE 2 SHEARWALLS ARE DESIGNED FOR THE OPENING IT CONTAINS. MAXIMUM HEIGHT OF OPENING SHALL BE 5/6 TIMES THE WALL HEIGHT. THE MINIMUM DISTANCE BETWEEN OPENINGS SHALL BE THE WALL HEIGHT/3.5 FOR 8'-0" WALLS (2'-3").

OPENING WIDTH	BILL PLATES	16d TOE NAILS EACH END
UP TO 6'-0"	(1) 2x4 OR (1) 2x6	1
> 6' TO 9'-0"	(3) 2x4 OR (1) 2x6	2
> 9' TO 12'-0"	(5) 2x4 OR (2) 2x6	3

Shear Wall DETAILS

SCALE: NONE

E

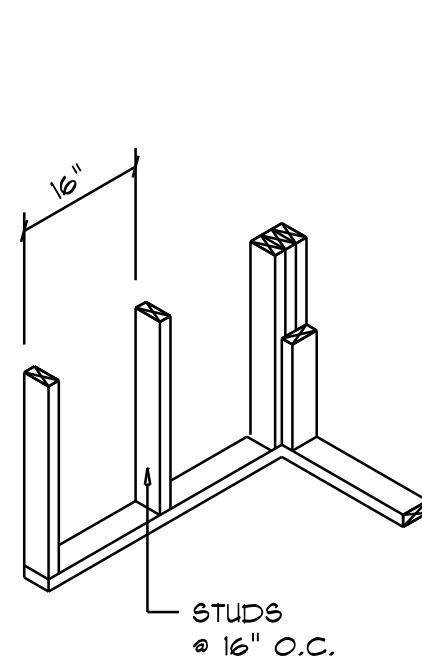

WALL CORNER

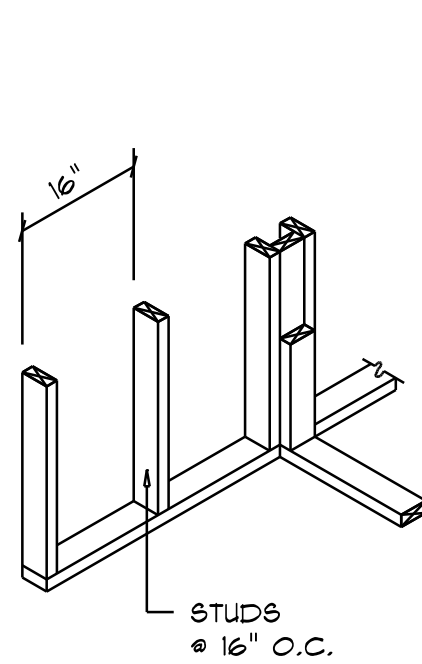

WALL INTERSECTION

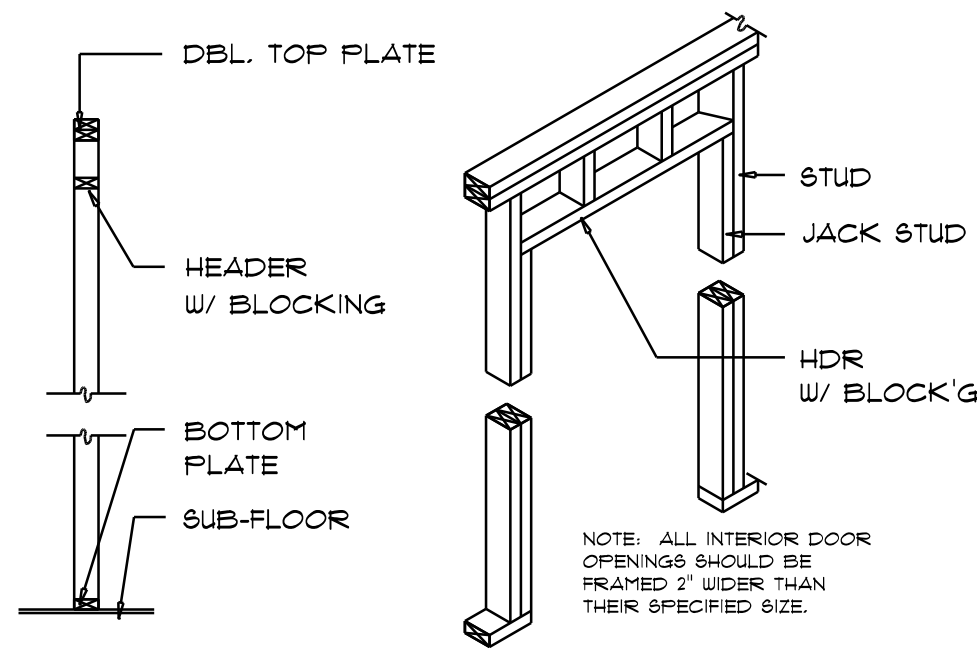

NON-BEARING WALL HEADER

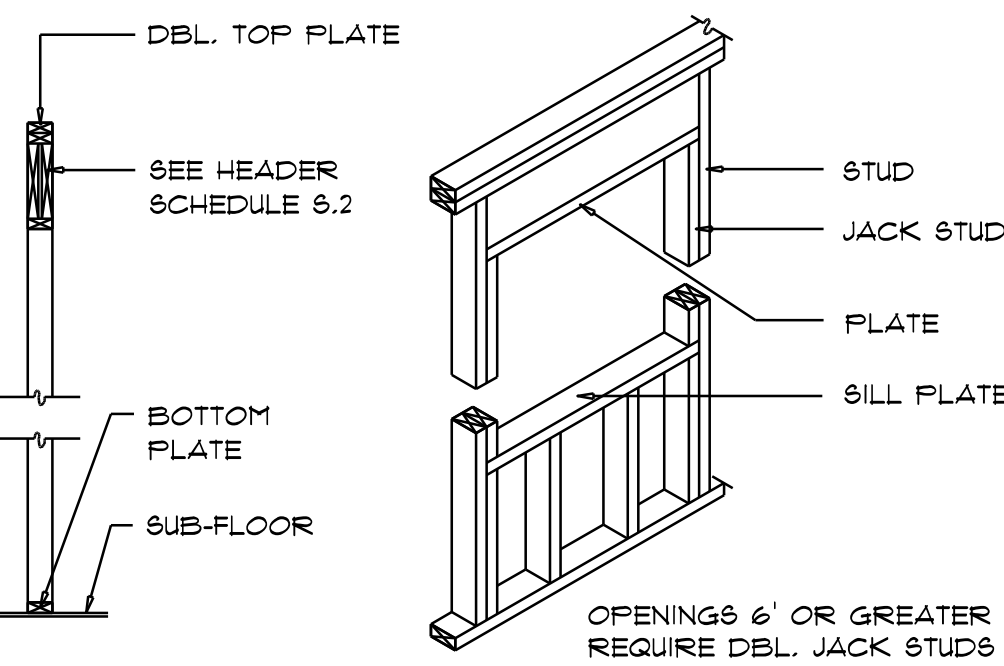

TYPICAL WINDOW HEADER

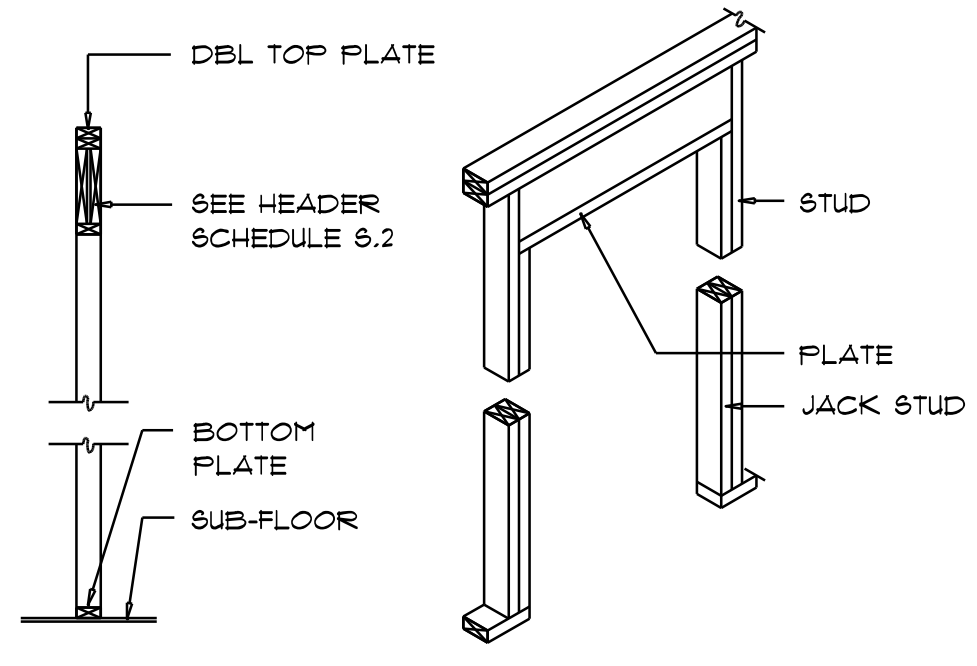

BEARING WALL HEADER

Wall Framing/Header DETAILS

SCALE: NONE

F

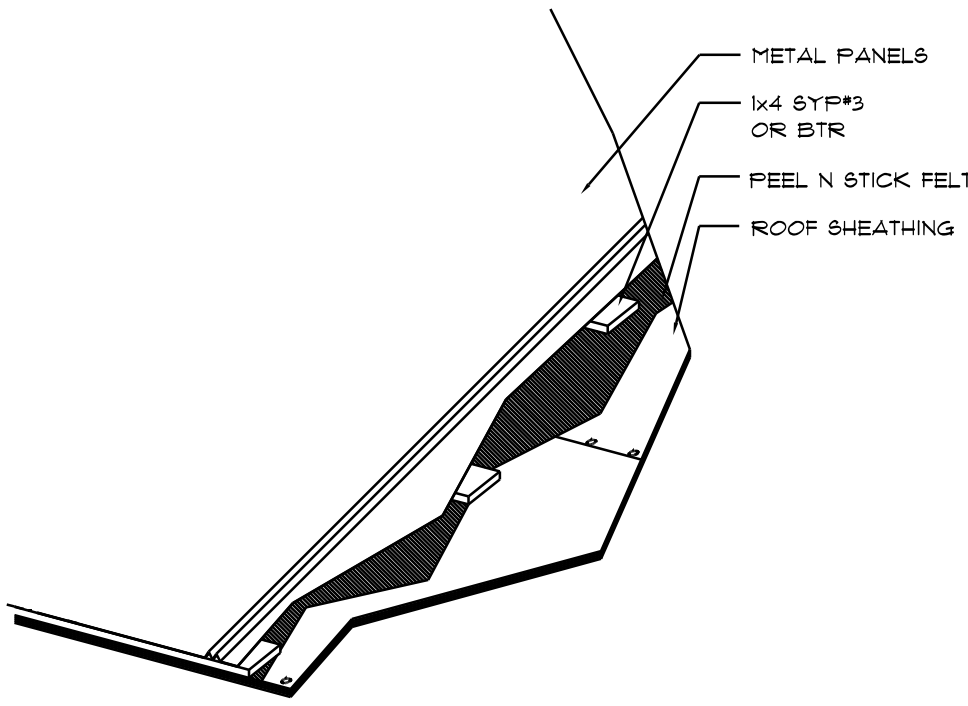

METAL ROOFING. DET.

SCALE: NONE

General Roofing NOTES:

DECK REQUIREMENTS:
METAL PANELS MUST BE FASTENED TO 1x4 FURRING FURLINS OR 1/2" PLYWOOD

CAULKING:
MUST BE APPROVED BY THE MANUFACTURER, BUTYL SEALANT SUPPLIED IN TAPE OR GUN-GRADE FORM.

METAL PANEL:
METAL PANELS SHALL BE MIN. 29 GAUGE AND COMPLY WITH ASTM A-792 AND D-139

FASTENERS:
FASTENERS FOR METAL PANELS SHALL BE GALVANIZED WOOD FAST SCREW, MINIMUM OF #5 X 1 1/2" HEX HEAD.

ATTACHMENT:
METAL PANELS SHALL BE SECURED TO THE ROOF WITH NOT LESS THAN 24" O.C. WHERE ROOF IS LOCATED IN BASIC WIND SPEED OF 110 MPH OR GREATER, SPECIAL METHODS OF FASTENING ARE REQUIRED. UNLESS OTHERWISE NOTED, ATTACHMENT OF METAL PANELS SHALL CONFORM WITH ASTM E 330 OR FA 125.

BASE AND CAP FLASHINGS:
BASE AND CAP FLASHING SHALL BE INSTALLED IN ACCORDANCE W/ MFG'S INSTALLATION INSTRUCTIONS.

- RC-1 - RIDGE CAP
- ED-1 - EAVE DRIP
- EF-3 - EAVE FLASHING
- SW-1 - SIDEWALL FLASHING
- EW-1 - ENDWALL FLASHING
- GR-4 - GABLE END OR RAKE BOARD FLASHING
- TR-1 - TRANSITION FLASHING
- PV-2 - PREFORMED VALLEY FLASHING
- BUTYL TAPE
- SEALANT TAPE
- PIPEBOOT

UNDERLAYMENT APPLICATION:
UNDERLAYMENT SHALL BE A MINIMUM OF TWO LAYERS APPLIED AS FOLLOWS:
1. STARTING AT THE EAVE, A 19 INCH STRIP OF UNDERLAYMENT SHALL BE APPLIED PARALLEL WITH THE EAVE AND FASTENED SUFFICIENTLY TO STAY IN PLACE.

2. STARTING AT THE EAVE, 36 INCH WIDE STRIPS OF UNDERLAYMENT FELT SHALL BE APPLIED OVERLAPPING SUCCESSIVE SHEETS 19 INCHES AND FASTENED SUFFICIENTLY TO STAY IN PLACE.

BASE AND CAP FLASHINGS:
BASE AND CAP FLASHING SHALL BE INSTALLED IN ACCORDANCE W/ MFG'S INSTALLATION INSTRUCTIONS. BASE FLASHING SHALL BE EITHER CORROSION RESISTANT METAL OF MINIMUM NOMINAL THICKNESS 0.019 INCH OR MINERAL SURFACE ROLL ROOFING WEIGHING A MINIMUM OF 11 LBS PER 100 SQUARE FEET. CAP FLASHING SHALL BE CORROSION RESISTANT METAL OF MINIMUM NOMINAL THICKNESS OF 0.019 INCH.

VALLEYS:
VALLEY LININGS SHALL BE INSTALLED IN ACCORDANCE W/ MANUFACTURER'S INSTALLATION INSTRUCTIONS BEFORE APPLYING ROOFING MATERIAL. VALLEY LININGS OF THE FOLLOWING TYPES SHALL BE PERMITTED.

1. OPEN VALLEYS LINED WITH METAL: THE VALLEY LINING SHALL BE AT LEAST 16" WIDE AND OF ANY OF THE CORROSION RESISTANT METALS IN FBIC TABLE 1501.3.3.2.
2. OPEN VALLEYS: VALLEY LINING OF TWO PLYS OF MINERAL SURFACE ROLL ROOFING SHALL BE PERMITTED. THE BOTTOM LAYER SHALL BE 18 INCHES AND THE TOP LAYER A MINIMUM OF 36 INCHES WIDE.
3. CLOSED VALLEYS: VALLEY LINING SHALL BE ONE OF THE FOLLOWING:
 1. BOTH TYPES 1 AND 2 ABOVE, COMBINED.
 2. ONE PLY OF SMOOTH ROLL ROOFING AT LEAST 36 INCHES WIDE AND COMPLYING WITH ASTM D 224.
 3. SPECIALITY UNDERLAYMENT AT LEAST 36 INCHES WIDE & COMPLYING WITH ASTM D 1910.

8M-RIB METAL ROOFING PANELS ALTERNATE FASTENER SCHEDULE FOR VARIOUS WIND VELOCITIES MANUFACTURER'S RECOMMENDED FASTENER SCHEDULE FOR BUILDINGS W/ 30' MEAN ROOF HEIGHT, MIN. 3/12 PITCH BASED ON ASCE 7-98, EXPOSURE 'C'							
ROOF ZONE	FASTENER TYPE	FASTENER SIZE	PLACEMENT TO	100 - 110		120 - 130	
				O/C SPACING	TRIM	O/C SPACING	TRIM
1	WD. SCREW	#5 X 1 1/2"	WOOD	36"	18"	24"	12"
				36"	18"	24"	12"
2 & 3	WD. SCREW	#5 X 1 1/2"	WOOD	36"	18"	24"	12"
				36"	18"	24"	12"

STANDARD HEADER SCHEDULE

0'-0" UP TO 6'-0" OPENINGS

DOUBLE 2x8 No.2 SOUTHERN PINE WITH 1/2" OSB SOLID CONTINUOUS SPACER GLUED AND NAILED WITH 10d X 0.128" X 3" NAILS IN 2 ROWS @ 12" O.C. STAGGERED EACH SIDE WITH 1 - SIMPSON MSTA15 TOP AND 1 - SIMPSON SPH4R BOTTOM EACH SIDE OF OPENING WITH 1 - HEADER STUD AND 1 FULL HEIGHT STUDS EACH SIDE OF OPENING

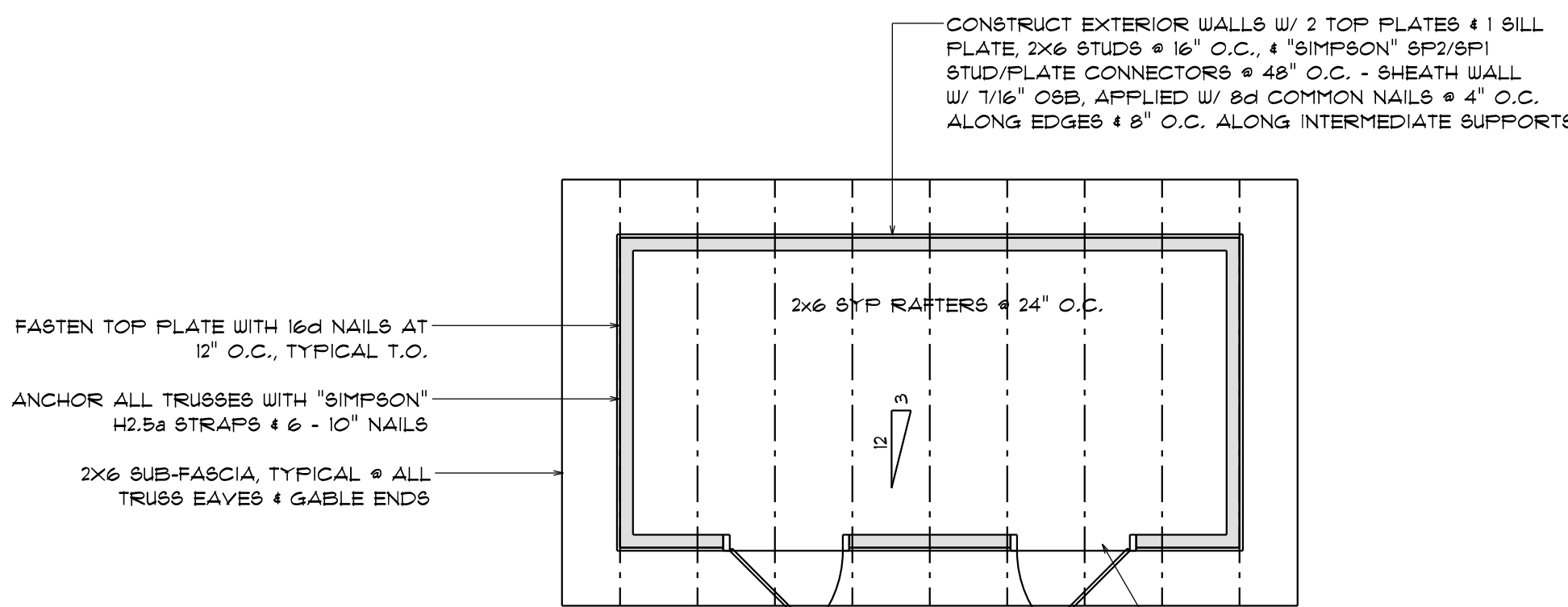

ROOF FRAMING PLAN

SCALE: 1/4" = 1'-0"

NOTE!
THE DESIGN WIND SPEED FOR THIS PROJECT IS 130 MPH PER FBC 1609 AND LOCAL JURISDICTION REQUIREMENTS

ROOF PLAN NOTES

- R-1 SEE ELEVATIONS FOR ROOF PITCH
- R-2 ALL OVERHANGS 18" (12" on gables) UNLESS OTHERWISE NOTED
- R-3 PROVIDE ATTIC VENTILATION IN ACCORDANCE WITH SCHEDULE ON BD.3
- R-4 SEE EXTERIOR ELEVATIONS AND FLOOR PLANS TO VERIFY PLATE AND HEEL HEIGHTS
- R-5 MOVE ALL VENTS AND OTHER ROOF PENETRATIONS TO REAR

NOTE: SP2/SP1 STUD/PLATE CONNECTORS ARE NOT REQUIRED WHEN USING WINDSTORM SHEATHING BOARDS

NOTE!
ALL PENETRATIONS OF THE TOP PLATE OF ALL LOAD BEARING WALLS SHALL BE SEALED WITH FIRE RETARDANT CAULKING, INCLUDING WIRING, PLUMBING OR OTHER SUCH PENETRATIONS. WALLS OVER 8'-0" TALL SHALL HAVE CONTINUOUS BLOCKING TO LIMIT CAVITY HEIGHT TO 8'-0". PENETRATIONS THROUGH SUCH BLOCKING SHALL BE TREATED IN THE SAME MANNER AS TOP PLATES, NOTED ABOVE

REVISIONS	
Mar. 21st, 2025	

RESTROOMS FOR:
COOPERS HIDEOUT
COLUMBIA COUNTY, FL

NICHOLAS PAUL GEISLER ARCHITECT
1758 NW Brown Rd.
Lake City, FL 32055
(386) 365-4355
N.C.A.R.B. Certified

SHEET NUMBER
S.2
OF 2 SHEETS

Nicholas
as
Geisler

Digitally
signed by
Nicholas
Geisler
Date:
2025.03.21
16:19:32 -04'00'

AR0007005