

Columbia County Property Appraiser

Jeff Hampton

2026 Working Values

updated: 10/2/2025

Parcel: << 20-4S-16-03079-077 (14494) >>

Owner & Property Info

Result: 1 of 1

Owner	HOGG C EDWARD 163 SW GREMLIN WAY LAKE CITY, FL 32024		
Site	163 SW GREMLIN WAY, LAKE CITY		
Description*	LOT 4 BLOCK 6 SHADY OAKS ACRES UNIT 2 ADDITION. ORB 634-048, 767-1205, WD 989-1616, WD 1027-1528.		
Area	0.337 AC	S/T/R	20-4S-16
Use Code**	SINGLE FAMILY (0100)	Tax District	3

*The Description above is not to be used as the Legal Description for this parcel in any legal transaction.

**The Use Code is a FL Dept. of Revenue (DOR) code and is not maintained by the Property Appraiser's office. Please contact your city or county Planning & Zoning office for specific zoning information.

Property & Assessment Values

2025 Certified Values				2026 Working Values			
Mkt Land		\$23,400		Mkt Land		\$23,400	
Ag Land		\$0		Ag Land		\$0	
Building		\$100,325		Building		\$98,805	
XFOB		\$5,108		XFOB		\$5,108	
Just		\$128,833		Just		\$127,313	
Class		\$0		Class		\$0	
Appraised		\$128,833		Appraised		\$127,313	
SOH/10% Cap		\$48,471		SOH/10% Cap		\$44,540	
Assessed		\$80,362		Assessed		\$82,773	
Exempt	HX HB SX	\$80,362		Exempt	HX HB SX	\$82,773	
Total Taxable		county:\$0 city:\$0 other:\$0 school:\$55,362		Total Taxable		county:\$0 city:\$0 other:\$0 school:\$57,773	

NOTE: Property ownership changes can cause the Assessed value of the property to reset to full Market value, which could result in higher property taxes.

Aerial Viewer Pictometry Google Maps

2023 2022 2019 2016 2013 Sales



Sales History

Sale Date	Sale Price	Book/Page	Deed	V/I	Qualification (Codes)	RCode
9/30/2004	\$69,000	1027 / 1528	WD	I	Q	
7/22/2003	\$60,500	989 / 1616	WD	I	Q	
11/13/1992	\$35,000	767 / 1205	WD	I	Q	
9/30/1987	\$38,900	634 / 048	WD	I	Q	
2/1/1985	\$33,500	557 / 282	WD	I	Q	
1/1/1979	\$25,800	419 / 631	03	I	Q	

Building Characteristics

Bldg Sketch	Description*	Year Blt	Base SF	Actual SF	Bldg Value
Sketch	SINGLE FAM (0100)	1978	1036	1392	\$98,805

*Bldg Desc determinations are used by the Property Appraisers office solely for the purpose of determining a property's Just Value for ad valorem tax purposes and should not be used for any other purpose.

Extra Features & Out Buildings

Code	Desc	Year Blt	Value	Units	Dims
0166	CONC,PAVMT	1993	\$1,000.00	500.00	0 x 0
0120	CLFENCE 4	1993	\$300.00	1.00	0 x 0
0294	SHED WOOD/VINYL	2006	\$448.00	64.00	8 x 8
0294	SHED WOOD/VINYL	2006	\$3,360.00	240.00	12 x 20

Land Breakdown

Code	Desc	Units	Adjustments	Eff Rate	Land Value
0100	SFR (MKT)	1.000 LT (0.337 AC)	1.0000/1.0000 1.0000/9000000 /	\$23,400 /LT	\$23,400

Search Result: 1 of 1

© Columbia County Property Appraiser | Jeff Hampton | Lake City, Florida | 386-758-1083

by: GrizzlyLogic.com

The information presented on this website was derived from data which was compiled by the Columbia County Property Appraiser solely for the governmental purpose of property assessment. This information should not be relied upon by anyone as a determination of the ownership of property or market value. The GIS Map image is not a survey and shall not be used in a Title Search or any official capacity. No warranties, expressed or implied, are provided for the accuracy of the data herein, its use, or its interpretation. This website was last updated: 10/2/2025 and may not reflect the data currently on file at our office.

Columbia County Property Appraiser

Jeff Hampton | Lake City, Florida | 386-758-1083

Owner & Property Info

Parcel ID: **20-4S-16-03079-077 (14494)**

Name	HOGG C EDWARD (exempt: HX-HB-SX-)
Site Addr	163 SW GREMLIN, LAKE CITY
Mailing	163 SW GREMLIN WAY LAKE CITY, FL 32024
Description	LOT 4 BLOCK 6 SHADY OAKS ACRES UNIT 2 ADDITION. ORB 634-048, 767-1205, WD 989-1616, WD 1027-1528. 20-4S-16-03079-077

	Bldg Item	Bldg Desc	Year Blt	Base S.F.	Actual S.F.	Bldg Value
Show Sub-Area Codes	1	SINGLE FAM (0100)	1978	1036	1392	\$98,805.00

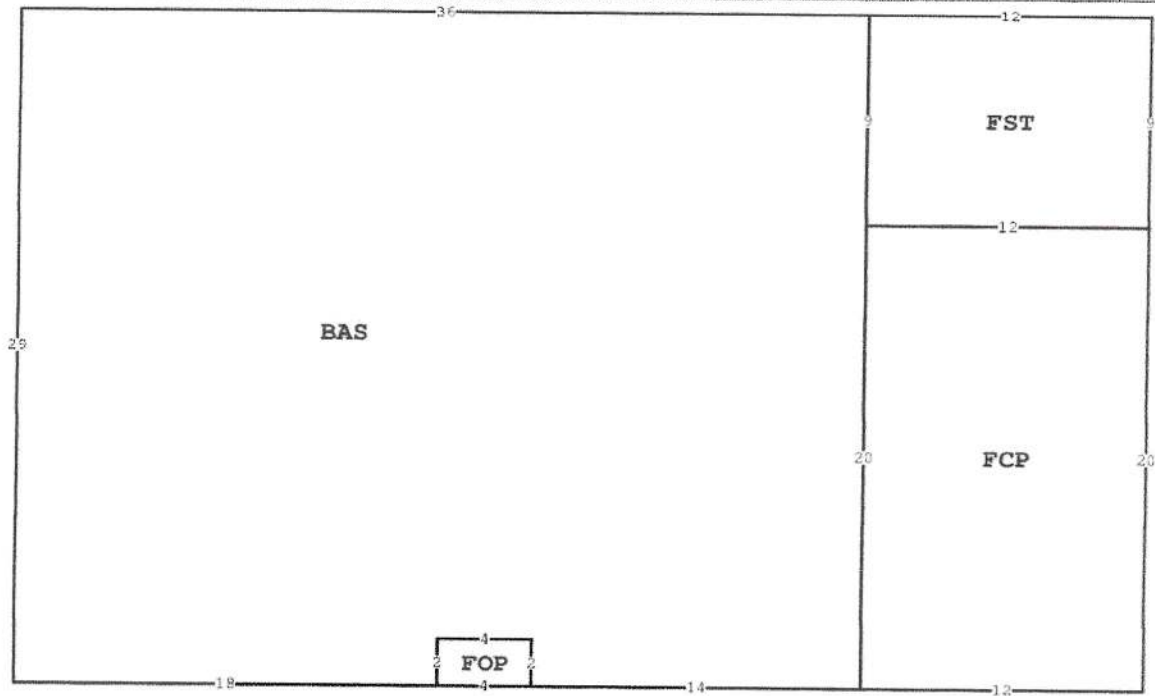

Show All Buildings