



STATE OF FLORIDA
DEPARTMENT OF HEALTH
ONSITE SEWAGE TREATMENT AND DISPOSAL
SYSTEM
APPLICATION FOR CONSTRUCTION PERMIT

CR #

PERMIT NO. 22-0326
DATE PAID: 4/12/22
FEE PAID: 310.00
RECEIPT #: 1817475

APPLICATION FOR:

☒ New System ☐ Existing System ☐ Holding Tank ☐ Innovative
☐ Repair ☐ Abandonment ☐ Temporary ☐

APPLICANT: ETHEL SWILLEY & STEVEN SCHWARTZ

AGENT: PAUL LLOYD

TELEPHONE: (386) 269-2087

MAILING ADDRESS: 3645 SW PINEMOUNT ROAD

LAKE CITY FL 32024

TO BE COMPLETED BY APPLICANT OR APPLICANT'S AUTHORIZED AGENT. SYSTEMS MUST BE CONSTRUCTED BY A PERSON LICENSED PURSUANT TO 489.105(3)(m) OR 489.552, FLORIDA STATUTES. IT IS THE APPLICANT'S RESPONSIBILITY TO PROVIDE DOCUMENTATION OF THE DATE THE LOT WAS CREATED OR PLATTED (MM/DD/YY) IF REQUESTING CONSIDERATION OF STATUTORY GRANDFATHER PROVISIONS.

PROPERTY INFORMATION

LOT: N/A BLOCK: N/A SUBDIVISION: METES AND BOUNDS PLATTED: _____

PROPERTY ID #: 07-4S-16-02806-003 ZONING: RES I/M OR EQUIVALENT: ☐ NO ☐

PROPERTY SIZE: 2.450 ACRES WATER SUPPLY: ☐ PRIVATE PUBLIC ☐ ≤ 2000 GPD ☐ > 2000 GPD

IS SEWER AVAILABLE AS PER 381.0065, FS? ☐ NO ☐ DISTANCE TO SEWER: N/A FT

PROPERTY ADDRESS: 3645 SW PINEMOUNT ROAD

DIRECTIONS TO PROPERTY: TAKE 90 WEST. TURN LEFT ON PINEMOUNT ROAD. SITE ON LEFT AFTER CHRISTIAN ACADEMY

BUILDING INFORMATION ☒ RESIDENTIAL ☐ COMMERCIAL

Unit No.	Type of Establishment	No. of Bedrooms	Building Area Sqft	Commercial/Institutional System Design Table 1, Chapter 64E-6, FAC
1	<u>MOBILE HOME</u>	<u>4</u>	<u>1612</u>	
2				
3				
4				

☐ Floor/Equipment Drains ☐ Other (Specify) _____

SIGNATURE: Paul Lloyd

DATE: 4/13/22

DH 4015, 08/09 (Obsoletes previous editions which may not be used)
Incorporated 64E-6.001, FAC

Application for Onsite Sewage Disposal System
Construction Permit. Part II Site Plan
Permit Application Number: 22-0326

ALL CHANGES MUST BE APPROVED BY THE COUNTY HEALTH UNIT

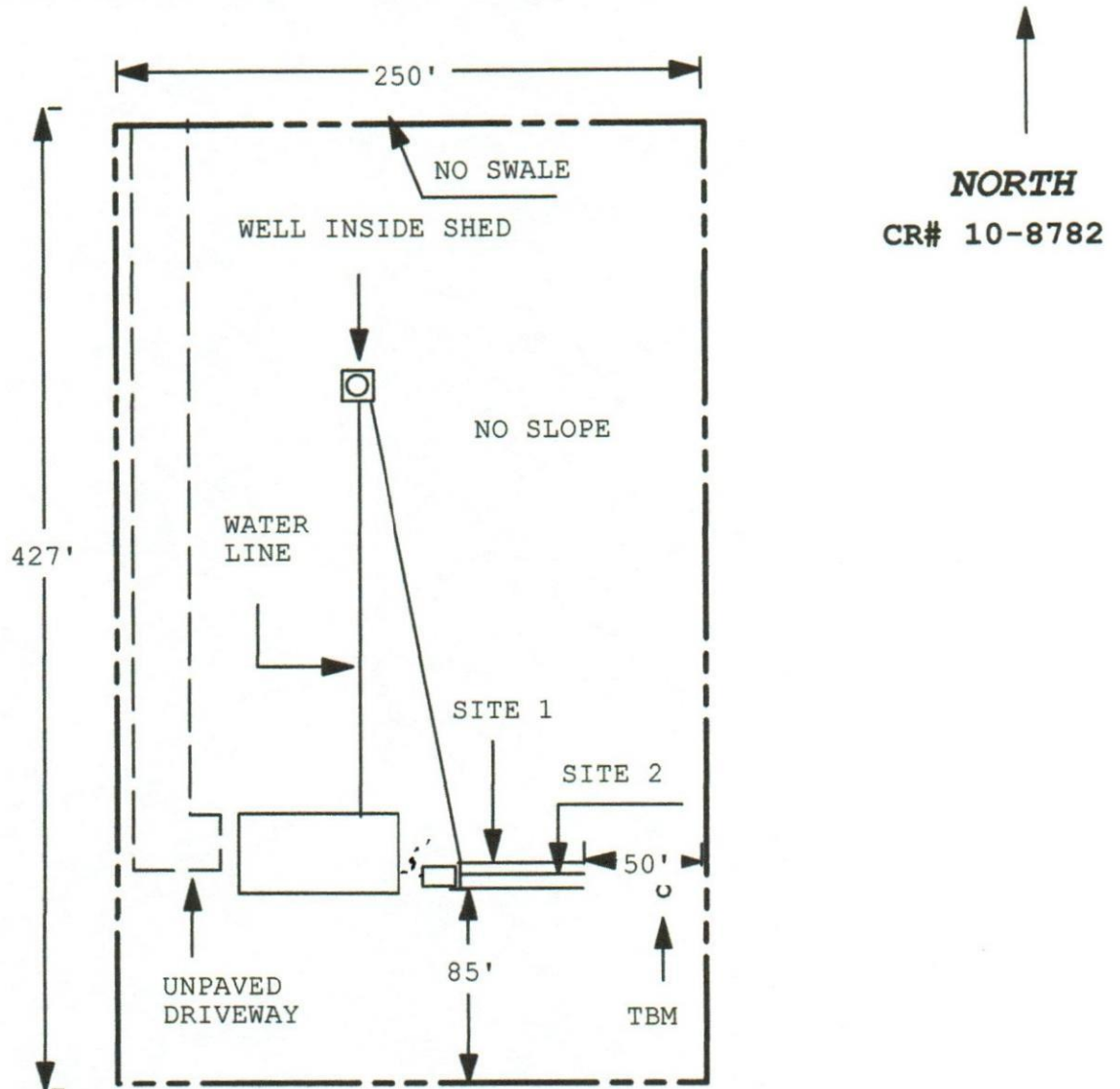

NO WELLS WITHIN 100'

1 INCH = 80 FEET

Site Plan Submitted By Paul R. [Signature] Date 4/7/22
Plan Approved [Signature] Not Approved [Signature] Date
By [Signature] EPH Director CPHU
Notes: 4.20.22