

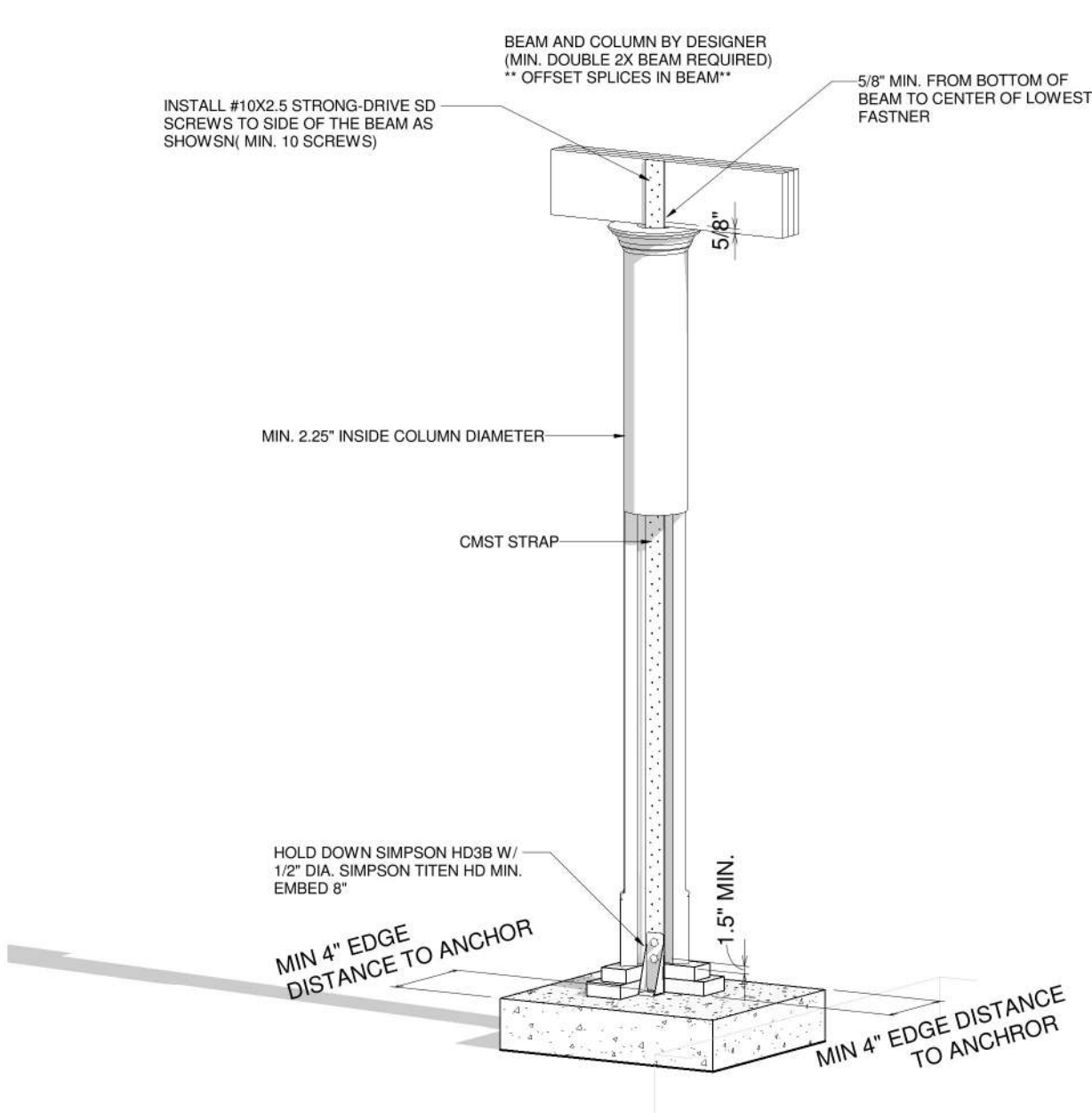

James A Zaleski

Digitally signed by James A Zaleski
Date: 2021.07.13 09:01:30 -04'00'



1 COLUMN DETAIL

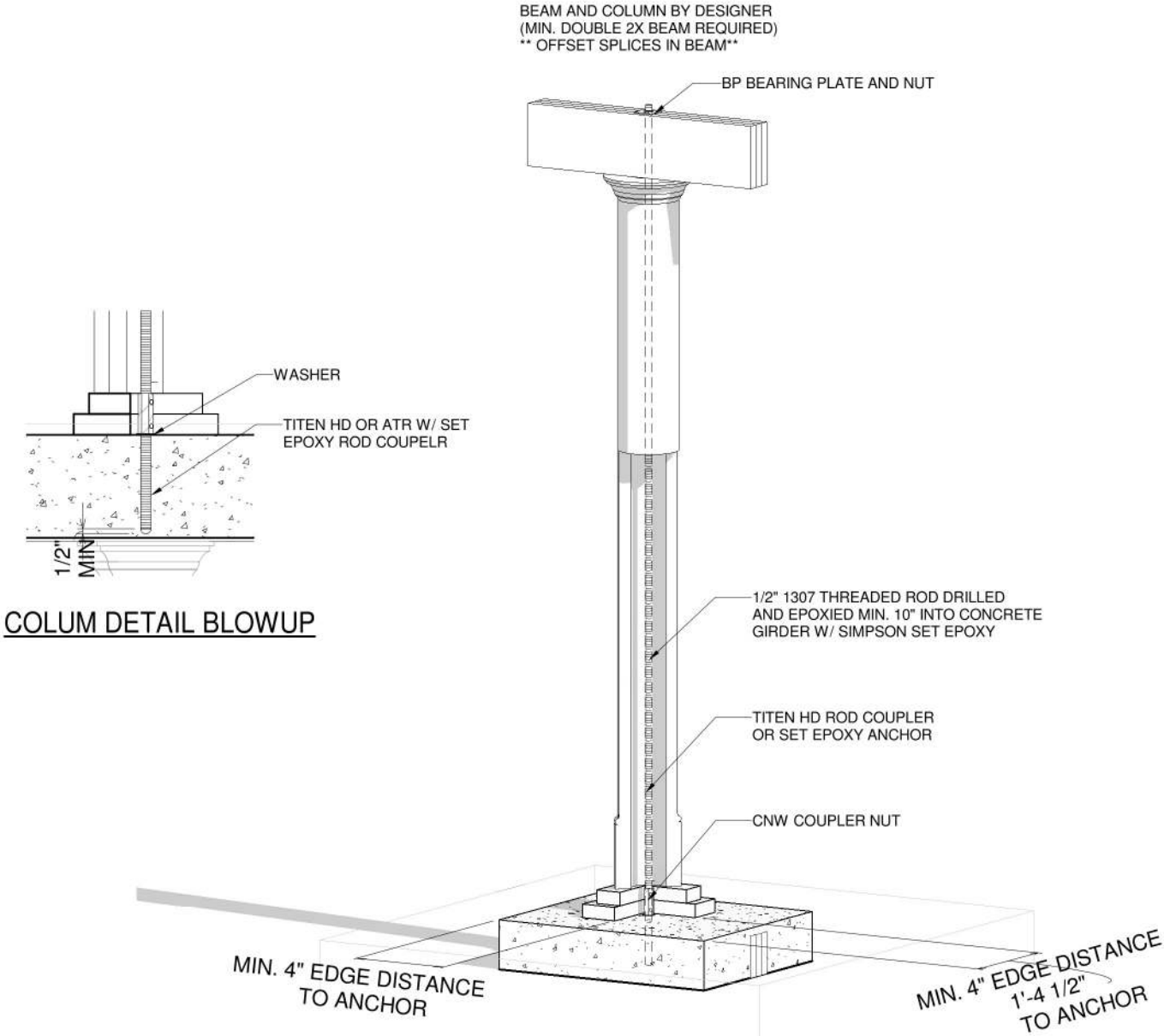

2 COLUMN DETAIL 2

James Zaleski P.E 51544 2305 Haverhill Rd Tallahassee,FI 32312 PH 850-766-7778

OPT. PAPER SIZE: for 1/4" =1'-0" on 24"x36" PAPER SIZE ENLARGE PRINTS TO 200%
FINAL CONSTRUCTION PLANS

Revision Schedule		Revision			
Revision Number	Revision Description	Revision Date	Revision	Revision	Revision
1	FINAL	7/9/21			

AREAS:		Revision			
FIRST FLOOR HEATED	1,296 SF	Revision	Revision	Revision	Revision
SECOND FLOOR HEATED	510 SF	Revision	Revision	Revision	Revision
FRONT PORCH	252 SF	Revision	Revision	Revision	Revision
REAR PORCH	240 SF	Revision	Revision	Revision	Revision
TOTAL UNDER ROOF	2,298 SF	Revision	Revision	Revision	Revision

THE:		FOR:		OFFICE:	
DOGWOOD 'A'		AUSTIN ODUM		GAINESVILLE, FL	
59-21-017		2x4 EXTERIOR WALLS		MONOSLAB	
J. GENCHUR		B. TOOMBS		7/12/2021 11:03:07 AM	
DRAWN BY:		CHECKED BY:		PRINT DATE:	
JOB#		FOUNDATION TYPE:		SOLD BY:	
437 S. E. PEACOCK TER.		LAKE CITY, FL 32025		RD	
PROPERTY OF:		FL-COLUMN HOLD DOWN		DETAILS	
S-5		© COPYRIGHT - 2021		PAPER SIZE: 11" x 17"	
SHEET NUMBER:		SCALE:		3/4" = 1'-0"	

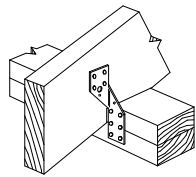

Simpson Strong-Tie
H2.5

RAFTER WITH NO STUD BELOW
WHEN H2 ARE NOT USED PROVIDE
SIMPSON CS16 @ 48" O.C. STRAP OVER
TOP PLATE AND MIN. 10" LAP ON STUDS U.N.O.

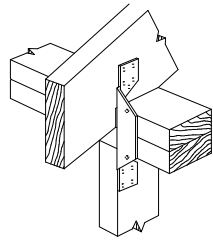

Simpson Strong-Tie
H2

RAFTER ABOVE STUD
WHEN H2 ARE USED EVERY OTHER JOIST
SIMPSON CS16 STRAP OVER TOP PLATE
& MIN. 10" LAP ON STUDS ARE NOT REQUIRED U.N.O.

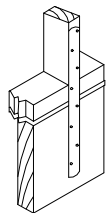

20" SIMPSON CS 16 TIE STRAP CONNECTS STUDS TO
FLOOR SYSTEM @ 48" O.C., 10d NAILS ALL HOLES
AND WOOD COLUMNS TO PORCH HEADERS
AND WOOD COLUMNS TO FLOOR RIM JOIST U.N.O.

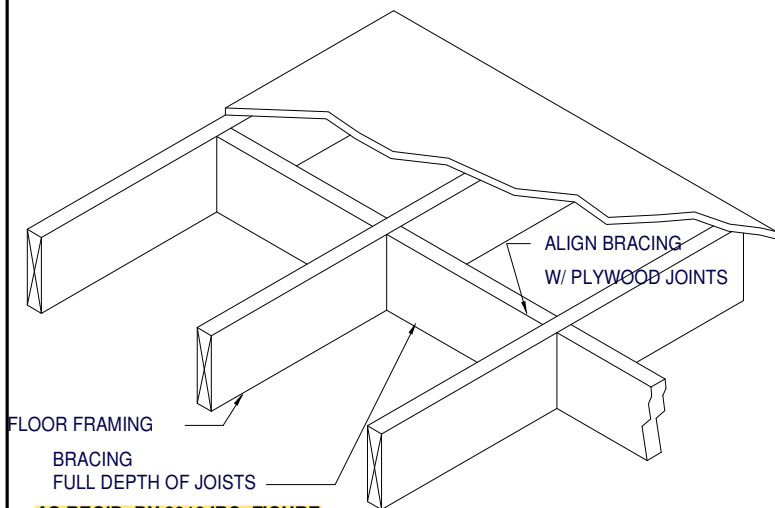

FLOOR FRAMING

BRACING
FULL DEPTH OF JOISTS

AS REQ'D. BY 2018 IRC, FIGURE
R502.2 & SECTION R502.7

OPTIONAL RAFTER OR STUD/POST
TO DBL PLATE/HEADER CONNECTION:
6" FASTENMASTER TIMBERLOK
INSTALLED AT 22.5 DEGREE
MIN. 2.5" FROM CONNECTION
WWW.FASTENMASTER.COM

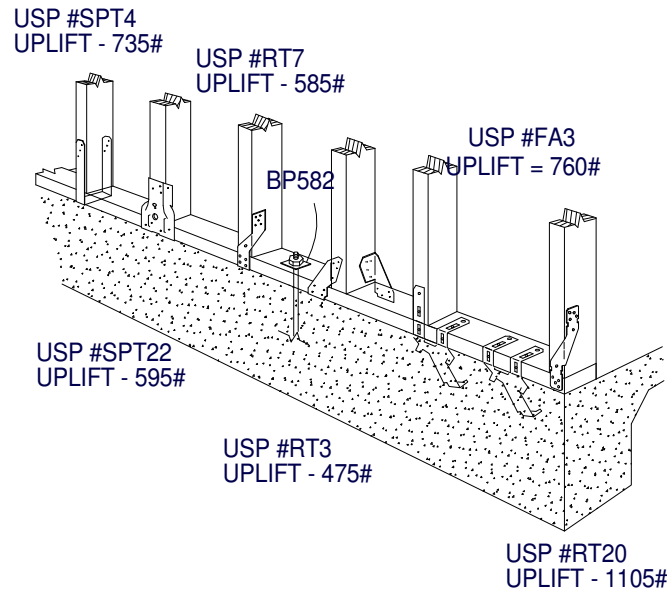

OPTIONAL SLAB/BOTTOM PLATE/WALL CONNECTIONS
SIMPSON H2.5, H3, OR SSP OR DSP BOTTOM PLATE TO STUDS

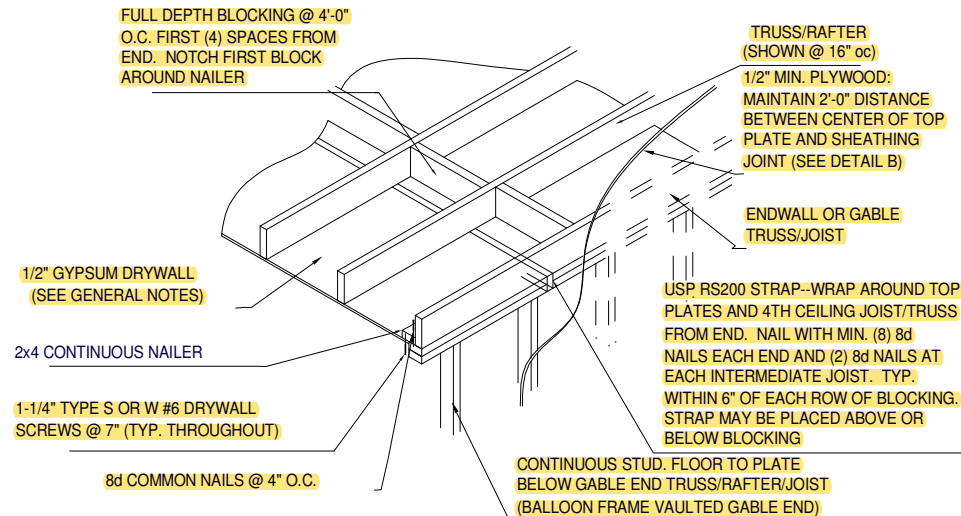

ENDWALL CEILING CONNECTION

James Zaleski P.E 51544 2305 Haverhill Rd Tallahassee, FL 32312 PH 850-766-7778

RAFTER/TRUSS

USP RS200 ON EACH RAFTER PAIR, 12" MIN.
END LENGTH ON EACH RAFTER, (11)
8d FASTENERS REQ'D EACH END.
ALT: 1x6 COLLAR TIE EVERY OTHER RAFTER,
MIN. (9) 8d NAILS EACH END.
NOTE: DETAIL ABOVE NOT REQUIRED
FOR CONTINUOUS TRUSSES.

USP RT16 STRAP AT
ALL BEARING POINTS

RT16 MUST BE INSTALLED ON OUTSIDE OF
STUD WALL. IF INSTALLED ON INSIDE OF
WALL, STUDS ON EITHER SIDE OF RT16
MUST BE ANCHORED TO TOP PLATE USING
RT7 STRAPS.

INTERIOR LOAD BEARING WALLS-
STRAP TRUSS/RAFTERS TO TOP PLATES
WITH USP RT16. ANCHOR TOP PLATES TO
STUDS WITH USP SPT24 STRAPS ON SAME
SIDE AS RT16 STRAPS. CONNECT 2ND
FLOOR WALL STUDS TO 1ST FLOOR WALL
STUDS OR BEAMS USING USP RS200
STRAPS @ 48" O.C. (MIN. 11 8d NAILS EACH
END). ATTACH 1ST FLOOR STUDS TO
SUPPORTING GIRDERS IN SIMILAR MANNER.
ANCHOR FLOOR JOISTS TO DROPPED
GIRDERS WITH USP RT 17. SEE DETAIL I
FOR DROPPED GIRDER ANCHORING.

OPTIONAL TIEDOWN IS THE QUICK TIE SYSTEM
WWW.QUICKTIEPRODUCTS.COM
CONTRACTOR SHALL SUBMIT TIEDOWN PLAN
FOR ENGINEER'S APPROVAL

STRAP OVERBUILT VALLEY
SET) TRUSSES/RAFTERS OVER
MAIN TRUSSES/RAFTERS WITH
USP MTW12 OR MTW18

USP STRAP RS200 -- WRAP
OVER TOP OF EVERY PIGGY
BACK RAFTER/TRUSS AND FASTEN
WITH (4) 8d COMMON NAILS
AT EACH MEMBER

OPTIONAL RAFTER TIEDOWN IS:
6" FASTENMASTER TIMBERLOK
2"-3" IN TOP AND 3"-4" IN BOTTOM

MIN. (4) 8d COMMON NAILS
ON EACH SIDE OF 2 MEMBER
CONNECTION

RAFTER TO HIP CONNECTION:
SIMPSON LS50 OR
(2) 1/4"X3.5" WOOD SCREWS PLACED
AT 1/3 DEPTH POINTS AND PASS
THROUGH THE INSIDE CORNER OF CONNECTION

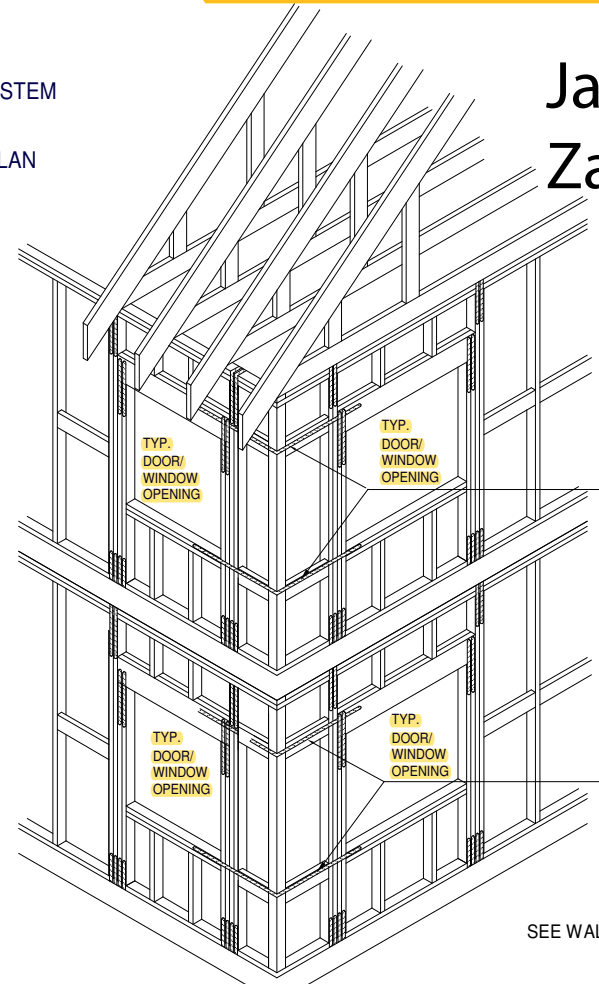

HORIZONTAL STRAPPING DETAIL @ CORNERS

OPT. PAPER SIZE: for 1/4" = 1'-0" on 24"x36" PAPER SIZE ENLARGE PRINTS TO 200%

FINAL CONSTRUCTION PLANS



USP RS200 STRAP--OVERLAP
TOP AND BOTTOM HEADER (USE
BLOCKING BETWEEN STUDS WHERE
HEADERS DON'T ALIGN) 12" MIN.
EACH SIDE. TYP. WITH CORNER
WALLS SHEATHED LESS THAN 3'-6"
EITHER WAY AND ALL BAY WINDOWS.

SEE WALL SECTIONS FOR VERICAL TIEDOWN

James A Zaleski
Digitally signed by
James A Zaleski
Date: 2021.07.13
08:53:30 -04'00'

Revision Number	Revision Description	Revision Date
1	FINAL	7/9/21

AREAS:	1,296 SF	510 SF	252 SF	240 SF	2,298 SF
FIRST FLOOR HEATED					
SECOND FLOOR HEATED					
FRONT PORCH					
REAR PORCH					
TOTAL UNDER ROOF					

THE: DOGWOOD 'A'	FOR: AUSTIN ODUM	437 S. E. PEACOCK TER. LAKE CITY, FL 32025
JOB# 59-21-017	2x4 EXTERIOR WALLS	FOUNDATION TYPE: MONOSLAB
DRAWN BY: J. GENCHUR	CHECKED BY: B. TOOMBS	PRINT DATE: 7/12/2021 11:03:09 AM
PROPERTY OF: AMERICA'S HOME PLACE	SHEET NUMBER: S-6	FL- HOLD DOWN DETAILS