

NOTE: UNLESS IT BEARS THE SIGNATURE AND THE ORIGINAL RAISED MAPPER THIS DRAWING, SKETCH, PLAT OR MAP IS FOR INFORMATION

PLS 4708

INSERT "A"
SCALE: 1" = 30'

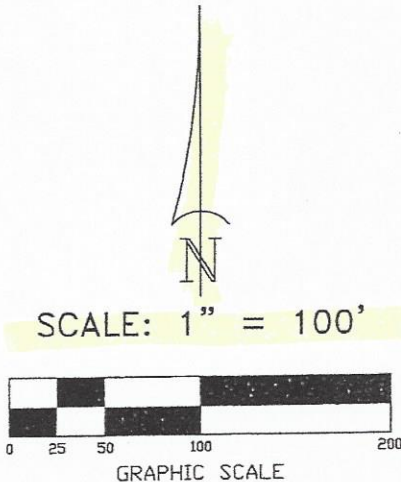
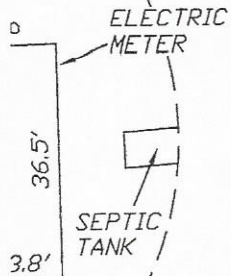

SYMBOL LEGEND:

■	4"X4" CONCRETE MONUMENT FOUND
□	4"X4" CONCRETE MONUMENT SET
●	IRON PIPE FOUND
○	IRON PIN AND CAP SET
×	"X" CUT IN PAVEMENT
+	CALCULATED PROPERTY CORNER
⊙	NAIL & DISK
⊕	POWER POLE
+	SIGN POST
▲	WATER METER
⊙	UTILITY BOX
*	WELL
⊙	SANITARY MANHOLE
⊙	CENTERLINE
---	SECTION LINE
---E---	ELECTRIC LINES
---X---	WIRE FENCE
---O---	CHAIN LINK FENCE
---□---	WOODEN FENCE
(PLAT)	AS PER A PLAT OF RECORD
(DEED)	AS PER A DEED OF RECORD
(CALC.)	AS PER CALCULATIONS
(FIELD)	AS PER FIELD MEASUREMENTS
P.R.M.	PERMANENT REFERENCE MARKER
P.C.P.	PERMANENT CONTROL POINT

DESCRIPTION:

LOT 12, MAGNOLIA PLACE, ACCORDING TO THE MAP OR PLAT THEREOF AS RECORDED IN PLAT BOOK 7, PAGES 174-179, OF THE PUBLIC RECORDS OF COLUMBIA COUNTY, FLORIDA.

SURVEYOR'S NOTES:

1. BOUNDARY BASED ON MONUMENTATION FOUND IN ACCORDANCE WITH THE RETRACEMENT OF THE ORIGINAL SURVEY FOR SAID PLAT OF RECORD.
2. BEARINGS ARE BASED ON SAID PLAT OF RECORD AND THE BEARING BASIS SHOWN HEREDON.
3. IT IS APPARENT THAT THIS PARCEL IS IN ZONE "X" AND IS DETERMINED TO BE OUTSIDE THE 500 YEAR FLOOD PLAIN AS PER FLOOD RATE MAP, DATED 4 FEBRUARY, 2009 FIRM PANEL NUMBER 12023C0415C. HOWEVER, THE FLOOD INSURANCE RATE MAPS ARE SUBJECT TO CHANGE.
4. THE IMPROVEMENTS, IF ANY, INDICATED ON THIS SURVEY DRAWING ARE AS LOCATED ON DATE OF FIELD SURVEY AS SHOWN HEREDON.
5. IF THEY EXIST, NO UNDERGROUND ENCROACHMENTS AND/OR UTILITIES WERE LOCATED FOR THIS SURVEY EXCEPT AS SHOWN HEREDON.
6. THIS SURVEY WAS COMPLETED WITHOUT THE BENEFIT OF A TITLE COMMITMENT OR A TITLE POLICY.
7. DIMENSIONS SHOWN HEREDON ARE IN FEET AND DECIMAL PARTS THEREOF.
8. THIS SURVEY DOES NOT REFLECT OR DETERMINE OWNERSHIP.
9. THE ADJACENT OWNERSHIP INFORMATION AS SHOWN HEREDON IS BASED ON THE COUNTY PROPERTY APPRAISERS GIS SYSTEM, UNLESS OTHERWISE DENOTED.

ABLE CHARGE AND MEETS THE MINIMUM PROFESSIONAL SURVEYORS AND MAPPERS FIRM #12027, FLORIDA STATUTES.

BRITT BRITT, P.S.M.
REGISTRATION # 5757

OF A FLORIDA LICENSED SURVEYOR AND POSSES ONLY AND IS NOT VALID.



BRITT SURVEYING & MAPPING, LLC

LAND SURVEYORS AND MAPPERS, L.B. # 8016

2086 SW MAIN BLVD, SUITE. 112, LAKE CITY, FLORIDA 32025

(386)752-7163 FAX (386)752-5573

www.brittsurvey.com

WORK ORDER # L- **25832**