

**Columbia County New Building Permit Application**

<b>For Office Use Only</b>		Application # <u>44407</u>	Date Received <u>1/24/20</u>	By <u>LH</u>	Permit # <u>39233</u>
Zoning Official <u>LW / LH</u>	Date <u>1-28-20</u>	Flood Zone <u>X</u>	Land Use <u>Ag</u>	Zoning <u>A-3</u>	
FEMA Map # _____	Elevation _____	MFE _____	River _____	Plans Examiner <u>T.C.</u>	Date <u>1-30-20</u>
<b>Comments</b>					
<input checked="" type="checkbox"/> NOC <input checked="" type="checkbox"/> DEH <input type="checkbox"/> Deed or PA <input type="checkbox"/> Site Plan <input type="checkbox"/> State Road Info <input type="checkbox"/> Well letter <input type="checkbox"/> 911 Sheet <input type="checkbox"/> Parent Parcel # _____ <input type="checkbox"/> Dev Permit # _____ <input type="checkbox"/> In Floodway <input checked="" type="checkbox"/> Letter of Auth. from Contractor <input type="checkbox"/> F W Comp. letter _____ <input type="checkbox"/> Owner Builder Disclosure Statement <input type="checkbox"/> Land Owner Affidavit <input type="checkbox"/> Ellisville Water <input checked="" type="checkbox"/> App Fee Paid <input checked="" type="checkbox"/> Sub VF Form _____					
Septic Permit No. <u>20-0068</u>		OR City Water <input type="checkbox"/>		Fax <u>336-551-3449</u>	
Applicant (Who will sign/pickup the permit) <u>Bami Al-Chacar</u>			Phone <u>336-367-6600</u>		
Address <u>310 Skyview Gln, Lake City, FL 32024</u>					
Owners Name <u>Milton Westover</u>			Phone _____		
911 Address <u>310 Skyview Gln, Lake City, FL 32024</u>					
Contractors Name <u>Javier Lara</u>			Phone <u>877-272-8276</u>		
Address <u>820 Reeves Drive, Mt. Airy, NC 27030</u>					
Contractor Email <u>Sbspermitting@sbsihq.com</u>			***Include to get updates on this job.		
Fee Simple Owner Name & Address _____					
Bonding Co. Name & Address _____					
Architect/Engineer Name & Address <u>Wayne S. Moore, 401 S. Main St., Mt. Airy, NC 27030</u>					
Mortgage Lenders Name & Address _____					
Circle the correct power company <input type="checkbox"/> FL Power & Light <input type="checkbox"/> Clay Elec. <input type="checkbox"/> Suwannee Valley Elec. <input type="checkbox"/> Duke Energy					
Property ID Number <u>35-3S-15-00278-005</u>		Estimated Construction Cost <u>5957.27</u>			
Subdivision Name <u>Kronyville Forest</u>		Lot <u>1</u>	Block <u>B</u>	Unit _____	Phase _____
Driving Directions from a Major Road <u>* See attached *</u>					
Construction of <u>22 x 35 accessory structure</u> <input type="checkbox"/> Commercial OR <input checked="" type="checkbox"/> Residential					
Proposed Use/Occupancy <u>accessory storage / carport</u>		Number of Existing Dwellings on Property <u>1</u>			
Is the Building Fire Sprinkled? <u>No</u> If Yes, blueprints included _____ Or Explain _____					
Circle Proposed <input type="checkbox"/> Culvert Permit or <input type="checkbox"/> Culvert Waiver or <input type="checkbox"/> D.O.T. Permit or <input checked="" type="checkbox"/> Have an Existing Drive					
Actual Distance of Structure from Property Lines - Front _____ Side _____ Side _____ Rear _____					
Number of Stories _____		Heated Floor Area <u>0</u>		Total Floor Area <u>770</u> Acreage <u>8.33</u>	
Zoning Applications applied for (Site & Development Plan, Special Exception, etc.) _____					

App Emailed in .

LH - Emailed on 1/24/20

**Columbia County Building Permit Application**

**CODE: Florida Building Code 2017 and the 2014 National Electrical Code.**

Application is hereby made to obtain a permit to do work and installations as indicated. I certify that no work or installation has commenced prior to the issuance of a permit and that all work be performed to meet the standards of all laws regulating construction in this jurisdiction.

**TIME LIMITATIONS OF APPLICATION :** An application for a permit for any proposed work shall be deemed to have been abandoned 180 days after the date of filing, unless pursued in good faith or a permit has been issued.

**TIME LIMITATIONS OF PERMITS:** Every permit issued shall become invalid unless the work authorized by such permit is commenced within 180 days after its issuance, or if the work authorized by such permit is suspended or abandoned for a period of 180 days after the time work is commenced. A valid permit receives an approved inspection every 180 days. Work shall be considered not suspended, abandoned or invalid when the permit has received an approved inspection within 180 days of the previous approved inspection.

**FLORIDA'S CONSTRUCTION LIEN LAW: Protect Yourself and Your Investment:** According to Florida Law, those who work on your property or provide materials, and are not paid-in-full, have a right to enforce their claim for payment against your property. This claim is known as a construction lien. If your contractor fails to pay subcontractors or material suppliers or neglects to make other legally required payments, the people who are owed money may look to your property for payment, even if you have paid your contractor in full. This means if a lien is filed against your property, it could be sold against your will to pay for labor, materials or other services which your contractor may have failed to pay.

**NOTICE OF RESPONSIBILITY TO CONTRACTOR AND AGENT:** **YOU ARE HEREBY NOTIFIED** as the recipient of a building permit from Columbia County, Florida, you will be held responsible to the County for any damage to sidewalks and/or road curbs and gutters, concrete features and structures, together with damage to drainage facilities, removal of sod, major changes to lot grades that result in ponding of water, or other damage to roadway and other public infrastructure facilities caused by you or your contractor, subcontractors, agents or representatives in the construction and/or improvement of the building and lot for which this permit is issued. No certificate of occupancy will be issued until all corrective work to these public infrastructures and facilities has been corrected.

**WARNING TO OWNER:** YOUR FAILURE TO RECORD A NOTICE OF COMMENCEMENT MAY RESULT IN YOU PAYING TWICE FOR IMPROVEMENTS TO YOUR PROPERTY. A NOTICE OF COMMENCEMENT MUST BE RECORDED AND POSTED ON THE JOB SITE BEFORE THE FIRST INSPECTION. IF YOU INTEND TO OBTAIN FINANCING, CONSULT WITH YOUR LENDER OR ATTORNEY BEFORE RECORDING YOUR NOTICE OF COMMENCEMENT.

**OWNERS CERTIFICATION:** I CERTIFY THAT ALL THE FOREGOING INFORMATION IS ACCURATE AND THAT ALL WORK WILL BE DONE IN COMPLIANCE WITH ALL APPLICABLE LAWS REGULATING CONSTRUCTION AND ZONING.

**NOTICE TO OWNER:** There are some properties that may have deed restrictions recorded upon them. These restrictions may limit or prohibit the work applied for in your building permit. You must verify if your property is encumbered by any restrictions or face possible litigation and or fines.

Milton R. Westover

Print Owners Name

Milton R. Westover

Owners Signature

**\*\*Property owners must sign here before any permit will be issued.**

**\*\*If this is an Owner Builder Permit Application then, ONLY the owner can sign the building permit when it is issued.**

**CONTRACTORS AFFIDAVIT:** By my signature I understand and agree that I have informed and provided this written statement to the owner of all the above written responsibilities in Columbia County for obtaining this Building Permit including all application and permit time limitations.

Frances Garcia  
Contractor's Signature

Contractor's License Number CBC1260497  
Columbia County  
Competency Card Number \_\_\_\_\_

Affirmed under penalty of perjury to by the Contractor and subscribed before me this 14th day of January 2020

Personally known ☒ or Produced Identification \_\_\_\_\_

Frances Garcia  
State of Florida Notary Signature (For the Contractor)

SEAL:

**FRANCES GARCIA**  
NOTARY PUBLIC  
SURRY COUNTY  
STATE OF NORTH CAROLINA

**Columbia County Property Appraiser**

Jeff Hampton

**2020 Working Values**

updated: 1/6/2020

Parcel: &lt;&lt; 35-3S-15-00278-005 &gt;&gt;

Aerial Viewer Pictometry Google Maps

**Owner & Property Info**

Result: 1 of 1

Owner	WESTOVER MILTON R 310 SW SKYVIEW GLEN LAKE CITY, FL 32024		
Site	310 SKYVIEW GLN, LAKE CITY		
Description*	COMM SE COR OF LOT 1 BLOCK B KOONEYVILLE FOREST S/D, RUN E 500 FT FOR POB, RUN N 447.85 FT, E 389.30 FT, S 940.56 FT, W 382.53 FT, N 492 FT TO POB. 584-035, LE 1354-281.		
Area	8.33 AC	S/T/R	35-3S-15
Use Code**	SINGLE FAM (000100)	Tax District	3

\*The Description above is not to be used as the Legal Description for this parcel in any legal transaction.

\*\*The Use Code is a FL Dept. of Revenue (DOR) code and is not maintained by the Property Appraiser's office. Please contact your city or county Planning &amp; Zoning office for specific zoning information.

**Property & Assessment Values**

2019 Certified Values			2020 Working Values		
Mkt Land (1)	\$35,679		Mkt Land (1)	\$35,679	
Ag Land (0)	\$0		Ag Land (0)	\$0	
Building (1)	\$110,479		Building (1)	\$112,882	
XFOB (2)	\$2,600		XFOB (2)	\$2,600	
Just	\$148,758		Just	\$151,161	
Class	\$0		Class	\$0	
Appraised	\$148,758		Appraised	\$151,161	
SOH Cap [?]	\$11,334		SOH Cap [?]	\$9,614	
Assessed	\$137,424		Assessed	\$141,547	
Exempt	HX H3 OTHER	\$55,000	Exempt	HX H3 OTHER	\$55,000
Total	county:\$82,424 city:\$82,424		Total	county:\$86,547 city:\$86,547	
Taxable	other:\$82,424 school:\$107,424		Taxable	other:\$86,547 school:\$111,547	

2019 2016 2013 2010 2007 2005 Sales

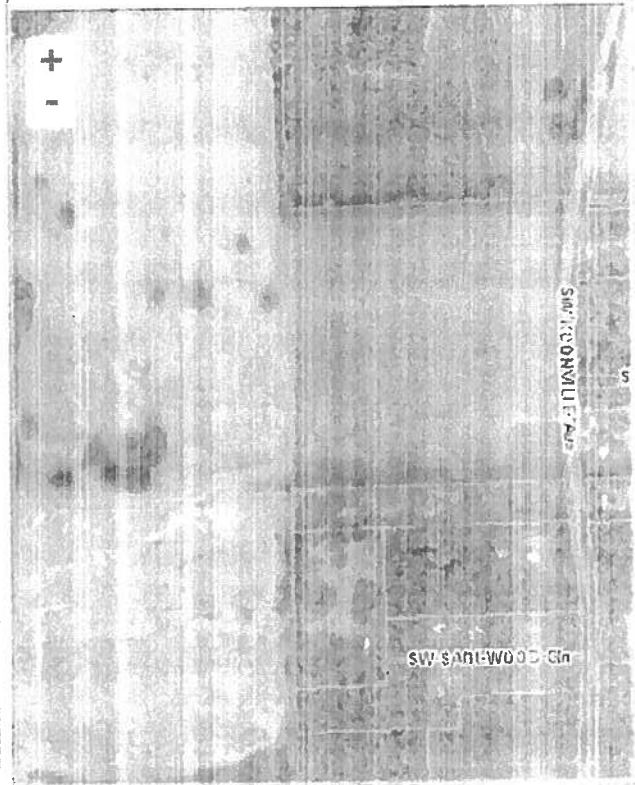
**▼ Sales History**

Sale Date	Sale Price	Book/Page	Deed	V/I	Quality (Codes)	RCode
2/14/2018	\$100	1354/0281	LE	I	U	14

**▼ Building Characteristics**

Bldg Sketch	Bldg Item	Bldg Desc*	Year Blt	Base SF	Actual SF	Bldg Value
Sketch	2	SINGLE FAM (000100)	2003	1581	1989	\$112,882

\*Bldg Desc determinations are used by the Property Appraisers office solely for the purpose of determining a property's Just Value for ad valorem tax purposes and should not be used for any other purpose.

**▼ Extra Features & Out Buildings (Codes)**

Code	Desc	Year Blt	Value	Units	Dims	Condition (% Good)
0294	SHED WOOD/	0	\$800.00	1.000	16 x 24 x 0	(000.00)
0070	CARPORT UF	2003	\$1,800.00	600.000	20 x 30 x 0	(000.00)

**▼ Land Breakdown**

Land Code	Desc	Units	Adjustments	Eff Rate	Land Value
000100	SFR (MKT)	8.330 AC	1.00/1.00 1.00/1.00	\$4,283	\$35,679

Search Result: 1 of 1

© Columbia County Property Appraiser | Jeff Hampton | Lake City, Florida | 386-758-1083

by: GrizzlyLogic.com

# SUBCONTRACTOR VERIFICATION

APPLICATION/PERMIT # \_\_\_\_\_ JOB NAME Milton Westover

## THIS FORM MUST BE SUBMITTED BEFORE A PERMIT WILL BE ISSUED

Columbia County issues combination permits. One permit will cover all trades doing work at the permitted site. It is **REQUIRED** that we have records of the subcontractors who actually did the trade specific work under the general contractors permit.

**NOTE:** It shall be the responsibility of the general contractor to make sure that all of the subcontractors are licensed with the Columbia County Building Department.

Use website to confirm licenses: <http://www.columbiacountyfla.com/PermitSearch/ContractorSearch.aspx>

**NOTE:** If this should change prior to completion of the project, it is your responsibility to have a corrected form submitted to our office, before that work has begun.

Violations will result in stop work orders and/or fines.

<b>ELECTRICAL</b> <input type="checkbox"/> CC# _____	Print Name <u>No electrical</u> Signature _____ Company Name: _____ License #: _____ Phone #: _____	<b>Need</b> <input type="checkbox"/> Lic <input type="checkbox"/> Liab <input type="checkbox"/> W/C <input type="checkbox"/> EX <input type="checkbox"/> DE
<b>MECHANICAL/A/C</b> <input type="checkbox"/> CC# _____	Print Name <u>No mechanical</u> Signature _____ Company Name: _____ License #: _____ Phone #: _____	<b>Need</b> <input type="checkbox"/> Lic <input type="checkbox"/> Liab <input type="checkbox"/> W/C <input type="checkbox"/> EX <input type="checkbox"/> DE
<b>PLUMBING/GAS</b> <input type="checkbox"/> CC# _____	Print Name <u>No Plumbing</u> Signature _____ Company Name: _____ License #: _____ Phone #: _____	<b>Need</b> <input type="checkbox"/> Lic <input type="checkbox"/> Liab <input type="checkbox"/> W/C <input type="checkbox"/> EX <input type="checkbox"/> DE
<b>ROOFING</b> <input type="checkbox"/> CC# _____	Print Name _____ Signature _____ Company Name: _____ License #: _____ Phone #: _____	<b>Need</b> <input type="checkbox"/> Lic <input type="checkbox"/> Liab <input type="checkbox"/> W/C <input type="checkbox"/> EX <input type="checkbox"/> DE
<b>SHEET METAL</b> <input type="checkbox"/> CC# _____	Print Name _____ Signature _____ Company Name: _____ License #: _____ Phone #: _____	<b>Need</b> <input type="checkbox"/> Lic <input type="checkbox"/> Liab <input type="checkbox"/> W/C <input type="checkbox"/> EX <input type="checkbox"/> DE
<b>FIRE SYSTEM/SPRINKLER</b> <input type="checkbox"/> CC# _____	Print Name <u>N/A</u> Signature _____ Company Name: _____ License #: _____ Phone #: _____	<b>Need</b> <input type="checkbox"/> Lic <input type="checkbox"/> Liab <input type="checkbox"/> W/C <input type="checkbox"/> EX <input type="checkbox"/> DE
<b>SOLAR</b> <input type="checkbox"/> CC# _____	Print Name <u>N/A</u> Signature _____ Company Name: _____ License #: _____ Phone #: _____	<b>Need</b> <input type="checkbox"/> Lic <input type="checkbox"/> Liab <input type="checkbox"/> W/C <input type="checkbox"/> EX <input type="checkbox"/> DE
<b>STATE SPECIALTY</b> <input type="checkbox"/> CC# _____	Print Name <u>N/A</u> Signature _____ Company Name: _____ License #: _____ Phone #: _____	<b>Need</b> <input type="checkbox"/> Lic <input type="checkbox"/> Liab <input type="checkbox"/> W/C <input type="checkbox"/> EX <input type="checkbox"/> DE

North  
Boundary

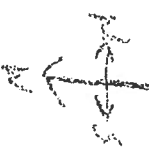

680'

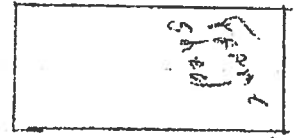

Garage

50'



House

63'

22' x 35'

33'



Well

15'

13'

19'

225'

5' Boundary line

W Boundary line



Septic

# NOTICE OF COMMENCEMENT

Tax Parcel Identification Number:

35-35-15-00278-005

Clerk's Office Stamp

Inst: 202012001687 Date: 01/21/2020 Time: 11:39AM  
Page 1 of 1 B: 1403 P: 2369, P. DeWitt Cason, Clerk of Court  
Columbia, County, By: LK  
Deputy Clerk

THE UNDERSIGNED hereby gives notice that improvements will be made to certain real property, and in accordance with Section 713.13 of the Florida Statutes, the following information is provided in this NOTICE OF COMMENCEMENT.

1. Description of property (legal description): Comm se cor of Lot 1 Block B Kooneyville forest.  
a) Street (job) Address: 310 Skyview GLN, Lake City, FL 32024
2. General description of improvements: 22x35 detached residential accessory structure
3. Owner Information or Lessee information if the Lessee contracted for the improvements:  
a) Name and address: Milton Westover, 310 Skyview Gln, Lake City, FL 32024  
b) Name and address of fee simple titleholder (if other than owner):  
c) Interest in property: Storage / carport
4. Contractor Information  
a) Name and address: Javier Lara, 820 Reeves Drive, Mt. Airy, NC 27030  
b) Telephone No.: 877-272-8276
5. Surety Information (if applicable, a copy of the payment bond is attached):  
a) Name and address:  
b) Amount of Bond:  
c) Telephone No.:
6. Lender  
a) Name and address:  
b) Phone No.:
7. Person within the State of Florida designated by Owner upon whom notices or other documents may be served as provided by Section 713.13(1)(a)7., Florida Statutes:  
a) Name and address:  
b) Telephone No.:
8. In addition to himself or herself, Owner designates the following person to receive a copy of the Lienor's Notice as provided in Section 713.13(1)(b), Florida Statutes:  
a) Name: \_\_\_\_\_ OF \_\_\_\_\_  
b) Telephone No.: \_\_\_\_\_
9. Expiration date of Notice of Commencement (the expiration date will be 1 year from the date of recording unless a different date is specified): \_\_\_\_\_

**WARNING TO OWNER: ANY PAYMENTS MADE BY THE OWNER AFTER THE EXPIRATION OF THE NOTICE OF COMMENCEMENT ARE CONSIDERED IMPROPER PAYMENTS UNDER CHAPTER 713, PART I, SECTION 713.13, FLORIDA STATUTES, AND CAN RESULT IN YOUR PAYING TWICE FOR IMPROVEMENTS TO YOUR PROPERTY; A NOTICE OF COMMENCEMENT MUST BE RECORDED AND POSTED ON THE JOB SITE BEFORE THE FIRST INSPECTION. IF YOU INTEND TO OBTAIN FINANCING, CONSULT YOUR LENDER OR AN ATTORNEY BEFORE COMMENCING WORK OR RECORDING YOUR NOTICE OF COMMENCEMENT.**

STATE OF FLORIDA  
COUNTY OF COLUMBIA

10. Milton R. Westover  
Signature of Owner or Lessee, or Owner's or Lessee's Authorized Office/Director/Partner/Manager

Milton Randall Westover  
Printed Name and Signatory's Title/Office

The foregoing instrument was acknowledged before me, a Florida Notary, this 21<sup>st</sup> day of January, 202021, by:  
Milton Randall Westover Owner for \_\_\_\_\_  
(Name of Person) (Type of Authority) (name of party on behalf of whom instrument was executed)

Personally Known \_\_\_\_\_ OR Produced Identification ☒ Type: 4710

Notary Signature Laura B Koon

Notary Stamp or

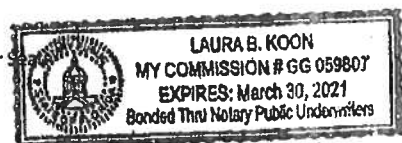





App # 44407



STATE OF FLORIDA  
DEPARTMENT OF HEALTH  
ONSITE SEWAGE TREATMENT AND DISPOSAL  
SYSTEM  
APPLICATION FOR CONSTRUCTION PERMIT

PERMIT NO. 20-20068  
DATE PAID: 11/27/20  
FEE PAID: 600.00  
RECEIPT #: 1464546

## APPLICATION FOR:

☐ New System ☒ Existing System ☐ Holding Tank ☐ Innovative  
☐ Repair ☐ Abandonment ☐ Temporary ☐

APPLICANT: Steel Buildings and Structures, Inc. Milton W. StoenAGENT: Javier Lara TELEPHONE: 877-272-8276MAILING ADDRESS: P.O. Box 1287, Mt. Airy, NC 27030

TO BE COMPLETED BY APPLICANT OR APPLICANT'S AUTHORIZED AGENT. SYSTEMS MUST BE CONSTRUCTED BY A PERSON LICENSED PURSUANT TO 489.105(3)(m) OR 489.552, FLORIDA STATUTES. IT IS THE APPLICANT'S RESPONSIBILITY TO PROVIDE DOCUMENTATION OF THE DATE THE LOT WAS CREATED OR PLATTED (MM/DD/YY) IF REQUESTING CONSIDERATION OF STATUTORY GRANDFATHER PROVISIONS.

## PROPERTY INFORMATION

LOT: 1 BLOCK: B SUBDIVISION: Kooneyville Forrest PLATTED: \_\_\_\_\_PROPERTY ID #: 35-35-15-00278-005 ZONING: \_\_\_\_\_ I/M OR EQUIVALENT: ☒ Y / ☐ NPROPERTY SIZE: 8.33 ACRES WATER SUPPLY: ☒ PRIVATE PUBLIC ☐ <=2000GPD ☐ >2000GPDIS SEWER AVAILABLE AS PER 381.0065, FS? ☐ Y / ☐ N DISTANCE TO SEWER: \_\_\_\_\_ FTPROPERTY ADDRESS: 310 Skyview Gln, Lake City, FL 32024DIRECTIONS TO PROPERTY: \* See Attached \*

## BUILDING INFORMATION

☒ RESIDENTIAL☐ COMMERCIAL

Unit No	Type of Establishment	No. of Bedrooms	Building Area Sqft	Commercial/Institutional System Design Table 1, Chapter 64E-6, FAC
1	Single Family		1581	OK Site
2	Accessory	0	770	(Carport addition)
3				
4				

☐ Floor/Equipment Drains ☐ Other (Specify) \_\_\_\_\_SIGNATURE: Javier Lara DATE: 01-23-2020

DH 4015, 08/09 (Obsoletes previous editions which may not be used)  
Incorporated 64E-6.001, FAC

STATE OF FLORIDA  
DEPARTMENT OF HEALTH  
APPLICATION FOR CONSTRUCTION PERMIT

Permit Application Number 20-0008

----- PART II - SITEPLAN -----

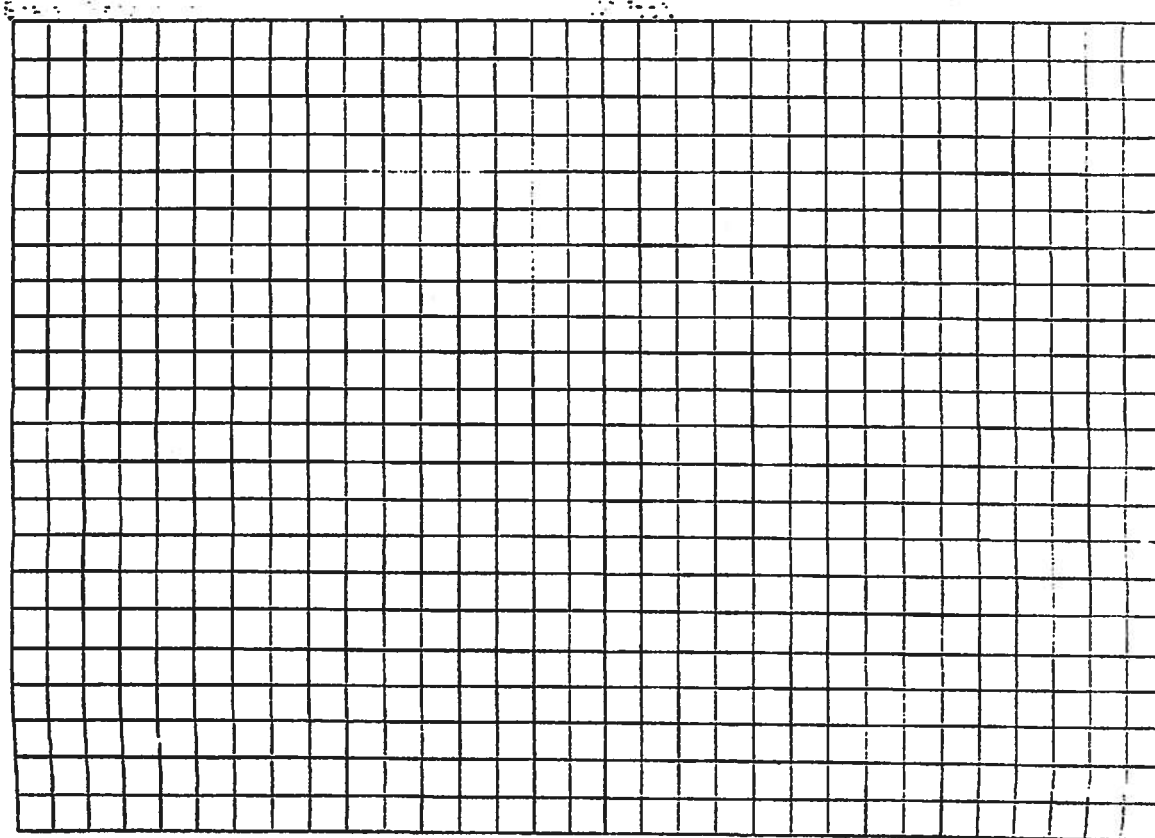

Notes: See Attached

Site Plan submitted by: Milton Westover

Plan Approved X

Not Approved \_\_\_\_\_

Date 1/30/20

By [Signature]

Columbia

County Health Department

ALL CHANGES MUST BE APPROVED BY THE COUNTY HEALTH DEPARTMENT

DH 4015, 09/09 (Obsoletes previous editions which may not be used) Incorporated: 64E-6.301, FAC  
(Stock Number: 5744-002-4015-6)

Page 2 of 4



20-0068

W Boundary line

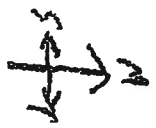
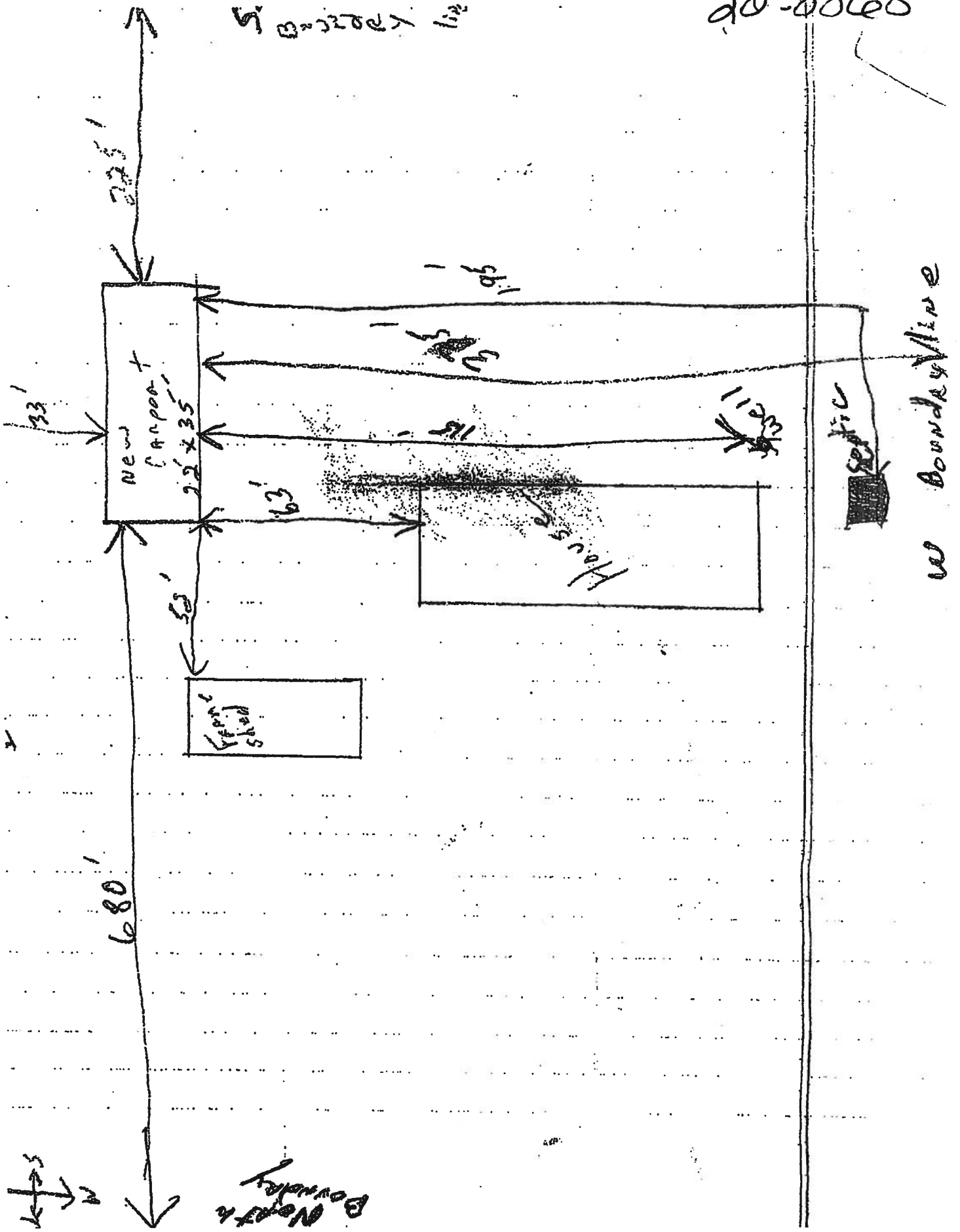

North  
Boundary

As required by Florida Statute 553.842 and Florida Administrative Code 9B-72, please provide the information and approval numbers on the building components listed below if they will be utilized on the construction project for which you are applying for a building permit. We recommend you contact your local product supplier should you not know the product approval number for any of the applicable listed products. Statewide approved products are listed online @ [www.floridabuilding.org](http://www.floridabuilding.org)

Category/Subcategory	Manufacturer	Product Description	Approval Number(s)
<b>1. EXTERIOR DOORS</b>			
A. SWINGING			
B. SLIDING			
C. SECTIONAL/ROLL UP			
D. OTHER			
<b>2. WINDOWS</b>			
A. SINGLE/DOUBLE HUNG			
B. HORIZONTAL SLIDER			
C. CASEMENT			
D. FIXED			
E. MULLION			
F. SKYLIGHTS			
G. OTHER			
<b>3. PANEL WALL</b>			
A. SIDING			
B. SOFFITS			
C. STOREFRONTS			
D. GLASS BLOCK			
E. OTHER	Steel Buildings	Ag Panel wall	22562.1
<b>4. ROOFING PRODUCTS</b>			
A. ASPHALT SHINGLES			
B. NON-STRUCT METAL			
C. ROOFING TILES			
D. SINGLE PLY ROOF			
E. OTHER			
<b>5. STRUCT COMPONENTS</b>			
A. WOOD CONNECTORS			
B. WOOD ANCHORS			
C. TRUSS PLATES			
D. INSULATION FORMS			
E. LINTELS			
F. OTHERS	Steel Buildings	Ag metal roof	22561.1
<b>6. NEW EXTERIOR ENVELOPE PRODUCTS</b>			

The products listed below did not demonstrate product approval at plan review. I understand that at the time of inspection of these products, the following information must be available to the inspector on the jobsite; 1) copy of the product approval, 2) performance characteristics which the product was tested and certified to comply with, 3) copy of the applicable manufacturers installation requirements.

Further, I understand these products may have to be removed if approval cannot be demonstrated during inspection.

NOTES: \_\_\_\_\_

\_\_\_\_\_



## **STRUCTURAL DESIGN FULLY OPEN (CARPORT) BUILDING**

**MAXIMUM 30'-0" WIDE X 20'-0" EAVE HEIGHT- BOX EAVE  
FRAME**

**14 December 2018**

**Revision 7**

**M&A Project No. 16062S/16155S/16207S/17155S/17200S/18068S/18156S/18290S**

**Prepared for:**

**Steel Buildings and Structures, Inc.  
P.O. Box 1287  
Mt. Airy, NC 27030**

**Prepared by:**

**Moore and Associates Engineering  
and Consulting, Inc.**

**1009 East Avenue  
North Augusta, SC 29841**

**401 S. Main St., Suite 200  
Mount Airy, NC 27030**

Digitally signed  
by Wayne S  
Moore  
Date: 2018.12.17  
13:54:32 -05'00'



**MOORE AND ASSOCIATES  
ENGINEERING AND CONSULTING**

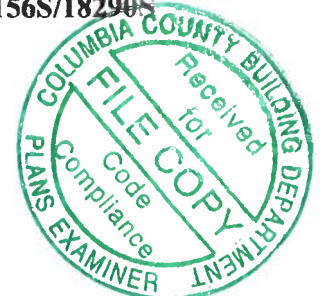

This item has been electronically signed and sealed by Wayne S. Moore, PE, using a Digital Signature and date.

Printed copies of this document are not considered signed and sealed and the signature must be verified on any electronic copies.

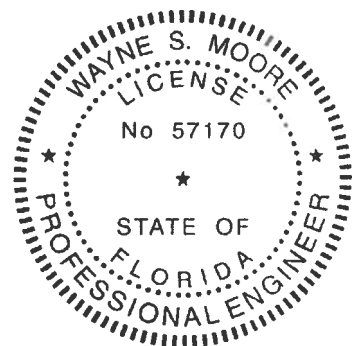

This item has been electronically signed and sealed by Wayne S. Moore, PE, using a Digital Signature and date.

Printed copies of this document are not considered signed and sealed and the signature must be verified on any electronic copies.

**MOORE AND ASSOCIATES  
ENGINEERING AND CONSULTING, INC.**

**DRAWN BY: AT**

**CHECKED BY: PDH**

**PROJECT MGR: WSM**

**CLIENT: SSSI**

**STEEL BUILDINGS AND STRUCTURES, INC.**  
P.O. BOX 1287,  
MOUNT AIRY, NC 27030  
30'-0"x20'-0" FULLY OPEN STRUCTURE

**DATE: 12-14-18**

**SCALE: NTS**

**JOB NO: 180685/180905**

**SHT. 1**

**DWG. NO SK-1**

**REV: 7**

THIS DOCUMENT IS THE PROPERTY OF MOORE AND ASSOCIATES ENGINEERING AND CONSULTING. THE UNAUTHORIZED REPRODUCTION, COPYING, OR OTHERWISE USE OF THIS DOCUMENT IS STRICTLY PROHIBITED AND ANY INFRINGEMENT THEREUPON MAY BE SUBJECT TO LEGAL ACTION.

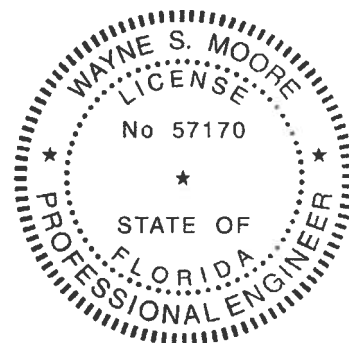

This item has been electronically signed and sealed by Wayne S. Moore, PE, using a Digital Signature and date.

Printed copies of this document are not considered signed and sealed and the signature must be verified on any electronic copies.

**MOORE AND ASSOCIATES  
ENGINEERING AND CONSULTING, INC.**

**DRAWN BY: AT**

**CHECKED BY: PDH**

**PROJECT MGR: VSH**

**CLIENT: SISI**

**STEEL BUILDINGS AND STRUCTURES, INC.**  
P.O. BOX 1287,  
MOUNT AIRY, NC 27030  
30'-0" x 20'-0" FULLY OPEN STRUCTURE

**DATE: 12-14-18**

**SCALE: NTS**

**JOB NO: 18068S/18154S/18220S**

**SHT. 1A**

**DWG. NO SK-1**

**REV. 7**

THIS DOCUMENT IS THE PROPERTY OF MOORE AND ASSOCIATES ENGINEERING AND CONSULTING, INC. UNAUTHORIZED REPRODUCTION, COPYING, OR OTHERWISE USE OF THIS DOCUMENT IS STRICTLY PROHIBITED AND ANY INFRINGEMENT THEREUPON MAY BE SUBJECT TO LEGAL ACTION.

# DRAWING INDEX

SHEET 1	PE SEAL COVER SHEET (1 OF 2)
SHEET 1A	PE SEAL COVER SHEET (2 OF 2)
SHEET 2	DRAWING INDEX
SHEET 3	INSTALLATION NOTES AND SPECIFICATIONS
SHEET 3A	TYPICAL SIDE AND END ELEVATIONS
SHEET 4	TYPICAL RAFTER/COLUMN END AND SIDE FRAMING SECTION (BOX EAVE STRUCTURE)
SHEET 4A	TYPICAL RAFTER/COLUMN END AND SIDE FRAMING SECTION (BOX EAVE STRUCTURE)
SHEET 4B	TYPICAL RAFTER/COLUMN END AND SIDE FRAMING SECTION (BOX EAVE STRUCTURE)
SHEET 4C	TYPICAL RAFTER/COLUMN END AND SIDE FRAMING SECTION (BOX EAVE STRUCTURE)
SHEET 4D	TYPICAL RAFTER/COLUMN END AND SIDE FRAMING SECTION (BOX EAVE STRUCTURE)
SHEET 4E	TYPICAL RAFTER/COLUMN END AND SIDE FRAMING SECTION (BOX EAVE STRUCTURE)
SHEET 5	COLUMN CONNECTION DETAILS (BOX EAVE STRUCTURE)
SHEET 5A	COLUMN CONNECTION DETAILS (BOX EAVE STRUCTURE)
SHEET 6	COLUMN CONNECTION DETAILS (BOX EAVE STRUCTURE)
SHEET 6A	COLUMN CONNECTION DETAILS (BOX EAVE STRUCTURE)
SHEET 7	BASE RAIL ANCHORAGE OPTIONS
SHEET 8	CONNECTION DETAILS
SHEET 9	GABLE END OPTION (BOX EAVE STRUCTURE)
SHEET 9A	GABLE END OPTION (BOX EAVE STRUCTURE)
SHEET 10	EXTRA SIDE PANEL OPTION
SHEET 10A	EXTRA SIDE PANEL OPTION
SHEET 10B	EXTRA SIDE PANEL OPTION
SHEET 10C	EXTRA SIDE PANEL OPTION
SHEET 10D	EXTRA SIDE PANEL OPTION
SHEET 11	EXTRA SIDE PANEL OPTION
SHEET 11A	EXTRA SIDE PANEL OPTION
SHEET 11B	EXTRA SIDE PANEL OPTION
SHEET 11C	EXTRA SIDE PANEL OPTION
SHEET 11D	EXTRA SIDE PANEL OPTION
SHEET 12	VERTICAL ROOF OPTION END AND SIDE ELEVATION AND SECTION
SHEET 13	ADDITIONAL BASE RAIL ANCHORAGE OPTION
SHEET 14	BASE RAIL ON GRADE APPLICATION
SHEET 15	OPTIONAL BASE RAIL ON TIMBER BEAM
SHEET 16	OPTIONAL BASE RAIL ON TIMBER BEAM WITH SOIL NAIL
SHEET 17	OPTIONAL CONCRETE STRIP FOOTING

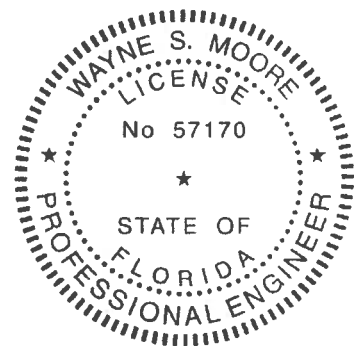

This item has been electronically signed and sealed by Wayne S. Moore, PE, using a Digital Signature and date.

Printed copies of this document are not considered signed and sealed and the signature must be verified on any electronic copies.

**MOORE AND ASSOCIATES  
ENGINEERING AND CONSULTING, INC.**

**DRAWN BY: AT**

**CHECKED BY: PMH**

**PROJECT NO: VSH**

**CLIENT: SSSI**

**STEEL BUILDINGS AND STRUCTURES, INC.**

P.O. BOX 1287,

MOUNT AIRY, NC 27030

30'-0" x 20'-0" FULLY OPEN STRUCTURE

**DATE: 12-14-18**

**SCALE: NTS**

**JOB NO: 180583/182905**

**SHT. 2**

**DWG NO SK-1**

**REV. 7**

THIS DOCUMENT IS THE PROPERTY OF MOORE AND ASSOCIATES ENGINEERING AND CONSULTING, INC. THE UNAUTHORIZED REPRODUCTION, COPYING, OR OTHERWISE USE OF THIS DOCUMENT IS STRICTLY PROHIBITED AND ANY INFRINGEMENT THEREUPON MAY BE SUBJECT TO LEGAL ACTION.

## INSTALLATION NOTES AND SPECIFICATIONS

1. DESIGN IS FOR MAXIMUM 30'-0" WIDE x 20'-0" EAVE HEIGHT OPEN CARPORT STRUCTURES.
2. DESIGN WAS DONE IN ACCORDANCE WITH THE 2017 FLORIDA BUILDING CODE (FBC) 6TH EDITION, 2018 NORTH CAROLINA BUILDING CODE, 2006 INTERNATIONAL BUILDING CODE (IBC), 2009 IBC, 2012 IBC AND 2015 IBC.
3. DESIGN LOADS ARE AS FOLLOWS:
  - A) DEAD LOAD = 15 PSF
  - B) LIVE LOAD = 12 PSF
  - C) GROUND SNOW LOAD = 30 PSF ( $\leq 26'-0"$ ), 35 PSF ( $26'-0" < W \leq 30'-0"$ )  
(UNBALANCED SNOW LOADS DUE TO DRIFTING HAVE NOT BEEN EVALUATED)
4. 3-SECOND GUST ULTIMATE WIND SPEED ( $V_{ULT}$ ) 105 TO 145 MPH (NOMINAL WIND SPEED 82 TO 112 MPH) MAXIMUM RAFTER/COLUMN AND END COLUMN SPACING = 5.0 FEET (UNLESS NOTED OTHERWISE).
5. END WALL COLUMNS (POST) ARE EQUIVALENT TO SIDE WALL POSTS UNLESS NOTED OTHERWISE.
6. RISK CATEGORY I.
7. WIND EXPOSURE CATEGORY B.
8. SPECIFICATIONS APPLICABLE TO 29 GAUGE METAL PANELS FASTENED DIRECTLY TO 2 1/2" x 2 1/2" - 14 GAUGE TUBE STEEL (TS) FRAMING MEMBERS (UNLESS NOTED OTHERWISE).
9. AVERAGE FASTENER SPACING ON-CENTERS ALONG RAFTERS OR HAT CHANNELS, AND COLUMNS (INTERIOR OR END) = 8 INCHES.
10. FASTENERS CONSIST OF 1/4"x3/4" SELF-DRILLING FASTENER (SDF), USE CONTROL SEAL WASHER WITH EXTERIOR FASTENERS. SPECIFICATIONS APPLICABLE ONLY FOR MEAN ROOF HEIGHT OF 20 FEET OR LESS, AND ROOF SLOPES OF 14' (3:12 PITCH) OR LESS SPACING REQUIREMENTS FOR OTHER ROOF HEIGHTS AND/OR SLOPES MAY VARY.
11. GROUND ANCHORS SHALL BE INSTALLED THROUGH BASE RAIL WITHIN 6" OF EACH COLUMN.
12. GROUND ANCHORS CONSIST OF #4 REBAR W/ WELDED NUT x 36" LONG IN SUITABLE SOIL CONDITIONS. OPTIONAL ANCHORAGE MAY BE USED IN SUITABLE SOILS AND MUST BE USED IN UNSUITABLE SOILS AS NOTED.
13. WIND FORCES GOVERN OVER SEISMIC FORCES. SEISMIC PARAMETERS ANALYZED ARE:
  - SOIL SITE CLASS = D
  - RISK CATEGORY I/II/III
  - $R = 3.25$   $I_E = 1.0$
  - $S_{DS} = 2.039$   $V = C_s W$
  - $S_{DI} = 1.258$

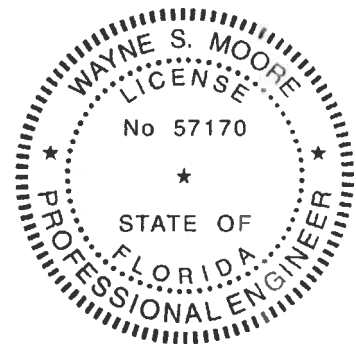

This item has been electronically signed and sealed by Wayne S. Moore, PE. using a Digital Signature and date.

Printed copies of this document are not considered signed and sealed and the signature must be verified on any electronic copies.

**MOORE AND ASSOCIATES  
ENGINEERING AND CONSULTING, INC.**

**DRAWN BY: AT**

**CHECKED BY: PDH**

**PROJECT MGR: VSM**

**CLIENT: SRST**

**STEEL BUILDINGS AND STRUCTURES, INC.**  
P.O. BOX 1287,  
MOUNT AIRY, NC 27030  
30'-0" x 20'-0" FULLY OPEN STRUCTURE

**DATE: 12-14-18**

**SCALE: NTS**

**DWG. NO: SK-1**

**JOB NO: 180685/182905**

**REV: 7**

THIS DOCUMENT IS THE PROPERTY OF MOORE AND ASSOCIATES ENGINEERING AND CONSULTING. THE UNAUTHORIZED REPRODUCTION, COPYING, OR OTHERWISE USE OF THIS DOCUMENT IS STRICTLY PROHIBITED AND ANY INFRINGEMENT THEREUPON MAY BE SUBJECT TO LEGAL ACTION.



# BOX EAVE FRAME RAFTER STRUCTURE

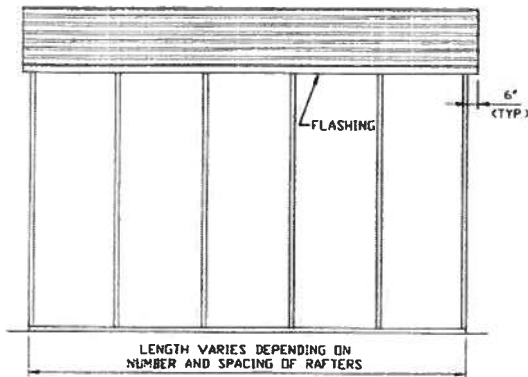

**TYPICAL SIDE ELEVATION**  
SCALE: NTS

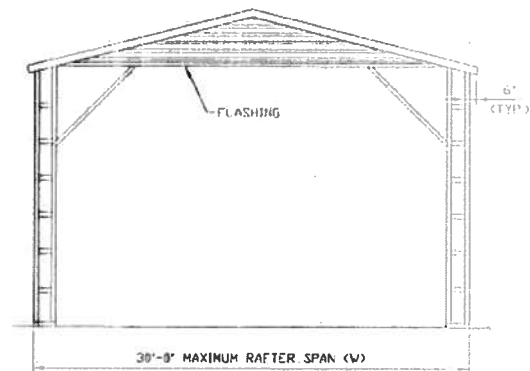

**TYPICAL END ELEVATION**  
SCALE: NTS

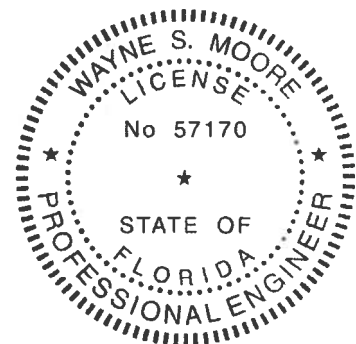

This item has been electronically signed and sealed by Wayne S. Moore, PE. using a Digital Signature and date.

Printed copies of this document are not considered signed and sealed and the signature must be verified on any electronic copies.

**MOORE AND ASSOCIATES  
ENGINEERING AND CONSULTING, INC.**

DRAWN BY: AT

CHECKED BY: PDH

PROJECT MGR: VSM

CLIENT: SSSI

**STEEL BUILDINGS AND STRUCTURES, INC.**  
P.O. BOX 1287,  
MOUNT AIRY, NC 27030  
30'-0" x 20'-0" FULLY OPEN STRUCTURE

DATE: 12-14-18

SCALE: NTS

JOB NO. 18069S/18090S

SHT. 3A

DWG. NO. SK-1

REV. 7

THIS DOCUMENT IS THE PROPERTY OF MOORE AND ASSOCIATES ENGINEERING AND CONSULTING, INC. THE UNAUTHORIZED REPRODUCTION, COPYING, OR OTHERWISE USE OF THIS DOCUMENT IS STRICTLY PROHIBITED AND ANY VIOLATION THEREOF MAY BE SUBJECT TO LEGAL ACTION.

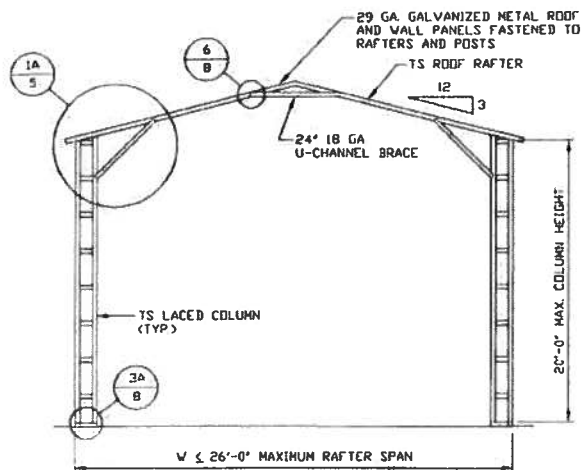

**TYPICAL RAFTER/COLUMN FRAME SECTION**  
SCALE: NTS

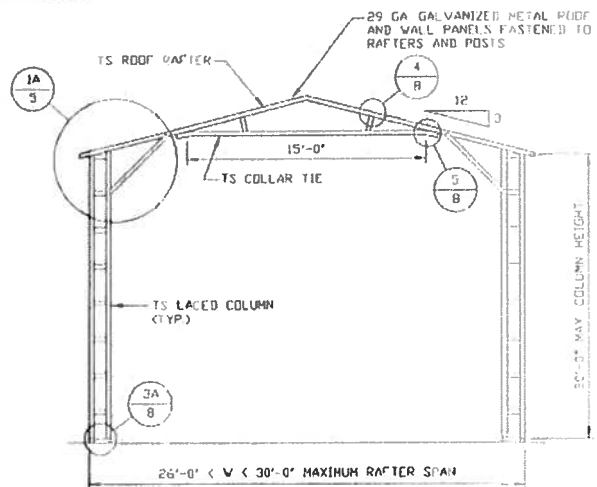

**TYPICAL RAFTER/COLUMN END FRAME SECTION**  
SCALE: NTS

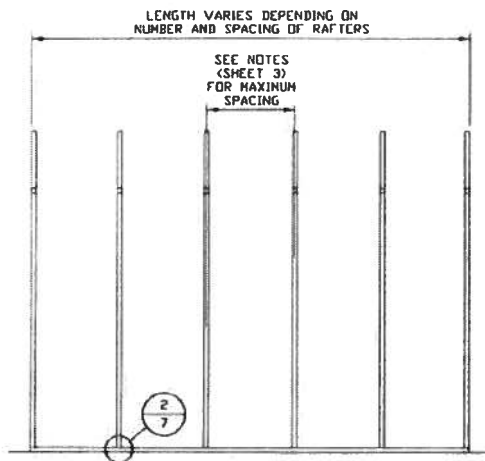

**TYPICAL RAFTER/COLUMN SIDE FRAMING SECTION**  
SCALE: NTS

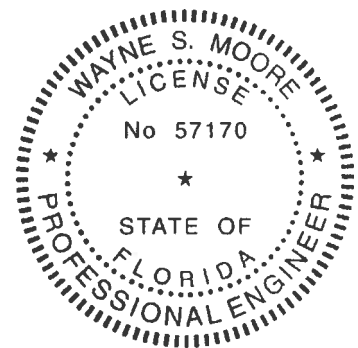

This item has been electronically signed and sealed by Wayne S. Moore, PE, using a Digital Signature and date.

Printed copies of this document are not considered signed and sealed and the signature must be verified on any electronic copies.

**MOORE AND ASSOCIATES  
ENGINEERING AND CONSULTING, INC.**

**DRAWN BY: AT**

**CHECKED BY: PJH**

**PROJECT MGR: VSH**

**CLIENT: SBSI**

**STEEL BUILDINGS AND STRUCTURES, INC.**  
P.O. BOX 1287,  
MOUNT AIRY, NC 27030  
30'-0" x 20'-0" FULLY OPEN STRUCTURE

**DATE: 12-14-18**

**SHT. 4**

**SCALE: NTS**

**DWG NO SK-1**

**JOB NO 180565/182205**

**REV: 7**

THIS DOCUMENT IS THE PROPERTY OF MOORE AND ASSOCIATES ENGINEERING AND CONSULTING, INC. THE UNAUTHORIZED REPRODUCTION, COPYING, OR OTHERWISE USE OF THIS DOCUMENT IS STRICTLY PROHIBITED AND ANY INFRINGEMENT THEREUPON MAY BE SUBJECT TO LEGAL ACTION.

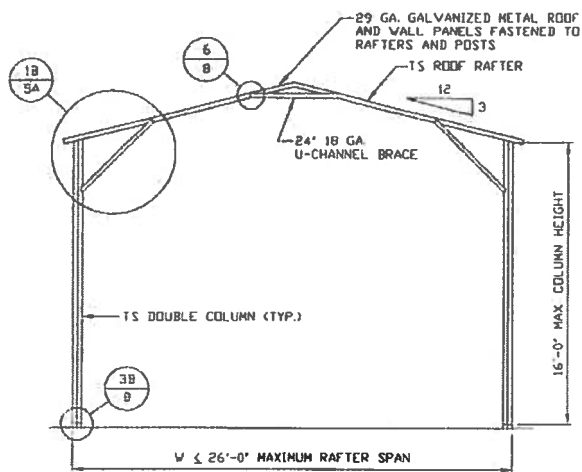

**TYPICAL RAFTER/COLUMN FRAME SECTION**  
SCALE: NTS

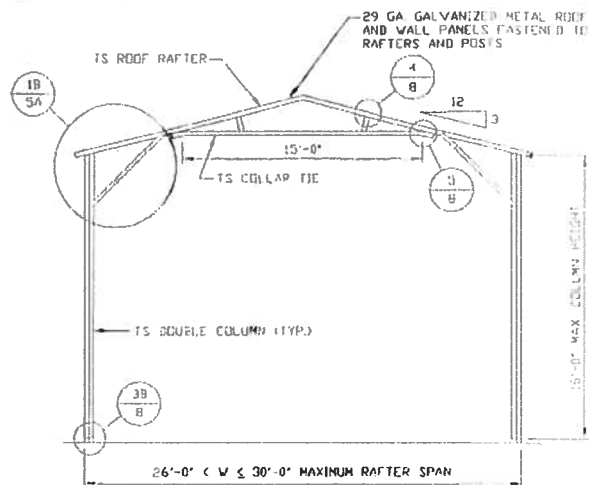

**TYPICAL RAFTER/COLUMN END FRAME SECTION**  
SCALE: NTS

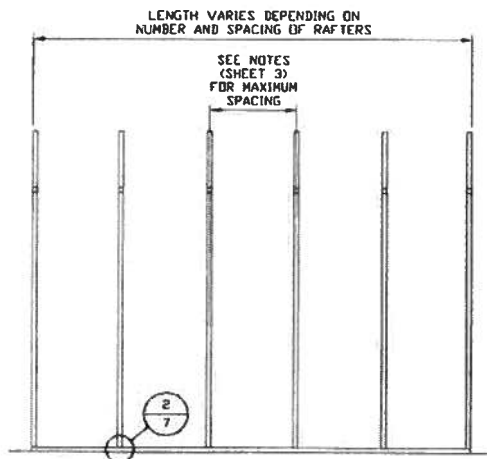

**TYPICAL RAFTER/COLUMN SIDE FRAMING SECTION**  
SCALE: NTS

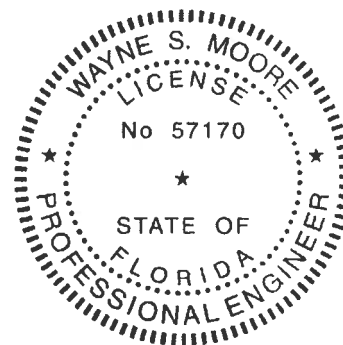

This item has been electronically signed and sealed by Wayne S. Moore, PE, using a Digital Signature and date.

Printed copies of this document are not considered signed and sealed and the signature must be verified on any electronic copies.

**MOORE AND ASSOCIATES  
ENGINEERING AND CONSULTING, INC.**

**DRAWN BY: AT**

**CHECKED BY: FDM**

**PROJECT MGR: VSH**

**CLIENT: SBSI**

**STEEL BUILDINGS AND STRUCTURES, INC.**  
P.O. BOX 1287,  
MOUNT AIRY, NC 27030  
30'-0"x20'-0" FULLY OPEN STRUCTURE

**DATE: 12-14-18**

**SHT. 4A**

**SCALE: NTS**

**DWG. NO. SK-1**

**JOB NO. 180668/182905**

**REV. 7**

THIS DOCUMENT IS THE PROPERTY OF MOORE AND ASSOCIATES ENGINEERING AND CONSULTING, INC. THE UNAUTHORIZED REPRODUCTION, COPYING, OR OTHERWISE USE OF THIS DOCUMENT IS STRICTLY PROHIBITED AND ANY INFRINGEMENT THEREUPON MAY BE SUBJECT TO LEGAL ACTION.

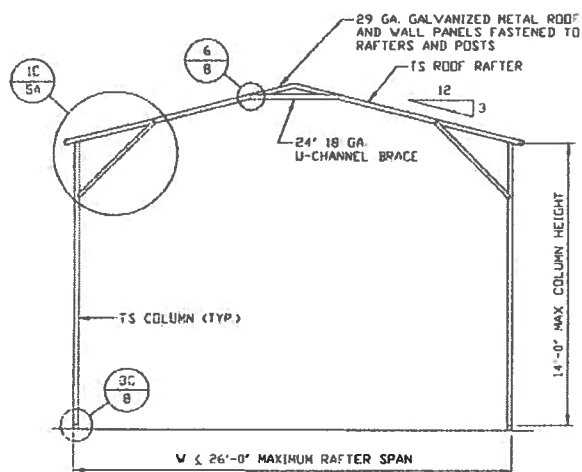

**TYPICAL RAFTER/COLUMN FRAME SECTION**

SCALE: NTS

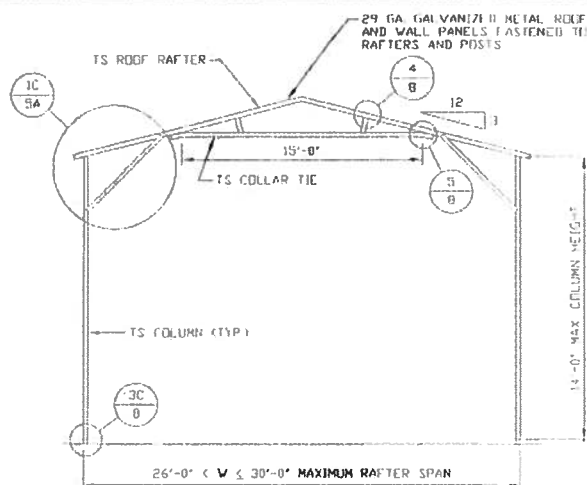

**TYPICAL RAFTER/COLUMN END FRAME SECTION**

SCALE: NTS

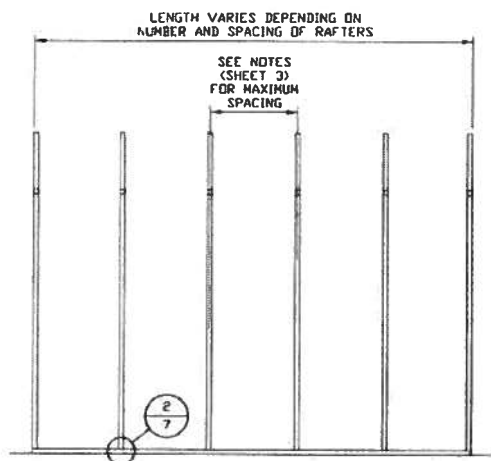

**TYPICAL RAFTER/COLUMN SIDE FRAMING SECTION**

SCALE: NTS

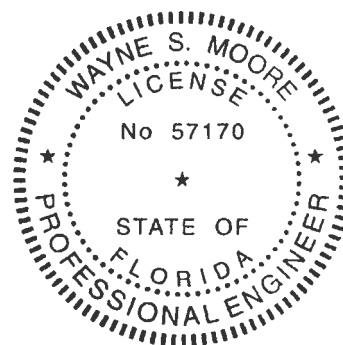

This item has been electronically signed and sealed by Wayne S. Moore, PE, using a Digital Signature and date.

Printed copies of this document are not considered signed and sealed and the signature must be verified on any electronic copies.

**MOORE AND ASSOCIATES  
ENGINEERING AND CONSULTING, INC.**

**DRAWN BY: AT**

**CHECKED BY: PJM**

**PROJECT MGR: VSM**

**CLIENT: SSSI**

**STEEL BUILDINGS AND STRUCTURES, INC.**  
P.O. BOX 1287,  
MOUNT AIRY, NC 27030  
30'-0" x 20'-0" FULLY OPEN STRUCTURE

**DATE: 12-14-18**

**SHT. 4B**

**SCALE: NTS**

**DWG. NO. SK-1**

**JOB NO. 180665/181545/182705**

**REV. 7**

THIS DOCUMENT IS THE PROPERTY OF MOORE AND ASSOCIATES ENGINEERING AND CONSULTING, INC. THE UNAUTHORIZED REPRODUCTION, COPYING, OR OTHERWISE USE OF THIS DOCUMENT IS STRICTLY PROHIBITED AND ANY INFRINGEMENT THEREUPON MAY BE SUBJECT TO LEGAL ACTION.

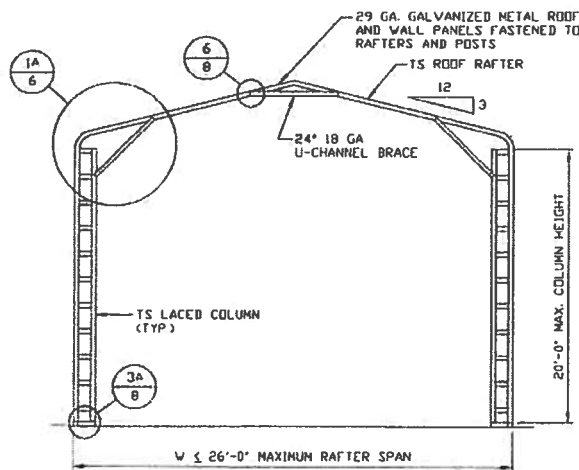

**TYPICAL RAFTER/COLUMN FRAME SECTION**  
SCALE: NTS

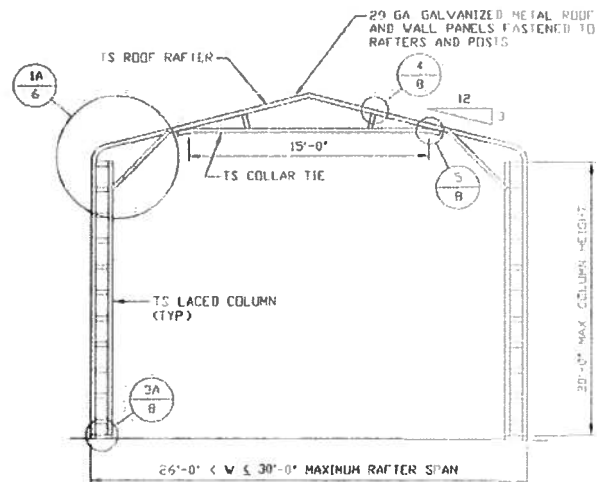

**TYPICAL RAFTER/COLUMN END FRAME SECTION**  
SCALE: NTS

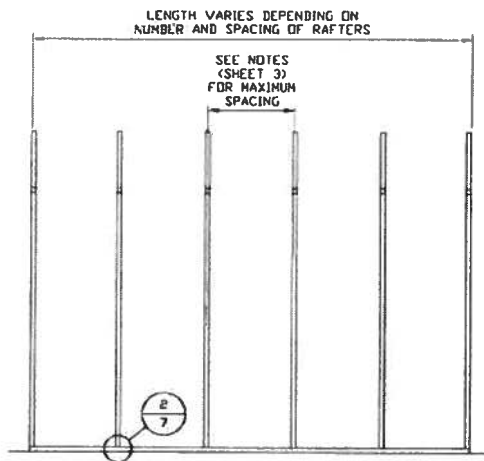

**TYPICAL RAFTER/COLUMN SIDE FRAMING SECTION**  
SCALE: NTS

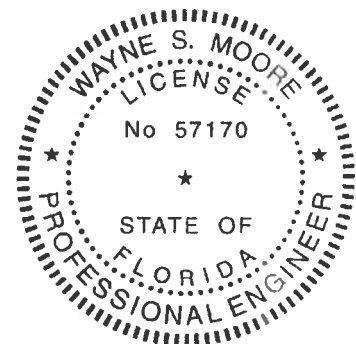

This item has been electronically signed and sealed by Wayne S. Moore, PE. using a Digital Signature and date.

Printed copies of this document are not considered signed and sealed and the signature must be verified on any electronic copies.

**MOORE AND ASSOCIATES  
ENGINEERING AND CONSULTING, INC.**

**DRAWN BY: AT**

**CHECKED BY: PDH**

**PROJECT MGR: VSM**

**CLIENT: SSSI**

**STEEL BUILDINGS AND STRUCTURES, INC.**  
P.O. BOX 1287,  
MOUNT AIRY, NC 27030  
30'-0" x 20'-0" FULLY OPEN STRUCTURE

**DATE: 12-14-18**

**SHT. 4C**

**SCALE: NTS**

**DWG. NO SK-1**

**JOB NO. 18056S/18136S/18230S**

**REV. 7**

THIS DOCUMENT IS THE PROPERTY OF MOORE AND ASSOCIATES ENGINEERING AND CONSULTING, INC. UNAUTHORIZED REPRODUCTION, COPYING, OR OTHERWISE USE OF THIS DOCUMENT IS STRICTLY PROHIBITED AND ANY INFRINGEMENT THEREUPON MAY BE SUBJECT TO LEGAL ACTION.

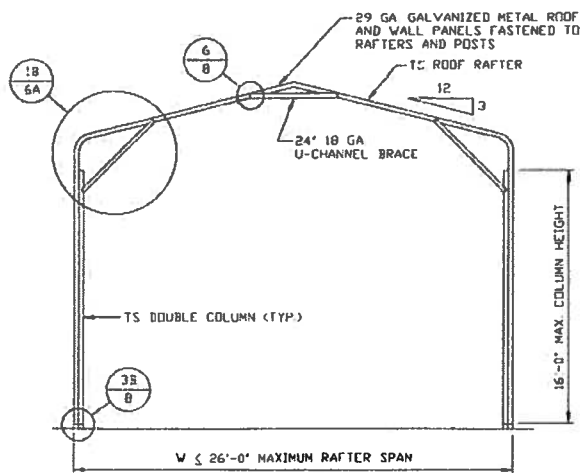

**TYPICAL RAFTER/COLUMN FRAME SECTION**  
SCALE: NTS

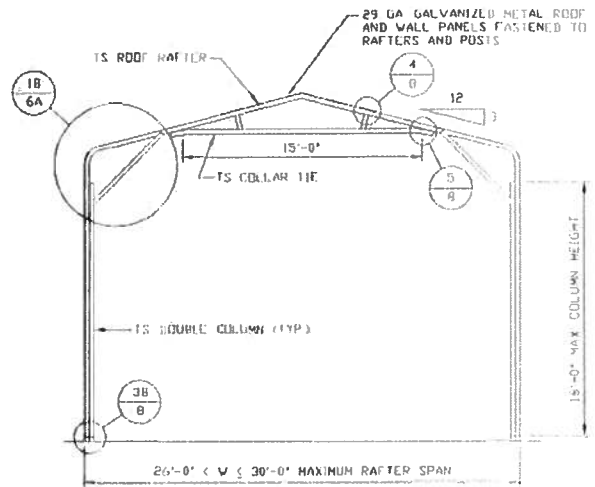

**TYPICAL RAFTER/COLUMN END FRAME SECTION**  
SCALE: NTS

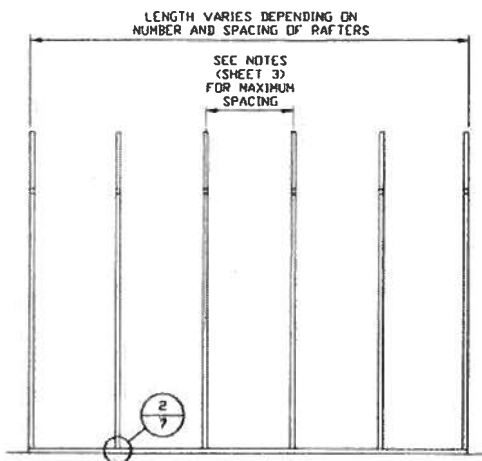

**TYPICAL RAFTER/COLUMN SIDE FRAMING SECTION**  
SCALE: NTS

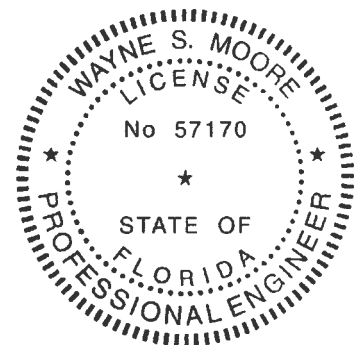

This item has been electronically signed and sealed by Wayne S. Moore, PE, using a Digital Signature and date.

Printed copies of this document are not considered signed and sealed and the signature must be verified on any electronic copies.

**MOORE AND ASSOCIATES  
ENGINEERING AND CONSULTING, INC.**

**DRAWN BY: AT**

**CHECKED BY: PDH**

**PROJECT NO: VSM**

**CLIENT: SPSI**

**STEEL BUILDINGS AND STRUCTURES, INC.**  
P.O. BOX 1287,  
MOUNT AIRY, NC 27030  
30'-0" x 20'-0" FULLY OPEN STRUCTURE

**DATE: 12-14-19**

**SCALE: NTS**

**DWG. NO: SK-1**

**JOB NO: 180663/182205**

**SHT. 4D**

**REV: 7**

THIS DOCUMENT IS THE PROPERTY OF MOORE AND ASSOCIATES ENGINEERING AND CONSULTING. THE UNAUTHORIZED REPRODUCTION, COPYING, OR OTHERWISE USE OF THIS DOCUMENT IS STRICTLY PROHIBITED AND ANY INFRACTION THEREUPON MAY BE SUBJECT TO LEGAL ACTION.

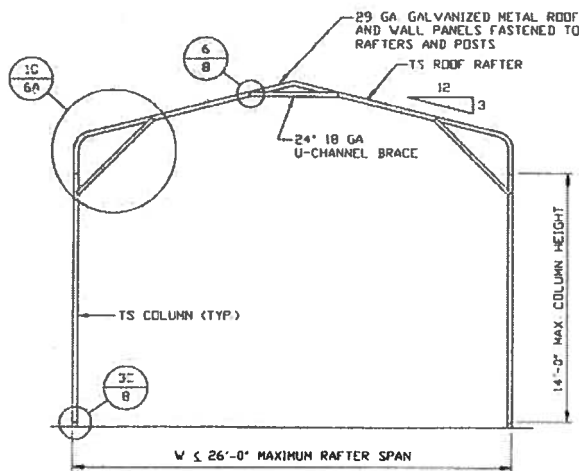

**TYPICAL RAFTER/COLUMN FRAME SECTION**  
SCALE: NTS

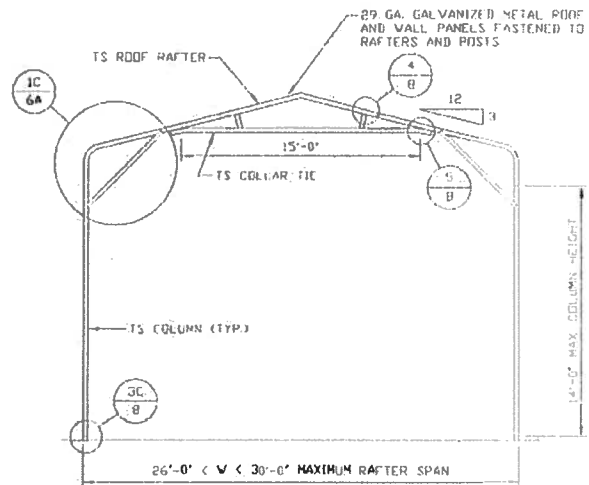

**TYPICAL RAFTER/COLUMN END FRAME SECTION**  
SCALE: NTS

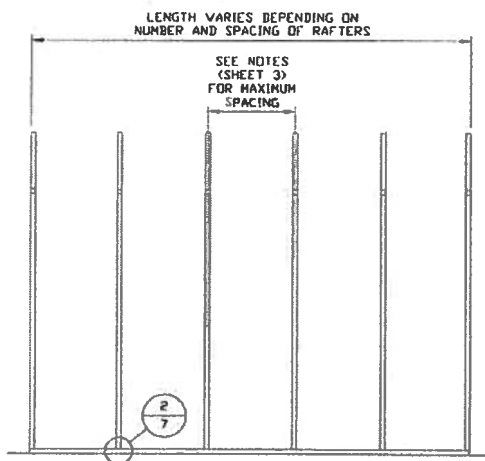

**TYPICAL RAFTER/COLUMN SIDE FRAMING SECTION**  
SCALE: NTS

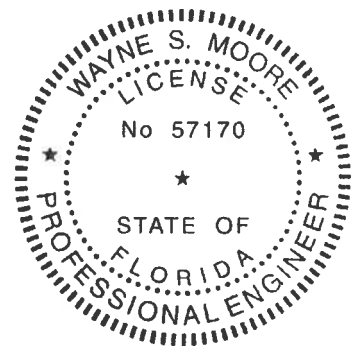

This item has been electronically signed and sealed by Wayne S. Moore, PE. using a Digital Signature and date.

Printed copies of this document are not considered signed and sealed and the signature must be verified on any electronic copies.

**MOORE AND ASSOCIATES  
ENGINEERING AND CONSULTING, INC.**

**DRAWN BY: AT**

**CHECKED BY: PDH**

**PROJECT: HGR VSH**

**CLIENT: SBST**

**STEEL BUILDINGS AND STRUCTURES, INC.**  
P.O. BOX 1287,  
MOUNT AIRY, NC 27030  
30'-0" x 20'-0" FULLY OPEN STRUCTURE

**DATE: 12-14-18**

**SCALE: NTS**

**DWG. NO: SK-1**

**JOB NO: 180565/182905**

**REV: 7**

THIS DOCUMENT IS THE PROPERTY OF MOORE AND ASSOCIATES ENGINEERING AND CONSULTING, INC. THE UNAUTHORIZED REPRODUCTION, COPYING, OR OTHERWISE USE OF THIS DOCUMENT IS STRICTLY PROHIBITED AND ANY INFRINGEMENT THEREUPON MAY BE SUBJECT TO LEGAL ACTION.



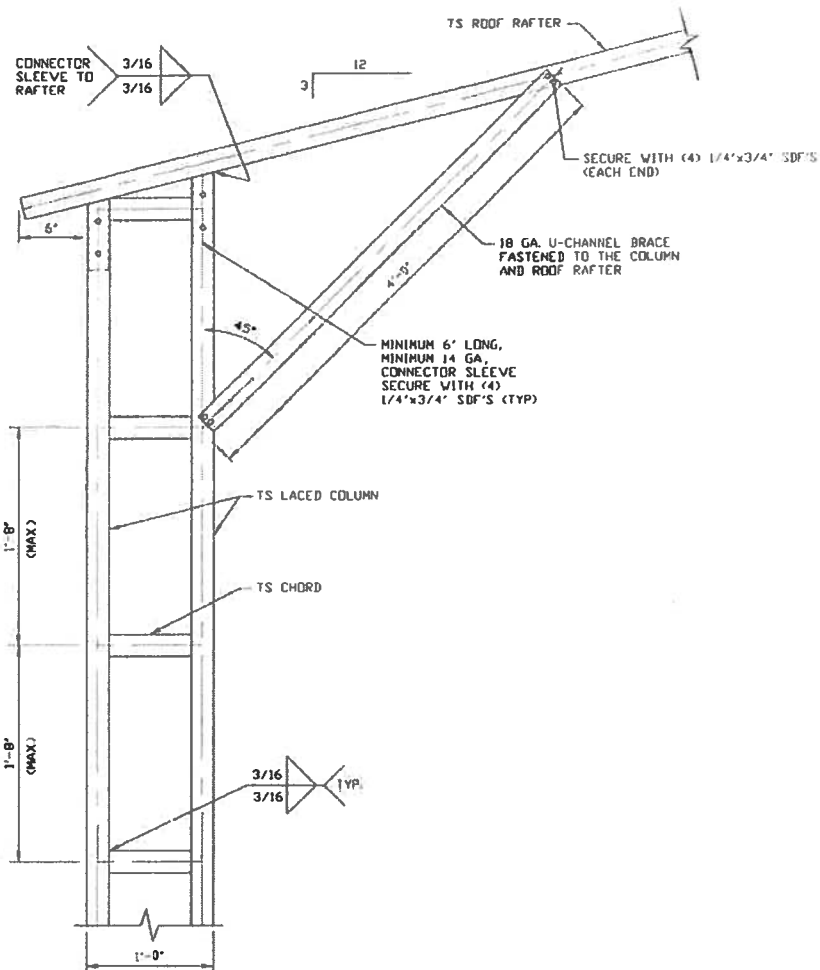

**BOX EAVE RAFTER/CORNER POST  
CONNECTION DETAIL  
FOR HEIGHTS 16'-0" < TO ≤ 20'-0"**

1A

SCALE: NTS

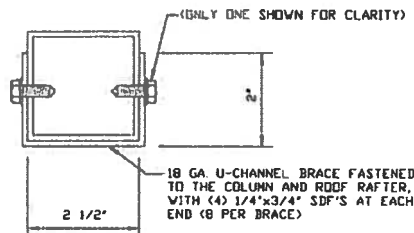

**BRACE SECTION**

SCALE: NTS

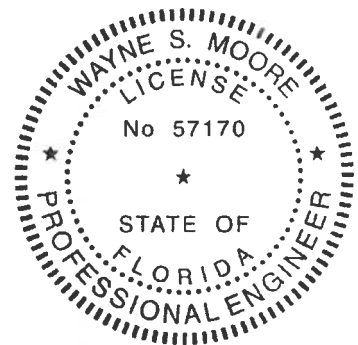

This item has been electronically signed and sealed by Wayne S. Moore, PE, using a Digital Signature and date.

Printed copies of this document are not considered signed and sealed and the signature must be verified on any electronic copies.

**MOORE AND ASSOCIATES  
ENGINEERING AND CONSULTING, INC.**

DRAWN BY: AT

CHECKED BY: PDM

PROJECT MGR: VSH

CLIENT: SSSI

STEEL BUILDINGS AND STRUCTURES, INC.  
P.O. BOX 1287,  
MOUNT AIRY, NC 27030  
30'-0" x 20'-0" FULLY OPEN STRUCTURE

DATE: 12-14-10

SCALE: NTS

SHT. 5

DWG NO SK-1

JOB NO 100605/100605/100605

REV. 7

THIS DOCUMENT IS THE PROPERTY OF MOORE AND ASSOCIATES ENGINEERING AND CONSULTING, INC. THE UNAUTHORIZED REPRODUCTION, COPYING, OR OTHERWISE USE OF THIS DOCUMENT IS STRICTLY PROHIBITED AND ANY INFRINGEMENT THEREUPON MAY BE SUBJECT TO LEGAL ACTION.

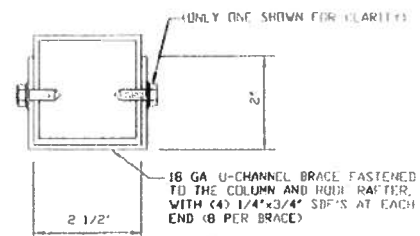

**BOX EAVE RAFTER/CORNER POST  
CONNECTION DETAIL  
FOR HEIGHTS  $\leq 14'-0"$**   
SCALE: NTS

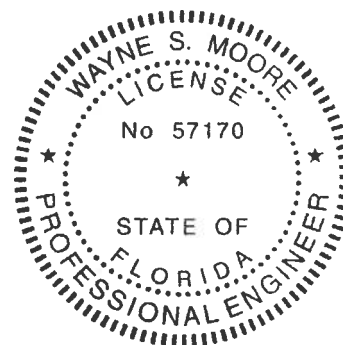

This item has been electronically signed and sealed by Wayne S. Moore, PE, using a Digital Signature and date.

Printed copies of this document are not considered signed and sealed and the signature must be verified on any electronic copies.

REV. 7

THIS DOCUMENT IS THE PROPERTY OF MOORE AND ASSOCIATES ENGINEERING AND CONSULTING. THE UNAUTHORIZED REPRODUCTION, COPYING, OR OTHERWISE USE OF THIS DOCUMENT IS STRICTLY PROHIBITED AND ANY VIOLATION THEREUPON MAY BE SUBJECT TO LEGAL ACTION.

REV. 7

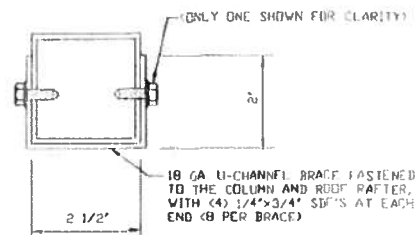
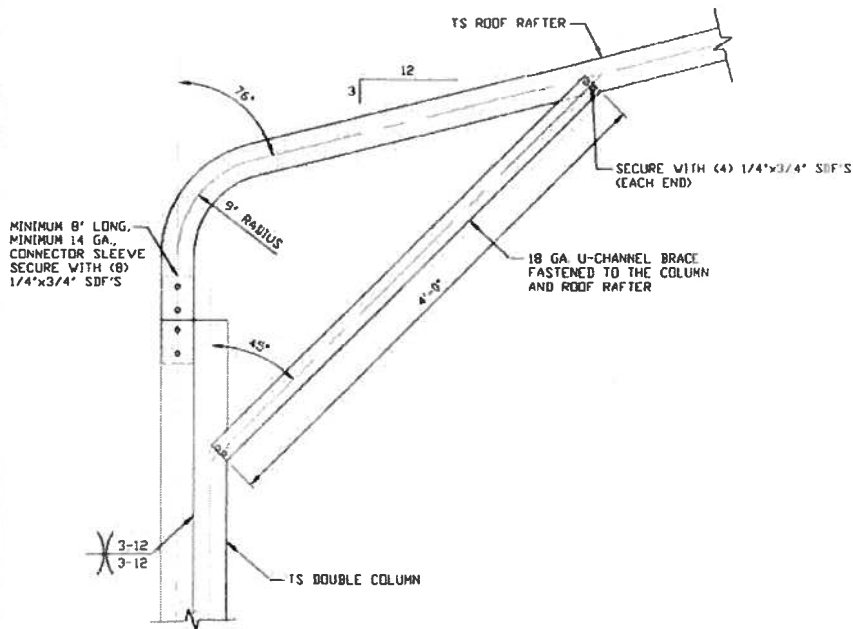

**BRACE SECTION**  
SCALE: NTS

**1B**

**BOW EAVE RAFTER/CORNER POST  
CONNECTION DETAIL  
FOR HEIGHTS 14'-0" < TO ≤ 16'-0"**  
SCALE: NTS

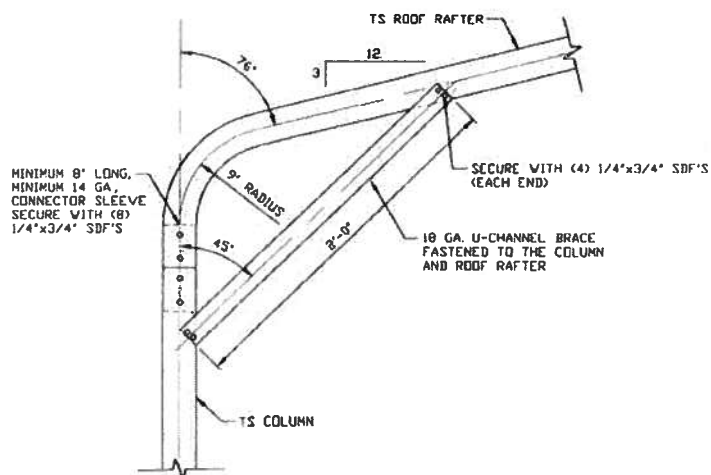

**1C**

**BOW EAVE RAFTER/CORNER POST  
CONNECTION DETAIL  
FOR HEIGHTS ≤ 14'-0"**  
SCALE: NTS

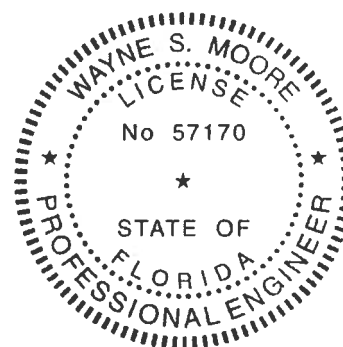

This item has been electronically signed and sealed by Wayne S. Moore, PE. using a Digital Signature and date.

Printed copies of this document are not considered signed and sealed and the signature must be verified on any electronic copies.

**MOORE AND ASSOCIATES  
ENGINEERING AND CONSULTING, INC.**

**DRAWN BY: AT**

**CHECKED BY: PJH**

**PROJECT MGR: VSH**

**CLIENT: SSSI**

**STEEL BUILDINGS AND STRUCTURES, INC.**  
P.O. BOX 1287,  
MOUNT AIRY, NC 27030  
30'-0" x 20'-0" FULLY OPEN STRUCTURE

**DATE: 12-14-18**

**SCALE: NTS**

**JOB NO: 18068S/18156S/18290S**

**SHT. 6A**

**DWG NO: SK-1**

**REV. 7**

THIS DOCUMENT IS THE PROPERTY OF MOORE AND ASSOCIATES ENGINEERING AND CONSULTING, INC. THE UNAUTHORIZED REPRODUCTION, COPYING, OR OTHERWISE USE OF THIS DOCUMENT IS STRICTLY PROHIBITED AND ANY INFRINGEMENT THEREUPON MAY BE SUBJECT TO LEGAL ACTION.

## BASE RAIL ANCHORAGE OPTIONS

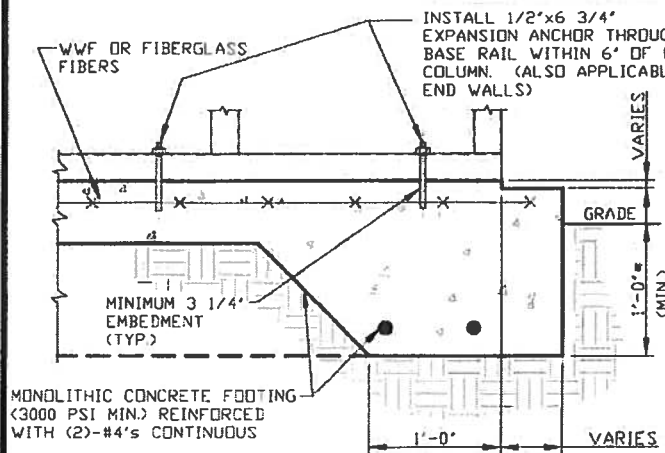

2A

### CONCRETE MONOLITHIC SLAB BASE RAIL ANCHORAGE

SCALE: NTS

MINIMUM ANCHOR EDGE DISTANCE IS 4".  
\* COORDINATE WITH LOCAL CODES/ORD.

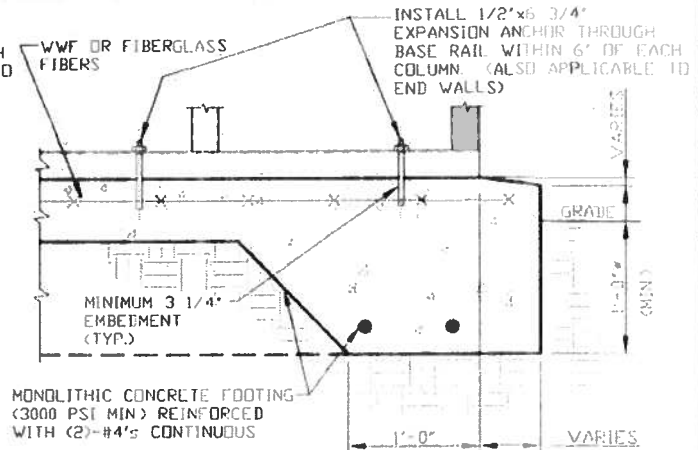

2B

### CONCRETE SLAB BASE RAIL ANCHORAGE

SCALE: NTS

MINIMUM ANCHOR EDGE DISTANCE IS 4".  
\* COORDINATE WITH LOCAL CODES/ORD.

## GENERAL NOTES

NOTE: CONCRETE MONOLITHIC SLAB DESIGN BASED ON MINIMUM SOIL BEARING CAPACITY OF 1,500 PSF.

### CONCRETE:

CONCRETE SHALL HAVE A MINIMUM SPECIFIED COMPRESSIVE STRENGTH OF 3,000 PSI AT 28 DAYS.

### COVER OVER REINFORCING STEEL:

FOR FOUNDATIONS, MINIMUM CONCRETE COVER OVER REINFORCING BARS SHALL BE PER ACI-318:

3" IN FOUNDATIONS WHERE THE CONCRETE IS CAST AGAINST AND PERMANENTLY IN CONTACT WITH THE EARTH OR EXPOSED TO THE EARTH OR WEATHER, AND 1 1/2" ELSEWHERE.

### REINFORCING STEEL:

THE TURNDOWN REINFORCING STEEL SHALL BE ASTM A615 GRADE 60. THE SLAB REINFORCEMENT SHALL BE WELDED WIRE FABRIC MEETING ASTM A185 OR FIBERGLASS FIBER REINFORCEMENT.

### REINFORCEMENT MAY BE BENT IN THE SHOP OR THE FIELD PROVIDED:

1. REINFORCEMENT IS BENT COLD.
2. THE DIAMETER OF THE BEND, MEASURED ON THE INSIDE OF THE BAR, IS NOT LESS THAN SIX-BAR DIAMETERS.
3. REINFORCEMENT PARTIALLY EMBEDDED IN CONCRETE SHALL NOT BE FIELD BENT.

### HELIX ANCHOR NOTES:

1. FOR VERY DENSE AND/OR CEMENTED SANDS, COARSE GRAVEL AND COBBLES, CALICHE, PRELOADED SILTS AND CLAYS, USE MINIMUM (2) 4" HELICES WITH MINIMUM 30" EMBEDMENT OR SINGLE 6" HELIX WITH MINIMUM 50" EMBEDMENT.
2. FOR CORAL USE MINIMUM (2) 4" HELICES WITH MINIMUM 30" EMBEDMENT OR SINGLE 6" HELIX WITH MINIMUM 50" EMBEDMENT.
3. FOR MEDIUM DENSE COARSE SANDS, SANDY GRAVELS, VERY STIFF SILTS, AND CLAYS USE MINIMUM (2) 4" HELICES WITH MINIMUM 30 INCH EMBEDMENT OR SINGLE 6" HELIX WITH MINIMUM 50" EMBEDMENT.
4. FOR LOOSE TO MEDIUM DENSE SANDS, FIRM TO STIFF CLAYS AND SILTS ALLUVIAL FILL, USE MINIMUM (2) 6" HELICES WITH MINIMUM 50" EMBEDMENT.
5. FOR VERY LOSE TO MEDIUM DENSE SANDS, FIRM TO STIFFER CLAYS AND SILTS, ALLUVIAL FILL, USE MINIMUM (2) 8" HELICES WITH MINIMUM 60" EMBEDMENT.

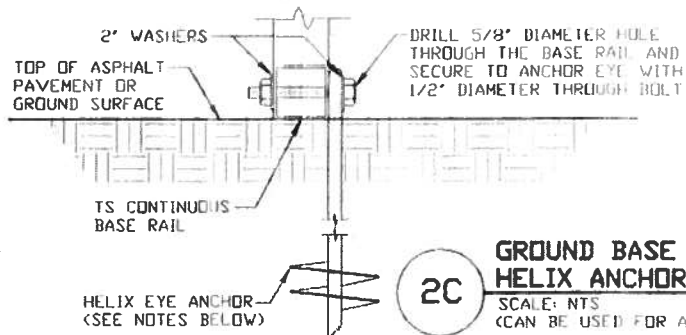

2C

### GROUND BASE HELIX ANCHORAGE

SCALE: NTS

(CAN BE USED FOR ASPHALT)

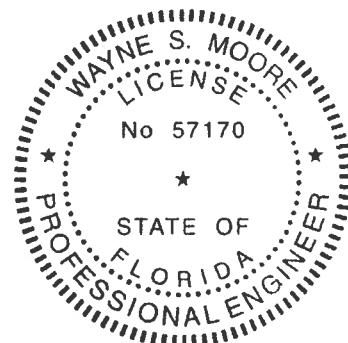

This item has been electronically signed and sealed by Wayne S. Moore, PE, using a Digital Signature and date.

Printed copies of this document are not considered signed and sealed and the signature must be verified on any electronic copies.

**MOORE AND ASSOCIATES  
ENGINEERING AND CONSULTING, INC.**

DRAWN BY: AT

CHECKED BY: PMH

PROJECT MGR: VSM

CLIENT: SSSI

STEEL BUILDINGS AND STRUCTURES, INC.

P.O. BOX 1287,  
MOUNT AIRY, NC 27030

30'-0" x 20'-0" FULLY OPEN STRUCTURE

DATE: 12-14-18

SHT. 7

SCALE: NTS

DWG. NO: SK-1

JOB NO: 180685/181365/182905

REV: 7

THIS DOCUMENT IS THE PROPERTY OF MOORE AND ASSOCIATES ENGINEERING AND CONSULTING, INC. UNAUTHORIZED REPRODUCTION, COPYING, OR OTHERWISE USE OF THIS DOCUMENT IS STRICTLY PROHIBITED AND ANY INFRINGEMENT THEREUPON MAY BE SUBJECT TO LEGAL ACTION.

## CONNECTION DETAILS

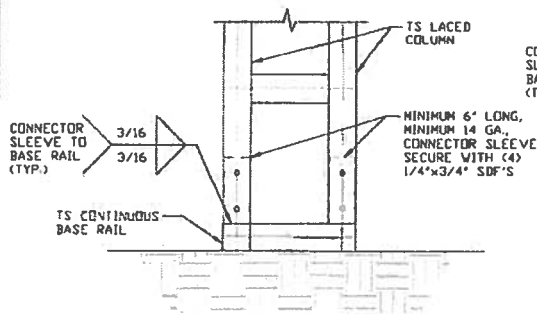

**3A**

**POST/BASE RAIL  
CONNECTION DETAIL**  
SCALE: NTS

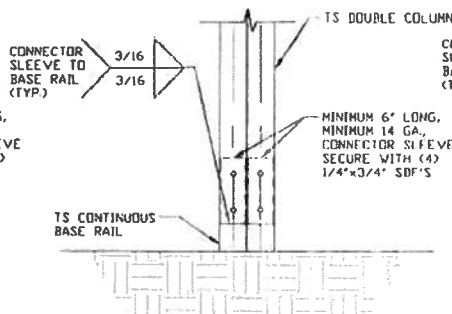

**3B**

**POST/BASE RAIL  
CONNECTION DETAIL**  
SCALE: NTS

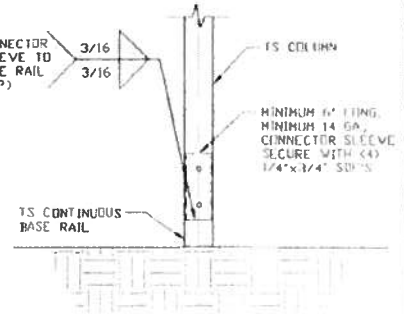

**3C**

**POST/BASE RAIL  
CONNECTION DETAIL**  
SCALE: NTS

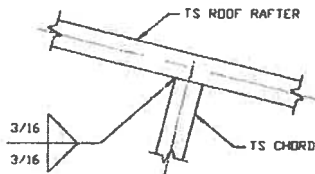

**4**

**RAFTER TO CHORD  
CONNECTION DETAIL**  
SCALE: NTS

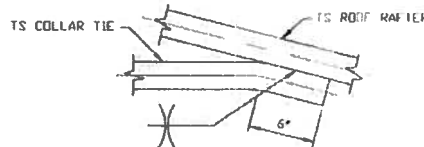

**5**

**COLLAR TIE  
CONNECTION DETAIL**  
SCALE: NTS

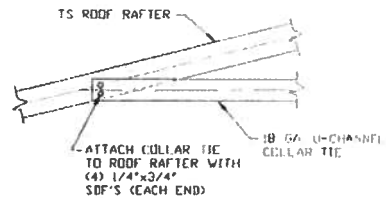

**6**

**COLLAR TIE  
CONNECTION DETAIL**  
SCALE: NTS

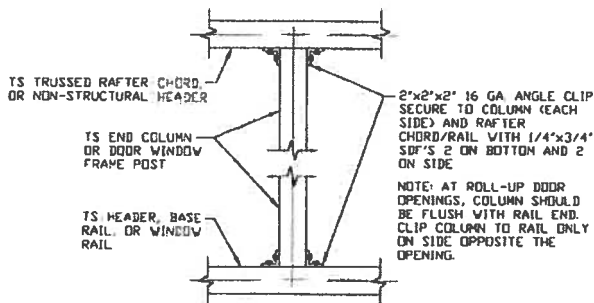

**7**

**COLUMN TO HEADER, BASE RAIL, OR  
WINDOW RAIL CONNECTION DETAIL**  
SCALE: NTS

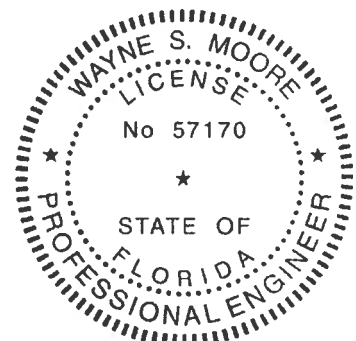

This item has been electronically signed and sealed by Wayne S. Moore, PE, using a Digital Signature and date.

Printed copies of this document are not considered signed and sealed and the signature must be verified on any electronic copies.

**MOORE AND ASSOCIATES  
ENGINEERING AND CONSULTING, INC.**

**DRAWN BY: AT**

**CHECKED BY: PDH**

**PROJECT MGR: VSM**

**CLIENT: SSSI**

**STEEL BUILDINGS AND STRUCTURES, INC.**  
P.O. BOX 1287,  
MOUNT AIRY, NC 27030  
30'-0" x 20'-0" FULLY OPEN STRUCTURE

**DATE: 12-14-18**

**SCALE: NTS**

**JOB NO: 180685/182905**

**SHT. 8**

**DWG. NO: SK-1**

**REV: 7**

THIS DOCUMENT IS THE PROPERTY OF MOORE AND ASSOCIATES ENGINEERING AND CONSULTING. THE UNAUTHORIZED REPRODUCTION, COPYING, OR OTHERWISE USE OF THIS DOCUMENT IS STRICTLY PROHIBITED AND ANY INFRINGEMENT THEREUPON MAY BE SUBJECT TO LEGAL ACTION.

## GABLE END OPTION

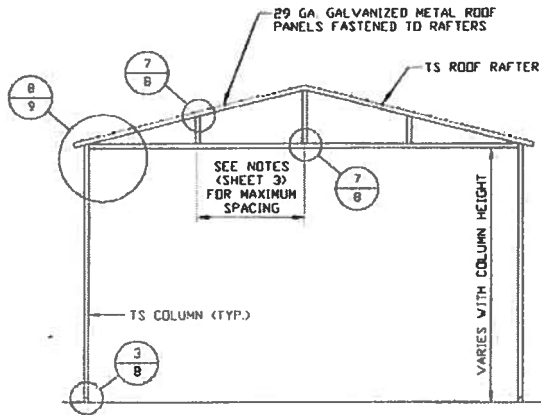

**TYPICAL GABLE END FRAMING SECTION**  
SCALE: NTS

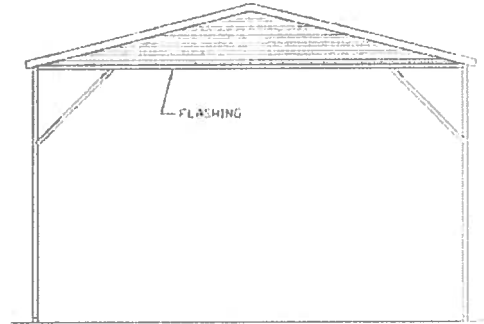

**TYPICAL GABLE END ELEVATION**  
SCALE: NTS

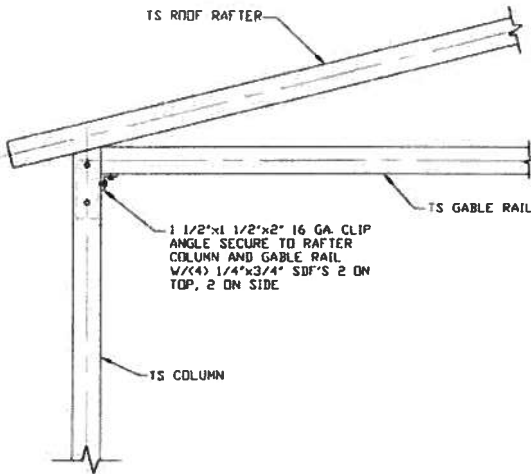

**BOX EAVE RAFTER GABLE RAIL TO RAFTER COLUMN CONNECTION DETAIL**  
SCALE: NTS

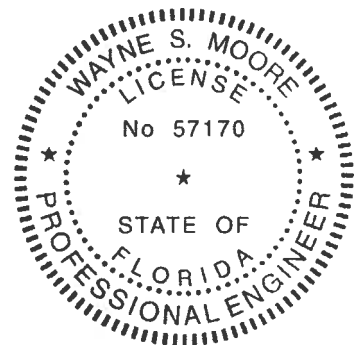

This item has been electronically signed and sealed by Wayne S. Moore, PE, using a Digital Signature and date.

Printed copies of this document are not considered signed and sealed and the signature must be verified on any electronic copies.

**MOORE AND ASSOCIATES  
ENGINEERING AND CONSULTING, INC.**

**DRAWN BY: AT**

**CHECKED BY: PJH**

**PROJECT MGR: VSM**

**CLIENT: SBSI**

**STEEL BUILDINGS AND STRUCTURES, INC.**  
P.O. BOX 1287,  
MOUNT AIRY, NC 27030  
30'-0" x 20'-0" FULLY OPEN STRUCTURE

**DATE: 12-14-18**

**SCALE: NTS**

**DWG. NO SK-1**

**SHT. 9**

**JOB NO 180685/182908**

**REV: 7**

THIS DOCUMENT IS THE PROPERTY OF MOORE AND ASSOCIATES ENGINEERING AND CONSULTING, INC. THE UNAUTHORIZED REPRODUCTION, COPYING, OR OTHERWISE USE OF THIS DOCUMENT IS STRICTLY PROHIBITED AND ANY INFRACTION THEREUPON MAY BE SUBJECT TO LEGAL ACTION.



## GABLE END OPTION

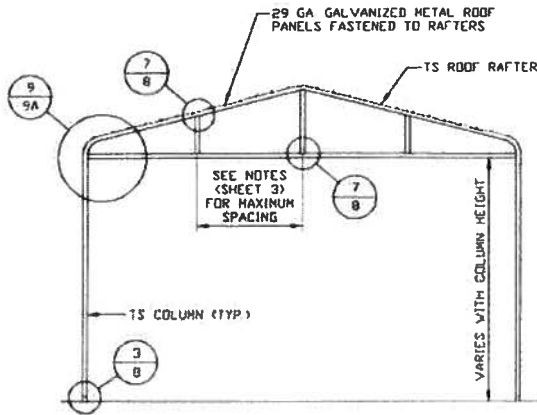

**TYPICAL GABLE END FRAMING SECTION**  
SCALE: NTS

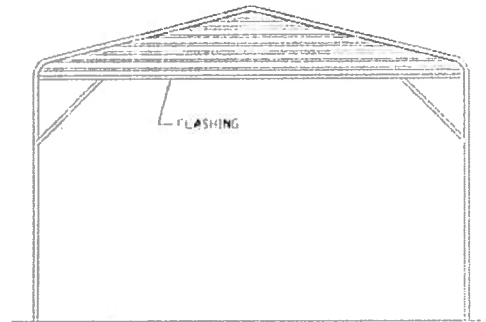

**TYPICAL GABLE END ELEVATION**  
SCALE: NTS

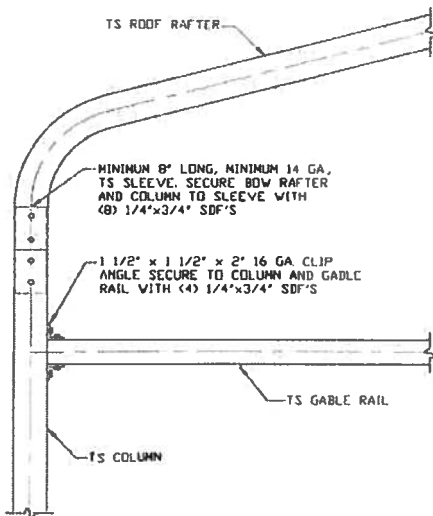

**BOW EAVE RAFTER GABLE RAIL TO  
RAFTER COLUMN CONNECTION DETAIL**  
SCALE: NTS

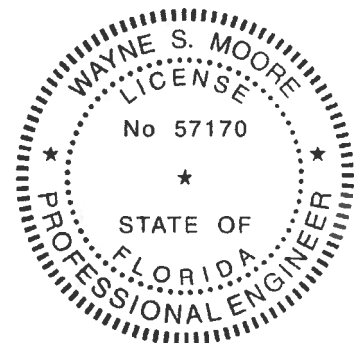

This item has been electronically signed and sealed by Wayne S. Moore, PE. using a Digital Signature and date.

Printed copies of this document are not considered signed and sealed and the signature must be verified on any electronic copies.

**MOORE AND ASSOCIATES  
ENGINEERING AND CONSULTING, INC.**

**DRAWN BY: AT**

**CHECKED BY: PDH**

**PROJECT MGR: VSM**

**CLIENT: SSSI**

**STEEL BUILDINGS AND STRUCTURES, INC.**

P.O. BOX 1287,  
MOUNT AIRY, NC 27030

**30'-0" x 20'-0" FULLY OPEN STRUCTURE**

**DATE: 12-14-18**

**SCALE: NTS**

**JOB NO: 180563/180563/180563**

**SHT. 9A**

**DWG NO SK-1**

**REV. 7**

THIS DOCUMENT IS THE PROPERTY OF MOORE AND ASSOCIATES ENGINEERING AND CONSULTING, INC. THE UNAUTHORIZED REPRODUCTION, COPYING, OR OTHERWISE USE OF THIS DOCUMENT IS STRICTLY PROHIBITED AND ANY VIOLATION THEREOF MAY BE SUBJECT TO LEGAL ACTION.

## EXTRA SIDE PANEL OPTION

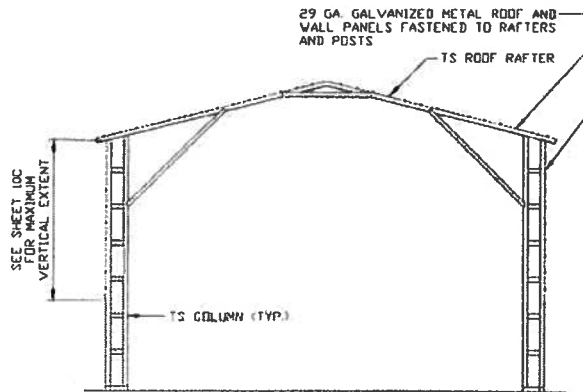

**TYPICAL END FRAME SECTION  
EXTRA SIDE PANELS**

SCALE: NTS

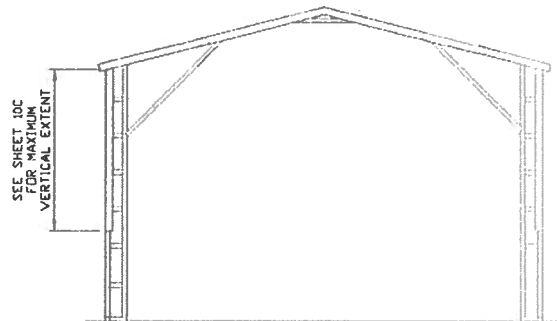

**TYPICAL END ELEVATION  
EXTRA SIDE PANELS**

SCALE: NTS

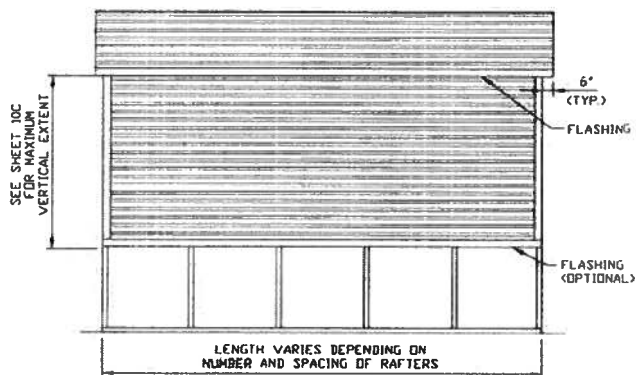

**TYPICAL SIDE ELEVATION  
EXTRA SIDE PANELS**

SCALE: NTS

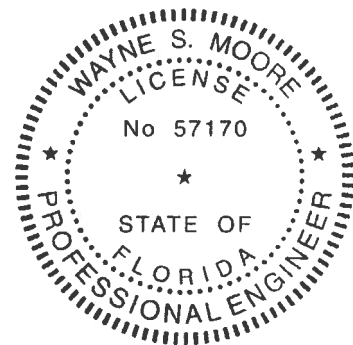

This item has been electronically signed and sealed by Wayne S. Moore, PE.  
using a Digital Signature and date.

Printed copies of this document are not considered signed and sealed and the signature must be verified on any electronic copies.

**MOORE AND ASSOCIATES  
ENGINEERING AND CONSULTING, INC.**

**DRAWN BY: AT**

**CHECKED BY: PDH**

**PROJECT MGR: VSM**

**CLIENT: SSSI**

**STEEL BUILDINGS AND STRUCTURES, INC.**  
P.O. BOX 1287,  
MOUNT AIRY, NC 27030  
30'-0" x 20'-0" FULLY OPEN STRUCTURE

**DATE: 12-14-18**

**SCALE: NTS**

**SHT. 10**

**DWG. NO SK-1**

**JOB NO 180685/181363/192905**

**REV. 7**

THIS DOCUMENT IS THE PROPERTY OF MOORE AND ASSOCIATES ENGINEERING AND CONSULTING. THE UNAUTHORIZED REPRODUCTION, COPYING, OR OTHERWISE USE OF THIS DOCUMENT IS STRICTLY PROHIBITED AND ANY INFRINGEMENT THEREUPON MAY BE SUBJECT TO LEGAL ACTION.

## EXTRA SIDE PANEL OPTION

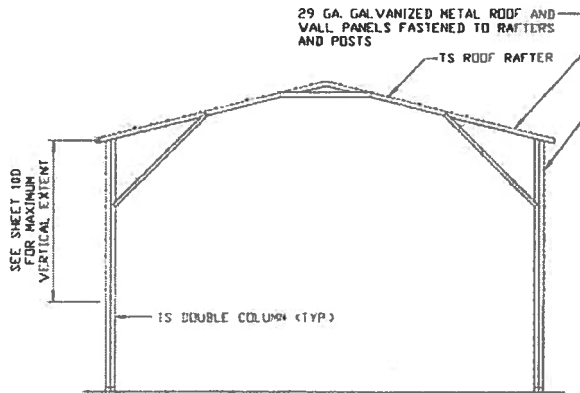

**TYPICAL END FRAME SECTION  
EXTRA SIDE PANELS**

SCALE: NTS

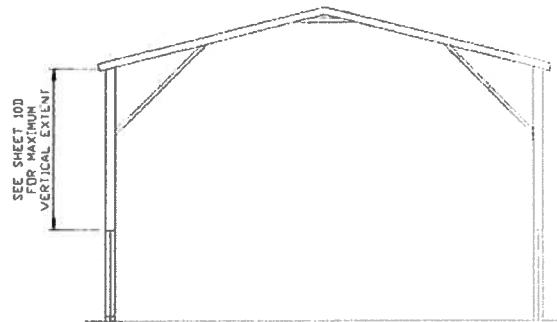

**TYPICAL END ELEVATION  
EXTRA SIDE PANELS**

SCALE: NTS

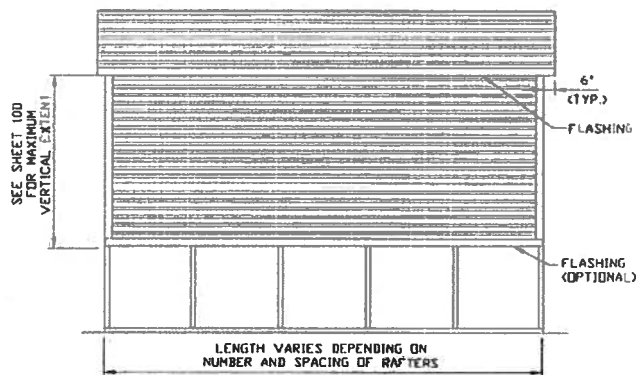

**TYPICAL SIDE ELEVATION  
EXTRA SIDE PANELS**

SCALE: NTS

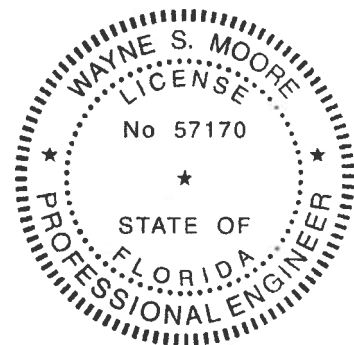

This item has been electronically signed and sealed by Wayne S. Moore, PE, using a Digital Signature and date.

Printed copies of this document are not considered signed and sealed and the signature must be verified on any electronic copies.

**MOORE AND ASSOCIATES  
ENGINEERING AND CONSULTING, INC.**

**DRAWN BY: AT**

**CHECKED BY: PDM**

**PROJECT NO: VSM**

**CLIENT: SRSI**

**STEEL BUILDINGS AND STRUCTURES, INC.**  
P.O. BOX 1287,  
MOUNT AIRY, NC 27030  
**30'-0" x 20'-0" FULLY OPEN STRUCTURE**

**DATE: 12-14-18**

**SCALE: NTS**

**SHT. 10A**

**DWG. NO SK-1**

**JOB NO: 18066S/18136S/18290S**

**REV. 7**

THIS DOCUMENT IS THE PROPERTY OF MOORE AND ASSOCIATES ENGINEERING AND CONSULTING. THE UNAUTHORIZED REPRODUCTION, COPYING, OR OTHERWISE USE OF THIS DOCUMENT IS STRICTLY PROHIBITED AND ANY INFRINGEMENT THEREUPON MAY BE SUBJECT TO LEGAL ACTION.

## EXTRA SIDE PANEL OPTION

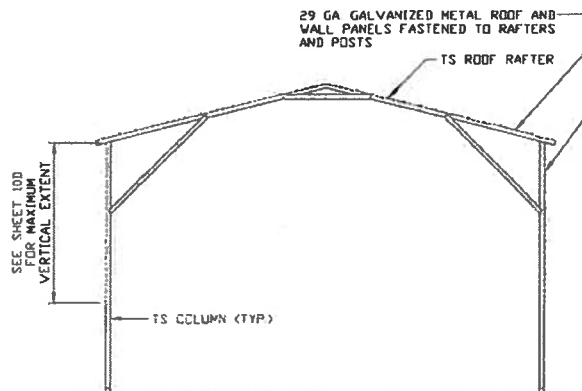

**TYPICAL END FRAME SECTION  
EXTRA SIDE PANELS**

SCALE: NTS

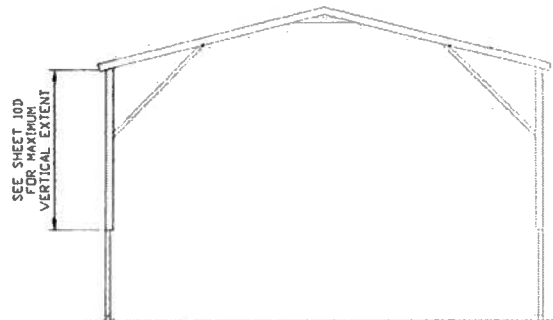

**TYPICAL END ELEVATION  
EXTRA SIDE PANELS**

SCALE: NTS

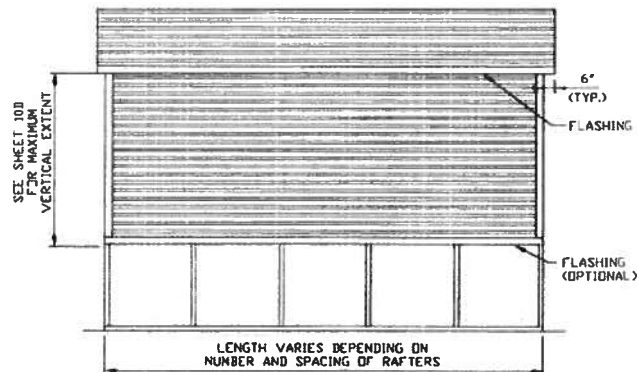

**TYPICAL SIDE ELEVATION  
EXTRA SIDE PANELS**

SCALE: NTS

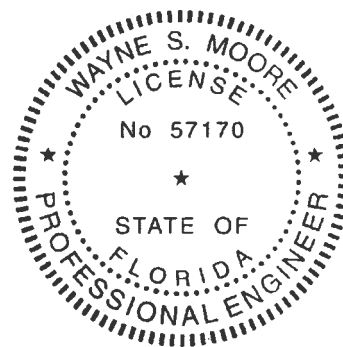

This item has been electronically signed and sealed by Wayne S. Moore, PE, using a Digital Signature and date.

Printed copies of this document are not considered signed and sealed and the signature must be verified on any electronic copies.

**MOORE AND ASSOCIATES  
ENGINEERING AND CONSULTING, INC.**

**DRAWN BY: AT**

**CHECKED BY: PDM**

**PROJECT MGR: VSM**

**CLIENT: SBSI**

**STEEL BUILDINGS AND STRUCTURES, INC.**  
P.O. BOX 1287,  
MOUNT AIRY, NC 27030  
30'-0" x 20'-0" FULLY OPEN STRUCTURE

**DATE: 12-14-18**

**SHT. 10B**

**SCALE: NTS**

**DWG. NO: SK-1**

**JOB NO: 180685/182905**

**REV: 7**

THIS DOCUMENT IS THE PROPERTY OF MOORE AND ASSOCIATES ENGINEERING AND CONSULTING. THE UNAUTHORIZED REPRODUCTION, COPYING, OR OTHERWISE USE OF THIS DOCUMENT IS STRICTLY PROHIBITED AND ANY INFRINGEMENT THEREUPON MAY BE SUBJECT TO LEGAL ACTION.

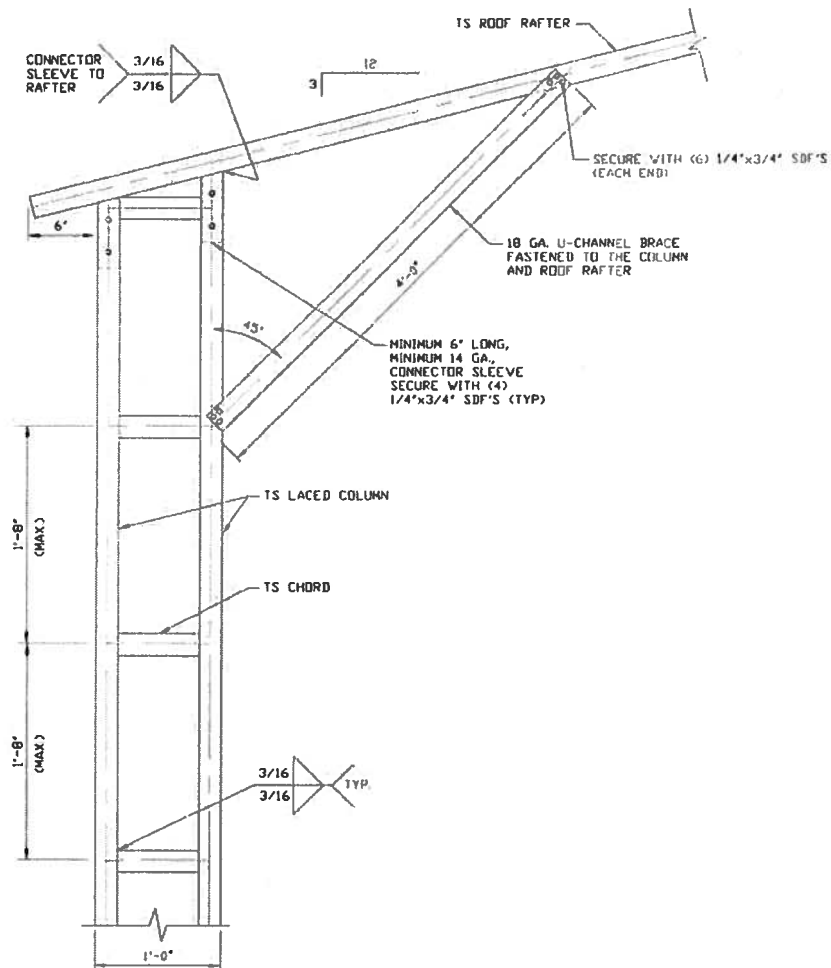

**BOX EAVE RAFTER/CORNER POST  
CONNECTION DETAIL  
FOR HEIGHTS 16'-0" < TO ≤ 20'-0"  
AND FOR MAXIMUM 20'-0" VERTICAL EXTENT**  
SCALE: NTS

10

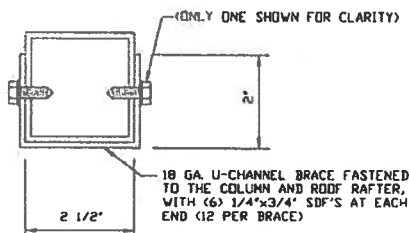

**BRACE SECTION**  
SCALE: NTS

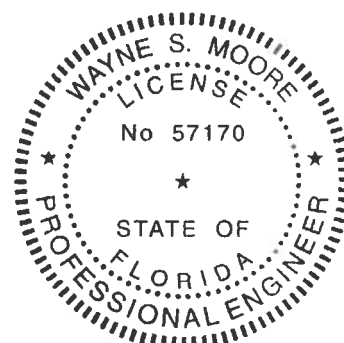

This item has been electronically signed and sealed by Wayne S. Moore, PE, using a Digital Signature and date.

Printed copies of this document are not considered signed and sealed and the signature must be verified on any electronic copies.

**MOORE AND ASSOCIATES  
ENGINEERING AND CONSULTING, INC.**

THIS DOCUMENT IS THE PROPERTY OF MOORE AND ASSOCIATES ENGINEERING AND CONSULTING, INC. THE UNAUTHORIZED REPRODUCTION, COPYING, OR OTHERWISE USE OF THIS DOCUMENT IS STRICTLY PROHIBITED AND ANY INFRINGEMENT THEREUPON MAY BE SUBJECT TO LEGAL ACTION.

**DRAWN BY: AT**

**CHECKED BY: FDM**

**PROJECT MGR: VSM**

**CLIENT: SRSI**

**STEEL BUILDINGS AND STRUCTURES, INC.**  
P.O. BOX 1287,  
MOUNT AIRY, NC 27030  
30'-0"x20'-0" FULLY OPEN STRUCTURE

**DATE: 12-14-18**

**SHT. 10C**

**SCALE: NTS**

**DWG NO SK-1**

**JOB NO: 180685/181565/182905**

**REV. 7**

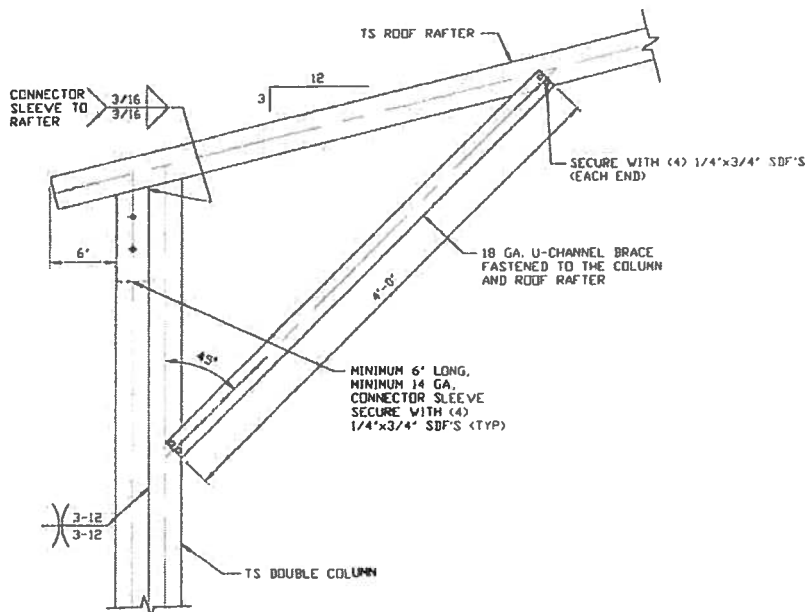

**BOX EAVE RAFTER/CORNER POST  
CONNECTION DETAIL  
FOR HEIGHTS 14'-0" < TO ≤ 16'-0"  
AND FOR MAXIMUM 16'-0" VERTICAL EXTENT**

10A

SCALE: NTS

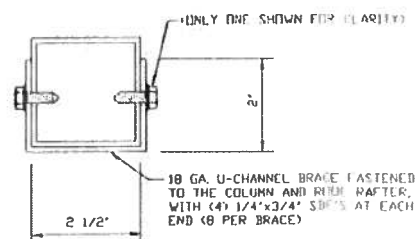

**BRACE SECTION**

SCALE: NTS

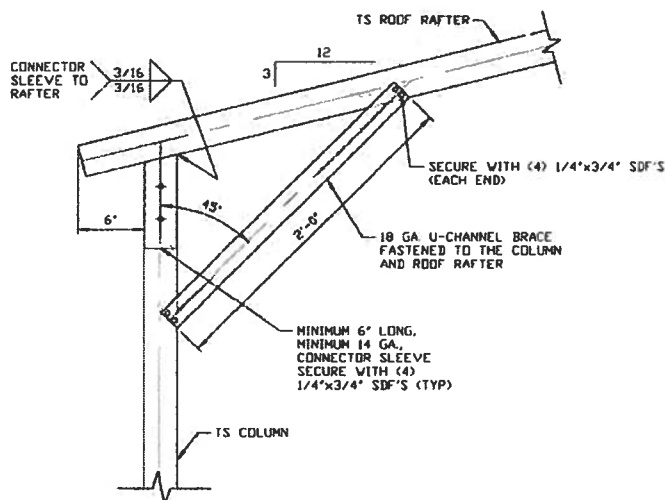

**BOX EAVE RAFTER/CORNER POST  
CONNECTION DETAIL  
FOR HEIGHTS ≤ 14'-0"  
AND FOR MAXIMUM 3'-0" VERTICAL EXTENT**

10B

SCALE: NTS

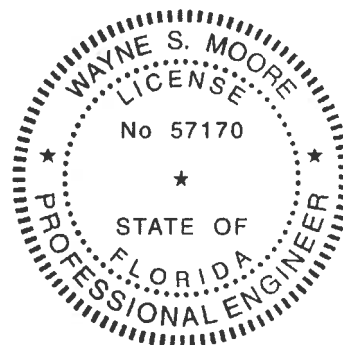

This item has been electronically signed and sealed by Wayne S. Moore, PE. using a Digital Signature and date.

Printed copies of this document are not considered signed and sealed and the signature must be verified on any electronic copies.

**MOORE AND ASSOCIATES  
ENGINEERING AND CONSULTING, INC.**

**DRAWN BY: AT**

**CHECKED BY: PDH**

**PROJECT MGR: VSH**

**CLIENT: SBSI**

**STEEL BUILDINGS AND STRUCTURES, INC.**  
P.O. BOX 1287,  
MOUNT AIRY, NC 27030  
30'-0" x 20'-0" FULLY OPEN STRUCTURE

**DATE: 12-14-18**

**SCALE: NTS**

**DWG. NO: SK-1**

**180685/  
JOB NO: 181365/182935**

**REV: 7**

THIS DOCUMENT IS THE PROPERTY OF MOORE AND ASSOCIATES ENGINEERING AND CONSULTING, INC. THE UNAUTHORIZED REPRODUCTION, COPYING, OR OTHERWISE USE OF THIS DOCUMENT IS STRICTLY PROHIBITED AND ANY INFRINGEMENT THEREUPON MAY BE SUBJECT TO LEGAL ACTION.

## EXTRA SIDE PANEL OPTION

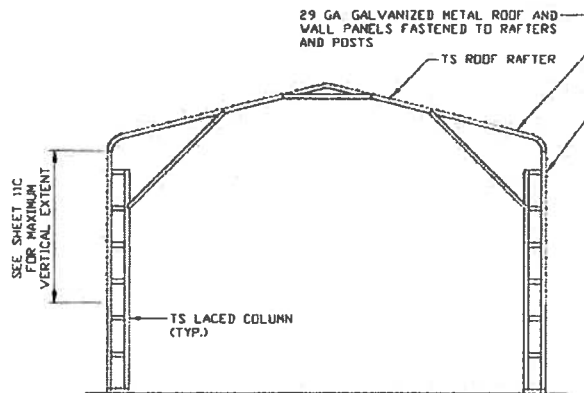

**TYPICAL END FRAME SECTION  
EXTRA SIDE PANELS**  
SCALE: NTS

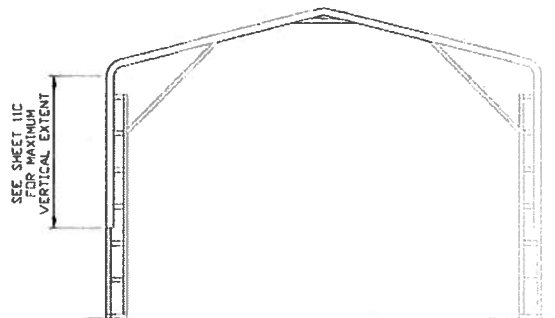

**TYPICAL END ELEVATION  
EXTRA SIDE PANELS**  
SCALE: NTS

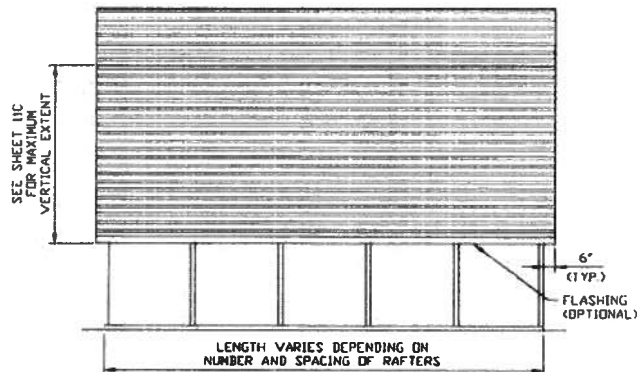

**TYPICAL SIDE ELEVATION  
EXTRA SIDE PANELS**  
SCALE: NTS

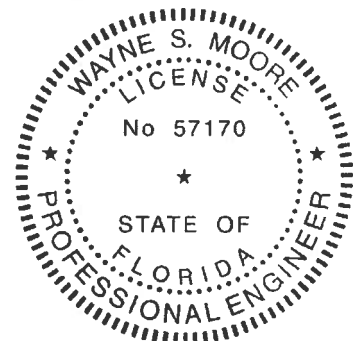

This item has been electronically signed and sealed by Wayne S. Moore, PE, using a Digital Signature and date.

Printed copies of this document are not considered signed and sealed and the signature must be verified on any electronic copies.

**MOORE AND ASSOCIATES  
ENGINEERING AND CONSULTING, INC.**

THIS DOCUMENT IS THE PROPERTY OF MOORE AND ASSOCIATES ENGINEERING AND CONSULTING. THE UNAUTHORIZED REPRODUCTION, COPYING, OR OTHERWISE USE OF THIS DOCUMENT IS STRICTLY PROHIBITED AND ANY INFRINGEMENT THEREUPON MAY BE SUBJECT TO LEGAL ACTION.

**DRAWN BY: AT**

**CHECKED BY: PDH**

**PROJECT NGR VSN**

**CLIENT: SBSI**

**STEEL BUILDINGS AND STRUCTURES, INC.**  
P.O. BOX 1287,  
MOUNT AIRY, NC 27030  
30'-0" x 20'-0" FULLY OPEN STRUCTURE

**DATE: 12-14-18**

**SHT. 11**

**SCALE: NTS**

**DWG. NO SK-1**

**JOB NO: 180685/182905**

**REV. 7**



## EXTRA SIDE PANEL OPTION

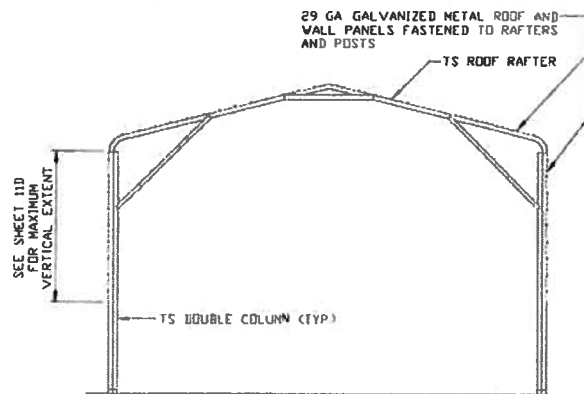

**TYPICAL END FRAME SECTION  
EXTRA SIDE PANELS**

SCALE: NTS

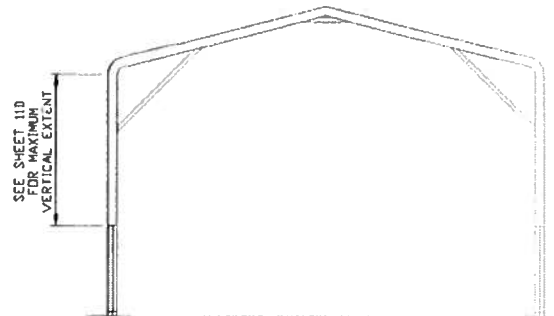

**TYPICAL END ELEVATION  
EXTRA SIDE PANELS**

SCALE: NTS

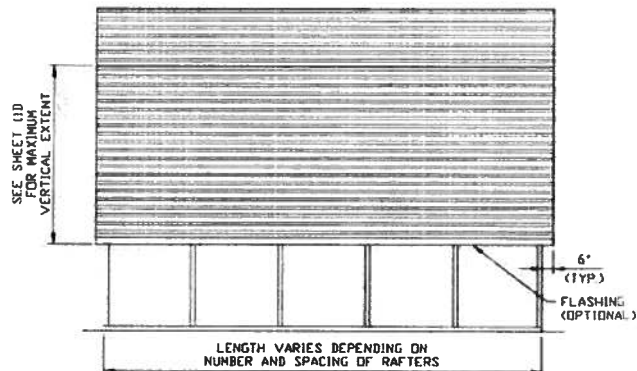

**TYPICAL SIDE ELEVATION  
EXTRA SIDE PANELS**

SCALE: NTS

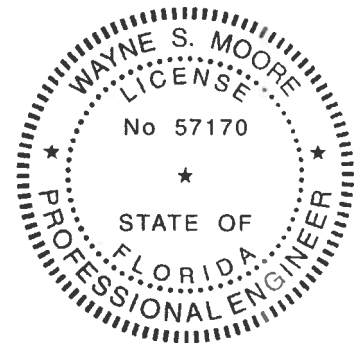

This item has been electronically signed and sealed by Wayne S. Moore, PE, using a Digital Signature and date.

Printed copies of this document are not considered signed and sealed and the signature must be verified on any electronic copies.

**MOORE AND ASSOCIATES  
ENGINEERING AND CONSULTING, INC.**

**DRAWN BY: AT**

**CHECKED BY: PDH**

**PROJECT MGR: VSH**

**CLIENT: SSSI**

**STEEL BUILDINGS AND STRUCTURES, INC.**  
P.O. BOX 1287,  
MOUNT AIRY, NC 27030  
30'-0"X20'-0" FULLY OPEN STRUCTURE

**DATE: 12-14-18**

**SCALE: NTS**

**DWG. NO: SK-1**

**JOB NO: 180685/181365/182905**

**REV: 7**

THIS DOCUMENT IS THE PROPERTY OF MOORE AND ASSOCIATES ENGINEERING AND CONSULTING. THE UNAUTHORIZED REPRODUCTION, COPYING, OR OTHERWISE USE OF THIS DOCUMENT IS STRICTLY PROHIBITED AND ANY INFRINGEMENT THEREUPON MAY BE SUBJECT TO LEGAL ACTION.

## EXTRA SIDE PANEL OPTION

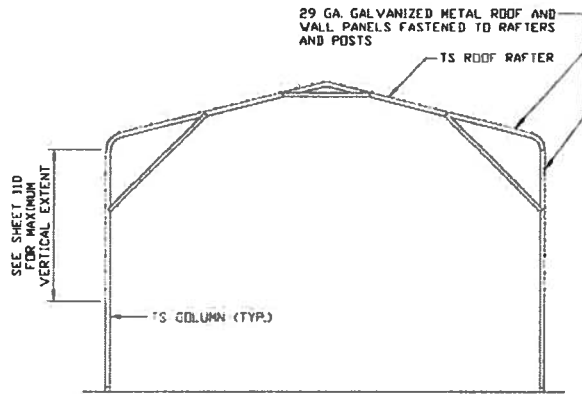

**TYPICAL END FRAME SECTION  
EXTRA SIDE PANELS**

SCALE: NTS

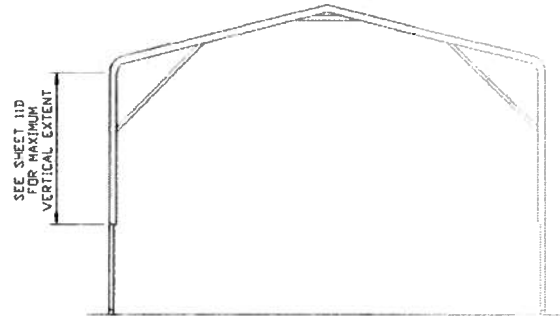

**TYPICAL END ELEVATION  
EXTRA SIDE PANELS**

SCALE: NTS

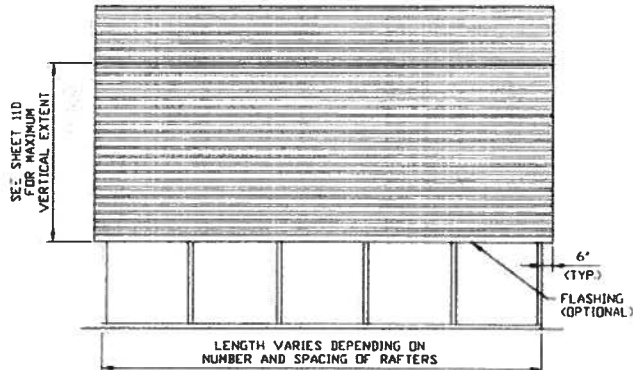

**TYPICAL SIDE ELEVATION  
EXTRA SIDE PANELS**

SCALE: NTS

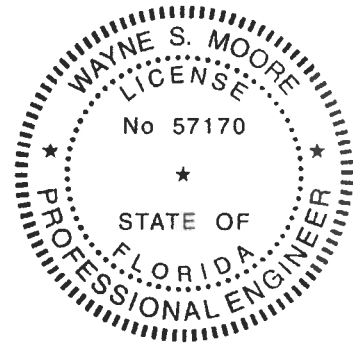

This item has been electronically signed and sealed by Wayne S. Moore, PE, using a Digital Signature and date.

Printed copies of this document are not considered signed and sealed and the signature must be verified on any electronic copies.

**MOORE AND ASSOCIATES  
ENGINEERING AND CONSULTING, INC.**

**DRAWN BY: AT**

**CHECKED BY: PMH**

**PROJECT MGR: VSM**

**CLIENT: SRSI**

**STEEL BUILDINGS AND STRUCTURES, INC.**  
P.O. BOX 1287,  
MOUNT AIRY, NC 27030  
30'-0"X20'-0" FULLY OPEN STRUCTURE

**DATE: 12-14-18**

**SCALE: NTS**

**JOB NO: 18136S/18290S**

**SHT. 11B**

**DWG. NO: SK-1**

**REV. 7**

THIS DOCUMENT IS THE PROPERTY OF MOORE AND ASSOCIATES ENGINEERING AND CONSULTING. THE UNAUTHORIZED REPRODUCTION, COPYING, OR OTHERWISE USE OF THIS DOCUMENT IS STRICTLY PROHIBITED AND ANY INFRINGEMENT THEREUPON MAY BE SUBJECT TO LEGAL ACTION.

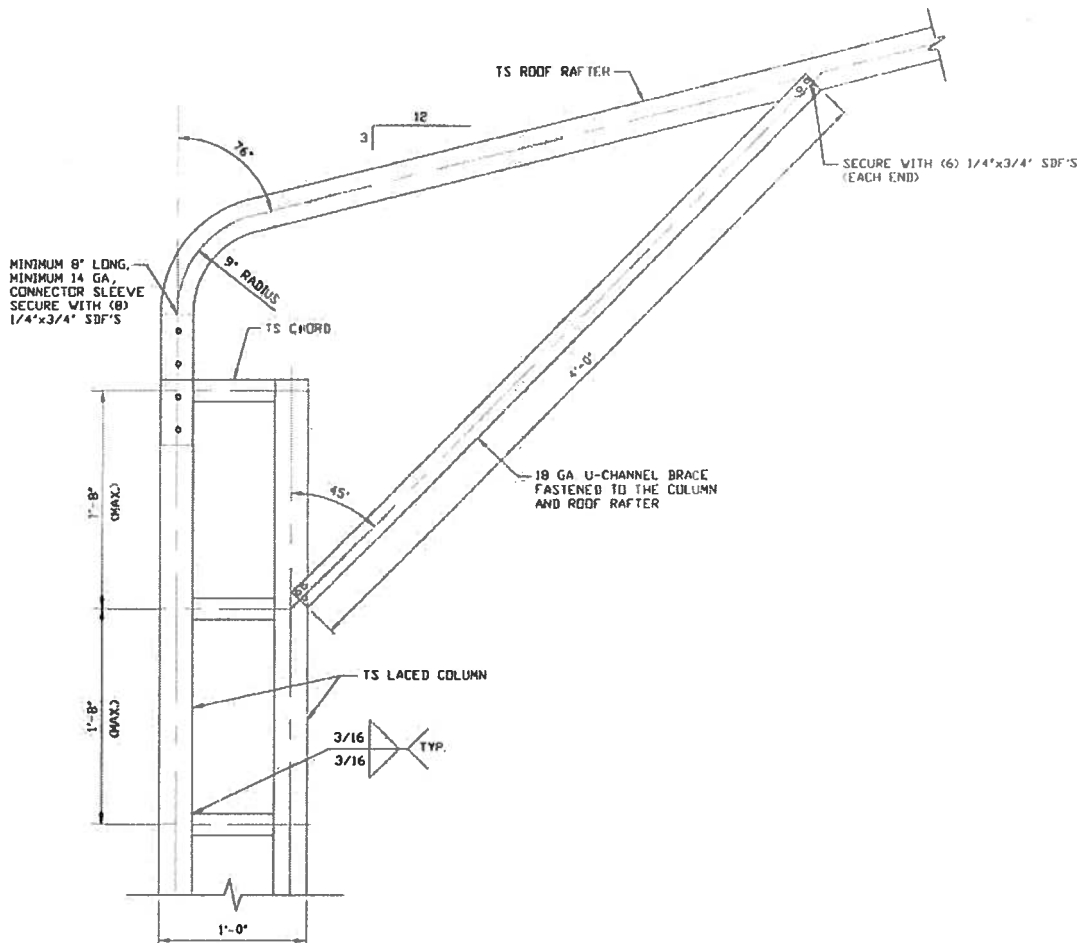

**BOW EAVE RAFTER/CORNER POST  
CONNECTION DETAIL  
FOR HEIGHTS 16'-0" < TO ≤ 20'-0"  
AND FOR MAXIMUM 20'-0" VERTICAL EXTENT**

11

SCALE: NTS

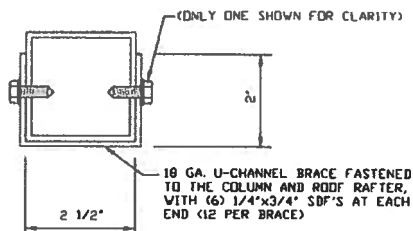

**BRACE SECTION**

SCALE: NTS

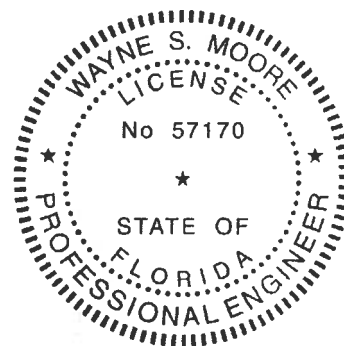

This item has been electronically signed and sealed by Wayne S. Moore, PE. using a Digital Signature and date.

Printed copies of this document are not considered signed and sealed and the signature must be verified on any electronic copies.

**MOORE AND ASSOCIATES  
ENGINEERING AND CONSULTING, INC.**

**DRAWN BY: AT**

**CHECKED BY: PMH**

**PROJECT MGR: VSM**

**CLIENT: SISI**

**STEEL BUILDINGS AND STRUCTURES, INC.**  
P.O. BOX 1287,  
MOUNT AIRY, NC 27030  
30'-0" x 20'-0" FULLY OPEN STRUCTURE

**DATE: 12-14-18**

**SCALE: NTS**

**JOB NO: 180565/180595**

**SHT. 11C**

**DWG. NO SK-1**

**REV: 7**

THIS DOCUMENT IS THE PROPERTY OF MOORE AND ASSOCIATES ENGINEERING AND CONSULTING, INC. UNAUTHORIZED REPRODUCTION, COPYING, OR OTHERWISE USE OF THIS DOCUMENT IS STRICTLY PROHIBITED AND ANY INFRINGEMENT THEREUPON MAY BE SUBJECT TO LEGAL ACTION.

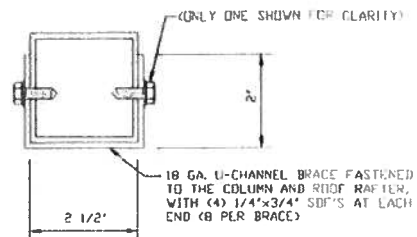

11A

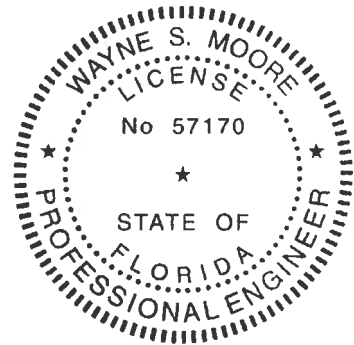

Printed copies of this document are not considered signed and sealed and the signature must be verified on any electronic copies.

REV. 7

THIS DOCUMENT IS THE PROPERTY OF MOORE AND ASSOCIATES ENGINEERING AND CONSULTING. THE UNAUTHORIZED REPRODUCTION, COPIING, OR OTHERWISE USE OF THIS DOCUMENT IS STRICTLY PROHIBITED AND ANY INFRINGEMENT THEREUPON MAY BE SUBJECT TO LEGAL ACTION.

## VERTICAL ROOF OPTION

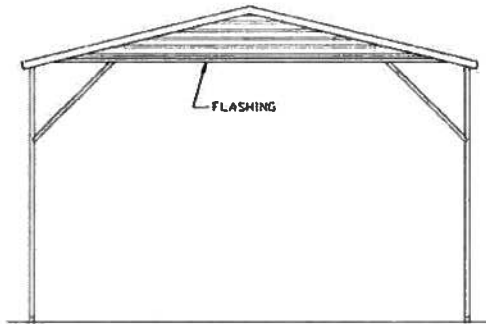

**TYPICAL END ELEVATION  
VERTICAL ROOF**

SCALE: NTS

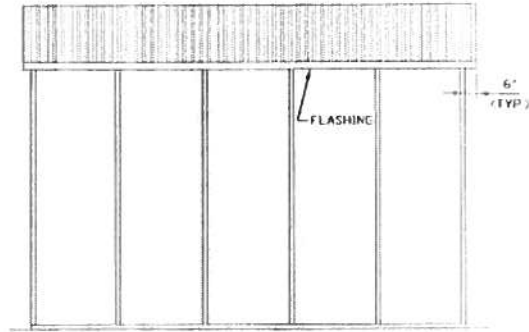

**TYPICAL SIDE ELEVATION  
VERTICAL ROOF OPTION**

SCALE: NTS

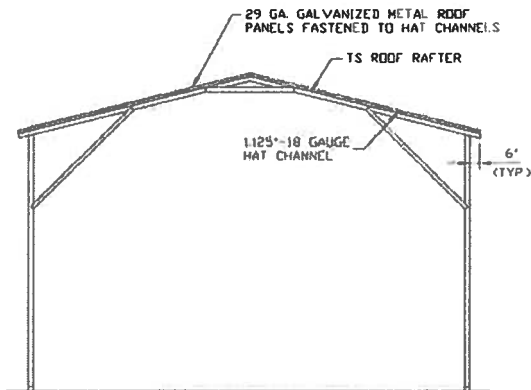

**TYPICAL SECTION  
VERTICAL ROOF OPTION**

SCALE: NTS

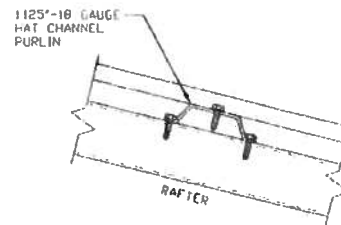

**ROOF PANEL ATTACHMENT**

(ALTERNATE FOR VERTICAL ROOF PANELS)  
SCALE: NTS

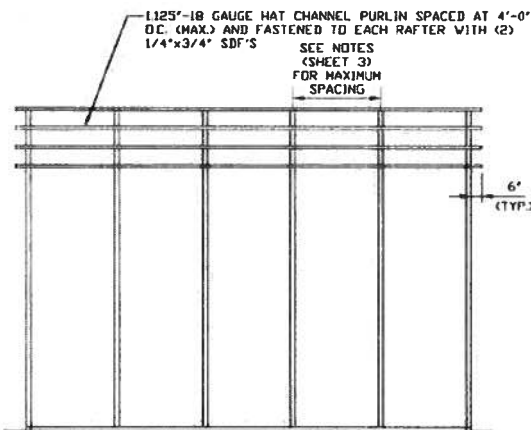

**TYPICAL SIDE FRAMING SECTION  
VERTICAL ROOF OPTION**

SCALE: NTS

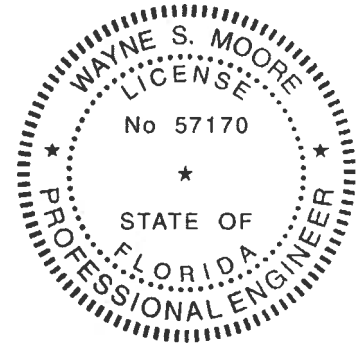

This item has been electronically signed and sealed by Wayne S. Moore, PE. using a Digital Signature and date.

Printed copies of this document are not considered signed and sealed and the signature must be verified on any electronic copies.

**MOORE AND ASSOCIATES  
ENGINEERING AND CONSULTING, INC.**

**DRAWN BY: AT**

**CHECKED BY: PMH**

**PROJECT MGR: VSM**

**CLIENT: SEBI**

**STEEL BUILDINGS AND STRUCTURES, INC.**  
P.O. BOX 1287,  
MOUNT AIRY, NC 27030  
30'-0" x 20'-0" FULLY OPEN STRUCTURE

DATE: 12-14-18	SCALE: NTS	JOB NO: 180668/181365/182905	180668/181365/182905
SHT. 12	DWG. NO: SK-1	REV. 7	

THIS DOCUMENT IS THE PROPERTY OF MOORE AND ASSOCIATES ENGINEERING AND CONSULTING. THE UNAUTHORIZED REPRODUCTION, COPYING, OR OTHERWISE USE OF THIS DOCUMENT IS STRICTLY PROHIBITED AND ANY INFRINGEMENT THEREUPON MAY BE SUBJECT TO LEGAL ACTION.

## ADDITIONAL BASE RAIL ANCHORAGE OPTION

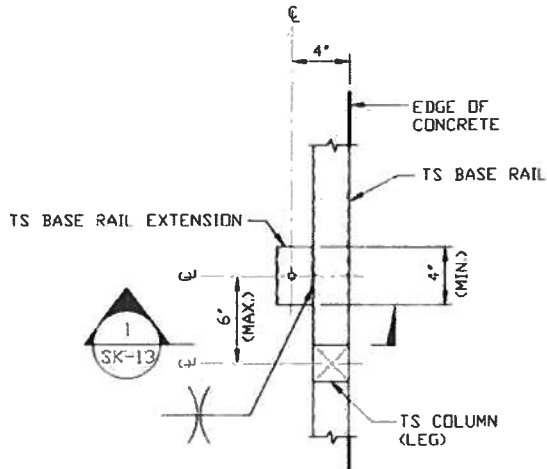

**TYPICAL ANCHOR DETAIL WHEN BASE RAIL IS NEAR EDGE OF CONCRETE**

SCALE: NTS

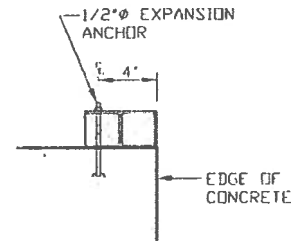

**SECTION 1**  
SCALE: NTS

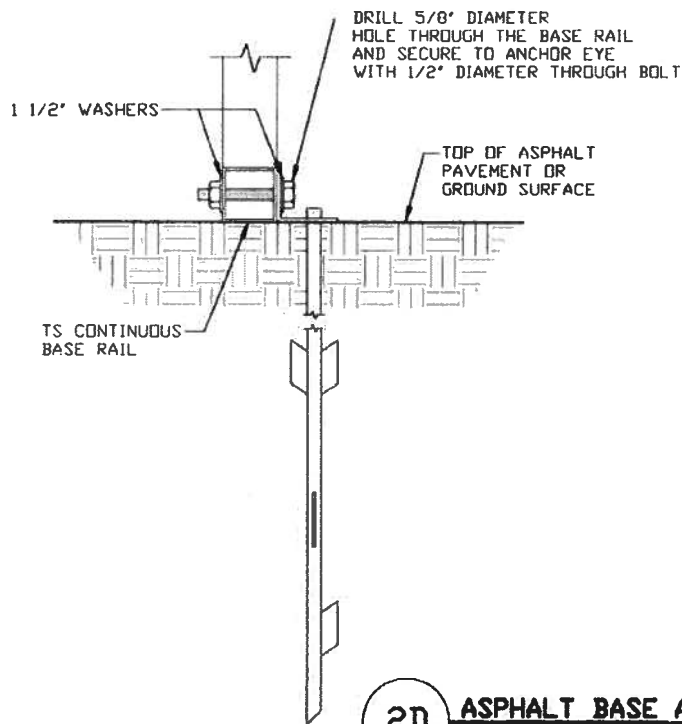

**2D**

**ASPHALT BASE ANCHORAGE**  
SCALE: NTS

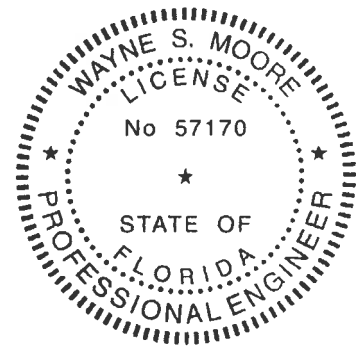

This item has been electronically signed and sealed by Wayne S. Moore, PE, using a Digital Signature and date.

Printed copies of this document are not considered signed and sealed and the signature must be verified on any electronic copies.

**MOORE AND ASSOCIATES  
ENGINEERING AND CONSULTING, INC.**

**DRAWN BY: AT**

**CHECKED BY: PDH**

**PROJECT MGR: VSM**

**CLIENT: SSSI**

**STEEL BUILDINGS AND STRUCTURES, INC.**  
P.O. BOX 1287,  
MOUNT AIRY, NC 27030  
30'-0" x 20'-0" FULLY OPEN STRUCTURE

**DATE: 12-14-18**

**SCALE: NTS**

**DWG. NO: SK-1**

**JOB NO: 180685/182208**

**SHT. 13**

**REV: 7**

THIS DOCUMENT IS THE PROPERTY OF MOORE AND ASSOCIATES ENGINEERING AND CONSULTING. THE UNAUTHORIZED REPRODUCTION, COPYING, OR OTHERWISE USE OF THIS DOCUMENT IS STRICTLY PROHIBITED AND ANY INFRINGEMENT THEREUPON MAY BE SUBJECT TO LEGAL ACTION.

# OPTIONAL BASE RAIL ON GRADE APPLICATION

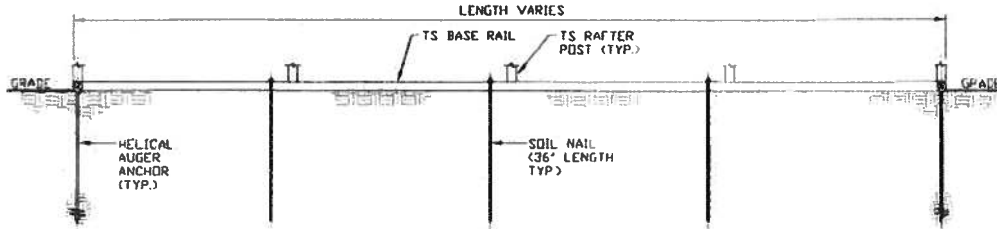

SECTION 2  
SCALE: NTS  
SK-14

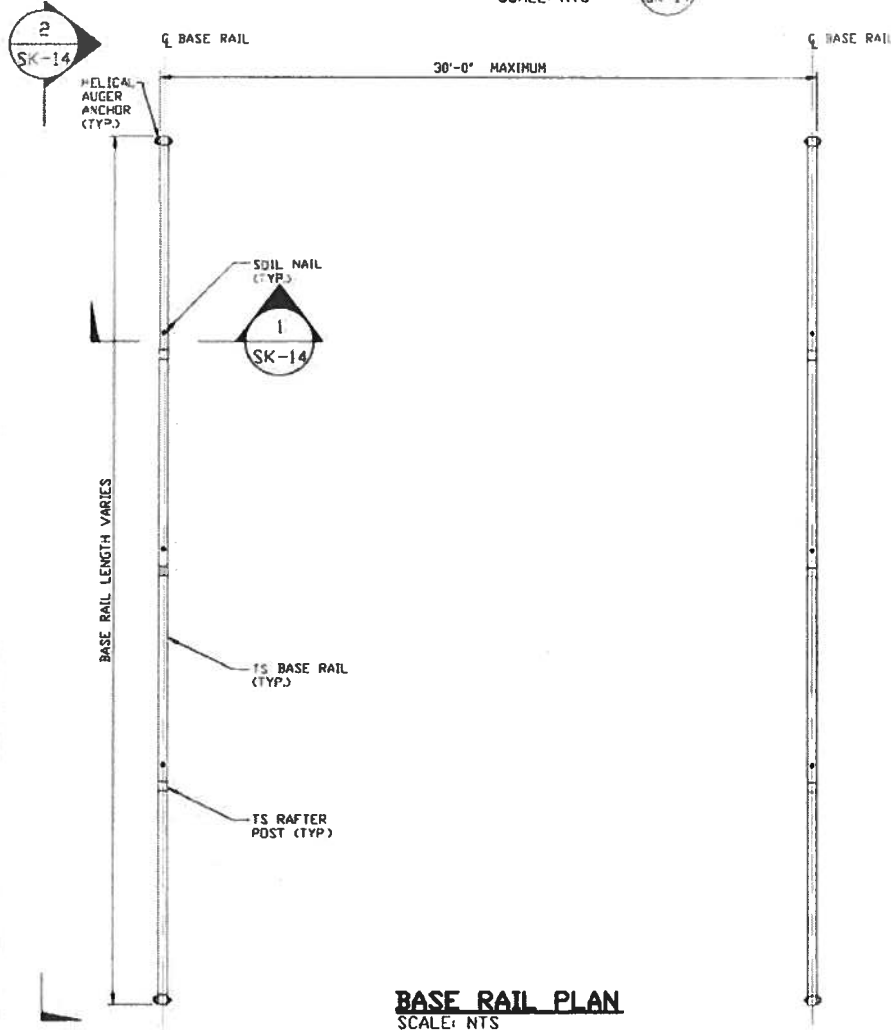

BASE RAIL PLAN  
SCALE: NTS

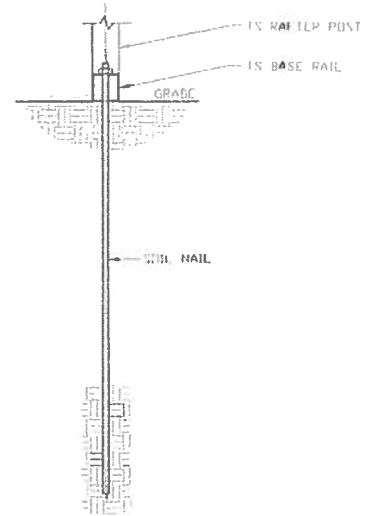

SECTION 1  
SCALE: NTS  
SK-14

HELIX ANCHOR	
SIDE LENGTH	MAXIMUM SPACING
VARIES	10'-0" (EVERY OTHER POST)

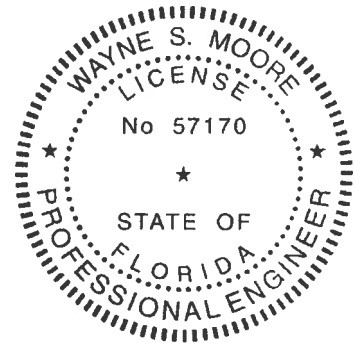

This item has been electronically signed and sealed by Wayne S. Moore, PE. using a Digital Signature and date.

Printed copies of this document are not considered signed and sealed and the signature must be verified on any electronic copies.

MOORE AND ASSOCIATES  
ENGINEERING AND CONSULTING, INC.

DRAWN BY: AT

CHECKED BY: PDH

PROJECT MGR: VSM

CLIENT: SSSI

STEEL BUILDINGS AND STRUCTURES, INC.  
P.O. BOX 1287,  
MOUNT AIRY, NC 27030  
30'-0" x 20'-0" FULLY OPEN STRUCTURE

DATE: 12-14-18

SHT. 14

SCALE: NTS

DWG. NO: SK-1

JOB NO: 180685/182905

REV. 7

THIS DOCUMENT IS THE PROPERTY OF MOORE AND ASSOCIATES ENGINEERING AND CONSULTING, INC. THE UNAUTHORIZED REPRODUCTION, COPYING, OR OTHERWISE USE OF THIS DOCUMENT IS STRICTLY PROHIBITED AND ANY INFRINGEMENT THEREUPON MAY BE SUBJECT TO LEGAL ACTION.

# OPTIONAL BASE RAIL ON TIMBER BEAM

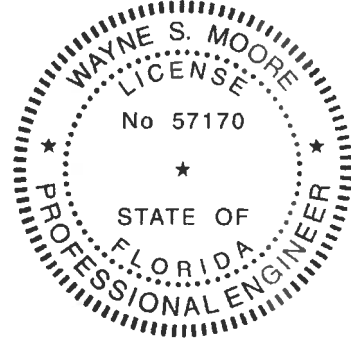
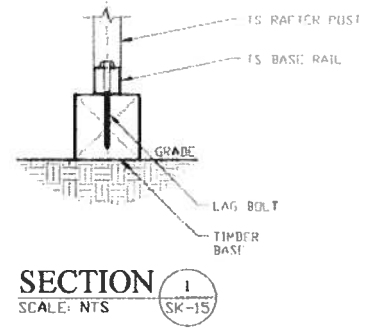
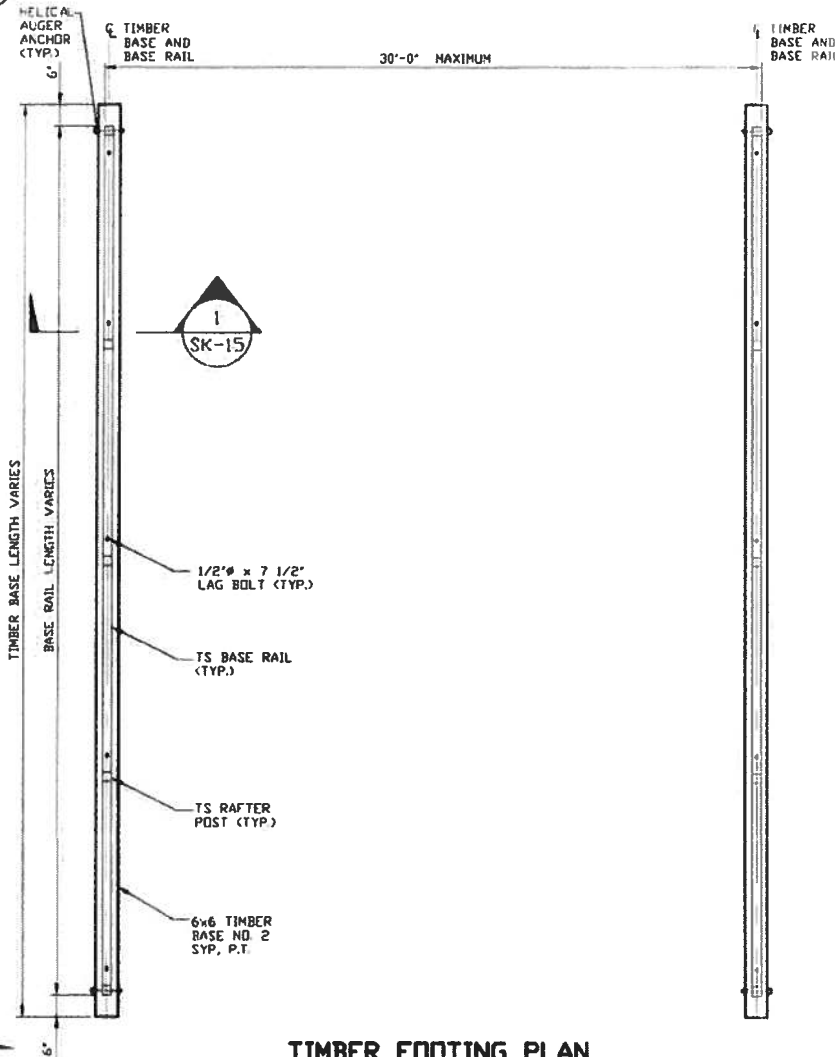
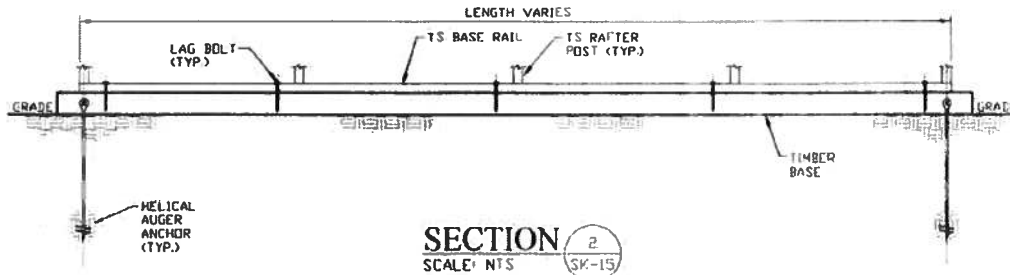

**TIMBER FOOTING PLAN**  
SCALE: NTS

HELIX ANCHOR	
SIDE LENGTH	MAXIMUM SPACING
VARIES	10'-0" (EVERY OTHER POST)

This item has been electronically signed and sealed by Wayne S. Moore, PE. using a Digital Signature and date.

Printed copies of this document are not considered signed and sealed and the signature must be verified on any electronic copies.

**MOORE AND ASSOCIATES  
ENGINEERING AND CONSULTING, INC.**

**DRAWN BY:** AT  
**CHECKED BY:** PDH  
**PROJECT NGR:** VSM  
**CLIENT:** SRSI

**STEEL BUILDINGS AND STRUCTURES, INC.**  
P.O. BOX 1287  
MOUNT AIRY, NC 27030  
30'-0" x 20'-0" FULLY OPEN STRUCTURE  
**DATE:** 12-14-18  
**SCALE:** NTS  
**SHT.** 15  
**DWG. NO.** SK-1  
**REV.** 7  
**JOB NO.** 181265/182205

THIS DOCUMENT IS THE PROPERTY OF MOORE AND ASSOCIATES ENGINEERING AND CONSULTING, INC. THE UNAUTHORIZED REPRODUCTION, COPYING, OR OTHERWISE USE OF THIS DOCUMENT IS STRICTLY PROHIBITED AND ANY INFRINGEMENT THEREUPON MAY BE SUBJECT TO LEGAL ACTION.



# OPTIONAL BASE RAIL ON TIMBER BEAM WITH SOIL NAIL

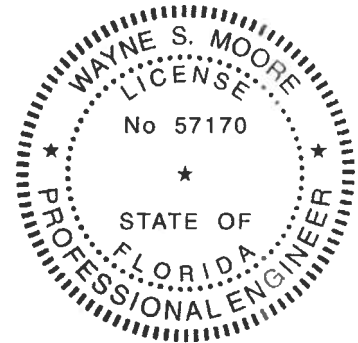
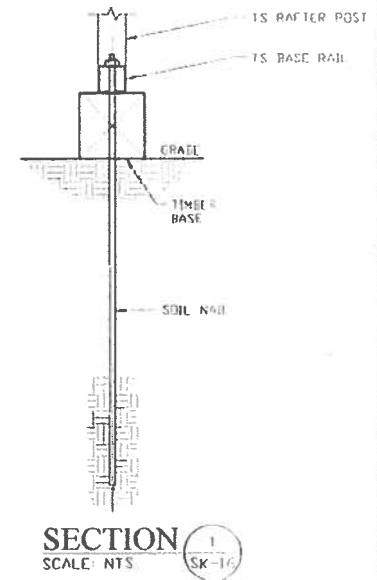
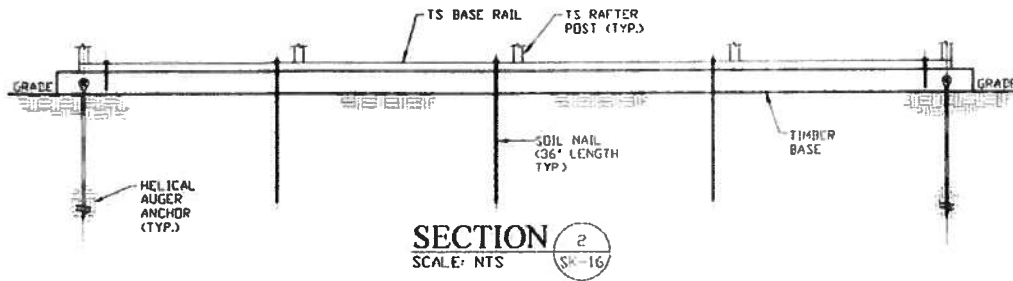

This item has been electronically signed and sealed by Wayne S. Moore, PE. using a Digital Signature and date.

Printed copies of this document are not considered signed and sealed and the signature must be verified on any electronic copies.

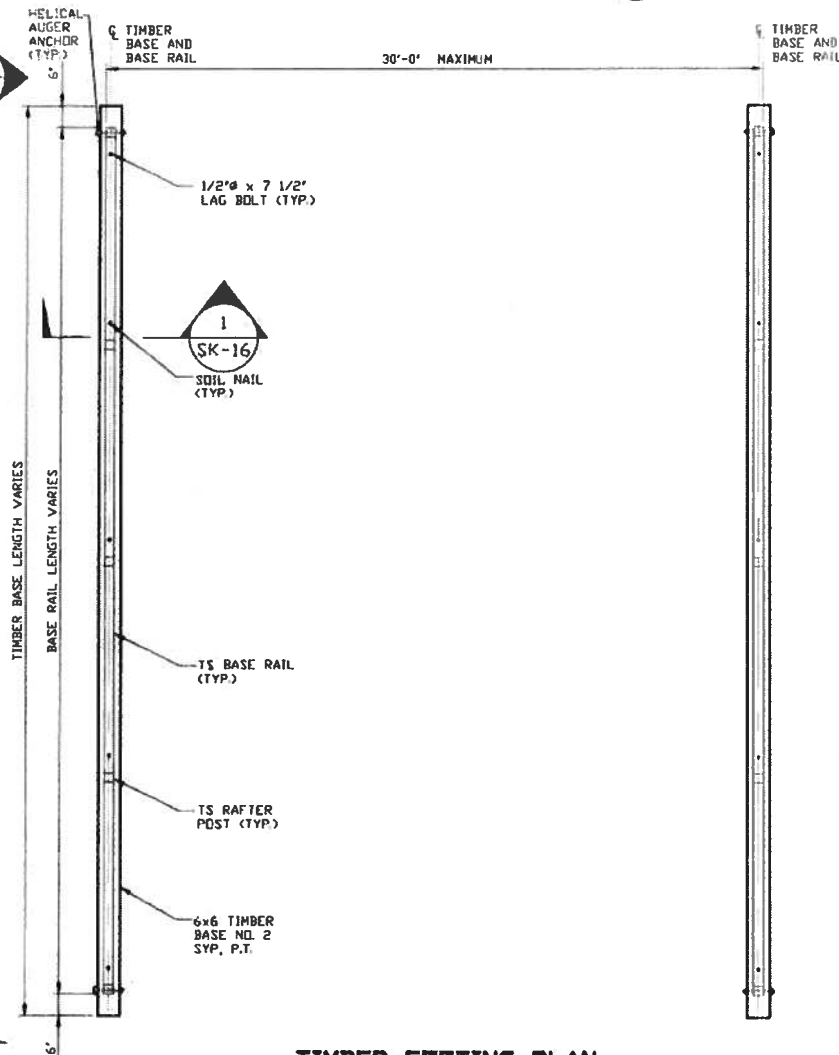

**TIMBER FOOTING PLAN**  
SCALE: NTS

HELIX ANCHOR	
SIDE LENGTH	MAXIMUM SPACING
VARIES	10'-0" (EVERY OTHER POST)

**MOORE AND ASSOCIATES  
ENGINEERING AND CONSULTING, INC.**

DRAWN BY: AT

CHECKED BY: PDH

PROJECT MGR: YSH

CLIENT: SBT

STEEL BUILDINGS AND STRUCTURES, INC.  
P.O. BOX 1287,  
MOUNT AIRY, NC 27030  
30'-0" x 20'-0" FULLY OPEN STRUCTURE

DATE: 12-14-18

SCALE: NTS

JOB NO: 180685/181345/1822905

SHT. 16

DWG. NO: SK-1

REV: 7

THIS DOCUMENT IS THE PROPERTY OF MOORE AND ASSOCIATES ENGINEERING AND CONSULTING, INC. UNAUTHORIZED REPRODUCTION, COPYING, OR OTHERWISE USE OF THIS DOCUMENT IS STRICTLY PROHIBITED AND ANY INFRINGEMENT THEREUPON MAY BE SUBJECT TO LEGAL ACTION.

### OPTIONAL CONCRETE STRIP FOOTING

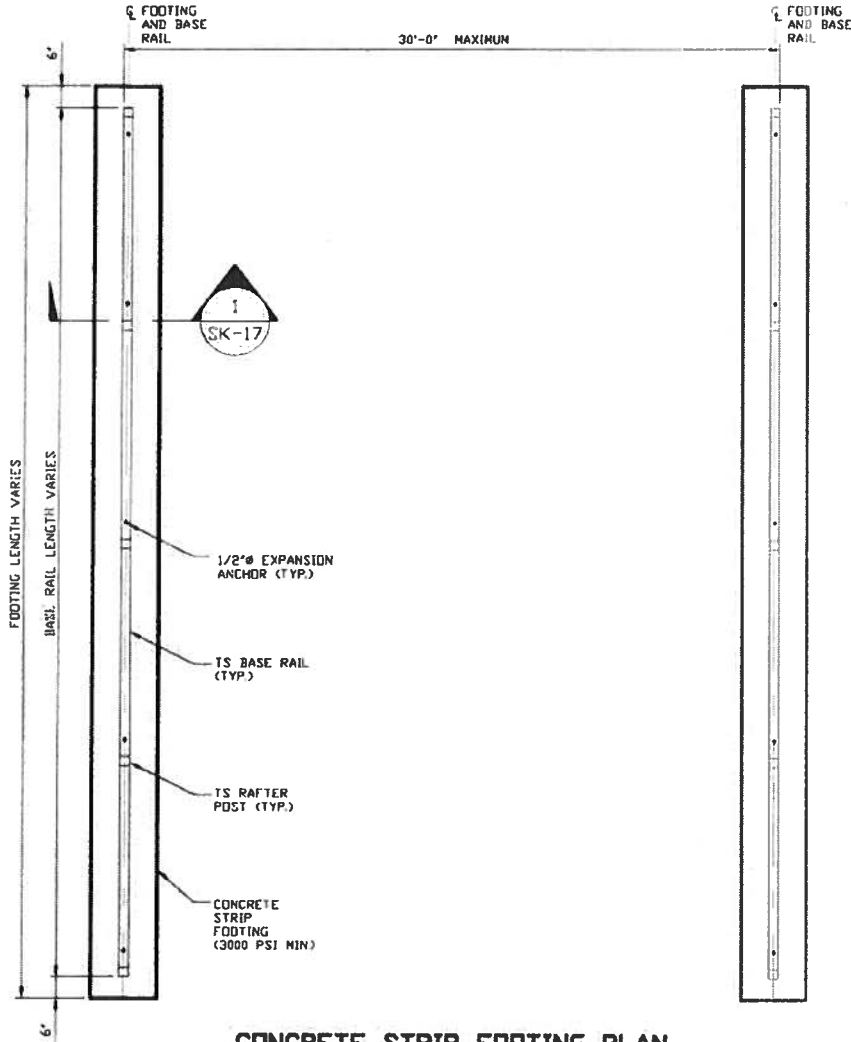

**CONCRETE STRIP FOOTING PLAN**  
SCALE: NTS

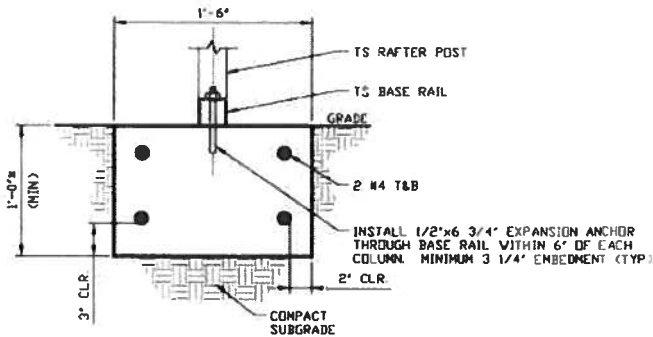

SECTION 1  
SCALE: NTS SK-17

►COORDINATE WITH LOCAL CODES/ORD.

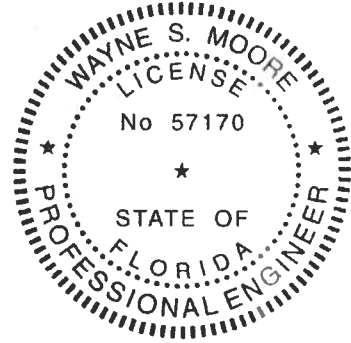

This item has been electronically signed and sealed by Wayne S. Moore, PE.  
using a Digital Signature and date.

Printed copies of this document are not considered signed and sealed and the signature must be verified on any electronic copies.

**MOORE AND ASSOCIATES  
ENGINEERING AND CONSULTING, INC.**

**DRAWN BY: AT**

CHECKED BY: PDH

PROJECT HGR VSH

**CLIENT: SRSI**

STEEL BUILDINGS AND STRUCTURES, INC.

P.O. BOX 1287,

MOUNT AIRY, NC 27030

30'-0"x20'-0" FULLY OPEN STRUCTURE

DATE 12-14-18

**SCALE: NTS**

**DWG NO. SK-1**

JTB NO: 180685/  
181545/182908

REV. 7

THIS DOCUMENT IS THE PROPERTY OF MOORE AND ASSOCIATES ENGINEERING AND CONSULTING. THE UNAUTHORIZED REPRODUCTION, COPYING, OR OTHERWISE USE OF THIS DOCUMENT IS STRICTLY PROHIBITED AND ANY INFRINGEMENT THEREUPON MAY BE SUBJECT TO LEGAL ACTION.