

## Columbia County Property Appraiser

Jeff Hampton

## 2022 Working Values

updated: 1/20/2022

Parcel: &lt;&lt; 35-3S-15-00276-102 (882) &gt;&gt;

## Owner &amp; Property Info

Result: 1 of 1

Owner	TOWNSEND DAVID D TOWNSEND ANNETTE M 6567 COUNTY ROAD 248 C LAKE PANASOFFKER, FL 33538		
Site	391 SW MEADOW WOOD Gln, LAKE CITY		
Description*	LOTS 2 MEADOW WOOD S/D. WD 1354-2007, QC 1407-1174, WD 1452-1438,		
Area	4.96 AC	S/T/R	35-3S-15E
Use Code**	VACANT (0000)	Tax District	3

\*The Description above is not to be used as the Legal Description for this parcel in any legal transaction.

\*\*The Use Code is a FL Dept. of Revenue (DOR) code and is not maintained by the Property Appraiser's office. Please contact your city or county Planning & Zoning office for specific zoning information.

## Property &amp; Assessment Values

2021 Certified Values		2022 Working Values	
Mkt Land	\$40,000	Mkt Land	\$40,000
Ag Land	\$0	Ag Land	\$0
Building	\$0	Building	\$0
XFOB	\$0	XFOB	\$0
Just	\$40,000	Just	\$40,000
Class	\$0	Class	\$0
Appraised	\$40,000	Appraised	\$40,000
SOH Cap [?]	\$0	SOH Cap [?]	\$0
Assessed	\$40,000	Assessed	\$40,000
Exempt	\$0	Exempt	\$0
Total	county:\$40,000	Total	county:\$40,000
Taxable	city:\$0	Taxable	city:\$0
	other:\$0		other:\$0
	school:\$40,000		school:\$40,000

Aerial Viewer Pictometry Google Maps

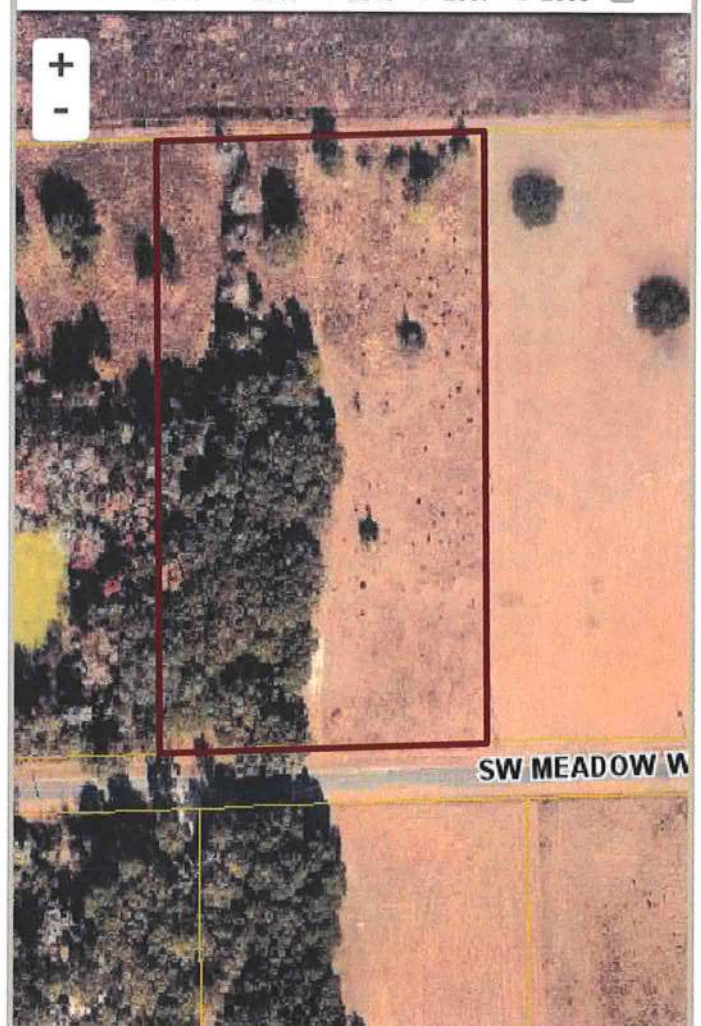
☒ 2019 ☐ 2016 ☐ 2013 ☐ 2010 ☐ 2007 ☐ 2005 ☐ Sales

## Sales History

Sale Date	Sale Price	Book/Page	Deed	V/I	Qualification (Codes)	RCode
11/12/2021	\$110,000	1452/1438	WD	V	Q	05 (Multi-Parcel Sale) - show
2/26/2020	\$100	1407/1174	QC	V	U	11
3/2/2018	\$45,000	1354/2007	WD	V	Q	01

## Building Characteristics

Bldg Sketch	Description*	Year Blt	Base SF	Actual SF	Bldg Value
NONE					

## Extra Features &amp; Out Buildings (Codes)

Code	Desc	Year Blt	Value	Units	Dims
NONE					

## Land Breakdown

Code	Desc	Units	Adjustments	Eff Rate	Land Value
0000	VAC RES (MKT)	1.000 LT (4.960 AC)	1.0000/1.0000 1.0000/ /	\$40,000 /LT	\$40,000

Search Result: 1 of 1