

# Project Information

## Customer

Diego Corr  
917 SW Iowa Dr  
Fort White, FL 32038  
Phone: (610) 324-8915  
haleydcorr@gmail.com

## Property

917 SW Iowa Dr  
Fort White, FL 32038

## Salesperson

Conner Rawlins  
Phone: (904) 515-8680  
Email: crawlins@foundationprosfl.com

# Materials List

## Products

Description	Quantity
Galvanized Steel I-Beam (LF)	40.00
General Permitting & Engineering	1.00
Crawl Space Screw Jacks	1.00
General Day Labor	1.00

# Bid Information

## Foundation

### Overview

On October 7, 2022, Conner Rawlins, a Geotechnical Solutions Consultant with Foundation Professionals of Florida, Inc. (FPI), provided an onsite inspection to evaluate the customer's concern regarding their foundation.

Project: This 1996 home is a one-story, single-family wood frame with a pier, beam foundation, and shingle roof.

Problem: The existing foundation is inadequately supported.

FPI recommends the following repair plan:

1) FPI will install by welding four 10' sections of 8"x5 1/4" steel I-beam under the floor joist spanning between the existing I-beams to adequately support the floor joist.

2) FPI will install (1) triple hot dipped galvanized steel ECP adjustable crawlspace jack as indicated on the included drawing.

### Crawl Space Foundation Repair

Product	Quantity
Galvanized Steel I-Beam (LF) <i>4" galvanized I-Beam</i>	40
General Permitting & Engineering	1
Crawl Space Screw Jacks <i>Crawlspace support jacks are designed to provide positive support to sagging floors above crawlspaces and to help remove the bouncing or squeaking caused by inadequate support. This supplemental support system has an ultimate capacity of 60,000 lbs per jack and is used for supplemental structural support.</i>	1
General Day Labor	1

### Notes

\* Due to the constant fluctuation in material cost, this proposal is valid for 30 days. If your proposal has expired, we are happy to provide a new proposal.

\* Due to the unsupported span of I-beam being installed, the I-beam has the potential to sag slightly.



# Photos

## Foundation

### Crawl Space Foundation Repair



# Legend

- Foundation 
- Exterior Pier 
- Exterior Wall 

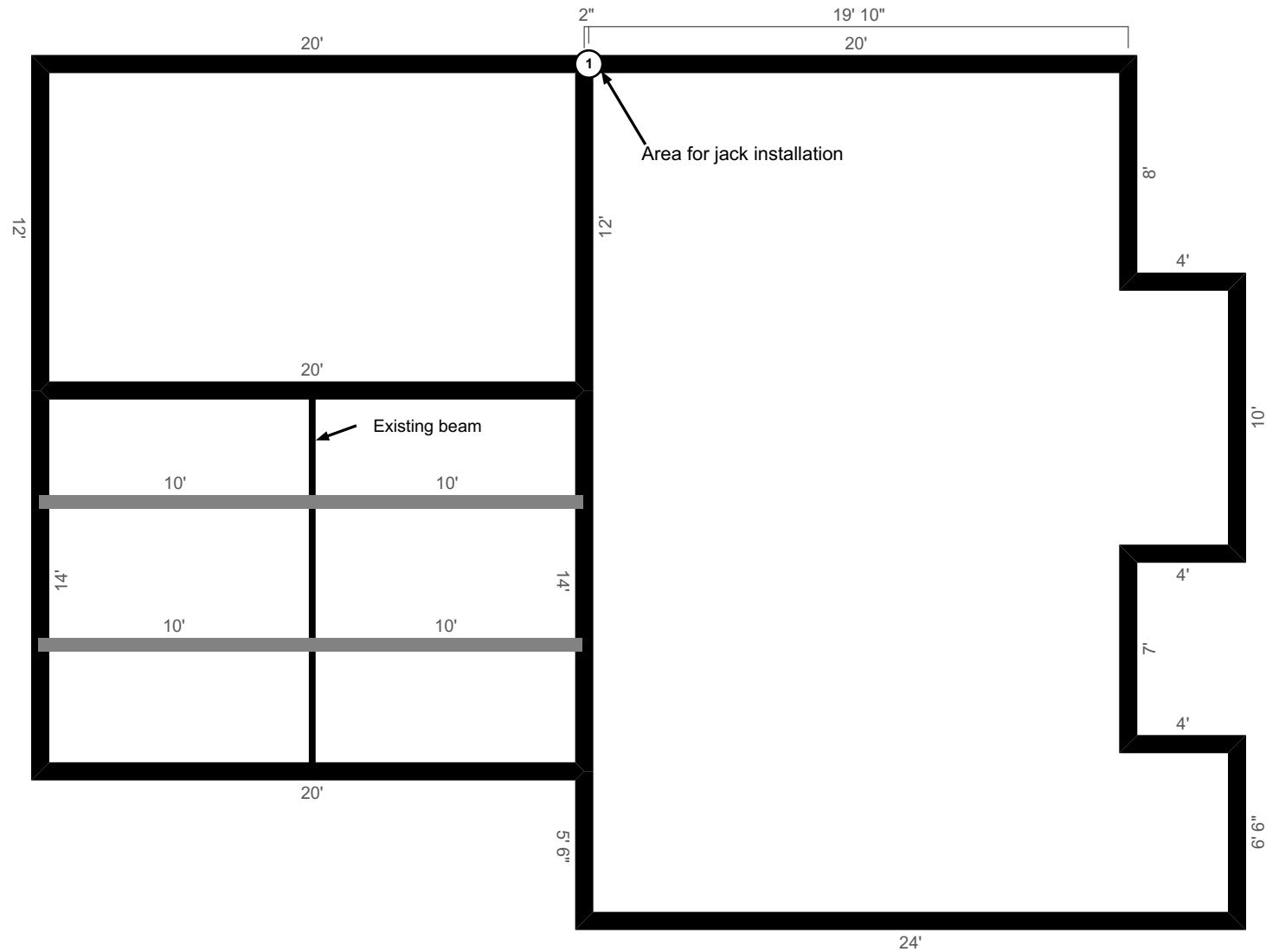

Corr / Foundation Repair (Copy)



**Foundation Professionals of Florida**  
 3309 SW State Road 247  
 Lake City, FL 32024  
[www.foundationprosfl.com](http://www.foundationprosfl.com)

**Project Address**  
 Diego Corr  
 917 SW Iowa Dr  
 Fort White, FL 32038

**Created By**  
 Conner Rawlins  
 (904) 515-8680  
 11/3/2022