

Columbia County, FLA - Building & Zoning Property Map

Printed: Mon May 12 2025 13:06:08 GMT-0400 (Eastern Daylight Time)

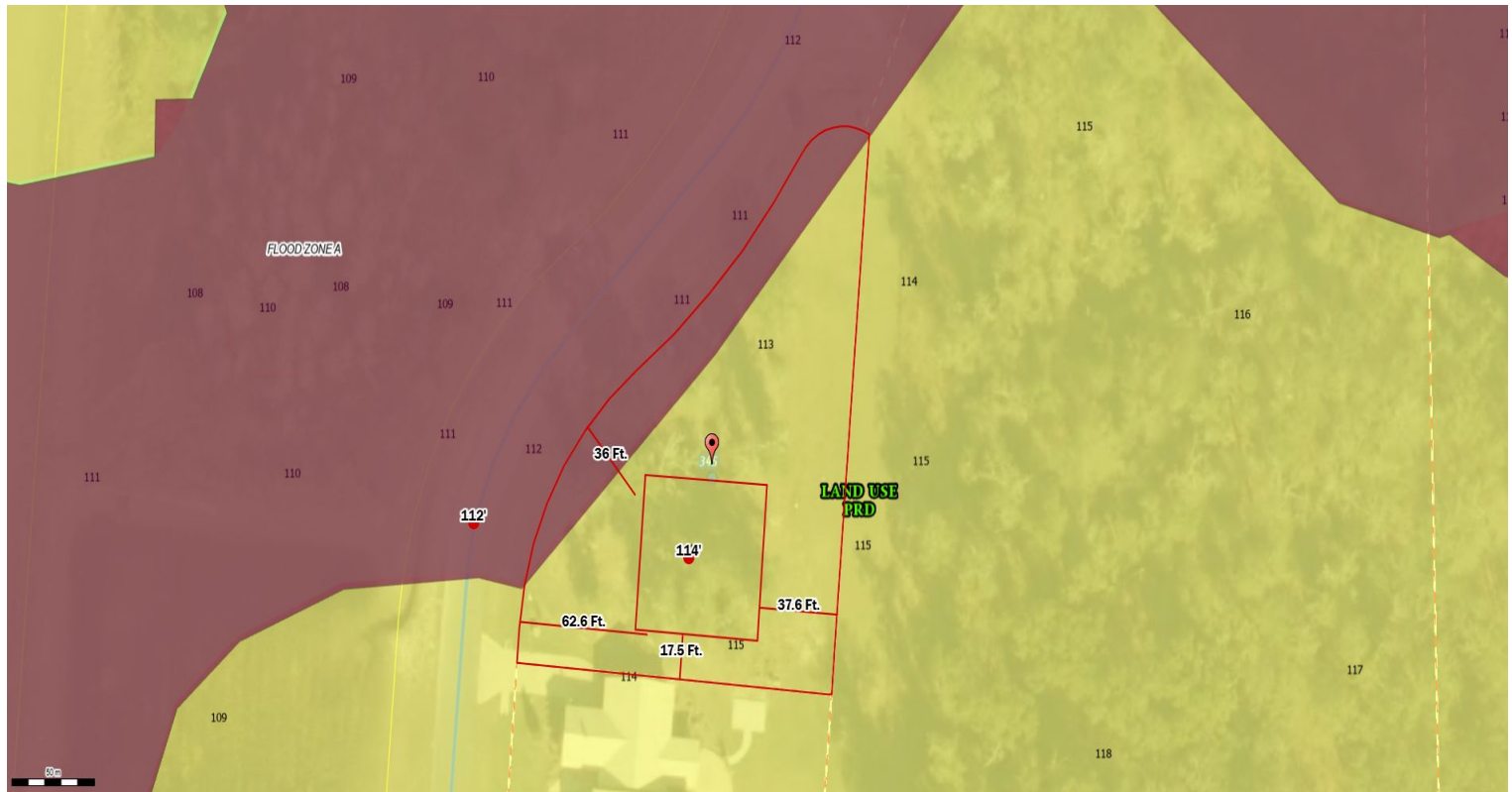

Parcel No: 13-4S-16-02951-117
Owner: GRAHAM MURVYN,
Subdivision: AMELIA LANDING PHASE 1
Lot: 17
Acres: 0.5500921
Deed Acres:
District: District 5 Tim Murphy
Future Land Uses: Residential - Low, Residential - Very Low
Flood Zones: A,
Official Zoning Atlas: PRD

All data, information, and maps are provided "as is" without warranty or any representation of accuracy, timeliness of completeness. Columbia County, FL makes no warranties, express or implied, as to the use of the information obtained here. There are no implied warranties of merchantability or fitness for a particular purpose. The requester acknowledges and accepts all limitations, including the fact that the data, information, and maps are dynamic and in a constant state of maintenance, and update.