



STATE OF FLORIDA
DEPARTMENT OF ENVIRONMENTAL PROTECTION
ONSITE SEWAGE TREATMENT AND DISPOSAL
SYSTEM (OSTDS)

PERMIT NO.
DATE PAID:
FEE PAID:
RECEIPT #:

24-0453
5/21/24
310.00
2088925

APPLICATION FOR CONSTRUCTION PERMIT

APPLICATION FOR:

☒ New System ☐ Existing System ☐ Holding Tank ☐ Innovative
☐ Repair ☐ Abandonment ☐ Temporary ☐

APPLICANT: Kenneth Hill EMAIL: liveoakspoiled@aol.com

AGENT: Suwannee Septic and Sitework TELEPHONE: 239-910-7555

MAILING ADDRESS: 18081 185th Rd Live Oak, FL 32060

TO BE COMPLETED BY APPLICANT OR APPLICANT'S AUTHORIZED AGENT. SYSTEMS MUST BE CONSTRUCTED BY A PERSON LICENSED PURSUANT TO 489.105(3)(m) OR 489.552, FLORIDA STATUTES. IT IS THE APPLICANT'S RESPONSIBILITY TO PROVIDE DOCUMENTATION OF THE DATE THE LOT WAS CREATED OR PLATTED (MM/DD/YY) IF REQUESTING CONSIDERATION OF STATUTORY GRANDFATHER PROVISIONS.

PROPERTY INFORMATION

OSTDS REMEDIATION PLAN? ☒ Y / ☐ N

LOT: 12 BLOCK: Suwannee Hills S SUBDIVISION: Pine Ridge Estates PLATTED: 21-2s-16-01689-112

PROPERTY ID #: 27364602323002 ZONING: Res I/M OR EQUIVALENT: ☐ I ☒ M

PROPERTY SIZE: 5.01 ACRES WATER SUPPLY: ☐ PRIVATE PUBLIC ☒ ≤ 2000 GPD ☐ > 2000 GPD

IS SEWER AVAILABLE AS PER 381.0065, FS? ☐ Y / ☒ N DISTANCE TO SEWER: 500+ FT

PROPERTY ADDRESS: 251 NW Sugarcane Pl Lake City FL 32055

DIRECTIONS TO PROPERTY: Turn right on NE Franklin Ave. Turn left on NE Washington St. Turn right on Main St(SR 41)
Turn left on NW Baughn St. Turn right on NW Cracknel Way. Turn left on NW Sugarcane Pl. Property will be on the right.

BUILDING INFORMATION

☒ RESIDENTIAL ☐ COMMERCIAL

Unit No	Type of Establishment	No. of Bedrooms	Building Area Sqft	Commercial/Institutional System Design Table I, Chapter 62-6, FAC
1	Manufactured home	4	2514	
2				
3				
4				

☐ Floor/Equipment Drains ☐ Other (Specify) _____

SIGNATURE: John Watson DATE: 05/27/2024

DEP 4015, 06-21-2022 (Obsoletes previous editions which may not be used)

Incorporated 62-6.004, FAC

✓ 21-25-16-01689-112

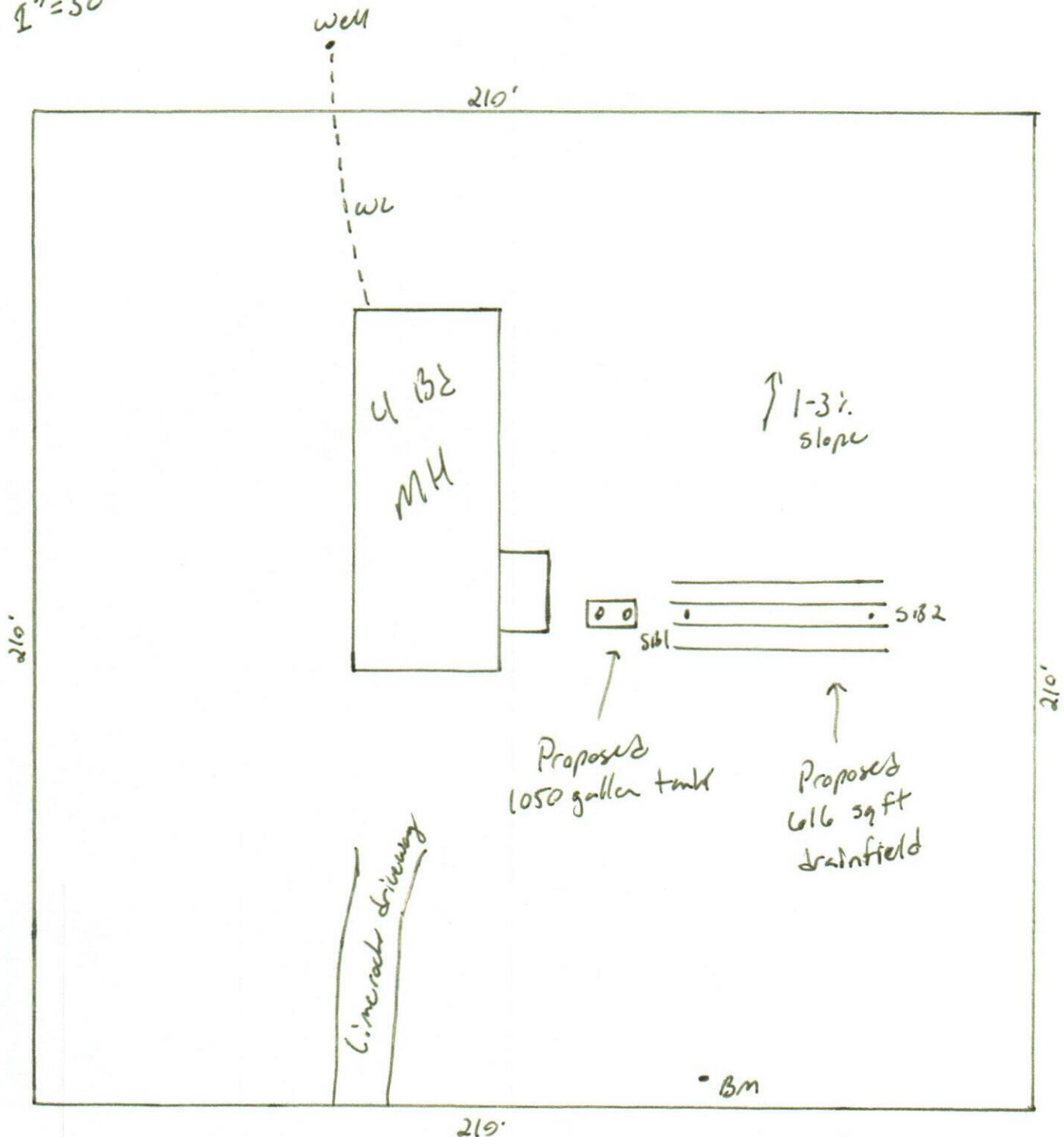
$$1'' = 30'$$

Isle Water
5/27/24

No offsite features
with in 75'