

Permit # 41509



Woodman Park Builders, Inc.

Charles Ward Res.

PROJECT ADDRESS:  
Columbia County, Florida

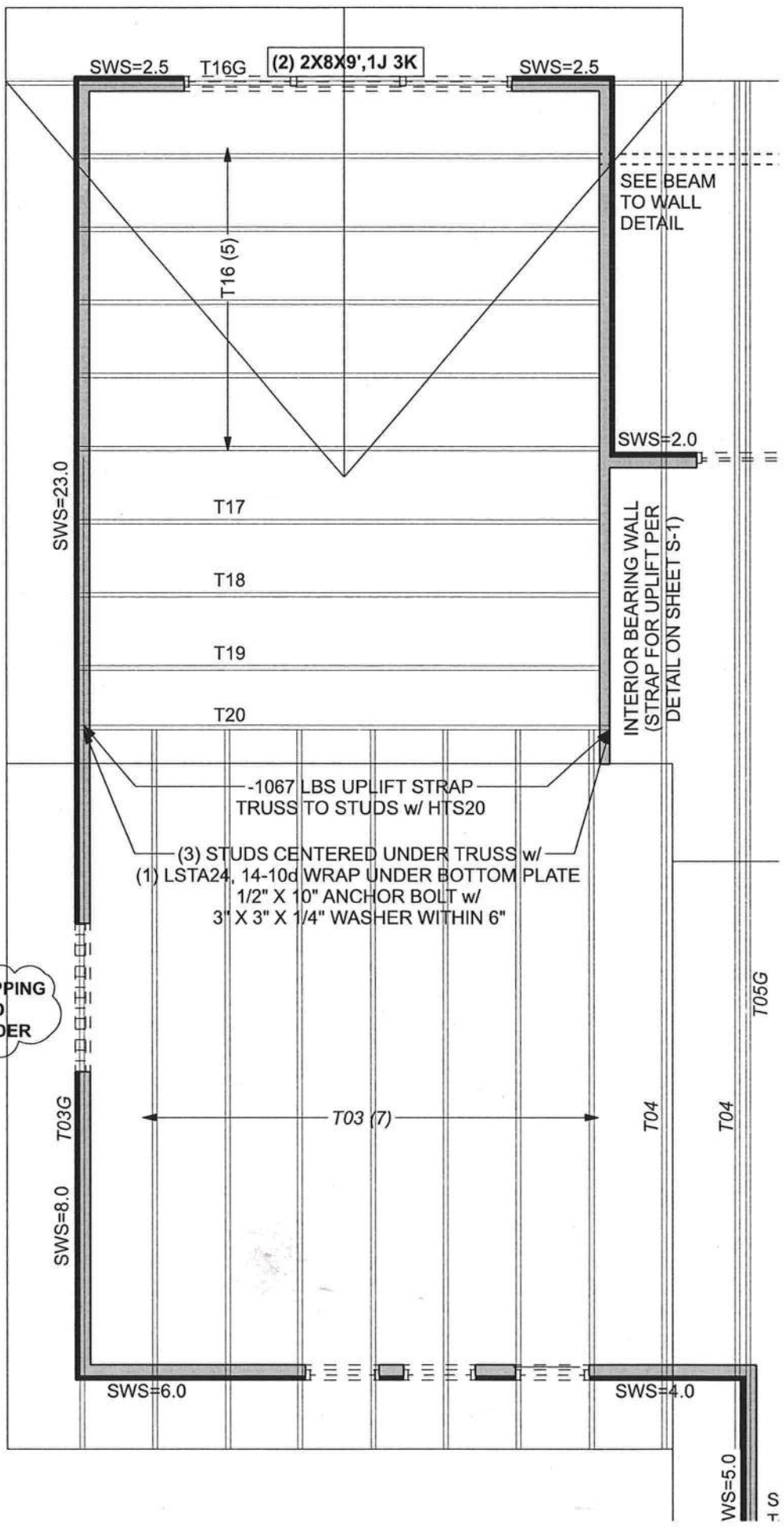

NO STRAPPING  
REQUIRED  
THIS HEADER

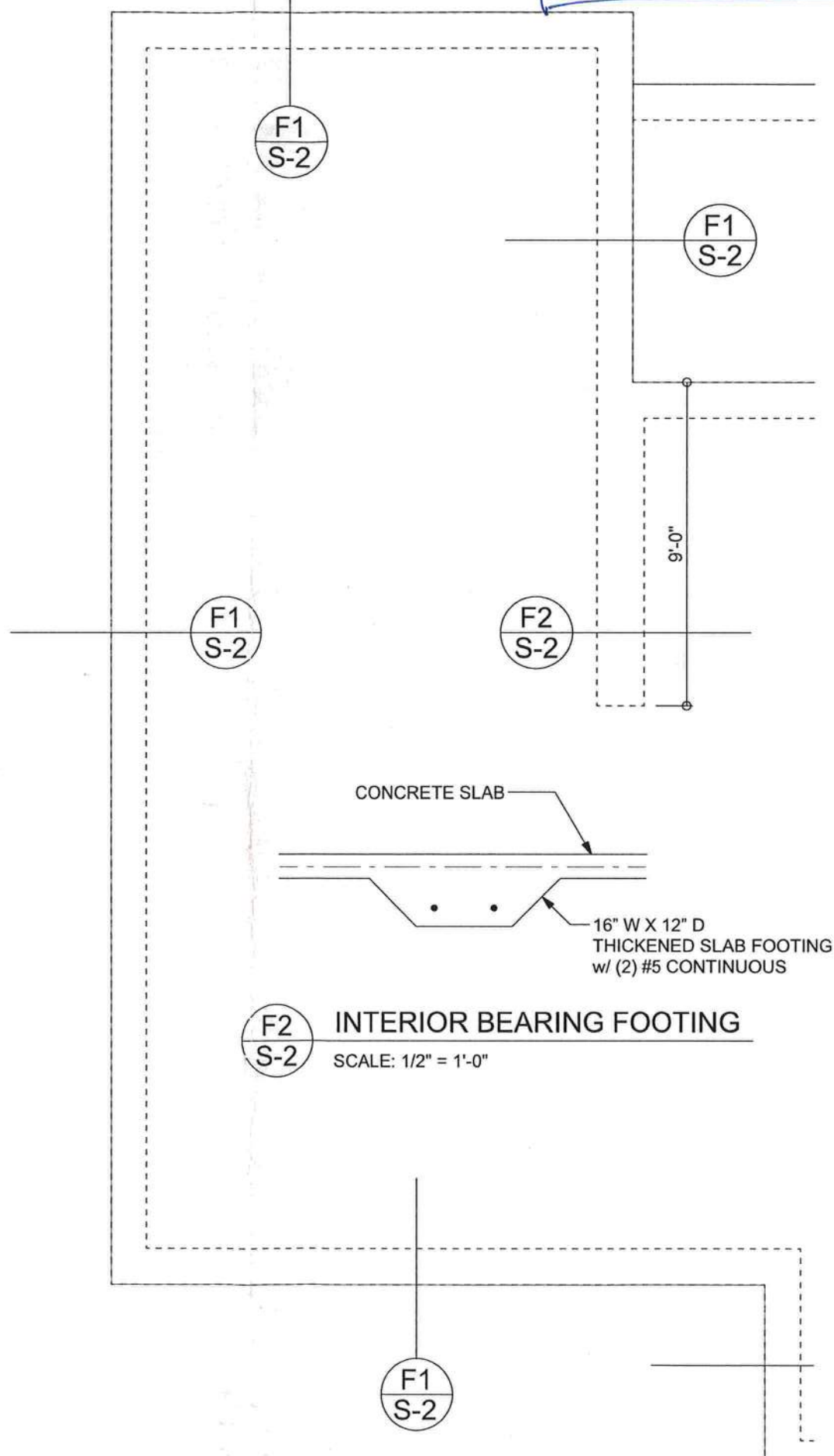

**DIMENSIONS:**  
Stated dimensions supercede scaled dimensions. Refer all questions to Mark Disosway, P.E. for resolution. Do not proceed without clarification.

**COPYRIGHTS AND PROPERTY RIGHTS:**  
Mark Disosway, P.E. hereby expressly reserves its common law copyrights and property right in these instruments of service. This document is not to be reproduced, altered or copied in any form or manner without first the express written permission and consent of Mark Disosway.

**CERTIFICATION:** I hereby certify that I have examined this plan, and that the applicable portions of the plan, relating to wind engineering comply with the 7th Edition Florida Building Code Residential (2020) to the best of my knowledge.

**LIMITATION:** This design is valid for one building, at specified location.



Monday, March 29, 2021

**Mark Disosway P.E.**  
163 SW Midtown Place  
Suite 103  
Lake City, Florida 32025  
386.754.5419  
disoswaydesign@gmail.com

**JOB NUMBER:**  
210100