



279 W. Duval St.
Lake City, FL 32055
03/01/22

Allen Industries

YOUR BRAND AT ITS BEST™

1-800-967-2553
www.allenindustries.com

Customer Approval / Signature

Signature: _____ Date: _____

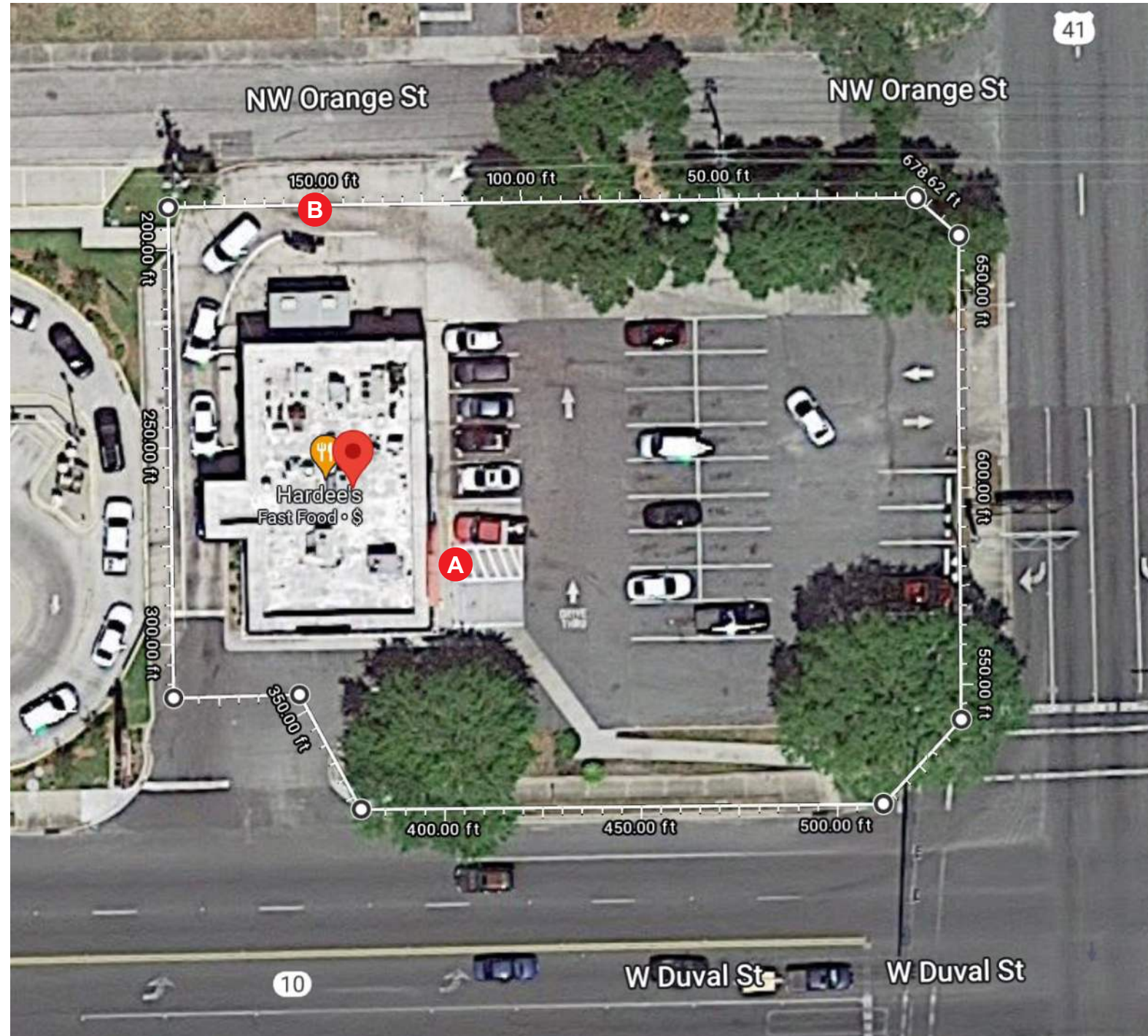

- A** Stacked Logo and Backer
- B** DT OCU

Client Review Status
 Allen Industries, Inc. requires that an approved drawing be obtained from the client prior to any production release or production release revision.

Client Signature: _____ Approval Date: _____

Notes:

#	Date	Description	Initial
1	04/13/22	-	BH
2	07/08/22	-	BH
3	-	-	-
4	-	-	-
5	-	-	-
6	-	-	-
7	-	-	-
8	-	-	-
9	-	-	-
10	-	-	-
11	-	-	-
12	-	-	-
13	-	-	-
14	-	-	-
15	-	-	-
16	-	-	-
17	-	-	-
18	-	-	-
19	-	-	-
20	-	-	-

Date: 03/01/22 Page #: 2

File Name: CKE-H-F.41_Lake City, FL_301

Sales: TA Design: BH PM: CR

Client: Hardee's

Address: 279 W. Duval St.
 Lake City, FL 32055

Copyright © 2022 Allen Industries, Inc.
 This is an original, unpublished drawing, created by Allen Industries, Inc. This drawing is submitted to you in confidence for your use solely in connection with the project being planned for you by Allen Industries, Inc. and is not to be shown to anyone outside your organization, nor used, reproduced, copied or exhibited in any fashion whatsoever. The designs shown on the drawing (except for any registered trademarks that may belong to a client of Allen Industries, Inc.) remain the property of Allen Industries, Inc.

Stacked Logo and Backer

Client Review Status
 Allen Industries, Inc. requires that an approved drawing be obtained from the client prior to any production release or production release revision.

Client Signature: _____ Approval Date: _____

Notes:

#	Date	Description	Initial
1	04/13/22	-	BH
2	07/08/22	-	BH
3	-	-	-
4	-	-	-
5	-	-	-
6	-	-	-
7	-	-	-
8	-	-	-
9	-	-	-
10	-	-	-
11	-	-	-
12	-	-	-
13	-	-	-
14	-	-	-
15	-	-	-
16	-	-	-
17	-	-	-
18	-	-	-
19	-	-	-
20	-	-	-

Date: **03/01/22** Page #: **3**

File Name: **CKE-H-F.41_Lake City, FL_301**

Sales: **TA** Design: **BH** PM: **CR**

Client: **Hardee's**

Address: **279 W. Duval St.
 Lake City, FL 32055**

Copyright © 2022 Allen Industries, Inc.
 This is an original, unpublished drawing, created by Allen Industries, Inc. This drawing is submitted to you in confidence for your use solely in connection with the project being planned for you by Allen Industries, Inc. and is not to be shown to anyone outside your organization, nor used, reproduced, copied or exhibited in any fashion whatsoever. The designs shown on the drawing (except for any registered trademarks that may belong to a client of Allen Industries, Inc.) remain the property of Allen Industries, Inc.

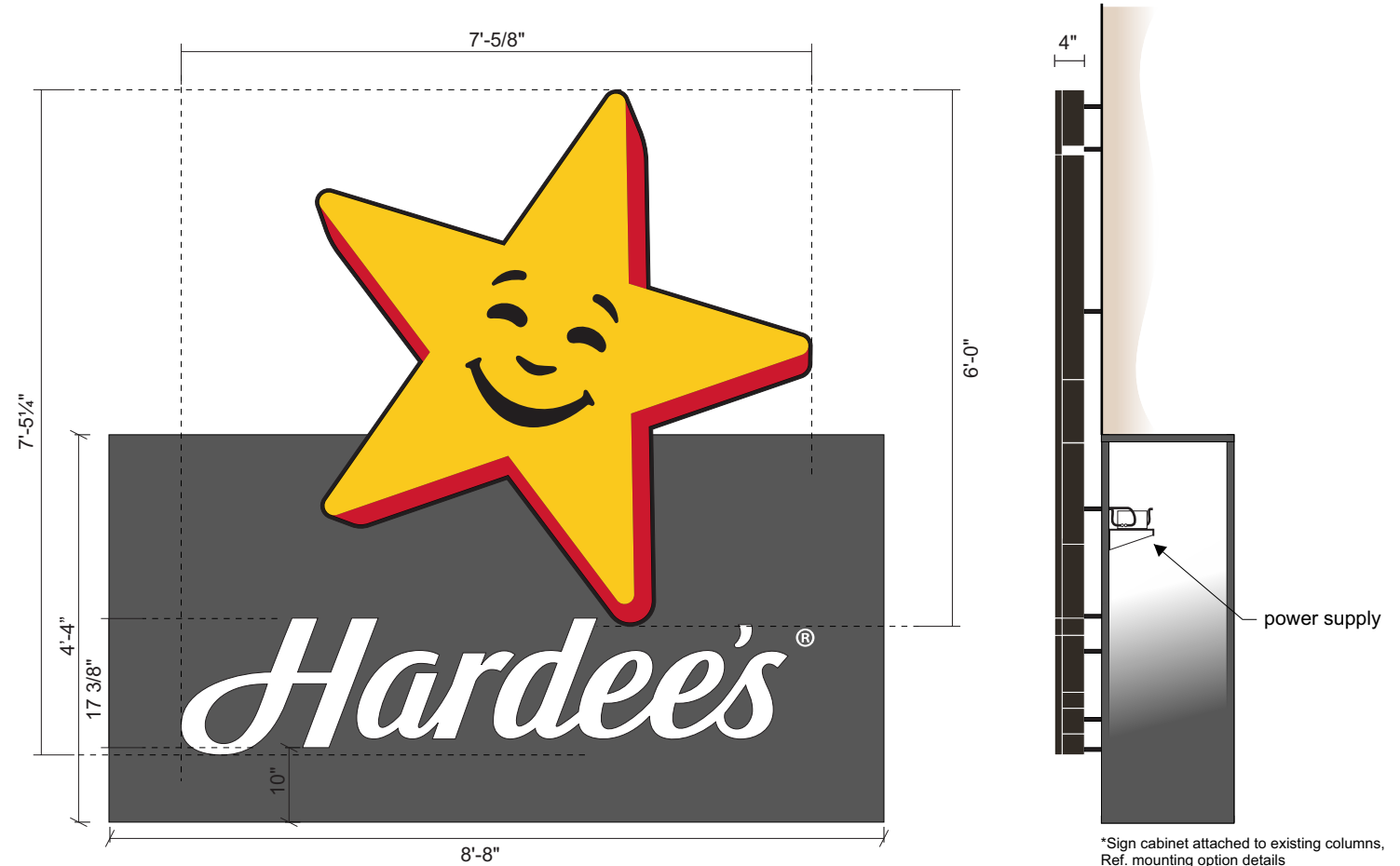

ELEVATION
 Scale: 1/2" = 1'-0"

1/2" x 1" Fab Retainer for Logo
52.5 sq ft

Specifications:

Letters:
 4"D, .063"aluminum returns - Black.
 .177" acrylic faces - 7328 White, 1" jewelite retainer to match returns.

Star:
 4"D, .063"aluminum returns - Black.
 .177" acrylic faces - 7328 White with 1st surface translucent vinyl graphics, 1/2" aluminum retainer to match returns.

Backer box to consist of (2) 2" aluminum angle w/ crossbars at front top, front bottom and rear bottom locations. Zip screw to metal cladding top and sides.
All framing, cladding, and visible fasteners to be painted SW 7674 Peppercorn.

Illumination:
 Facelit White LED, Red halo, mount projected 1/2" from facade.

All components MET Approved

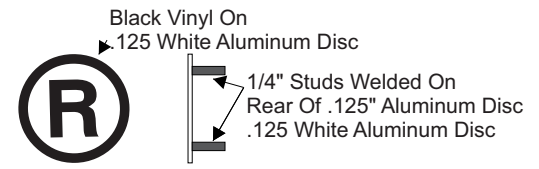

GENERAL COLOR SPECIFICATION

- PMS Black C / 3M 3630-22
- PMS 123C Yellow / 3M 3630-125
- PMS 186C Red / 3M 3630-73

Other:

- Matthews Satin Black for the returns & Jewelite Trim to match
- White - #7328 acrylic
- SW 7674 Peppercorn

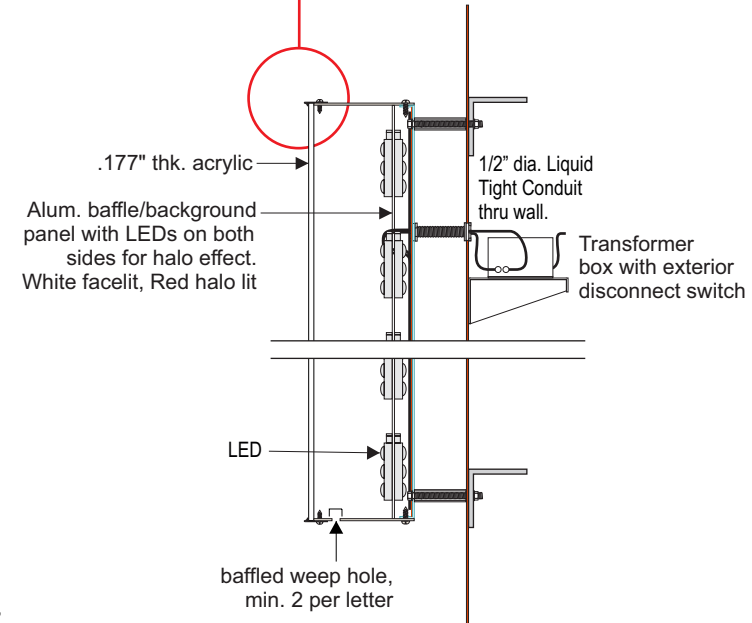
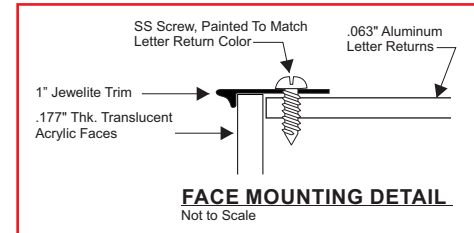

SIDE VIEW DETAIL LED Face & Halo Illumination

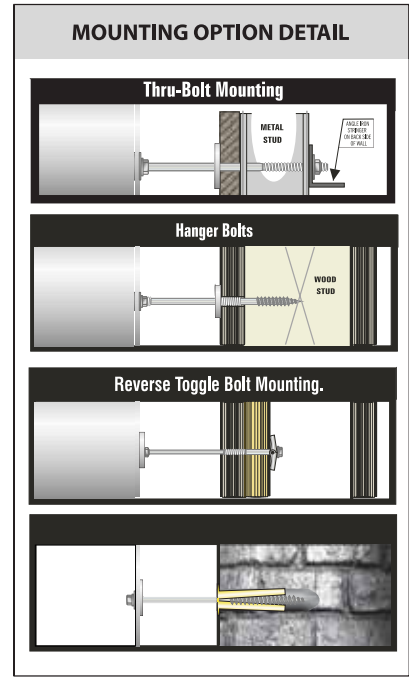

Right Elevation



Existing

71'-0"



Proposed

18'-0"

Elevation Frontage:	1278 sq ft	(216"H x 1852"W) / 144 = 1278 sq ft
Allowable Signage:	128sq ft	453 sq ft x 10% = 171 sq ft
Proposed sq ft:	53 sq ft	(89.25" x 84.625"W)/144 = 53 sq ft

Client Review Status
 Allen Industries, Inc. requires that an approved drawing be obtained from the client prior to any production release or production release revision.

Client Signature:	Approval Date:
-------------------	----------------

Notes:

#	Date	Description	Initial
1	04/13/22	-	BH
2	07/08/22	-	BH
3	-	-	-
4	-	-	-
5	-	-	-
6	-	-	-
7	-	-	-
8	-	-	-
9	-	-	-
10	-	-	-
11	-	-	-
12	-	-	-
13	-	-	-
14	-	-	-
15	-	-	-
16	-	-	-
17	-	-	-
18	-	-	-
19	-	-	-
20	-	-	-

Date:	Page #:
03/01/22	5

File Name:
CKE-H-F.41_Lake City, FL_301

Sales:	Design:	PM:
TA	BH	CR

Client:
Hardee's

Address:
**279 W. Duval St.
 Lake City, FL 32055**

Copyright © 2022 Allen Industries, Inc.
 This is an original, unpublished drawing, created by Allen Industries, Inc. This drawing is submitted to you in confidence for your use solely in connection with the project being planned for you by Allen Industries, Inc. and is not to be shown to anyone outside your organization, nor used, reproduced, copied or exhibited in any fashion whatsoever. The designs shown on the drawing (except for any registered trademarks that may belong to a client of Allen Industries, Inc.) remain the property of Allen Industries, Inc.



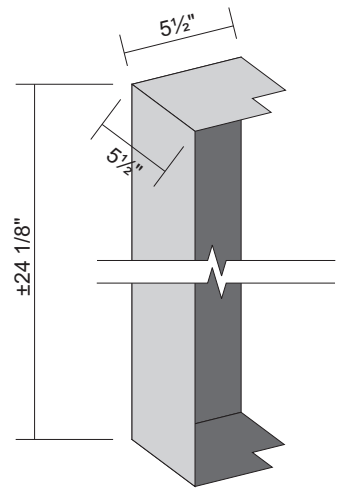

CORNER CAP

.040" fabricated aluminum painted black; to cap over corner joins of band

Specifications:

Mansard wrap band to be ACM cladding on 2" angle framework. Corners of band to be brought to square terminations with prefab caps.

- ACM to be 4mm BLX PE Black (62x196).
- Sheets to have routed returns to cap over install frame. All sheets to have 1" routed returns @ butt-joint locations.
- Mansard wash lighting (up) to be installed along upper length of band.

QTY: -

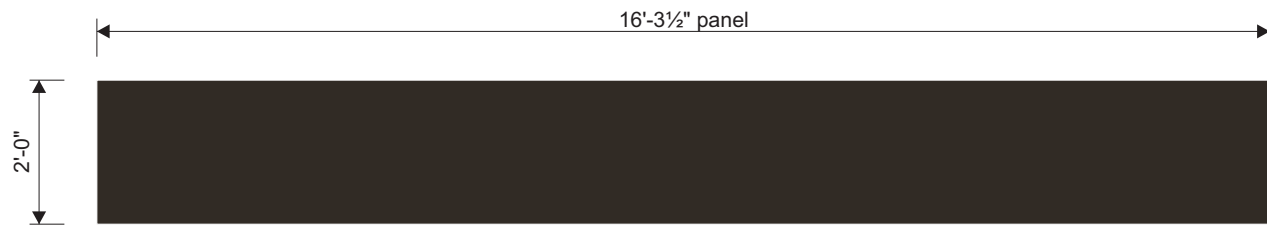

GEN. ELEVATION - Flat Panel Runs

Scale: 3/8" = 1'-0"

QTY: - Sheets will be field cut as necessary

FRAME SECTIONS MAY BE SLIGHTLY DIFFERNT

COLOR SPECIFICATIONS

■ BLX Black ACM

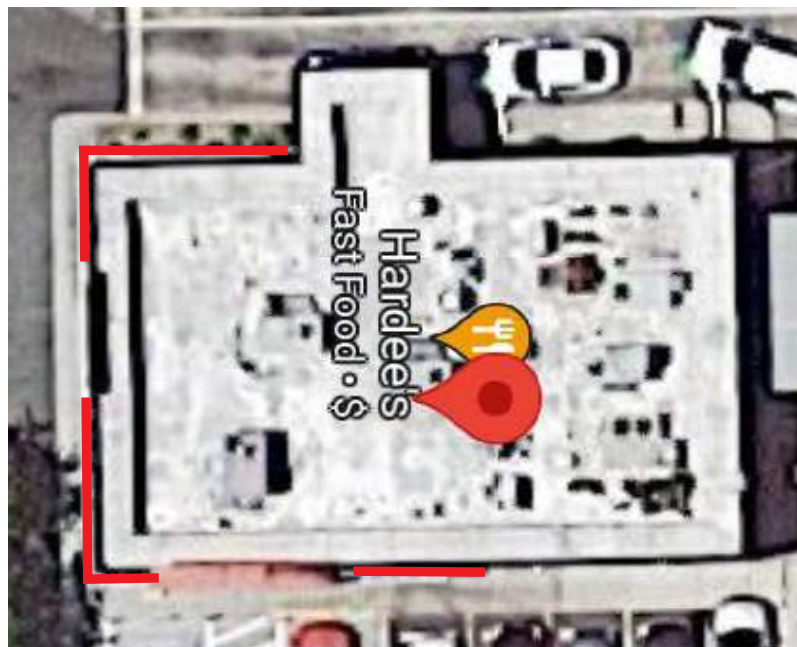

Proposed Mansard Wrap Locations

ROOF FASTENER SCHEDULE (ALL FASTENERS TO BE NON-COROSIVE)		
	3/8" Ø GRADE 36 THREADED ROD WITH BLOCKING BEHIND WALL	FOR ALL FRAMING TYPES
	3/8" Ø GRADE 36 LAG SCREW	FOR WOOD FRAMING. 2-1/2" MIN. EMBEDMENT IN 2x FRAMING / BLOCKING

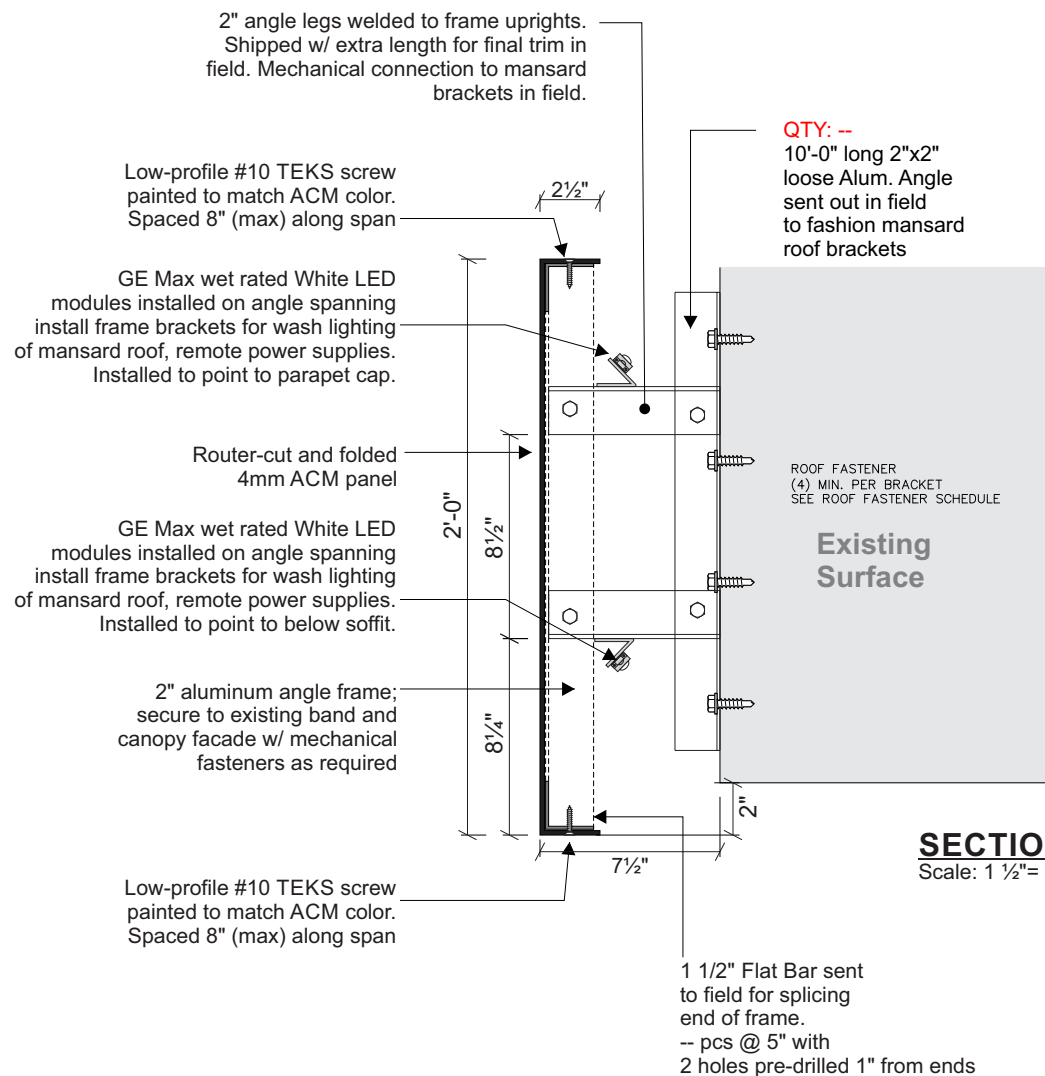

SECTION
Scale: 1 1/2" = 1"

QTY: -
10'-0" long 2"x2" loose Alum. Angle sent out in field to fashion mansard roof brackets

ROOF FASTENER (4) MIN. PER BRACKET SEE ROOF FASTENER SCHEDULE

Existing Surface

1 1/2" Flat Bar sent to field for splicing end of frame. -- pcs @ 5" with 2 holes pre-drilled 1" from ends

ACM Surface Wrap

Blank & Corners

Client Review Status

Allen Industries, Inc. requires that an approved drawing be obtained from the client prior to any production release or production release revision.

Client Signature: _____

Approval Date: _____

Notes:

#	Date	Description	Initial
1	04/13/22	-	BH
2	07/08/22	-	BH
3	-	-	-
4	-	-	-
5	-	-	-
6	-	-	-
7	-	-	-
8	-	-	-
9	-	-	-
10	-	-	-
11	-	-	-
12	-	-	-
13	-	-	-
14	-	-	-
15	-	-	-
16	-	-	-
17	-	-	-
18	-	-	-
19	-	-	-
20	-	-	-

Date: 03/01/22	Page #: 6
----------------	-----------

File Name: **CKE-H-F.41_Lake City, FL_301**

Sales: TA	Design: BH	PM: CR
-----------	------------	--------

Client: **Hardee's**

Address: **279 W. Duval St. Lake City, FL 32055**

Copyright © 2022 Allen Industries, Inc. This is an original, unpublished drawing, created by Allen Industries, Inc. This drawing is submitted to you in confidence for your use solely in connection with the project being planned for you by Allen Industries, Inc. and is not to be shown to anyone outside your organization, nor used, reproduced, copied or exhibited in any fashion whatsoever. The designs shown on the drawing (except for any registered trademarks that may belong to a client of Allen Industries, Inc.) remain the property of Allen Industries, Inc.

36" Channel Letters

Face / Halo Lit

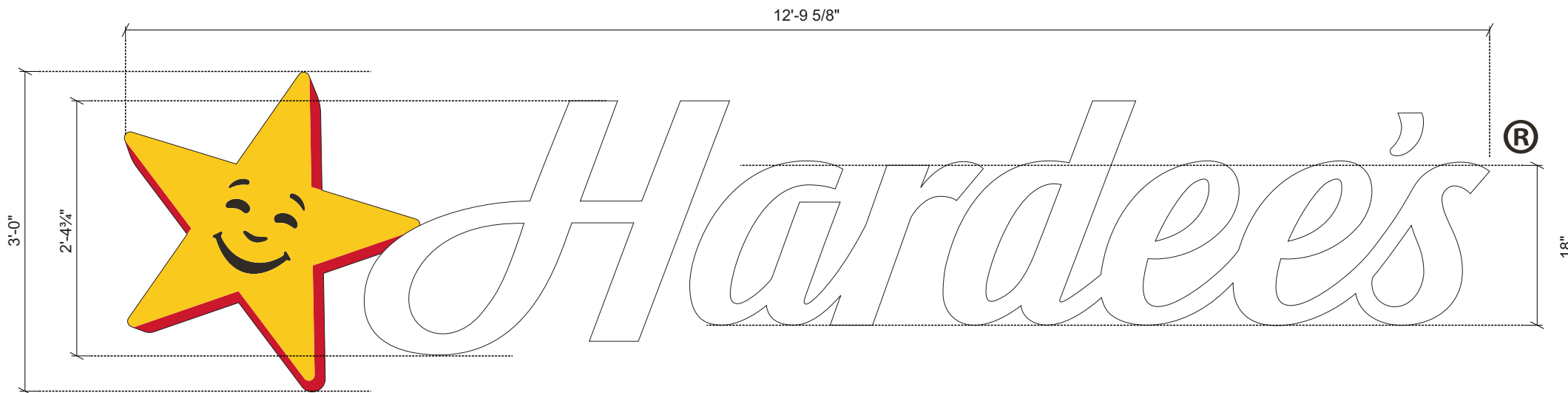

Client Review Status
 Allen Industries, Inc. requires that an approved drawing be obtained from the client prior to any production release or production release revision.

Client Signature: _____ Approval Date: _____

Notes:

#	Date	Description	Initial
1	04/13/22	-	BH
2	07/08/22	-	BH
3	-	-	-
4	-	-	-
5	-	-	-
6	-	-	-
7	-	-	-
8	-	-	-
9	-	-	-
10	-	-	-
11	-	-	-
12	-	-	-
13	-	-	-
14	-	-	-
15	-	-	-
16	-	-	-
17	-	-	-
18	-	-	-
19	-	-	-
20	-	-	-

Date: 03/01/22 Page #: 7

File Name: CKE-H-F.41_Lake City, FL_301

Sales: TA Design: BH PM: CR

Client: Hardee's

Address: 279 W. Duval St. Lake City, FL 32055

Copyright © 2022 Allen Industries, Inc. This is an original, unpublished drawing, created by Allen Industries, Inc. This drawing is submitted to you in confidence for your use solely in connection with the project being planned for you by Allen Industries, Inc. and is not to be shown to anyone outside your organization, nor used, reproduced, copied or exhibited in any fashion whatsoever. The designs shown on the drawing (except for any registered trademarks that may belong to a client of Allen Industries, Inc.) remain the property of Allen Industries, Inc.

Allen Industries
 YOUR BRAND AT ITS BEST™
 1-800-967-2553
 www.allenindustries.com

ELEVATION VIEW
 Scale: 3/4"= 1'-0"
 38.4 sq ft

Specifications:

- Letters:**
 4"D, .063"aluminum returns - Black.
 .177" acrylic faces - 7328 White, 1" jewelite retainer to match returns.
- Star:**
 4"D, .063"aluminum returns - Black.
 .177" acrylic faces - 7328 White with 1st surface translucent vinyl graphics, 1" jewelite retainer to match returns.

Illumination:
 Facelit White LED, Red halo backlight; 1½" projected mounting.
 All components MET Approved

GENERAL COLOR SPECIFICATION

- PMS 433C Black / 3M 3630-22 / AKZ CKE-DkGrey-082017
- Hardee's Red / AKZ 20647 / 3M 3630-73
- PMS 123C Yellow / 3M 3630-125 / AKZ CKE-Yellow-082017

Other:

- Matthews Satin Black for the returns & Jewelite Trim to match
- White - #7328 acrylic



Illuminated View

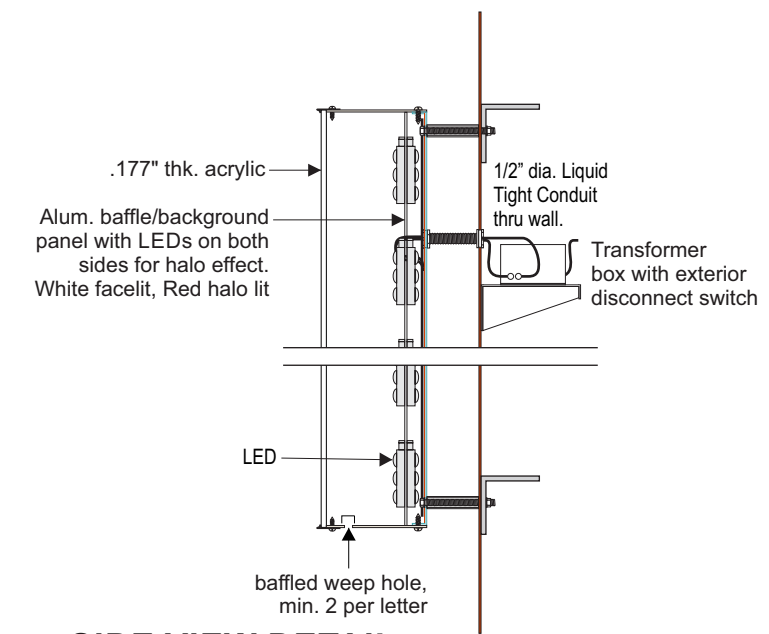

SIDE VIEW DETAIL
 LED Face & Halo Illumination



Existing cloud sign to be replaced

Allen Industries MET E212503
 LISTED Electric Sign Complies with UL48 CSA C22.2 No.207
 THIS SIGN IS INTENDED TO BE INSTALLED IN ACCORDANCE WITH THE REQUIREMENTS OF ARTICLE 600 OF THE NATIONAL ELECTRICAL CODE AND/OR OTHER APPLICABLE LOCAL CODES. THIS INCLUDES PROPER GROUNDING AND BONDING OF THE SIGN.
GROUNDING ELECTRICAL CONNECTIONS

HAR-OC32X8-FRIL-STAR

Order Canopy, Flat Roof

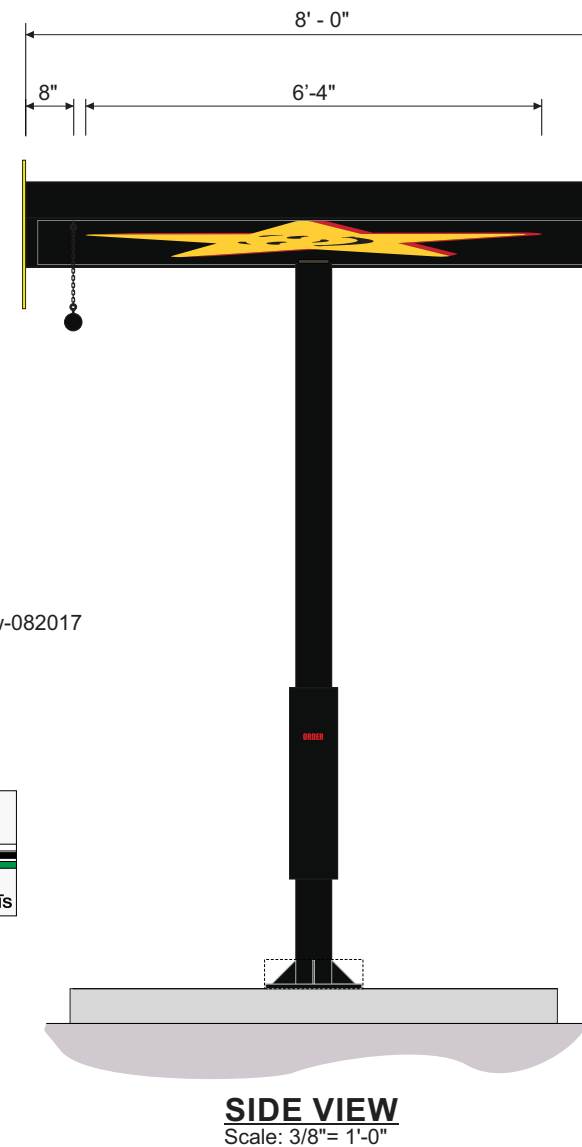
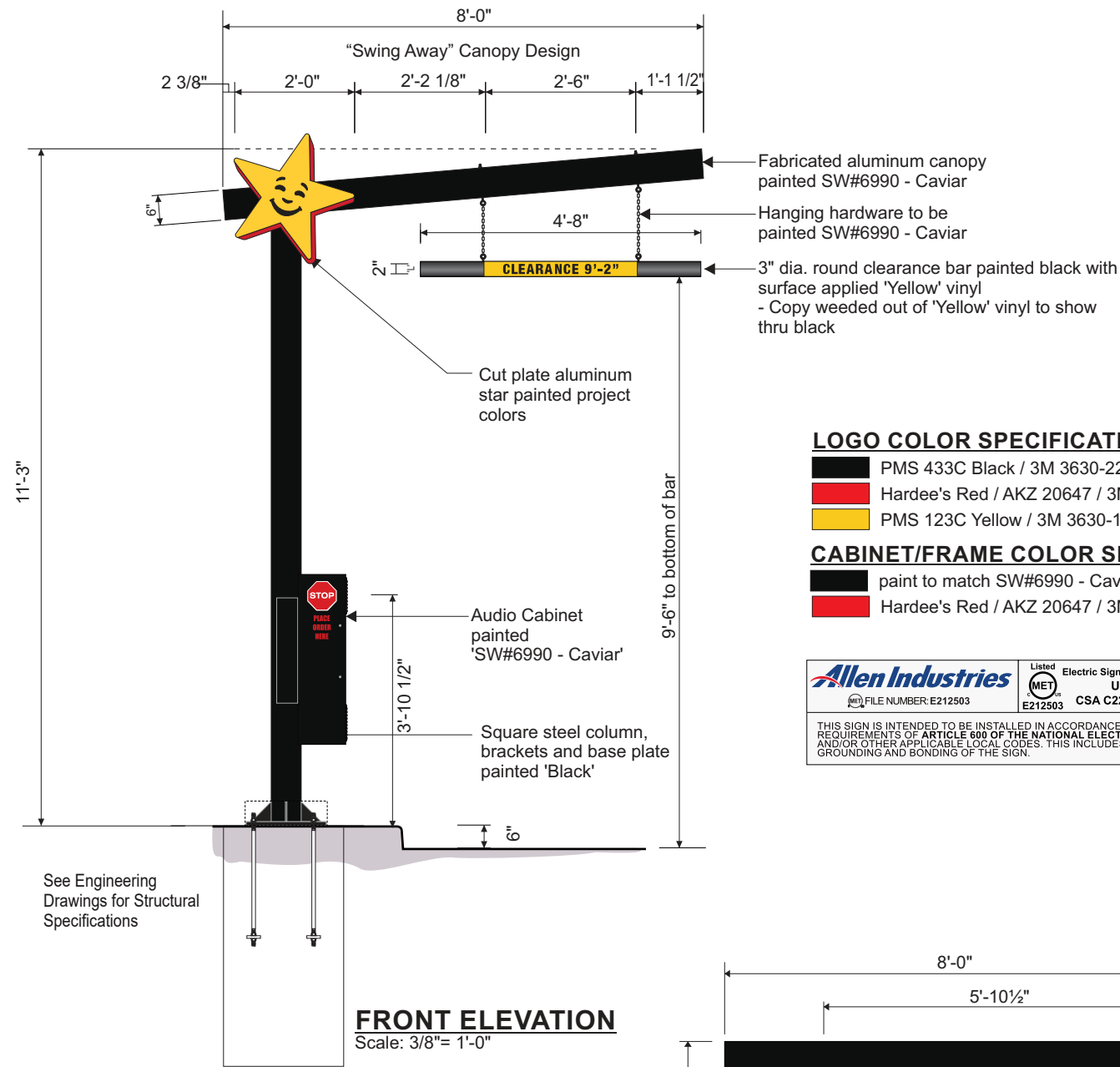

LOGO COLOR SPECIFICATION

- PMS 433C Black / 3M 3630-22
- Hardee's Red / AKZ 20647 / 3M 3630-73
- PMS 123C Yellow / 3M 3630-125 / AKZ CKE-Yellow-082017

CABINET/FRAME COLOR SPECIFICATION

- paint to match SW#6990 - Caviar
- Hardee's Red / AKZ 20647 / 3M 3630-73

Allen Industries FILE NUMBER: E212503

Listed Electric Sign Complies with **UL48** MET E212503 CSA C22.2 No.207

THIS SIGN IS INTENDED TO BE INSTALLED IN ACCORDANCE WITH THE REQUIREMENTS OF ARTICLE 600 OF THE NATIONAL ELECTRICAL CODE AND/OR OTHER APPLICABLE LOCAL CODES. THIS INCLUDES PROPER GROUNDING AND BONDING OF THE SIGN.

GROUNDING ELECTRICAL CONNECTIONS

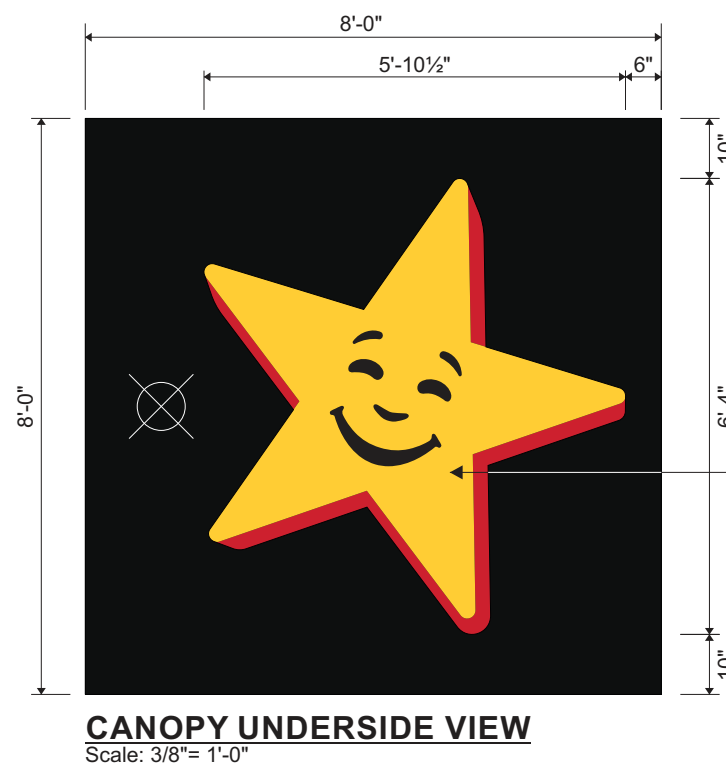
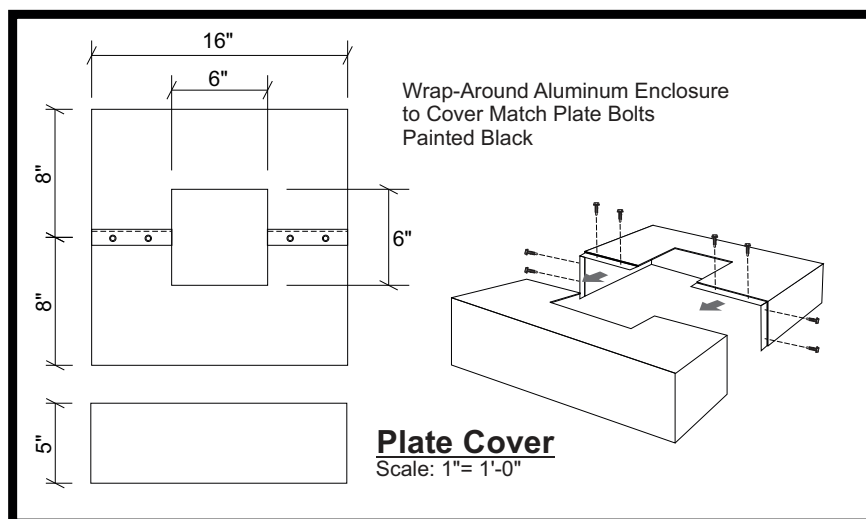

Notice:
YJ Inc is responsible for column, base plate, anchor bolt & foundation design only.

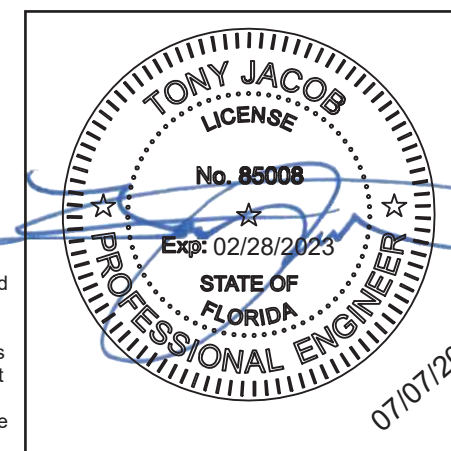

This item has been electronically signed and sealed by Tony Jacob using a digital signature and date. Printed copies of this document are not considered signed and sealed and the signature must be verified on any electronic copies.

Client Review Status

Allen Industries, Inc. requires that an approved drawing be obtained from the client prior to any production release or production release revision.

Client Signature:

Approval Date:

Notes:

#	Date	Description	Initial
1	04/11/22	-	BH
2	-	-	-
3	-	-	-
4	-	-	-
5	-	-	-
6	-	-	-
7	-	-	-
8	-	-	-
9	-	-	-
10	-	-	-
11	-	-	-
12	-	-	-
13	-	-	-
14	-	-	-
15	-	-	-
16	-	-	-
17	-	-	-
18	-	-	-
19	-	-	-
20	-	-	-

Date: **03/02/22** Page #: **10**

File Name:

Sales: **TA** Design: **BH** PM: **CR**

Client: **Hardee's**

Address: **279 W DUVAL ST
LAKE CITY, FL**

Copyright © 2022 Allen Industries, Inc. This is an original, unpublished drawing, created by Allen Industries, Inc. This drawing is submitted to you in confidence for your use solely in connection with the project being planned for you by Allen Industries, Inc. and is not to be shown to anyone outside your organization, nor used, reproduced, copied or exhibited in any fashion whatsoever. The designs shown on the drawing (except for any registered trademarks that may belong to a client of Allen Industries, Inc.) remain the property of Allen Industries, Inc.

Allen Industries
YOUR BRAND AT ITS BEST™
1-800-967-2553
www.allenindustries.com

HAR-OC32X8-FRIL-STAR

Order Canopy, Flat Roof Production Details

Client Review Status
 Allen Industries, Inc. requires that an approved drawing be obtained from the client prior to any production release or production release revision.

Client Signature: _____ Approval Date: _____

Notes:

#	Date	Description	Initial
1	04/11/22	-	BH
2	-	-	-
3	-	-	-
4	-	-	-
5	-	-	-
6	-	-	-
7	-	-	-
8	-	-	-
9	-	-	-
10	-	-	-
11	-	-	-
12	-	-	-
13	-	-	-
14	-	-	-
15	-	-	-
16	-	-	-
17	-	-	-
18	-	-	-
19	-	-	-
20	-	-	-

Date: **03/02/22** Page #: **11**

File Name: _____

Sales: **TA** Design: **BH** PM: **CR**

Client: **Hardee's**

Address: **279 W DUVAL ST
LAKE CITY, FL**

Copyright © 2022 Allen Industries, Inc.
 This is an original, unpublished drawing, created by Allen Industries, Inc. This drawing is submitted to you in confidence for your use solely in connection with the project being planned for you by Allen Industries, Inc. and is not to be shown to anyone outside your organization, nor used, reproduced, copied or exhibited in any fashion whatsoever. The designs shown on the drawing (except for any registered trademarks that may belong to a client of Allen Industries, Inc.) remain the property of Allen Industries, Inc.

Allen Industries
 YOUR BRAND AT ITS BEST™
1-800-967-2553
 www.allenindustries.com

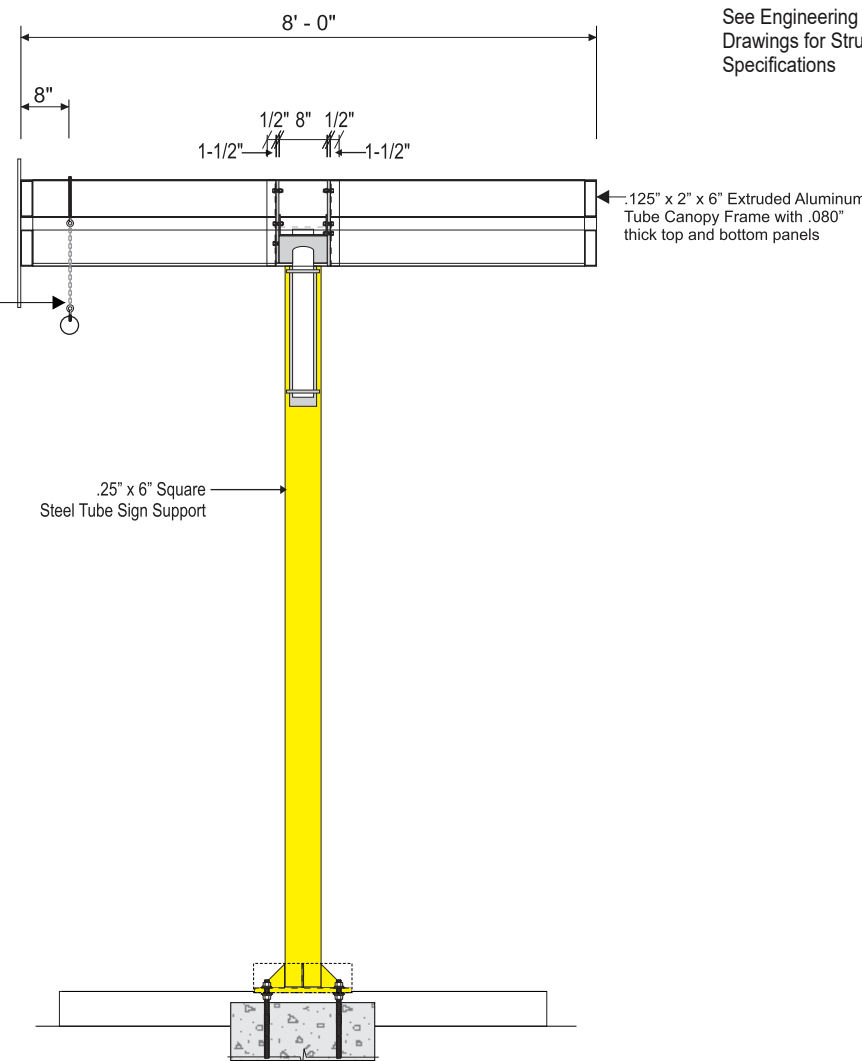
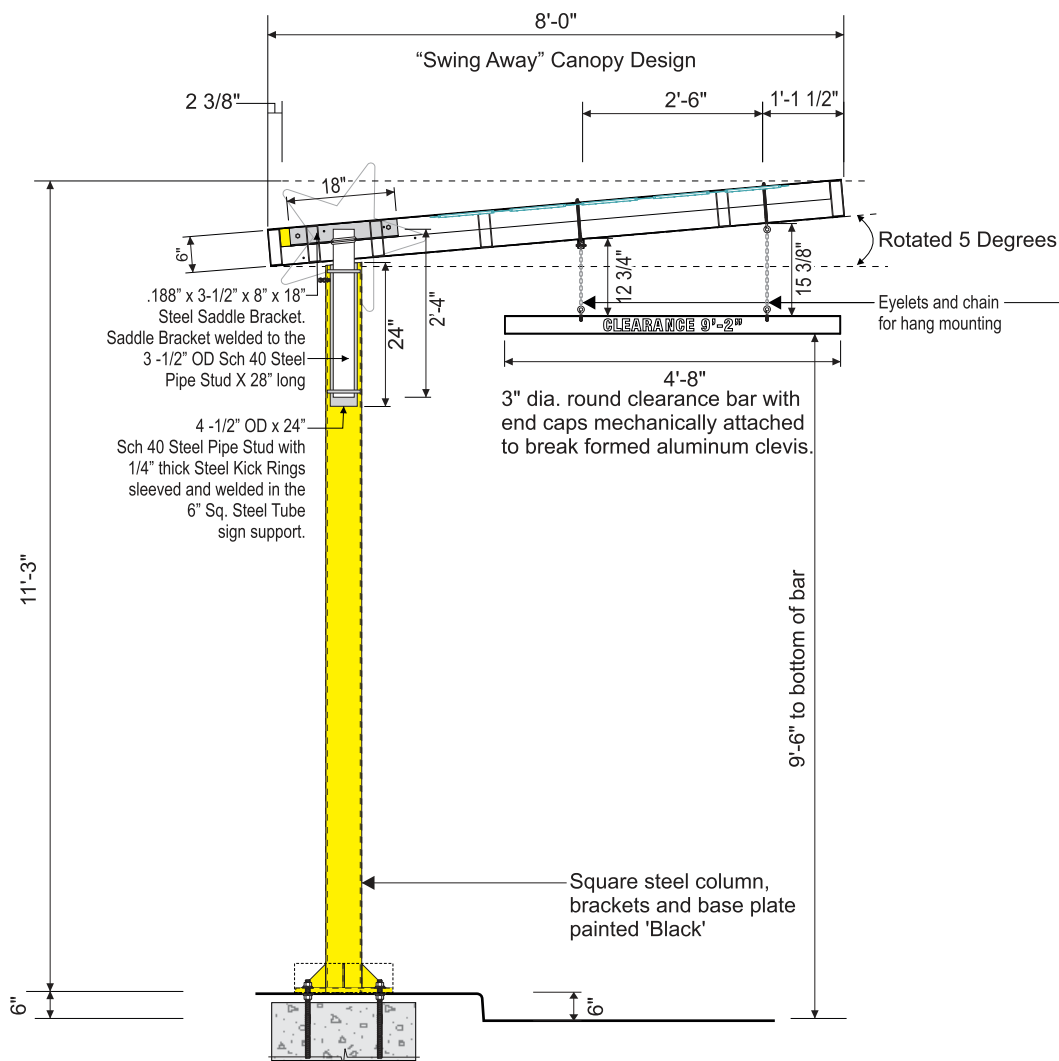
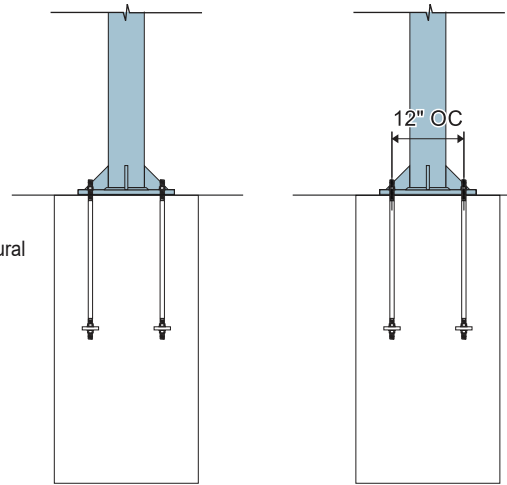
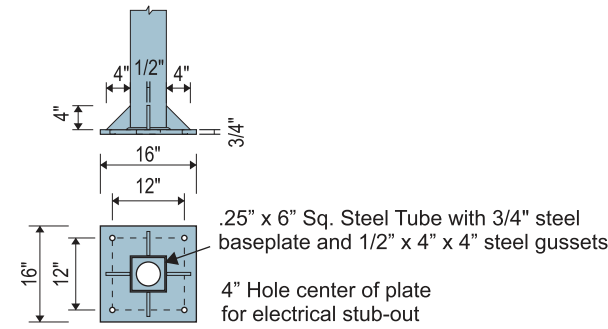
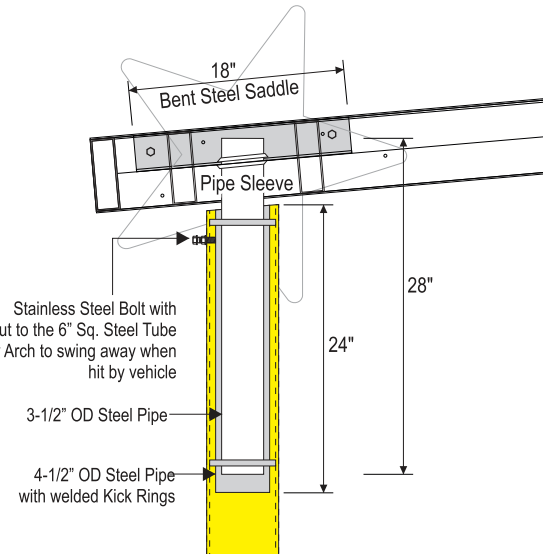
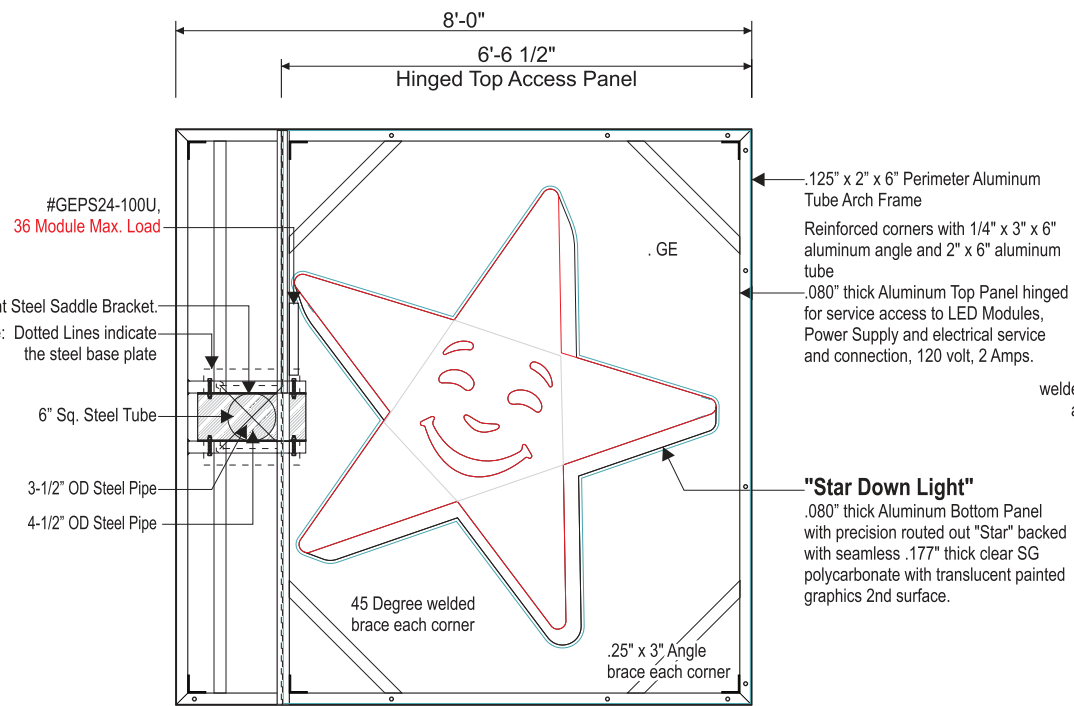

Notice:
 YJ Inc is responsible for column, base plate, anchor bolt & foundation design only.

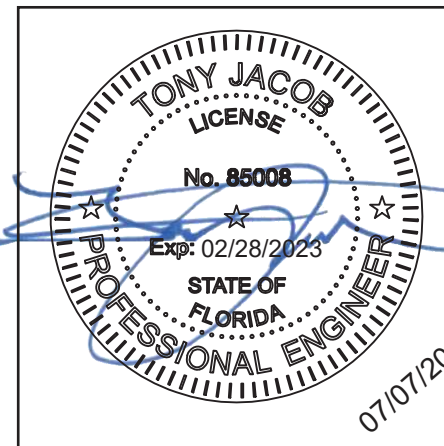

Allen Industries MET E212993 Electric Sign Complies with UL48 CSA C22.2 No.207

THIS SIGN IS INTENDED TO BE INSTALLED IN ACCORDANCE WITH THE REQUIREMENTS OF ARTICLE 600 OF THE NATIONAL ELECTRICAL CODE AND/OR OTHER APPLICABLE LOCAL CODES. THIS INCLUDES PROPER GROUNDING AND BONDING OF THE SIGN.

GROUNDING ELECTRICAL CONNECTIONS

GENERAL NOTES:

- All design, detailing, fabricating and construction shall conform to the following codes and specifications:
 - The Florida Building Code 7th Edition (2020) & (ASCE 7-16).
 - American Society of Testing and Materials (ASTM) specifications.
 - Building Code Requirements for Reinforced concrete (ACI 318-Current Edition).
 - Code for Welding in Building Construction of the American Welding Society.
 - Specification for the Design, Fabrication and Erection of Structural Steel for Buildings by The American Institute of Steel Construction (AISC) (Current Edition).
 - Aluminum Association Aluminum Design Manual (2010 Edition).
- Structural Material Specifications:
 - Aluminum shapes shall be extruded from 6061-T6 alloy. Welding filler alloy shall be 5183, 5356, 5556 or approved alternative.
 - Structural Steel and Plates shall be ASTM A-36 (F_y=36 ksi)
 - W-Shape beams shall be ASTM A-992 (F_y=50 ksi) Minimum
 - Structural tubing shall be ASTM A-500, Grade B, (F_y=46 ksi)
 - Structural piping shall be ASTM A-53, Grade B, Type E or S, (F_y=35 ksi), ASTM A572 Grade 42 (F_y=42 ksi) or ASTM A572 Grade 50 (F_y=50 ksi). (see drawing for individual member specifications).
- Threaded rods shall be Galvanized or Zinc plated F-1554 Grade 36, A307 Grade A, A307 Grade B, A307 Grade C, SAE J429 Grade 1 or SAE J429 Grade 2, unless otherwise noted.
- Welding electrodes shall comply with AWS D1.1-(Current Edition), E70XX. (All welding to be done by welder certified for specified weld type.)

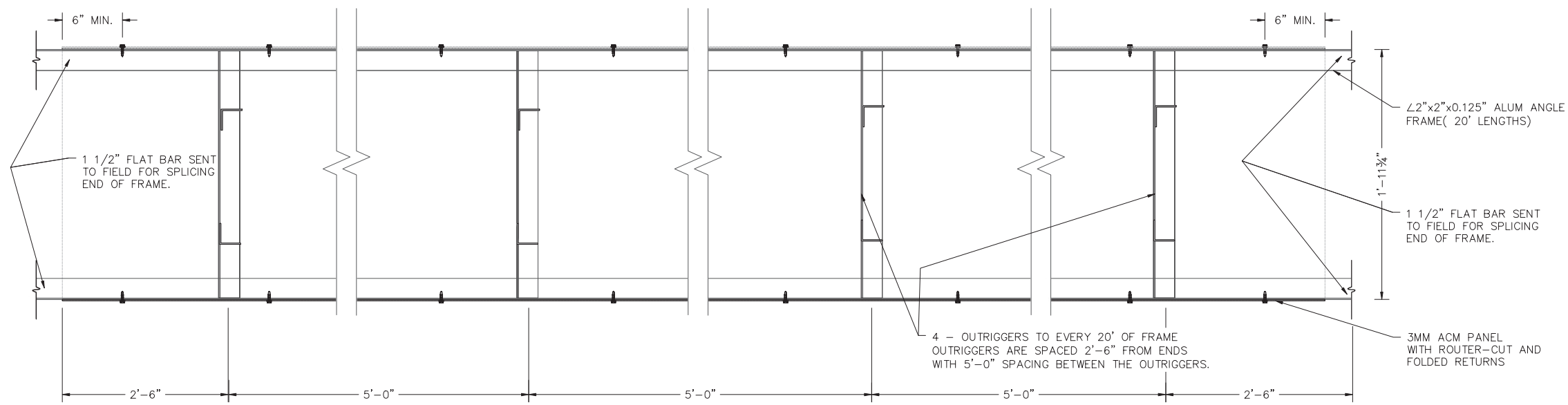

ANGLE INSTALLATION FRAME ELEVATION (TYP.)
 NOT TO SCALE

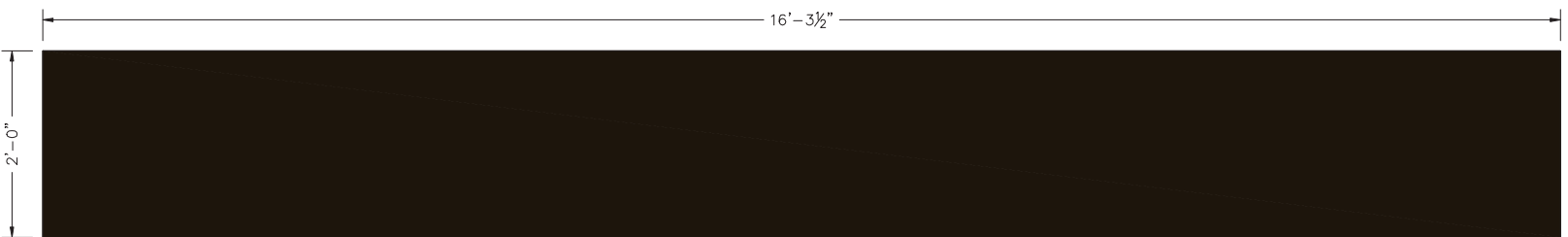

GEN. ELEVATION - FLAT PANEL RUNS
 SHEETS WILL BE FIELD CUT AS NECESSARY
 QTY: 7

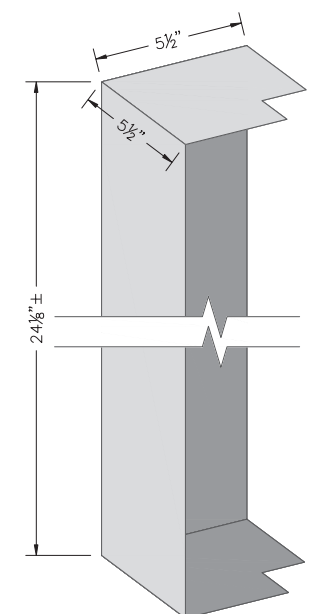
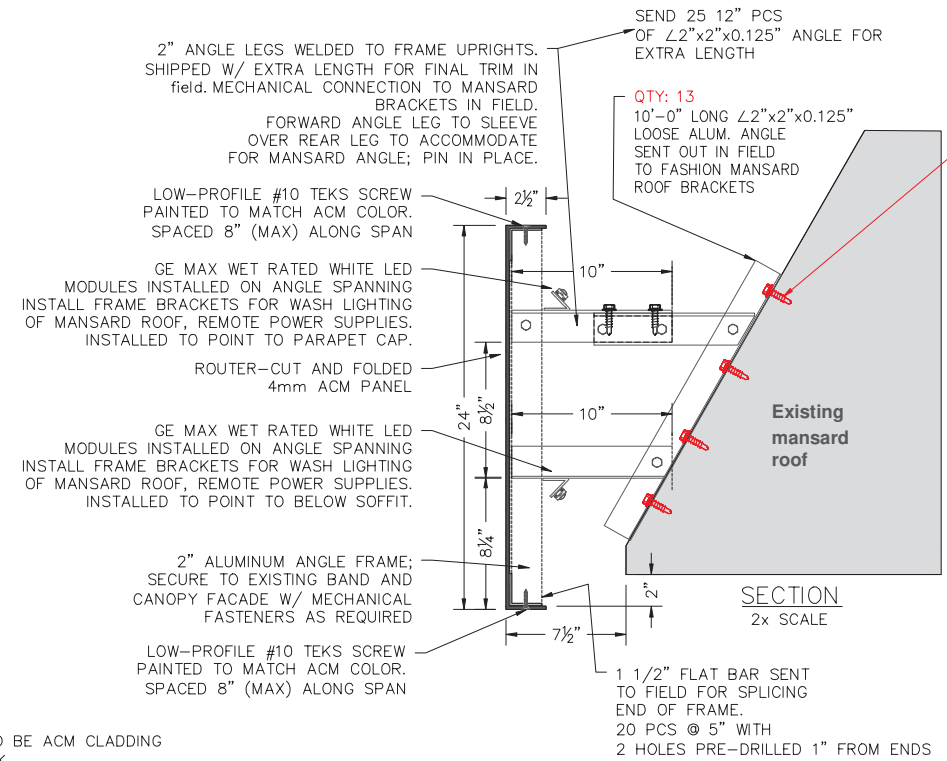

SPECIFICATIONS:
 MANSARD WRAP BAND TO BE ACM CLADDING ON 2" ANGLE FRAMEWORK.
 CORNERS OF BAND TO BE BROUGHT TO SQUARE TERMINATIONS WITH PREFAB CAPS.
 -ACM TO BE 4MM BLX PE BLACK (62X196).
 -SHEETS TO HAVE ROUTED RETURNS TO CAP OVER INSTALL FRAME.
 ALL SHEETS TO HAVE 1" ROUTED RETURNS @ BUTT-JOINT LOCATIONS.
 -MANSARD WASH LIGHTING (UP) TO BE INSTALLED ALONG UPPER LENGTH OF BAND.
 QTY: 2

CORNER CAP
 .040" FABRICATED ALUMINUM PAINTED BLACK; TO CAP OVER CORNER JOINS OF BAND

COLOR SPECIFICATIONS

BLX Black ACM

ROOF FASTENER SCHEDULE
 (ALL FASTENERS TO BE NON-CORROSIVE)

	3/8" Ø GRADE 36 THREADED ROD WITH BLOCKING BEHIND WALL	FOR ALL FRAMING TYPES
	3/8" Ø GRADE 36 LAG SCREW	FOR WOOD FRAMING. 2-1/2" MIN. EMBEDMENT IN 2x FRAMING / BLOCKING

Notice:
 YJ Inc is responsible for ACM Mansard Wrap Framing & roof attachment design only.

TONY JACOB
 LICENSE
 No. 98508
 Exp: 02/28/2023
 STATE OF FLORIDA
 PROFESSIONAL ENGINEER
 07/11/2022

This item has been electronically signed and sealed by Tony Jacob using a digital signature and date. Printed copies of this document are not considered signed and sealed and the signature must be verified on any electronic copies.