

PERMIT WORKSHEET

page 1 of 2

PERMIT NUMBER

Installer Brent Strickland License # IH 1104218
 Installer Mobile Phone # 386-365-7043
 Address of home being installed 1141 Falling Creek Road
LAKELAND, FL 32055
 Manufacturer Town Home Length x width 16x362

NOTE: if home is a single wide fill out one half of the blocking plan
 if home is a triple or quad wide sketch in remainder of home

I understand Lateral Arm Systems cannot be used on any home (new or used)
 where the sidewall ties exceed 5 ft 4 in.

Installer's initials BS

New Home ☐ Used Home ☒

Home installed to the Manufacturer's Installation Manual ☐

Home is installed in accordance with Rule 15-C ☒

Single wide ☒ Wind Zone II ☒ Wind Zone III ☐

Double wide ☐ Installation Decal # 43905

Triple/Quad ☐ Serial # _____

Roof System: ☒ Typical ☐ Hinged

PIER SPACING TABLE FOR USED HOMES

Load bearing capacity	Footer size (sq in)	16" x 16" (256)	18 1/2" x 18 1/2" (342)	20" x 20" (400)	22" x 22" (484)*	24" x 24" (576)*	26" x 26" (676)
1000 psf	3'	3'	4'	5'	6'	7'	8'
1500 psf	4' 6"	4' 6"	6'	7'	8'	8'	8'
2000 psf	6'	6'	8'	8'	8'	8'	8'
2500 psf	7' 6"	8'	8'	8'	8'	8'	8'
3000 psf	8'	8'	8'	8'	8'	8'	8'
3500 psf	8'	8'	8'	8'	8'	8'	8'

* Interpolated from Rule 15C-1 pier spacing table.

PIER PAD SIZES

I-beam pier pad size 17x25

Perimeter pier pad size 16x16

Other pier pad sizes (required by the mfg.) _____

Draw the approximate locations of marriage wall openings 4 foot or greater. Use this symbol to show the piers.

List all marriage wall openings greater than 4 foot and their pier pad sizes below.

Opening N/A Pier pad size _____

TIEDOWN COMPONENTS

Longitudinal Stabilizing Device (LSD)

Manufacturer olive
 Longitudinal Stabilizing Device w/ Lateral Arms

POPULAR PAD SIZES

Pad Size	Sq In
16 x 16	256
16 x 18	288
18.5 x 18.5	342
16 x 22.5	360
17 x 22	374
13 1/4 x 26 1/4	348
20 x 20	400
17 3/16 x 25 3/16	441
17 1/2 x 25 1/2	446
24 x 24	576
26 x 26	676

ANCHORS

4 ft ☒ 5 ft ☐

FRAME TIES

within 2' of end of home spaced at 5' 4" oc

OTHER TIES

Number
Sidewall <u>24</u>
Longitudinal <u>0</u>
Marriage wall <u>8</u>
Shearwall <u>0</u>

Typical pier spacing

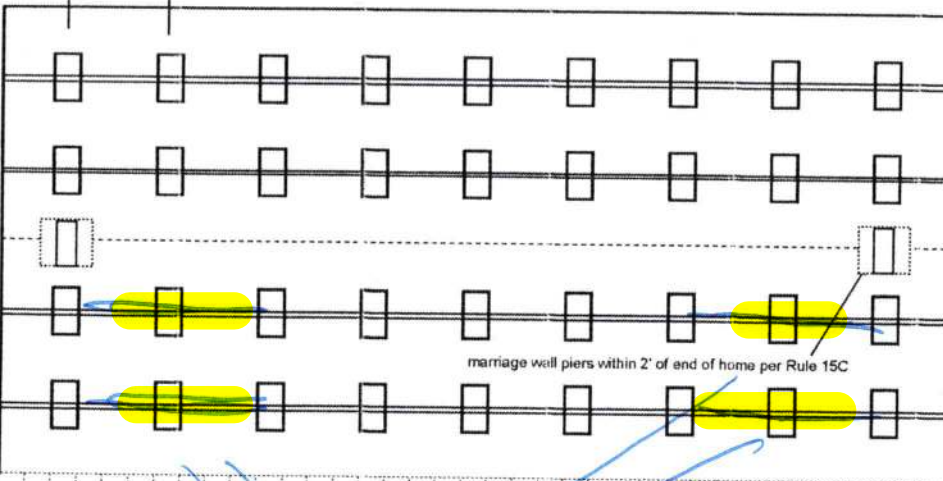
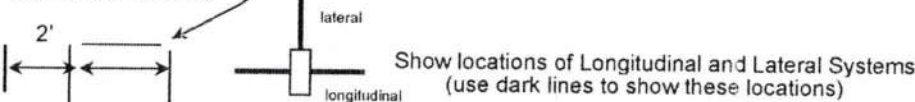

Model HOLLY olive system
I beam backed 5' o.c 17x25 ASD
pad 1500# soil

Laurie
Hodson

Digitally signed by Laurie Hodson
 Date: 2020.11.18 12:09:02 -05'00'

PERMIT NUMBER

PERMIT WORKSHEET

page 2 of 2

POCKET PENETROMETER TEST

The pocket penetrometer tests are rounded down to 1500 psf or check here to declare 1000 lb. soil _____ without testing.

x 1500 x 1700 x 1790

POCKET PENETROMETER TESTING METHOD

1. Test the perimeter of the home at 6 locations.
2. Take the reading at the depth of the footer.
3. Using 500 lb. increments, take the lowest reading and round down to that increment.

x 1500 x 1700 x 1500

TORQUE PROBE TEST

The results of the torque probe test is 285 inch pounds or check here if you are declaring 5' anchors without testing _____. A test showing 275 inch pounds or less will require 5 foot anchors.

Note: A state approved lateral arm system is being used and 4 ft. anchors are allowed at the sidewall locations. I understand 5 ft anchors are required at all centerline tie points where the torque test reading is 275 or less and where the mobile home manufacturer may requires anchors with 4000 lb holding capacity.

BS Installer's initials

ALL TESTS MUST BE PERFORMED BY A LICENSED INSTALLER

Installer Name Brent Strickland
Date Tested 10/27/20



Site Preparation

Debris and organic material removed _____
Water drainage: Natural _____ Swale _____ Pad _____ Other _____

Fastening multi wide units

Floor: Type Fastener: _____ Length: _____ Spacing: _____
Walls: Type Fastener: _____ Length: _____ Spacing: _____
Roof: Type Fastener: _____ Length: _____ Spacing: _____
For used homes a min. 30 gauge, 8" wide, galvanized metal strip will be centered over the peak of the roof and fastened with galv. roofing nails at 2" on center on both sides of the centerline.

Gasket (weatherproofing requirement)

I understand a properly installed gasket is a requirement of all new and used homes and that condensation, mold, mildew and buckled marriage walls are a result of a poorly installed or no gasket being installed. I understand a strip of tape will not serve as a gasket.

Installer's initials _____

Type gasket _____
Pg. _____

Installed: _____
Between Floors Yes _____
Between Walls Yes _____
Bottom of ridgebeam Yes _____

Weatherproofing

The bottomboard will be repaired and/or taped. Yes _____ Pg. _____
Siding on units is installed to manufacturer's specifications. Yes _____
Fireplace chimney installed so as not to allow intrusion of rain water. Yes _____

Miscellaneous

Skirting to be installed. Yes _____ No _____
Dryer vent installed outside of skirting. Yes _____ N/A _____
Range downflow vent installed outside of skirting. Yes _____ N/A _____
Drain lines supported at 4 foot intervals. Yes _____
Electrical crossovers protected. Yes _____
Other: _____

Electrical

Connect electrical conductors between multi-wide units, but not to the main power source. This includes the bonding wire between multi-wide units. Pg. _____

Plumbing





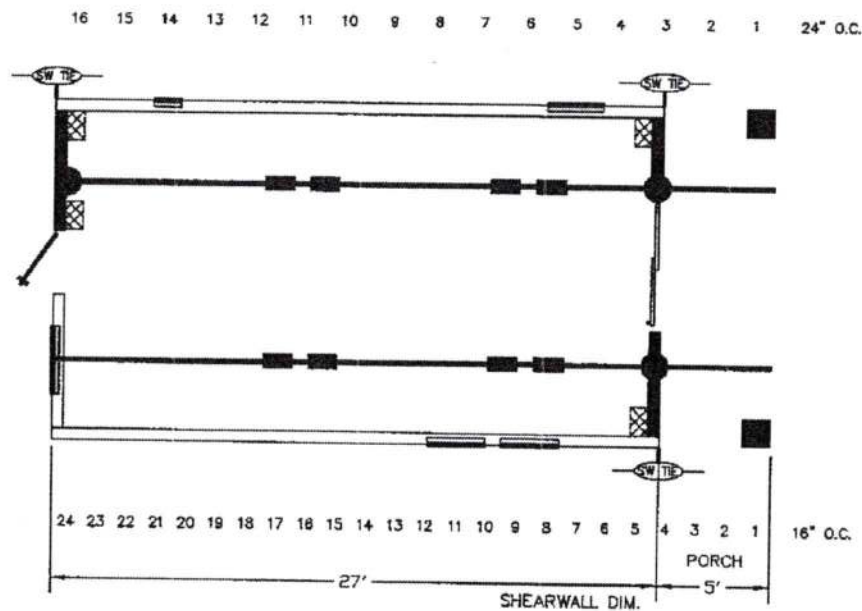

Connect all sewer drains to an existing sewer tap or septic tank. Pg. _____

Connect all potable water supply piping to an existing water meter, water tap, or other independent water supply systems. Pg. _____

Installer verifies all information given with this permit worksheet is accurate and true based on the manufacturer's installation instructions and or Rule 15C-1 & 2

Installer Signature BS Date 10/27/20



-  I-BEAM BLOCKING
SEE SOIL BEARING CAPACITY CHARTS FOR SPACING
-  COLUMN BLOCKING
SEE SOIL BEARING CAPACITY CHARTS FOR PAD SIZE
-  SHEARWALL BLOCKING
-  SHEARWALL FRAME TIE
-  CENTER LINE TIES
-  VERTICAL TIE
MAX. SPACING 5'-4" CENTER TO CENTER
-  LONGITUDINAL TIES

 SHEARWALL TIE

BLOCKING LEGEND: FLORIDA

- 1) ALL EXTERIOR DOORS, BAY WINDOWS, RECESSED SIDEWALLS AND EXTERIOR WALL OPENINGS 48" OR GREATER, WILL REQUIRE BLOCKING ON EACH SIDE.
- 2) 32' WIDE HOMES REQUIRED TO BE BLOCKED MIN 8'-0" ON CENTER BETWEEN COLUMNS.



Date: 8-21-17	Revisions:	Code: 1613A
Dr'n: SLM		
Parent: NEW		
Code: T (17)		
Model: 1613-476	Print: FLORIDA BLOCKING PLAN	

FRONT

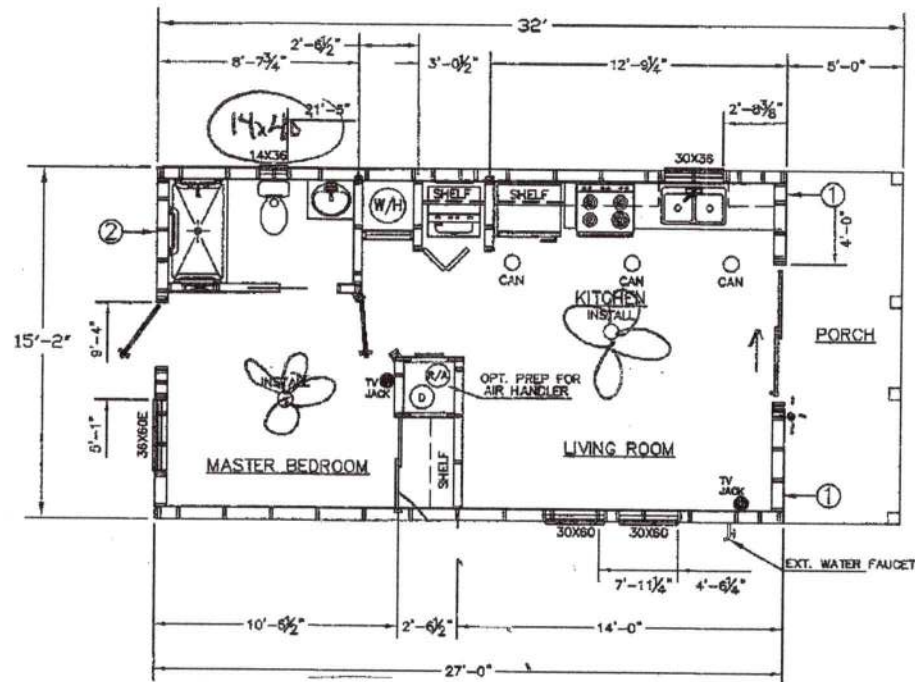

KENNEDY S208558

ZONE 2	SW#1	SW#2
--------	------	------



Date: 8-21-17	Revisions		Code: S206558
Dr'n: SLM			
Parent: NEW			
Code: T (17)			
<div> <div>ZONE</div> <div>2</div> </div>	Model: 1613-473	Print: 410 SQ.FT. SALES	