

PERMIT NO. 20-0887  
DATE PAID: 11/9/20  
FEE PAID: 310.00  
RECEIPT #: 1600174



STATE OF FLORIDA  
DEPARTMENT OF HEALTH  
ONSITE SEWAGE TREATMENT AND DISPOSAL  
SYSTEM  
APPLICATION FOR CONSTRUCTION PERMIT

APPLICATION FOR:

☒ New System ☒ Existing System ☐ Holding Tank ☐ Innovative  
☐ Repair ☐ Abandonment ☐ Temporary ☐

APPLICANT: NEW GENERATION CHRISTIAN MINISTRY INC

AGENT: DMC CONSTRUCTION INC.

TELEPHONE: (386) 867-5055

MAILING ADDRESS: 184 N. MARION AVE.

LAKE CITY

FL 32055

TO BE COMPLETED BY APPLICANT OR APPLICANT'S AUTHORIZED AGENT. SYSTEMS MUST BE CONSTRUCTED BY A PERSON LICENSED PURSUANT TO 489.105(3) (m) OR 489.552, FLORIDA STATUTES. IT IS THE APPLICANT'S RESPONSIBILITY TO PROVIDE DOCUMENTATION OF THE DATE THE LOT WAS CREATED OR PLATTED (MM/DD/YY) IF REQUESTING CONSIDERATION OF STATUTORY GRANDFATHER PROVISIONS.

PROPERTY INFORMATION

LOT: N/A BLOCK: N/A SUBDIVISION: METES AND BOUNDS PLATTED: \_\_\_\_\_

PROPERTY ID #: 07-4S-17-08110-000 ZONING: COM I/M OR EQUIVALENT: ☐ NO ☐

PROPERTY SIZE: 25.150 ACRES WATER SUPPLY: ☐ PRIVATE PUBLIC ☐ ≤2000GPD ☒ >2000GPD

IS SEWER AVAILABLE AS PER 381.0065, FS? ☐ NO ☐ DISTANCE TO SEWER: N/A FT

PROPERTY ADDRESS: 608 MARVIN BURNETT RD. LAKE CITY

DIRECTIONS TO PROPERTY:

90 WEST, TURN LEFT ON SISTERS WELCOM BLVD. TURN LEFT ON BASCOM NORRIS DR. TURN RIGHT ON MARVIN BURNETT RD. TURN RIGHT ON SW HIDEAWAY DR. SITE ON RIGHT.

BUILDING INFORMATION ☐ RESIDENTIAL ☒ COMMERCIAL

Unit No.	Type of Establishment	No. of Bedrooms	Building Area Sqft	Commercial/Institutional System Design Table 1, Chapter 64E-6, FAC
1	SCHOOL BUILDING	0	11,152	12 CLASS ROOMS X 15 STUDENTS = 180 STUDENTS
2				180 STUDENTS X 10 GPD = 1800 TOTAL GPD
3			5,000	GYM BUILDING
4				

+ 12 Teachers Ref.  
@ 15 GPD per Teacher

☐ Floor/Equipment Drains ☐ Other (Specify) \_\_\_\_\_

SIGNATURE: \_\_\_\_\_

DATE: 11/9/2020

20.0887

NORTH

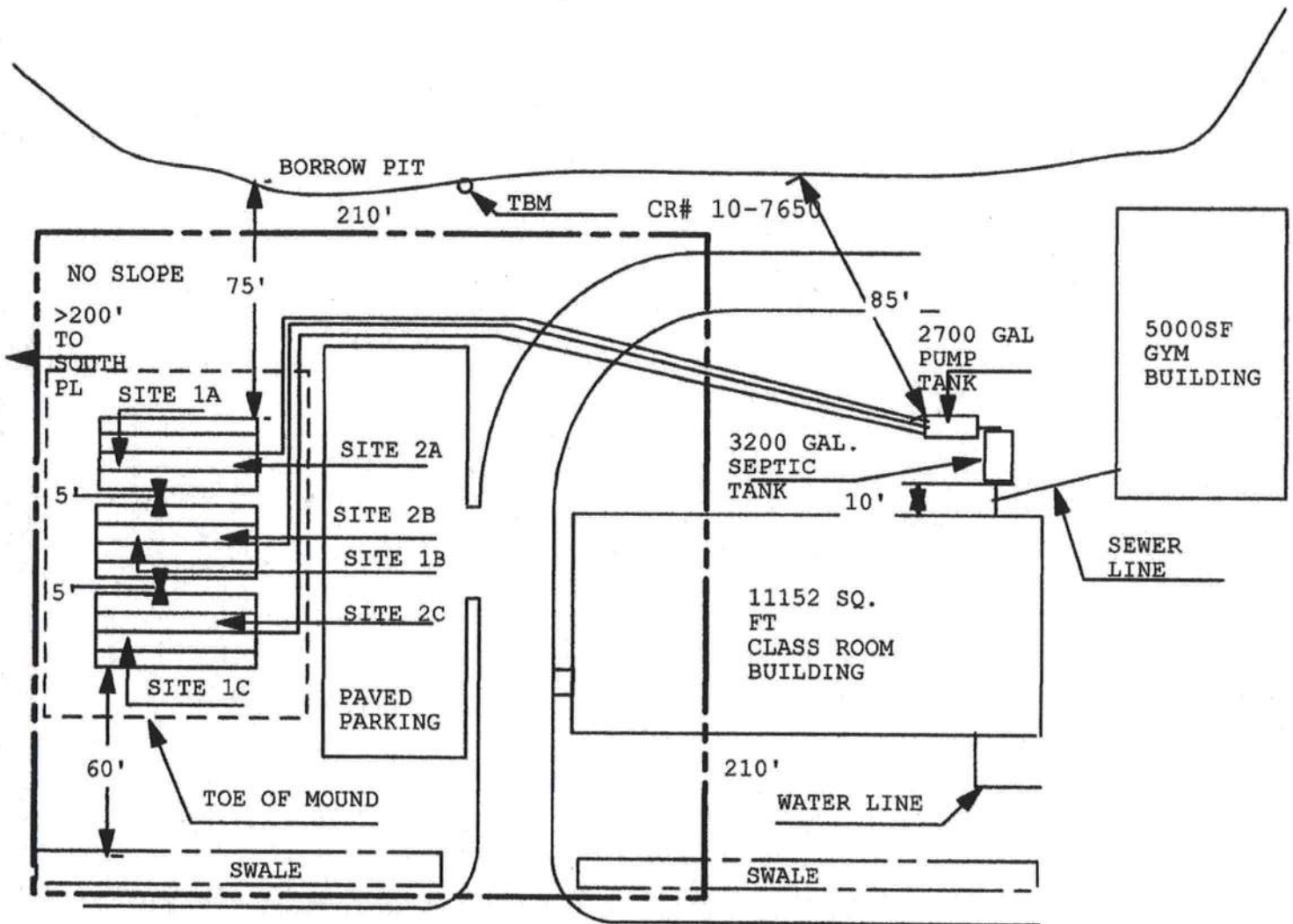

NO WELLS WITHIN 100'

1 INCH = 50 FEET

Site Plan Submitted

By [Signature] Date 11/7/20

Plan Approved [Signature] Not Approved           

Date 11/12/20

By [Signature] CPHU Columbia

APPROVED

Notes: